

6/12 PITCH - 24" O/H

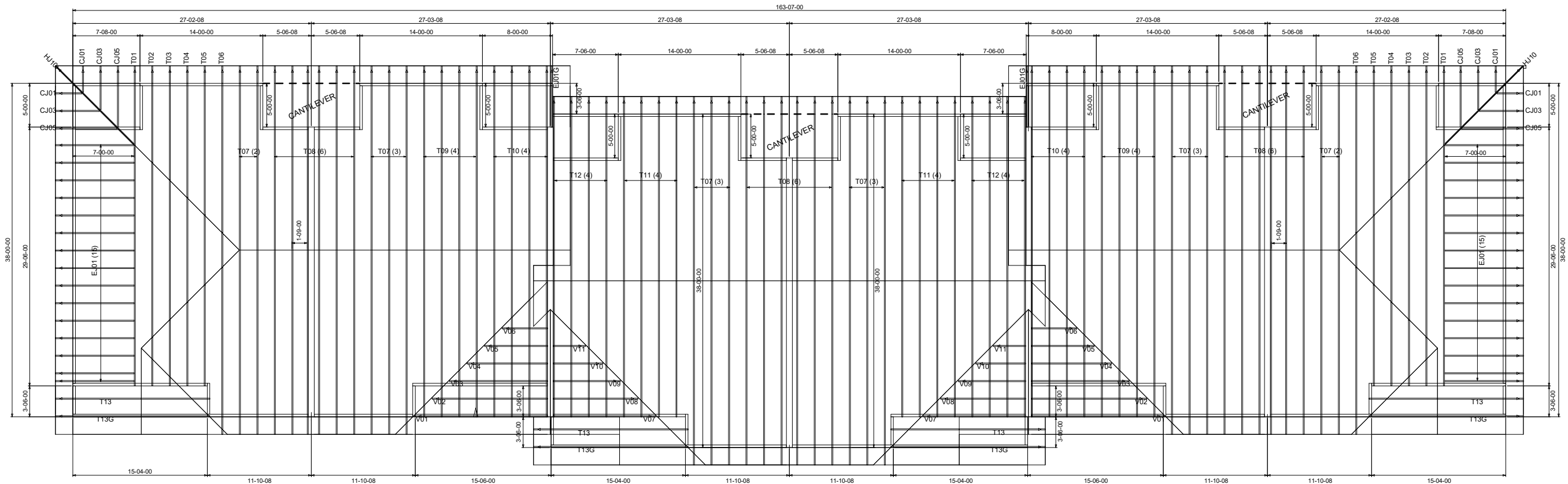

BEARING HEIGHT SCHEDULE

PER PLAN

- NOTES:
- 1) REFER TO HB 91 (RECOMMENDATIONS FOR HANDLING INSTALLATION AND TEMPORARY BRACING) REFER TO ENGINEERED DRAWINGS FOR PERMANENT BRACING REQUIRED.
  - 2) ALL TRUSSES (INCLUDING TRUSSES UNDER VALLEY FRAMING) MUST BE COMPLETELY DECKED OR REFER TO DETAIL V105 FOR ALTERNATE BRACING REQUIREMENTS.
  - 3) ALL VALLEYS ARE TO BE CONVENTIONALLY FRAMED BY BUILDER.
  - 4) ALL TRUSSES ARE DESIGNED FOR 2' o.c. MAXIMUM SPACING, UNLESS OTHERWISE NOTED.
  - 5) ALL WALLS SHOWN ON PLACEMENT PLAN ARE CONSIDERED TO BE LOAD BEARING, UNLESS OTHERWISE NOTED.
  - 6) SY42 TRUSSES MUST BE INSTALLED WITH THE TOP BEING UP.
  - 7) BEAM/HEADER/INTEL (HDR) TO BE FURNISHED BY BUILDER.



Jacksonville  
PHONE: 904-772-6100 FAX: 904-772-1973

Tampa  
PHONE: 813-621-9831 FAX: 813-628-8956

Lake City  
PHONE: 386-755-6894 FAX: 386-755-7973

BUILDER: **BLAKE CONST.**

LEGAL ADDRESS: **APARTMENTS**

MODEL: Revision: Rev. By:

DATE: 9-6-20 DRAWN BY: KLH Original Reference #: 2455456

1st Level Job #: 2nd Level Job #: Roof Job #: 2455456

FL Approval Codes - Mitek Plates #'s 2197.2 - 2197.4, Versa-Lam #1644-R4 & BCI Joists #1392-R4