



STATE OF FLORIDA
DEPARTMENT OF ENVIRONMENTAL PROTECTION
ONSITE SEWAGE TREATMENT AND DISPOSAL
SYSTEM (OSTDS)

PERMIT NO. 23-0411
DATE PAID: 6/5/23
FEE PAID: 60.00
RECEIPT #: AP1969912

APPLICATION FOR CONSTRUCTION PERMIT

APPLICATION FOR:

☐ New System ☒ Existing System ☐ Holding Tank ☐ Innovative
☐ Repair ☐ Abandonment ☐ Temporary ☐

APPLICANT: Marie & Angel Colon

EMAIL: marie.colon2@gmail.com

AGENT:

TELEPHONE: (386) 288-4697

MAILING ADDRESS: 412 SW Fenton Glen Ft. White, FL 32838

TO BE COMPLETED BY APPLICANT OR APPLICANT'S AUTHORIZED AGENT. SYSTEMS MUST BE CONSTRUCTED BY A PERSON LICENSED PURSUANT TO 489.105(3) (m) OR 489.552, FLORIDA STATUTES. IT IS THE APPLICANT'S RESPONSIBILITY TO PROVIDE DOCUMENTATION OF THE DATE THE LOT WAS CREATED OR PLATTED (MM/DD/YY) IF REQUESTING CONSIDERATION OF STATUTORY GRANDFATHER PROVISIONS.

PROPERTY INFORMATION

OSTDS REMEDIATION PLAN? [Y / N]

LOT: 118 BLOCK: _____ SUBDIVISION: _____ PLATTED: _____

PROPERTY ID #: 00-00-00-01009-000 ZONING: _____ I/M OR EQUIVALENT: [Y / N]

PROPERTY SIZE: .921 ACRES WATER SUPPLY: [] PRIVATE PUBLIC [] <=2000GPD [] >2000GPD

IS SEWER AVAILABLE AS PER 381.0065, FS? [Y / N] DISTANCE TO SEWER: _____ FT

PROPERTY ADDRESS: 1881 SW Nebraska Terr. Ft. White, FL 32838

DIRECTIONS TO PROPERTY: 27 N. to SW Riverside Ave LEFT - Go to Nebraska Terr. make LEFT. Go down to 1881 SW Nebraska Terr. property on LEFT side.

BUILDING INFORMATION

☒ RESIDENTIAL ☐ COMMERCIAL

Unit No. Type of Establishment No. of Bedrooms Building Area Sqft Commercial/Institutional System Design Table I, Chapter 62-6, FAC

1	<u>Residential</u>	<u>2</u>	<u>900 w/ Bonus for space/storage 2nd floor</u>	
2				
3				
4				

[] Floor/Equipment Drains [] Other (Specify) _____

SIGNATURE: _____ DATE: 6/5/23

DEP 4015, 06-21-2022 (Obsoletes previous editions which may not be used)

Incorporated 62-6.004, FAC

Page 1 of 4

STATE OF FLORIDA
DEPARTMENT OF ENVIRONMENTAL PROTECTION
APPLICATION FOR CONSTRUCTION PERMIT

Permit Application Number

23-0411

PART II - SITEPLAN

Scale: Each block represents 10 feet and 1 inch = 40 feet.

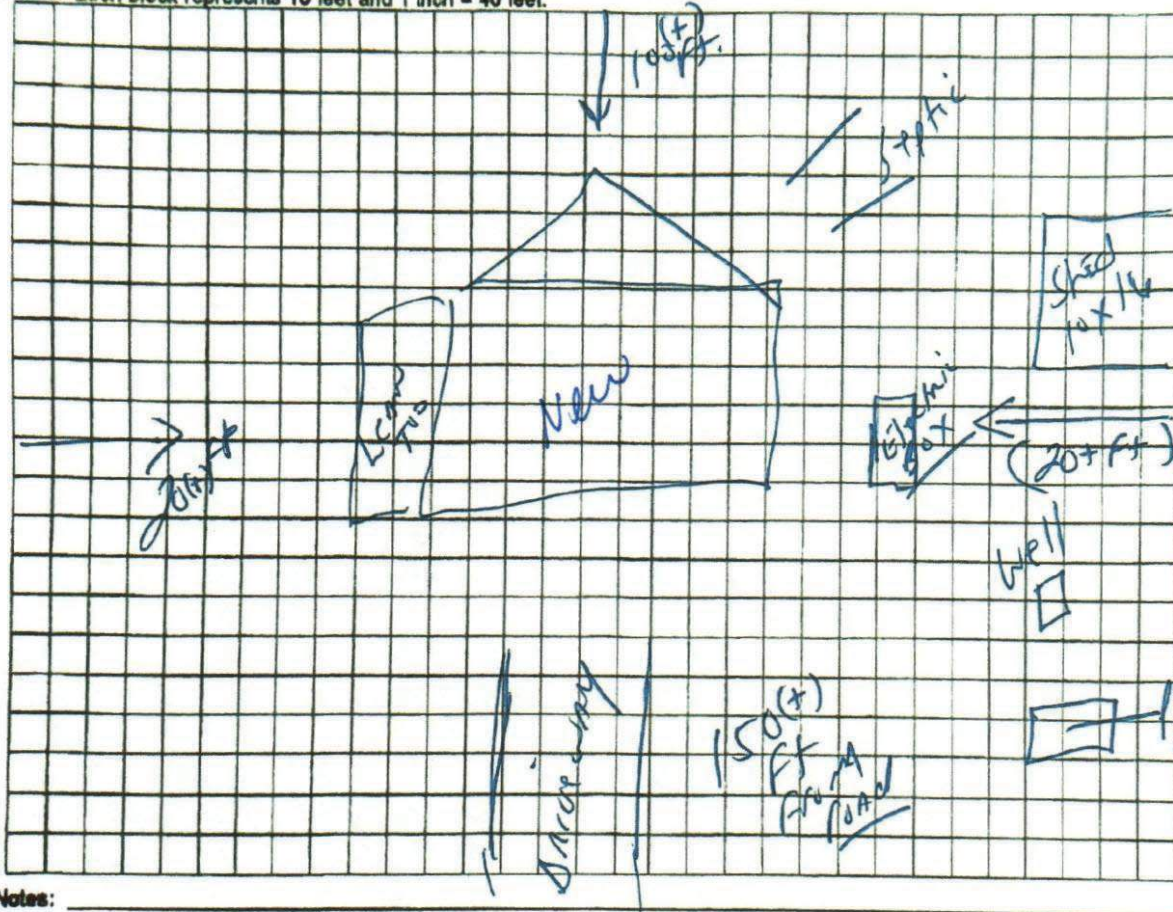

Notes:

Site Plan submitted by: Marie Colon

Plan Approved ☒

Not Approved ☐

Date 6/5/23

By

Camandra Brock

ESI Columbia

County Health Department

ALL CHANGES MUST BE APPROVED BY THE COUNTY HEALTH DEPARTMENT

DEP 4015, 06-21-2022 (Obsoletes previous editions which may not be used)

Incorporated: 62-6.004, F.A.C.

Page 2 of 4