



STATE OF FLORIDA  
DEPARTMENT OF ENVIRONMENTAL PROTECTION  
ONSITE SEWAGE TREATMENT AND DISPOSAL  
SYSTEM (OSTDS)

PERMIT NO. 24-0470  
DATE PAID: 5/11/24  
FEE PAID: 205.84  
RECEIPT #: 2097404

APPLICATION FOR CONSTRUCTION PERMIT

APPLICATION FOR:

☐ New System ☒ Existing System ☐ Holding Tank ☐ Innovative  
☐ Repair ☐ Abandonment ☐ Temporary ☒ Modif

APPLICANT: Bruce McNutt EMAIL: \_\_\_\_\_

AGENT: Andrews Site prep TELEPHONE: 386-807-0572

MAILING ADDRESS: 8230 SW SR-121 Lake Butler FL 32054

TO BE COMPLETED BY APPLICANT OR APPLICANT'S AUTHORIZED AGENT. SYSTEMS MUST BE CONSTRUCTED BY A PERSON LICENSED PURSUANT TO 489.105(3)(m) OR 489.552, FLORIDA STATUTES. IT IS THE APPLICANT'S RESPONSIBILITY TO PROVIDE DOCUMENTATION OF THE DATE THE LOT WAS CREATED OR PLATTED (MM/DD/YY) IF REQUESTING CONSIDERATION OF STATUTORY GRANDFATHER PROVISIONS.

PROPERTY INFORMATION

OSTDS REMEDIATION PLAN? ☐ Y ☒ N

LOT: 7 BLOCK: \_\_\_\_\_ SUBDIVISION: Sedgefield S/D phase 3 PLATTED: \_\_\_\_\_

PROPERTY ID #: 03-65-16-03762-307 ZONING: \_\_\_\_\_ I/M OR EQUIVALENT: ☐ Y ☒ N

PROPERTY SIZE: 5 ACRES WATER SUPPLY: ☒ PRIVATE PUBLIC ☐  $\leq 2000$  GPD ☐  $> 2000$  GPD

IS SEWER AVAILABLE AS PER 381.0065, FS? ☐ Y ☒ N DISTANCE TO SEWER: \_\_\_\_\_ FT

PROPERTY ADDRESS: 322 SW Rolling Meadows Gln Ft. White 32038

DIRECTIONS TO PROPERTY: Take FL-475, @ onto SW Rolling Meadows Gln  
Parcel on (R)

BUILDING INFORMATION

☒ RESIDENTIAL

☐ COMMERCIAL

Unit No.	Type of Establishment	No. of Bedrooms	Building Area Sqft	Commercial/Institutional System Design Table I, Chapter 62-6, FAC
1	SFR - Main	3	1840	
2	SFR - MIL Home	1	432	
3		total -	2272	
4				

☐ Floor/Equipment Drains ☐ Other (Specify) \_\_\_\_\_

SIGNATURE: B DATE: 5/31/24





STATE OF FLORIDA  
DEPARTMENT OF HEALTH  
ONSITE SEWAGE TREATMENT AND DISPOSAL  
SYSTEM

PERMIT #: 12-SC-2930447  
APPLICATION #: AP2097404  
DATE PAID: \_\_\_\_\_  
FEE PAID: \_\_\_\_\_  
RECEIPT #: \_\_\_\_\_  
DOCUMENT #: PR2111187

CONSTRUCTION PERMIT FOR: OSTDS Existing Modification  
APPLICANT: BRUCE\*\*24-0470 McNUTT  
PROPERTY ADDRESS: 322 SW ROLLING MEADOWS Fort White, FL 32038  
LOT: 7 BLOCK: \_\_\_\_\_ SUBDIVISION: SEDGEFIELD PH-3  
PROPERTY ID #: 03767-307 [SECTION, TOWNSHIP, RANGE, PARCEL NUMBER]  
[OR TAX ID NUMBER]

SYSTEM MUST BE CONSTRUCTED IN ACCORDANCE WITH SPECIFICATIONS AND STANDARDS OF SECTION 381.0065, F.S., AND CHAPTER 64E-6, F.A.C. DEPARTMENT APPROVAL OF SYSTEM DOES NOT GUARANTEE SATISFACTORY PERFORMANCE FOR ANY SPECIFIC PERIOD OF TIME. ANY CHANGE IN MATERIAL FACTS, WHICH SERVED AS A BASIS FOR ISSUANCE OF THIS PERMIT, REQUIRE THE APPLICANT TO MODIFY THE PERMIT APPLICATION. SUCH MODIFICATIONS MAY RESULT IN THIS PERMIT BEING MADE NULL AND VOID. ISSUANCE OF THIS PERMIT DOES NOT EXEMPT THE APPLICANT FROM COMPLIANCE WITH OTHER FEDERAL, STATE, OR LOCAL PERMITTING REQUIRED FOR DEVELOPMENT OF THIS PROPERTY.

SYSTEM DESIGN AND SPECIFICATIONS

T [ 1,200 ] GALLONS / GPD New Septic CAPACITY  
A [ ] GALLONS / GPD N/A CAPACITY  
N [ ] GALLONS GREASE INTERCEPTOR CAPACITY [MAXIMUM CAPACITY SINGLE TANK:1250 GALLONS]  
K [ ] GALLONS DOSING TANK CAPACITY [ ] GALLONS @ [ ] DOSES PER 24 HRS #Pumps [ ]

D [ 500 ] SQUARE FEET \_\_\_\_\_ SYSTEM  
R [ ] SQUARE FEET N/A SYSTEM  
A TYPE SYSTEM: [X] STANDARD [ ] FILLED [ ] MOUND [ ]  
I CONFIGURATION: [X] TRENCH [ ] BED [ ]

F LOCATION OF BENCHMARK: SW Corner of Concrete Rear Porch

I ELEVATION OF PROPOSED SYSTEM SITE [ 20.00 ] [ INCHES / FT ] [ ABOVE / BELOW ] BENCHMARK/REFERENCE POINT

E BOTTOM OF DRAINFIELD TO BE [ 32.00 ] [ INCHES / FT ] [ ABOVE / BELOW ] BENCHMARK/REFERENCE POINT

L

D FILL REQUIRED: [ 6.00 ] INCHES EXCAVATION REQUIRED: [ ] INCHES

O The system is sized for 4 bedrooms with a maximum occupancy of 8 persons (2 per bedroom), for a total estimated flow of 400 gpd.

T Existing 375SqFt of drainfield can be used.

E

R

SPECIFICATIONS BY: (Joshua) Kameron Keen TITLE: CEHP

APPROVED BY: Kyle B Roberts TITLE: Environmental Manager Columbia CHD

DATE ISSUED: 06/24/2024 EXPIRATION DATE: 12/24/2025

DEP 4015, 06-21-2022 (Obsoletes previous editions which may not be used)  
Incorporated 62-6.004, FAC



STATE OF FLORIDA  
DEPARTMENT OF ENVIRONMENTAL PROTECTION  
APPLICATION FOR CONSTRUCTION PERMIT

Permit Application Number

24-0470

PART II - SITEPLAN

Scale: Each block represents 10 feet and 1 inch = 40 feet.

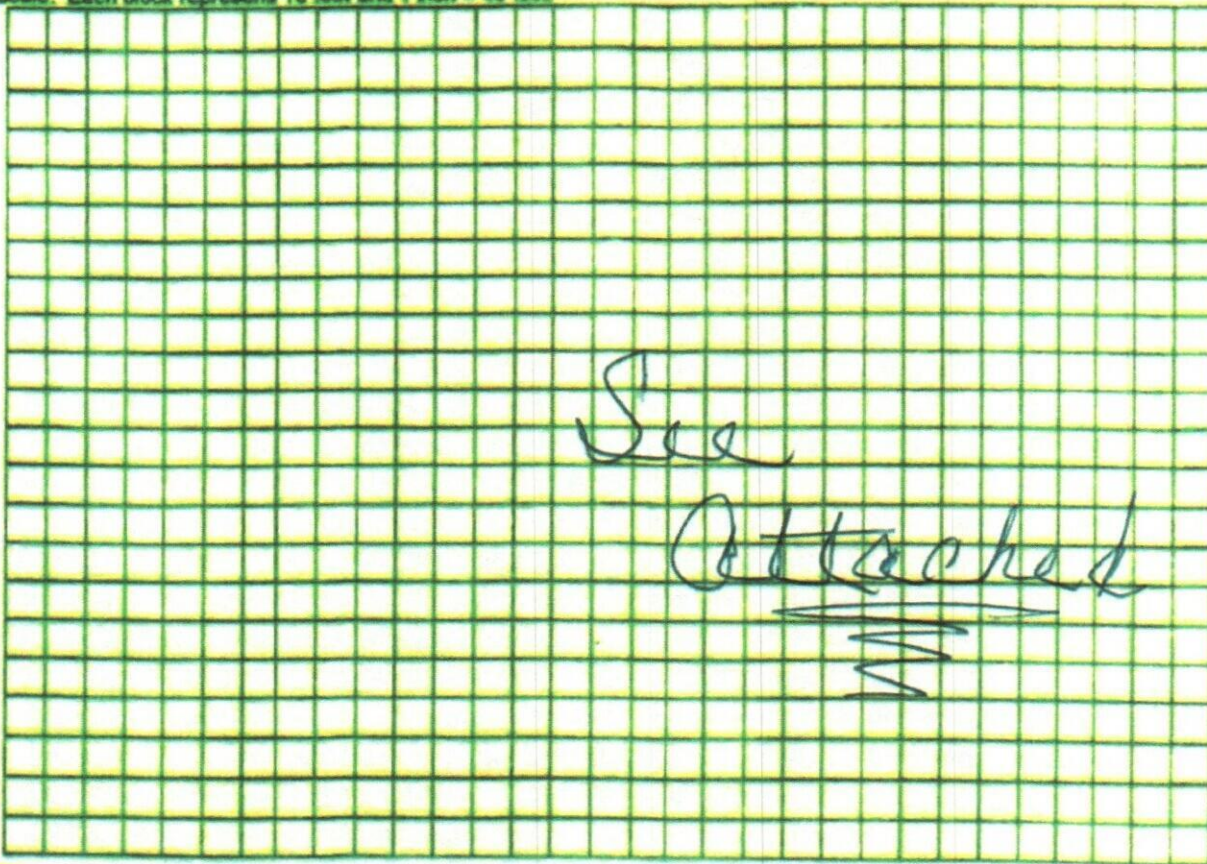

Notes:

Site Plan submitted by

H. Keen

Plan Approved

Not Approved

Date

By

County Health Department

ALL CHANGES MUST BE APPROVED BY THE COUNTY HEALTH DEPARTMENT

DEP 4015, 05-21-2022 (Obsoletes previous editions which may not be used)  
Incorporated: 62-5.004, F.A.C.

Page 2 of 4

24-0470

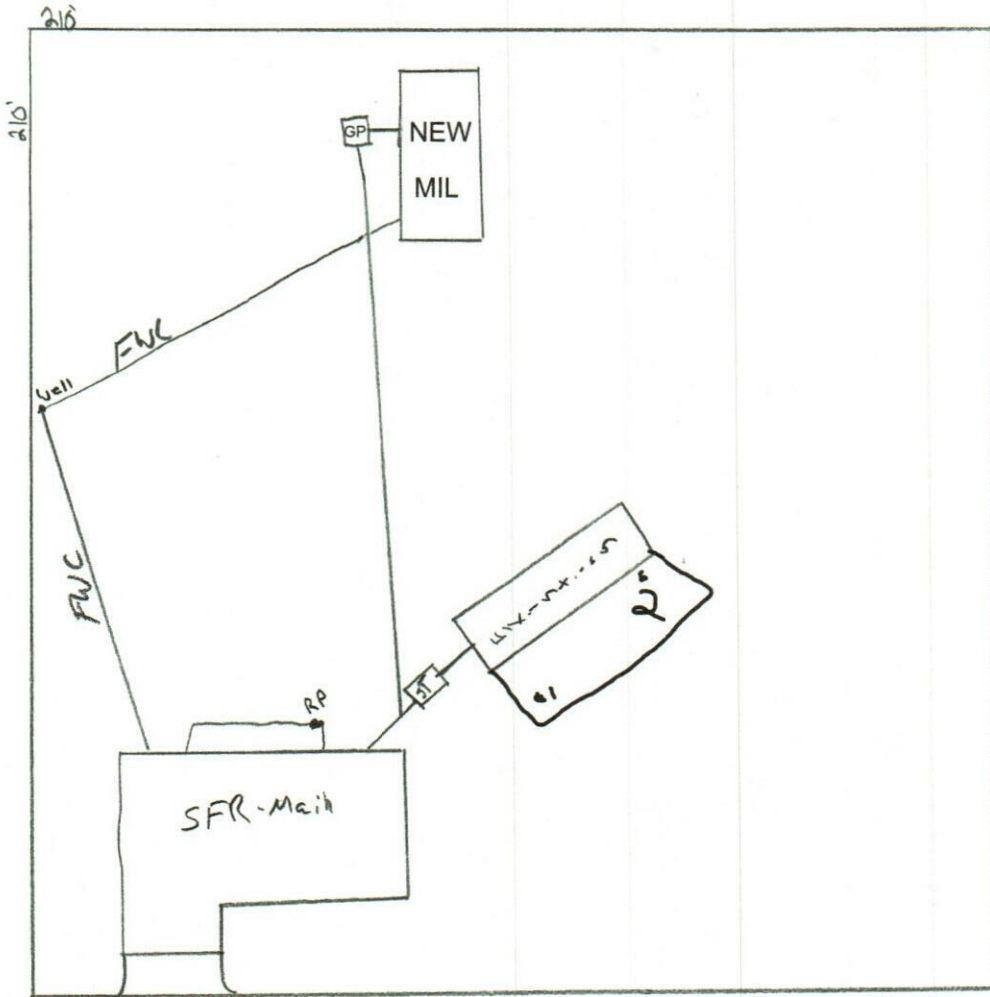

Scale 1"=40'

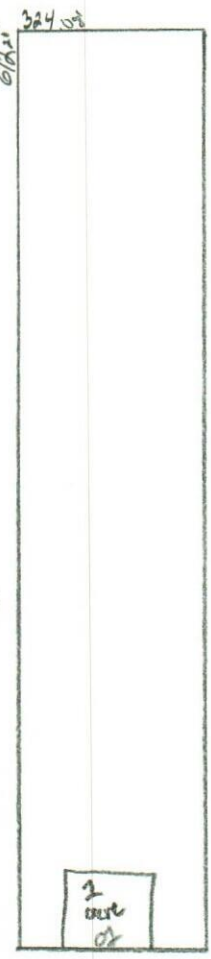

Bruce McNutt  
322 SW Rolling Meadows Cir  
Ft. White 32038

B

K. Keen

23-2064

Approved  
K. Keen

6/24/24