



STATE OF FLORIDA  
DEPARTMENT OF HEALTH  
ONSITE SEWAGE TREATMENT AND DISPOSAL  
SYSTEM  
APPLICATION FOR CONSTRUCTION PERMIT

PERMIT NO. 22-0030  
DATE PAID: 3/17/22  
FEE PAID: 20.00  
RECEIPT #: 1812156

APPLICATION FOR:

[ ] New System [ ☒ ] Existing System [ ] Holding Tank [ ] Innovative  
[ ] Repair [ ] Abandonment [ ] Temporary [ ]

APPLICANT:

Walter Hencik

AGENT:

TELEPHONE:

386.755.5348

MAILING ADDRESS:

226 SW Burnett LN

TO BE COMPLETED BY APPLICANT OR APPLICANT'S AUTHORIZED AGENT. SYSTEMS MUST BE CONSTRUCTED BY A PERSON LICENSED PURSUANT TO 489.105(3) (m) OR 489.552, FLORIDA STATUTES. IT IS THE APPLICANT'S RESPONSIBILITY TO PROVIDE DOCUMENTATION OF THE DATE THE LOT WAS CREATED OR PLATTED (MM/DD/YY) IF REQUESTING CONSIDERATION OF STATUTORY GRANDFATHER PROVISIONS.

PROPERTY INFORMATION

LOT: 9 BLOCK: \_\_\_\_\_ SUBDIVISION: Country Acres PLATTED: \_\_\_\_\_

PROPERTY ID #: 25-45-16-03/22-009 ZONING: \_\_\_\_\_ I/M OR EQUIVALENT: [ Y / N ]

PROPERTY SIZE: 1 ACRES WATER SUPPLY: [ ☒ ] PRIVATE PUBLIC [ ] <=2000GPD [ ] >2000GPD

IS SEWER AVAILABLE AS PER 381.0065, FS? [ ☒ ] / N ] DISTANCE TO SEWER: \_\_\_\_\_ FT

PROPERTY ADDRESS: 226 SW Burnett LN Lake City, FL 32024

DIRECTIONS TO PROPERTY: 47 South to 242 (right) go 1 mile turn left on Yolanda Street turn right on Burnett Lane 5th Brick house on left

BUILDING INFORMATION

[ ☒ ] RESIDENTIAL

[ ] COMMERCIAL

| Unit No | Type of Establishment   | No. of Bedrooms | Building Area Sqft | Commercial/Institutional System Design Table 1, Chapter 64E-6, FAC |
|---------|-------------------------|-----------------|--------------------|--|
| 1       | <u>Storage Building</u> |                 | <u>600</u>         | <u>ORIGINAL ATTACHED</u>   |
| 2       |                         |                 |                    |  |
| 3       |                         |                 |                    |  |
| 4       |                         |                 |                    |  |

[ ] Floor/Equipment Drains [ ] Other (Specify) \_\_\_\_\_

SIGNATURE:

Walter Hencik

DATE:

3/17/22



STATE OF FLORIDA  
DEPARTMENT OF HEALTH  
APPLICATION FOR CONSTRUCTION PERMIT

Permit Application Number 22-0230

----- PART II - SITEPLAN -----

Scale: Each block represents 10 feet and 1 inch = 40 feet.

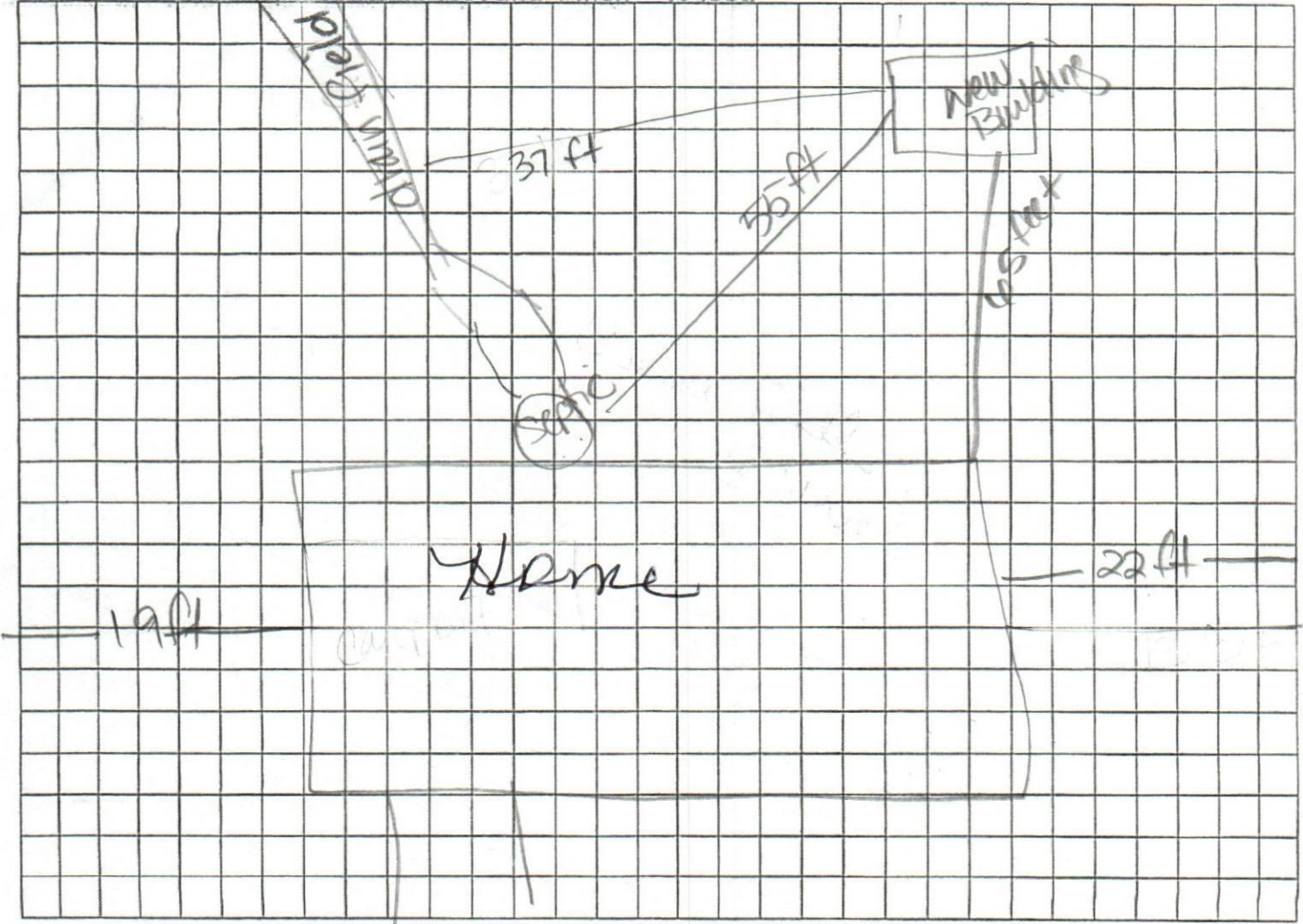

Notes: \_\_\_\_\_

Site Plan submitted by: Walter Doh TITLE \_\_\_\_\_ DATE: 3/11/22

Plan Approved X Not Approved \_\_\_\_\_ Date 3.29.22

By Sally Ford EPH Director Columbia County Health Department

ALL CHANGES MUST BE APPROVED BY THE COUNTY HEALTH DEPARTMENT