

District No. 1 - Ronald Williams  
District No. 2 - Rocky Ford  
District No. 3 - Bucky Nash  
District No. 4 - Toby Witt  
District No. 5 - Tim Murphy



**BOARD OF COUNTY COMMISSIONERS • COLUMBIA COUNTY**

**Address Assignment and Maintenance Document**

To maintain the county wide Addressing Policy you must make application for a 9-1-1 Address at the time you apply for a building permit. The established standards for addressing and posting numbers to all principal buildings, dwellings, businesses and industries are contained in Columbia County Ordinance 2001-9. The addressing system is to enable Emergency Services Agencies to locate you in an emergency, and to assist the United States Postal Service and the public in the timely and efficient provision of services to residents and businesses of Columbia County

Date/Time Issued: **9/27/2019 3:22:00 PM**  
Address: **243 SW STELL Gln**  
City: **LAKE CITY**  
State: **FL**  
Zip Code **32024**

Parcel ID **09630-015**

REMARKS: Address for proposed structure on parcel.

**NOTICE: THIS ADDRESS WAS ISSUED BASED ON LOCATION AND ACCESS INFORMATION RECEIVED FROM THE REQUESTER. SHOULD, AT A LATER DATE, THE LOCATION AND/OR ACCESS INFORMATION BE FOUND TO BE IN ERROR OR CHANGED, THIS ADDRESS IS SUBJECT TO CHANGE.**

Address Issued By: **Signed:/ Matt Crews**

Columbia County GIS/911 Addressing Coordinator

COLUMBIA COUNTY  
911 ADDRESSING / GIS DEPARTMENT

263 NW Lake City Ave., Lake City, FL 32055 Telephone: (386) 755-1125  
Email: [gis@columbiacountyfla.com](mailto:gis@columbiacountyfla.com)

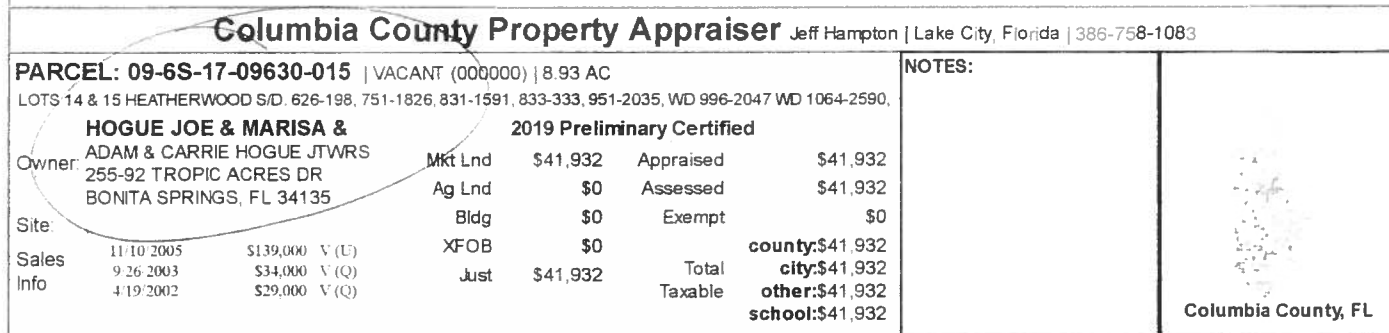

This information was derived from data which was compiled by the Columbia County Property Appraiser Office solely for the governmental purpose of property assessment. This information should not be relied upon by anyone as a determination of the ownership of property or market value. No warranties, expressed or implied, are provided for the accuracy of the data herein, its use, or its interpretation. Although it is periodically updated, this information may not reflect the data currently on file in the Property Appraiser's office. GrizzlyLogic.com

# SUBCONTRACTOR VERIFICATION

APPLICATION/PERMIT # 43794 JOB NAME Joe & Marisa Hogue

THIS FORM MUST BE SUBMITTED BEFORE A PERMIT WILL BE ISSUED

Columbia County issues combination permits. One permit will cover all trades doing work at the permitted site. IT IS **REQUIRED** that we have records of the subcontractors who actually did the trade specific work under the general contractors permit.

**NOTE:** It shall be the responsibility of the general contractor to make sure that all of the subcontractors are licensed with the Columbia County Building Department.

**Use website to confirm licenses:** <http://www.columbiacountyfla.com/PermitSearch/ContractorSearch.aspx>

**NOTE:** If this should change prior to completion of the project, it is your responsibility to have a corrected form submitted to our office, before that work has begun

Violations will result in stop work orders and/or fines

<b>ELECTRICAL</b>	Print Name <u>Joe Hogue</u>	Signature <u>[Signature]</u>
<input checked="" type="checkbox"/>	Company Name: <u>Owner</u>	
CC#	License #: <u>Ex000 8837</u>	Phone #: <u>239-770-1756</u>
<b>MECHANICAL/</b>	Print Name	Signature
<b>A/C</b> <input type="checkbox"/>	Company Name:	
CC#	License #:	Phone #:
<b>PLUMBING/</b>	Print Name <u>Joe Hogue</u>	Signature
<b>GAS</b> <input type="checkbox"/>	Company Name: <u>Owner</u>	
CC#	License #:	Phone #: <u>239-770-1756</u>
<b>ROOFING</b>	Print Name	Signature
<input type="checkbox"/>	Company Name:	
CC#	License #:	Phone #:
<b>SHEET METAL</b>	Print Name	Signature
<input type="checkbox"/>	Company Name:	
CC#	License #:	Phone #:
<b>FIRE SYSTEM/</b>	Print Name	Signature
<b>SPRINKLER</b> <input type="checkbox"/>	Company Name:	
CC#	License #:	Phone #:
<b>SOLAR</b>	Print Name	Signature
<input type="checkbox"/>	Company Name:	
CC#	License #:	Phone #:
<b>STATE</b>	Print Name	Signature
<b>SPECIALTY</b>	Company Name:	
CC#	License #:	Phone #:

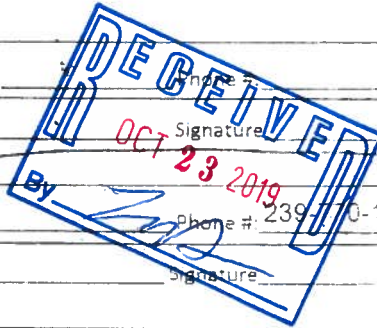

SCANNED