

PERMIT APPLICATION / MANUFACTURED HOME INSTALLATION APPLICATION

For Office Use Only (Revised 7-1-15) Zoning Official LN Building Official MAA

AP# 807-68 Date Received 7/19 By JW Permit # 37029

Flood Zone X Development Permit _____ Zoning RR Land Use Plan Map Category RVL D

Comments Replacing Home

FEMA Map# _____ Elevation _____ Finished Floor 1st floor River _____ In Floodway _____

☒ Recorded Deed or ☒ Property Appraiser PO ☒ Site Plan ☒ EH # 18-0663 ☒ Well letter OR

☒ Existing well ☐ Land Owner Affidavit ☐ Installer Authorization ☐ FW Comp. letter ☒ App Fee Paid

☐ DOT Approval ☐ Parent Parcel # _____ ☐ STUP-MH _____ ☒ 911 App

☐ Ellisville Water Sys ☒ Assessment Paid on Property ☐ Out County ☐ In County ☒ Sub VF Form

Property ID # 15-4S-17-08355-107 Subdivision Perry Place Lot# 7

- New Mobile Home X Used Mobile Home _____ MH Size 28 x 48 Year 2018
- Applicant Dale Burd or Rocky Ford Phone # 386-497-2311
- Address 546 SW Dortch Street, Fort White, FL, 32038
- Name of Property Owner Elizabeth Earls Phone# 386-269-2756
- 911 Address 297 SE Sharon Ln Lake City fl 32025
- Circle the correct power company - FL Power & Light - (Clay Electric)
(Circle One) - Suwannee Valley Electric - Duke Energy
- Name of Owner of Mobile Home Same Phone # Same
Address 192 SW Titanium Court, Lake City, 32024
- Relationship to Property Owner Same
- Current Number of Dwellings on Property 0
- Lot Size 150 X 291 Total Acreage 1.0
- Do you : Have Existing Drive or Private Drive or need Culvert Permit or Culvert Waiver (Circle one)
(Currently using) (Blue Road Sign) (Putting in a Culvert) (Not existing but do not need a Culvert)
- Is this Mobile Home Replacing an Existing Mobile Home Yes
- Driving Directions to the Property US 90 East, TR SR 100, TR CR 245, TR Sharon Lane, 7th lot on right
- Name of Licensed Dealer/Installer Richard Rayborn Phone # 352-257-1282
- Installers Address 11381 N Linda Marie Terr, Dunnellon, FL, 34433
- License Number IH-1025436 Installation Decal # 51488

*DALE is aware of permits needed 7.19.18
Homeowner called 7.23.18*

\$37500

Bulk "A" 2nd

COLUMBIA COUNTY PERMIT WORKSHEET

page 1 of 2

These worksheets must be completed and signed by the installer.
Submit the original with the permit.

Installer

Richard Pearson

License #

1H1025436

911 Address where home is being installed

2917 SE SHARON AVE
LAKELAND, FL 33005

Manufacturer

Playon

Length x width

25' x 45'

NOTE:

If home is a single wide fill out one half of the blocking plan
If home is a triple or quad write sketch in remainder of home

I understand Lateral Arm Systems cannot be used on any home (new or used) where the sidewall ties exceed 5 ft 4 in.

Installer's initials

[Signature]

Typical pier spacing



Show locations of Longitudinal and Lateral Systems (use dark lines to show these locations)

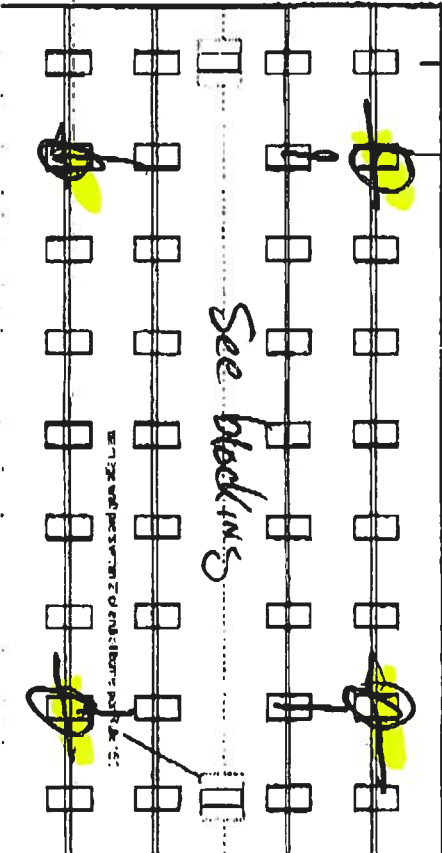

PIER SPACING TABLE FOR USED HOMES

Load bearing capacity (sq. ft.)	16' x 16' (256)	18' 1/2' x 18' (324)	20' x 20' (400)	22' x 22' (484)	24' x 24' (576)	26' x 26' (676)
1000 psf	3'	4'	5'	6'	7'	8'
500 psf	4' 6"	5'	6'	7'	8'	9'
2000 psf	6'	8'	10'	12'	14'	16'
2500 psf	7' 6"	9'	11'	13'	15'	17'
3000 psf	8'	10'	12'	14'	16'	18'
3500 psf	9'	11'	13'	15'	17'	19'

Interpolated from Rule 15C - pier spacing table.

PIER PAD SIZES

1x clean pier pad size 17x21
Perimeter pier pad size 17x21
Other pier pad sizes (required by the mfg.) ---

Draw the approximate locations of mainline wall openings 4 feet or greater. Use this symbol to show tie piers.

List all mainline wall openings greater than 4 feet and their pier pad sizes below.

Opening door Pier pad size 16x16

door Pier pad size 16x16

door Pier pad size 16x16

door Pier pad size 16x16

door Pier pad size 16x16

LONGITUDINAL STABILIZING DEVICE (LSD)

Manufacturer ALC
Longitudinal Stabilizing Device w/ Lateral Arms
Manufacturer OLIVER

ANCHORS

Side wall Longitudinal Lateral Arms Shear wall
Number 1

OTHER TIES

Number 1

COLUMBIA COUNTY PERMIT WORKSHEET

page 2 of 2

POCKET PENETROMETER TEST

The pocket penetrometer tests are recorded down to 1000 psi or check here to declare 1000 lb soil without testing.

X 1000 X 1000 X 1000

POCKET PENETROMETER TESTING METHOD

1. Test the perimeter of the home at 6 locations.
2. Take the reading at the depth of the footer.
3. Using 500 lb increments, take the lowest reading and raise down to that increment.

TORQUE PROBE TEST

X 1000 X 1000 X 1000

The results of the torque probe test is 455 inch pounds or check here if you are declaring 5' anchors without testing. A test showing 275 inch pounds or less will require 5 foot anchors.

Note: A state approved lateral arm system is being used 3x14 ft anchors are allowed at the specified locations. 1' under slabs 5 ft anchors are required at all centerline tie points where the torque test reading is 275 or less and where the probe frame manufacturer may requires anchors with 4000 ft-lb capacity.

Installer's initials

ALL TESTS MUST BE PERFORMED BY A LICENSED INSTALLER

Installer Name

Rehman Hassan

Date Tested

7-18-18

Electrical

Connect electrical conductors between multi-wire units but not to the main power source. This includes the bonding wire between multi-wire units. Pg. 3

Plumbing

Connect all sewer drains to an existing sewer tap or septic tank. Pg. 3

Connect all potable water supply piping to an existing water meter, water tap, or other independent water supply systems. Pg. 3

Site Preparation

Debris and organic material removed: YES
Water drainage: Natural ☒ Swale ☐ Pad ☐ Other ☐

Fastening multi-wide walls

Floor:	Type Fastener	Length	Spacing
Walls:	Type Fastener	Length	Spacing
Roof:	Type Fastener	Length	Spacing

For wood homes: 1/4" 30 gauge, 8" wide galvanized metal strip will be cemented over the peat of the roof and fastened with galv. roofing nails at 2' on center on both sides of the overhang.

Gasket (non-degrading material)

I understand a properly installed gasket is a requirement of all new and used homes and that condensation, mold, mildew and buckled mantle walls are a result of a poorly installed or no gasket being installed. I understand a ship of tape will not serve as a gasket.

Installer's initials

Type gasket

4x4 70x9

Installer
Between Floors Yes ☒
Between Walls Yes ☒
Bottom of ridgebeam Yes ☒

Weatherproofing

The bottomboard will be repaired and/or taped. Yes ☒
Sliding on units is installed to manufacturer's specifications. Yes ☒
Fireplace chimney installed so as not to allow intrusion of rain water. Yes ☒

Miscellaneous

Skirting to be installed. Yes ☒ No ☐
Over vent installed outside of skirting. Yes ☒ N/A ☐
Range downflow vent installed outside of skirting. Yes ☒ N/A ☐
Chimney lined supported at 4 foot intervals. Yes ☒
Electrical crossovers protected. Yes ☒
Other ☒

Installer verifies all information given with this permit worksheet is accurate and true based on the

Installer Signature



Date 7-18-18

20 lb ROOF LOAD		SQUARE FEET (FT)				
SPOKEWALL OPENING PIER LOAD		STANDARD PER LOAD (LBS)				
3	4	5	6	8	10	
1175	1330	1485	1640	1950	2260	

FIGS. 30 LB & 40 LB ROOF LOAD REFER TO TABLES 7b & 7c IN THE INSTALLATION MANUAL.

SERVICE DROP LEGEND	
(E)	FURCHCA (POF)
(W)	WATER (H2O)
(D)	DRY PLUMBING (H2O)
(G)	GAS (N2)

PIER LEGEND	
(□)	24" DIA. UNDER WADING SERVICE
(■)	SUPPORT AT WADING SERVICE
(□)	SUPPORT LOAD > 4000 LBS
(■)	18" DIA. CIRCULAR SERVICE
(□)	18" DIA. CIRCULAR SERVICE
(■)	18" DIA. CIRCULAR SERVICE
(□)	18" DIA. CIRCULAR SERVICE

PIER LOAD 20lb, ROOF LOAD	
LOADING PER #	STANDARD LOAD
1	1,330
2	2,660
3	3,990
4	5,320

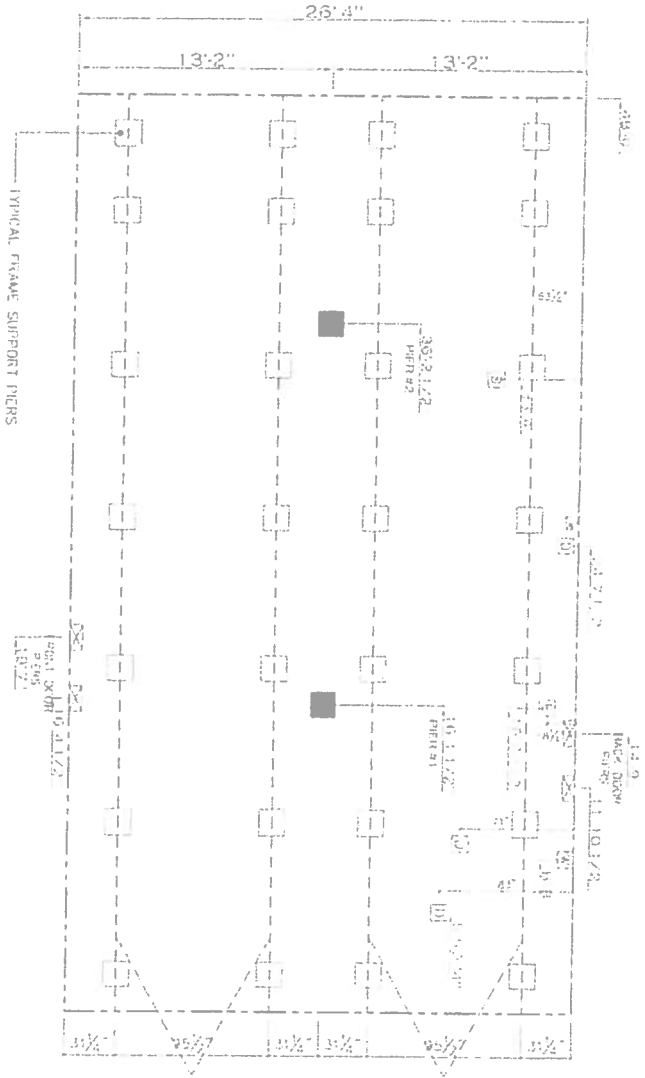

- GENERAL NOTES:
- PIER LOADS SHOWN ARE TO BE USED TO SIZE THE FOOTINGS BELOW THE MARRIAGEWALL FOR COLUMN SUPPORT PIERS. REFER TO TABLES 7b AND 7c IN THE INSTALLATION MANUAL FOR LOAD ON TRAIL, PIER FOOTINGS FOR HOMES THAT DO NOT REQUIRE PERMANENT BLOCKING. REFER TO TABLES 7b AND 7c IN THE INSTALLATION MANUAL FOR LOAD ON FRAME PIER FOOTINGS THAT REQUIRE PERMANENT BLOCKING. REFER TO TABLES 7b AND 7c TO DETERMINE FOOTING SIZE FOR ALL PIERS.
 - REFER TO TABLE 9 FOR PIER CONFIGURATION AND MAXIMUM ALLOWABLE HEIGHTS CROSS REFERENCE THE PIER HEIGHT WITH THE MAXIMUM ALLOWABLE FLOOR HEIGHT LISTED IN THE FRAME TIE-DOWN CHARTS (TABLE 19, 19 AND 20).
 - FLOOR WIDTH SHOWN IS FOR STANDARD PRODUCT ONLY. CONTACT THE MFG. PLANT FOR SPECIFICATIONS OF OPTIONS ORDERED.
 - SERVICE DROP LOCATIONS IDENTIFIED ARE APPROXIMATE. THE MAXIMUM SPACING FOR 8" I-BEAMS IS 8 FEET, 10" & 12" I-BEAMS ARE 10 FEET.

CMH	
Model # 20x40 ProRail	1,264 sq. ft. (SID PLAN "CONDITIONED")
Model # 20x40 ProRail	1,264 sq. ft. (SID PLAN "CONDITIONED")

OLIVER TECHNOLOGIES, INC.
FLORIDA INSTALLATION INSTRUCTIONS FOR THE
MODEL 1101 "V" SERIES ALL STEEL FOUNDATION SYSTEM
MODEL 1101"V" (STEPS 1-15)
LONGITUDINAL ONLY: FOLLOW STEPS 1-9
FOR ADDING LATERAL ARM : Follow Steps 10-15
FOR CONCRETE APPLICATIONS: Follow Steps 16-19

ENGINEERS STAMP

ENGINEERS STAMP

1. SPECIAL CIRCUMSTANCES: If the following conditions occur - **STOP! Contact Oliver Technologies at 1-800-284-7437** :
- a) Pier height exceeds 48"
 - b) Length of home exceeds 76'
 - c) Roof eaves exceed 16"
 - d) Sidewall height exceed 96"
 - e) Location is within 1500 feet of coast

INSTALLATION OF GROUND PAN

2. Remove weeds and debris in an approximate two foot square to expose firm soil for each ground pan (C) .
3. Place ground pan (C) directly below chassis I-beam . Press or drive pan firmly into soil until flush with or below soil.
- SPECIAL NOTE:** The longitudinal "V" brace system serves as a pier under the home and should be loaded as any other pier. It is recommended that after leveling piers, and one-third inch (1/3") before home is lowered completely on to piers, complete steps 4 through 9 below then remove jacks.

INSTALLATION OF LONGITUDINAL "V" BRACE SYSTEM

NOTE: WHEN INSTALLING THE LONGITUDINAL SYSTEM ONLY, A MINIMUM OF 2 SYSTEMS PER FLOOR SECTION IS REQUIRED. SOIL TEST PROBE SHOULD BE USED TO DETERMINE CORRECT TYPE OF ANCHOR PER SOIL CLASSIFICATION. IF PROBE TEST READINGS ARE BETWEEN 175 & 275 A 5 FOOT ANCHOR MUST BE USED. IF PROBE TEST READINGS ARE BETWEEN 276 & 350 A 4 FOOT ANCHOR MAY BE USED. USE GROUND ANCHORS WITH DIAGONAL TIES AND STABILIZER PLATES EVERY 5'4" . VERTICAL TIES ARE ALSO REQUIRED ON HOMES SUPPLIED WITH VERTICAL TIE CONNECTION POINTS (PER FLORIDA REG.) .

4. Select the correct square tube brace (E) length for set - up (pier) height at support location. (The 18" tube is always used as the bottom part of the longitudinal arm). Note: Either tube can be used by itself, cut and drilled to length as long as a 40 to 45 degree angle is maintained.

PIER HEIGHT
(Approx. 45 degrees Max.)

1.25" ADJUSTABLE
Tube Length

1.50" ADJUSTABLE
Tube Length

7 3/4" to 25"	22"	18"
24 3/4" to 32 1/4"	32"	18"
33" to 41"	44"	18"
40" to 48"	54"	18"

5. Install (2) of the 1.50" square tubes (E {18" tube}) into the "U" bracket (J), insert carriage bolt and leave nut loose for final adjustment.
6. Place I-beam connector (F) loosely on the bottom flange of the I-beam.
7. Slide the selected 1.25" tube (E) into a 1.50" tube (E) and attach to I-beam connectors (F) and fasten loosely with bolt and nut.
8. Repeat steps 6 through 7 to create the "V" pattern of the square tubes loosely in place. The angle is not to exceed 45 degree and not below 40 degrees.
9. After all bolts are tightened, secure 1.25" and 1.50" tubes using four(4) 1/4"-14 x 3/4" self-tapping screws in pre-drilled holes.

INSTALLATION OF LATERAL TELESCOPING TRANSVERSE ARM SYSTEM

THE MODEL 1101 "V" (LONGITUDINAL & LATERAL PROTECTION) ELIMINATES THE NEED FOR MOST STABILIZER PLATES & FRAME TIES.

NOTE: THE USE OF THIS SYSTEM REQUIRES VERTICAL TIES SPACED AT 5'4".

FOUR FOOT (4') GROUND ANCHOR MAY BE USED EXCEPT WHERE THE HOME MANUFACTURER SPECIFIES DIFFERENT.

10. Install remaining vertical tie-down straps and 4' ground anchors per home manufacturer's instructions. **NOTE:** Centerline anchors to be sized according to soil torque condition. Any manufacturer's specifications for sidewall anchor loads in excess of 4,000 lbs. require a 5' anchor per Florida Code.
11. **NOTE:** Each system is required to have a frame tie and stabilizer attached at each lateral arm stabilizing location. This frame tie & stabilizer plate needs to be located within 18" from of center ground pan.
12. Select the correct square tube brace (H) length for set-up lateral transverse at support location. The lengths come in either 60" or 72" lengths. (With the 1.50" tube as the bottom tube, and the 1.25" tube as the inserted tube.)
13. Install the 1.50 transverse brace (H) to the ground pan connector (D) with bolt and nut.
14. Slide 1.25" transverse brace into the 1.50" brace and attach to adjacent I-beam connector (I) with bolt and nut.
15. Secure 1.50" transverse arm to 1.25" transverse arm using four (4) 1/4" - 14 x 3/4" self-tapping screws in pre-drilled holes.



OLIVER TECHNOLOGIES, INC.
1-800-284-7437

Telephone 931-796-4555
Fax: 931-796-8811
www.olivertechnologies.com

INSTALLATION USING CONCRETE RUNNER / FOOTER

16. A concrete runner, footer or slab may be used in place of the steel ground pan.

- The concrete shall be minimum 2500 psi mix
- A concrete runner may be either longitudinal or transverse, and must be a minimum of 8" deep with a minimum width of 16 inches longitudinally or 18 inches transverse to allow proper distance between the concrete bolt and the edge of the concrete (see below).
- Footers must have minimum surface area of 441 sq. in. (i.e. 21" square), and must be a minimum of 8" deep.
- If a full slab is used, the depth must be a 4" minimum at system bracket location, all other specifications must be per local jurisdiction. Special inspection of the system bracket installation is not required. Footers must allow for at least 4" from the concrete bolt to the edge of the concrete.

NOTE: The bottom of all footings, pads, slabs and runners must be per local jurisdiction.

LONGITUDINAL: (Model 1101 LC "V")

17. When using Part # 1101-W-CPCA (wetset), simply install the bracket in runner/footer **OR** When installing in cured concrete use Part # 101-D-CPCA (dryset). The 1101 (dryset) CA bracket is attached to the concrete using (2) 5/8"x3" concrete wedge bolts (Simpson part # S162300H 5/8" X 3" or Powers equivalent). Place the CA bracket in desired location. Mark bolt hole locations, then using a 5/8" diameter masonry bit, drill a hole to a minimum depth of 3". Make sure all dust and concrete is blown out of the holes. Place wedge bolts into drilled holes, then place 1101 (dry set) CA bracket onto wedge bolts and start wedge bolt nuts. Take a hammer and lightly drive the wedge bolts down by hitting the nut (making sure not to hit the top of threads on bolt). The sleeve of concrete wedge bolt needs to be at or below the top of concrete. Complete by tightening nuts.

LATERAL: (Model 1101 TC "V")

18. For wet set (part # 1101-W-TACA) installation simply install the anchor bolt into runner/footer. For dry set installation (part # 1101-D-TACA) mark bolt hole locations, then using a 5/8" diam. masonry bit, drill a hole to a minimum depth of 3". Make sure all dust and concrete is blown out of the hole. Place wedge bolts (Simpson part #S162300H 5/8" X 3" or Powers equivalent) into (D) concrete dry transverse connector and into drilled hole. If needed, take a hammer and lightly drive the wedge bolts down by hitting the nut (making sure not to hit the top of threads on bolt), then remove the nut. The sleeve of concrete wedge bolt needs to be at or below the top of concrete.
19. When using part # 1101 CVW (wetset) or 1101 CVD (dryset), install per steps 17 & 18.

Notes:

- LENGTH OF HOUSE IS THE ACTUAL BOX SIZE
- = STABILIZER PLATE AND FRAME TIE LOCATION (needs to be located within 18 inches of center of ground pan or concrete)
- ☐ = LOCATION OF LONGITUDINAL BRACING ONLY
- ☐ = TRANSVERSE & LONGITUDINAL LOCATIONS

REQUIRED NUMBER AND LOCATION OF MODEL 1101 "V" OR 1101 C "V" BRACES FOR UP TO 4/12 ROOF PITCH

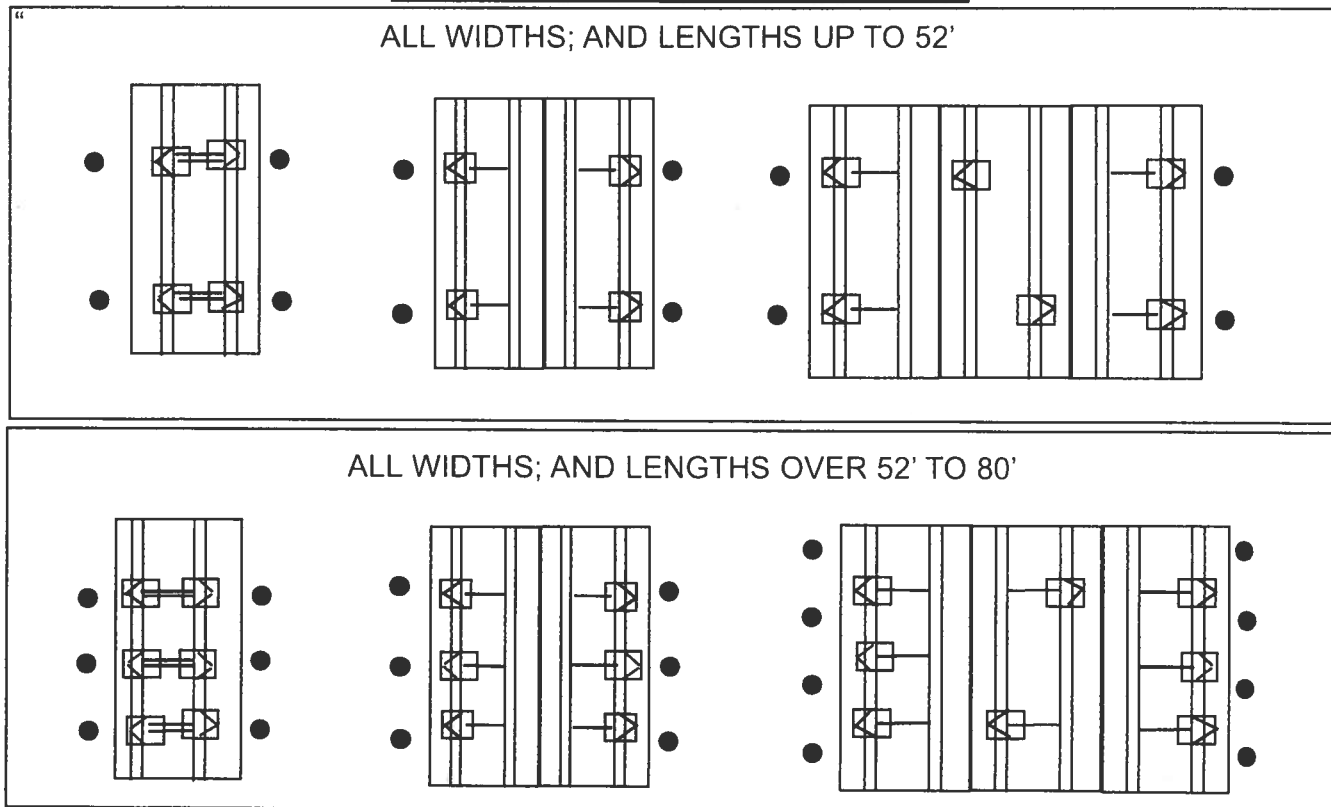

HOMES WITH 5/12 ROOF PITCH REQUIRE: PER FLORIDA REGULATIONS

6 systems for home lengths up to 52' and 8 systems for homes over 52' and up to 80'. One stabilizer plate and frame tie required at each lateral bracing system.

Florida approved 4' ground anchors may be used in all locations except where home manufacturers specifications for sidewall straps are in excess of 4,000 lbs. These locations require a 5' anchor. Per Florida Code.

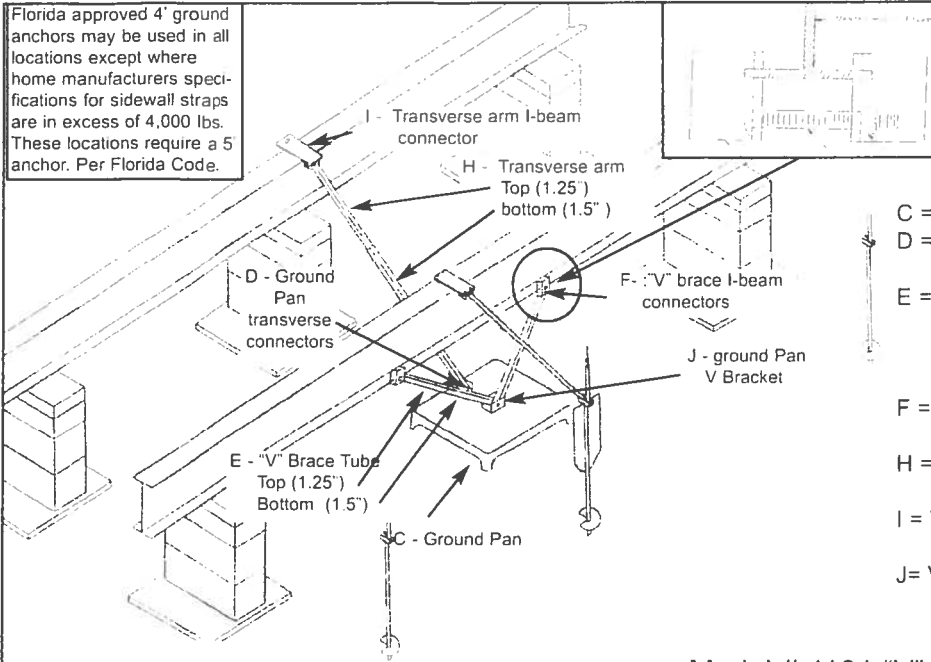

- C = GROUND PAN
- D = GROUND PAN CONNECTOR U BRACKETS TRANSVERSE
- E = TELESCOPING V BRACE TUBE ASSEMBLY W/ 1.5 BOTTOM TUBE AND 1.25 TUBE INSERT
- F = "V" BRACE I-BEAM CONNECTORS ASSEMBLY
- H = TELESCOPING TRANSVERSE ARM ASSEMBLY
- I = TRANSVERSE ARM I-BEAM CONNECTOR
- J = V PAN BRACKET

Model # 1101 "V"

Longitude dry concrete bracket part # 1101 D-CPCA

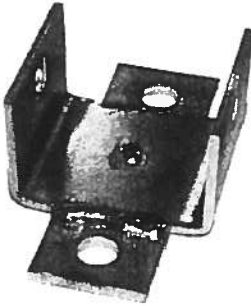

Wet bracket part # 1101 W-CPCA not shown

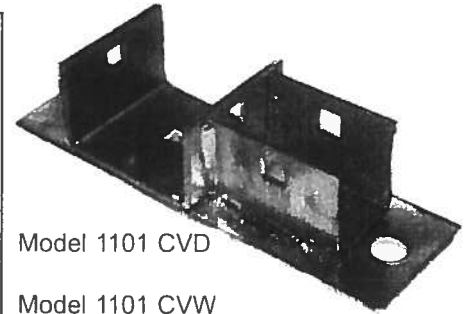
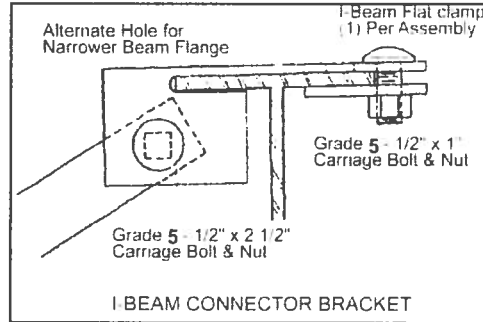

Model 1101 CVD

Model 1101 CVW not shown

Florida approved 4' ground anchors may be used in all locations except where home manufacturers specifications for sidewall straps are in excess of 4,000 lbs. These locations require a 5' anchor. Per Florida Code.

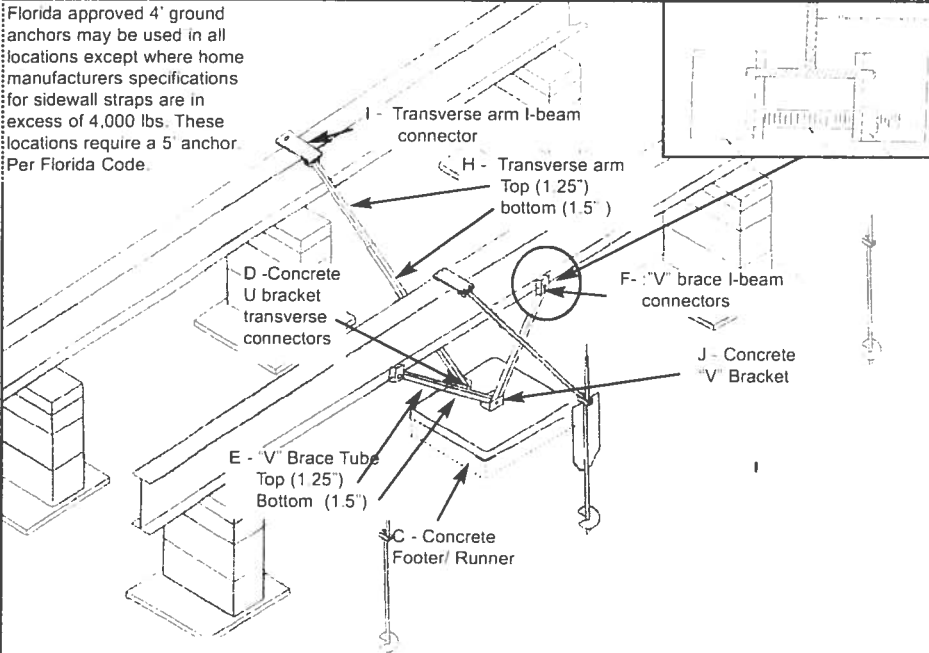

- C = CONCRETE FOOTER/RUNNER
- D = CONCRETE U BRACKET TRANSVERSE CONNECTOR (connects with grade 5 - 1/2" x 2 1/2" carriage bolt & nut)
- E = TELESCOPING V BRACE TUBE ASSEMBLY W/ 1.5 BOTTOM TUBE AND 1.25 TUBE INSERT
- F = "V" BRACE I-BEAM CONNECTOR ASSEMBLY (connects with grade 5 - 1/2" x 4" carriage bolt & nut)
- H = TELESCOPING TRANSVERSE ARM ASSEMBLY
- I = TRANSVERSE ARM I-BEAM CONNECTOR (connects with grade 5 - 1/2" x 2 1/2" carriage bolt & nut)
- J = CONCRETE "V" BRACKET (connects with grade 5 - 1/2" x 4" carriage bolt & nut)

Model # 1101 C "V"



OLIVER TECHNOLOGIES, INC.
1-800-284-7437

Telephone: 931-796-4555
Fax: 931-796-8811
www.olivertechnologies.com

This Instrument Prepared by & return to:
Name: **TRISH LANG, an employee of
Integrity Title Services, LLC**
Address: **343 NW Cole Terrace, #101
Lake City, FL 32055
File No. 18-06017TL**

Inst: 201812015019 Date: 07/19/2018 Time: 2:16PM
Page 1 of 1 B: 1364 P: 2735, P. DeWitt Cason, Clerk of Court
Columbia County, By: BD
Deputy Clerk Doc Stamp-Deed: 125.30

Parcel I.D. #: **R08355-107**

SPACE ABOVE THIS LINE FOR PROCESSING DATA

SPACE ABOVE THIS LINE FOR RECORDING DATA

THIS WARRANTY DEED Made the 17th day of July, A.D. 2018, by **JAY S. DAVIS, CONVEYING
NON-HOMESTEAD PROPERTY**, hereinafter called the grantor, to **ELIZABETH ANN EARLS**, whose past office
address is **192 SE TITANIUM COURT, LAKE CITY, FL 32024**, hereinafter called the grantee:

(Wherever used herein the terms "grantor" and "grantee" include all the parties to this instrument, singular and plural, the heirs, legal
representatives and assigns of individuals, and the successors and assigns of corporations, wherever the context so admits or requires.)

Witnesseth: That the grantor, for and in consideration of the sum of \$10.00 and other valuable consideration,
receipt whereof is hereby acknowledged, does hereby grant, bargain, sell, alien, remise, release, convey and confirm
unto the grantee all that certain land situate in **Columbia County, State of Florida**, viz:

Lot 7, Block A of PERRY PLACE, a subdivision, according to the Plat thereof as recorded in Plat
Book 6, Page(s) 195, of the Public Records of COLUMBIA County, Florida.

Together with all the tenements, hereditaments and appurtenances thereto belonging or in anywise
appertaining.

To Have and to Hold the same in fee simple forever.

And the grantor hereby covenants with said grantee that he is lawfully seized of said land in fee simple; that
he has good right and lawful authority to sell and convey said land, and hereby fully warrants the title to said land and
will defend the same against the lawful claims of all persons whomsoever, and that said land is free of all
encumbrances, except taxes accruing subsequent to December 31, 2018.

In Witness Whereof, the said grantor has signed and sealed these presents, the day and year first above
written.

Signed, sealed and delivered in the presence of:

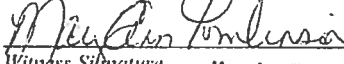
Witness Signature **Mary Ann Tomlinson**

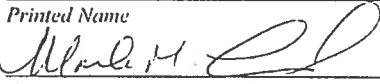
Printed Name

Witness Signature **Marla M. Landin**

Printed Name

JAY S. DAVIS L.S.
Address:
P.O. BOX 1508, LAKE CITY, FL 32056

STATE OF FLORIDA
COUNTY OF COLUMBIA

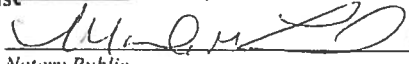
The foregoing instrument was acknowledged before me this 17th day of July, 2018, by **JAY S. DAVIS**, who is
known to me or who has produced **Driver's License** as identification.

Notary Public
My commission expires **9/16/18**

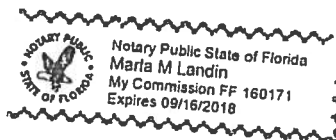

MOBILE HOME INSTALLATION SUBCONTRACTOR VERIFICATION FORM



APPLICATION NUMBER 1807-68 CONTRACTOR Richard Rayborn PHONE 352-257-1282

THIS FORM MUST BE SUBMITTED PRIOR TO THE ISSUANCE OF A PERMIT

Earls

In Columbia County one permit will cover all trades doing work at the permitted site. It is **REQUIRED** that we have records of the subcontractors who actually did the trade specific work under the permit. Per Florida Statute 440 and Ordinance 89-6, a contractor shall require all subcontractors to provide evidence of workers' compensation or exemption, general liability insurance and a valid Certificate of Competency license in Columbia County.

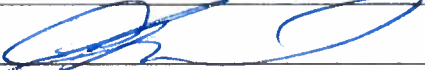
Any changes, the permitted contractor is responsible for the corrected form being submitted to this office prior to the start of that subcontractor beginning any work. Violations will result in stop work orders and/or fines.

✓ 1074 ELECTRICAL	Print Name <u>Glen Whittington</u>	Signature <u></u>
	License #: <u>EC 13002957</u>	Phone #: <u>386-972-1700</u>
	Qualifier Form Attached <input checked="" type="checkbox"/>	
✓ A/C 950 MECHANICAL/	Print Name <u>Michael Boland</u>	Signature <u></u>
	License #: <u>CAC 1817716</u>	Phone #: <u>352-274-9326</u>
	Qualifier Form Attached <input checked="" type="checkbox"/>	

Qualifier Forms cannot be submitted for any Specialty License.

Specialty License	License Number	Sub-Contractors Printed Name	Sub-Contractors Signature
MASON			
CONCRETE FINISHER			

F. S. 440.103 Building permits; identification of minimum premium policy.—Every employer shall, as a condition to applying for and receiving a building permit, show proof and certify to the permit issuer that it has secured compensation for its employees under this chapter as provided in ss. 440.10 and 440.38, and shall be presented each time the employer applies for a building permit.

Revised 10/30/2015



COLUMBIA COUNTY BUILDING DEPARTMENT
135 NE Hernando Ave, Suite B-21, Lake City, FL 32055
Phone: 386-758-1008 Fax: 386-758-2160

LICENSED QUALIFIER AUTHORIZATION

I, Glenn Whittington (license holder name), licensed qualifier for Whittington Electric Inc (company name), do certify that the below referenced person(s) listed on this form is/are contracted/hired by me, the license holder, or is/are employed by me directly or through an employee leasing arrangement; or, is an officer of the corporation; or, partner as defined in Florida Statutes Chapter 468, and the said person(s) is/are under my direct supervision and control and is/are authorized to purchase and sign permits; call for inspections and sign subcontractor verification forms on my behalf.

Printed Name of Person Authorized	Signature of Authorized Person
1. <u>Walter Ford</u>	1. <u>[Signature]</u>
2. <u>Rocky Ford</u>	2. <u>[Signature]</u>
3.	3.
4.	4.
5.	5.

I, the license holder, realize that I am responsible for all permits purchased, and all work done under my license and fully responsible for compliance with all Florida Statutes, Codes, and Local Ordinances. I understand that the State and County Licensing Boards have the power and authority to discipline a license holder for violations committed by him/her, his/her agents, officers, or employees and that I have full responsibility for compliance with all statutes, codes and ordinances inherent in the privilege granted by issuance of such permits.

If at any time the person(s) you have authorized is/are no longer agents, employee(s), or officer(s), you must notify this department in writing of the changes and submit a new letter of authorization form, which will supersede all previous lists. Failure to do so may allow unauthorized persons to use your name and/or license number to obtain permits.

[Signature] License Qualifiers Signature (Notarized) FL13002957 License Number 3/7/16 Date

NOTARY INFORMATION:

STATE OF: FL COUNTY OF: Columbia

The above license holder, whose name is Glenn Whittington, personally appeared before me and is known by me or has produced identification (type of I.D.) FL DL on this 7 day of MARCH, 20 16.

[Signature]
NOTARY'S SIGNATURE





COLUMBIA COUNTY BUILDING DEPARTMENT
135 NE Hernando Ave. Suite B-21, Lake City, FL 32055
Phone: 386-758-1008 Fax: 386-758-2160

LICENSED QUALIFIER AUTHORIZATION

I, Michael A. Boland (license holder name), licensed qualifier
for ACE A/C of Ocala LLC (company name), do certify that

the below referenced person(s) listed on this form is/are contracted/hired by me, the license holder or is/are employed by me directly or through an employee leasing arrangement, or, is an officer of the corporation; or, partner as defined in Florida Statutes Chapter 468, and the said person(s) is/are under my direct supervision and control and is/are authorized to purchase and sign permits, call for inspections and sign subcontractor verification forms on my behalf.

Printed Name of Person Authorized	Signature of Authorized Person
1. <u>Dale Reed</u>	1. <u>[Signature]</u>
2. <u>Kelly Bishop</u>	2. <u>Kelly Bishop</u>
3. <u>Larry Ford</u>	3. <u>[Signature]</u>
4.	4.
5.	5.

I, the license holder, realize that I am responsible for all permits purchased, and all work done under my license and fully responsible for compliance with all Florida Statutes, Codes, and Local Ordinances. I understand that the State and County Licensing Boards have the power and authority to discipline a license holder for violations committed by him/her, his/her agents, officers, or employees and that I have full responsibility for compliance with all statutes, codes and ordinances inherent in the privilege granted by issuance of such permits.

If at any time the person(s) you have authorized is/are no longer agents, employee(s), or officer(s), you must notify this department in writing of the changes and submit a new letter of authorization form, which will supersede all previous lists. Failure to do so may allow unauthorized persons to use your name and/or license number to obtain permits.

[Signature]
Licensed Qualifiers Signature (Notarized)

00017716 License Number
ES/200920 Date
11/17/15

NOTARY INFORMATION
STATE OF Florida COUNTY OF Marion

The above license holder, whose name is Michael A. Boland
personally appeared before me and is known by me or has produced identification
(type of I.D.) _____ on this 17th day of November, 2015

[Signature]
NOTARY'S SIGNATURE

(Seal/Stamp)

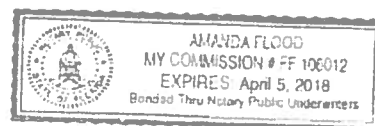

Permit Application Number _____

PART II - SITEPLAN

[illegible]

Notes: _____

Site Plan submitted by: CLD (H&S)

MASTER CONTRACTOR

Plan Approved _____ Not Approved _____

Date _____

By _____ County Health Department

DH 4015, 08/09 (Obsoletes previous editions which may not be used) Incorporated: 64E-6.001, FAC
 (Stock Number: 5744-002-4015-6)

Columbia County Property Appraiser

updated: 6/4/2018

2017 Tax Year

Parcel: 15-4S-17-08355-107

Search Result: 1 of 1

Owner & Property Info

Owner's Name	DAVIS JAY S		
Mailing Address	P.O BOX 1508 LAKE CITY, FL 32056		
Site Address	297 SE SHARON LN		
Use Desc. (code)	VACANT (000000)		
Tax District	2 (County)	Neighborhood	15417
Land Area	1.000 ACRES	Market Area	06
Description	NOTE: This description is not to be used as the Legal Description for this parcel in any legal transaction.		
LOT 7 BLOCK A PERRY PLACE S/D. ORB 771-1124, WD 1030-305, TD 1346-249,			

Property & Assessment Values

2017 Certified Values		
Mkt Land Value	cnt: (0)	\$12,867.00
Ag Land Value	cnt: (2)	\$0.00
Building Value	cnt: (0)	\$0.00
XFOB Value	cnt: (0)	\$0.00
Total Appraised Value		\$12,867.00
Just Value		\$12,867.00
Class Value		\$0.00
Assessed Value		\$12,867.00
Exempt Value		\$0.00
Total Taxable Value	Cnty: \$12,867 Other: \$12,867 Schl: \$12,867	

2018 Working Values (...Hide Values)		
Mkt Land Value	cnt: (0)	\$13,717.00
Ag Land Value	cnt: (2)	\$0.00
Building Value	cnt: (0)	\$0.00
XFOB Value	cnt: (0)	\$0.00
Total Appraised Value		\$13,717.00
Just Value		\$13,717.00
Class Value		\$0.00
Assessed Value		\$13,717.00
Exempt Value		\$0.00
Total Taxable Value	Cnty: \$13,717 Other: \$13,717 Schl: \$13,717	

NOTE: 2018 Working Values are NOT certified values and therefore are subject to change before being finalized for ad valorem assessment purposes.

Account Number	Tax Type	Tax Year
R08355-107	REAL ESTATE	2017
Mailing Address LLOYD DEBORAH R C/O JAY S. DAVIS PO BOX 1508 LAKE CITY FL 32056		Property Address 297 SHARON SE LAKE CITY GEO Number 154S17-08355-107
Exempt Amount	Taxable Value	
See Below	See Below	
Exemption Detail NO EXEMPTIONS Legal Description (click for full description) 15-4S-17 0000/0200 1.00 Acres LOT 7 BLOCK A PERRY PLACE S/D. ORB 771-1124, WD 1030-305.		
Millage Code 002		
Escrow Code		
Ad Valorem Taxes		
Taxing Authority	Rate	Assessed Value Exemption Amount Taxable Value Taxes Levied
BOARD OF COUNTY COMMISSIONERS	8.0150	12,867 0 \$12,867 \$103.13
COLUMBIA COUNTY SCHOOL BOARD		
DISCRETIONARY	0.7480	12,867 0 \$12,867 \$9.63
LOCAL	4.3200	12,867 0 \$12,867 \$55.59
CAPITAL OUTLAY	1.5000	12,867 0 \$12,867 \$19.30
SUWANNEE RIVER WATER MGT DIST	0.4027	12,867 0 \$12,867 \$5.18
LAKE SHORE HOSPITAL AUTHORITY	0.9620	12,867 0 \$12,867 \$12.38
Total Millage		Total Taxes
15.9477		\$205.21
Non-Ad Valorem Assessments		
Code	Levying Authority	Amount
FFIR	FIRE ASSESSMENTS	\$219.98
GGAR	SOLID WASTE - ANNUAL	\$193.00
Total Assessments		\$412.98
Taxes & Assessments		\$618.19
If Paid By		Amount Due
		\$0.00

Date Paid	Transaction	Receipt	Item	Amount Paid
11/30/2017	PAYMENT	2701963.0001	2017	\$593.46



STATE OF FLORIDA
DEPARTMENT OF HEALTH
ONSITE SEWAGE TREATMENT AND DISPOSAL
SYSTEM
APPLICATION FOR CONSTRUCTION PERMIT

PERMIT NO. 18-0663
DATE PAID: 2/20/18
FEE PAID: 600.00
RECEIPT #: 23500111

APPLICATION FOR:

☐ New System ☒ Existing System ☐ Holding Tank ☐ Innovative
☐ Repair ☐ Abandonment ☐ Temporary ☐

APPLICANT: Elizabeth Earls

AGENT: ROCKY FORD, A & B CONSTRUCTION

TELEPHONE: 386-497-2311

MAILING ADDRESS: 546 SW Dortch Street, FT. WHITE, FL, 32038

TO BE COMPLETED BY APPLICANT OR APPLICANT'S AUTHORIZED AGENT. SYSTEMS MUST BE CONSTRUCTED BY A PERSON LICENSED PURSUANT TO 489.105(3)(m) OR 489.552, FLORIDA STATUTES. IT IS THE APPLICANT'S RESPONSIBILITY TO PROVIDE DOCUMENTATION OF THE DATE THE LOT WAS CREATED OR PLATTED (MM/DD/YY) IF REQUESTING CONSIDERATION OF STATUTORY GRANDFATHER PROVISIONS.

PROPERTY INFORMATION

LOT: 7 BLOCK: A SUB: Perry Place PLATTED: 1978

PROPERTY ID #: 15-4S-17-08355-107 ZONING: _____ I/M OR EQUIVALENT: ☐ Y ☒ N

PROPERTY SIZE: 1 ACRES WATER SUPPLY: ☐ PRIVATE PUBLIC ☒ <2000GPD ☐ >2000GPD

IS SEWER AVAILABLE AS PER 381.0065, FS? ☐ Y ☒ N DISTANCE TO SEWER: _____ FT

PROPERTY ADDRESS: 297 Sharon Lane, LC

DIRECTIONS TO PROPERTY: US 90 East, TR SR 100, TR CR 245, TR Sharon Lane, 7th lot
on right

BUILDING INFORMATION

☒ RESIDENTIAL ☐ COMMERCIAL

Unit No. Type of Establishment No. of Bedrooms Building Area Sqft Commercial/Institutional System Design Table 1, Chapter 64E-6, FAC

1	SF Residential	3	1344	3BR Like Sea Like
2				
3				

☒ Floor/Equipment Drains ☒ Other (Specify) _____

SIGNATURE: Rocky Ford

DATE: 7/18/2018

Permit Application Number.

18-0443

Scale: 1 inch = 40 feet.

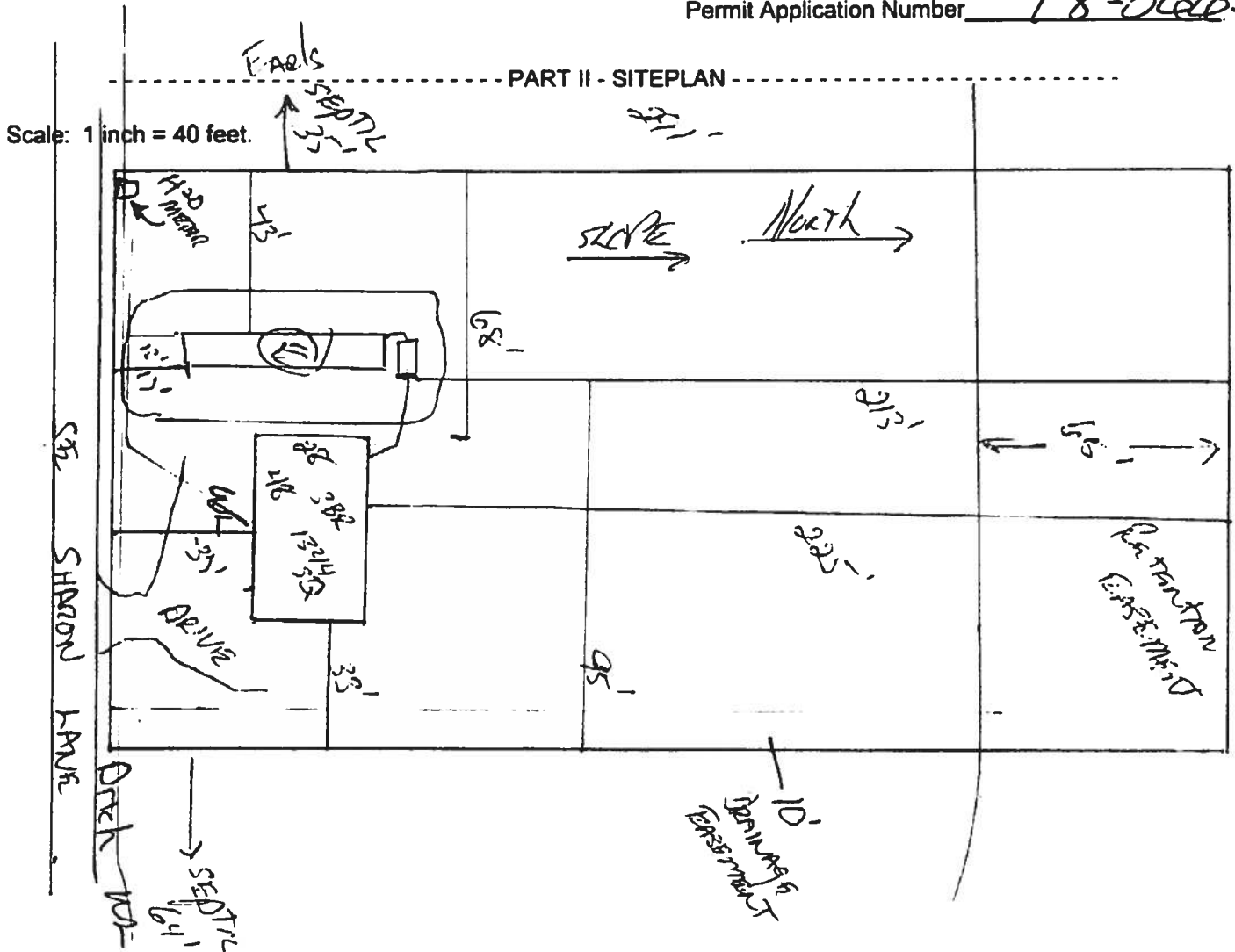

Notes:

Site Plan submitted by:

Plan Approved

By _____

Not Approved

51

Columbia

MASTER CONTRACTOR

Date 7/24/18

County Health Department

DH 4015, 08/09 (Obsoletes previous editions which may not be used) Incorporated: 64E-8.001, FAC
 (Stock Number 5744-002-4015-8)

District No. 1 - Ronald Williams
District No. 2 - Rusty DePratter
District No. 3 - Bucky Nash
District No. 4 - Everett Phillips
District No. 5 - Tim Murphy



BOARD OF COUNTY COMMISSIONERS • COLUMBIA COUNTY

Address Assignment and Maintenance Document

To maintain the county wide Addressing Policy you must make application for a 9-1-1 Address at the time you apply for a building permit. The established standards for addressing and posting numbers to all principal buildings, dwellings, businesses and industries are contained in Columbia County Ordinance 2001-9. The addressing system is to enable Emergency Services Agencies to locate you in an emergency, and to assist the United States Postal Service and the public in the timely and efficient provision of services to residents and businesses of Columbia County

Date/Time Issued: **7/25/2018 3:49:52 PM**
Address: **297 SE SHARON Ln**
City: **LAKE CITY**
State: **FL**
Zip Code **32025**

Parcel ID **08355-107**

REMARKS: Address Verification.

NOTICE: THIS ADDRESS WAS ISSUED BASED ON LOCATION AND ACCESS INFORMATION RECEIVED FROM THE REQUESTER. SHOULD, AT A LATER DATE, THE LOCATION AND/OR ACCESS INFORMATION BE FOUND TO BE IN ERROR OR CHANGED, THIS ADDRESS IS SUBJECT TO CHANGE.

Address Issued By: **Signed:/ Matt Crews**

Columbia County GIS/911 Addressing Coordinator

**COLUMBIA COUNTY
911 ADDRESSING / GIS DEPARTMENT**

263 NW Lake City Ave., Lake City, FL 32055 Telephone: (386) 758-1125
Email: gis@columbiacountyfla.com