

COLUMBIA COUNTY

Property Appraiser

Parcel 17-2S-17-04720-000

Owners

CHRISTIE KIMBERLY
8877 N US HIGHWAY 441
LAKE CITY, FL 32055

Parcel Summary

Location	8877 N US HIGHWAY 441
Use Code	0100: SINGLE FAMILY
Tax District	3: COUNTY
Acreage	1.0000
Section	17
Township	2S
Range	17
Subdivision	DIST 3
Exemptions	01: HOMESTEAD (196.031a&b) (100%)

Legal Description

COMM AT NW COR OF NE1/4 OF
SE1/4, RUN S 235 FT FOR POB,
RUN E 363 FT, S 130 FT, W 363
FT, N 130 FT TO POB. EX R/W.
ORB 627-218, 724-283, 830-2028
WD 1153-1148

Working Values

	2025
Total Building	\$182,837
Total Extra Features	\$0
Total Market Land	\$5,200
Total Ag Land	\$0



	2025
Total Market	\$188,037
Total Assessed	\$127,916
Total Exempt	\$50,722
Total Taxable	\$77,194
SOH Diff	\$60,121

Value History

	2024	2023	2022	2021	2020	2019
Total Building	\$179,846	\$166,347	\$152,404	\$129,993	\$120,254	\$112,091
Total Extra Features	\$0	\$0	\$0	\$0	\$0	\$0
Total Market Land	\$5,200	\$5,200	\$5,200	\$5,200	\$5,198	\$5,198
Total Ag Land	\$0	\$0	\$0	\$0	\$0	\$0
Total Market	\$185,046	\$171,547	\$157,604	\$135,193	\$125,452	\$117,289
Total Assessed	\$124,311	\$120,690	\$117,175	\$113,762	\$112,191	\$109,669
Total Exempt	\$50,000	\$50,000	\$50,000	\$50,000	\$50,000	\$50,000
Total Taxable	\$74,311	\$70,690	\$67,175	\$63,762	\$62,191	\$59,669
SOH Diff	\$60,735	\$50,857	\$40,429	\$21,431	\$13,261	\$7,620

Document/Transfer/Sales History

Instrument / Official Record	Date	<u>Q/U</u>	Reason	Type	<u>V/I</u>	Sale Price	Ownership
<u>WD</u> 1153/1148	2008-06-26	<u>Q</u>	<u>01</u>	WARRANTY DEED	Improved	\$100	Grantor: ROBERT & MARTHA CHRISTIE Grantee: KIMBERLY CHRISTIE

Buildings

Building # 2, Section # 1, 118918, SFR

Type	Model	Heated Sq Ft	Repl Cost New	YrBl t	<u>WAY</u>	Other % Dpr	Normal % Dpr	% Cond	Value
<u>0100</u>	<u>01</u>	1332	\$215,102	2009	2009	0.00%	15.00%	85.00%	\$182,837

Structural Elements

Type	Description	Code	Details
EW	Exterior Wall	32	HARDIE BRD
RS	Roof Structure	03	GABLE/HIP

Subareas

Type	Gross Area	Percent of Base	Adjusted Area
<u>BAS</u>	1,332	100%	1,332
<u>FGR</u>	440	55%	242

Type	Description	Code	Details
RC	Roof Cover	03	COMP SHNGL
IW	Interior Wall	05	DRYWALL
IF	Interior Flooring	14	CARPET
IF	Interior Flooring	15	HARDTILE
AC	Air Conditioning	03	CENTRAL
HT	Heating Type	04	AIR DUCTED
BDR	Bedrooms	3.00	
BTH	Bathrooms	2.00	
FR	Frame	02	WOOD FRAME
STR	Stories	1.	1.
AR	Architectual Type	05	CONV

Type	Gross Area	Percent of Base	Adjusted Area
FOP	108	30%	32
FOP	108	30%	32

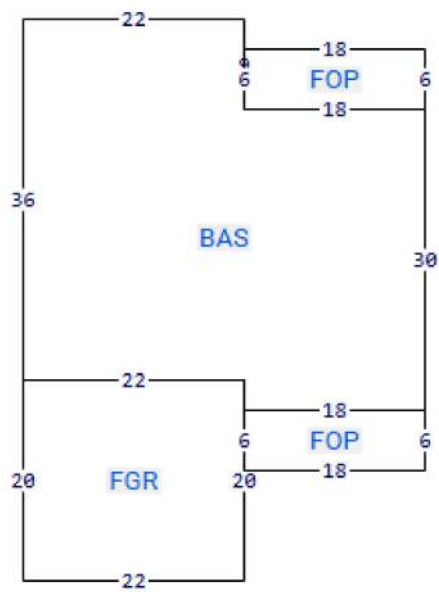

Extra Features

None

Land Lines

Code	Description	Zone	Front	Depth	Units	Rate/Unit	Acreage	Total Adj	Value
0100	SFR		.00	.00	1.00	\$5,200.00/AC	1.00	1.00	\$5,200

Personal Property

None

Permits

Date	Permit	Type	Status	Description
May 20, 2009	27811	SFR	COMPLETED	SFR

TRIM Notices

2024
2023
2022

Disclaimer

All parcel data on this page is for use by the Columbia County Assessor for assessment purposes only. The summary data on this page may not be a complete representation of the parcel or of the improvements thereon. Building information, including unit counts and number of permitted units, should be verified with the appropriate building and planning agencies. Zoning information should be verified with the appropriate planning agency. All parcels are reappraised each year. This is a true and accurate copy of the records of the Columbia County Assessor's Office as of April 15, 2025.