

BOUNDARY SURVEY

LOT 4, BLOCK D, SOUTHWOOD ACRES, UNIT 1
IN SECTION 36, TOWNSHIP 4 SOUTH, RANGE 16 EAST
COLUMBIA COUNTY, FLORIDA

DESCRIPTION:

Lot 4, Block D, SOUTHWOOD ACRES, Unit 1, a subdivision recorded in Plat Book 3, Page 376, of the Public Records of Columbia County, Florida.

NOTES:

- 1.) Monumentation is as shown and designated on the face of the plat.
- 2.) Boundary based on monumentation found in place, description furnished by client, prior survey and subdivision by Willis Melvin, R.L.S.
- 3.) Bearings projected from West Right-of-Way line of SW Belmont Dr. and based on above referenced prior survey and subdivision by Willis Melvin, R.L.S.
- 4.) Interior improvements were located by field ties.
- 5.) Underground encroachments, if present, were not located with this survey.
- 6.) This survey was made without benefit of a title search. There may be additional easements, restrictions, etc. not shown hereon but found in the Public Records. Issues regarding title, land use & zoning, easements & other encumbrances are not a part of the scope of a Boundary Survey and can only be revealed with a title search.
- 7.) Date of field survey completion: October 18, 2010.
- 8.) Examination of the Flood Insurance Rate Maps (FIRM) for Columbia County shows that, per said maps, the described parcel lies partly within Flood Zone "X", which according to said maps is outside of the 0.2% chance floodplain (ref: Map No. 12023C0383C).

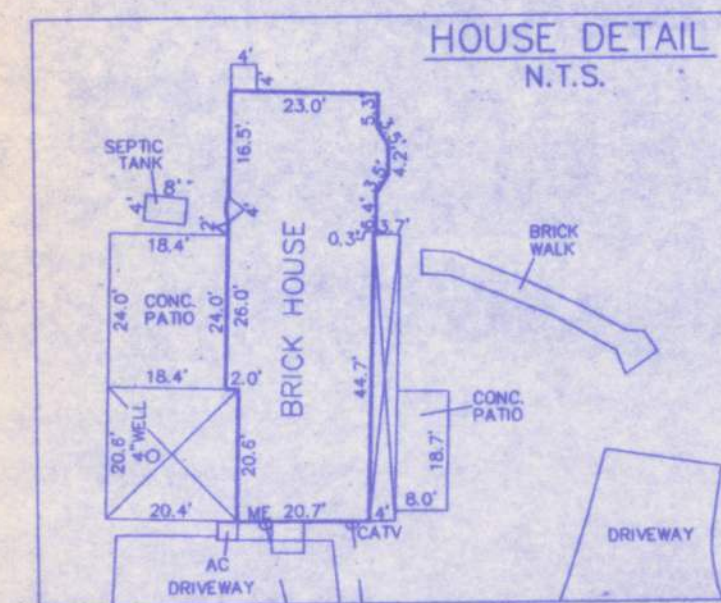

LEGEND	
CMF=CONCRETE MONUMENT FOUND	OHE=OVERHEAD ELECTRIC LINE
PLS=PROFESSIONAL LAND SURVEYOR	SEC=SECTION
P.S.M.=PROFESSIONAL SURVEYOR & MAPPER	RGE=RANGE
R/W=RIGHT-OF-WAY	TWP=TOWNSHIP
C=CENTER LINE	CR=CORNER
PP=POWER POLE	NE=NORTHEAST
SP=SERVICE POLE	NW=NORTHWEST
TPD=TELEPHONE PEDESTAL	SW=SOUTHWEST
IRC=IRON REBAR & CAP	SE=SOUTHEAST
(P)=PLAT MEASUREMENTS	LB=LICENSED BUSINESS
NO ID=NO IDENTIFICATION	(F)=FIELD MEASUREMENTS
SHPL=SHARED POLE W/LIGHT	(D)=DEED MEASUREMENTS
SPT=SERVICE POLE W/TRANSFORMER	FL=FOUND
CATV=CABLE TELEVISION BOX	PPT=POWER POLE W/TRANSFORMER
ME=METER, ELECTRIC	

CAD FILE: 5954.DWG

NOT VALID WITHOUT THE SIGNATURE
AND ORIGINAL RAISED SEAL OF A
FLORIDA REGISTERED PROFESSIONAL
SURVEYOR AND MAPPER

Timothy A. Delbene
Timothy A. Delbene, P.L.S.
Florida Reg. No. 5594
DATE: 10/20/2010



Donald F. Lee and Associates, Inc.

SURVEYORS — ENGINEERS

140 Northwest Ridgewood Avenue, Lake City, Florida 32055

Phone: (386) 755-6166 FAX: (386) 755-6167

Certificate of Authorization # LB 7042

Date: 10/19/2010

Drafting: A V G

Computations: A V G

Checked: T A D

LOUIS & MARTHA
POGUE

Scale: 1"=60'

Field Book: 10-573

Work Order: 10-5954

File: A-51-15

