

# Columbia County Property Appraiser

Jeff Hampton

2021 Working Values

updated: 3/18/2021

Parcel: << 05-4S-16-02777-017 (11781) >>

Aerial Viewer Pictometry Google Maps

## Owner & Property Info

Result: 6 of 43

Owner	COLWELL KEITH COLWELL ROBBIN L 5753 HIGHWAY 85 NORTH #2650 CRESTVIEW, FL 32536		
Site	272 ASPEN GLN, LAKE CITY		
Description*	LOT 16 BLOCK A WOODGATE VILLAGE UNIT 1. ORB 527-697, 550-369, 688-421, 736-876, 852-1940, 991-175, WD 1106-20.		
Area	0.249 AC	S/T/R	05-4S-16
Use Code**	MOBILE HOME (0200)	Tax District	2

\*The Description above is not to be used as the Legal Description for this parcel in any legal transaction.

\*\*The Use Code is a FL Dept. of Revenue (DOR) code and is not maintained by the Property Appraiser's office. Please contact your city or county Planning & Zoning office for specific zoning information.

## Property & Assessment Values

2020 Certified Values		2021 Working Values	
Mkt Land	\$13,266	Mkt Land	\$13,266
Ag Land	\$0	Ag Land	\$0
Building	\$4,646	Building	\$4,792
XFOB	\$2,300	XFOB	\$2,300
Just	\$20,212	Just	\$20,358
Class	\$0	Class	\$0
Appraised	\$20,212	Appraised	\$20,358
SOH Cap [?]	\$0	SOH Cap [?]	\$0
Assessed	\$20,212	Assessed	\$20,358
Exempt	\$0	Exempt	\$0
Total Taxable	county:\$20,212 city:\$20,212 other:\$20,212 school:\$20,212	Total Taxable	county:\$20,358 city:\$0 other:\$0 school:\$20,358

2019 2016 2013 2010 2007 2005 Sales

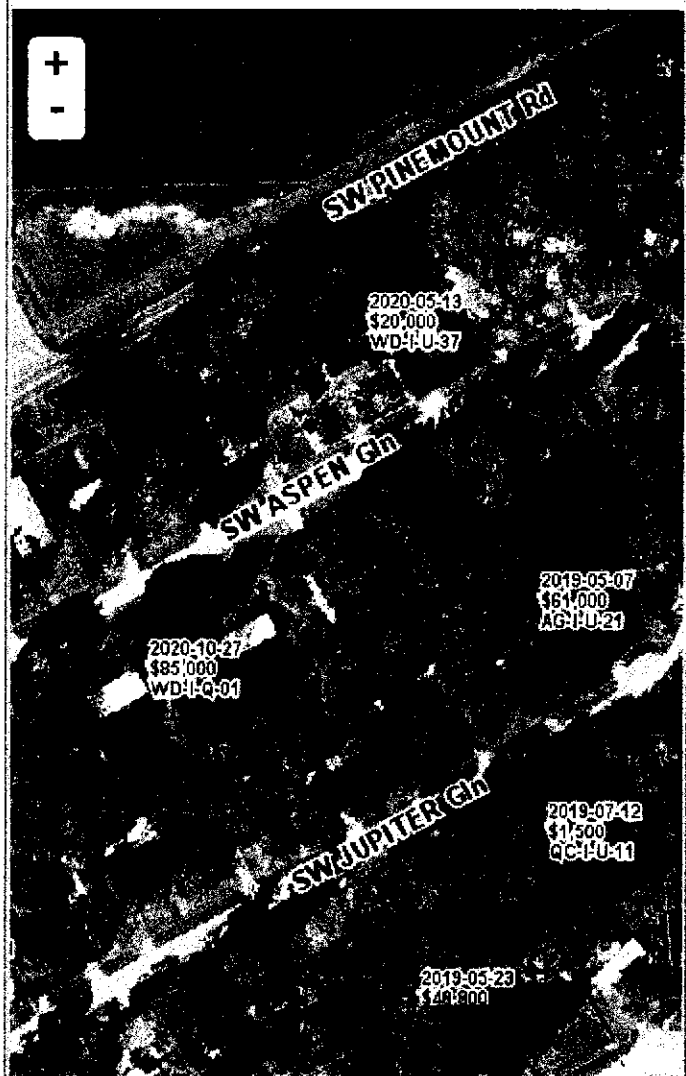

## Sales History

Sale Date	Sale Price	Book/Page	Deed	V/I	Qualification (Codes)	RCode
12/20/2006	\$26,000	1106/0020	WD	I	Q	
8/8/2003	\$17,000	0991/0175	WD	I	Q	
1/30/1998	\$18,000	0852/1940	WD	I	Q	
11/16/1990	\$16,000	0736/0876	WD	I	Q	
6/6/1989	\$16,500	0687/0421	WD	V	U	
8/1/1986	\$5,800	0599/0257	WD	V	Q	
3/1/1986	\$5,500	0587/0422	WD	V	Q	

## Building Characteristics

Bldg Sketch	Description*	Year Blt	Base SF	Actual SF	Bldg Value
Sketch	MOBILE HME (0800)	1986	644	868	\$4,792

\*Bldg Desc determinations are used by the Property Appraisers office solely for the purpose of determining a property's Just Value for ad valorem tax purposes and should not be used for any other purpose.

## Extra Features & Out Buildings (Codes)

Code	Desc	Year Blt	Value	Units	Dims
------	------	----------	-------	-------	------