

Legend

2018 Flood Zones

0.2 PCT ANNUAL CHANCE

A

AE

AH

Roads

Roads

others

Dirt

Interstate

Main

Other

Paved

Private

SRWMD Wetlands

Addresses

DevZones1

others

A-1

A-2

A-3

CG

CHI

CI

CN

CSV

ESA-2

I

ILW

MUD-1

PRD

PRRD

RMF-1

RMF-2

RO

RR

RSF-1

RSF-2

RSF-3

RSF/MH-1

RSF/MH-2

RSF/MH-3

DEFAULT

LidarElevations

X

Columbia County, FLA - Building & Zoning Property Map

Printed: Wed Jul 22 2020 14:39:08 GMT-0400 (Eastern Daylight Time)

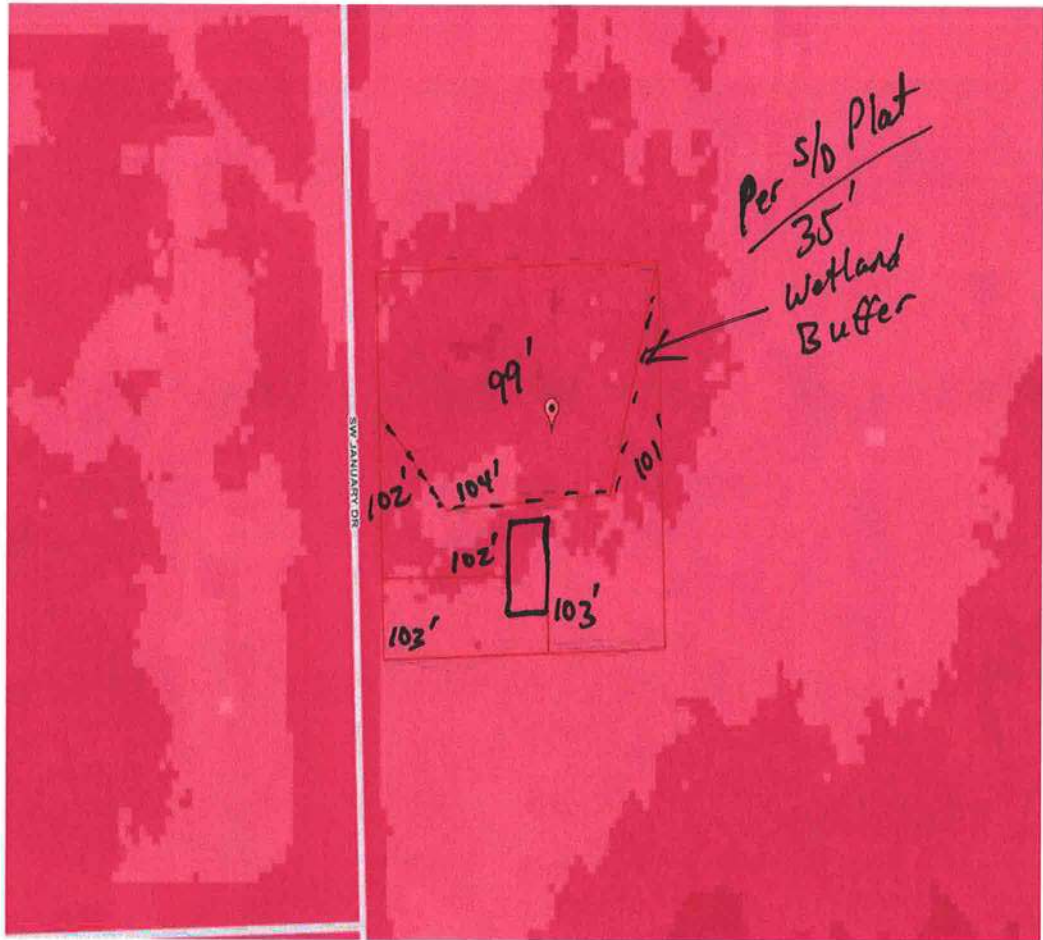

Parcel Information

Parcel No: 22-4S-16-03090-320

Owner: CRAPPS DANIEL & JAMES CHERRY

Subdivision: BLAINE ESTATES PHASE III

Lot: 20

Acres: 1.00277019

Deed Acres:

District: District 3 Bucky Nash

Future Land Uses: Residential - Very Low

Flood Zones:

Official Zoning Atlas: RR

All data, information, and maps are provided "as is" without warranty or any representation of accuracy, timeliness of completeness. Columbia County, FL makes no warranties, express or implied, as to the use of the information obtained here. There are no implied warranties of merchantability or fitness for a particular purpose. The requester acknowledges and accepts all limitations, including the fact that the data, information, and maps are dynamic and in a constant state of maintenance, and update.