



STATE OF FLORIDA  
DEPARTMENT OF ENVIRONMENTAL PROTECTION  
ONSITE SEWAGE TREATMENT AND DISPOSAL  
SYSTEM (OSTDS)

PERMIT NO. 25-0498  
DATE PAID: 2/12/25  
FEE PAID: 200.00  
RECEIPT #: 2224869

APPLICATION FOR CONSTRUCTION PERMIT

APPLICATION FOR:

[ ] New System [x] Existing System [ ] Holding Tank [ ] Innovative  
[ ] Repair [ ] Abandonment [ ] Temporary [ ]

APPLICANT: Rainflower, Brook EMAIL: antonio.jones@tidalbasingroup.com

AGENT: Antonio Jones TELEPHONE: 757-703-5696

MAILING ADDRESS: 573 Hawthorne Ave Athens Ga 30606

TO BE COMPLETED BY APPLICANT OR APPLICANT'S AUTHORIZED AGENT. SYSTEMS MUST BE CONSTRUCTED BY A PERSON LICENSED PURSUANT TO 489.105(3)(m) OR 489.552, FLORIDA STATUTES. IT IS THE APPLICANT'S RESPONSIBILITY TO PROVIDE DOCUMENTATION OF THE DATE THE LOT WAS CREATED OR PLATTED (MM/DD/YY) IF REQUESTING CONSIDERATION OF STATUTORY GRANDFATHER PROVISIONS.

PROPERTY INFORMATION

OSTDS REMEDIATION PLAN? [Y] / [N]

LOT: 12 BLOCK: \_\_\_\_\_ SUBDIVISION: Turkey Haven PLATTED: \_\_\_\_\_

PROPERTY ID #: 29-5S-16-03737-112 ZONING: \_\_\_\_\_ I/M OR EQUIVALENT: [Y] / [N]

PROPERTY SIZE: 5.1 ACRES WATER SUPPLY: [x] PRIVATE PUBLIC [ ] <=2000GPD [ ] >2000GPD

IS SEWER AVAILABLE AS PER 381.0065, FS? [Y] / [N] DISTANCE TO SEWER: \_\_\_\_\_ FT

PROPERTY ADDRESS: 415 SW Drew Feagle Ave Fort White Fl 32038

DIRECTIONS TO PROPERTY: See google map

BUILDING INFORMATION

[x] RESIDENTIAL

[ ] COMMERCIAL

Unit No.	Type of Establishment	No. of Bedrooms	Building Area Sqft	Commercial/Institutional System Design Table I, Chapter 62-6, FAC
1	MHU	2	13'-6"x 50'-8"	
2				
3				
4				

*Needed forms rec'd 6/10/25*

[ ] Floor/Equipment Drains [ ] Other (Specify) \_\_\_\_\_

SIGNATURE: Antonio Jones DATE: 5/30/2025

DEP 4015, 06-21-2022 (Obsoletes previous editions which may not be used)

Incorporated 62-6.004, FAC

STATE OF FLORIDA  
DEPARTMENT OF ENVIRONMENTAL PROTECTION  
APPLICATION FOR CONSTRUCTION PERMIT

Permit Application Number

25-0498

PART II - SITEPLAN

Rainflower

Scale: Each block represents 10 feet and 1 inch = 40 feet.

Notes:

Site Plan submitted by: ~~X~~ Antonio Jones

Plan Approved

By

Not Approved

Date

6/13/20

County Health Department

ALL CHANGES MUST BE APPROVED BY THE COUNTY HEALTH DEPARTMENT

DEP 4015, 06-21-2022 (Obsoletes previous editions which may not be used)

Incorporated: 62-6.004, F.A.C.



Site Map Picture (If Applicable)

25-0448

2/1

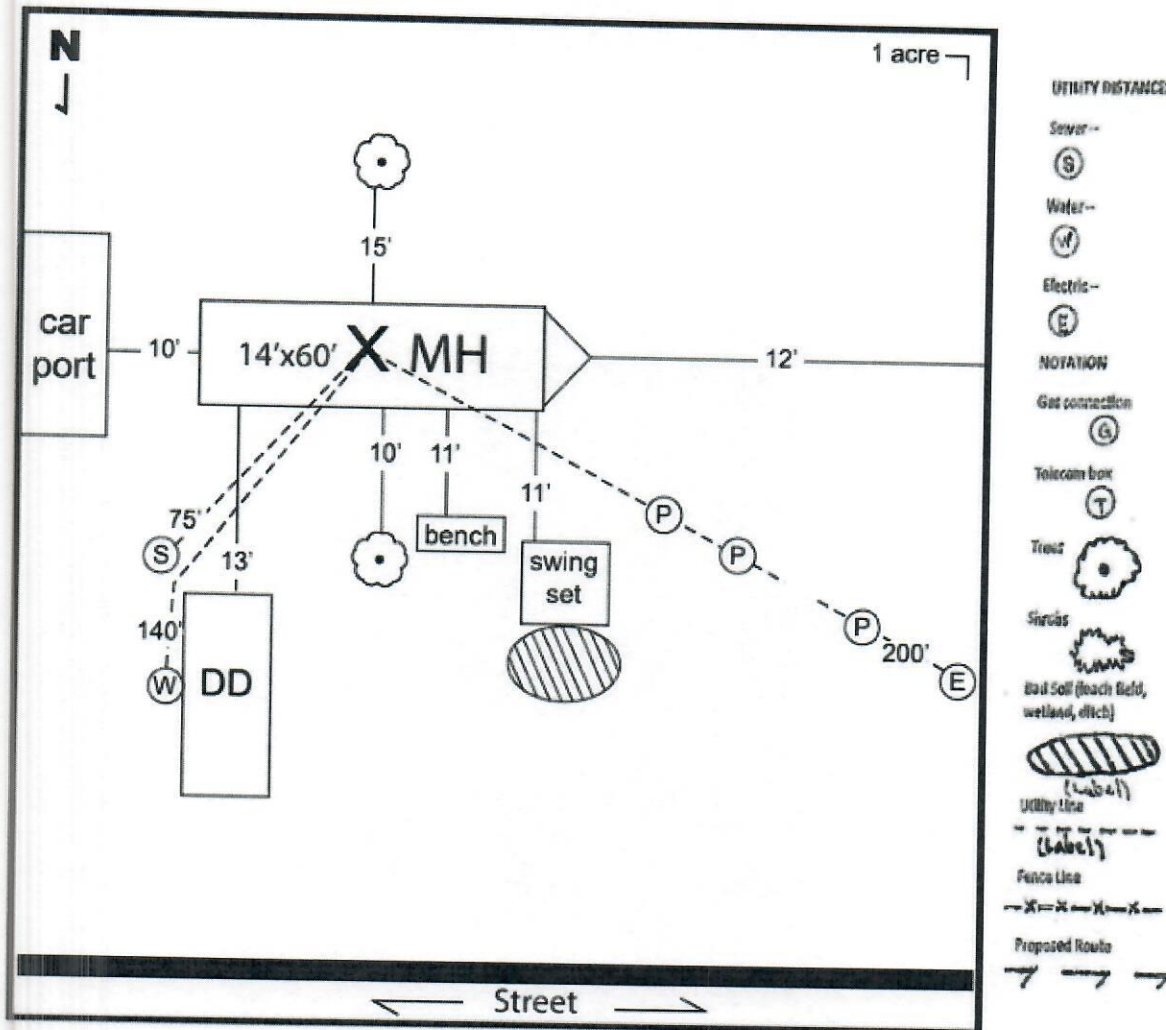

Site Address 415 SW Drew Feagle Ave SIR# 4828-023-000D-P

Power 200'  
Water 140'  
Sewer 75'

Largest Unit Size MH 14'x60'

Center Unit Coordinates 30.01851  
-82.74278

Corner 1 Coordinates 30.01848  
-82.74280

Corner 3 Coordinates 30.01866  
-82.74276

Corner 2 Coordinates 30.01857  
-82.74277

Corner 4 Coordinates 30.01867  
-82.74279