

FLORIDA DEPARTMENT OF
Business & Professional Regulation



[DBPR HOME](#) | [ABOUT DBPR](#) | [DBPR DIVISIONS](#) | [CONTACT DBPR](#)

[BCIS Home](#) | [Log In](#) | [User Registration](#) | [Hot Topics](#) | [Submit Surcharge](#) | [Stats & Facts](#) | [Publications](#) | [Contact Us](#) | [BCIS Site Map](#) | [Links](#) | [Search](#)



Product Approval
USER: Public User

[Product Approval Menu](#) > [Product or Application Search](#) > [Application List](#) > **Application Detail**

► OFFICE OF THE
SECRETARY

FL #	FL19563-R6										
Application Type	Affirmation										
Code Version	2023										
Application Status	Approved										
Comments											
Archived	<input type="checkbox"/>										
Product Manufacturer	Andersen Corporation										
Address/Phone/Email	100 Fourth Avenue North Bayport, MN 55003 (651) 264-5308 alan.barstad@AndersenCorp.com										
Authorized Signature	Alan Barstad alan.barstad@AndersenCorp.com										
Technical Representative											
Address/Phone/Email											
Quality Assurance Representative											
Address/Phone/Email											
Category	Windows										
Subcategory	Horizontal Slider										
Compliance Method	Evaluation Report from a Florida Registered Architect or a Licensed Florida Professional Engineer <input type="checkbox"/> Evaluation Report - Hardcopy Received										
Florida Engineer or Architect Name who developed the Evaluation Report	Hermes F. Norero, P.E.										
Florida License	PE-73778										
Quality Assurance Entity	Window and Door Manufacturers Association-QA										
Quality Assurance Contract Expiration Date	12/16/2030										
Validated By	Zachary R. Priest, P.E. <input type="checkbox"/> Validation Checklist - Hardcopy Received										
Certificate of Independence	FL19563_R6_COI_COI Andersen SS 2021-10-18.pdf										
Referenced Standard and Year (of Standard)	<table> <thead> <tr> <th><u>Standard</u></th><th><u>Year</u></th></tr> </thead> <tbody> <tr> <td>AAMA/WDMA/CSA 101/I.S.2/A440</td><td>2008</td></tr> <tr> <td>AAMA/WDMA/CSA 101/I.S.2/A440</td><td>2011</td></tr> <tr> <td>AAMA/WDMA/CSA 101/I.S.2/A440</td><td>2017</td></tr> <tr> <td>ASTM E1886</td><td>2013</td></tr> </tbody> </table>	<u>Standard</u>	<u>Year</u>	AAMA/WDMA/CSA 101/I.S.2/A440	2008	AAMA/WDMA/CSA 101/I.S.2/A440	2011	AAMA/WDMA/CSA 101/I.S.2/A440	2017	ASTM E1886	2013
<u>Standard</u>	<u>Year</u>										
AAMA/WDMA/CSA 101/I.S.2/A440	2008										
AAMA/WDMA/CSA 101/I.S.2/A440	2011										
AAMA/WDMA/CSA 101/I.S.2/A440	2017										
ASTM E1886	2013										

ASTM E1996	2017
TAS 201	1994
TAS 202	1994
TAS 203	1994

Equivalence of Product Standards
Certified By

Sections from the Code

☒ I affirm that there are no changes in the new Florida Building Code which affect my product(s) and my product(s) are in compliance with the new Florida Building Code.

Documentation from approved Evaluation or Validation Entity ☐ Yes ☐ No ☐ N/A

[FL19563_R6_COC_SA19563_SS_2023-06-19.pdf](#)

Product Approval Method

Method 1 Option D

Date Submitted 08/08/2023
Date Validated 08/08/2023
Date Pending FBC Approval
Date Approved 08/10/2023
Date Revised 08/27/2024

Summary of Products

FL #	Model, Number or Name	Description
19563.1	Renewal by Andersen Glider Window (Non-HVHZ) (Non-Impact)	Renewal by Andersen Glider Window (Non-HVHZ) (Non-Impact)
Limits of Use Approved for use in HVHZ: No Approved for use outside HVHZ: Yes Impact Resistant: No Design Pressure: N/A Other: See Installation Details and Evaluation Report for allowable design pressures, sizes, configurations, installation requirements and limits of use.		Installation Instructions FL19563_R6_II_AWD243_SS_2018-12-17.pdf Verified By: Hermes F. Norero, P.E. FL PE No. 73778 Created by Independent Third Party: Yes Evaluation Reports FL19563_R6_AE_PER5898_SS_2018-12-16.pdf Created by Independent Third Party: Yes
19563.2	Renewal by Andersen Glider Windows (HVHZ) (Impact)	Renewal by Andersen Glider Windows (HVHZ) (Impact)
Limits of Use Approved for use in HVHZ: Yes Approved for use outside HVHZ: Yes Impact Resistant: Yes Design Pressure: +60/-70 Other: See Installation Details and Evaluation Report for allowable sizes, configurations, installation requirements and limits of use.		Installation Instructions FL19563_R6_II_AWD322_SS_2022-10-13.pdf Verified By: Hermes F. Norero, P.E. Florida P.E. 73778 Created by Independent Third Party: Yes Evaluation Reports FL19563_R6_AE_PER8163_SS_2022-10-13.pdf Created by Independent Third Party: Yes

[Back](#)

[Next](#)

Contact Us :: 2601 Blair Stone Road, Tallahassee FL 32399 Phone: 850-487-1824

The State of Florida is an AA/EEO employer. [Copyright 2007-2013 State of Florida.](#) :: [Privacy Statement](#) :: [Accessibility Statement](#) :: [Refund Statement](#)

Under Florida law, email addresses are public records. If you do not want your e-mail address released in response to a public-records request, do not send electronic mail to this entity. Instead, contact the office by phone or by traditional mail. If you have any questions, please contact 850.487.1395. *Pursuant to Section 455.275(1), Florida Statutes, effective October 1, 2012, licensees licensed under Chapter 455, F.S. must provide the Department with an email address if they have one. The emails provided may be used for official communication with the licensee. However email addresses are public record. If you do not wish to supply a personal address, please provide the Department with an email address which can be made available to the public. To determine if you are a licensee under Chapter



BUILDING DROPS

398 E DANIA BEACH BLVD. SUITE 338, DANIA BEACH, FL 33004

: K 9 k k S

S F # k
k Y F 6 ,
3&30E N kK E

5 k: K F k

5Bo 5BpWbs

S M nGpbs

5 k L

g (p-1 9 9 k k E
#k (,
z Y-#k (3 k z

: K (S k Y F 6 ,

g k k (5Y c : 8#
: K 1 (z N k k N K l F, 1sAA

: k (

F # k

pee C F nM

Lk l g k wrees

: k Y (

3 5nM l : r9n

1 V(V p e g3gg#

RV t dDi dni 7d77

p V V T u t (V a-f

Digitally signed by Hermes F. Norero, P.E.
Reason: I am approving this document
Date: 2022.10.13 11:09:24 -04'00'

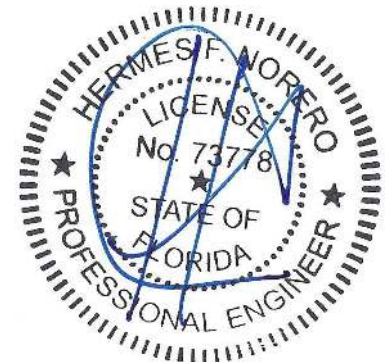

W 1l M P(lpl
1 VM l g3gg#



398 E DANIA BEACH BLVD. SUITE 338, DANIA BEACH, FL 33004

5Bo(5BpWbs
RV t dDi dni 7d77
T M t #an3

g k kK (F # k
: K #k (-
: K z Yi#k (W V b
k K g (b V (C V A .aN N
: K Mk (S k Y F 6 ,
3&30E N kKE

zK (y V(p V V T W 1l M P(lpl .1c e g3gg#N
F # k V A a b V 1 V(C VP
R V v V (V T V E1 Vv u I
W 1l M P(lpl V V V V V
V V V I
y V V V V V 1 Vv
u I
b w V V w F, 1sAAP V V W 1l M P(lpl .1c e
g3gg#N V V I

B ® (al y V V V V 1 V
v u P K the “High Velocity Hurricane Zone” (HVHZ).
7l (V V V V V V V I C
V V V V V I
3l - V V
u V an 1 Vv u V V V
V I
8l b V V V V V F, 1sAA
V I
fl b w V V w F, 1sAA V V I

954.399.8478

954.744.4738

: k A w

BUILDINGDROPS.COM

CONTACT@BUILDINGDROPS.COM



398 E DANIA BEACH BLVD. SUITE 338, DANIA BEACH, FL 33004

5Bo(5BpWbs
RV t dDi dni 7d77
T M t #an3

D k F k K (y V V V V V V V
V V 1 Vv u V V
V V V V V V V V V
, k 1 g k kK F Kk
.1vu h V V e) LC7fafN

: k K z k k (y V V V t

- CCA Ci- RA Ci ubC adai wbl7i C88dEag
- CbyA pa##nEa3V
- CbyA paDDnEag
- yCb 7daE8
- yCb 7d7E8
- yCb 7d3E8

S K 1k k(

al (y F K K k x I NKn k N
K k Ei 5 I g M
.1vu h V V etybyagDf N
T et M#837ldaE7daEa#P T RV t d#i d3i 77
yCb V V yV VCl R P1 V(p eD3f 3n

T et M#837ld7E7daEa#P T RV t d#i aai 77
T et M#83gldaE7daE8P T RV t d#i adi 77
T et M#83ldaE7daE8P T RV t d#i adi 77
T et M#83DldaE7daE8P T RV t d#i aai 77

7l (y F K K k x I NKn k N
K k Ei f I : F
.1vu h V V etybyaff #N
CbyA Rn3f
CbyA Rn3#
CbyA RaD7D
CbyA 5aff
T et Sf nn3ldaEadnEa#P T RV t d8i d7i 7a
CbyA p#8
T et Sf nn3ld8Ea7aEa8P T RV t dni d8i 7d

954.399.8478

954.744.4738

BUILDINGDROPS.COM

CONTACT@BUILDINGDROPS.COM

: k s w



398 E DANIA BEACH BLVD. SUITE 338, DANIA BEACH, FL 33004

5Bo(5BpWbs
RV t dDi dni 7d77
T M t #an3

3l (y F S k K # k
.1vu h V V etybyaf #f N
"South Florida outside 45 degree exposure for 5 years" (in lieu of ASTM
57ni5aff fNs CbyA R n3#
T et 18nD3P T RV t d3i 78i DD
8l (y N x z K MF NK 9 E
CbyA Rn3f
T et 3addf f DbCyEddg T RV t d#i d#i dn
CbyA RaD7D
T et 3addf f DbCyEdda T RV t d#i dDi dn
CbyA p#8
T et 3addf f DbCyEdd8 T RV t d#i d8i dn
fl A V V u V
g k i1k # M K FKK k K
8 k k F Kkl NKn : 1 : E
y (Bv w V

N k k (T w V V w .F, 1sAAN V V V V
V V I

1 : (T w V V w .F, 1sAAN V P V P
V V I

: k C w

954.399.8478

BUILDINGDROPS.COM

954.744.4738

CONTACT@BUILDINGDROPS.COM



398 E DANIA BEACH BLVD. SUITE 338, DANIA BEACH, FL 33004

5Bo(5BpWbs
RV t dDi dni 7d77
T M t #an3

9 k K x z k k (P V P
BV V V V V V
V V
1 Vv u IF # k V
V V . N
aN CbyA pa##nEaD
7N CbyA paDDnE7d
u V 3f 1 Vv u
V V V t
aN CbyA pa##nEa3V
7N CbyA paDDnEag
C V V V V P V
V V V V V IC
V V V V I

: k w w

954.399.8478

BUILDINGDROPS.COM

954.744.4738

CONTACT@BUILDINGDROPS.COM

ANDERSEN CORPORATION
RENEWAL by ANDERSEN GLIDER WINDOWS
(HVHZ) (IMPACT)

GENERAL NOTES:

1. THE PRODUCT SHOWN HEREIN IS DESIGNED AND MANUFACTURED TO COMPLY WITH THE CURRENT EDITION FLORIDA BUILDING CODE (FBC), INCLUDING HVHZ AND HAS BEEN EVALUATED ACCORDING TO THE FOLLOWING:
- AAMA WDMA/CSA 101/15.2/A440-17
 - ASTM E1886-13a
 - ASTM E1996-17
 - TAS 201-94
 - TAS 202-94
 - TAS 203-94

2. ADEQUACY OF THE EXISTING STRUCTURAL CONCRETE/MASONRY, 2X FRAMING, AND METAL FRAMING AS A MAIN VERTICAL FORCE RESISTING SYSTEM CAPABLE OF WITHSTANDING AND TRANSFERRING ALL PRODUCT LOADS TO THE FOUNDATION IS THE RESPONSIBILITY OF THE ENGINEER OR ARCHITECT OF RECORD FOR THE PROJECT OF INSTALLATION

3. 1X AND 2X BUCKS (WHEN USED) SHALL BE DESIGNED AND ANCHORED TO PROPERLY TRANSFER ALL LOADS TO THE STRUCTURE. BUCK DESIGN AND INSTALLATION IS THE RESPONSIBILITY OF THE ENGINEER OR ARCHITECT OF RECORD FOR THE PROJECT OF INSTALLATION.

4. INSTALL INDIVIDUAL INSTALLATION ANCHORS WITHIN A TOLERANCE OF $\pm 1/4$ INCH OF THE DEPICTED LOCATION IN THE ANCHOR LAYOUT DETAIL (I.E., WITHOUT CONSIDERATION OF TOLERANCES). TOLERANCES ARE NOT CUMULATIVE FROM ONE INSTALLATION ANCHOR TO THE NEXT.

5. THE INSTALLATION DETAILS DESCRIBED HEREIN ARE GENERIC AND MAY NOT REFLECT ACTUAL CONDITIONS FOR A SPECIFIC SITE. IF SITE CONDITIONS CAUSE INSTALLATION TO DEVIATE FROM THE REQUIREMENTS DETAILED HEREIN, A LICENSED ENGINEER OR ARCHITECT SHALL PREPARE SITE SPECIFIC DOCUMENTS FOR USE WITH THIS DOCUMENT IN NON-HVHZ AREAS. IN HVHZ AREAS, ONE-TIME APPROVAL TO BE OBTAINED FROM MIAMI-DADE RER OR AHI.

6. APPROVED IMPACT PROTECTIVE SYSTEM IS NOT REQUIRED ON THIS PRODUCT IN AREAS REQUIRING IMPACT RESISTANCE.

7. WINDOW FRAME MATERIAL: FIBREX & PVC

8. GLASS MEET THE REQUIREMENTS OF ASTM E 1300 GLASS CHARTS. SEE SHEET 1 FOR GLAZING DETAILS.

9. DESIGNATIONS "X" AND "O" STAND FOR THE FOLLOWING:
X: OPERABLE PANEL
O: FIXED PANEL

TABLE OF CONTENTS	
SHEET	SHEET DESCRIPTION
1	GENERAL NOTES AND GLAZING DETAILS
2	ELEVATIONS AND ANCHOR LAYOUT
3	VERTICAL SECTIONS
4	HORIZONTAL SECTIONS
5	INSTALLATION NOTES AND DETAILS

PRODUCT RATING TABLE

	SIZE	CONFIGURATION	DESIGN PRESSURE	SASH WIDTH RATIO	IMPACT RATING
	74" X 72"	OX		1:1	LARGE AND SMALL MISSILE RATING
	86" X 64"	XOX	+60/-70 PSF	1:2:1	
	120" X 64"	XOX		1:1:1	

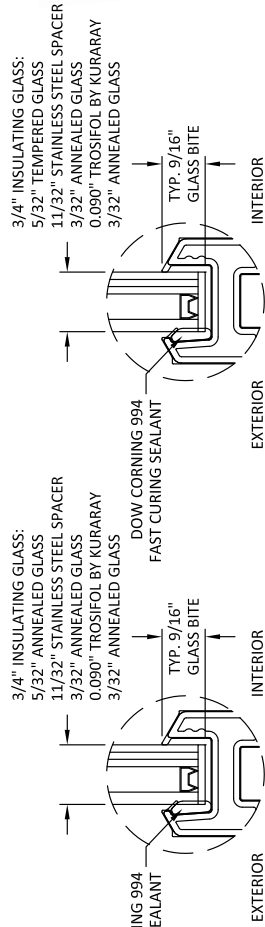

GLAZING DETAIL 1

GLAZING DETAIL 2

ZING NOTES:

1. GLASS TYPE AND THICKNESS COMPLY WITH ASTM E1300 REQUIREMENTS AS WELL AS APPLICABLE SAFETY GLAZING REQUIREMENTS PER THE FBC. TEMPER AND SAFETY GLAZING REQUIREMENTS SHALL BE REVIEWED ON A SITE SPECIFIC BASIS.
2. SETTING BLOCK DUREMETER HARDNESS OF 70-90 (SHORE A) AS REFERENCED IN FBC CHAPTER 24.
3. SETTING BLOCKS TO BE LOCATED AT 1/4 SPAN LENGTH FOR GLASS WIDER THAN 36" AS PER FBC CHAPTER 24.
4. DESIGN PRESSURES MAY NOT EXCEED MAX VALUES IN DESIGN PRESSURE TABLE ON SHEET 1.



RENEWAL
by ANDERSEN
FULL SERVICE WINDOW & MOON REPLACEMENT

100 FOURTH AVE NORTH
BAYPORT, MN 55003-1050
PH: (651) 264-5150 FX: (651) 264-5150

RENEWAL by ANDERSEN
GLIDER WINDOWS
(HVVHZ) (IMPACT)
GENERAL NOTES AND GLAZING DETAILS

BUILDING DROPS, INC.

PH: (954) 399-8478
FAX: (954) 744-4738
WEB: www.buildingdrops.com

REMARKS	BY	DATE
THE INSTALLATION DETAILS DESCRIBED HEREIN ARE GENERALIZED FOR A SPECIFIC SITE AND MAY NOT REFLECT ACTUAL CONDITIONS FOR A SPECIFIC SITE. IF SITE CONDITIONS CAUSE INSTALLATION TO DEVIATE FROM THE SPECIFICATIONS, THE ENGINEER OR ARCHITECT SHALL PREPARE SITE SPECIFIC DOCUMENTS FOR USE WITH THIS DOCUMENT.		

Digitally signed by Hermes F. Norero, P.E.
Reason: I am approving this document
Date: 2022.10.13 11:06:59 -0400

FL #: **FI 19563**

DATE: 09.16.22	CHK. BY: HF
DWG. BY: MS	

SCALE: NTS
DWG. #: AWD322
SHEET:

1 OF 5

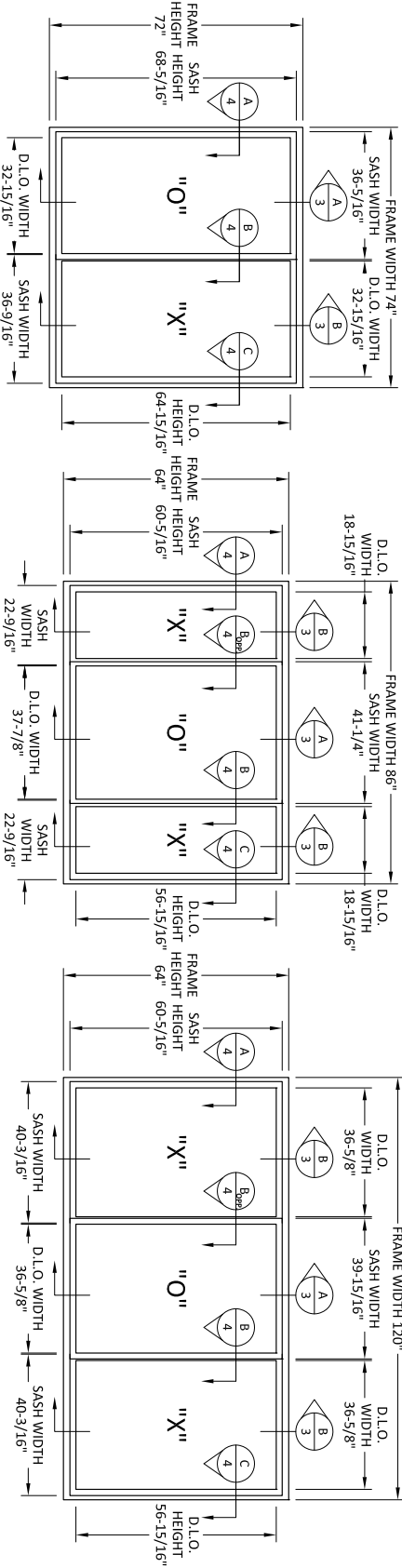

TYPICAL ELEVATION

TYPICAL ELEVATION

TYPICAL ELEVATION

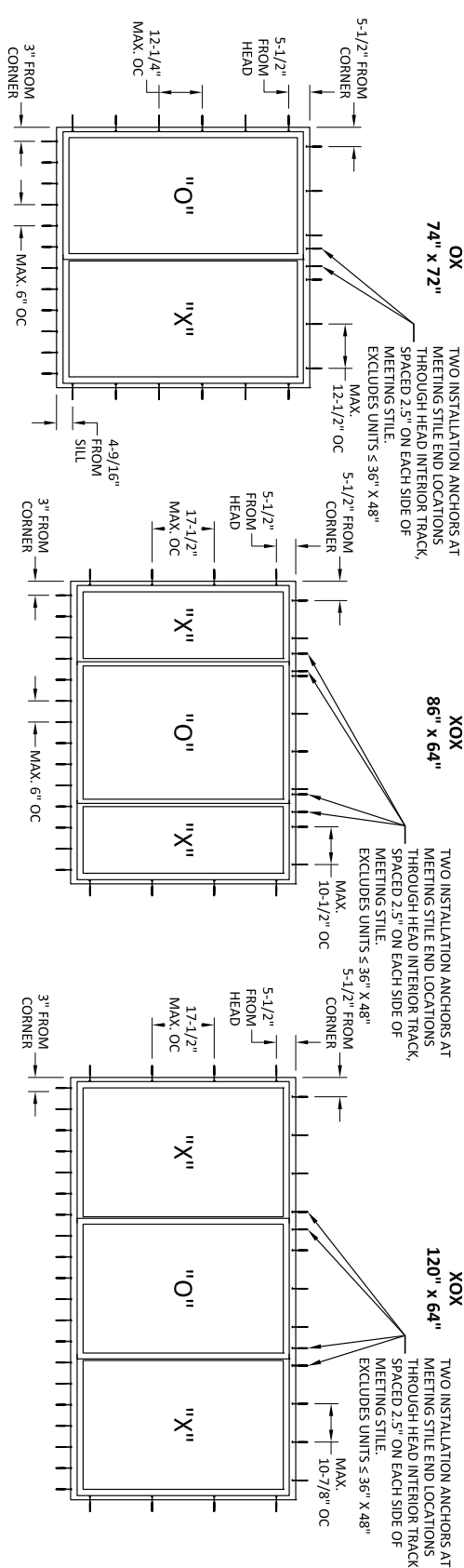

ANCHOR LAYOUT

ANCHOR LAYOUT

ANCHOR LAYOUT

OX
74" x 72"

XOX
86" x 64"

XOX
120" x 64"

RENEWAL
by **ANDERSEN**
WINDOW SYSTEMS, INC.
100 FOURTH AVE NORTH
BAYPORT, MN 55003-1095
PH: (651) 264-5150 FX: (651) 264-5485

TITLE: **RENEWAL by ANDERSEN GLIDER WINDOWS (HVHZ) (IMPACT)**

ELEVATIONS AND ANCHOR LAYOUT

PREPARED BY: **BUILDING DROPS, INC.**
398 E. DANIA BEACH BLVD., STE. 338
DANIA BEACH, FL 33004
PH: (954)399-8478
FAX: (954)744-4738
WEB: www.buildingdrops.com

REMARKS

BY DATE

THIS INSTALLATION PER THIS PROJECT IS THE PROPERTY OF THE GENERAL CONTRACTOR. IT IS TO BE USED FOR THE PROJECT ONLY. IT IS NOT TO BE REPRODUCED OR COPIED IN ANY MANNER WITHOUT THE WRITTEN PERMISSION OF THE GENERAL CONTRACTOR. THE GENERAL CONTRACTOR SHALL BE RESPONSIBLE FOR THE PROTECTION OF THIS DOCUMENT AND ITS CONTENTS. ANY UNAUTHORIZED USE OF THIS DOCUMENT IS PROHIBITED.

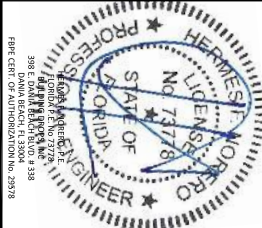

FL #: **FL19563**

DATE: **09.16.22**

DWG. BY: **MS** CHK. BY: **HFN**

SCALE: **NTS**

DWG. #: **AWD322**

SHEET: **2**

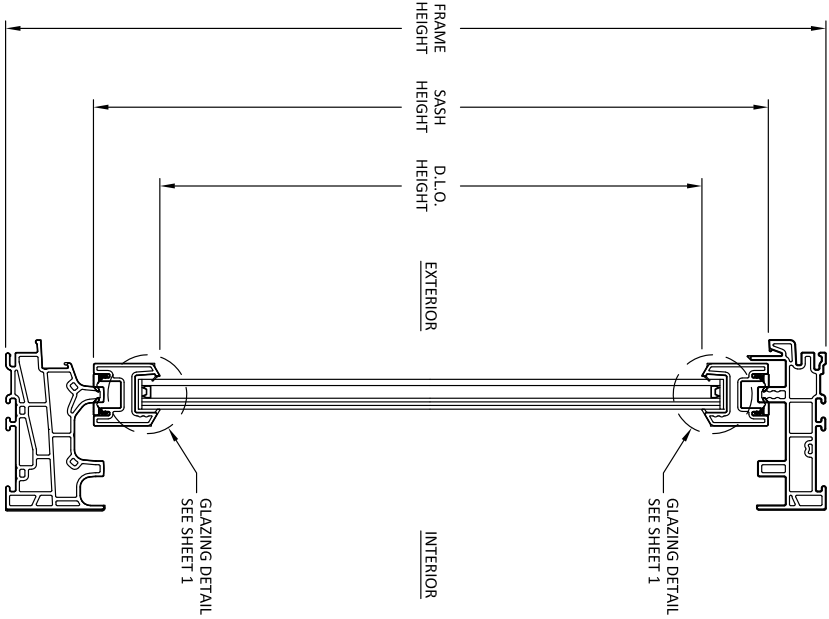

A
VERTICAL SECTION
FIXED SASH

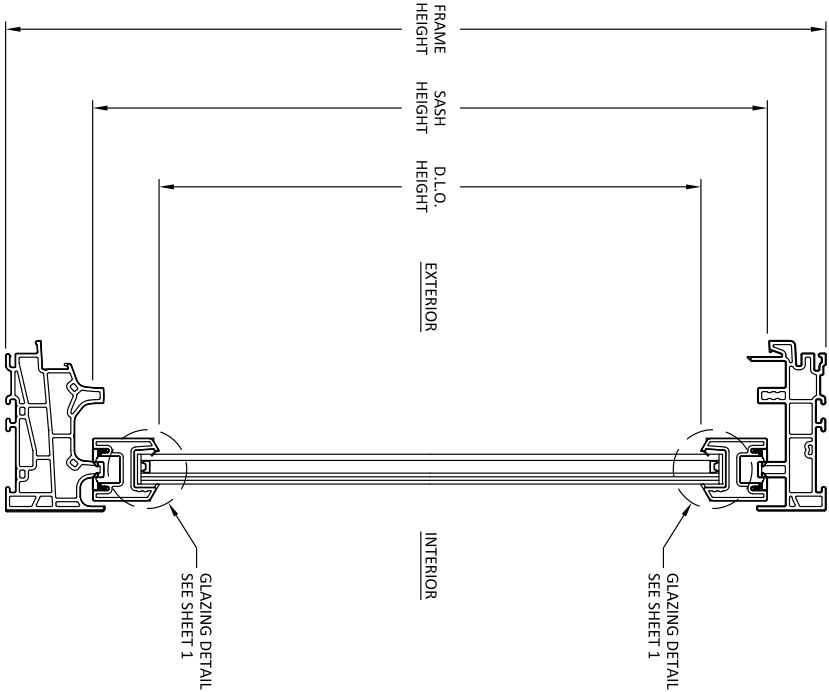

B
VERTICAL SECTION
OPERABLE SASH

RENEWAL by ANDERSEN
1001 E. 14TH AVE. NORTH
BAYPORT, MN 55003-1095
PH: (651) 264-5150 FX: (651) 264-5485

TITLE:
RENEWAL by ANDERSEN
GLIDER WINDOWS (HVHZ) (IMPACT)
VERTICAL SECTIONS

PREPARED BY:
BUILDING DROPS, INC.
398 E. DANIA BEACH BLVD., STE. 338
DANIA BEACH, FL 33004
PH: (954)399-8478
FAX: (954)764-4738
WEB: www.buildingdrops.com

REMARKS	BY	DATE

THIS INSTALLATION PERMITS ARE ISSUED BY THE FLORIDA DEPARTMENT OF REVENUE. THE PERMITTEE SHALL BE RESPONSIBLE FOR OBTAINING ALL NECESSARY PERMITS FROM THE RELEVANT AGENCIES. THE PERMITTEE SHALL BE RESPONSIBLE FOR OBTAINING ALL NECESSARY PERMITS FROM THE RELEVANT AGENCIES. THE PERMITTEE SHALL BE RESPONSIBLE FOR OBTAINING ALL NECESSARY PERMITS FROM THE RELEVANT AGENCIES.

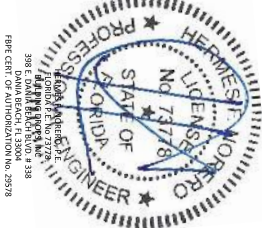

FL #: **FL19563**

DATE: **09.16.22**

DWG. BY: **MS** CHK. BY: **HFN**

SCALE: **NTS**

DWG. #: **AWD322**

SHEET: **3**

A
4 HORIZONTAL SECTION
FIXED JAMB

B
4 HORIZONTAL SECTION
MEETING STILE

C
4 HORIZONTAL SECTION
OPERABLE JAMB

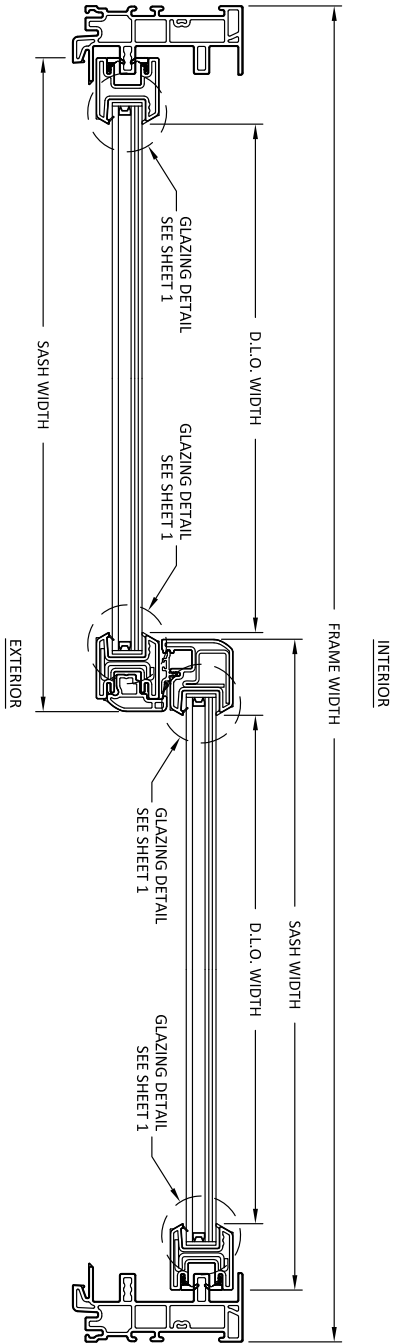



RENEWAL
by **ANDERSEN**

1001 FOURTH AVE NORTH
BAYPORT, MN 55003-1095
PH: (651) 264-5150 FX: (651) 264-5485

TITLE:
RENEWAL by ANDERSEN
GLIDER WINDOWS
(HVHZ) (IMPACT)
HORIZONTAL SECTIONS

PREPARED BY:
BUILDING DROPS, INC.
398 E. DANIA BEACH BLVD., STE. 338
DANIA BEACH, FL 33004
PH: (954)399-8478
FAX: (954)744-4738
WEB: www.buildingdrops.com

REMARKS	BY	DATE

THIS INSTALLATION PER THIS PERMITTING AGENCY IS THE GENERAL RESPONSIBILITY OF THE INSTALLER. THE INSTALLER SHALL BE RESPONSIBLE FOR THE PROPER INSTALLATION OF THE WINDOW. THE INSTALLER SHALL BE RESPONSIBLE FOR THE PROPER SELECTION OF THE WINDOW. THE INSTALLER SHALL BE RESPONSIBLE FOR THE PROPER SELECTION OF THE WINDOW. THE INSTALLER SHALL BE RESPONSIBLE FOR THE PROPER SELECTION OF THE WINDOW.



HERMES J. NORBERT
PROFESSIONAL ENGINEER
STATE OF FLORIDA
LICENSE NO. 73778
398 E. DANIA BEACH BLVD., STE. 338
DANIA BEACH, FL 33004
PH: (954)399-8478
FAX: (954)744-4738
WEB: www.buildingdrops.com

FL #:	FL19563
DATE:	09.16.22
DWG. BY:	MS
CHK. BY:	HFN
SCALE:	NTS
DWG. #:	AWD322
SHEET:	4

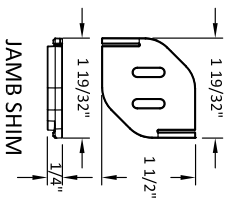
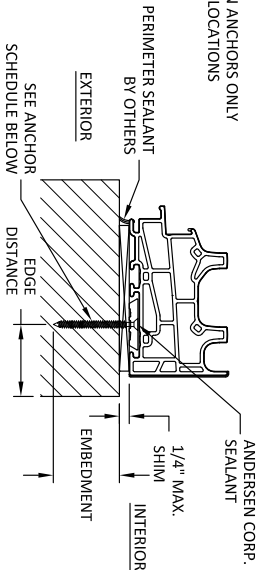
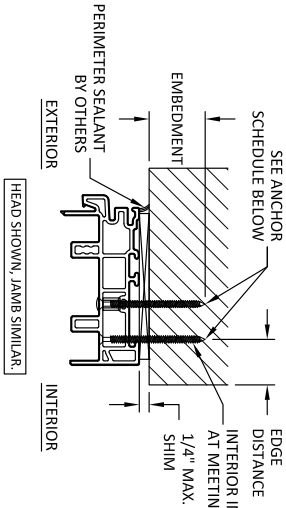

NOTE: JAMB SHIM TO BE USED AT EACH ANCHOR LOCATION

A INSTALLATION DETAILS

THROUGH FRAME

B INSTALLATION DETAILS

SILL CLEAT

INSTALLATION NOTES:

- ONE (1) INSTALLATION ANCHOR IS REQUIRED AT EACH ANCHOR LOCATION SHOWN.
- THE NUMBER OF INSTALLATION ANCHORS DEPICTED IS THE MINIMUM NUMBER OF ANCHORS TO BE USED FOR PRODUCT INSTALLATION OF THE MAXIMUM SIZE LISTED.
- INSTALL INDIVIDUAL INSTALLATION ANCHORS WITHIN A TOLERANCE OF $\pm 1/2$ INCH THE DEPICTED LOCATION & SPACING IN THE ANCHOR LAYOUT DETAILS (I.E., WITHOUT CONSIDERATION OF TOLERANCES). TOLERANCES ARE NOT CUMULATIVE FROM ONE INSTALLATION ANCHOR TO THE NEXT.
- SHIM AS REQUIRED AT EACH INSTALLATION ANCHOR WITH LOAD BEARING SHIM(S). MAXIMUM ALLOWABLE SHIM STACK TO BE $1/4$ " SHIM WHERE SPACE OF $1/16$ " OR GREATER OCCURS. SHIM(S) SHALL BE CONSTRUCTED OF HIGH DENSITY PLASTIC OR BETTER.
- FOR MASONRY OR CONCRETE OPENINGS, 1X WOOD BLOCK MAY BE USED (OPTIONAL AS LONG AS THE MINIMUM EMBEDMENT AND EDGE DISTANCE REQUIREMENTS ARE STILL MET WITHIN THE CORRESPONDING HOST SUBSTRATE. SEE GENERAL NOTE #3 ON SHEET 1 FOR MORE INFORMATION.
- MINIMUM EMBEDMENT AND EDGE DISTANCE EXCLUDE WALL FINISHES, INCLUDING BUT NOT LIMITED TO STUCCO, FOAM, BRICK VENEER, AND SIDING.
- INSTALLATION ANCHORS AND ASSOCIATED HARDWARE MUST BE MADE OF CORROSION RESISTANT MATERIAL OR HAVE A CORROSION RESISTANT COATING.
- FOR HOLLOW BLOCK AND GROUT FILLED BLOCK, DO NOT INSTALL INSTALLATION ANCHORS INTO MORTAR JOINTS. EDGE DISTANCE IS MEASURED FROM FREE EDGE OF BLOCK OR EDGE OF MORTAR JOINT INTO FACE SHELL OF BLOCK.
- INSTALLATION ANCHORS SHALL BE INSTALLED IN ACCORDANCE WITH ANCHOR MANUFACTURER'S INSTALLATION INSTRUCTIONS, AND ANCHORS SHALL NOT BE USED IN SUBSTRATES WITH STRENGTHS LESS THAN THE MINIMUM STRENGTH SPECIFIED BY THE ANCHOR MANUFACTURER.

ANCHOR SCHEDULE

METHOD	SUBSTRATE	ANCHOR TYPE	MIN. EMBEDMENT	MIN. EDGE DISTANCE
	WOOD			
	MIN. S.G. ≥ 0.55	#10 WOOD SCREW	1.5"	0.75"
	STEEL: MIN. .18 GAUGE MIN. F _y = 33KSI ALUM.: MIN. 1/8" THK. MIN. 6063-T5	#10 TEK SCREW	3 THREADS MIN PENETRATION BEYOND METAL	0.50"
THROUGH FRAME	CONCRETE: MIN. F _c =2000 PSI	3/16" ITW TAPCON	1"	1.50"
OR SILL CLEAT	MASONRY: CMU per ASTM C90	3/16" ITW TAPCON	1"	2"



100 FOURTH AVE NORTH
BAYPORT, MN 55003-1095
PH: (651) 264-5150 FX: (651) 264-5485

TITLE: RENEWAL by ANDERSEN
GLIDER WINDOWS
(HVHZ) (IMPACT)
INSTALLATION NOTES AND DETAILS

PREPARED BY: BUILDING DROPS, INC.
398 E. DANIA BEACH BLVD., STE. 338
DANIA BEACH, FL 33004
PH: (954)399-8478
FAX: (954)764.4738
WEB: www.buildingdrops.com

REMARKS BY DATE

THIS INSTALLATION PERMITS PREPARED HEREIN ARE GENERAL INSTRUCTIONS AND NOT A SUBSTITUTE FOR THE MANUFACTURER'S INSTRUCTIONS. THE INSTALLER SHALL BE RESPONSIBLE FOR OBTAINING ALL NECESSARY PERMITS AND FOR OBTAINING ALL NECESSARY INFORMATION FROM THE REQUIREMENTS SET FORTH HEREIN. A LICENSED PROFESSIONAL ENGINEER HAS REVIEWED THIS DOCUMENT FOR CONFORMANCE WITH THE REQUIREMENTS FOR USE WITH THIS DOCUMENT.

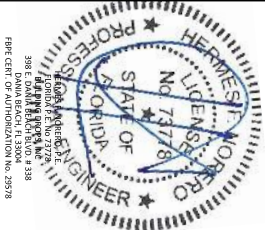

FL #: FL19563

DATE: 09.16.22

DWG. BY: MS CHK. BY: HFN

SCALE: NTS

DWG. #: AWD322

SHEET:

5

OF 5