

LYING IN SECTION 26, TOWNSHIP 5 SOUTH, RANGE 15 EAST,  
COLUMBIA COUNTY, FLORIDA



COMMENCE AT THE NORTHWEST CORNER OF THE SOUTHWEST 1/4 OF THE  
NORTHWEST 1/4, SECTION 26, TOWNSHIP 5 SOUTH, RANGE 15 EAST,  
COLUMBIA COUNTY, FLORIDA, AND RUN THENCE SOUTH 01 DEGREES 08'  
WEST 263.06 FEET TO THE POINT OF BEGINNING; THENCE CONTINUE SOUTH  
40.00 FEET TO THE POINT OF BEGINNING; THENCE CONTINUE SOUTH 01  
DEGREES 08' 34" EAST ALONG SAID WEST LINE, 2633.06 FEET TO THE  
SOUTHWEST CORNER OF THE NORTHWEST 1/4 OF THE SOUTHWEST 1/4 OF  
THE NORTHWEST 1/4, SECTION 26, TOWNSHIP 5 SOUTH, RANGE 15 EAST,  
COLUMBIA COUNTY, FLORIDA, AND RUN THENCE SOUTH 01 DEGREES 08'  
WEST 2633.06 FEET TO THE POINT OF BEGINNING; THENCE CONTINUE  
SOUTH LINE OF SAID NORTHWEST 1/4 OF SOUTHWEST 1/4, 602.37 FEET  
THENCE NORTH 01 DEGREES 08' 34" WEST, 1319.49 FEET; THENCE SOUTH  
87 DEGREES 53' 35" WEST, 542.44 FEET; THENCE NORTH 01 DEGREES  
08' 34" WEST, 1319.49 FEET; THENCE SOUTH 87 DEGREES 53' 35" WEST,  
542.44 FEET TO THE POINT OF BEGINNING.

LEGEND:

- = SET 5/8" REBAR & CAP (PSM 6602)
- = FOUND 4"x4" CONCRETE MONUMENT (RLS 4303)
- (L) = LEGAL EXISTING DATA
- (M) = MEASURED DATA
- O.R. = OFFICIAL RECORDS BOOK
- R/W = RIGHT OF WAY
- X— = 4' WIRE FENCE LINE (UNLESS NOTED OTHERWISE)
- OHE— = OVERHEAD UTILITY LINE
- ⌚ = WOOD POWER POLE
- ⊙ = WELL
- ST = SEPTIC TANK
- ⓔ = ELECTRIC METER

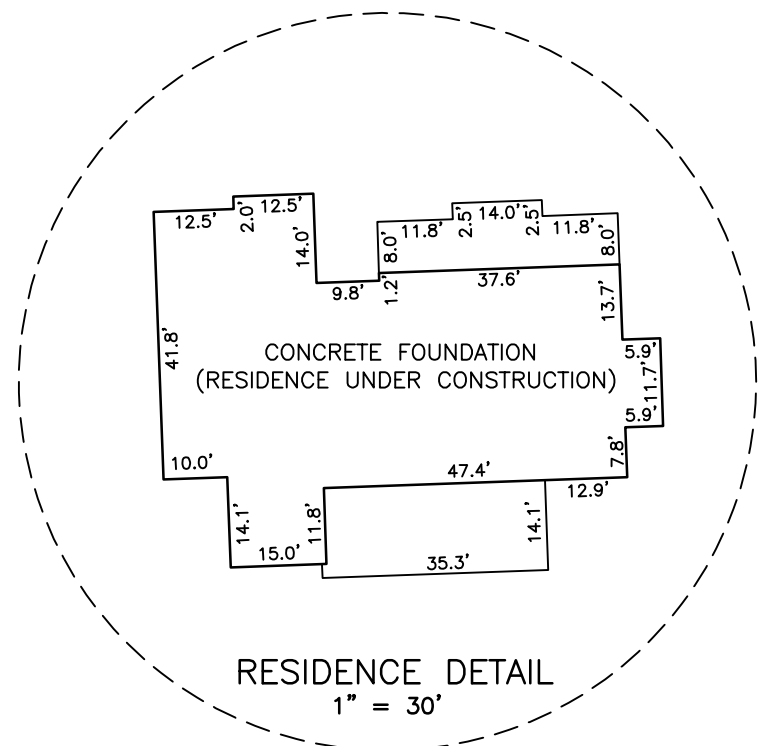

**FLOOD NOTE:**  
THE SUBJECT PROPERTY LIES WITHIN FLOOD ZONE X  
(AREAS DETERMINED TO BE OUTSIDE THE 0.2%  
ANNUAL CHANCE FLOODPLAIN, AND ZONE A (SPECIAL  
FLOOD HAZARD SUBJECT TO INUNDATION BY  
THE 1% ANNUAL CHANCE FLOOD, NO BASE FLOOD  
ELEVATION DETERMINED) AS SHOWN ON FLOOD  
INSURANCE RATE MAP NUMBER 12001C0370C FOR  
COLUMBIA COUNTY, FLORIDA, EFFECTIVE DATE  
FEBRUARY 4, 2009, FOR COLUMBIA COUNTY  
UNINCORPORATED AREAS, COMMUNITY NUMBER  
120070 PANEL NUMBER 0370 SUFFIX C.

SURVEYOR NOTES:

1. THE BEARINGS SHOWN HEREON ARE BASED ON FIELD MEASUREMENTS PROJECTED FROM A RECORD BEARING OF N 01°08'34"W, ALONG THE EAST LINE OF THE SUBJECT PARCEL.
2. NO UNDERGROUND INSTALLATION OF UTILITIES OR IMPROVEMENTS HAVE BEEN LOCATED EXCEPT AS SHOWN.
3. THE SURVEYOR HAS NO KNOWLEDGE OF UNDERGROUND FOUNDATIONS WHICH MAY ENCROACH.
4. RECORDED EASEMENT AND/OR DEEDS NOT FURNISHED TO THE SURVEYOR ARE NOT SHOWN.

NOT VALID WITHOUT THE SIGNATURE AND THE ORIGINAL RAISED SEAL OF  
A FLORIDA LICENSED SURVEYOR AND MAPPER. ADDITIONS OR DELETIONS  
TO THIS MAP BY ANYONE OTHER THAN THIS SURVEYOR IS PROHIBITED.

I HEREBY CERTIFY THAT THE SURVEY DATA SHOWN HEREON, IS A TRUE AND CORRECT REPRESENTATION OF A SURVEY PERFORMED UNDER MY SUPERVISION OF THE HEREON DESCRIBED PROPERTY, AND IT MEETS THE MINIMUM TECHNICAL STANDARDS AS SET FORTH BY THE FLORIDA BOARD OF LAND SURVEYORS, PURSUANT TO SECTION 472.027, FLORIDA STATUTES, AND CHAPTER 5J-17, FLORIDA ADMINISTRATIVE CODE.

LEIGH ANN FLOWERS  
Leigh A Flowers  
Digitally signed by  
Leigh A Flowers  
Date: 2024.10.11  
13:01:32 -04'00'

---

PROFESSIONAL SURVEYOR & MAPPER  
FLA. LICENSE NO. 6602

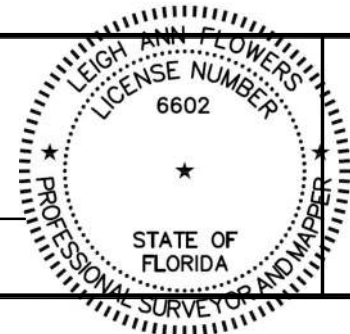

FLOWERS SURVEYING AND MAPPING INC  
207 SE CONDOR GLEN  
HIGH SPRINGS, FLORIDA 32643  
PHONE: (386) 462-0130  
EMAIL: FLOWERSSURVEYING@GMAIL.COM

CERTIFIED TO:

JOSHUA E. GASKINS and TASHA M. GASKINS

♦♦♦♦

FIELD BOOK - SEE FOLDER

---

DRAFTED: LAF

---

CHECKED: LAF

---

SURVEY DATE: 10/7/24

JOB NUMBER: 24-142

SHEET  
1 OF 1