

DATE 11/07/2017

Columbia County Building Permit**PERMIT****This Permit Must Be Prominently Posted on Premises During Construction****000035960**

APPLICANT DEBORAH CHRISTIE PHONE 904-219-3739
 ADDRESS 7495 NW LAKE JEFFERY RD LAKE CITY FL 32055
 OWNER DEBORAH CHRISTIE PHONE 904-219-3739
 ADDRESS 7495 NW LAKE JEFFERY RD LAKE CITY FL 32055
 CONTRACTOR DEBORAH CHRISTIE PHONE 904-219-3739
 LOCATION OF PROPERTY 90 W. R LAKE JEFFERY RD. 7 MILES. AT CREST OF HILL
ON RIGHT. YELLOW HOUSE WITH GREEN ROOF
 TYPE DEVELOPMENT UTILITY POLE ESTIMATED COST OF CONSTRUCTION 0.00
 HEATED FLOOR AREA TOTAL AREA HEIGHT STORIES
 FOUNDATION WALLS ROOF PITCH FLOOR
 LAND USE & ZONING MAX. HEIGHT
 Minimum Set Back Requirments: STREET-FRONT REAR SIDE
 NO. EX.D.U. 1 FLOOD ZONE NA DEVELOPMENT PERMIT NO.

PARCEL ID 05-3S-16-01968-000 SUBDIVISION
 LOT BLOCK PHASE UNIT TOTAL ACRES 31.64

OWNER x Deborah Christie
 Culvert Permit No. Culvert Waiver X17-097 Contractor's License Number Applicant/Owner/Contractor
LH N
 Driveway Connection Septic Tank Number LU & Zoning checked by Approved for Issuance New Resident Time/STUP No.

COMMENTS: FOR EXISTING BARNCheck # or Cash CASH**FOR BUILDING & ZONING DEPARTMENT ONLY**

(footer/Slab)

Temporary Power Foundation Monolithic
 date/app. by date/app. by date/app. by
 Under slab rough-in plumbing Slab Sheathing/Nailing
 date/app. by date/app. by date/app. by
 Framing Insulation
 date/app. by date/app. by
 Rough-in plumbing above slab and below wood floor Electrical rough-in
 date/app. by date/app. by
 Heat & Air Duct Peri. beam (Lintel) Pool
 date/app. by date/app. by date/app. by
 Permanent power C.O. Final Culvert
 date/app. by date/app. by date/app. by
 Pump pole Utility Pole M/H tie downs, blocking, electricity and plumbing
 date/app. by date/app. by date/app. by
 Reconnection RV Re-roof
 date/app. by date/app. by date/app. by

BUILDING PERMIT FEE \$ 0.00 CERTIFICATION FEE \$ 0.00 SURCHARGE FEE \$ 0.00

MISC. FEES \$ 50.00 ZONING CERT. FEE \$ FIRE FEE \$ 0.00 WASTE FEE \$

Columbia County Property Appraiser

updated: 10/27/2017

35960

2017 Tax Year

904-219-3739

Tax Collector

Tax Estimator

Property Card

Parcel: 05-3S-16-01968-000

Parcel List Generator

<< Next Lower Parcel Next Higher Parcel >>

2017 TRIM (pdf)

Interactive GIS Map

Print

Owner & Property Info

Search Result: 1 of 1

Owner's Name	CHRISTIE DEBORAH P FARR		
Mailing Address	7495 NW LAKE JEFFERY RD LAKE CITY, FL 32055-8614		
Site Address	7495 NW LAKE JEFFERY RD		
Use Desc. (code)	IMPROVED A (005000)		
Tax District	3 (County)	Neighborhood	5316
Land Area	31.640 ACRES	Market Area	01
Description	NOTE: This description is not to be used as the Legal Description for this parcel in any legal transaction. BEG NE COR OF SE1/4 OF NW1/4, RUN E 748 FT, SE 180 FT, E 234.12 FT, S 1119.80 FT, NW 540 FT, S 354 FT TO N R/W CR-250, NW 671.95 FT, N 504 FT W 202 FT, N 639.85 FT, E 198.85 FT. ORB 403-623, 800-1257, 805-2435, 819-2120, JTWRS 937-112, (DC 1241-2164; ADHEMAR FRANCOIS POURBAIX),		

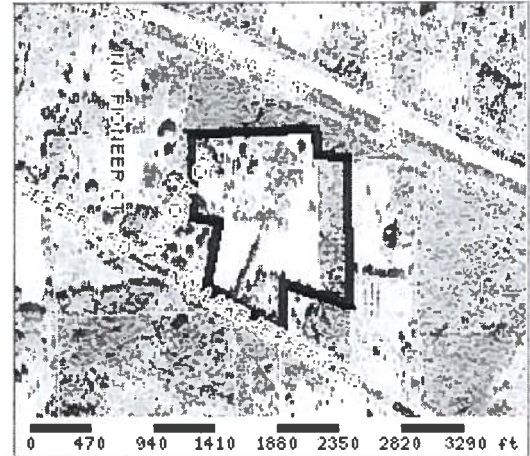

Property & Assessment Values

2017 Certified Values		
Mkt Land Value	cnt: (1)	\$8,999.00
Ag Land Value	cnt: (1)	\$7,200.00
Building Value	cnt: (1)	\$86,034.00
XFOB Value	cnt: (4)	\$7,626.00
Total Appraised Value		\$109,859.00
Just Value		\$213,129.00
Class Value		\$109,859.00
Assessed Value		\$109,859.00
Exempt Value	(code: HX H3)	\$50,000.00
Total Taxable Value	Cnty: \$59,859 Other: \$59,859 Schl: \$84,859	

2018 Working Values (...Hide Values)		
Mkt Land Value	cnt: (1)	\$9,899.00
Ag Land Value	cnt: (1)	\$7,200.00
Building Value	cnt: (1)	\$89,375.00
XFOB Value	cnt: (4)	\$7,626.00
Total Appraised Value		\$114,100.00
Just Value		\$228,417.00
Class Value		\$114,100.00
Assessed Value		\$114,100.00
Exempt Value	(code: HX H3)	\$50,000.00
Total Taxable Value	Cnty: \$64,100 Other: \$64,100 Schl: \$89,100	

NOTE: 2018 Working Values are NOT certified values and therefore are subject to change before being finalized for ad valorem assessment purposes.

Sales History

Show Similar Sales w ithin 1/2 mile

Sale Date	OR Book/Page	OR Code	Vacant / Improved	Qualified Sale	Sale RCode	Sale Price
10/8/2001	937/112	WD	I	Q		\$155,000.00
1/12/1995	800/1257	WD	I	Q		\$124,000.00
5/1/1978	403/623	03	I	Q		\$45,000.00

Building Characteristics

Bldg Item	Bldg Desc	Year Blt	Ext. Walls	Heated S.F.	Actual S.F.	Bldg Value
1	SINGLE FAM (000100)	1976	CONC BLOCK (15)	2022	3086	\$89,375.00

Note: All S.F. calculations are based on exterior building dimensions.

Extra Features & Out Buildings