

# CLAY ELECTRIC COOPORATIVE LAKE CITY DISTRICT OFFICE

COLUMBIA COUNTY, FLORIDA

## DEVELOPMENT INFORMATION:

1.	PROJECT OWNER:	MICHAEL FRANK MILLIKEN 2023 SW STATE ROAD 37 LAKE CITY, FLORIDA 32025
2.	CONSULTANT ENGINEER:	ENG. DENMAN & ASSOCIATES, INC. 2404 NW 43rd STREET GAINESVILLE, FL 32606 373-3541 CONTACT: SERGIO REYES, P.E.
2.	NAME OF PROJECT:	CLAY ELECTRIC COOPERATIVE LAKE CITY DISTRICT OFFICE
3.	PROJECT DESCRIPTION:	CONSTRUCTION OF AN OFFICE WAREHOUSE BUILDING WITH STORAGE FACILITIES AND ASSOCIATED PARKING, STORMWATER AND UTILITIES.
4.	PROJECT ADDRESS:	1659 SW STATE ROAD 47 LAKE CITY, FLORIDA 32025
5.	TAX PARCEL NUMBER:	18-45-17-08451-000 (PORTION OF)
6.	SECTION/TOWNSHIP/RANGE:	SECTION 18, TOWNSHIP 4 SOUTH, RANGE 17 EAST
7.	ZONING:	CI (COMMERCIAL INTENSIVE)
8.	FUTURE LAND USE:	COMMERCIAL

## DEVELOPMENT DATA:

1.	TOTAL PARCEL AREA:	30,462 ACRES	1,326,945 S.F.	100%
	TOTAL PROJECT AREA:	11.76 ACRES	512,267 S.F.	100%
	PROPOSED BUILDING AREA:			
	MAIN BUILDING:		9,653 S.F.	0.73%
	GARAGE:		1,359 S.F.	0.10%
	TOTAL BUILDING AREA:		11,011 S.F.	0.83%
	PROPOSED PAVEMENT/SIDEWALK AREA:	3.32 ACRES	144,763 S.F.	11%
	TOTAL PROPOSED IMPERVIOUS AREA:	3.57 ACRES	155,774 S.F.	12%
	TOTAL PROPOSED OPEN AREA:	26.89 ACRES	1,171,171 S.F.	88%
2.	PARKING:			
	A. CRITERIA:	COMMERCIAL/SERVICE: 1 PARKING SPACE PER 350 S.F. (MINIMUM)		
	B. REQUIRED:	9,653 S.F. X 1.0 SPACE/350 S.F. = 28 SPACES		
	C. PROPOSED:	40 SPACES INCLUDING 2 HANDICAP SPACES		

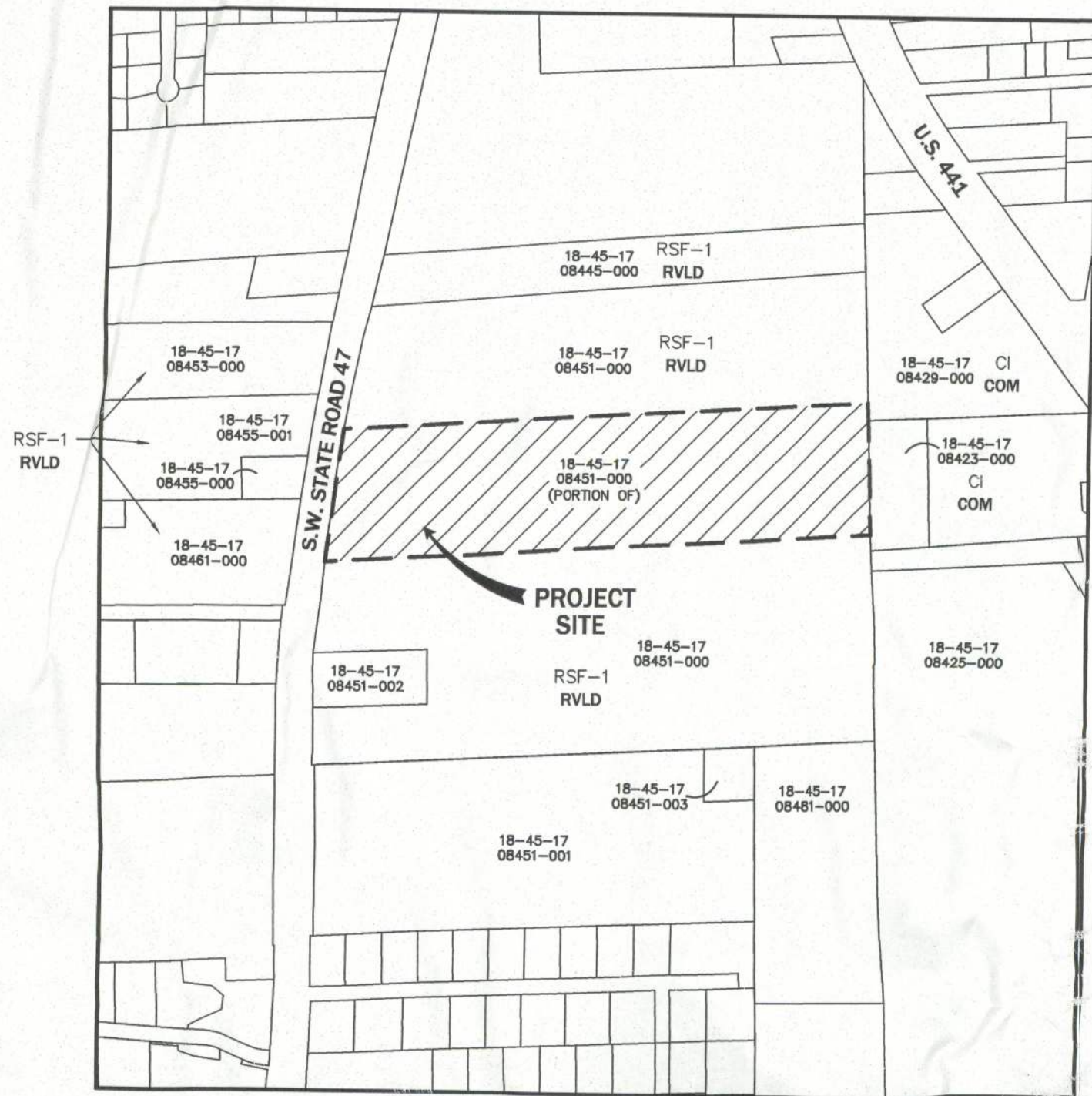

LEGEND  
ZONING:  
CI - COMMERCIAL INTENSIVE  
RSF-1 - RESIDENTIAL SINGLE FAMILY 1

FUTURE LAND USE:  
COM - COMMERCIAL INDUSTRIAL  
RVLD - RESIDENTIAL VERY LOW DENSITY

LOCATION MAP  
COLUMBIA COUNTY, FLORIDA  
NOT TO SCALE

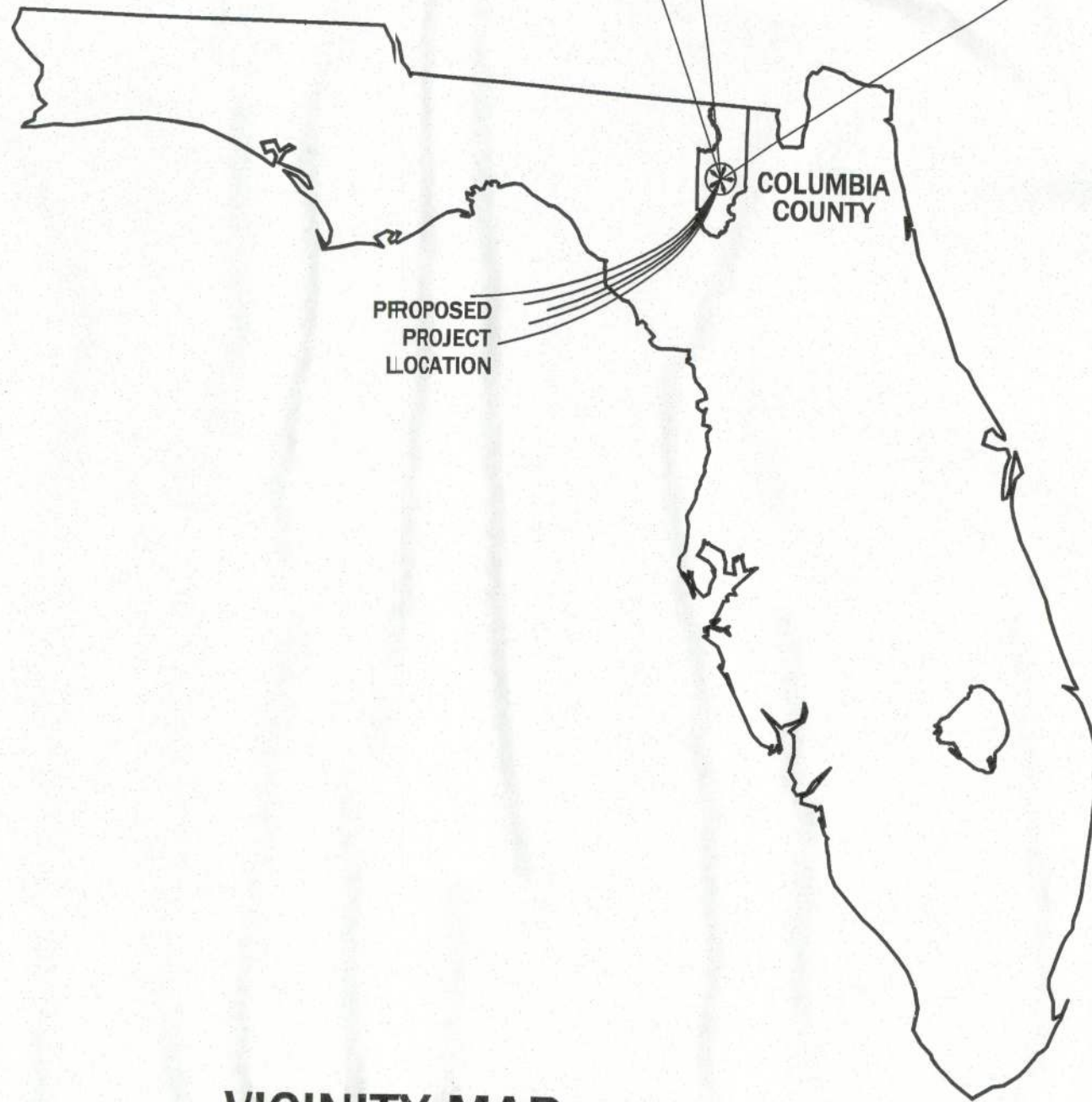

VICINITY MAP  
STATE OF FLORIDA  
N.T.S.

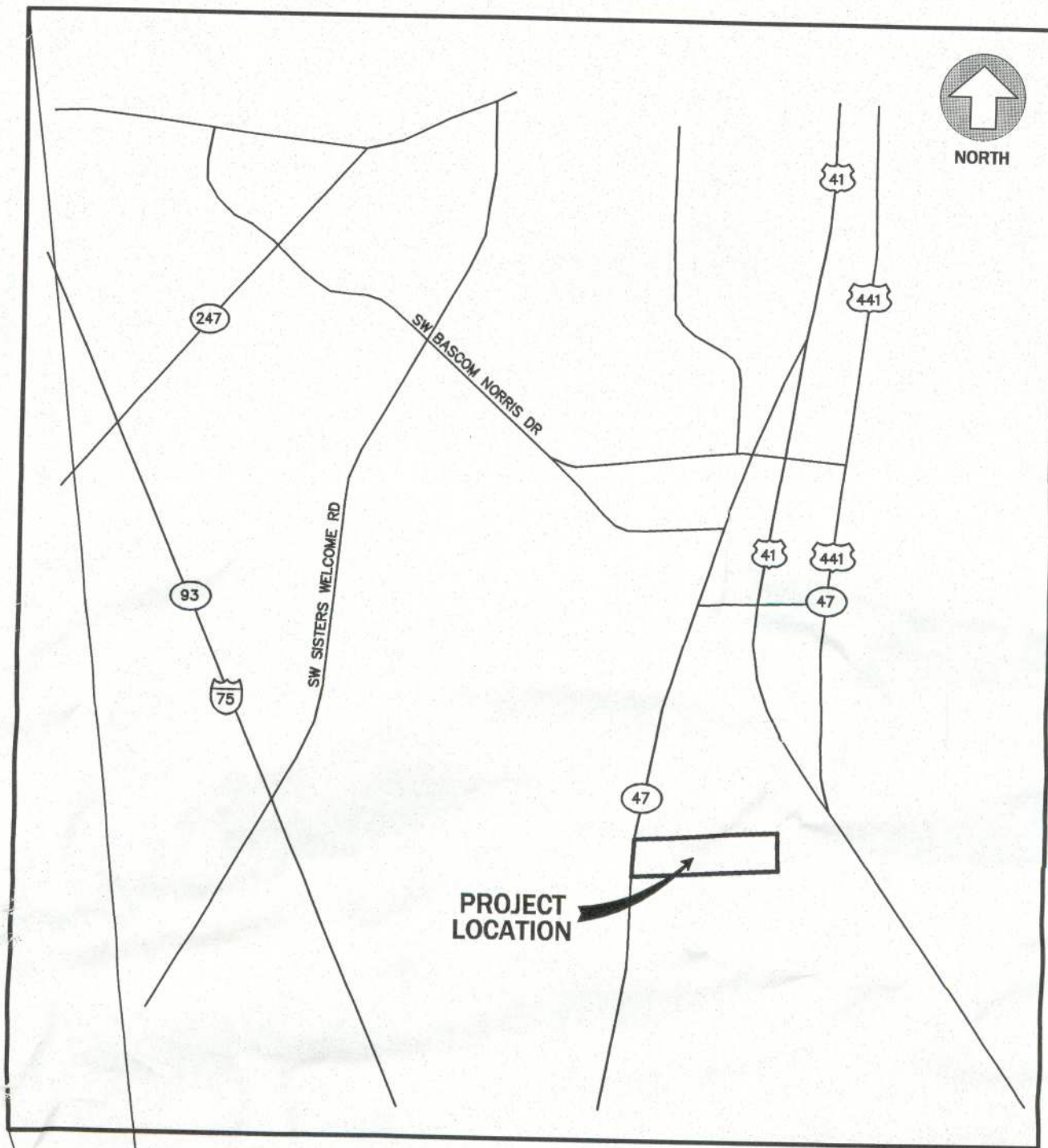

## LEGAL DESCRIPTION

A PORTION OF THE NORTHEAST QUARTER OF SECTION 18, TOWNSHIP 4 SOUTH, RANGE 17 EAST, COLUMBIA COUNTY, FLORIDA; BEING MORE PARTICULARLY DESCRIBED AS FOLLOWS:

COMMENCE AT THE NORTHEAST CORNER OF SECTION 18, TOWNSHIP 4 SOUTH, RANGE 17 EAST, COLUMBIA COUNTY, FLORIDA, AND RUN THENCE SOUTH 02°16'07" EAST, ALONG THE EAST BOUNDARY OF SAID SECTION 18, A DISTANCE OF 608.92 FEET TO THE POINT OF BEGINNING; THENCE CONTINUE SOUTH 02°16'07" EAST, ALONG SAID EAST BOUNDARY, A DISTANCE OF 600.35 FEET; THENCE SOUTH 85°46'48" WEST, PARALLEL WITH THE NORTHERLY RIGHT-OF-WAY LINE OF STATE ROAD NO. 47, SAID THENCE NORTHERLY ALONG SAID EASTERLY RIGHT-OF-WAY LINE, A DISTANCE OF 2270.59 FEET TO A POINT ON THE EASTERLY RIGHT-OF-WAY LINE OF SAID SECTION 18, A DISTANCE OF POINT LYING ON THE ARC OF A CURVE, CONCAVE EASTERLY, HAVING A RADIUS OF 6488.40 FEET; CURVE THROUGH A CENTRAL ANGLE OF 04°36'51", AN ARC DISTANCE OF 522.51 FEET TO THE END OF SAID CURVE, SAID ARC BEING SUBTENDED BY A CHORD HAVING A BEARING AND DISTANCE OF NORTH 09°16'25" EAST, 522.37 FEET; THENCE NORTH 11°34'50" EAST, ALONG SAID RIGHT-OF-WAY LINE, 95.66 FEET; THENCE NORTH 85°46'48" EAST, PARALLEL WITH SAID NORTH BOUNDARY, 2143.10 FEET TO THE POINT OF BEGINNING.

CONTAINING 30.462 ACRES (1,326,945 SQUARE FEET), MORE OR LESS.

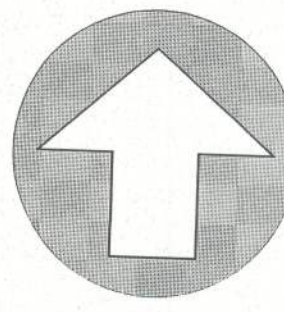

NORTH

SCALE:  
AS SHOWN

**EDA**  
ENG. DENMAN & ASSOCIATES, INC.  
ENGINEERS - SURVEYORS - PLANNERS  
2604 NW 43rd STREET, GAINESVILLE, FLORIDA 32604-6602  
TEL: (352) 336-7249 FAX: (352) 336-7249  
E-MAIL: eda@denmaneda.com

CLAY ELECTRIC COOPERATIVE  
LAKE CITY DISTRICT OFFICE  
COLUMBIA COUNTY, FLORIDA

COVER SHEET

## DRAWING INDEX

SHEET NUMBER	DRAWING TITLE
C0.00	COVER SHEET
C0.10	DEVELOPMENT PLAN
C1.00	DIMENSION PLAN
C2.00	STORMWATER PRE & POST DEVELOPMENT DRAINAGE AREAS
C3.00	PAVING, GRADING, & DRAINAGE PLAN
C3.10	STORMWATER BASIN DETAILS
C3.20	PAVING, GRADING & DRAINAGE DETAILS & NOTES
C4.00	STORMWATER POLLUTION PREVENTION PLAN
C4.10	EROSION CONTROLL DETAILS
C5.00	UTILITY PLAN
C5.10	SANITARY SYSTEM DETAILS
C5.20	UTILITY DETAILS AND NOTES
C6.00 - C6.40	STATE ROAD 47 IMPROVEMENTS
S	BOUNDARY & TOPOGRAPHIC SURVEY
LS	LANDSCAPE PLAN (BY OTHERS)

Project phase:	BID SET - ADDENDUM 1
Designed:	SR
Drawn:	TAR
Project No:	11-121
Date:	02/17/12
Professional Engineer of Record:	Sergio J. Reyes, P.E.
Engineer	47311
Certificate No.	
Sheet No.:	C0.00

C0.00

NOT FOR CONSTRUCTION