



PITMAN ENGINEERING

FINISHED FLOOR ELEVATION CERTIFICATION

For

PHELPS PETROLEUM, LOT 1, WINDSWEPT INDUSTRIAL SUBDIVISION, UNIT 6

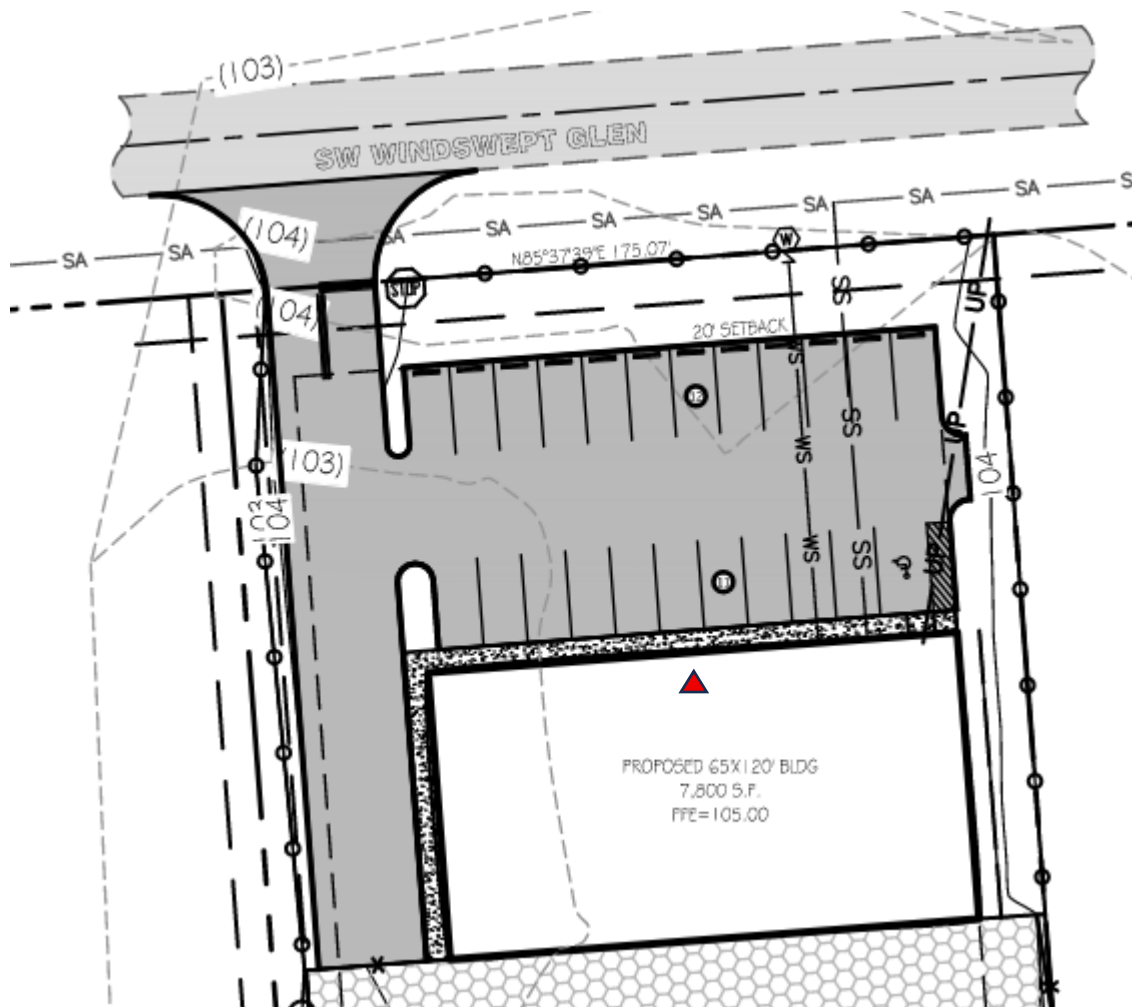

ACTUAL FIELD MEASURED FINISHED FLOOR ELEVATION = 104.83

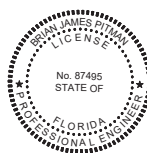

THIS DOCUMENT HAS BEEN DIGITALLY SIGNED AND
SEALED BY:

ON THE DATE ADJACENT TO THE SEAL
PRINTED COPIES OF THIS DOCUMENT ARE NOT
CONSIDERED SIGNED AND SEALED. THE
SIGNATURE MUST BE VERIFIED IN THE
ELECTRONIC DOCUMENTS.

PITMAN ENGINEERING, LLC
P.O. BOX 1238
LAKE CITY, FL 32056

THE ABOVE NAMED PROFESSIONAL ENGINEER SHALL BE RESPONSIBLE FOR THE
FOLLOWING SHEETS IN ACCORDANCE WITH RULE 61G15-23.004, F.A.C.

PO Box 1238, LAKE CITY, FL 32055 | WWW.PITMANENGINEERING.COM | 386-628-7855