

- NOTES:
1. ALL WORK IS TO COMPLY WITH ALL APPLICABLE CODES & ORDINANCES.
 2. CONSTRUCTED OF 3000 PSI CONCRETE OR EQUAL WITH #3 REBAR 12" O.C. EACH WAY, TIED AT EVERY OTHER INTERSECTION. MIN COVER FOR REBAR IS 2.5" MIN OVERLAP IS 18".
 3. POOL SHAPE IS FREE FORM, ANY SHAPE AND DIMENSIONS ARE APPROXIMATE.
 4. ASSUMED SOIL BEARING = 2 KSF
 5. CIRCULATION SYSTEMS, COMPONENTS, & EQUIPMENT SHALL COMPLY W/ NSF 50.
 6. INSTALL CONTROL JOINTS @ 20'-0" ON CENTER IN POOL DECKING.
 7. PLANS TO CONFORM TO NEC 2008
 8. FLORIDA BUILDING CODE 2010 RESIDENTIAL
 9. CONCRETE STAIRS ARE 12" TREAD WIDTH AND 10" MAXIMUM HEIGHT
 10. ALL CONSTRUCTION SHALL COMPLY WITH APSP-7, ANSI 5-03, 2008 NEC ARTICLE 680, & ANSI-NSPI 3-99 IN-GROUND SPA CONSTR.
 - *11. ENGINEERS DESIGN IS FOR STRUCTURAL ONLY. DESIGN OF PIPING/EQUIPMENT ETC. BY POOL CONTRACTOR.

- FENCE REQUIREMENTS:
1. MINIMUM 48" HEIGHT
 2. 2" MAX VERTICAL CLEARANCE BETWEEN GRADE & BARRIER BOTTOM.
 3. MAX OPENING SHALL NOT ALLOW PASSAGE OF A SPHERE
 4. FENCE POSTS WILL BE LOCATED ON POOLSIDE OF FENCE
 5. GATE WILL BE SELF-CLOSING WITH APPROVED LOCKING DEVICE

PAUL D. RIDDLE, P.E.
No. 36989, State of Florida

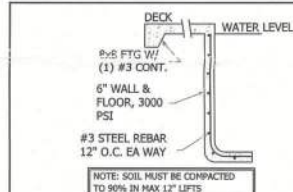

6x6 #10-10 WIRE MESH, REFER TO NEC FOR BONDING & GROUNDING REQ'MENTS

TYPICAL WALL SECTION



EQUIPOTENTIAL BONDING GRID:

ALL METAL PARTS EXPOSED IN OR ABOVE MUST BE BONDED TO AN EQUIPOTENTIAL BONDING GRID WITH A SOLID COPPER CONDUCTOR NOT SMALLER THAN 8 AWG. THE TERMINATION OF THE BONDING CONDUCTOR MUST BE MADE BY EXOTHERMIC WELDING, LISTED PRESSURE CONNECTIONS, OR LISTED CLAMPS THAT ARE LABELED AS SUITABLE FOR THE PURPOSE. THE EQUIPOTENTIAL BONDING GRID MUST EXTEND UNDER WALKING SURFACES FOR 3 FEET HORIZONTALLY FROM THE WATER (800.40(3)).

THE EQUIPOTENTIAL BONDING GRID MUST BE FORMED FROM EITHER OR BOTH OF:

THE STRUCTURAL REINFORCING STEEL OF A CONCRETE PERMANENTLY INSTALLED POOL, OUTDOOR SPA, OR OUTDOOR HOT TUB, TIED TOGETHER BY THE USUAL STEEL TIES.

THE METAL WALLS OF A PERMANENTLY INSTALLED POOL, OUTDOOR SPA, OR OUTDOOR HOT TUB

THE EQUIPOTENTIAL BONDING GRID CAN BE CONSTRUCTED WITH 8 AWG BARE SOLID COPPER CONDUCTORS BONDED TO EACH OTHER AT ALL POINTS OF CHANGES BY EXOTHERMIC WELDING, LISTED PRESSURE CONNECTIONS OF THE LISTED OR ON CONNECTION TYPE, LISTED CLAMPS, OR OTHER LISTED FITTINGS (800.41).

THE EQUIPOTENTIAL BONDING GRID MUST COVER THE ENTIRETY OF THE PERMANENTLY INSTALLED POOL, OUTDOOR SPA, OR HOT TUB AND EACH EXTENDING 1 FOOT HORIZONTALLY FROM THE WATER. THE EQUIPOTENTIAL BONDING GRID MUST BE INSTALLED IN A 1-FOOT BY 1-FOOT NETWORK OF 8 AWG CONDUCTORS, WITH A TOLERANCE OF 1/8 INCHES.

EXCEPTION: THE EQUIPOTENTIAL BONDING GRID SHALL NOT BE REQUIRED TO BE INSTALLED UNDER THE BOTTOM OF: VERTICALLY ALONG THE WALLS OF VINYL-LINED POLYMER WALL-LIBERALS COMPOSITE, OR OTHER POOLS CONSTRUCTED OF NON-CONDUCTIVE MATERIALS.

ANY METAL PARTS OF THE POOL, INCLUDING METAL STRUCTURAL SUPPORTS, SHALL BE BONDED IN ACCORDANCE WITH 800.40(3). ROUNDED CONCRETE, INSULATED CONCRETE, AND CONCRETE BLOCK SHALL BE CONSIDERED NON-CONDUCTIVE.

NOTE: IF POOL ENCLOSED ON THE ANGLE OF REPOSE STEEL SHALL BE PLACED @ 6" o.c.

Drawn By:
JASON R. RIDDLE
Drawing #:
2130326

AQUATIC ART
POOLS AND SPAS



RIDDLE CONSULTING ENGINEERS, Inc.
PAUL D. RIDDLE, P.E.

CERTIFICATE OF AUTHORIZATION: 00004759

(352) 245-7041
RiddleENG@aol.com

1720 SE CTY HWY 464
BELLEVUE, FL 34420

1/4" = 1'-0"
unless noted
otherwise

A CUSTOM POOL DESIGN FOR
THE FRAZE RESIDENCE

11/13/2013