

DATE 08/14/2009

Columbia County Building Permit  
This Permit Must Be Prominently Posted on Premises During Construction

PERMIT  
000028012

APPLICANT ROBERT MILNER PHONE 386 292-9295  
ADDRESS 931 NW SAVANNAH CIRCE LAKE CITY FL 32055  
OWNER MIKE HELVEY PHONE 754-6800  
ADDRESS 353 SW MULBERRY DR LAKE CITY FL 32024  
CONTRACTOR ROBERT MILNER PHONE 386 292-9295  
LOCATION OF PROPERTY 90W, TL ON 252B, TR ON TIMBERRIDGE DR., TL ON MULBERRY, GO  
AROUND TURN, 1ST HOUSE ON LEFT  
TYPE DEVELOPMENT SWIMMING POOL ESTIMATED COST OF CONSTRUCTION 29000.00  
HEATED FLOOR AREA TOTAL AREA HEIGHT STORIES  
FOUNDATION WALLS ROOF PITCH FLOOR  
LAND USE & ZONING RSF-2 MAX. HEIGHT  
Minimum Set Back Requirments: STREET-FRONT 25.00 REAR 15.00 SIDE 10.00  
NO. EX.D.U. 1 FLOOD ZONE N/A DEVELOPMENT PERMIT NO.

PARCEL ID 10-4S-16-02856-140 SUBDIVISION TIMBERLANDS  
LOT 40 BLOCK PHASE UNIT TOTAL ACRES 0.50

CPC1456862  
Culvert Permit No. Culvert Waiver Contractor's License Number Applicant/Owner/Contractor  
EXISTING X09-233 CS WR N  
Driveway Connection Septic Tank Number LU & Zoning checked by Approved for Issuance New Resident

COMMENTS: NOC ON FILE

Check # or Cash 1081

FOR BUILDING & ZONING DEPARTMENT ONLY

(footer/Slab)

Temporary Power Foundation Monolithic  
date/app. by date/app. by date/app. by  
Under slab rough-in plumbing Slab Sheathing/Nailing  
date/app. by date/app. by date/app. by  
Framing Insulation  
date/app. by date/app. by  
Rough-in plumbing above slab and below wood floor Electrical rough-in  
date/app. by date/app. by  
Heat & Air Duct Peri. beam (Lintel) Pool  
date/app. by date/app. by date/app. by  
Permanent power C.O. Final Culvert  
date/app. by date/app. by date/app. by  
Pump pole Utility Pole M/H tie downs, blocking, electricity and plumbing  
date/app. by date/app. by date/app. by  
Reconnection RV Re-roof  
date/app. by date/app. by date/app. by

BUILDING PERMIT FEE \$ 145.00 CERTIFICATION FEE \$ 0.00 SURCHARGE FEE \$ 0.00  
MISC. FEES \$ 0.00 ZONING CERT. FEE \$ 50.00 FIRE FEE \$ 0.00 WASTE FEE \$  
FLOOD DEVELOPMENT FEE \$ FLOOD ZONE FEE \$ CULVERT FEE \$ TOTAL FEE 195.00  
INSPECTORS OFFICE CLERKS OFFICE

NOTICE: IN ADDITION TO THE REQUIREMENTS OF THIS PERMIT, THERE MAY BE ADDITIONAL RESTRICTIONS APPLICABLE TO THIS PROPERTY THAT MAY BE FOUND IN THE PUBLIC RECORDS OF THIS COUNTY. AND THERE MAY BE ADDITIONAL PERMITS REQUIRED FROM OTHER GOVERNMENTAL ENTITIES SUCH AS WATER MANAGEMENT DISTRICTS, STATE AGENCIES, OR FEDERAL AGENCIES.

"WARNING TO OWNER: YOUR FAILURE TO RECORD A NOTICE OF COMMENCEMENT MAY RESULT IN YOUR PAYING TWICE FOR IMPROVEMENTS TO YOUR PROPERTY. IF YOU INTEND TO OBTAIN FINANCING, CONSULT WITH YOUR LENDER OR AN ATTORNEY BEFORE RECORDING YOUR NOTICE OF COMMENCEMENT."

EVERY PERMIT ISSUED SHALL BECOME INVALID UNLESS THE WORK AUTHORIZED BY SUCH PERMIT IS COMMENCED WITHIN 180 DAYS AFTER ITS ISSUANCE, OR IF THE WORK AUTHORIZED BY SUCH PERMIT IS SUSPENDED OR ABANDONED FOR A PERIOD OF 180 DAYS AFTER THE TIME THE WORK IS COMMENCED. A VALID PERMIT RECIEVES AN APPROVED INSPECTION EVERY 180 DAYS. WORK SHALL BE CONSIDERED NOT SUSPENDED, ABANDONED OR INVALID WHEN THE PERMIT HAS RECIEVED AN APPROVED INSPECTION WITHIN 180 DAYS OT THE PREVIOUS INSPECTION.

The Issuance of this Permit Does Not Waive Compliance by Permittee with Deed Restrictions.

313,540.00

Prepared by and Return to:  
Steel City Title, Inc.  
Reta Brown  
851 Trafalgar Ct.  
Ste. 132E  
Maitland, FL 32751  
File Number: SCT08-702

Inst:200912001343 Date:1/28/2009 Time:2:18 PM  
Doc Stamp-Deed:1495.20  
DC.P.DeWitt Cason,Columbia County Page 1 of 1 B:1166 P:384

**SPECIAL WARRANTY DEED**  
(Corporate Seller)

THIS INDENTURE, made this 26TH day of JANUARY, 2009, between MARONDA HOMES, INC. OF FLORIDA, A FLORIDA CORPORATION, a corporation existing under laws of the STATE of FLORIDA, whose mailing address is: 6800 SOUTHPOINT PKWY. STE. 300 JACKSONVILLE, FLORIDA 32216, hereinafter called the grantor, to ROBERT M. HELVEY, AND TRECY D. HELVEY, HUSBAND AND WIFE, whose mailing address is: 353 SW MULBERRY DR., LAKE CITY, FLORIDA 32024, hereinafter called the grantee:

(Whenever used herein the term "grantor" and "grantee" include all the parties to this instrument and the heirs, legal representatives and assigns of individuals, and the successors and assigns of corporations)

Witnesseth, that the grantor, for and in consideration of the sum of TEN AND NO/100 DOLLARS (\$10.00) and other valuable considerations, receipt whereof is hereby acknowledged, hereby grants, bargains, sells, aliens, remises, releases, conveys and confirms unto the grantee, all that certain land situate in Columbia County, Florida, viz:

Lot 40, Timberlands Phase 1, according to map or plat thereof as recorded in Plat Book 9, Pages 26 and 27, of the Public Records of Columbia County, Florida.

Parcel Identification Number: R02856-140

Subject, however, to the taxes for the current year, all covenants, conditions, restrictions, reservations, limitations, easements and to all applicable zoning ordinances and/or restrictions and prohibitions imposed by governmental authorities, if any.

TOGETHER with all the tenements, hereditaments and appurtenances thereto belonging or in anywise appertaining thereto.

TO HAVE AND TO HOLD the same in fee simple forever.

And the grantor hereby covenants with said grantee that it is lawfully seized of said land in fee simple; that it has good right and lawful authority to sell and convey said land; that it hereby full warrants the title to said land and will defend the same against the lawful claims of all persons claiming by through or under the said grantor.

In Witness Whereof, the said grantor has signed and sealed these presents the day and year first above written.

Signed, sealed and delivered  
in the presence of:

  
Witness signature

Reta M. Brown  
Print witness name

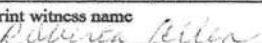
  
Witness signature

Robert M. Helvey  
Print witness name

Print witness name

State of FLORIDA  
County of Duval

THE FOREGOING INSTRUMENT was acknowledged before me this 26 day of January, 2009 by STEVEN R. HOGG, known to me to be the VICE-PRESIDENT of MARONDA HOMES, INC. OF FLORIDA, A FLORIDA CORPORATION who is personally known to me or who has produced \_\_\_\_\_ as identification.

MARONDA HOMES, INC. OF FLORIDA, A FLORIDA CORPORATION

By:   
Print Name: STEVEN R. HOGG  
Title: VICE-PRESIDENT

(Corporate Seal)

NOTARY PUBLIC-STATE OF FLORIDA  
 Reta M. Brown  
Commission #DD476403  
Expires: SEP 27, 2009  
Bonded Thru Atlantic Bonding Co., Inc.

  
Notary Public  
Reta M. Brown  
Print Notary Name  
My Commission Expires: 9/27/09  
Notary Seal



## Columbia County Building Permit Application

For Office Use Only Application # 0908-09 Date Received 8/11 By JW Permit # 28012  
 Zoning Official ays Date 8/14/09 Flood Zone N/A Land Use RLD Zoning RSF2  
 FEMA Map # \_\_\_\_\_ Elevation \_\_\_\_\_ MFE \_\_\_\_\_ River \_\_\_\_\_ Plans Examiner (WV) Date 8/13/09  
 Comments \_\_\_\_\_  
☒ NOC ☐ EH ☒ Deed or PA ☐ Site Plan ☐ State Road Info ☐ Parent Parcel # \_\_\_\_\_  
☐ Dev Permit # \_\_\_\_\_ ☐ In Floodway ☐ Letter of Auth. from Contractor ☐ F W Comp. letter  
 IMPACT FEES: EMS \_\_\_\_\_ Fire \_\_\_\_\_ Corr \_\_\_\_\_ Road/Code \_\_\_\_\_  
 School \_\_\_\_\_ = TOTAL 0

Septic Permit No. X-09-233 in File Box Fax (386) 755-9860  
 Name Authorized Person Signing Permit Robert Milner Phone (386) 292-9295  
 Address 931 N.W. Savannah Cir Lake City, FL 32055  
 Owners Name Mike Helvey Phone (386) 754-6800  
 911 Address 353 S.W. MULBERRY DR LAKE CITY, FL 32064  
 Contractors Name Robert Milner / OUTBACK Pools + Waterfalls INC Phone 386 292-9295  
 Address 931 N.W. Savannah Circle Lake City, FL 32055  
 Fee Simple Owner Name & Address Mike Helvey 353 S.W. Mulberry Dr. Lake City, FL  
 Bonding Co. Name & Address N/A  
 Architect/Engineer Name & Address PE# 57216 WAYNE BENNETT 265 S. FED. HWY., DEERFIELD BCH, FL 33441  
 Mortgage Lenders Name & Address CHASE MTG. P.O. Box 9001871 Louisville Ky 40290-1871  
1-800 849 9136  
 Circle the correct power company - FL Power & Light - Clay Elec. - Suwannee Valley Elec. - Progress Energy  
 Property ID Number 10-45-16-02856-140 Estimated Cost of Construction \$29,000.00  
 Subdivision Name Timberlands Lot 40 Block \_\_\_\_\_ Unit \_\_\_\_\_ Phase 1  
 Driving Directions HWY 90 WEST PAST I-75 to 252-B Left, to Right  
turn onto Timberridgedr, Just Before 247 then left on Mulberry,  
ground turn to 1st house on Right Number of Existing Dwellings on Property 1

Construction of Concrete Swimming Pool Total Acreage 1/2 AC. Lot Size \_\_\_\_\_  
 Do you need a - Culvert Permit or Culvert Waiver or Have an Existing Drive Total Building Height \_\_\_\_\_  
 Actual Distance of Structure from Property Lines - Front 170' Side 30'-6" Side 27'-1" Rear 29'-10"  
 Number of Stories 1 Heated Floor Area \_\_\_\_\_ Total Floor Area \_\_\_\_\_ Roof Pitch \_\_\_\_\_

Application is hereby made to obtain a permit to do work and installations as indicated. I certify that no work or installation has commenced prior to the issuance of a permit and that all work be performed to meet the standards of all laws regulating construction in this jurisdiction.

Spoke to  
Robert 8/14/09



**TIME LIMITATIONS OF APPLICATION :** An application for a permit for any proposed work shall be deemed to have been abandoned 180 days after the date of filing, unless such application has been pursued in good faith or a permit has been issued; except that the building official is authorized to grant one or more extensions of time for additional periods not exceeding 90 days each. The extension shall be requested in writing and justifiable cause demonstrated.

**TIME LIMITATIONS OF PERMITS:** Every permit issued shall become invalid unless the work authorized by such permit is commenced within 180 days after its issuance, or if the work authorized by such permit is suspended or abandoned for a period of 180 days after the time work is commenced. A valid permit receives an approved inspection every 180 days. Work shall be considered not suspended, abandoned or invalid when the permit has received an approved inspection within 180 days of the previous approved inspection.

**FLORIDA'S CONSTRUCTION LIEN LAW: Protect Yourself and Your Investment:** According to Florida Law, those who work on your property or provide materials, and are not paid-in-full, have a right to enforce their claim for payment against your property. This claim is known as a construction lien. If your contractor fails to pay subcontractors or material suppliers or neglects to make other legally required payments, the people who are owed money may look to your property for payment, even if you have paid your contractor in full. This means if a lien is filed against your property, it could be sold against your will to pay for labor, materials or other services which your contractor may have failed to pay.

**NOTICE OF RESPONSIBILITY TO BUILDING PERMITEE:** YOU ARE HEREBY NOTIFIED as the recipient of a building permit from Columbia County, Florida, you will be held responsible to the County for any damage to sidewalks and/or road curbs and gutters, concrete features and structures, together with damage to drainage facilities, removal of sod, major changes to lot grades that result in ponding of water, or other damage to roadway and other public infrastructure facilities caused by you or your contractor, subcontractors, agents or representatives in the construction and/or improvement of the building and lot for which this permit is issued. No certificate of occupancy will be issued until all corrective work to these public infrastructures and facilities has been corrected.

**WARNING TO OWNER:** YOUR FAILURE TO RECORD A NOTICE OF COMMENCEMENT MAY RESULT IN YOU PAYING TWICE FOR IMPROVEMENTS TO YOUR PROPERTY. A NOTICE OF COMMENCEMENT MUST BE RECORDED AND POSTED ON THE JOB SITE BEFORE THE FIRST INSPECTION. IF YOU INTEND TO OBTAIN FINANCING, CONSULT WITH YOUR LENDER OR ATTORNEY BEFORE RECORDING YOUR NOTICE OF COMMENCEMENT.

**OWNERS CERTIFICATION:** I hereby certify that all the foregoing information is accurate and all work will be done in compliance with all applicable laws and regulating construction and zoning. I further understand the above written responsibilities in Columbia County for obtaining this Building Permit.

  
Owners Signature

**CONTRACTORS AFFIDAVIT:** By my signature I understand and agree that I have informed and provided this written statement to the owner of all the above written responsibilities in Columbia County for obtaining this Building Permit including all application and permit time limitations.

  
Contractor's Signature (Permitee)

Contractor's License Number C.P.C. 1456862  
Columbia County  
Competency Card Number \_\_\_\_\_

Affirmed under penalty of perjury to by the Contractor and subscribed before me this 11<sup>th</sup> day of August 2009.  
Personally known \_\_\_\_\_ or Produced Identification DL

  
State of Florida Notary Signature (For the Contractor)

SEAL:







# COLUMBIA COUNTY BUILDING DEPARTMENT

135 NE Hernando Ave., Suite B-21  
Lake City, FL 32055  
Office: 386-758-1008 Fax: 386-758-2160

Application Number \_\_\_\_\_

## NOTICE TO SWIMMING POOL OWNERS

I Mike Helvey have been informed and I understand that prior to the final inspection approval and use of my pool, I will need all the inspections approved and the required fencing installed in accordance with applicable regulations. The Florida Building Code Chapter 4 Section 24 requires private residential swimming pools, hot tubs, or non-portable spas containing water over 24 inches deep to meet the following pool barrier safety feature requirements:

- The pool access must be isolated by a barrier at least 4 feet high and installed around the perimeter of the pool. Unless the pool is equipped with a safety cover complying with the specifications of American Society for Testing and Materials standard F-1346-91.
- The barrier shall not have any gaps or openings which would allow a child to crawl under, squeeze through or climb over and must be placed no less than 20 inches from the water's edge.
- Gates located in the pool barrier must open outward away from the pool and be both self-closing and self latching, with a release mechanism not less than 54" above the standing surface at the gate.
- The barrier must be separate from any other fence, wall, or other enclosure surrounding the yard unless the fence, wall or other enclosure or portion thereof is situated on the perimeter of the pool and meets the pool barrier requirements.
- Where a wall of a dwelling serves as part of the barrier **one** of the following shall apply:
  - 1) All doors and first floor windows with a sill height of less than 48 inches providing direct access from the home to the pool must be equipped with an alarm that has a minimum sound pressure rating of 85 decibels at 10 feet. The alarm shall sound immediately upon opening the window or door unless the temporary bypass mechanism is activated.
  - 2) **Or;** all doors providing direct access from the home to the pool must be equipped with a self-closing, self-latching device with a release mechanism located at least 54 inches above the floor.

According to Florida statutes, failure to comply with these requirements is a misdemeanor of the second degree, punishable by imprisonment for up to 60 days or a fine of up to \$500, except that no penalty shall be imposed if within 45 days after arrest or issuance of a summons or notice to appear, the pool is equipped with the aforementioned safety features and the responsible person attends a drowning prevention education program developed by the Florida Department of Health. I also understand that there are several inspections required in addition to a final inspection for my swimming pool.

Mike Helvey  
Owner Signature Date

Address: 353 S.W. MALBERRY DR., Lake City, FL 32024

Raketa Milner 8/4/09  
Contractor Signature / Date

C.P.C. 1456862  
License Number



## COLUMBIA COUNTY BUILDING DEPARTMENT

135 NE Hernando Ave., Suite B-21

Lake City, FL 32055

Office: 386-758-1008 Fax: 386-758-2160

### SWIMMING POOL MINIMUM PLAN REQUIREMENTS AND CHECKLIST FOR FLORIDA BUILDING CODE 2004

REQUIREMENTS FOR SITE BUILT POOLS. (2 Sets of plans with engineering is required to be submitted for each permit.)

- ☒ 1. Site-Plan showing the location of the pool and the distance from each property line, include structures and the distance from the pool.
- ☒ 2. Reinforcement, thickness and type concrete, depth limits, details of built in steps, footings on decks, for both pools and hot tubs or whirlpools.
- ☒ 3. Piping detail for drains, suction inlet locations, skimmers and re-circulation lines.
- ☒ 4. Entrapment protection device. (Manufacturer and Model)
- ☒ 5. Back-up vacuum relief device or means.
  - A. Approved vacuum release system. (Manufacturer and Model)
  - B. Approved vent piping.
  - C. Other approved devices or means.
- ☒ 6. Diameter and depths of proposed pool relative to adjacent foundations of other structures and any retaining walls and/or finished grades and slopes. If pool falls in the angle of repose of any existing foundation, additional engineering shall be provided indicating how the foundation shall be maintained.
- ☐ 7. Distance of any glass adjacent to the pool edge and distance from walking surface to bottom edge of glass. (As per FBC 2004 section 2405.2 any glass within 60" of the waters edge and within 60" of the walking surface on the pool side of the glazing shall be tempered.)
- ☒ 8. All accessories to the pool such as ladders, slides, diving boards etc. that are proposed.
- ☒ 9. Location of existing electrical outlets and fixtures and the proposed receptacle within the pool area.
- ☐ 10. Location and type of all proposed pool equipment, electric and gas service.
- ☐ 11. Will pool or spa have a heater and will it be gas or electric? (If gas provide layout and sizing of gas lines.)
- ☐ 12. Show detail of how POOL BARRIER REQUIREMENTS, FBC Section 424.2.17, shall be met on this specific pool.
- ☒ 13. NOTICE TO SWIMMING POOL OWNERS - Include this form signed by the owner and the contractor.

#### REQUIRED INSPECTIONS:

GROUND: Set-backs from property lines, distance from existing foundations, pool shell structure, bonding of all metal parts, electrical rough-in, main drains and associated piping, distance to glazing.

DECK: Slab reinforcement and deck drains, bonding of all metal equipment and parts, lighting, including potting compound, electrical deck box, suction and return piping under minimum pressure test.

FINAL: Location and installation of all equipment, Barrier requirements as per plan, Electrical receptacles and finished electric hook-ups, Completed piping and valve system. Gas heaters installed and connected to gas lines (if applicable).



AFTER RECORDING - RETURN TO:

**OUTBACK POOLS**  
**931 SAVANNAH CIRCLE**  
**LAKE CITY, FL 32055**

PERMIT NUMBER:

Inst: 200912013354 Date: 8/11/2009 Time: 11:12 AM  
 DC, P. DeWitt Cason, Columbia County Page 1 of 1 B 1178 P 2212

**NOTICE OF COMMENCEMENT**

The undersigned hereby given notice that improvement will be made to certain real property, and in accordance with Chapter 713, Florida Statutes the following information is provided in the Notice of Commencement.

1. DESCRIPTION OF PROPERTY (Legal description and street address, if available) TAX FOLIO NUMBER: 10-45-16-02856-140  
 SUBDIVISION Timberlands Phase I BLOCK 9 TRACT 26+27 LOT 40 BLDG --- UNIT ---  
353 S.W. MULBERRY DR. LAKE CITY, FL. 32024

2. GENERAL DESCRIPTION OF IMPROVEMENT:  
CONSTRUCTION of new concrete swimming pool, deck & HEATER

3. OWNER INFORMATION: a. Name Robert M. Helvey  
 b. Address 353 S.W. MULBERRY DR. Lake City, FL. 32064 c. Interest in property owner  
 d. Name and address of fee simple titleholder (if other than Owner)

4. CONTRACTOR'S NAME, ADDRESS AND PHONE NUMBER:  
Robert A. Milner / OUTBACK Pools & Waterfalls, Inc (386) 272-9295  
931 N.W. Savannah Circle, Lake City, FL. 32055

5. SURETY'S NAME, ADDRESS AND PHONE NUMBER AND BOND AMOUNT:  
N/A

6. LENDER'S NAME, ADDRESS AND PHONE NUMBER:  
CHASE MFG. P.O. Box 9001871 Louisville, Ky. 40290-1871 1-800-849-9136

7. Persons within the State of Florida designated by Owner upon whom notices or other documents may be served as provided by Section 713.13 (1) (a) 7., Florida Statutes:  
 NAME, ADDRESS AND PHONE NUMBER:  
N/A

8. In addition to himself or herself, Owner designates the following to receive a copy of the Lienor's Notice as provided in Section 713.13 (1) (b), Florida Statutes:  
 NAME, ADDRESS AND PHONE NUMBER:  
N/A

9. Expiration date of notice of commencement (the expiration date is 1 year from the date of recording unless a different date is specified):       , 20

**WARNING TO OWNER: ANY PAYMENTS MADE BY THE OWNER AFTER THE EXPIRATION OF THE NOTICE OF COMMENCEMENT ARE CONSIDERED IMPROPER PAYMENTS UNDER CHAPTER 713, PART I, SECTION 713.13, FLORIDA STATUTES, AND CAN RESULT IN YOUR PAYING TWICE FOR IMPROVEMENTS TO YOUR PROPERTY. A NOTICE OF COMMENCEMENT MUST BE RECORDED AND POSTED ON THE JOB SITE BEFORE THE FIRST INSPECTION. IF YOU INTEND TO OBTAIN FINANCING, CONSULT WITH YOUR LENDER OR AN ATTORNEY BEFORE COMMENCING WORK OR RECORDING YOUR NOTICE OF COMMENCEMENT.**

Robert M. Helvey  
 Signature of Owner or  
 Owner's Authorized Officer/Director/Partner/Manager

ROBERT M. HELVEY  
 Print Name and Provide Signatory's Title/Office

State of Florida  
 County of Palm Beach

The foregoing instrument was acknowledged before me this 7<sup>TH</sup> day of AUG., 20 09

By Robert M. Helvey, as OWNER  
 (name of person) (type of authority,....c.g. officer, trustee, attorney in fact)  
 For OUTBACK POOLS & WATERFALLS, INC.  
 (name of party on behalf of whom instrument was executed)

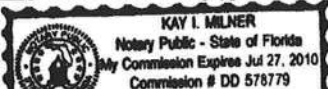
Personally known or ☒ produced the following type of identification: D.L.  
  
Kay I. Milner  
 (Signature of Notary Public)

Under Penalties of perjury, I declare that I have read the foregoing and that the facts in it are true to the best of my knowledge and belief (Section 92.525, Florida Statutes).

Signature(s) of Owner(s) or Owner(s)' Authorized Officer/ Director / Partner/Manager who signed above:

By Robert M. Helvey By ---

LT 40, THEREAFTER PAGES 1, 2, 3, 4, 5, 6, 7, 8, 9, 10, 11, 12, 13, 14, 15, 16, 17, 18, 19, 20, 21, 22, 23, 24, 25, 26, 27, 28, 29, 30, 31, 32, 33, 34, 35, 36, 37, 38, 39, 40, 41, 42, 43, 44, 45, 46, 47, 48, 49, 50, 51, 52, 53, 54, 55, 56, 57, 58, 59, 60, 61, 62, 63, 64, 65, 66, 67, 68, 69, 70, 71, 72, 73, 74, 75, 76, 77, 78, 79, 80, 81, 82, 83, 84, 85, 86, 87, 88, 89, 90, 91, 92, 93, 94, 95, 96, 97, 98, 99, 100, 101, 102, 103, 104, 105, 106, 107, 108, 109, 110, 111, 112, 113, 114, 115, 116, 117, 118, 119, 120, 121, 122, 123, 124, 125, 126, 127, 128, 129, 130, 131, 132, 133, 134, 135, 136, 137, 138, 139, 140, 141, 142, 143, 144, 145, 146, 147, 148, 149, 150, 151, 152, 153, 154, 155, 156, 157, 158, 159, 160, 161, 162, 163, 164, 165, 166, 167, 168, 169, 170, 171, 172, 173, 174, 175, 176, 177, 178, 179, 180, 181, 182, 183, 184, 185, 186, 187, 188, 189, 190, 191, 192, 193, 194, 195, 196, 197, 198, 199, 200, 201, 202, 203, 204, 205, 206, 207, 208, 209, 210, 211, 212, 213, 214, 215, 216, 217, 218, 219, 220, 221, 222, 223, 224, 225, 226, 227, 228, 229, 230, 231, 232, 233, 234, 235, 236, 237, 238, 239, 240, 241, 242, 243, 244, 245, 246, 247, 248, 249, 250, 251, 252, 253, 254, 255, 256, 257, 258, 259, 260, 261, 262, 263, 264, 265, 266, 267, 268, 269, 270, 271, 272, 273, 274, 275, 276, 277, 278, 279, 280, 281, 282, 283, 284, 285, 286, 287, 288, 289, 290, 291, 292, 293, 294, 295, 296, 297, 298, 299, 300, 301, 302, 303, 304, 305, 306, 307, 308, 309, 310, 311, 312, 313, 314, 315, 316, 317, 318, 319, 320, 321, 322, 323, 324, 325, 326, 327, 328, 329, 330, 331, 332, 333, 334, 335, 336, 337, 338, 339, 340, 341, 342, 343, 344, 345, 346, 347, 348, 349, 350, 351, 352, 353, 354, 355, 356, 357, 358, 359, 360, 361, 362, 363, 364, 365, 366, 367, 368, 369, 370, 371, 372, 373, 374, 375, 376, 377, 378, 379, 380, 381, 382, 383, 384, 385, 386, 387, 388, 389, 390, 391, 392, 393, 394, 395, 396, 397, 398, 399, 400, 401, 402, 403, 404, 405, 406, 407, 408, 409, 410, 411, 412, 413, 414, 415, 416, 417, 418, 419, 420, 421, 422, 423, 424, 425, 426, 427, 428, 429, 430, 431, 432, 433, 434, 435, 436, 437, 438, 439, 440, 441, 442, 443, 444, 445, 446, 447, 448, 449, 450, 451, 452, 453, 454, 455, 456, 457, 458, 459, 460, 461, 462, 463, 464, 465, 466, 467, 468, 469, 470, 471, 472, 473, 474, 475, 476, 477, 478, 479, 480, 481, 482, 483, 484, 485, 486, 487, 488, 489, 490, 491, 492, 493, 494, 495, 496, 497, 498, 499, 500, 501, 502, 503, 504, 505, 506, 507, 508, 509, 510, 511, 512, 513, 514, 515, 516, 517, 518, 519, 520, 521, 522, 523, 524, 525, 526, 527, 528, 529, 530, 531, 532, 533, 534, 535, 536, 537, 538, 539, 540, 541, 542, 543, 544, 545, 546, 547, 548, 549, 550, 551, 552, 553, 554, 555, 556, 557, 558, 559, 560, 561, 562, 563, 564, 565, 566, 567, 568, 569, 570, 571, 572, 573, 574, 575, 576, 577, 578, 579, 580, 581, 582, 583, 584, 585, 586, 587, 588, 589, 590, 591, 592, 593, 594, 595, 596, 597, 598, 599, 600, 601, 602, 603, 604, 605, 606, 607, 608, 609, 610, 611, 612, 613, 614, 615, 616, 617, 618, 619, 620, 621, 622, 623, 624, 625, 626, 627, 628, 629, 630, 631, 632, 633, 634, 635, 636, 637, 638, 639, 640, 641, 642, 643, 644, 645, 646, 647, 648, 649, 650, 651, 652, 653, 654, 655, 656, 657, 658, 659, 660, 661, 662, 663, 664, 665, 666, 667, 668, 669, 670, 671, 672, 673, 674, 675, 676, 677, 678, 679, 680, 681, 682, 683, 684, 685, 686, 687, 688, 689, 690, 691, 692, 693, 694, 695, 696, 697, 698, 699, 700, 701, 702, 703, 704, 705, 706, 707, 708, 709, 710, 711, 712, 713, 714, 715, 716, 717, 718, 719, 720, 721, 722, 723, 724, 725, 726, 727, 728, 729, 730, 731, 732, 733, 734, 735, 736, 737, 738, 739, 740, 741, 742, 743, 744, 745, 746, 747, 748, 749, 750, 751, 752, 753, 754, 755, 756, 757, 758, 759, 760, 761, 762, 763, 764, 765, 766, 767, 768, 769, 770, 771, 772, 773, 774, 775, 776, 777, 778, 779, 780, 781, 782, 783, 784, 785, 786, 787, 788, 789, 790, 791, 792, 793, 794, 795, 796, 797, 798, 799, 800, 801, 802, 803, 804, 805, 806, 807, 808, 809, 810, 811, 812, 813, 814, 815, 816, 817, 818, 819, 820, 821, 822, 823, 824, 825, 826, 827, 828, 829, 830, 831, 832, 833, 834, 835, 836, 837, 838, 8



IN SECTION 10, TOWNSHIP 4 SOUTH, RANGE  
16 EAST, COLUMBIA COUNTY, FLORIDA

[illegible][illegible]

ELIZABETH HARRISON AND HERBIE WATKINS, A BROTHER-SISTER SET, WERE THE FIRST TO BE KNOWN TO LIVE IN THIS NEIGHBORHOOD OF D.C. CITY. THEIR HOUSE WAS BUILT IN 1915 BY THE BROTHER OF JOHN R. HARRISON, A FUGITIVE SLAVE.

[illegible]

13. In the matter of SELENIUM, YOUNG AND CO  
INCORPORATED, SELENIUM (the person  
 executing the deed of assignment) was  
 an officer in the NAVY.

1. 在下列各句的空格内填上适当的词。

IN AN EFFORT TO PROTECT THE PUBLIC FROM THE CONSUMPTION OF CONTAMINATED FOOD, THE U.S. DEPARTMENT OF AGRICULTURE HAS ISSUED THE FOLLOWING ORDER:

ONLINE JOURNAL OF THE AMERICAN COLLEGE OF NUTRITION

IF ANYONE COULD BE ACHIEVING SHOULD BE CONTACTED FOR THE CRYSTAL PAPER FOR PAPER 13.

of the Bill of 1940 there were 300-400 men

Q NEEDS TO "COUNTERACT" CONSUMER HATE FOR BEER

**Blackberry** *Rubus fruticosus* L.

## FLUDD NOTES

## TRADE NOTICE

# STATEMENT OF SURVIVORS

FOR WOULD BE HELD IN EXAMINATION THE CIVILIAN POWER OF A  
A FURTHER INVESTIGATION BY THE OFFICE OF THE ATTORNEY GENERAL  
ON THE PART OF THE CIVILIAN POWER OF THE ATTORNEY GENERAL

[illegible]

Page 119/122

# THE UNIVERSITY OF MICHIGAN

1457 W. 10th Avenue, Suite 200, Denver, CO 80202  
Phone: (303) 733-7700

.....

THE MICHIGAN N. GUILTY SERVICE

[illegible]

RECEIVED ON 12/24/2001 FILED FOR MR. HARTZ

18-  
MEMBER

10



NOTE:  
BASED ON OUR EXPERIENCE WITH OTHER POOL PROJECTS IN THIS AREA THE BEARING CAPACITY IS 2000 PSF. IF OTHER CONDITIONS ARE FOUND AT EXCAVATION THE POOL CONTRACTOR MUST NOTIFY ENGINEER IMMEDIATELY.

NOTES:  
-ALL DECKS ARE MEASURED FROM WATERLINE OF POOL TO EDGE OF DECK  
-DIVING EQUIPMENT ABSOLUTELY PROHIBITED  
-VAC LINE TO HAVE VAC LOCK

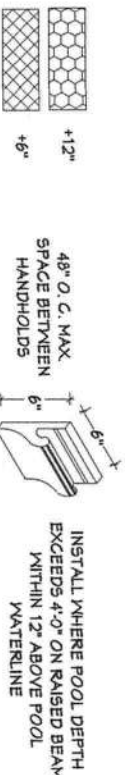
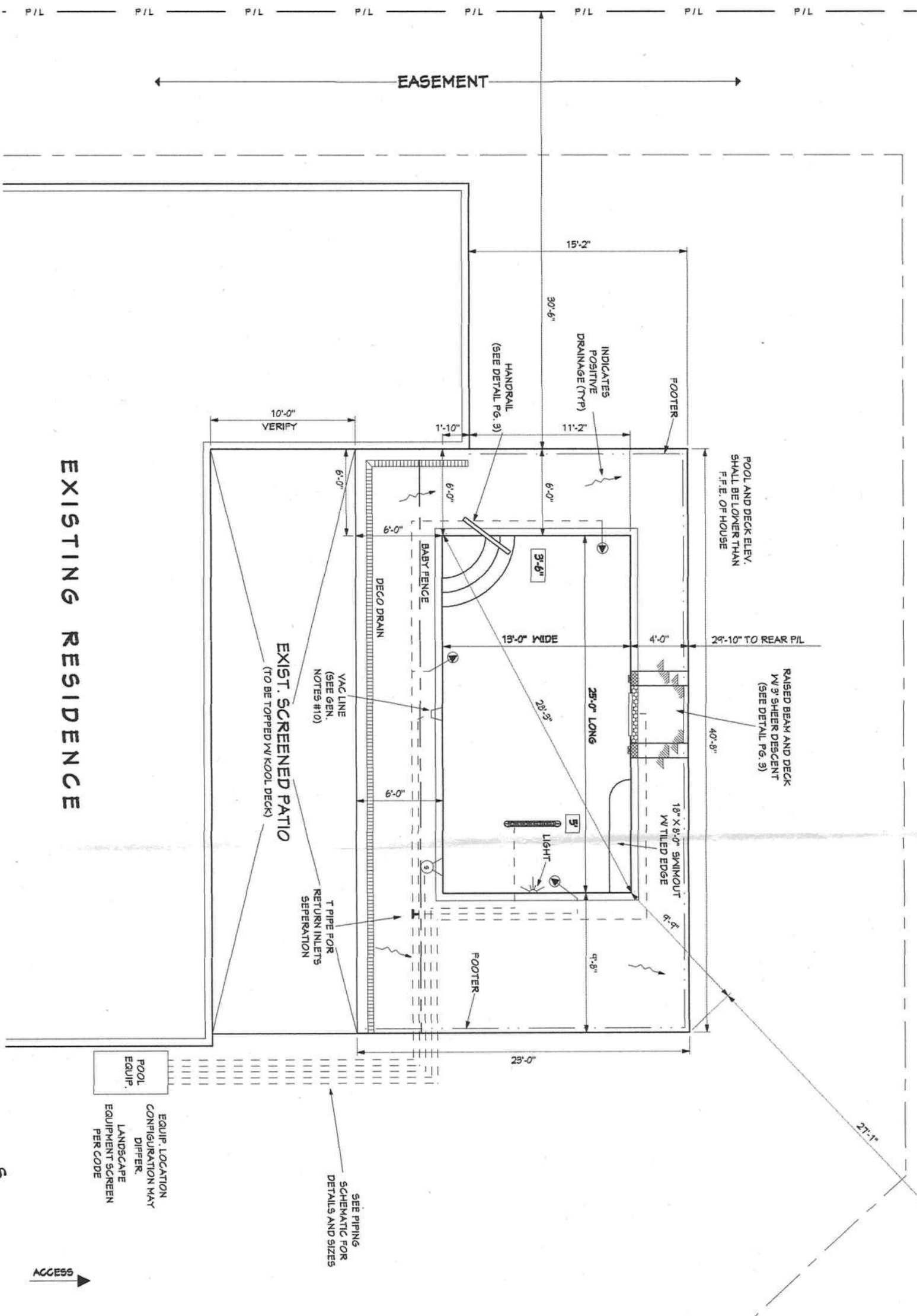

EXISTING RESIDENCE

POOL PLAN

SCALE 1/8" = 1'-0"



EQUIP. LOCATION  
CONFIGURATION MAY  
DIFFER.  
LANDSCAPE  
EQUIPMENT SCREEN  
PER CODE

SEE PIPING  
SCHEMATIC FOR  
DETAILS AND SIZES

ACCESS

POOL SPECIFICATIONS

POOL SIZE:	13'-0" X 25'-0"	POOL DEPTH:	3'-6" TO 5'
POOL CAPACITY:	10,350 GAL.	TURNOVER RATE:	1.56 HR (12 HR MAX)
POOL S.F.:	325 SF.	POOL PERIMETER:	76 L.F.

POOL EQUIPMENT

PUMP SIZE:	1.5 HP PENTAIR	MODEL:	WHISPERFLO 110 GPM@50T
FILTER SIZE:	150 SF	MODEL:	CARTRIDGE
CHLORINATOR:	SALT SYS.	MODEL:	HAYWARD
POOL RETURNS:	3	SKIMMER:	1
CLEANING LINE:	YES	HEAT PUMP	MODEL - SIZE : RHEEM 115K BTU

WATER FEATURES

ROSETTE :	NONE	LION HEADS :	NONE
SHEER DESCENT :	(1) 3'-0"	DECK JETS :	NONE
SPRITZER :	NONE	JET ON S-O :	NONE
FEED LINE(S) :	NONE	BUBBLER :	NONE

FINISHING ITEMS

COPING:	OVERPOUR	HANDHOLD TYPE:	CERAMIC
TILE:	6"	TYPE OF NEW DECK:	KOOL DECK
SWIMOUT SIZE:	18" X 8'-0"	NEW DECK SF.:	612 SF
EXIT RAILING5:	HANDRAIL	TOPPING SF.:	407 SF
AUTOMATION:	NONE	BENCH SIZE:	NONE
INTERIOR FINISH:	GEM	DECK-O-DRAIN:	48 LF

ADDITIONAL FEATURES

SCREEN ENCL.:	BY OTHERS	FOOTER:	85 LF
---------------	-----------	---------	-------

SPA SPECIFICATIONS

SPA SIZE:	NONE	DEPTH:	NONE
SPA PUMP:	NONE	SPA PERIMETER:	NONE
JETS:	NONE	SPA S.F.:	NONE
SPA CAPACITY:	NONE	TURNOVER RATE:	NONE
RAISED:	NONE	LIGHT:	NONE
GLASS BLOCKS:	NONE	BLOWER:	NONE
SPILLWAY SIZE:	NONE	ENTRY STEP:	NONE

NOTES

PERIMETER BARRIER: CHILD FENCE BY OUTBACK POOLS PER SAFETY REQUIREMENTS PAGE 2  
BARRACUDA POOL CLEANER  
9" COLOR BAND AT EDGE OF POOL  
CAP SWIMOUT ONLY

FINAL DRAWING

APPROVED FOR LAYOUT, DIMENSIONS & EQUIPMENT. I/WE UNDERSTAND THAT ANY CHANGES WILL INVOLVE AN ADDITIONAL CHARGE OF \$350.00 FOR EVERY CHANGE MADE. ALSO NO ENGINEERED PLANS WILL BE PROCESSED WITHOUT ORIGINAL SIGNED SALES DRAWING. NO EXCEPTIONS.

X DATE :

OUTBACK POOLS & WATERFALLS, INC.

431 NW SAVANNAH CIRC.  
LAKE CITY, FL., 32055  
Phon : (386) 755-9860-6677 / Fax : (386) 292-9295

MIKE HELVEY  
353 MULBERRY DR.  
LAKE CITY, FL., 32064

WAYNE MARKHAM BENNETT  
P.E. # 57216  
265 S. FEDERAL HIGHWAY  
DEERFIELD BCH., FL., 33441  
8-5-2009

ORDER# DATE: 8-5-09  
B.D.D.# 1 OF 3  
092175-B





GENERAL NOTES

- 1- CODE REQUIREMENTS :  
PRIVATE SWIMMING POOL, AND SPAS MUST COMPLY WITH CHAPTER 424 & R4101 FLORIDA BUILDING CODE 2001
- 2- MECHANICAL REQUIREMENTS :  
ALL PIPING EQUIPMENT AND MATERIALS USED IN THE PLUMBING SYSTEM OF SWIMMING POOLS AND SPAS THAT ARE BUILT IN PLACE SHALL CONFORM TO THE FLORIDA BUILDING CODE, PLUMBING 424.2.3 & R4101.3. ALL PIPING MATERIALS SHALL BE INSTALLED IN STRICT ACCORDANCE WITH THE MANUFACTURER'S INSTALLATION STANDARDS.
- 3- COMPLIANCE :  
ALL MATERIALS, PIPING, VALVES, EQUIPMENT OR APPLIANCES ENTERING INTO THE CONSTRUCTION OF SWIMMING POOLS, SPAS OR PORTIONS THEREOF SHALL BE OF A TYPE COMPLYING WITH THE CODE OR OF A TYPE RECOMMENDED AND APPROVED BY A NATIONALLY RECOGNIZED TESTING AGENCY OR CONFORMING TO OTHER RECOGNIZED STANDARDS ACCEPTABLE TO ADMINISTRATIVE AUTHORITY.
- 4- ENGINEERING DESIGN :  
DESIGN, CONSTRUCTION AND WORKMANSHIP SHALL BE IN CONFORMITY WITH ANSIS/ASPI 3, 4, 5 AND 6 2003, PUBLISHED BY THE INTERNATIONAL AQUATICS FOUNDATION OR OTHER ACCEPTED ENGINEERING PRACTICES.
- 5- TESTING AND CERTIFICATION :  
ALL POOL AND SPA SUCTION INLETS SHALL BE PROVIDED WITH A COVER THAT HAS BEEN TESTED AND ACCEPTED BY A RECOGNIZED TESTING FACILITY AND COMPLY WITH ANS/ASHA A112.14.8M - SUCTION FITTINGS FOR USE IN SWIMMING POOLS, SPAS, HOT TUBS AND WHIRLPOOL BATHUB APPLIANCES - EXCEPTION : SURFACE SKIMMERS.
- 6- SAFETY NOTE :  
DO NOT USE OR OPERATE POOL OR SPA IF THE SUCTION INLET FITTING IS BROKEN, MISSING OR LOOSE.
- 7- WATER VELOCITY PER ANSI/ASPS-7 2006 #4.4  
WATER VELOCITY IN FIELD FABRICATED PIPING IS BASED ON THE MAX. SYSTEM FLOW RATE. MAX. WATER VELOCITY IN BRANCH PIPING (THE PIPING BETWEEN THE DRAINS) SHALL BE LIMITED TO 6 FEET PER SECOND (FPS) WHEN ONE OF A PAIR IS BLOCKED. IN NORMAL OPERATION THEN, THE BRANCH SUCTION PIPING VELOCITY IS 3 FEET PER SECOND (FPS). ALL OTHER SUCTION PIPING VELOCITIES SHALL BE 6 FPS FOR PUBLIC POOLS OR 8 FPS FOR RESIDENTIAL POOLS.
- 8- MAX. SYSTEM FLOW RATE PER ANSI/ASPS-7 2006 #4.4.1  
THE MAXIMUM SYSTEM FLOW RATE SHALL BE DETERMINED BY ONE OF THE FOLLOWING:  
- THE CALCULATION FOR THE CIRCULATION SYSTEM OF EACH PUMP, OR  
- SIMPLIFIED TDH CALCULATION, OR  
- THE MAX. FLOW CAPACITY (DETERMINE FROM PUMP FLOW CURVE) OF THE NEW OR REPLACEMENT PUMP (WHICH SHALL BE LIMITED BY THE CRITERIA OF ANSI/ASPS-7 #4.4
- IMPORTANT NOTE : IF THE MAX. PUMP FLOW RATE IS GREATER THAN DRAIN FLOW RATE OR 8 FPS SUCTION FLOW RATE OR 10 FPS DISCHARGE FLOW RATE, THEN THE MAX. FLOW FROM THE PUMP CURVE OPTION HAS FAILED  
IF SO, THE TOTAL DYNAMIC HEAD TDH CALCULATION SHALL BE REQUIRED TO DETERMINE IF THE SYSTEM IS ACCEPTABLE. USING TDH, DETERMINE NEW MAX. FLOW RATE FROM PUMP CURVE. IF IT IS GREATER THAN DRAIN FLOW RATE OR 8 FPS SUCTION FLOW RATE OR 10 FPS DISCHARGE FLOW RATE, THE SYSTEM IS NOT ACCEPTABLE.
- IF A VARIABLE SPEED PUMP IS USED, USE THE MAX. PUMP FLOW IN CALCULATIONS  
- FOR SIDE DRAINS, USE APPROPRIATE SIDE WALL DRAIN FLOW AS PUBLISHED BY MANUFACTURER  
- IN-FLOOR SUCTION OUTLET COVER/RATE MUST CONFORM TO MOST RECENT EDITION OF ANSI/ASPI A112.14.8 AND BE EMBOSSED WITH THAT EDITION  
- PUMP, FILTER & HEATER MAKE AND MODEL CANNOT CHANGED AND EQUIPMENT LOCATION CANNOT BE MOVED CLOSER TO POOL, WITHOUT SUBMITTING A REVISED PLAN AND TDH CALCULATION FOR APPROVAL.
- MIN. SYSTEM FLOW BASED ON 1/4" FLOW PER SKIMMER OF 35 GPM  
- SYSTEM FLOW RATE MUST NOT EXCEED APPROVED COVER FLOW RATES  
- CENTER TO CENTER DISTANCE BETWEEN THE SUCTION PIPE OUTLETS SHALL BE 36" INCH MIN.  
- CHANNEL TYPE (WITH 2 OR 3 OUTLETS IN ONE PORT) SHALL BE AT LEAST 3" WIDE BY 3 1/2" LONG
- 9- PUMP :  
PER FBC 424.2.1.1, STRAINER, POOL CIRCULATING PUMPS SHALL BE EQUIPPED ON THE INLET SIDE WITH AN APPROVED TYPE HAIR AND LINT STRAINER WHEN USED WITH A PRESSURE FILTER. PER 424.2.12 INSTALLATION TO BE COMPLETED IN ACCORDANCE MANUFACTURER'S RECOMMENDATIONS. PER 424.2.13 CAPACITY : PUMPS SHALL HAVE DESIGN CAPACITY AT THE FOLLOWING HEADS: 1) PRESSURE DIAPHRAGMOUS EARTH/AT LEAST 60 FEET, 2) VACUUM D.E. 20 INCH VACUUM ON THE SUCTION SIDE AND 40 FEET TOTAL HEAD, 3) RAPID SAND - AT LEAST 45 FEET, 4) HIGH RATE - AT LEAST 60 FEET. PER 424.2.13 PUMP IMPELLERS, SHAFT, WEAR RINGS AND OTHER WORKING PARTS SHALL BE CORROSION RESISTANT MATERIALS.
- 10- CLEANER FITTINGS :  
PER ANSIS/SPS 4.12.10, THE VACUUM OR PRESSURE CLEANER FITTING(S) SHALL BE LOCATED IN AN ACCESSIBLE POSITION AT LEAST 6 INCHES AND NOT GREATER THAN 18 INCHES BELOW THE MINIMUM OPERATING WATER LEVEL, OR AS AN ATTACHMENT TO THE SKIMMER ALL CLEANER SUCTION INLETS SHALL BE PROTECTED BY AN APPROVED, PERMANENTLY INSTALLED, SELF CLOSING FLAPPER ASSEMBLY.
- 11- VALVE :  
PER FBC 424.2.3.1 & R4101.6.1 VALVES SHALL BE MADE OF MATERIALS THAT ARE APPROVED IN THE FLORIDA BUILDING CODE, PLUMBING, VALVES LOCATED UNDER CONCRETE SLABS SHALL BE SET IN A PIT HAVING A LEAST DIMENSION OF FIVE PIPE DIAMETERS, MINIMUM 10 INCHES, FITTED WITH A SUITABLE COVER
- 11- WASTE WATER DISPOSAL :  
PER FBC 424.2.10 & R4101.10 DIRECT OR INDIRECT CONNECTIONS CANNOT BE MADE TO EXISTING FACILITIES WITHOUT THE PRIOR APPROVAL OF THE ADMINISTRATIVE AUTHORITY.
- 13- WATER SERVICE :  
PER FBC 424.2.4.8 R4101.4 BACKFLOW PREVENTION DEVICE REQUIRED ON ALL POTABLE WATER SERVICE
- 14- TESTS :  
ALL POOL, PIPING SHALL BE INSPECTED AND APPROVED BEFORE COVER OR CONCEALMENT. IT SHALL BE TESTED AND APPROVED TIGHT UNDER A STATIC WATER OR AIR PRESSURE TEST OF NOT LESS THAN 35 PSI FOR 15 MINUTES. PER MANUFACTURER'S RECOMMENDATIONS, NO AIR TEST SHALL BE APPROVED FOR PVC PIPE AND FITTINGS. SECTION 424.2.12.1 & R4101.12.2 PRESSURE TESTS.
- 15- WATER HEATING EQUIPMENT :  
SWIMMING POOL, WATER HEATING EQUIPMENT SHALL CONFORM TO THE DESIGN CONSTRUCTION AND INSTALLATION REQUIREMENTS IN ACCORDANCE WITH ACCEPTED ENGINEERING PRACTICES AND SHALL BEAR THE LABEL OF A RECOGNIZED TESTING AGENCY, AND SHALL INCLUDE A CONSIDERATION OF COMBUSTION AIR, VENTING AND GAS SUPPLY REQUIREMENTS FOR WATER HEATERS SEC. 424.2.14.1 & R4101.14.1. IT MUST CONTAIN A THERMOSTATIC OR HIGH PRESSURE CONTROL SWITCH SO THE POOL WATER DOES NOT EXCEED 104 DEGREES F. SEC. 424.2.14.4 & R4101.14.4 WATER HEATING EQUIPMENT SHALL BE INSTALLED WITH FLANGES OR UNION CONNECTIONS ADJACENT TO THE HEATER. WATER HEATING EQUIPMENT SHALL COMPLY WITH FBC 412.1 ALL HEATERS MUST HAVE AN INTERNAL CHECK VALVE. PER FBC 196.12.1, 196.2.3.2 THE POOL AND SPA SHALL BE PROVIDED WITH A COVER TO REDUCE HEAT LOSS (IF REQUIRED BY THE CITY)
- 16- GAS PIPING :  
GAS PIPING SHALL COMPLY WITH FBC, FUEL GAS SEC. 424.2.15 & R4101.15
- 17- ELECTRICAL :  
POOL LOCATION AND ELECTRICAL WIRING AND EQUIPMENT SHALL COMPLY WITH THE NATIONAL ELECTRICAL CODE 2005, SPECIFICALLY SECTION 680.
- 18- LADDERS AND STEPS :  
PER FBC 424.2.18 & R4101.18 ALL POOL, S SHALL BE PROVIDED WITH A LADDER OR STEPS IN THE SHALLOW END WHERE WATER EXCEEDS 24 INCHES. WHERE WATER DEPTH EXCEEDS 5 FEET, THERE SHALL BE LADDERS, STAIRS OR UNDERWATER BENCHES/STAIRS/MOUNTS IN THE DEEP END.
- 19- FILTERS :  
PER FBC 424.2.20 & R4101.20 THE ENTIRE DESIGN OF MATCHED COMPONENTS SHALL HAVE SUFFICIENT CAPACITY TO PROVIDE A COMPLETE TURNOVER OF POOL WATER IN 12 HOURS OR LESS.
- 20- POOL FITTINGS :  
PER FBC 424.2.21 & R4101.21 POOL FITTINGS SHALL BE OF AN APPROVED TYPE AND DESIGN AS TO BE APPROPRIATE FOR THE SPECIFIC APPLICATION. PER FBC 424.2.13.2 JOINTS AND C CONNECTIONS, FBC PLUMBING SEC. 605.21, PURPLE PRIMER REQUIRED ON PVC PIPING
- 21- SKIMMERS :  
PER FBC 424.2.21.2 & R4101.21.4 SKIMMERS SHALL BE INSTALLED ON THE BASIS OF ONE PER 800 SF OF SURFACE AREA OR FRACTION THEREOF.
- 22- HYDROSTATIC RELIEF DEVICE :  
PER FBC 424.2.21.4.8 R4101.21.4 IN AREAS OF ANTICIPATED WATER TABLE, AN APPROVED HYDROSTATIC RELIEF DEVICE SHALL BE INSTALLED. EXCEPTION IS PLASTIC LINER POOL.
- 23- CONCRETE / STEEL :  
CONCRETE IS TO BE A MIX DESIGNED IN ACCORDANCE WITH ASTM C-94 BY A RECOGNIZED TESTING LABORATORY TO ACHIEVE A STRENGTH OF 3000 PSI, AT 28 DAYS (UNLESS OTHERWISE NOTED) WITH A PLASTIC AND WORKABLE MIX. PNEUMATICALLY APPLIED ANCHOR SHOTCRETE SHALL BE PLACED IN ACCORDANCE WITH ACI 304.2R-04 AND ACI 308.2-04, RESPECTIVELY. ALL OTHER CONCRETE SHALL BE PLACED IN ACCORDANCE WITH ACI 304R-04. A CERTIFICATE OF MANUFACTURER'S MIX AND STRENGTH IS TO BE PROVIDED. NO WATER IS TO BE ADDED AFTER TRUCK LEAVES PLANT WITHOUT APPROVAL OF ENGINEER. PLANT CONTROL, DEPOSIT IS REQUIRED. MAXIMUM MIX TIME AT POINT OF DEPOSIT IS 90 MINUTES. CONCRETE WORK SHALL BE AS PER REQUIREMENTS AND RECOMMENDATIONS OF ACI 301-04. REINFORCING, DEFORMED STEEL BARS SHALL BE #4'S GRADE 60 (UNLESS OTHERWISE NOTED). FREE FROM OIL, LOOSE SCALE AND LOOSE RUST. REINFORCING, DEFORMED STEEL BARS SHALL BE BENT, LAPPED, PLACED, SUPPORTED AND FASTENED ACCORDING TO THE MANUAL OF STANDARD PRACTICE FOR DETAILING CONCRETE STRUCTURES (ACI 315-04) AND THE BUILDING CODE REQUIREMENTS FOR REINFORCING CONCRETE (ACI 318-04). IN CASE OF CONFLICT, THE MORE CONSERVATIVE VALUE(S) SHALL BE USED.
- 24- SOIL STATEMENT :  
IN ACCORDANCE WITH FBC, SECTION 1818, HAZZ BEARING CAPACITY OF SOIL, BASED UPON RATIONAL ANALYSIS AND KNOWN VALUES IN THE VICINITY. THE IN-PLACE BEARING CAPACITY OF THE SOIL, BENEATH THE POOL AND RELATED STRUCTURES SHOWN WITHIN THESE PLANS IS 2000 PSF. AFTER EXCAVATION AND CONSTRUCTION IN ACCORDANCE WITH CURRENT EDITION OF FBC, SHOULD ANY MUCK, MARL, OR OTHER ORGANIC SOILS BE DISCOVERED ON EXCAVATION, THEY SHOULD BE REMOVED IN THEIR ENTIRETY. ALL CONSTRUCTION SHALL STOP AND THE ENGINEER OF RECORD SHALL BE CONTACTED TO CONDUCT AN INSPECTION. STRUCTURAL ELEMENTS ARE DESIGNED WITH A REQUIRED BEARING CAPACITY OF 2000 PSF, UNLESS OTHERWISE SPECIFIED.

25- POOL STAKING :

THIS DESIGN ENGINEER ASSUMES NO RESPONSIBILITY FOR POOL CONSTRUCTION IN EASEMENT OR REQUIRED SETBACKS AREAS. PLAT PLANS NOT PREPARED FROM LEGAL SURVEYS OF THE EXISTING LOT AND RESIDENCE ARE SO INDICATED. THE POOL CONTRACTOR SHALL VERIFY ALL DIMENSIONS IN THE FIELD AND ESTABLISH LOT LINES & LOCATION OF UTILITIES AT THE SITE AND CONTACT THE H.C.E. IF DIFFERENT THAN INDICATED ON PLAN. MINIMUM CLEARANCE DIMENSIONS SHALL BE HELD AS REQUIRED BY THE LOCAL REGULATORY AGENCY.

26- EXISTING STRUCTURES :

THE POOL CONTRACTOR SHALL ALWAYS TAKE ALL PRECAUTIONS TO PROTECT EXISTING STRUCTURES FROM FAILURE BY SHEETING AND/OR SHORING OR OTHER METHODS. THE DESIGN ENGINEER ACCEPTS NO RESPONSIBILITY FOR THE SAFETY OF EXISTING STRUCTURES. IN CASE OF FOOTINGS UNDERMINING, CONTRACTOR SHALL POUR CONCRETE BETWEEN POOL AND FOOTING. TOP OF CONCRETE SHALL BE BOTTOM OF FOOTING, WIDTH OF FURRED CONCRETE SHALL BE FOOTING WIDTH AT A MINIMUM

27- PIPING :

PIPING SHALL BE SCH. 40 BEARING NSF APPROVAL PER FBC 2007 R4101. PIPING CAN BE (IF NEEDED) ENCASED IN THE CONCRETE OF THE POOL SHEEL.

28- CONCRETE SLABS :

ALL POOL EQUIPMENT SLABS SHALL COMPLY WITH SECTION 1820.3 OF FBC 2007

29- HANDHOLD :

ANSI/ASPI'S ARTICLE XV SECTION 15.13, A SECURED ROPE OR CERAMIC HANDHOLDS MUST BE PLACED AT OR NO MORE THAN 12" ABOVE THE NORMAL WATERLINE OF THE POOL.

30- POWER LINE :

OVERHEAD ELECTRIC LINES MUST BE LOCATED 10 FEET AND UNDERGROUND ELECTRIC LINES MUST BE LOCATED 5 FEET FROM POOL WATER EDGE.

31- BACKFILL & COMPACTION

BACKFILL CONSTRUCTION AREAS TO PROPER ELEVATION, IF NEEDED USING CLEAN GRANULAR MATERIAL, FREE OF ORGANICS AND OTHER DELETERIOUS MATERIALS AND PLACED IN LIFTS NOT TO EXCEED 12 INCHES IN THICKNESS AND COMPACTED TO 95% OF THE ASTM D-1557 MODIFIED PROCTOR METHOD. BACKFILLING SHALL COMMENCE ONLY FOLLOWING REMOVAL FROM EXCAVATION OF ALL FORMS, WOOD, DEBRIS, AND OTHER DELETERIOUS MATERIALS. COMPACTION SHALL BE WITH EQUIPMENT SUITED TO SOIL, BEING COMPACTED. MOISTEN OR AERATE MATERIAL AS NECESSARY TO PROVIDE MOISTURE CONTENT COMPACT EACH LAYER TO NOT LESS THAN PERCENTAGE OF THAT WHICH WILL READILY FACILITATE OBTAINING SPECIFIED COMPACTION WITH EQUIPMENT USED. ENSURE THAT THE COMPACTION OF PREVIOUSLY PREPARED FILL AREAS HAS BEEN MAINTAINED PRIOR TO PLACING NEW LAYERS. AFTER INSTALLATION OF ANY PLUMBING AND ELECTRICAL PIPING, DISTURBED AREAS SHALL BE RECOMPACTED.

32- ENTRAPMENT TESTING AND CERTIFICATION :

ALL POOL AND SPA SUCTION INLETS SHALL BE PROVIDED WITH A COVER THAT HAS BEEN TESTED AND ACCEPTED BY A RECOGNIZED TESTING FACILITY AND COMPLY WITH ANS/ASHA A112.14.8 - SUCTION FITTINGS FOR USE IN SWIMMING POOLS, SPAS, HOT TUBS AND WHIRLPOOL BATHUB APPLIANCES - EXCEPTION : SURFACE SKIMMERS.

33- WARNING :

TO EMPTY POOL, AFTER CONSTRUCTION, FOR REPAIRS OR ANY OTHER REASON, THE HYDROSTATIC UPLIFT PRESSURES BENEATH THE POOL MUST BE ELIMINATED TO PREVENT THE POOL FROM FLOATING UPWARD. THE OWNER MUST CONSULT A POOL CONTRACTOR OR POOL REPAIR CONTRACTOR EXPERIENCED IN ELIMINATING UPLIFT PRESSURES.

34- NOTE 1 :

THIS PLAN IS NOT TRANSFERABLE FROM ONE CONTRACTOR TO ANOTHER

35- NOTE 2 :

UNLESS OTHERWISE SPECIFIED, ALL DETAILS SHOWN ARE NOT TO SCALE.

36- NOTE 3 :

POOL WALL SHALL BE REINFORCED WITH #8@8" O.C.E.W. WHERE LESS THAN 5 FEET FROM ANY EXISTING STRUCTURE OR PATIO (SEE SHEETING & SHORING DETAIL)

37- NOTE 4 :

POOL AND DECK ELEVATION SHALL BE LOWER THAN FINISH FLOOR ELEVATION OF THE HOUSE

38- NOTE 5 :

THERE IS ALWAYS THE POSSIBILITY THAT CONDITIONS IN THE FIELD MAY BE DIFFERENT FROM THOSE INDICATED IN AN ENGINEERING PERMIT DRAWINGS. THEREFORE, IF DIFFERENT CONDITIONS ARE ENCOUNTERED BEFORE OR DURING CONSTRUCTION, THE ENGINEER OF RECORD SHALL BE NOTIFIED TO REVIEW THE FINDINGS AND MAKE RECOMMENDATIONS AS NEEDED.

39- NOTE 6 :

STRUCTURAL ENGINEER MUST CERTIFY OR DESIGN REPLACEMENT ANCHOR AND DEADMAN SYSTEM FOR SEAWALL WITH IN 15 FEET OF POOL SEAWALL

40- NOTE 7 :

NO DIVING BOARD AND NO DIVING IS ALLOW ON ANY POOL, LESS THAN 8 FEET DEEP AND SPECIFICALLY DESIGN FOR DIVING

41- BONDING

CONTINUOUS SINGLE #8 WVG BARE COPPER WIRE SHALL BE BURIED TO A MIN. 4" TO 6" BELOW SURGRADE, 18" TO 24" FROM INSIDE THE WALL OF SWIMMING POOL, SPA AROUND THE SWIMMING POOL, SPA PERIMETER, AND SHALL BE CONNECTED TO THE POOL STEEL REINFORCEMENT AT A MIN. 4 DIFFERENT LOCATIONS, EQUALLY SPACED.

42- NOTE 8 :

IT IS THE CONTRACTOR RESPONSIBILITY TO PROVIDE THE ENGINEER WITH AN ACCURATE SURVEY AND DRAWINGS THAT REPRESENTS THE EXISTING FIELD CONDITIONS, I.E. ADDITIONS, TREES, AC PADS, WALKWAYS, ETC.

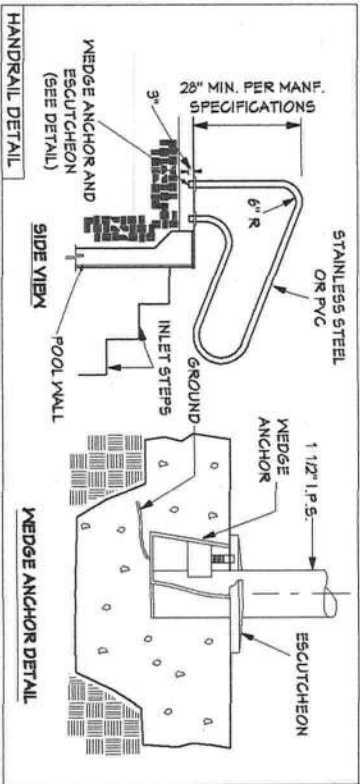
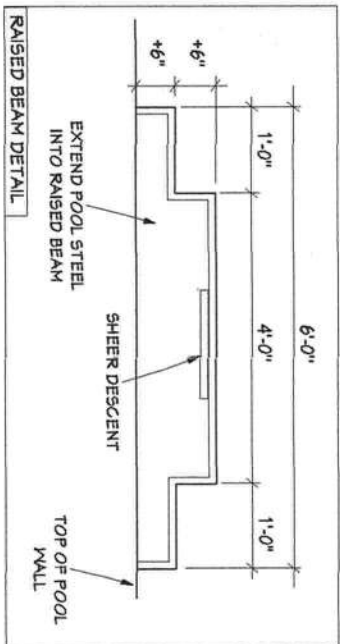
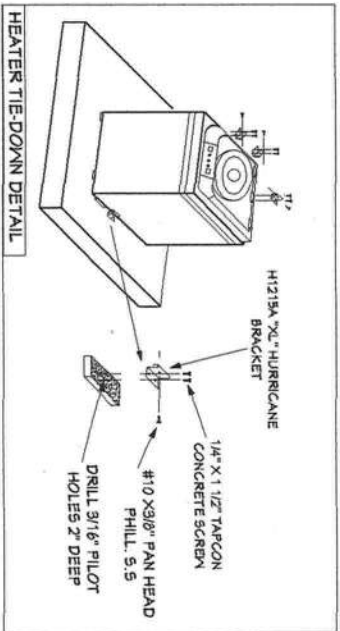

WYNNE MARCHAM BENNETT  
P.E. # 57216  
265 S. FEDERAL HIGHWAY  
DEERFIELD BCH, FL., 39441  
8-5-2004