



STATE OF FLORIDA  
DEPARTMENT OF HEALTH  
ONSITE SEWAGE TREATMENT AND DISPOSAL  
SYSTEM  
APPLICATION FOR CONSTRUCTION PERMIT

PERMIT NO. 21-0404  
DATE PAID: 3/9/21  
FEE PAID: 60.00  
RECEIPT #: \_\_\_\_\_

APPLICATION FOR:

☐ New System ☒ Existing System ☐ Holding Tank ☐ Innovative  
☐ Repair ☐ Abandonment ☐ Temporary ☐ \_\_\_\_\_

APPLICANT: Kenneth Edenfield on behalf of the Cross Church

AGENT: Brian Pitman, PE - Pitman Engineering

TELEPHONE: 386-965-5919

MAILING ADDRESS: 206 S Marion Ave  
Lake City, FL 32025

TO BE COMPLETED BY APPLICANT OR APPLICANT'S AUTHORIZED AGENT. SYSTEMS MUST BE CONSTRUCTED BY A PERSON LICENSED PURSUANT TO 489.105(3)(m) OR 489.552, FLORIDA STATUTES. IT IS THE APPLICANT'S RESPONSIBILITY TO PROVIDE DOCUMENTATION OF THE DATE THE LOT WAS CREATED OR PLATTED (MM/DD/YY) IF REQUESTING CONSIDERATION OF STATUTORY GRANDFATHER PROVISIONS.

PROPERTY INFORMATION

LOT: \_\_\_\_\_ BLOCK: \_\_\_\_\_ SUBDIVISION: \_\_\_\_\_ PLATTED: \_\_\_\_\_

PROPERTY ID #: 27-5S-17-09419-102 ZONING: A-3 I/M OR EQUIVALENT: [ Y / N ]

PROPERTY SIZE: 5.0 ACRES WATER SUPPLY: [ X ] PRIVATE PUBLIC [ ] <=2000GPD [ ] >2000GPD

IS SEWER AVAILABLE AS PER 381.0065, FS? [ Y / N ] DISTANCE TO SEWER: 200+ FT

PROPERTY ADDRESS: 12518 US HWY 441 S, Lake City, FL 32025

DIRECTIONS TO PROPERTY: West side of US 441 approximately 1.3 miles north of the I-75 intersection.

BUILDING INFORMATION

[ ] RESIDENTIAL

[ X ] COMMERCIAL

Unit No	Type of Establishment	No. of Bedrooms	Building Area Sqft	Commercial/Institutional System Design Table 1, Chapter 64E-6, FAC
1	<u>Church</u>	<u>n/a</u>	<u>8,000</u>	<u>same as original</u>
2	_____	_____	_____	_____
3	_____	_____	_____	_____
4	_____	_____	_____	_____

[ ] Floor/Equipment Drains [ ] Other (Specify) \_\_\_\_\_

SIGNATURE: Brian Pitman

DATE: 6-30-21

STATE OF FLORIDA  
DEPARTMENT OF HEALTH  
APPLICATION FOR CONSTRUCTION PERMIT

Permit Application Number

21-0604

----- PART II - SITEPLAN -----

Scale: Each block represents 10 feet and 1 inch = 40 feet.

SEE ATTACHMENT NEXT PAGE																																							
-----------------------------	--	--	--	--	--	--	--	--	--	--	--	--	--	--	--	--	--	--	--	--	--	--	--	--	--	--	--	--	--	--	--	--	--	--	--	--	--	--	--

Notes: \_\_\_\_\_

Site Plan submitted by: Brian Pitman, PE

Plan Approved ☒

Not Approved ☐

Date 7-9-21  
6-30-21

By Sallie Ford Env Health Director - Columbia County Health Department

**ALL CHANGES MUST BE APPROVED BY THE COUNTY HEALTH DEPARTMENT**



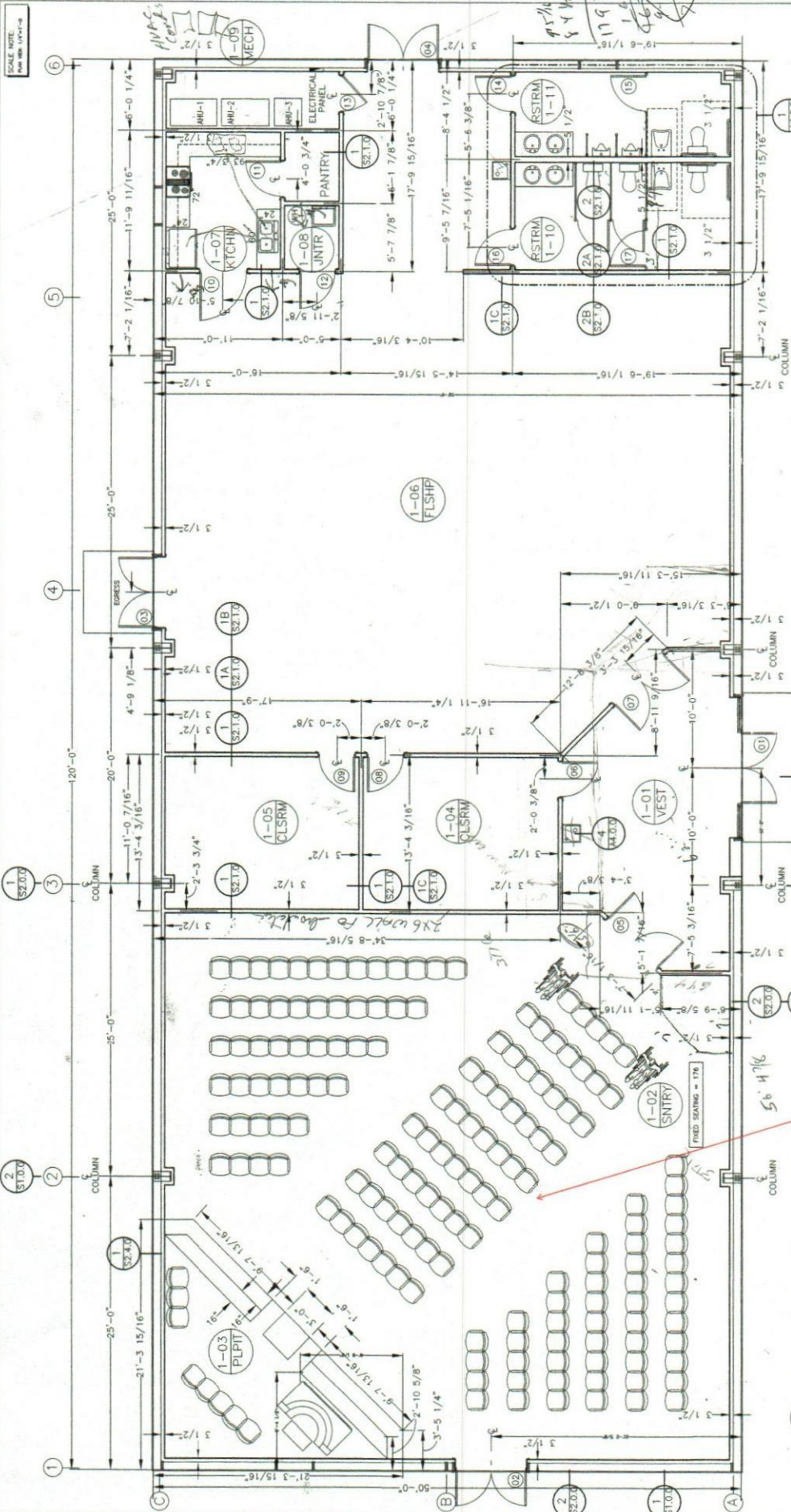

**AREA SCHEDULE**

AREA	DESIGNATIONS
1-01	VESTIBULE
1-02	ENTRANCE
1-03	PULPIT
1-04	CLASSROOM
1-05	CLASSROOM
1-06	FELLOWSHIP AREA
1-07	KITCHEN
1-08	JANITOR'S CLOSET
1-09	MEN'S ACCESSIBLE RESTROOM
1-10	WOMEN'S ACCESSIBLE RESTROOM
1-11	WOMEN'S ACCESSIBLE RESTROOM
GROSS CONSTRUCTED CONDITIONED AREA	
6000 S.F.	

**This section of the sanctuary  
 will be mirrored in the 40'  
 extension**

1 DIMENSIONED FIRST LEVEL PLAN VIEW  
 42.0.0 SCALE: 1/8" = 1'-0"

