

B-1

Water Table: 7.5 ft.

Soil Description

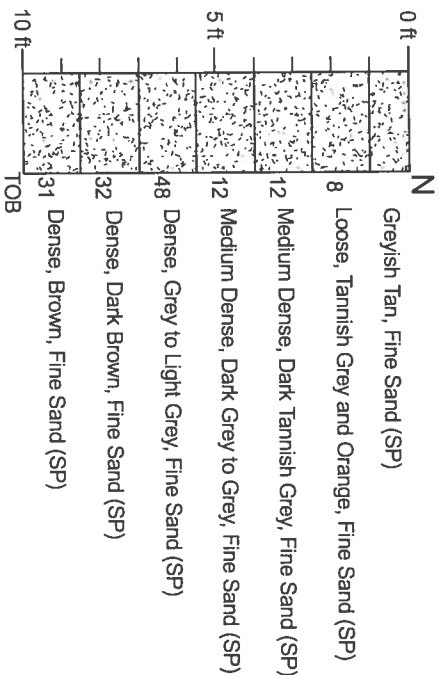

B-2

Water Table: 6.5 ft.

Soil Description

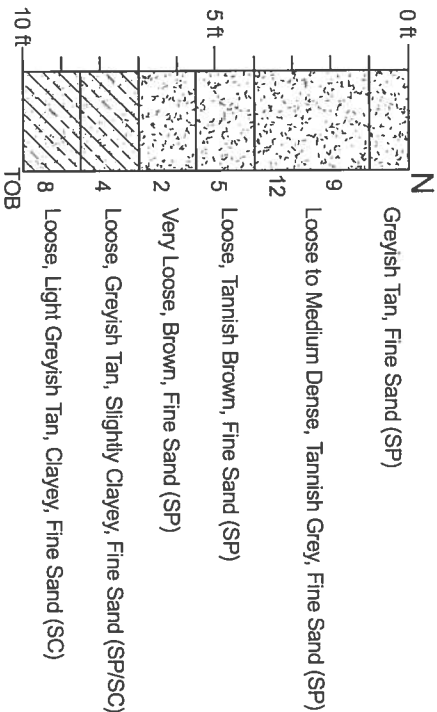

B-3

Water Table: 6.0 ft.

Soil Description

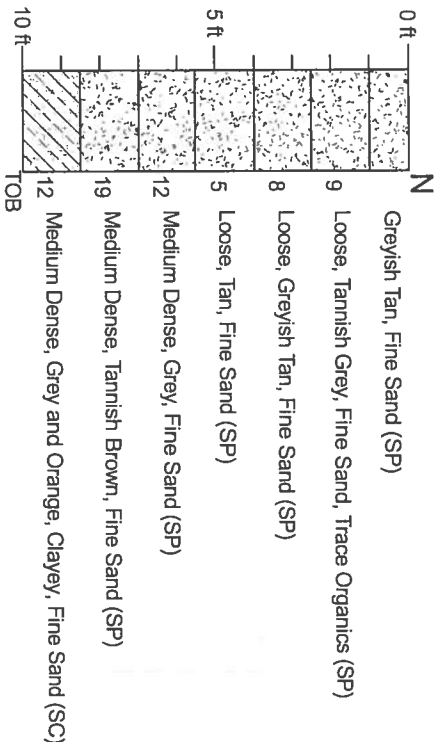

B-4

Water Table: 5.0 ft.

Soil Description

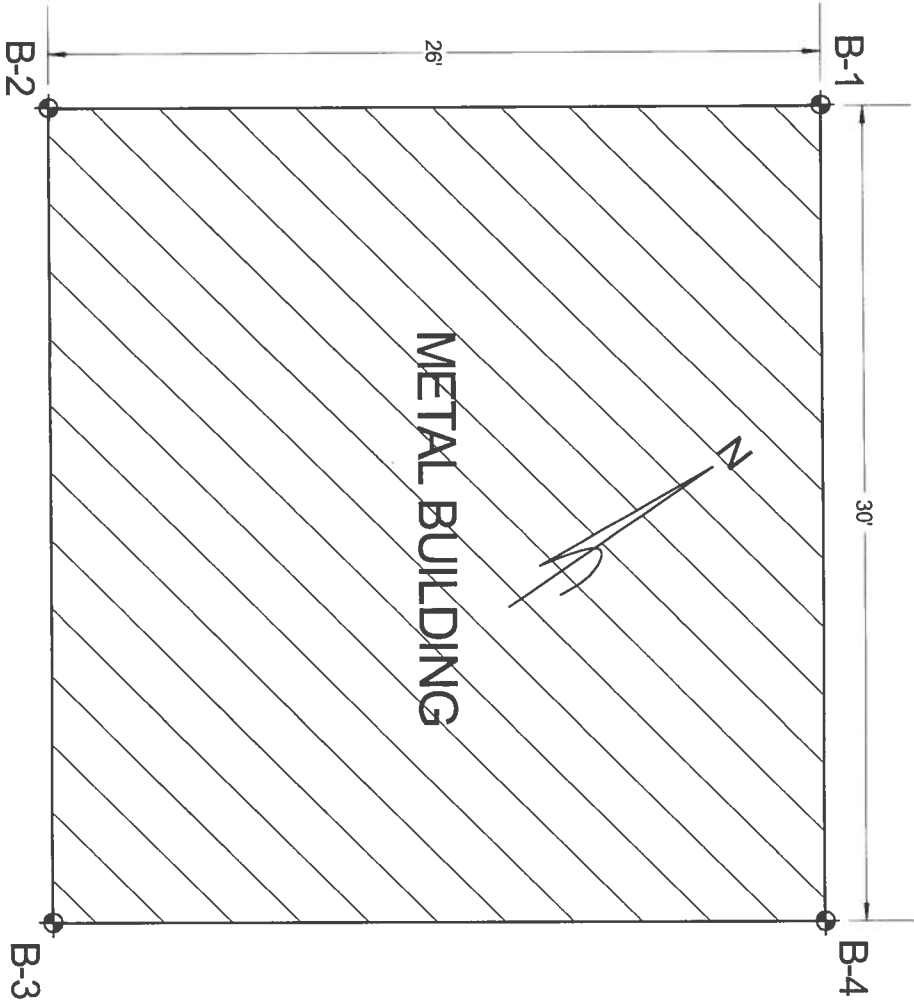
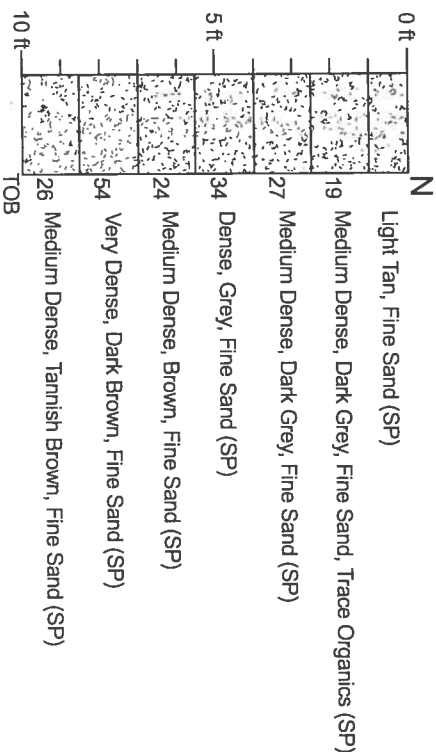

ENGINEERING CLASSIFICATION

GRANULAR MATERIAL-S-  
Relative Density  
SPT  
(Blows/12 inches)

Very Loose Less than 4  
Loose 4-10  
Medium Dense 11-30  
Dense 31-50  
Very Dense Greater than 50

SILTS AND CLAYS-

Consistency (Blows/12 inches)  
SPT

Very Soft Less than 2  
Soft 2-4  
Medium Stiff 5-8  
Stiff 9-15  
Very Stiff 16-30  
Hard Greater than 30

LEGEND:

TOB Termination of Boring

GSE Ground Surface Elevation

V Ground Water at Time of Drilling

V Wet Season Water Table

N Standard Penetration Resistance in Blows  
Per 12 inches (18- inch Spoon, ASTM D-1586)

WOR Weight of Rod

WOH Weight of Hammer

MC Moisture Content (%)

OC Organic Content (%)

-200 Percent Passing No. 200 U.S.  
Standard Sieve

LL Liquid Limit

PI Plasticity Index

(SP) Unified Soil Classification Based on Visual  
Observation and Laboratory Tests

SAND SILTY SAND

SAND with SILT CLAYEY SAND

SAND with CLAY SANDY CLAY

CLAY LIMESTONE

MARL ORGANICS

REVISIONS

DATE	BY	DESCRIPTION	DATE	BY	DESCRIPTION

ENGINEER OF RECORD

CAL. TECH TESTING, INC.

P.O. BOX 1625  
LAKE CITY, FL. 32056  
PHONE NO. (386) 755-3633  
FAX NO. (386) 752-5456

SEAL

ROBERT W. CLARK

PE. 52210

COMMERCIAL METAL BUILDING

FREEDOM MOBILE HOMES

ROAD NO. COUNTY FINANCIAL PROJECT ID

COLUMBIA

REPORT OF SOIL BORINGS

1 of 1

SHEET NO.