

## Truss Anchor DETAIL

SCALE: 3/4" = 1'-0"

A

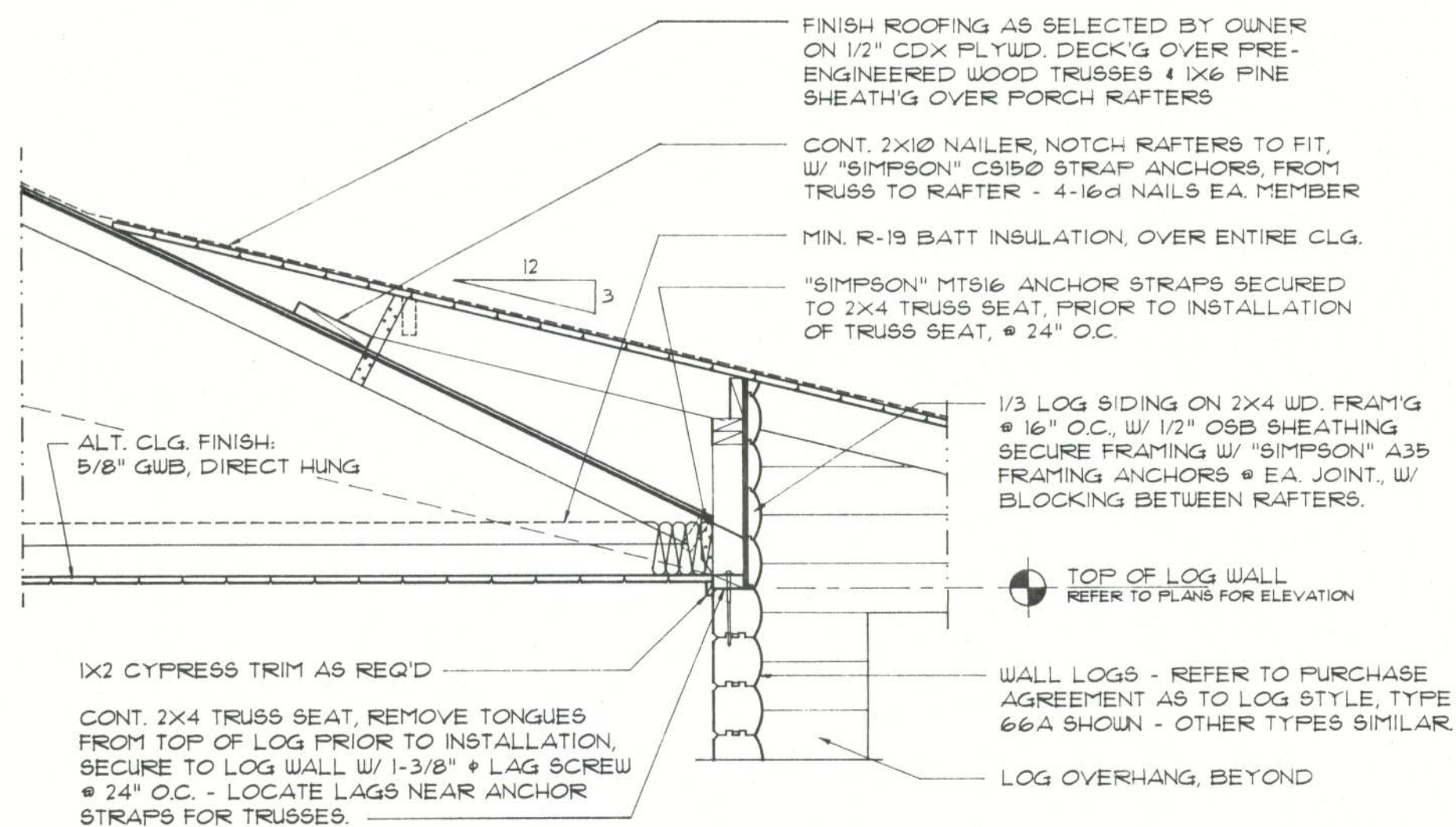

## Truss Anchor DETAIL

SCALE: 3/4" = 1'-0"

B

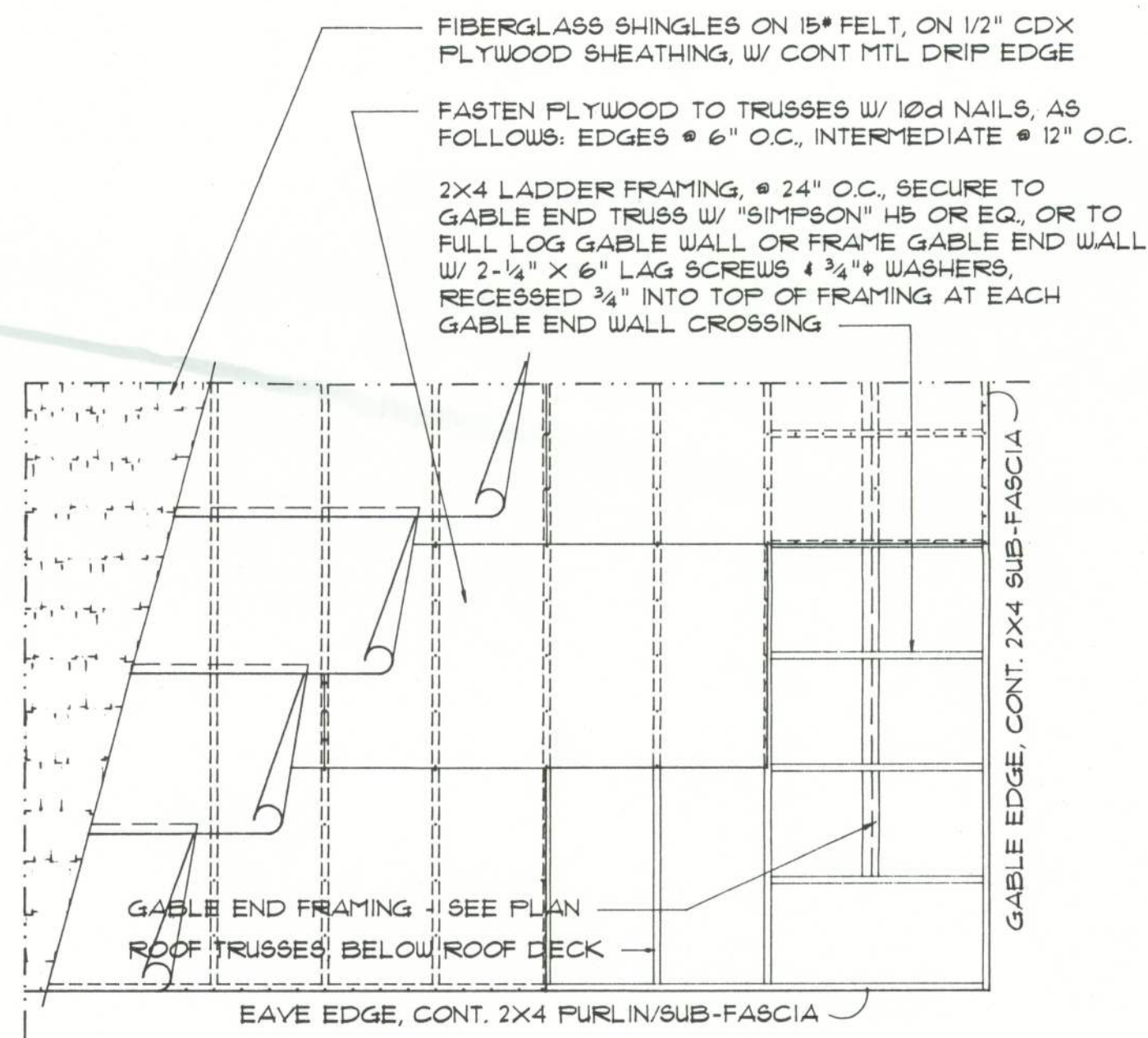

## Roof Deck DETAIL

SCALE: 3/8" = 1'-0"

D

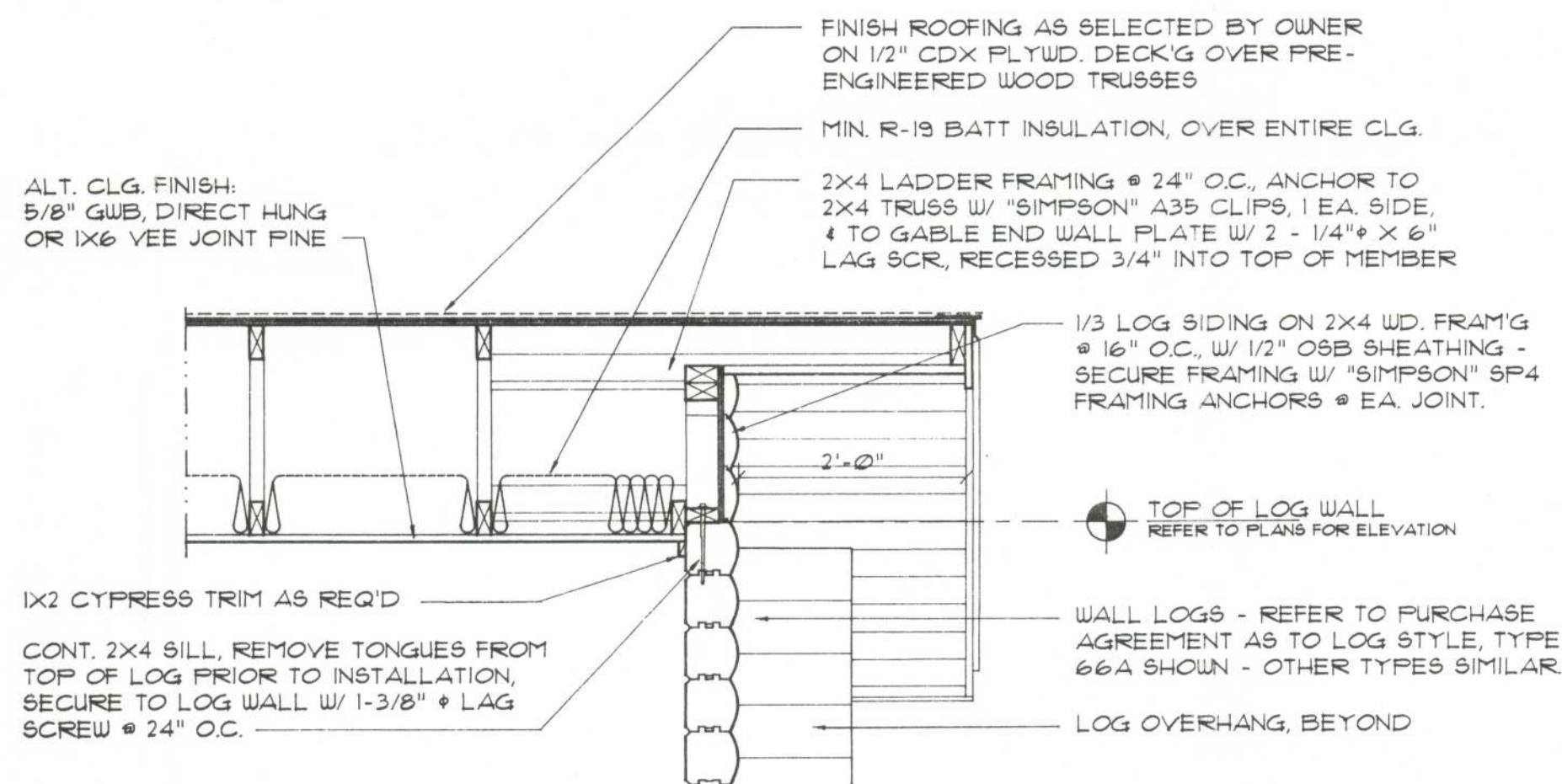

## Gable End DETAIL

SCALE: 3/4" = 1'-0"

C

### GENERAL TRUSS NOTES:

1. TRUSSES SHALL BE DESIGNED BY A LICENSED ENGINEER, AND IN ACCORDANCE WITH THE REQUIREMENTS OF THE "NATIONAL FOREST PRODUCTS ASSOCIATION" MANUAL FOR "STRESS RATED LUMBER AND ITS CONNECTIONS", LATEST Ed., ALONG W/ THE "TRUSS PLATE INSTITUTE" SUGGESTED GUIDELINES FOR TEMPORARY AND PERMANENT BRACING, AND HANDLING OF TRUSSES. TRUSS SHOP DRAWINGS SHALL INCLUDE TRUSS DESIGN, PLACEMENT PLANS, DETS, & TRUSS TO TRUSS CONNECTIONS.
2. TRUSS SHOP DRAWINGS SHALL BE SIGNED & SEALED BY THE DESIGNING ENGINEER.
3. IN HURRICANE PRONE AREAS, ADDITIONAL BRACING MAY BE REQUIRED FOR PERMIT.

### NOTE:

REFER TO PLANS FOR SPECIFIC  
TRUSS INFORMATION, STYLE, SIZES,  
PITCH & PROFILES.

### NOTE:

REFER TO GENERAL STRUCTURAL  
NOTES FOR ADDITIONAL FRAMING  
RELATED INFORMATION & SCHEDULES



Manufacturers  
Specializing in Cypress & Cedar Custom Homes  
4345 HIGHWAY 90, WELLBORN, FLORIDA 32094  
904.963.1065 / 1.800.362.1065

Custom Log Home Standard Details:

TRUSS ROOFING DETAILS

DUE TO VARIANCE IN LOCAL CODES/STANDARDS, THIS DRAWING IS FOR INFORMATION ONLY. THE CUSTOMER IS RESPONSIBLE FOR APPROVAL BY A LICENSED PROFESSIONAL ENGINEER. THE CUSTOMER IS RESPONSIBLE FOR OBTAINING ALL NECESSARY PERMITS AND APPROVALS. THE CUSTOMER IS RESPONSIBLE FOR OBTAINING ALL NECESSARY PERMITS AND APPROVALS. THE CUSTOMER IS RESPONSIBLE FOR OBTAINING ALL NECESSARY PERMITS AND APPROVALS.

SHEET: D.8a  
REVISION:  
DRAWN: NPG  
DATE: 01NOV96  
COM: SRLH