

TOTAL SHEAR WALL SEGMENTS

INDICATES SHEAR WALL SEGMENTS

	REQUIRED	ACTUAL
TRANSVERSE	5268 LBS	11280 LBS
LONGITUDINAL	5762 LBS	19970 LBS

(2) 2x12 HEADER CONT FROM CORNER TO CORNER ATTACHED AS PER PORTAL FRAME SHEARWALL DETAIL

HEADER LEGEND

- (2) 2X12X10', 1J 1K
- HEADER/BEAM CALL-OUT (U.N.O.)
- NUMBER OF KING STUDS (FULL LENGTH)
- NUMBER OF JACK STUDS (UNDER HEADER)
- SPAN OF HEADER
- SIZE OF HEADER MATERIAL
- NUMBER OF PLIES IN HEADER

STRUCTURAL PLAN NOTES

- SN-1 ALL LOAD BEARING FRAME WALL & PORCH HEADERS SHALL BE A MINIMUM OF (2) 2X6 SYP#2 (U.N.O.)
- SN-2 ALL LOAD BEARING FRAME WALL HEADERS SHALL HAVE (1) JACK STUD & (1) KING STUD EACH SIDE (U.N.O.)
- SN-3 DIMENSIONS ON STRUCTURAL SHEETS ARE NOT EXACT. REFER TO ARCHITECTURAL FLOOR PLAN FOR ACTUAL DIMENSIONS
- SN-4 PERMANENT TRUSS BRACING IS TO BE INSTALLED AT LOCATIONS AS SHOWN ON THE SEALED TRUSS DRAWINGS. LATERAL BRACING IS TO BE RESTRAINED PER BCISI-03, BCISI-B1, BCISI-B2, & BCISI-B3. BCISI-B1, BCISI-B2, & BCISI-B3 ARE FURNISHED BY THE TRUSS SUPPLIER, WITH THE SEALED TRUSS PACKAGE

ANCHOR TABLE

OBTAIN UPLIFT REQUIREMENTS FROM TRUSS MANUFACTURER'S ENGINEERING

TRUSS CONNECTOR	UPLIFT SYP	UPLIFT SPF	F1 SYP	F2 SYP	F1 SPF	F2 SPF	TO RAFTER/TRUSS	TO PLATES
H5	455	265	115	200	100	170	4-8d x 1 1/2"	4-8d x 1 1/2"
H3	415	290	125	160	105	140	4-8d x 1 1/2"	4-8d x 1 1/2"
H2.5	415	365	150	150	130	110	5-8d x 1 1/2"	5-8d x 1 1/2"
H2.5A	480	480	110	110	110	110	5-8d x 1 1/2"	5-8d x 1 1/2"
H6	950	820					8-8d	8-8d
H8	745	565					5-10d x 1 1/2"	5-10d x 1 1/2"
H14-1	1465	1050	515	265	480	245	12-8d x 1 1/2"	13-8d
H14-2	1465	1050	515	265	480	245	12-8d x 1 1/2"	15-8d
H10	990	850	585	525	505	450	8-8d x 1 1/2"	8-8d x 1 1/2"
H10-2	760	655	455	395	390	340	6-10d	6-10d
H16	1470	1265					2-10d x 1 1/2"	10-10d x 1 1/2"
H16-2	1470	1265					2-10d x 1 1/2"	10-10d x 1 1/2"
LTS12 - LTS20	1000	620					6-10d x 1 1/2"	6-10d x 1 1/2"
MTS12 - MTS30	1000	860					7-10d x 1 1/2"	7-10d x 1 1/2"
HTS16 - HTS30	1450	1245					12-10d x 1 1/2"	12-10d x 1 1/2"
HEAVY GIRDER TIEDOWNS								TO FOUNDATION
LG12	2050	1785	700	170	700	170	14-16d	14-16d
LG13-SDS2.5	3685	2655	795	410	795	410	12-SDS 1/4" x 2 1/2"	26-16dS
LG14-SDS3	4060	3660	2000	675	2000	675	12-SDS 1/4" x 3"	36-16dS
MGT	3965	3330					22-10d	
HGT-2	10980	6485					16-10d	5/8" ANCHOR
HGT-3	10530	9035					16-10d	2-5/8" ANCHOR
HGT-4	9250	9250					16-10d	2-5/8" ANCHOR
STUD STRAP CONNECTOR								TO STUDS
SSP DOUBLE TOP PLATE	435	435						3-10d 4-10d
SSP SINGLE SILL PLATE	455	420						1-10d 4-10d
DSP DOUBLE TOP PLATE	825	825						6-10d 8-10d
DSP SINGLE SILL PLATE	825	600						2-10d 8-10d
SP1	585	535						4-10d 6-10d
SP2	1065	605						6-10d 6-10d
SP4	885	760						6-10d x 1 1/2"
SPH4	1240	1065						10-10d x 1 1/2"
SP8	885	760						8-10d x 1 1/2"
SPH8	1240	1065						10-10d x 1 1/2"
LSTA18	1235	1110						14-10d
LSTA21	1235	1235						16-10d
CS20	1030	1030						14-10d
CS16	1705	1705						22-10d
STUD ANCHORS							TO STUDS	TO FOUNDATION
LTT19	1350	1305					8-16d	1/2" ANCHOR
LTT131	2310	2310					18-10d x 1 1/2"	5/8" ANCHOR
HD2A	2775	2570					2-5/8" BOLTS	5/8" ANCHOR
HTT16	4175	3695					16-16d	5/8" ANCHOR
HTT22	5260	5250					32-16d	5/8" ANCHOR
ABU44	2200	2200					12-16d	5/8" ANCHOR
ABU66	2300	2300					12-16d	5/8" ANCHOR
ABU88	2320	2320					16-16d	2-5/8" ANCHOR

- (1) w/ INSTALLATION OF 4-16dS OPTIONAL NAIL HOLES
- (2) FOR SYP GIRDER & SPF STUDS

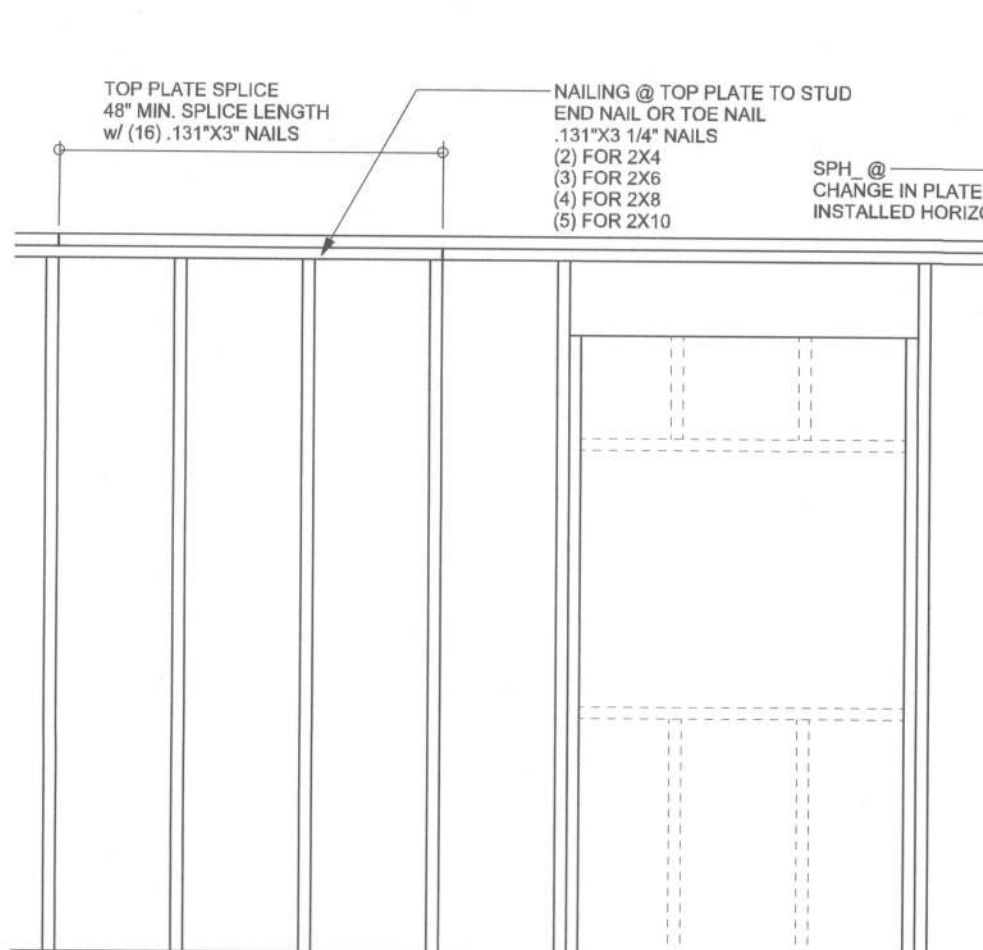
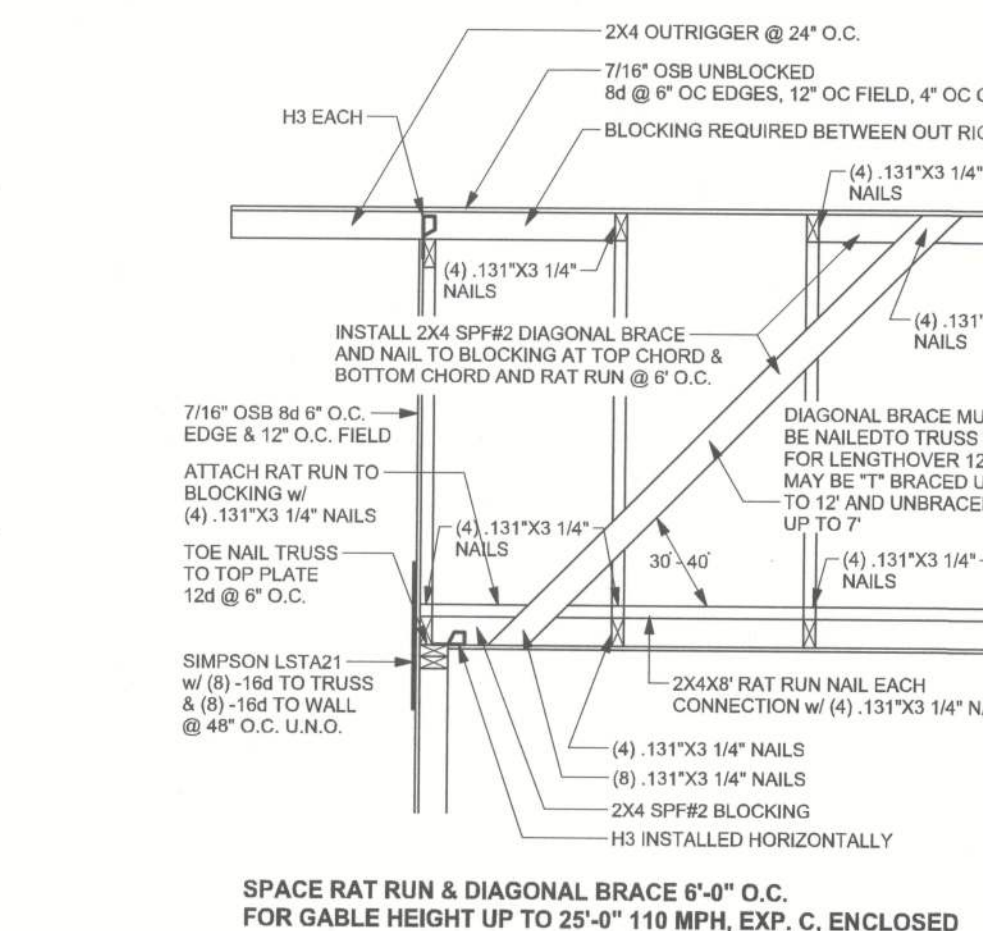

GRADE & SPECIES TABLE

		Fb (psi)	E (10 ⁶ psi)
2x8	SYP #2	1200	1.6
2x10	SYP #2	1050	1.6
2x12	SYP #2	975	1.6
GLB	24F-V3 SP	2400	1.8
LSL	TIMBERSTRAND	1700	1.7
LVL	MICROLAM	2900	2.0
PSL	PARALAM	2900	2.0

EXTERIOR WALL STUD TABLE FOR SPF #2 STUDS

(1) 2x4 @ 16" OC	TO 11'-8" STUD HEIGHT
(1) 2x4 @ 12" OC	TO 13'-0" STUD HEIGHT
(1) 2x6 @ 16" OC	TO 18'-10" STUD HEIGHT
(1) 2x6 @ 12" OC	TO 20'-0" STUD HEIGHT

THIS STUD HEIGHT TABLE IS PER WFCM 2001, TABLE 3.208. EXTERIOR LOAD BEARING & NON-LOAD BEARING STUD LENGTHS RESISTING INTERIOR ZONE WINDLOADS 110 MPH EXPOSURE 8. STUD SPACINGS SHALL BE MULTIPLIED BY 0.85 FOR FRAMING LOCATED WITHIN 4 FEET OF CORNERS FOR END ZONE LOADING. EXAMPLE 16" O.C. x 0.85 = 13.6" O.C.

GENERAL NOTES:

TRUSSES: TRUSSES SHALL BE DESIGNED BY A FLORIDA LICENSED ENGINEER IN ACCORDANCE WITH THE FBCR 2007. TRUSS ENGINEERING SHALL INCLUDE TRUSS DESIGN, TRUSS CONNECTIONS, TEMPORARY AND PERMANENT BRACING DETAILS, TRUSS TO TRUSS CONNECTIONS, AND UPLIFT AND REACTION LOADS FOR ALL BEARING LOCATIONS. TRUSS ENGINEERING IS THE RESPONSIBILITY OF THE TRUSS MANUFACTURER AND SHALL BE SIGNED & SEALED BY THE MANUFACTURER'S DESIGN ENGINEER. IT IS THE BUILDER'S RESPONSIBILITY TO VERIFY THE TRUSS DESIGNER'S FULLY SATISFIED ALL THE ABOVE REQUIREMENTS AND TO SELECT UPLIFT CONNECTIONS BASED ON TRUSS ENGINEERING UPLIFT AND PROVIDE FOOTINGS FOR INTERIOR BEARING WALLS. BUILDER IS TO FURNISH TRUSS ENGINEERING TO WIND LOAD ENGINEER FOR REVIEW OF TRUSS REACTIONS ON THE BUILDING STRUCTURE. STRAP 2X8 RAFTERS WITH MIN UPLIFT CONNECTION 415LB EACH END; 2X8 RAFTERS 700 LB EACH END.

SITE PREPARATION: SITE ANALYSIS AND PREPARATION IS NOT PART OF THIS PLAN. FOUNDATION: CONFIRM THAT THE FOUNDATION DESIGN & SITE CONDITIONS MEET GRAVITY LOAD REQUIREMENTS (ASSUME 1000 PSF BEARING CAPACITY UNLESS VISUAL OBSERVATION OR SOILS TEST PROVES OTHERWISE).

CONCRETE: MINIMUM COMPRESSIVE STRENGTH OF CONCRETE AT 28 DAYS, F_c = 3000 PSI.

WELDED WIRE REINFORCED SLAB: 8" x 8" W1.4 x W1.4, F_y = 85KSI, WELDED WIRE REINFORCEMENT FABRIC (W.W.R.) CONFORMING TO ASTM A185, LOCATED IN MIDDLE OF THE SLAB, SUPPORTED WITH APPROVED MATERIALS OR SUPPORTS AT SPACINGS NOT TO EXCEED 3'.

FIBER CONCRETE SLAB: CONCRETE SLABS ON GROUND CONTAINING SYNTHETIC FIBER REINFORCEMENT, FIBER LENGTH 1/2 INCH TO 2 INCHES. DOSAGE AMOUNTS FROM 0.75 TO 1.5 POUNDS PER CUBIC YARD PER THE MANUFACTURER'S RECOMMENDATIONS. FIBERS TO COMPLY WITH ASTM C 1116. SUPPLIER TO PROVIDE ASTM C 1116 CERTIFICATION OF COMPLIANCE WHEN REQUESTED BY BUILDING OFFICIAL.

CONTROL JOINTS: WHERE SPECIFIED, SAWN CONTROL JOINTS IN SLAB-ON-GRADE SHALL BE CUT IN ACCORDANCE WITH ACI 302. JOINTS SHALL BE CUT WITHIN 12 HOURS OF SLAB PLACEMENT. THE LENGTH / WIDTH RATIOS OF SLAB AREAS SHALL NOT EXCEED 1.5 AND TYPICAL SPACING OF CUTS IS TO BE 12FT. DO NOT CUT WMM OR REINFORCING STEEL. (RECOMMENDED LOCATION OF CONTROL JOINTS IS SUBJECT TO OWNER AND CONTRACTOR'S APPROVAL. THE CONTROL JOINTS ARE NOT INTENDED TO PREVENT CRACKS BUT RATHER TO ENCOURAGE THE SLAB TO CRACK ON A GIVEN LINE).

REBAR: ASTM A 615, GRADE 60, DEFORMED BARS, F_y = 60 KSI. ALL LAP SPICES 40" DB (25" FOR #5 BARS); UNO. ALL REINFORCEMENT SHALL BE DETAILD AND PLACED IN ACCORDANCE WITH ACI 318-06, U.N.O.

GLULAM BEAMS: GLB 24F-V3SP, F_b = 2.4kSI E = 1800KSI. UNO. SUPPLIER MAY SUPPLY AN ALTERNATE BEAM WITH EQUAL PROPERTIES OR MAY SUBMIT THEIR OWN SIZING CALC.

ROOF SHEATHING: ALL ROOFS ARE HORIZONTAL DIAPHRAGMS; 7/16" OSB SHEATHING, UNBLOCKED, APPLIED PERPENDICULAR TO FRAMING, OVER A MINIMUM OF 3 FRAMING MEMBERS, WITH PANEL EDGES STAGGERED, FASTENED WITH 8d COMMON NAILS (131), 100C PANEL EDGES, 120C INTERMEDIATE MEMBERS, SABLE ENDS AND DIAPHRAGM BOUNDARY, 100C, UNO.

STRUCTURAL CONNECTORS: MANUFACTURERS AND PRODUCT NUMBER FOR CONNECTORS, ANCHORS, AND REINFORCEMENT ARE LISTED FOR EXAMPLE NOT ENDORSEMENT. AN EQUIVALENT DEVICE OF THE SAME OR OTHER MANUFACTURER CAN BE SUBSTITUTED FOR ANY DEVICES LISTED IN THE EXAMPLE TABLES AS LONG AS IT MEETS THE REQUIRED LOAD CAPACITIES. MANUFACTURER'S INSTALLATION INSTRUCTIONS MUST BE FOLLOWED TO ACHIEVE RATED LOADS.

ANCHOR BOLTS: A-307 ANCHOR BOLTS WITH MINIMUM EMBEDMENT AS SPECIFIED IN DRAWINGS BUT NO LESS THAN 7" IN CONCRETE OR REINFORCED BOND BEAM OR 15" IN GROUTED CMU.

WASHERS: WASHERS USED WITH 1/2" BOLTS TO BE 2" x 2" x 9/64"; WITH 5/8" BOLTS TO BE 3" x 3" x 9/64"; WITH 3/4" BOLTS TO BE 3" x 3" x 9/64"; WITH 7/8" BOLTS TO BE 3" x 3" x 5/16"; UNO.

NAILS: ALL NAILS ARE COMMON NAILS UNLESS OTHERWISE SPECIFIED OR ACCEPTED BY FBC TEST REPORTS AS HAVING EQUAL STRUCTURAL VALUES.

BUILDER'S RESPONSIBILITY

THE BUILDER AND OWNER ARE RESPONSIBLE FOR THE FOLLOWING, WHICH ARE SPECIFICALLY NOT PART OF THE WIND LOAD ENGINEER'S SCOPE OF WORK.

CONFIRM SITE CONDITIONS, FOUNDATION BEARING CAPACITY, GRADE AND BACKFILL HEIGHT, WIND SPEED AND DEBRIS ZONE, AND FLOOD ZONE.

PROVIDE MATERIALS AND CONSTRUCTION TECHNIQUES, WHICH COMPLY WITH FBCR 2007 REQUIREMENTS FOR THE STATED WIND VELOCITY AND DESIGN PRESSURES.

PROVIDE A CONTINUOUS LOAD PATH FROM TRUSSES TO FOUNDATION. IF YOU BELIEVE THE PLAN OMITTS A CONTINUOUS LOAD PATH CONNECTION, CALL THE WIND LOAD ENGINEER IMMEDIATELY.

VERIFY THE TRUSS MANUFACTURER'S SEALED ENGINEERING INCLUDES TRUSS DESIGN, TRUSS CONNECTIONS, TEMPORARY AND PERMANENT BRACING DETAILS, TRUSS TO TRUSS CONNECTIONS, AND UPLIFT AND REACTION LOADS FOR ALL BEARING LOCATIONS.

VERIFY THE TRUSS MANUFACTURER'S SEALED ENGINEERING INCLUDES TRUSS DESIGN, TRUSS CONNECTIONS, TEMPORARY AND PERMANENT BRACING DETAILS, TRUSS TO TRUSS CONNECTIONS, AND UPLIFT AND REACTION LOADS FOR ALL BEARING LOCATIONS.

VERIFY THE TRUSS MANUFACTURER'S SEALED ENGINEERING INCLUDES TRUSS DESIGN, TRUSS CONNECTIONS, TEMPORARY AND PERMANENT BRACING DETAILS, TRUSS TO TRUSS CONNECTIONS, AND UPLIFT AND REACTION LOADS FOR ALL BEARING LOCATIONS.

VERIFY THE TRUSS MANUFACTURER'S SEALED ENGINEERING INCLUDES TRUSS DESIGN, TRUSS CONNECTIONS, TEMPORARY AND PERMANENT BRACING DETAILS, TRUSS TO TRUSS CONNECTIONS, AND UPLIFT AND REACTION LOADS FOR ALL BEARING LOCATIONS.

VERIFY THE TRUSS MANUFACTURER'S SEALED ENGINEERING INCLUDES TRUSS DESIGN, TRUSS CONNECTIONS, TEMPORARY AND PERMANENT BRACING DETAILS, TRUSS TO TRUSS CONNECTIONS, AND UPLIFT AND REACTION LOADS FOR ALL BEARING LOCATIONS.

VERIFY THE TRUSS MANUFACTURER'S SEALED ENGINEERING INCLUDES TRUSS DESIGN, TRUSS CONNECTIONS, TEMPORARY AND PERMANENT BRACING DETAILS, TRUSS TO TRUSS CONNECTIONS, AND UPLIFT AND REACTION LOADS FOR ALL BEARING LOCATIONS.

VERIFY THE TRUSS MANUFACTURER'S SEALED ENGINEERING INCLUDES TRUSS DESIGN, TRUSS CONNECTIONS, TEMPORARY AND PERMANENT BRACING DETAILS, TRUSS TO TRUSS CONNECTIONS, AND UPLIFT AND REACTION LOADS FOR ALL BEARING LOCATIONS.

VERIFY THE TRUSS MANUFACTURER'S SEALED ENGINEERING INCLUDES TRUSS DESIGN, TRUSS CONNECTIONS, TEMPORARY AND PERMANENT BRACING DETAILS, TRUSS TO TRUSS CONNECTIONS, AND UPLIFT AND REACTION LOADS FOR ALL BEARING LOCATIONS.

VERIFY THE TRUSS MANUFACTURER'S SEALED ENGINEERING INCLUDES TRUSS DESIGN, TRUSS CONNECTIONS, TEMPORARY AND PERMANENT BRACING DETAILS, TRUSS TO TRUSS CONNECTIONS, AND UPLIFT AND REACTION LOADS FOR ALL BEARING LOCATIONS.

VERIFY THE TRUSS MANUFACTURER'S SEALED ENGINEERING INCLUDES TRUSS DESIGN, TRUSS CONNECTIONS, TEMPORARY AND PERMANENT BRACING DETAILS, TRUSS TO TRUSS CONNECTIONS, AND UPLIFT AND REACTION LOADS FOR ALL BEARING LOCATIONS.

VERIFY THE TRUSS MANUFACTURER'S SEALED ENGINEERING INCLUDES TRUSS DESIGN, TRUSS CONNECTIONS, TEMPORARY AND PERMANENT BRACING DETAILS, TRUSS TO TRUSS CONNECTIONS, AND UPLIFT AND REACTION LOADS FOR ALL BEARING LOCATIONS.

VERIFY THE TRUSS MANUFACTURER'S SEALED ENGINEERING INCLUDES TRUSS DESIGN, TRUSS CONNECTIONS, TEMPORARY AND PERMANENT BRACING DETAILS, TRUSS TO TRUSS CONNECTIONS, AND UPLIFT AND REACTION LOADS FOR ALL BEARING LOCATIONS.

VERIFY THE TRUSS MANUFACTURER'S SEALED ENGINEERING INCLUDES TRUSS DESIGN, TRUSS CONNECTIONS, TEMPORARY AND PERMANENT BRACING DETAILS, TRUSS TO TRUSS CONNECTIONS, AND UPLIFT AND REACTION LOADS FOR ALL BEARING LOCATIONS.

VERIFY THE TRUSS MANUFACTURER'S SEALED ENGINEERING INCLUDES TRUSS DESIGN, TRUSS CONNECTIONS, TEMPORARY AND PERMANENT BRACING DETAILS, TRUSS TO TRUSS CONNECTIONS, AND UPLIFT AND REACTION LOADS FOR ALL BEARING LOCATIONS.

VERIFY THE TRUSS MANUFACTURER'S SEALED ENGINEERING INCLUDES TRUSS DESIGN, TRUSS CONNECTIONS, TEMPORARY AND PERMANENT BRACING DETAILS, TRUSS TO TRUSS CONNECTIONS, AND UPLIFT AND REACTION LOADS FOR ALL BEARING LOCATIONS.

VERIFY THE TRUSS MANUFACTURER'S SEALED ENGINEERING INCLUDES TRUSS DESIGN, TRUSS CONNECTIONS, TEMPORARY AND PERMANENT BRACING DETAILS, TRUSS TO TRUSS CONNECTIONS, AND UPLIFT AND REACTION LOADS FOR ALL BEARING LOCATIONS.

VERIFY THE TRUSS MANUFACTURER'S SEALED ENGINEERING INCLUDES TRUSS DESIGN, TRUSS CONNECTIONS, TEMPORARY AND PERMANENT BRACING DETAILS, TRUSS TO TRUSS CONNECTIONS, AND UPLIFT AND REACTION LOADS FOR ALL BEARING LOCATIONS.

VERIFY THE TRUSS MANUFACTURER'S SEALED ENGINEERING INCLUDES TRUSS DESIGN, TRUSS CONNECTIONS, TEMPORARY AND PERMANENT BRACING DETAILS, TRUSS TO TRUSS CONNECTIONS, AND UPLIFT AND REACTION LOADS FOR ALL BEARING LOCATIONS.

VERIFY THE TRUSS MANUFACTURER'S SEALED ENGINEERING INCLUDES TRUSS DESIGN, TRUSS CONNECTIONS, TEMPORARY AND PERMANENT BRACING DETAILS, TRUSS TO TRUSS CONNECTIONS, AND UPLIFT AND REACTION LOADS FOR ALL BEARING LOCATIONS.

VERIFY THE TRUSS MANUFACTURER'S SEALED ENGINEERING INCLUDES TRUSS DESIGN, TRUSS CONNECTIONS, TEMPORARY AND PERMANENT BRACING DETAILS, TRUSS TO TRUSS CONNECTIONS, AND UPLIFT AND REACTION LOADS FOR ALL BEARING LOCATIONS.

VERIFY THE TRUSS MANUFACTURER'S SEALED ENGINEERING INCLUDES TRUSS DESIGN, TRUSS CONNECTIONS, TEMPORARY AND PERMANENT BRACING DETAILS, TRUSS TO TRUSS CONNECTIONS, AND UPLIFT AND REACTION LOADS FOR ALL BEARING LOCATIONS.

VERIFY THE TRUSS MANUFACTURER'S SEALED ENGINEERING INCLUDES TRUSS DESIGN, TRUSS CONNECTIONS, TEMPORARY AND PERMANENT BRACING DETAILS, TRUSS TO TRUSS CONNECTIONS, AND UPLIFT AND REACTION LOADS FOR ALL BEARING LOCATIONS.

VERIFY THE TRUSS MANUFACTURER'S SEALED ENGINEERING INCLUDES TRUSS DESIGN, TRUSS CONNECTIONS, TEMPORARY AND PERMANENT BRACING DETAILS, TRUSS TO TRUSS CONNECTIONS, AND UPLIFT AND REACTION LOADS FOR ALL BEARING LOCATIONS.

VERIFY THE TRUSS MANUFACTURER'S SEALED ENGINEERING INCLUDES TRUSS DESIGN, TRUSS CONNECTIONS, TEMPORARY AND PERMANENT BRACING DETAILS, TRUSS TO TRUSS CONNECTIONS, AND UPLIFT AND REACTION LOADS FOR ALL BEARING LOCATIONS.

VERIFY THE TRUSS MANUFACTURER'S SEALED ENGINEERING INCLUDES TRUSS DESIGN, TRUSS CONNECTIONS, TEMPORARY AND PERMANENT BRACING DETAILS, TRUSS TO TRUSS CONNECTIONS, AND UPLIFT AND REACTION LOADS FOR ALL BEARING LOCATIONS.

VERIFY THE TRUSS MANUFACTURER'S SEALED ENGINEERING INCLUDES TRUSS DESIGN, TRUSS CONNECTIONS, TEMPORARY AND PERMANENT BRACING DETAILS, TRUSS TO TRUSS CONNECTIONS, AND UPLIFT AND REACTION LOADS FOR ALL BEARING LOCATIONS.

VERIFY THE TRUSS MANUFACTURER'S SEALED ENGINEERING INCLUDES TRUSS DESIGN, TRUSS CONNECTIONS, TEMPORARY AND PERMANENT BRACING DETAILS, TRUSS TO TRUSS CONNECTIONS, AND UPLIFT AND REACTION LOADS FOR ALL BEARING LOCATIONS.

VERIFY THE TRUSS MANUFACTURER'S SEALED ENGINEERING INCLUDES TRUSS DESIGN, TRUSS CONNECTIONS, TEMPORARY AND PERMANENT BRACING DETAILS, TRUSS TO TRUSS CONNECTIONS, AND UPLIFT AND REACTION LOADS FOR ALL BEARING LOCATIONS.

VERIFY THE TRUSS MANUFACTURER'S SEALED ENGINEERING INCLUDES TRUSS DESIGN, TRUSS CONNECTIONS, TEMPORARY AND PERMANENT BRACING DETAILS, TRUSS TO TRUSS CONNECTIONS, AND UPLIFT AND REACTION LOADS FOR ALL BEARING LOCATIONS.

VERIFY THE TRUSS MANUFACTURER'S SEALED ENGINEERING INCLUDES TRUSS DESIGN, TRUSS CONNECTIONS, TEMPORARY AND PERMANENT BRACING DETAILS, TRUSS TO TRUSS CONNECTIONS, AND UPLIFT AND REACTION LOADS FOR ALL BEARING LOCATIONS.

VERIFY THE TRUSS MANUFACTURER'S SEALED ENGINEERING INCLUDES TRUSS DESIGN, TRUSS CONNECTIONS, TEMPORARY AND PERMANENT BRACING DETAILS, TRUSS TO TRUSS CONNECTIONS, AND UPLIFT AND REACTION LOADS FOR ALL BEARING LOCATIONS.

VERIFY THE TRUSS MANUFACTURER'S SEALED ENGINEERING INCLUDES TRUSS DESIGN, TRUSS CONNECTIONS, TEMPORARY AND PERMANENT BRACING DETAILS, TRUSS TO TRUSS CONNECTIONS, AND UPLIFT AND REACTION LOADS FOR ALL BEARING LOCATIONS.

VERIFY THE TRUSS MANUFACTURER'S SEALED ENGINEERING INCLUDES TRUSS DESIGN, TRUSS CONNECTIONS, TEMPORARY AND PERMANENT BRACING DETAILS, TRUSS TO TRUSS CONNECTIONS, AND UPLIFT AND REACTION LOADS FOR ALL BEARING LOCATIONS.

VERIFY THE TRUSS MANUFACTURER'S SEALED ENGINEERING INCLUDES TRUSS DESIGN, TRUSS CONNECTIONS, TEMPORARY AND PERMANENT BRACING DETAILS, TRUSS TO TRUSS CONNECTIONS, AND UPLIFT AND REACTION LOADS FOR ALL BEARING LOCATIONS.

VERIFY THE TRUSS MANUFACTURER'S SEALED ENGINEERING INCLUDES TRUSS DESIGN, TRUSS CONNECTIONS, TEMPORARY AND PERMANENT BRACING DETAILS, TRUSS TO TRUSS CONNECTIONS, AND UPLIFT AND REACTION LOADS FOR ALL BEARING LOCATIONS.

VERIFY THE TRUSS MANUFACTURER'S SEALED ENGINEERING INCLUDES TRUSS DESIGN, TRUSS CONNECTIONS, TEMPORARY AND PERMANENT BRACING DETAILS, TRUSS TO TRUSS CONNECTIONS, AND UPLIFT AND REACTION LOADS FOR ALL BEARING LOCATIONS.

VERIFY THE TRUSS MANUFACTURER'S SEALED ENGINEERING INCLUDES TRUSS DESIGN, TRUSS CONNECTIONS, TEMPORARY AND PERMANENT BRACING DETAILS, TRUSS TO TRUSS CONNECTIONS, AND UPLIFT AND REACTION LOADS FOR ALL BEARING LOCATIONS.

VERIFY THE TRUSS MANUFACTURER'S SEALED ENGINEERING INCLUDES TRUSS DESIGN, TRUSS CONNECTIONS, TEMPORARY AND PERMANENT BRACING DETAILS, TRUSS TO TRUSS CONNECTIONS, AND UPLIFT AND REACTION LOADS FOR ALL BEARING LOCATIONS.

VERIFY THE TRUSS MANUFACTURER'S SEALED ENGINEERING INCLUDES TRUSS DESIGN, TRUSS CONNECTIONS, TEMPORARY AND PERMANENT BRACING DETAILS, TRUSS TO TRUSS CONNECTIONS, AND UPLIFT AND REACTION LOADS FOR ALL BEARING LOCATIONS.

REVISIONS	



FOUNDATION: CONFIRM THAT THE FOUNDATION DESIGN & SITE CONDITIONS MEET GRAVITY LOAD REQUIREMENTS (ASSUME 1000 PSF BEARING CAPACITY UNLESS VISUAL OBSERVATION OR SOILS TEST PROVES OTHERWISE).

CONCRETE: MINIMUM COMPRESSIVE STRENGTH OF CONCRETE AT 28 DAYS, F_c = 3000 PSI.

WELDED WIRE REINFORCED SLAB: 8" x 8" W1.4 x W1.4, F<