



STATE OF FLORIDA  
DEPARTMENT OF ENVIRONMENTAL PROTECTION  
ONSITE SEWAGE TREATMENT AND DISPOSAL  
SYSTEM (OSTDS)

PERMIT NO. 23-0857  
DATE PAID: \_\_\_\_\_  
FEE PAID: 60.00  
RECEIPT #: \_\_\_\_\_

APPLICATION FOR CONSTRUCTION PERMIT

APPLICATION FOR:

☒ New System ☒ Existing System ☐ Holding Tank ☐ Innovative  
☐ Repair ☐ Abandonment ☐ Temporary ☐ \_\_\_\_\_

APPLICANT: Robert O Hastings

EMAIL: rbortg10@gmail.com

AGENT: \_\_\_\_\_

TELEPHONE: \_\_\_\_\_

MAILING ADDRESS: 275 SW Thistlewood Lane, Fort White, FL 32038

TO BE COMPLETED BY APPLICANT OR APPLICANT'S AUTHORIZED AGENT. SYSTEMS MUST BE CONSTRUCTED BY A PERSON LICENSED PURSUANT TO 489.105(3)(m) OR 489.552, FLORIDA STATUTES. IT IS THE APPLICANT'S RESPONSIBILITY TO PROVIDE DOCUMENTATION OF THE DATE THE LOT WAS CREATED OR PLATTED (MM/DD/YY) IF REQUESTING CONSIDERATION OF STATUTORY GRANDFATHER PROVISIONS.

PROPERTY INFORMATION

OSTDS REMEDIATION PLAN? ☐ Y ☒ N

LOT: 18 BLOCK: 34-68-1604-56-118 SUBDIVISION: Tharwood PLATTED: \_\_\_\_\_

PROPERTY ID #: 63562 ZONING: \_\_\_\_\_ I/M OR EQUIVALENT: ☐ Y ☐ N

PROPERTY SIZE: 1.2 ACRES WATER SUPPLY: ☒ PRIVATE PUBLIC ☐  $\leq 2000$  GPD ☐  $> 2000$  GPD

IS SEWER AVAILABLE AS PER 381.0065, FS? ☒ Y ☐ N DISTANCE TO SEWER: 120 FT

PROPERTY ADDRESS: 275 SW Thistlewood Ln, Ft. White, FL 32038

DIRECTIONS TO PROPERTY:  Hwy 18 to Thistlewood Lane

BUILDING INFORMATION

☒ RESIDENTIAL ☐ COMMERCIAL

Unit No.	Type of Establishment	No. of Bedrooms	Building Area Sqft	Commercial/Institutional System Design Table I, Chapter 62-6, FAC
1	<u>storage</u>	<u>0</u>	<u>2660</u>	
2				
3				
4				

☐ Floor/Equipment Drains ☐ Other (Specify) \_\_\_\_\_

SIGNATURE: Robert O Hastings

DATE: 12/11/23

DEP 4015, 06-21-2022 (Obsoletes previous editions which may not be used)

Incorporated 62-6.004, FAC

Page 1 of 4



STATE OF FLORIDA  
DEPARTMENT OF ENVIRONMENTAL PROTECTION  
APPLICATION FOR CONSTRUCTION PERMIT

Permit Application Number 23-0857

----- PART II - SITEPLAN -----

Scale: Each block represents 10 feet and 1 inch = 40 feet.

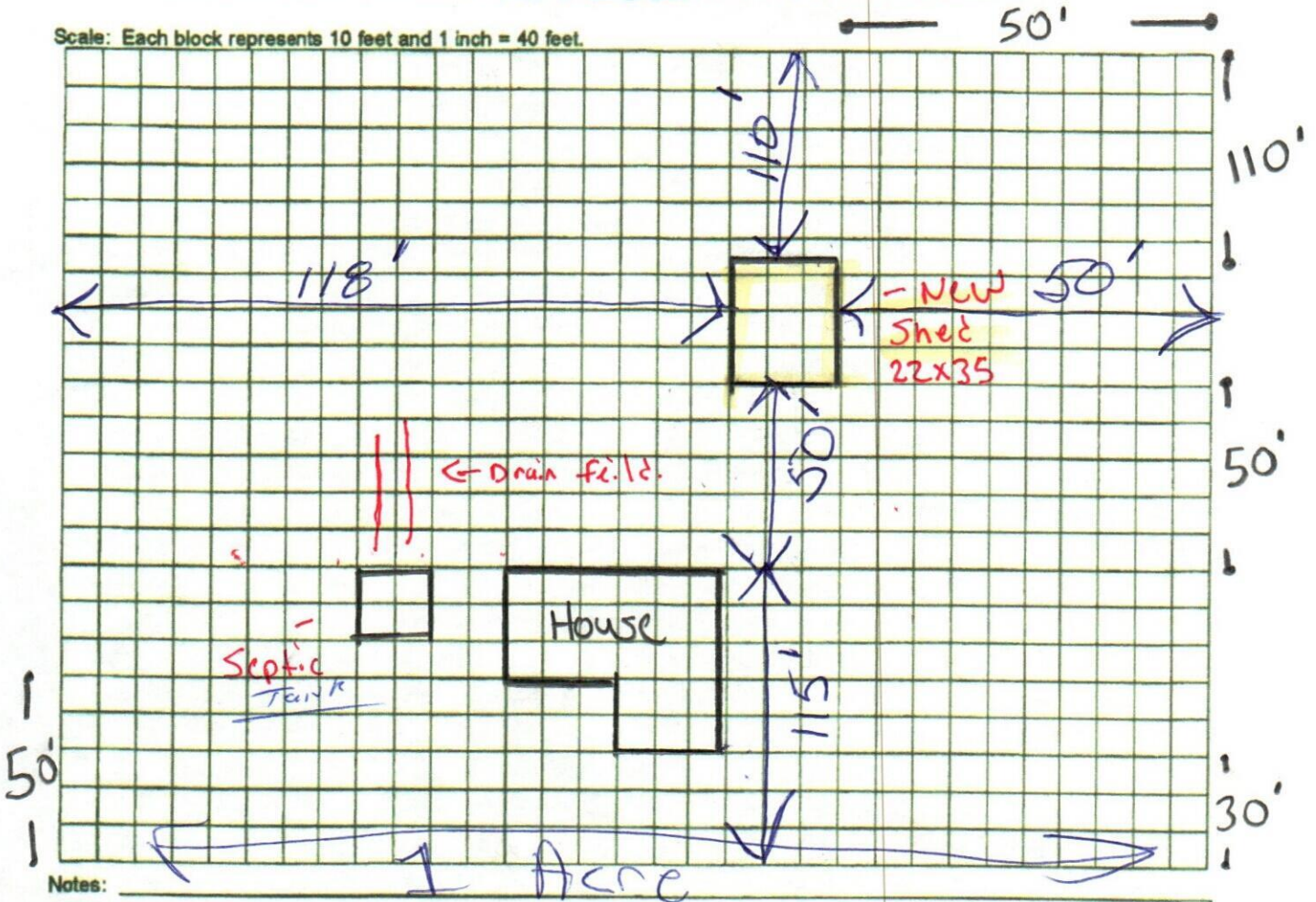

Notes:

Site Plan submitted by: Robert Hastings

Plan Approved ☒

Not Approved ☐

By [Signature]

Date 12/18/23

[Signature] County Health Department

12/18/23

ALL CHANGES MUST BE APPROVED BY THE COUNTY HEALTH DEPARTMENT

DEP 4015, 06-21-2022 (Obsoletes previous editions which may not be used)

Incorporated: 62-6.004, F.A.C.