

FRONT SIDE OF HOME FACING RIVER
FRONT DECK 8'x10' AS SHOWN. DECK
TO CONFORM TO SOUTHERN BUILDING CODE

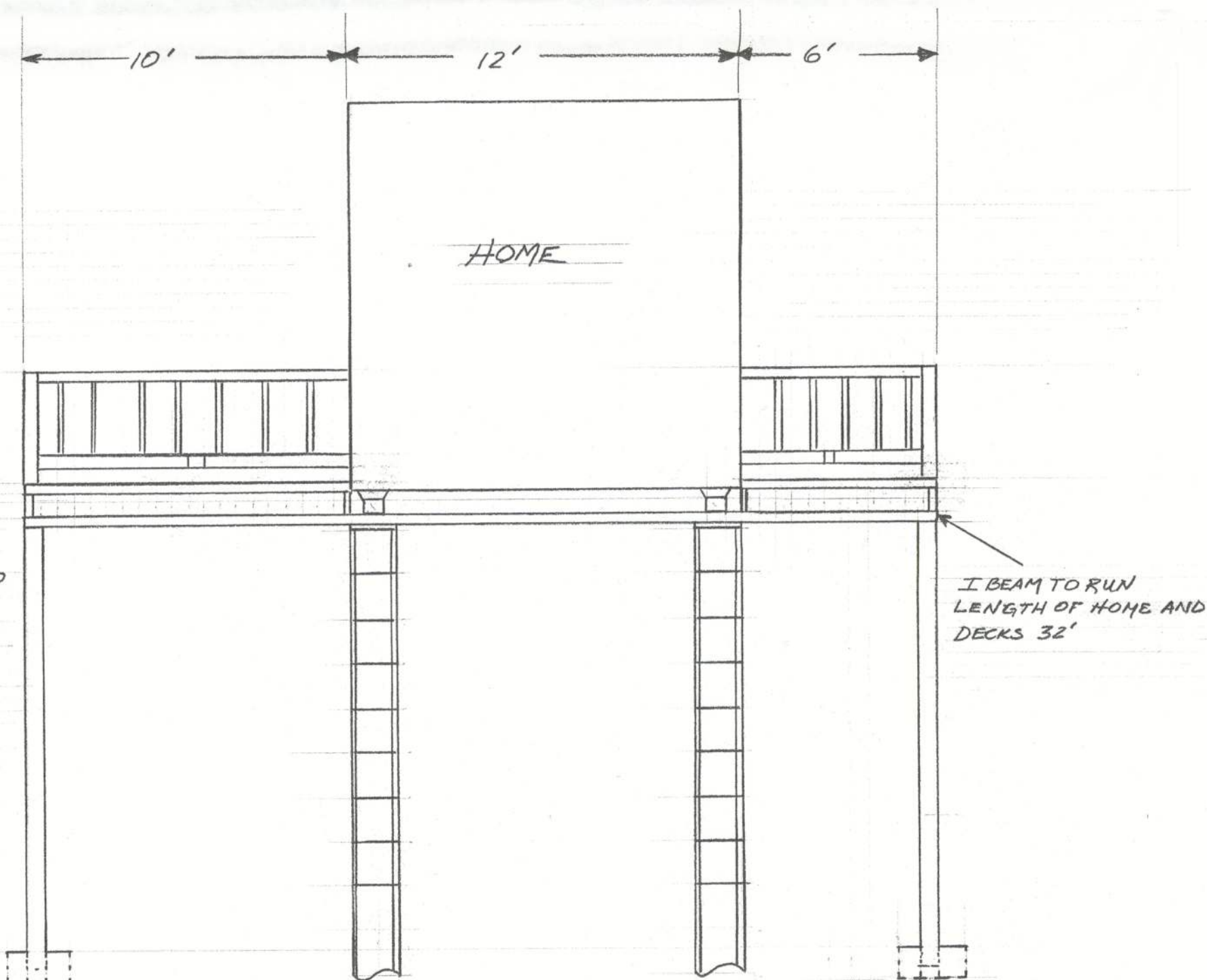
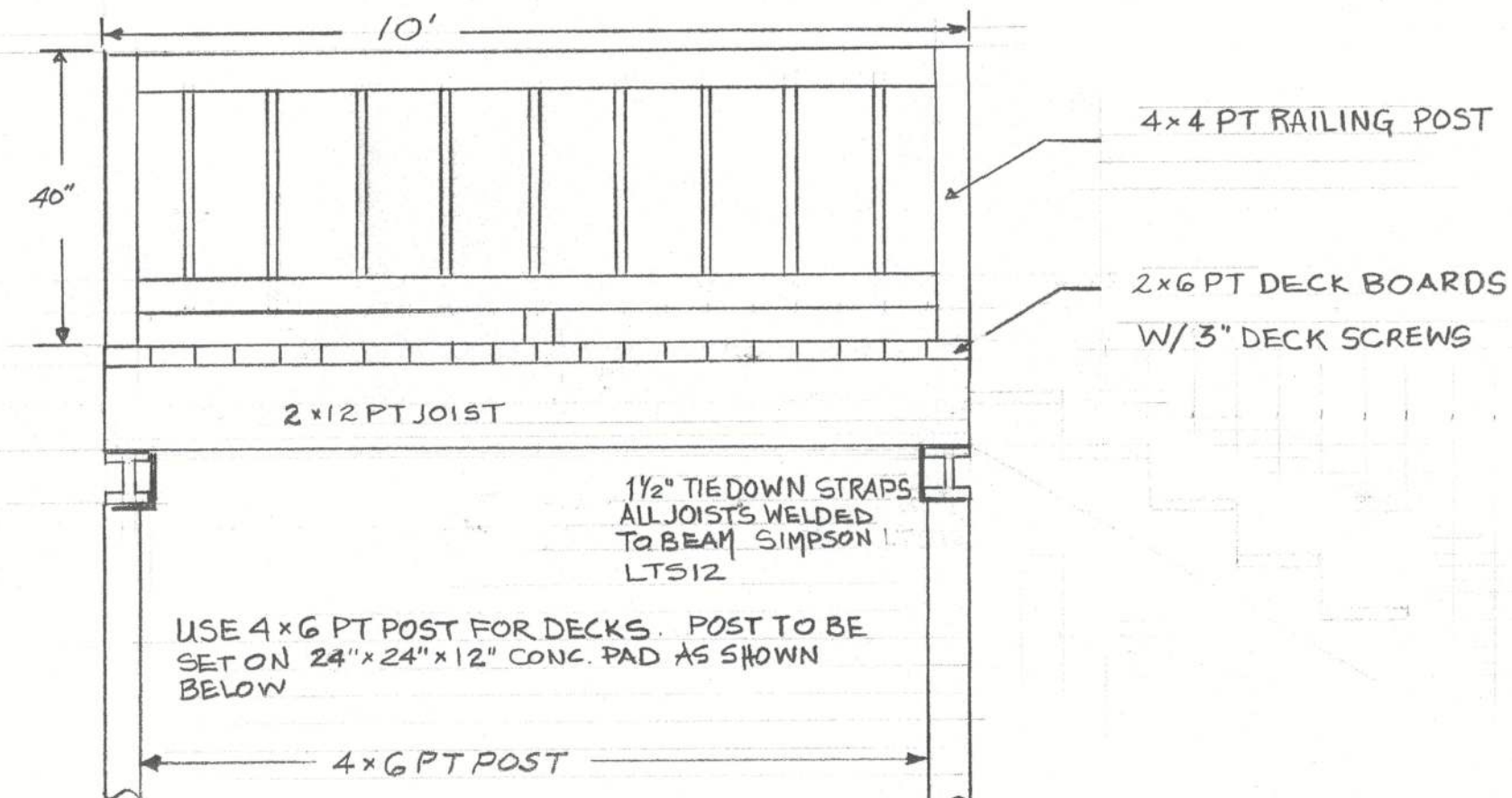

NOTE: DECK SHOWN W/O
STAIRS & 10' DECK
FACING RIVER.
CONTRACTOR TO BUILD
DECKS & STAIRS AS PER
SOUTHERN BUILDING
CODE

4x6 PT POST SET IN
24" x 24" x 12" CONC.
USE TAR ON POST AT
SURFACE AND BELOW

A = 4"
B = 6"
C = 0.426"
D = 0.271"

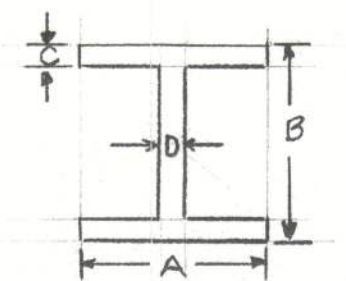

I-BEAM SHOWN NOT TO SCALE. DIMENSION IN TABLE
ARE ACTUAL. DIMENSION FROM AMERICAN STANDARD BEAMS

David Steel
5 Sept 2012

ROBERT'S PROJECT			
SCALE: VARIES	APPROVED BY:	DRAWN BY DAS	
DATE: 5 AUG 2012		REVISED	
			DRAWING NUMBER
			3