

Columbia County Building Permit Application

Revised 9-23-01

For Office Use Only Application # 0710-05 Date Received 10/1 By JW Permit # 26305
 Application Approved by - Zoning Official afs Date 10/2/07 Plans Examiner OK JH Date 10-2-07
 Flood Zone N/A Development Permit RR Zoning RR Land Use Plan Map Category RVL
 Comments _____

Applicants Name PEELER POOLS, INC.
9878 SOUTH US HIGHWAY 441 Phone 755 2848
LAKE CITY, FL 32025
 Address 386-755-2848
 Owners Name Steinruck, Nick & Angela Phone 961-9020
 911 Address 427 SW Shortleaf Drive Lake City FL 32024
 Contractors Name PEELER POOLS, INC.
9878 SOUTH US HIGHWAY 441 Phone 755 2848
LAKE CITY, FL 32025
386-755-2848
 Fee Simple Owner Name & Address _____
 Bonding Co. Name & Address _____
 Architect/Engineer Name & Address _____
 Mortgage Lenders Name & Address _____

Circle the correct power company - FL Power & Light - Clay Elec. - Suwannee Valley Elec. - Progressive Energy

Property ID Number 21481603080009 HX Estimated Cost of Construction 26,000

Subdivision Name Forest Country Lot 1 Block B Unit _____ Phase 2

Driving Directions Hwy 90 W - (L) SR 247 - (R) Forest Country -
(L) at stop sign - (R) Longleaf - last house on left BEFORE
Shortleaf # 427 Shortleaf.

Type of Construction Swimming Pool Number of Existing Dwellings on Property 1

Total Acreage _____ Lot Size _____ Do you need a - Culvert Permit or Culvert Waiver or Have an Existing Dr

Actual Distance of Structure from Property Lines - Front 100 ft Side 100 ft Side 20 ft Rear 20 ft

Total Building Height _____ Number of Stories _____ Heated Floor Area _____ Roof Pitch _____

Application is hereby made to obtain a permit to do work and installations as indicated. I certify that no work or installation has commenced prior to the issuance of a permit and that all work be performed to meet the standards of all laws regulating construction in this jurisdiction.

OWNERS AFFIDAVIT: I hereby certify that all the foregoing information is accurate and all work will be done in compliance with all applicable laws and regulating construction and zoning.

WARNING TO OWNER: YOUR FAILURE TO RECORD A NOTICE OF COMMENCEMENT MAY RESULT IN YOU PAYING TWICE FOR IMPROVEMENTS TO YOUR PROPERTY. IF YOU INTEND TO OBTAIN FINANCING, CONSULT WITH YOUR LENDER OR ATTORNEY BEFORE RECORDING YOUR NOTICE OF COMMENCEMENT.

Owner Builder or Agent (Including Contractor) _____

STATE OF FLORIDA
COUNTY OF COLUMBIA

Sworn to (or affirmed) and subscribed before me

this 26th day of September 2006.

Contractor Signature _____
 Contractors License Number CPC057105
 Competency Card Number _____
 NOTARY STAMP/SEAL

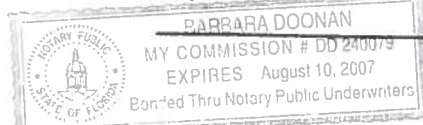



P384 d850

Distance to property line
20 ft +
100 ft +
100 ft +
30 ft +

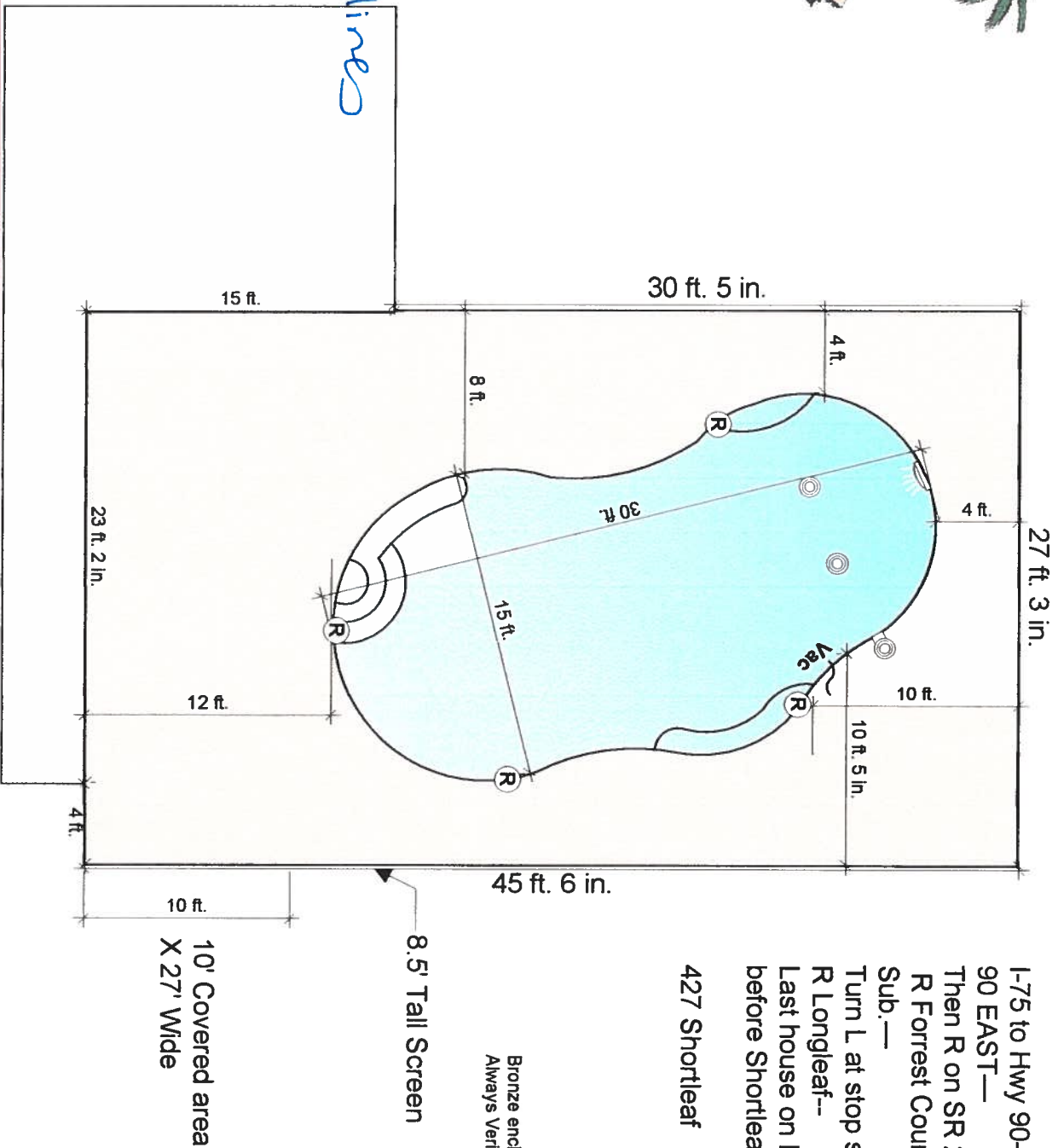

I-75 to Hwy 90-- take
90 EAST--
Then R on SR 247---
R Forrest Country
Sub.--
Turn L at stop sign---
R Longleaf--
Last house on L
before Shortleaf
427 Shortleaf

FILE COPY

SCALE: 1/8" = 1'

Peeler Pools
9878 S U.S.Hwy 441
Lake City FL 32025
Phone: 386-755-2848
Fax: 386-755-5577
Designed by:
Raymond Peeler
8/13/2007
Steinruck
427 SW Shortleaf Dr
Lake City FL 32024

@ CAM112M01	S	CamaUSA Appraisal System		Columbia County
10/03/2007 12:53		Legal Description Maintenance	34000	Land 001 *
Year T Property		Sel		AG 000
2007 R 21-4S-16-03080-009		...	162801	Bldg 001
427 SHORT LEAF DR SW LAKE CITY			3738	Xfea 001
HX		STEINRUCK NICK A & ANGELIA C	200539	TOTAL B*

1	LOT 1 BLOCK B FOREST COUNTRY	SECOND ADDITION. ORB 707-816,	2
3	WD 1014-1382.		4
5			6
7			8
9			10
11			12
13			14
15			16
17			18
19			20
21			22
23			24
25			26
27			28

Mnt 5/12/2004 KYLIE

F1=Task F3=Exit F4=Prompt F10=GoTo PgUp/PgDn F24=More