

Pena Resd.
 804 N.W. Milo Terr.
 Lake City 32055

Screen/Patio / Pool
 County: Columbia
 Wind: 120
 Exposure Cat:
 Imp. Fac:
 Design:

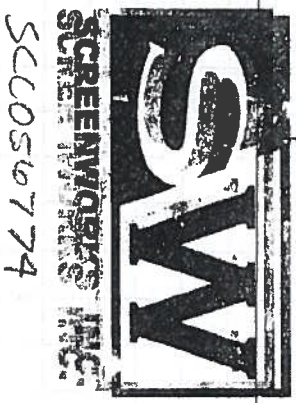

In the event of a conflict in member sizes shown on the plans and the general notes, the contractor must utilize the more stringent member size requirements. Engineer Michael Thompson, P.E. 47509/CA30930

12/2/15

PURLINS ATTACHED TO BEAM W/
(3) #10 2" SMS, PLACE WASHER
UNDER SCREW IN GUSSET CORNER

1" GUTTER STRAP IS ATTACHED TO GUTTER WITH #10 1" & INTO FASCIA WITH #10 2" PER STRAP 24" O.C. MAX 4" FROM EACH UPRIGHT

SMB

2X2 IS ATTACHED TO STRUCTURE W/
4" X 1/4" TAPCONS (#10 4" IF TO WOOD
STRUCTURE) 6" FROM ENDS 24" O.C.

2X2 ANGLE IS ATTACHED TO BEAM
WITH (2) #10 I" & INTO BLOCK WITH
2-1/4" X 1/4" TAPCON

DESIGN STATEMENT

METAL IS .046 THICKNESS OR GREATER, ALLOY IS 6005-T5
ALL TAPCONS SHALL PROVIDE MINIMUM OF 1 1/8" CONCRETE EMBEDMENT DEPTH

THIS STRUCTURE HAS BEEN DESIGNED IN ACCORDANCE TO MEET THE REQUIREMENTS OF THE 2017

PHONE: 407-734-1470

FAX: 407-734-1790

NOTES

1. GUSSET DIMENSIONS, ARE MINIMUM 8" ON BOTH SIDE OF BEAM, MAY BE INTERNAL OR EXTERNAL.
2. AS BEAM SIZE CHANGES ADD OR SUBTRACT TO MAINTAIN A 1-1/4" O.C.
3. SCREW SPACING W/ (10) SCREWS
4. GUSSET LENGTH REMAINS CONSTANT.
5. WIDTHS CHANGE TO MATCH BEAM SIZE

3' MAX RISE

3/16" GUSSET

(10) #10 SMS 1-1/4 O.C.

3/16" GUSSET

(10) #10 SMS 1-1/4 O.C.

MICHAEL THOMPSON

4401 VINELAND ROAD

SUITE A6

ORLANDO, FL 32811

P.E. # 47509

CA#30930

ALUMINUM SCREEN DESIGN

SIDE WALL CONNECTION DETAILS WHEN PURLIN DOESNT HIT POST

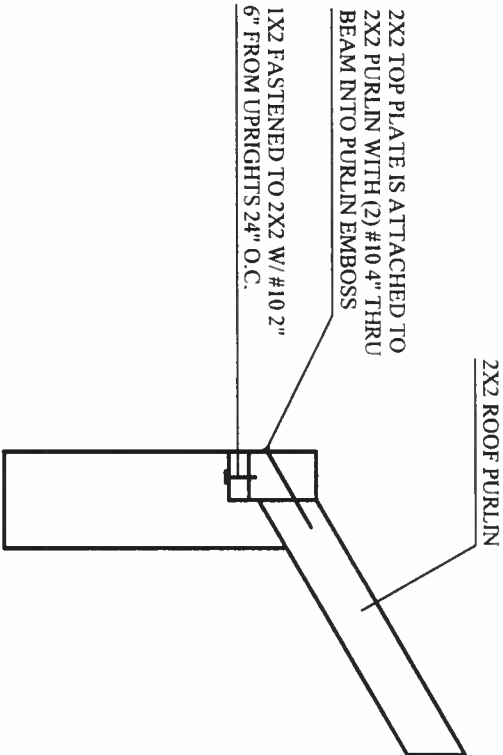

SIDE WALL CONNECTION DETAILS WHEN PURLIN DOESNT HIT POST

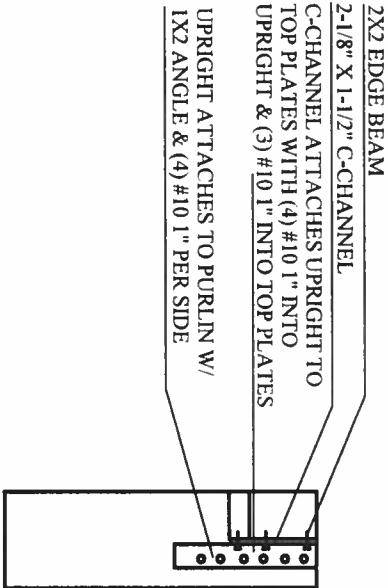

DOOR FULL Z OR DOOR JAM STANDARD 2X3 POST OR DOOR JAMB

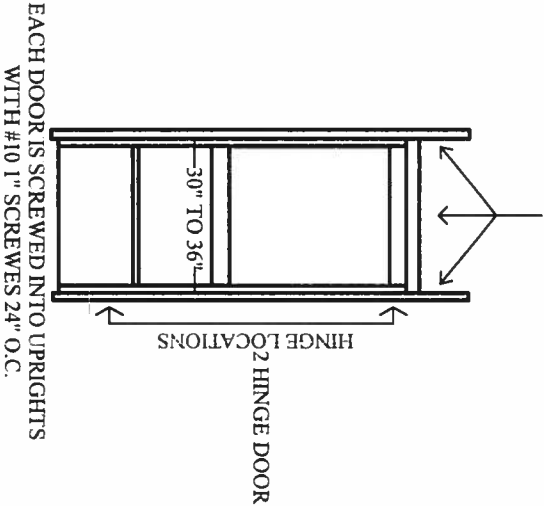

SLOPED PURLIN CONNECTION DETAIL

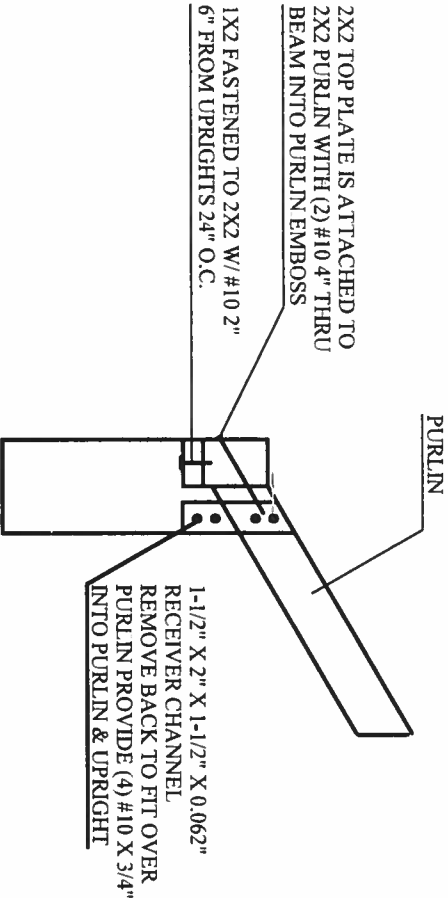

FRONT WALL TO BEAM

SMB BEAM IS NOTCHED OVER UPRIGHT

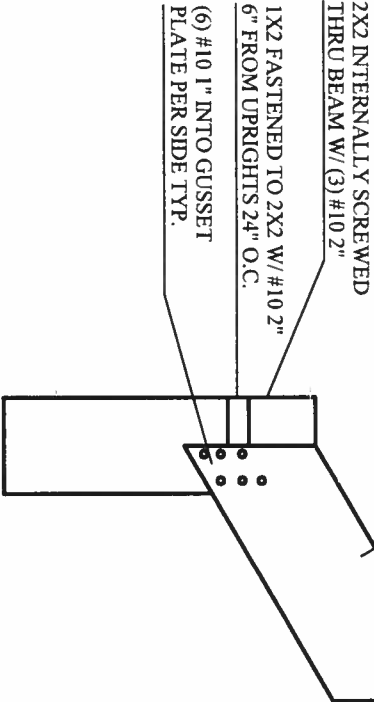

ALUMINUMSCREENDESIGN.COM

ALUMINUMSCREENDESIGN

@YAHOO.COM

PHONE: 407-734-1470

FAX: 407-734-1790

DESIGN STATEMENT

METAL IS .046 THICKNESS OR GREATER, ALLOY IS 6005-T5

ALL TAPCONS SHALL PROVIDE MINIMUM OF 1 1/8" CONCRETE EMBEDMENT DEPTH

THIS STRUCTURE HAS BEEN DESIGNED IN ACCORDANCE TO MEET THE REQUIREMENTS OF THE 2017 FLORIDA BUILDING CODE FOR OPEN AND SEMI-OPEN STRUCTURES AND SHALL WITH STAND ULTIMATE WIND SPEEDS OF 120 MPH (FOR 3 SECOND GUSTS) NOMINAL SPEED 93.6 MPH UP TO A 15FT ROOF HEIGHT, FACTOR OF 1.0, AND EXPOSURE C, RISK CATEGORY I. CONTRACTOR SHALL FIELD VERIFY ALL PLANS DIMENSIONS PRIOR TO MATERIAL PURCHASE. FABRICATION AND CONSTRUCTION CONTRACTOR SHALL NOTIFY THE ENGINEER IMMEDIATELY SHOULD SITE CONDITIONS DIFFER FROM CONSTRUCTION PLANS

MICHAEL THOMPSON

4401 VINELAND ROAD

SUITE A6

ORLANDO, FL 32811

P.E. # 47509

CA#30930

ALUMINUM SCREEN DESIGN

CABLE DETAIL

SEE GENERAL NOTES
& DESIGN STANDARD
FOR ADDITIONAL
INFORMATION (TYP.)

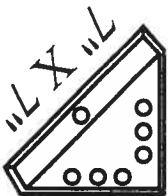

1/8" THICK ANGLE BRACKET
ATTACHED TO UPRITE AND
GIRT WITH (6) #10 1"

5/16" EYE BOLT WELDED
CLOSED WITH DOUBLE NUTS
COMPRESSION SLEEVE

SIDE VIEW
COMPRESSION SLEEVE
3"A.S.T.M. A-36 STEEL CLIP
WITH 2 2 1/4"X1/4 TAPCONS

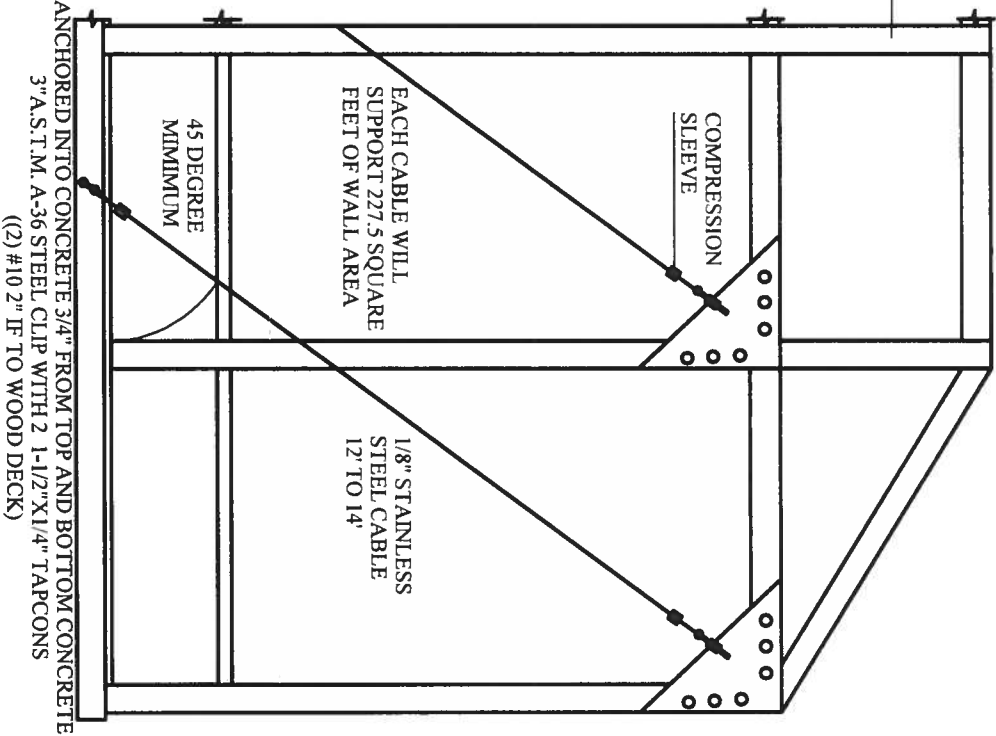

ANCHORED INTO CONCRETE 3/4" FROM TOP AND BOTTOM CONCRETE
3"A.S.T.M. A-36 STEEL CLIP WITH 2 1-1/2"X1/4" TAPCONS
(2) #10 2" IF TO WOOD DECK

IT SHALL BE THE RESPONSIBILITY OF THE CONTRACTOR TO INFORM THE HOMEOWNER THAT THE CABLES AND CABLE
ATTACHMENT MUST BE INSPECTED BY THE HOMEOWNER AT LEAST TWICE A YEAR TO ELIMINATE ANY DEFICIENCIES ASSOCIATED
WITH TENSION SLACK AND/OR CORROSION AND IF NECESSARY TO MAKE CORRECTIVE REPAIRS TO MAINTAIN THE CABLE FULL TENSION
(NO SLACK) DESIGNED FOR STRUCTURAL LATERAL STABILITY

K BRACING DETAIL

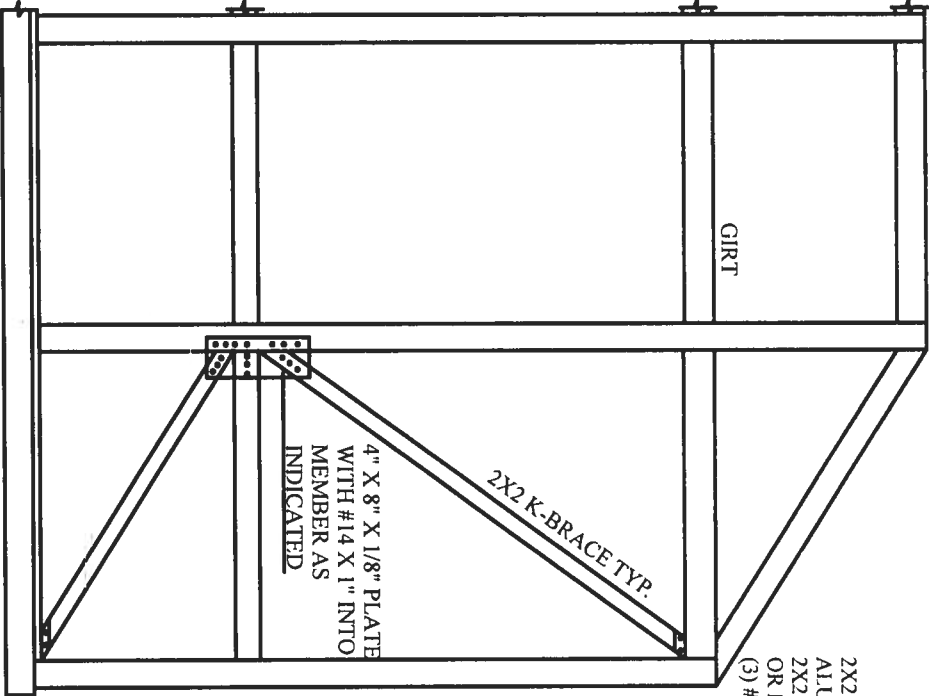

2X2 K BRACE IS ATTACHED TO
ALUMINUM STRUCTURE WITH
2X2" C CHANNEL & (6) #10 1"
OR BLIND SCREWED WITH
(3) #10 2" PER END

4" X 8" X 1/8" PLATE
WITH #14 X 1" INTO
MEMBER AS
INDICATED

DESIGN STATEMENT

METAL IS .046 THICKNESS OR GREATER, ALLOY IS 6005-T5
ALL TAPCONS SHALL PROVIDE MINIMUM OF 1 1/8" CONCRETE EMBEDMENT DEPTH

ALUMINUMSCREENDESIGN.COM
ALUMINUMSCREENDESIGN
@YAHOO.COM
PHONE: 407-734-1470
FAX: 407-734-1790

THIS STRUCTURE HAS BEEN DESIGNED IN ACCORDANCE TO MEET THE REQUIREMENTS OF THE 2017
FLORIDA BUILDING CODE FOR OPEN AND SEMI-OPEN STRUCTURES AND SHALL WITH STAND ULTIMATE WIND SPEEDS OF 110 MPH
(FOR 3 SECOND GUSTS) NOMINAL SPEED 85.8 MPH UP TO A 15FT ROOF HEIGHT, FACTOR OF 1.0, AND EXPOSURE C, RISK CATEGORY 1.
CONTRACTOR SHALL FIELD VERIFY ALL PLANS DIMENSIONS PRIOR TO MATERIAL PURCHASE, FABRICATION AND CONSTRUCTION
CONTRACTOR SHALL NOTIFY THE ENGINEER IMMEDIATELY SHOULD SITE CONDITIONS DIFFER FROM CONSTRUCTION PLANS

MICHAEL THOMPSON
4401 VINELAND ROAD
SUITE A6

ORLANDO, FL 32811
S.P.E. # 47509
CA#30930

ALUMINUM SCREEN DESIGN

SIDE WALL DETAIL

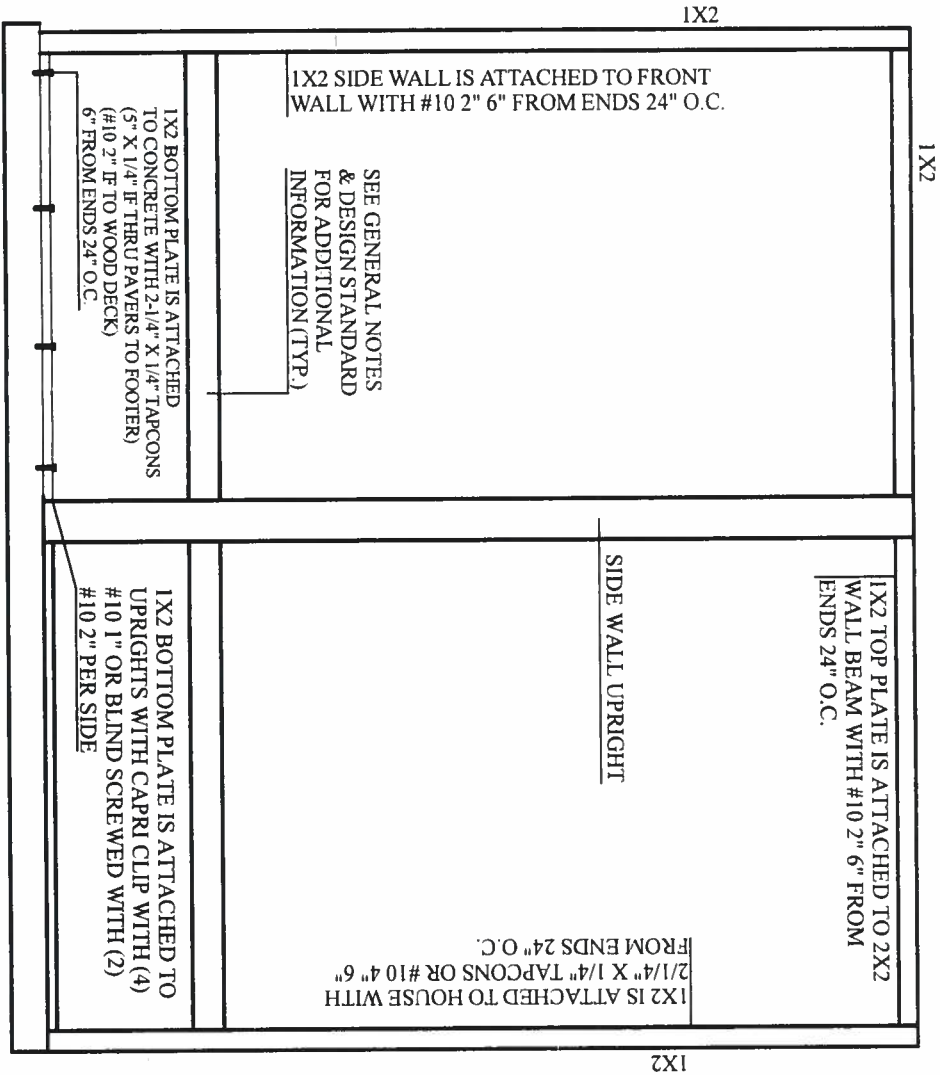

CHAIR RAIL & KICK PLATE DETAIL

CHAIR RAILS & GIRTS ARE ATTACHED W/ INTERNAL CLIPS W/ (4) #10 1" CAPRI CLIPPED, W/ RECEIVING CHANNEL & (6) #10 1" W/ (8) #10 1" OR BLIND SCREWED W/ (3) #10 2"

KICK PLATE IS ATTACHED TO STRUCTURE WITH #10 1" 6" FROM ENDS 18" O.C. (OPTIONAL)

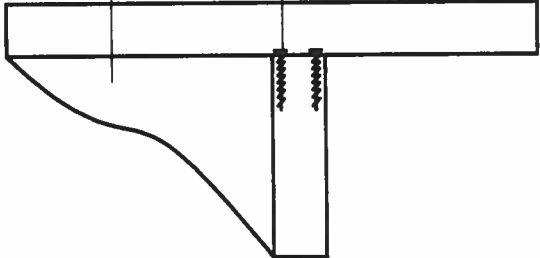

BLIND CLIP & CAPRI CLIP DETAILS

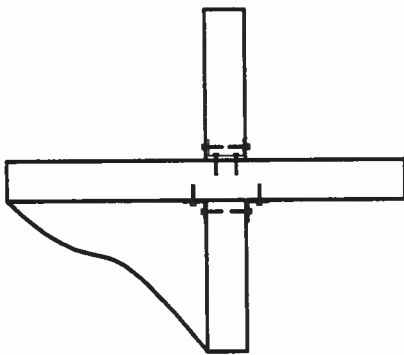

SELF MATING UPRIGHT DETAILS

UPRIGHT SHALL BE STITCHED W/ #10 X 1" SELF TAPPING SCREWS 12" O.C. TYP.

RECEIVING CHANNEL CLIP DETAILS

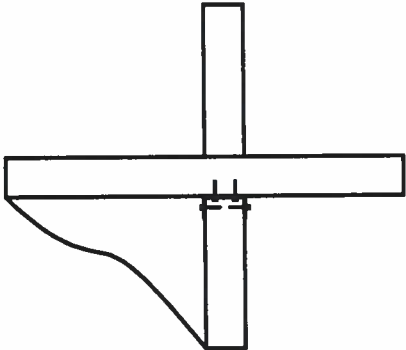

1X2 INTERNALLY SCREWED THRU 2X2X1/8" ANGLE TO UPRIGHT W/ (2) #10 X 1-1/2" FASTEN 1X2 TO CONCRETE W/ 3" X 1/4" (5" X 1/4" TAPCONS IF THRU PAVERS) (#10 2" IF TO WOOD DECK) SCREW CONCRETE ANCHOR 6" FROM UPRIGHT 24" O.C.

(2) #10 1" PER SIDE

MIN 4" SLAB 2500 PSI CONCRETE W/ FIBERMESH

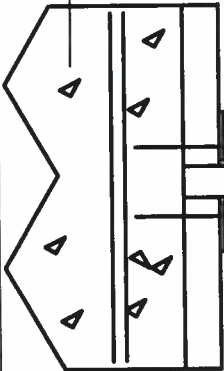

DESIGN STATEMENT

METAL IS .046 THICKNESS OR GREATER, ALLOY IS 6005-T5
ALL TAPCONS SHALL PROVIDE MINIMUM OF 1 1/8" CONCRETE EMBEDMENT DEPTH

MICHAEL THOMPSON
4401 VINELAND ROAD
SUITE A6

THIS STRUCTURE HAS BEEN DESIGNED IN ACCORDANCE TO MEET THE REQUIREMENTS OF THE 2017 (6TH EDITION)

FLORIDA BUILDING CODE FOR OPEN AND SEMI-OPEN STRUCTURES AND SHALL WITH STAND ULTIMATE WIND SPEEDS OF 120 MPH (FOR 3 SECOND GUSTS) NOMINAL SPEED 93.6 MPH UP TO A 15FT ROOF HEIGHT. FACTOR OF 1.0, AND EXPOSURE C, RISK CATEGORY 1. CONTRACTOR SHALL FIELD VERIFY ALL PLANS DIMENSIONS PRIOR TO MATERIAL PURCHASE. FABRICATION AND CONSTRUCTION CONTRACTOR SHALL NOTIFY THE ENGINEER IMMEDIATELY SHOULD SITE CONDITIONS DIFFER FROM CONSTRUCTION PLANS

ALUMINUMSCREENDESIGN.COM
ALUMINUMSCREENDESIGN

@YAHOO.COM

PHONE: 407-734-1470

FAX: 407-734-1790

ORLANDO, FL 32811

P.E. # 47509

CA#30930