



Steel Buildings & Structures

820 Reeves Drive (Mailing Address: PO Box 1287)

Mount Airy, North Carolina, 27030

877.272.8276

(336) 551-3449

#### Customer Details

Customer Name	Sarah & David Ripple
Billing Address	3309 SW Mauldin Ave
Billing City, State, ZIP	Lake City, FL, 32024
Phone Number	386-397-0896
Secondary Phone Number	386-397-0896
Email	smith-ripples@columbiak12.com

#### Delivery and Installation Details

Delivery Contact Person	Sarah & David Ripple
Delivery Address	3309 SW Mauldin Ave
Delivery City, State, ZIP	Lake City, FL, 32024

#### Dealer or Sales Rep

Dealer Name	Elite Outdoor Buildings
Dealer Address	2008 Ohio Ave N, Live Oak, FL, 32064
Dealer Email	sales@eliteoutdoorbuildings.com
Dealer Phone	386-364-1364
Dealer or Sales Rep Name	Tyler

#### Order Details

Date:	Thu, Jul 30, 2020
-------	-------------------

#### Additional Comments

Installation Surface: Cement

Power Available: No

Site Ready: No

Jobsite Level: No

#### Building Images

#1595623006125245

Building Images



Perspective View



Front



Left Side



Right Side



Back

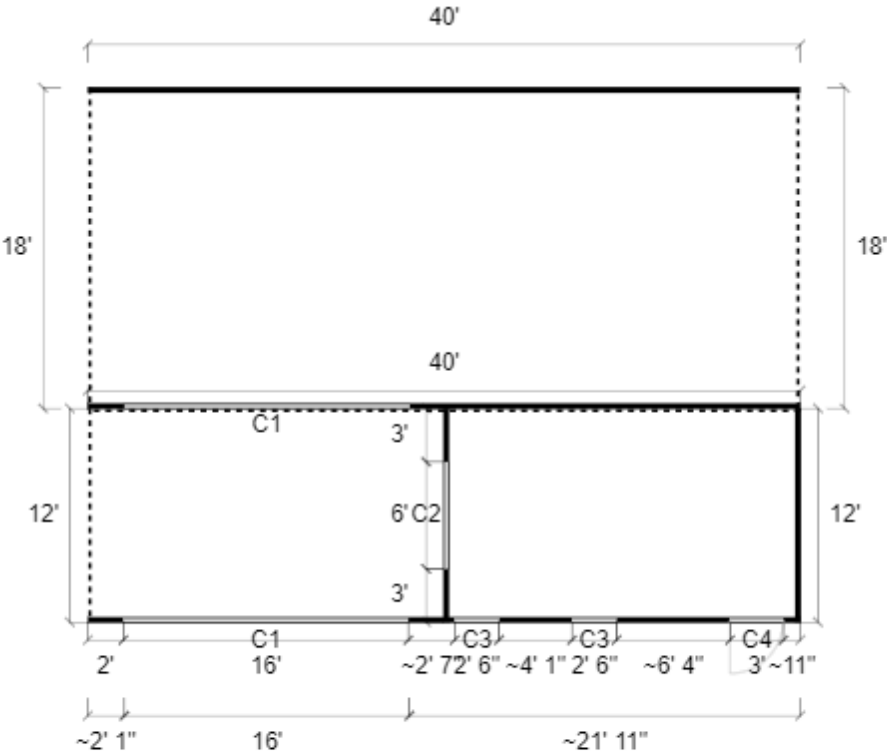

Symbol Legend:

- C1: Custom Size
- C2: 6'x6' Certified Garage Door
- C3: 30W x 30H Windows
- C4: Walk-In Door (36x80)

Section	Description	Quantity	Amount
	<b>Structure Details</b>		
Center	Style: Straight Line Barn	1	-
	Roof: Evergreen	1	-
	Trim: Evergreen	1	-
	Gable End Siding: Pebble Beige	1	-
	Side Wall Siding: Pebble Beige	1	-
	Base Price: 18'x41'	1	\$3,195.00
	Roof Style: Vertical Style	1	-
	Roof Overhang: 6"	1	-
	Leg Style: Standard	1	-
	Gauge: 14-Gauge Framing	1	-
	Brace: Standard Brace	1	-
	Leg Height: 12'	1	\$720.00
	Left Side: Top - 3' Panel	1	\$200.00
	Left Side Siding: Horizontal	1	-
	Left Side J-Trim: Sides Only	1	\$45.00
	Right Side: Fully Enclosed	1	\$830.00
	Right Side Siding: Horizontal	1	-
	Trusses: Standard	1	-
Right Lean	Base Price: 12'x41'	1	\$2,247.50
Right Lean	Type: Lean with storage	1	-
Right Lean	Back Storage Depth: 20'	1	-
Right Lean	Leg Style: Standard	1	-
Right Lean	Gauge: 14-Gauge Framing	1	-
Right Lean	Brace: Standard Brace	1	-
Right Lean	Leg Height: 9'	1	\$180.00
Right Lean	Right Side: Fully Enclosed	1	\$602.50
Right Lean	Right Side Siding: Horizontal	1	-
Right Lean	Storage Front End: Fully Enclosed	1	\$535.00
Right Lean	Storage Front End Siding: Horizontal	1	-
Right Lean	Storage Back End: Fully Enclosed	1	\$535.00
Right Lean	Storage Back End Siding: Horizontal	1	-
Right Lean	Connection Fee Side to Side (12-24 wide) 40'L	1	\$200.00
	<b>Roll Doors &amp; Ramps</b>		
Right Lean	Storage 6'x6' Certified Garage Door	1	\$650.00
	<b>Doors &amp; Ramps</b>		
Right Lean	Walk-In Door (36x80)	1	\$275.00

#1595623006125245

Section	Description	Quantity	Amount
	<b>Windows &amp; Accessories</b>		
Right Lean	30W x 30H Windows	2	\$360.00
	<b>Frameouts</b>		
Center	Custom Size (16'x9')	1	\$360.00
	Corner Style: Square (Traditional)	1	-
Right Lean	Storage Corner Style: Square (Traditional)	1	-
Right Lean	Custom Size (16'x7')	1	\$360.00
Right Lean	Corner Style: Square (Traditional)	1	-
	<b>Additions and Adjustments</b>		
All	Sales Tax 6% + \$50	1	\$727.70
Subtotal:			\$12,022.70
Sales Tax:			-
Total Order Amount:			\$12,022.70
Deposit Required to Order:			\$1,807.20
Final Balance Due at Installation:			\$10,215.50

Signatures	
Customer Signature:	<i>Sarah Ripple</i>
Date:	
Delivery Notes:	

Dealer or Manufacturer Signature:	
Date:	

This purchase agreement (the "Agreement") is made by and between Steel Buildings and Structures, Inc. ("SBS"), a North Carolina Corporation and the Buyer. Buyer agrees, after being fully educated about SBS's various products, include the fourteen (14) gauge, twelve (12) gauge, non-certified, and certified units, to buy, and SBS agrees to sell, pursuant to the terms listed in this Agreement described above. Buyer has read and understands the terms of this agreement, including the terms and conditions contained at the bottom of this document, which terms are expressly incorporated herein by reference, as well as any and all relevant warranty information and agrees to be bound by same.

- Terms, Conditions, and Warranties
1. SBS shall have the right to correct any errors made by any party in regard to pricing and/or sales tax.
  2. Lot must be level prior to installation, otherwise unit may be installed 'as is' and any and all warranties will be void.
  3. Buyer is aware of SBS's various products and warranties, without limitation the following:
    - a. Standard (Non-certified) Units - This unit is built according to the manufacturer's specifications and industry standards, but will not likely be available for a building permit in certain areas. Inquire for warranty information.
    - i. Standard Fourteen (14) Gauge Unit - The fourteen (14) gauge unit references the tubing thickness used on the framing. Those units are constructed with 2 1/2" x 2 1/2" square tubing. **Inquire for warranty**

information.

- ii. Standard Twelve (12) Gauge Unit - The twelve (12) gauge unit is constructed of more rigid 2 1/4" x 2 1/4" square tubing, which offers a higher tensile strength and thickness of material. Inquire for warranty information.

- b. Certified Units - These units, available in fourteen (14) or twelve (12) gauge, are typically installed in areas that require building permits. Certified units are built according to engineer specifications and engineer blueprint/drawings.

- c. Anchors - All units are secured with anchors that pass through the base rail of the frame and into the ground (concrete, asphalt, etc.) The base rail is affixed only to the installation surface with those anchors and the Buyer is aware of and understands and agrees that he/she may experience water leakage under the baserail.

- i. Standard (Non-Certified) Units - These units are anchored with rebar anchors for ground installation or concrete wedge anchors for concrete installations. The rebar anchors are thirty-two inches (32") long but may be shortened in length when installing on difficult terrain. Mobile home (auger type) anchors are available for non-certified units at a small additional charge.

- ii. Certified Units - The standard anchor for this unit is the mobile home (auger type) anchor for ground installations. We utilize concrete anchors for concrete installations. There is an additional charge for installing mobile home (auger type) anchors on asphalt.

4. Buyer is responsible for informing the Independent Installation Contractors of any underground cables, gas lines, utility hazards or relevant matters prior to commencement of installation. Buyer agrees to indemnify and hold SBS (the manufacturer) and the Dealer (seller) harmless for any damage done to submerged lines, pipes, cables, or other utility instrumentalities during installation.
5. Buyer shall be solely responsible for, and shall obtain, any and all necessary city, county, or state permits prior to commencement of installation. Buyer agrees to indemnify and hold SBS and the Dealer (seller) harmless for violation of any and all city and county ordinances or codes and/or covenants, set-backs and restrictions.
6. Payment Terms
  - a. Down Payment --Buyer shall pay the SBS Authorized Dealer a 10%-15% deposit based on the retail (before tax) purchase price. The Buyer shall not pay the SBS Authorized Dealer an amount exceeding the above mentioned deposit. In the event that Buyer pays an amount exceeding the above mentioned deposit, Buyer does so at his/her own risk, understanding that he/she is contractually obligated to remit the remaining eighty-five to ninety percent (85%-90%) of the purchase price as set forth below.
  - b. Balance - Buyer shall pay the remaining balance of eighty-five to ninety percent (85%-90%) to the installation crew on the date of installation. Payment may be made by check or money order to the crew. To pay the balance by credit card, call our office to process your payment toll free at 877-272-8276.
  - c. Excessive Down Payments - If Buyer pays more than the required deposit/down payment, at the time of the sale, SBS must receive those excessive funds from the SBS Authorized Dealer prior to installation.
  - d. Refunds - In the event Buyer cancels the order, Buyer will receive no refund of the down payment. Specifically, there are NO REFUNDS on special orders.
7. If Buyer alters the unit in any manner, including without limitation any interior or exterior modifications, installing electric or plumbing to the unit, all warranties shall be immediately void.
8. Buyer will pay an additional "labor charge" of not less than fifty dollars (\$50.00) if installers are required to dig, cut frame to level, transport materials more than fifty feet (50'), install on any wall or deck, or to install over any existing obstruction or structure. Buyer agrees to notify the SBS Authorized Dealer of any of these conditions at the time of the sale.
9. Buyer will pay a service charge of not less than 12% if installers cannot install the unit initially and the unit has to be reshipped due to any, but not limited to the following: Customer error, un-level installation site, concrete pad out of square, etc.
10. SBS and the SBS Authorized Dealer will not be liable to Buyer for punitive, indirect, incidental, special or consequential damages resulting from any defect or deficiencies in accepted items. For more specific terms, please contact us.
11. SBS and the SBS Authorized Dealer are not responsible for changes in delivery dates caused by circumstances beyond our control (weather, equipment breakdown, etc.). It is SBS Inc. intent to keep installation time frames to a minimum at all times, however, given that the weather is unpredictable and can vary from day to day, and state to state, thus we do not have an accurate way to predict dedicated leads times regardless of any statement made by any party in regard to lead times.
12. The Agreement shall be interpreted and construed according to, and governed by, the laws of the state of North Carolina. The parties hereto: (i) consent to submit itself to the personal jurisdiction of any state or federal court sitting in the County of Surry, State of North Carolina, in any action or proceeding arising out of or relating to this Agreement, (ii) agree that all claims in respect of such action or proceeding may be heard and determined in such court, (iii) agree that they shall not attempt to deny or defeat such personal jurisdiction by motion or other request for leave from any such court, and (iv) agree not to bring any action or proceeding arising out of or relating to this Agreement in any other court. Each of the parties waive any defense of inconvenient forum to the maintenance of any action or proceeding so brought and waives any bond, surety, or other security that might be required of the other party.

13. The parties attest that this Agreement is the complete and exclusive statement of the agreement between the parties, and supersedes all prior written or oral communications, representations and agreements relating to the subject matter of this agreement. The terms of this Agreement, save and except the price term in the event of a pricing error/change order, may be modified or amended by a written instrument executed by the parties hereto.
14. It is the customer's responsibility to provide a telescoping lift for the installation of any unit 13 feet tall or taller if the unit includes a side entry, and is required for all units 15 feet tall and taller regardless of door placement.
15. It is the customers responsibility to provide a telescoping lift on the day of installation for any unit 32' wide and wider regardless of the height.
16. Customer will be required to pay half of the retail balance on any unit \$15,000.00 and higher prior to the unit being manufactured.
17. Customer expressly agrees that the unit shall remain property of Steel Buildings and Structures, Inc. until payment in full is received. Steel Buildings and Structures Inc. hereby retains a purchase money interest in said building as set forth in Section 9 of the Uniform Commercial Codes enacted in the state where building is installed. Failure to pay will result in repossession of unit. This does not relieve the customer from liability for specific performance of the contract including legal fees and court costs, at the seller's option.
18. Steel Buildings and Structures, Inc. strongly recommends any unit longer than 36' be purchased in the Vertical Roof, roof style configuration to avoid possible leaks and or rust at the overlap seam. Any unit that is purchased 37' long or longer will forfeit all warranties other than the workmanship warranty. The workmanship warranty on units that are 37' long or longer will be 30 days from the date of install.

Customer Initials: S.R.

---

This estimate is provided by Steel Buildings & Structures. Use this estimate with any other company violates the terms and conditions of Steel Buildings & Structures and will be subject to legal action.



Steel Buildings & Structures

820 Reeves Drive (Mailing Address: PO Box 1287)

Mount Airy, North Carolina, 27030

877.272.8276

(336) 551-3449

#1595623006125245



# Signature Certificate

Document Ref.: XFVMY-RXEWN-RRXVY-GQQ8Y

Document signed by:

	<p><b>Sarah Ripple</b> Verified E-mail: smith-ripples@columbiak12.com</p>	<p><i>Sarah Ripple</i></p> 
IP: 66.157.214.55	Date: 30 Jul 2020 19:55:08 UTC	

Document completed by all parties on:  
30 Jul 2020 19:55:08 UTC

Page 1 of 1



Signed with PandaDoc.com

PandaDoc is the document platform that boosts your company's revenue by accelerating the way it transacts.

