

Mobile Home Permit Worksheet

Installer: Dale Houston License # 1H133271
 Address of home being installed: 494 SE Bailey St
Lake City FL 32024
 Manufacturer: Clayton Length x width: 28 x 54

NOTE: If home is a single wide fill out one half of the blocking plan
 if home is a triple or quad wide sketch in remainder of home
 I understand Lateral Arm Systems cannot be used on any home (new or used)
 where the sidewall ties exceed 5 ft 4 in.

Installer's initials: DH

Typical pier spacing

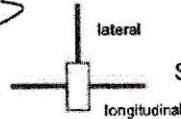
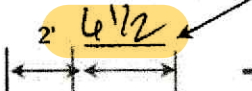

Show locations of Longitudinal and Lateral Systems
 (use dark lines to show these locations)

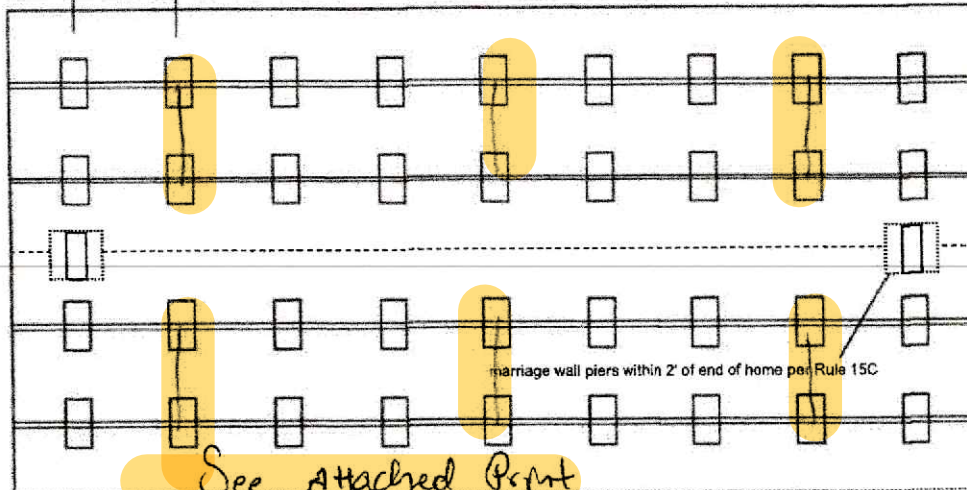

See Attached Print



Anthony Nolan

04-22-2024

Application Number: _____ Date: _____

New Home ☒ Used Home ☐

Home installed to the Manufacturer's Installation Manual
 Home is installed in accordance with Rule 15-C ☐

Single wide ☐ Wind Zone II ☒ Wind Zone III ☐

Double wide ☒ Installation Decal # 107674

Triple/Quad ☐ Serial # WHC031682GAAC

PIER SPACING TABLE FOR USED HOMES

Load bearing capacity	Footer size (sq in)	16" x 16" (256)	18 1/2" x 18 1/2" (342)	20" x 20" (400)	22" x 22" (484)*	24" X 24" (576)*	26" x 26" (676)
1000 psf		3'	4'	5'	6'	7'	8'
1500 psf		4' 6"	6'	7'	8'	8'	8'
2000 psf		6'	8'	8'	8'	8'	8'
2500 psf		7' 6"	8'	8'	8'	8'	8'
3000 psf		8'	8'	8'	8'	8'	8'
3500 psf		8'	8'	8'	8'	8'	8'

* interpolated from Rule 15C-1 pier spacing table.

PIER PAD SIZES

I-beam pier pad size: 23 x 31

Perimeter pier pad size: 16 x 14

Other pier pad sizes (required by the mfg.): _____

Draw the approximate locations of marriage wall openings 4 foot or greater. Use this symbol to show the piers.

List all marriage wall openings greater than 4 foot and their pier pad sizes below.

Opening	Pier pad size
<u>1, 2</u>	<u>23 x 31</u>
_____	_____
_____	_____

POPULAR PAD SIZES

Pad Size	Sq In
16 x 16	256
16 x 18	288
18.5 x 18.5	342
16 x 22.5	360
17 x 22	374
13 1/4 x 26 1/4	348
20 x 20	400
17 3/16 x 25 3/16	441
17 1/2 x 25 1/2	446
24 x 24	576
26 x 26	676

ANCHORS

4 ft 5 ft @ marriage line

FRAME TIES

within 2' of end of home spaced at 5' 4" oc

TIEDOWN COMPONENTS

Longitudinal Stabilizing Device (LSD)
 Manufacturer: Oliver
 Longitudinal Stabilizing Device w/ Lateral Arms
 Manufacturer: Oliver

OTHER TIES

	Number
Sidewall	<u>5/4</u>
Longitudinal	<u>6</u>
Marriage wall	<u>4</u>
Shearwall	<u>0</u>

Mobile Home Permit Worksheet

Application Number: _____ Date: _____

POCKET PENETROMETER TEST

The pocket penetrometer tests are rounded down to _____ psf or check here to declare 1000 lb. soil ☒ without testing.

X _____ X _____ X _____

POCKET PENETROMETER TESTING METHOD

1. Test the perimeter of the home at 6 locations.
2. Take the reading at the depth of the footer.
3. Using 500 lb. increments, take the lowest reading and round down to that increment.

X _____ X _____ X _____

TORQUE PROBE TEST

The results of the torque probe test is _____ inch pounds or check here if you are declaring 5" anchors without testing _____. A test showing 275 inch pounds or less will require 5 foot anchors.

Note: A state approved lateral arm system is being used and 4 ft. anchors are allowed at the sidewall locations. I understand 5 ft anchors are required at all centerline tie points where the torque test reading is 275 or less and where the mobile home manufacturer may requires anchors with 4000 lb holding capacity.

DP Installer's initials

ALL TESTS MUST BE PERFORMED BY A LICENSED INSTALLER

Installer Name Dale Houston

Date Tested _____

Electrical

Connect electrical conductors between multi-wide units, but not to the main power source. This includes the bonding wire between multi-wide units. Pg. 95

Plumbing

Connect all sewer drains to an existing sewer tap or septic tank. Pg. 69

Connect all potable water supply piping to an existing water meter, water tap, or other independent water supply systems. Pg. 88

Site Preparation

Debris and organic material removed ☒
Water drainage: Natural _____ Swale _____ Pad ☒ Other _____

Fastening multi wide units

Floor: Type Fastener: 148 Length: 6" Spacing: 24"
Walls: Type Fastener: 60 screw Length: 4.5" Spacing: 24"
Roof: Type Fastener: Screw/8" Length: 4.5" Spacing: 24"
For used homes a min. 30 gauge, 8" wide, galvanized metal strip will be centered over the peak of the roof and fastened with galv. roofing nails at 2" on center on both sides of the centerline.

Gasket (weatherproofing requirement)

I understand a properly installed gasket is a requirement of all new and used homes and that condensation, mold, mildew and buckled marriage walls are a result of a poorly installed or no gasket being installed. I understand a strip of tape will not serve as a gasket.

Installer's initials DPH

Type gasket Ecom Pad
Pg. 45

Installed: ☒
Between Floors Yes ☒
Between Walls Yes ☒
Bottom of ridgebeam Yes ☒

Weatherproofing

The bottomboard will be repaired and/or taped. ☒ Pg. 115
Siding on units is installed to manufacturer's specifications. ☒
Fireplace chimney installed so as not to allow intrusion of rain water. Yes N/A

Miscellaneous

Skirting to be installed. ☒ No ☒
Dryer vent installed outside of skirting. ☒ N/A
Range downflow vent installed outside of skirting. Yes ☒
Drain lines supported at 4 foot intervals. ☒
Electrical crossovers protected. ☒
Other: _____

Installer verifies all information given with this permit worksheet is accurate and true based on the manufacturer's installation instructions and or Rule 15C-1 & 2

Installer Signature Dale Houston

Date 4/10/24

Ketchum

License Number: IH / 1133271 / 1 Name: DALE HOUSTON

Order #: 6113	Label #: 107674	Manufacturer:	(Check Size of Home)
Homeowner:		Year Model:	Single _____
Address:		Length & Width:	Double _____
City/State/Zip:		Type Longitudinal System:	Triple _____
Phone #:		Type Lateral Arm System:	HUD Label #:
Date Installed:		New Home: _____ Used Home: _____	Soil Bearing / PSF:
Installed Wind Zone:		Data Plate Wind Zone:	Torque Probe / in-lbs:
Note:			Permit #:



STATE OF FLORIDA
INSTALLATION CERTIFICATION LABEL

107674
LABEL # DATE OF INSTALLATION

DALE HOUSTON
NAME

IH / 1133271 / 1 6113
LICENSE # ORDER #

CERTIFIES THAT THE INSTALLATION OF THIS MOBILE HOME IS
IN ACCORDANCE WITH FLORIDA STATUTES 320.8249, 320.8525
AND RULES OF THE HIGHWAY SAFETY AND MOTOR VEHICLES

PLEASE WRITE DATE OF
INSTALLATION AND AFFIX
LABEL NEXT TO HUD LABEL.
USE PERMANENT INK PEN
OR MARKER ONLY.
COMPLETE INFORMATION
ABOVE AND KEEP ON FILE
FOR A MINIMUM OF 2 YEARS.
YOU ARE REQUIRED TO
REVIEW WHEN

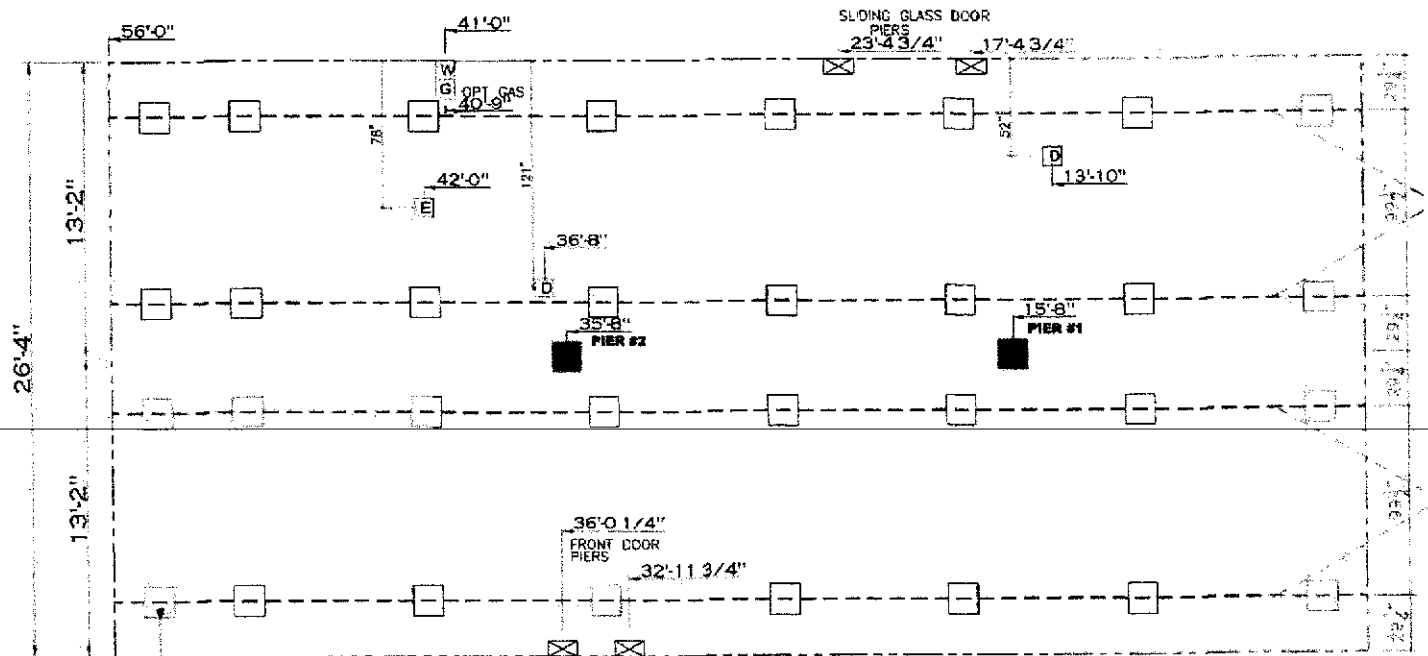

TYPICAL FRAME SUPPORT PIERS

20 lb ROOF LOAD SIDEWALL OPENING PIER LOAD 28' BOX WIDTH	SIDEWALL OPENING (FT) REQUIRED PIER LOAD (LBS)					
	3	4	5	6	8	10
	1175	1330	1485	1640	1950	2260

*FOR 30 lb & 40 lb ROOF LOAD REFER TO TABLES 7b & 7c IN THE INSTALLATION MANUAL

GENERAL NOTES:

- PIER LOADS SHOWN ARE TO BE USED TO SIZE THE FOOTINGS BELOW THE MARRIAGEWALL FOR COLUMN SUPPORT PIERS, REFER TO TABLES 6b AND 6c IN THE INSTALLATION MANUAL FOR LOAD ON FRAME PIER FOOTINGS FOR HOMES THAT DO NOT REQUIRE PERIMETER BLOCKING. REFER TO TABLES 7b AND 7c IN THE INSTALLATION MANUAL FOR LOAD ON FRAME PIER FOOTINGS THAT REQUIRE PERIMETER BLOCKING. REFER TO TABLES 10 AND 10a TO DETERMINE FOOTING SIZE FOR ALL PIERS.
- REFER TO TABLE 9 FOR PIER CONFIGURATION AND MAXIMUM ALLOWABLE HEIGHTS. CROSS REFERENCE THE PIER HEIGHT WITH THE MAXIMUM ALLOWABLE FLOOR HEIGHT LISTED IN THE FRAME TIEDOWN CHARTS (TABLE 18, 19, AND 20).
- FLOOR WIDTH SHOWN IS FOR STANDARD PRODUCT ONLY. CONTACT THE MFG PLANT FOR SPECIFICATIONS OF OPTIONS ORDERED.
- SERVICE DROP LOCATIONS IDENTIFIED ARE APPROXIMATE.
- THE MAXIMUM SPACING FOR FRAME SUPPORT PIERS FOR 8" I-BEAMS IS 8 FEET, 10" & 12" I-BEAMS ARE 10 FEET

SERVICE DROP LEGEND

- E** = ELECTRICAL DROP
- W** = WATER INLET
- D** = CHY PLUMBING DROP
- G** = GAS INLET

20 lb Roof Live Load		
Column Pier #	Distance from Hitch	Pier Load (lbs)
1	15.667	4284
2	35.333	4284

30 lb Roof Live Load		
Column Pier #	Distance from Hitch	Pier Load (lbs)
1	15.667	6632
2	35.333	6632

40 lb Roof Live Load		
Column Pier #	Distance from Hitch	Pier Load (lbs)
1	15.667	8190
2	35.333	8190

PIER LEGEND

- ☐ = SUPPORT UNDER MATING OPENING
- ☒ = SUPPORT AT MATING COLUMN
- ☒ = SUPPORT UNDER MATING WALL
- ☒ = PIER PORCH RECESSED ENTRY
- ☐ = PIER MAIN BEAM
- ☒ = PIER PERIMETER
- ☒ = TIE DOWN SUPPORT (QTY PER TBL. V. SEE DETAIL D-6 IN FOUND. PWS.)



DATE: _____
REVISION: _____

MODEL NAME: R10
MODEL NO: CEA28563AH
BOX SIZE: 28' x 56'
MODEL SQ FT: 1,475

DRAWN BY: Alex Whaley
DATE DRAWN: 11/26/2019
DATE PRINTED: 3/30/2022
SCALE: 3/16"=1'
PLAN NO: CE-M022-56-3
SHEET NAME: PIERS
99.5

SHEET NO: SU-1.