

MCCARTY 10.09 AC  
225 SW MARYLAND GLW, FT WHITE

N  
↑

VACANT

VACANT

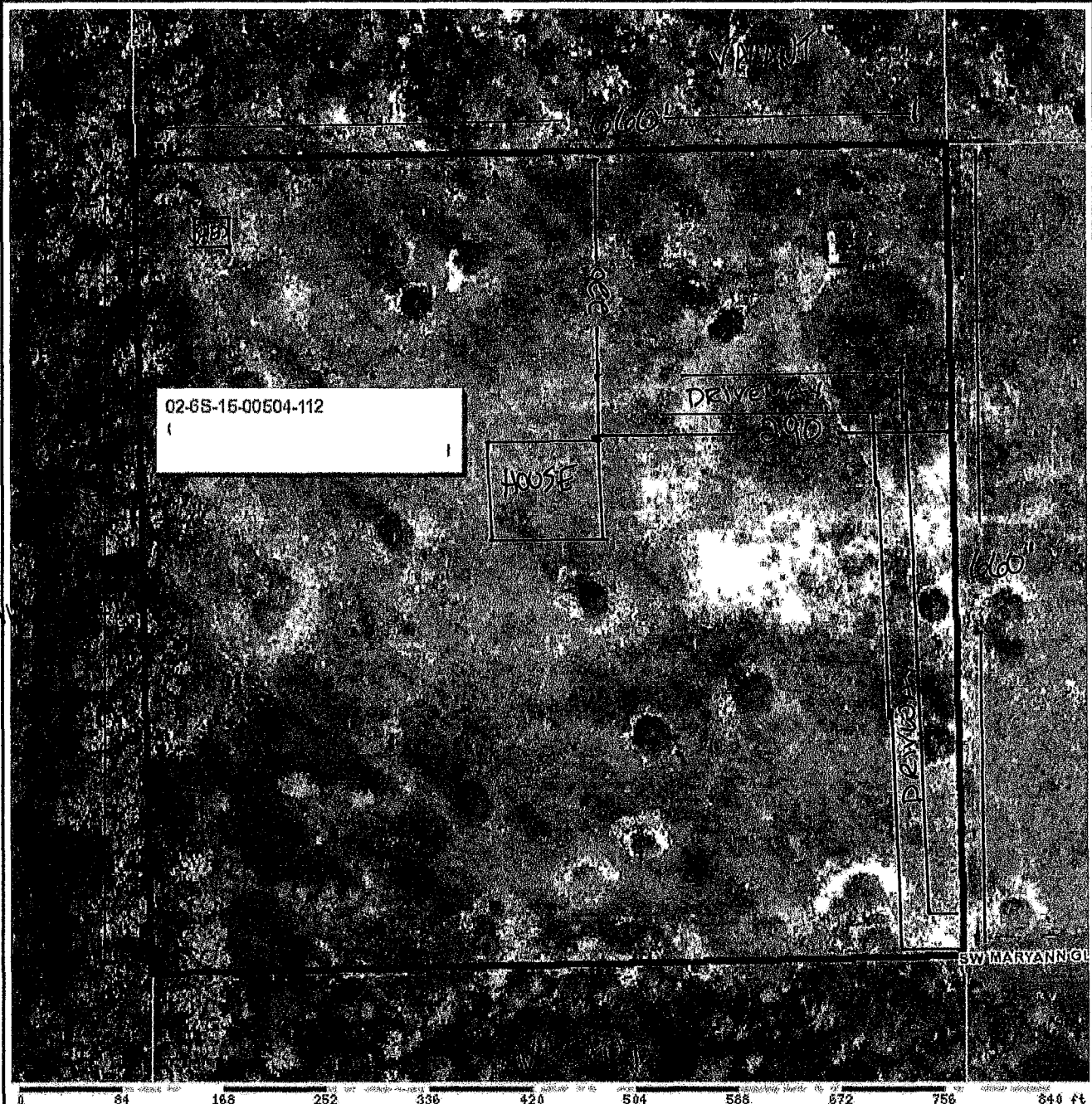

**Columbia County Property Appraiser**  
J Doyle Crews - Lake City, Florida 32055 | 386-758-1083

**PARCEL: 02-6S-15-00504-112 - PASTURELAN (006200)**  
LOT 12 SOUTHLAND TRAILS UNR. COMM AT NE COR OF W1/2 OF SEC, RUN S 2655.43 FT, W 1988 86 FT FOR  
POB, S 663 39 FT, W 662.87 FT, N 663.40 FT, E 662.15 FT

Name	i	2013 Certified Values	
Site		Land	\$1,250 00
Mail		Bldg	\$0 00
Sales		Assd	\$3,268 00
Info	V / U	Exmpt	\$0 00
		Cnty	\$3,268
		Taxbl	Other \$3,268   Schl \$3,268

NOTES:



This information, GIS updated 3/7/2014, was derived from data which was compiled by the Columbia County Property Appraiser Office solely for the governmental purpose of property assessment. This information should not be relied upon by anyone as a determination of the ownership of property or market value. No warranties, expressed or implied, are provided for the accuracy of the data herein, it's use, or it's interpretation. Although it is periodically updated, this information may not reflect the data currently on file in the Property Appraiser's office. The assessed values are NOT certified values and therefore are subject to change before being finalized for ad valorem assessment purposes.

powered by  
**GrizzlyLogic.com**