

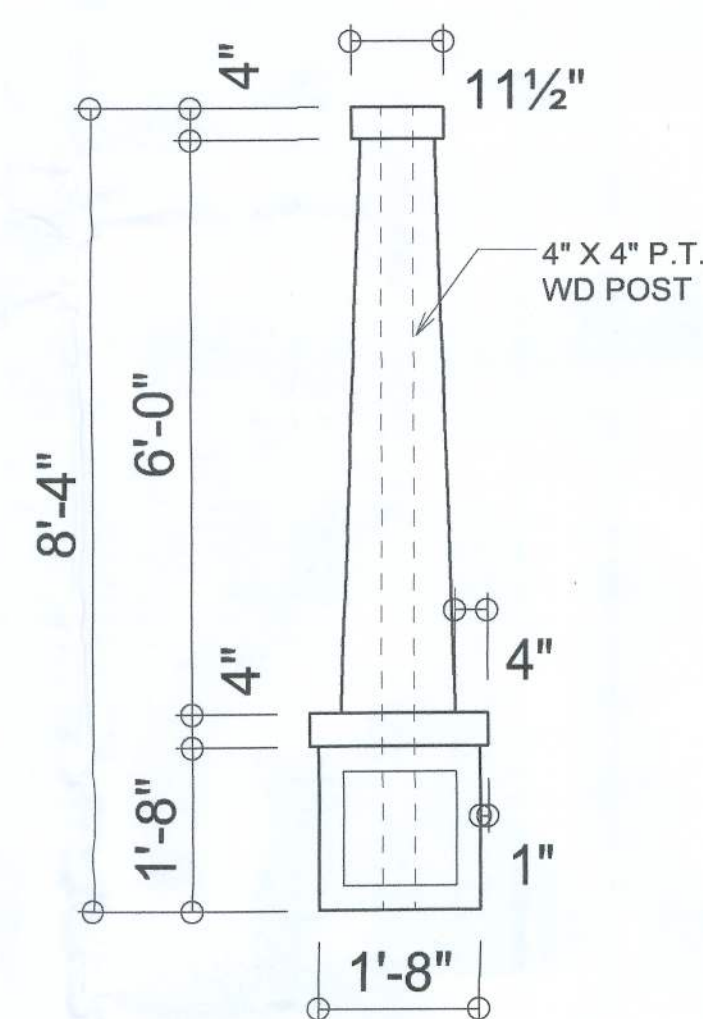

LEFT ELEVATION
SCALE: 1/4" = 1'-0"



RIGHT ELEVATION
SCALE: 1/4" = 1'-0"



CRAFTSMAN COLUMN DETAIL
SCALE: 1" = 1'-0"



REAR ELEVATION
SCALE: 1/4" = 1'-0"



FRONT ELEVATION
SCALE: 1/4" = 1'-0"



REVISIONS	DATE
January 27, 2020	
April 01, 2021	



EXTERIOR ELEVATIONS
SCALE: 1/4" = 1'-0"

DETAILS
SCALE: AS NOTED

MODEL 1523 FOR:
Lot 22, Turkey Creek
PROJECT ADDRESS: COLUMBIA COUNTY, FLORIDA
LIPSCOMB & EAGLE
LAKE BUTLER, FLORIDA

© VM DESIGN & ASSOCIATES, INC.
426 SV COMMERCE DR. STE 130
AKE CITY, FL 32025
386) 758-8406
vll@vmysrcs.net

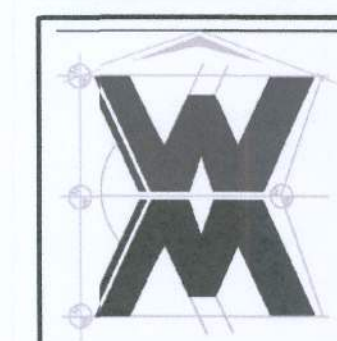

JOB NUMBER
20210402

SHEET NUMBER
A.1

NOTE: ALL DRAWINGS NOT TO BE SCALED, WRITTEN DIMENSIONS TAKE PRECEDENCE OVER SCALED DIMENSIONS

Wm C. G. M.

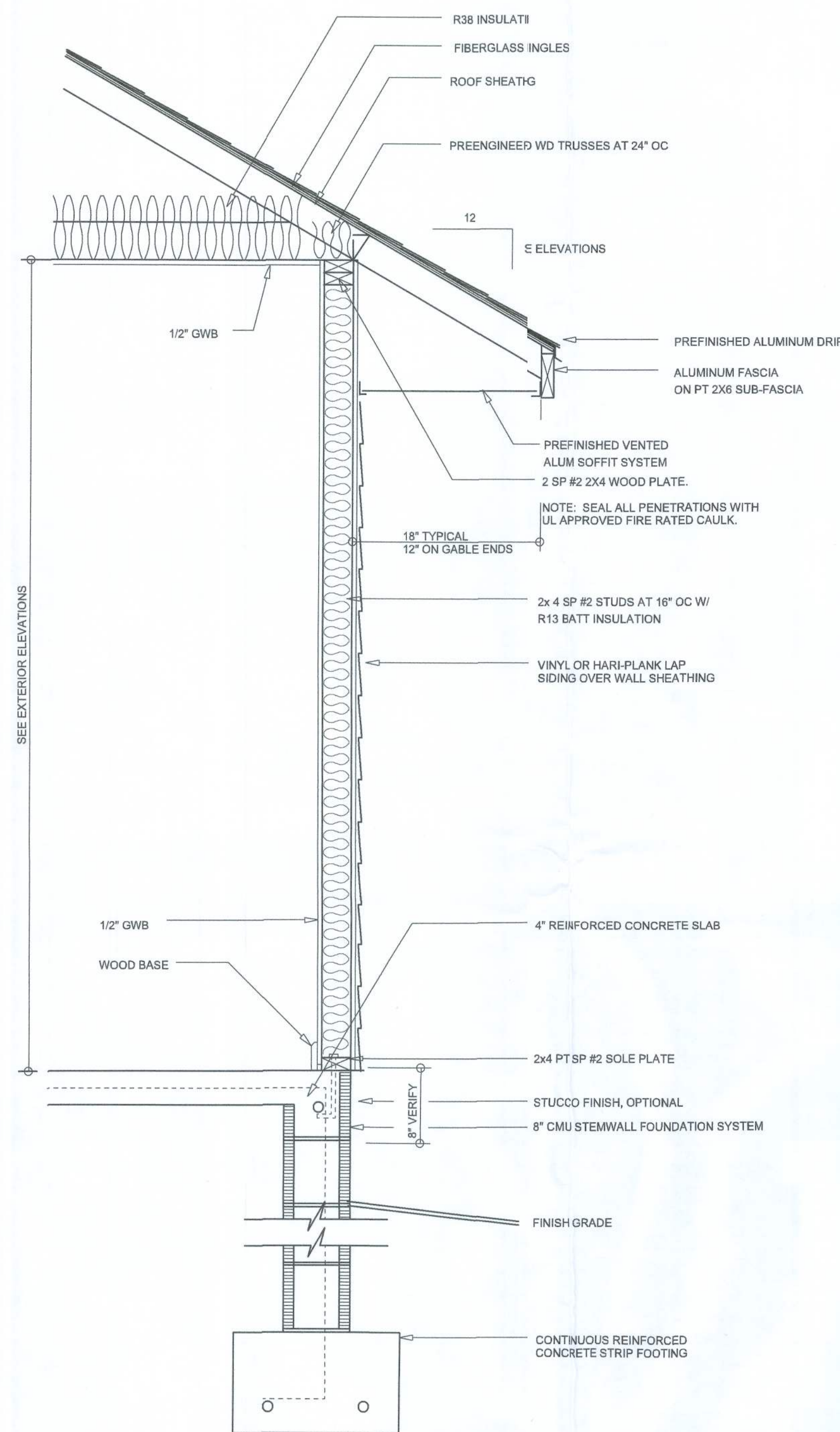

TYPICAL WALL SECTION
SCALE: 1/4" = 1'-0"

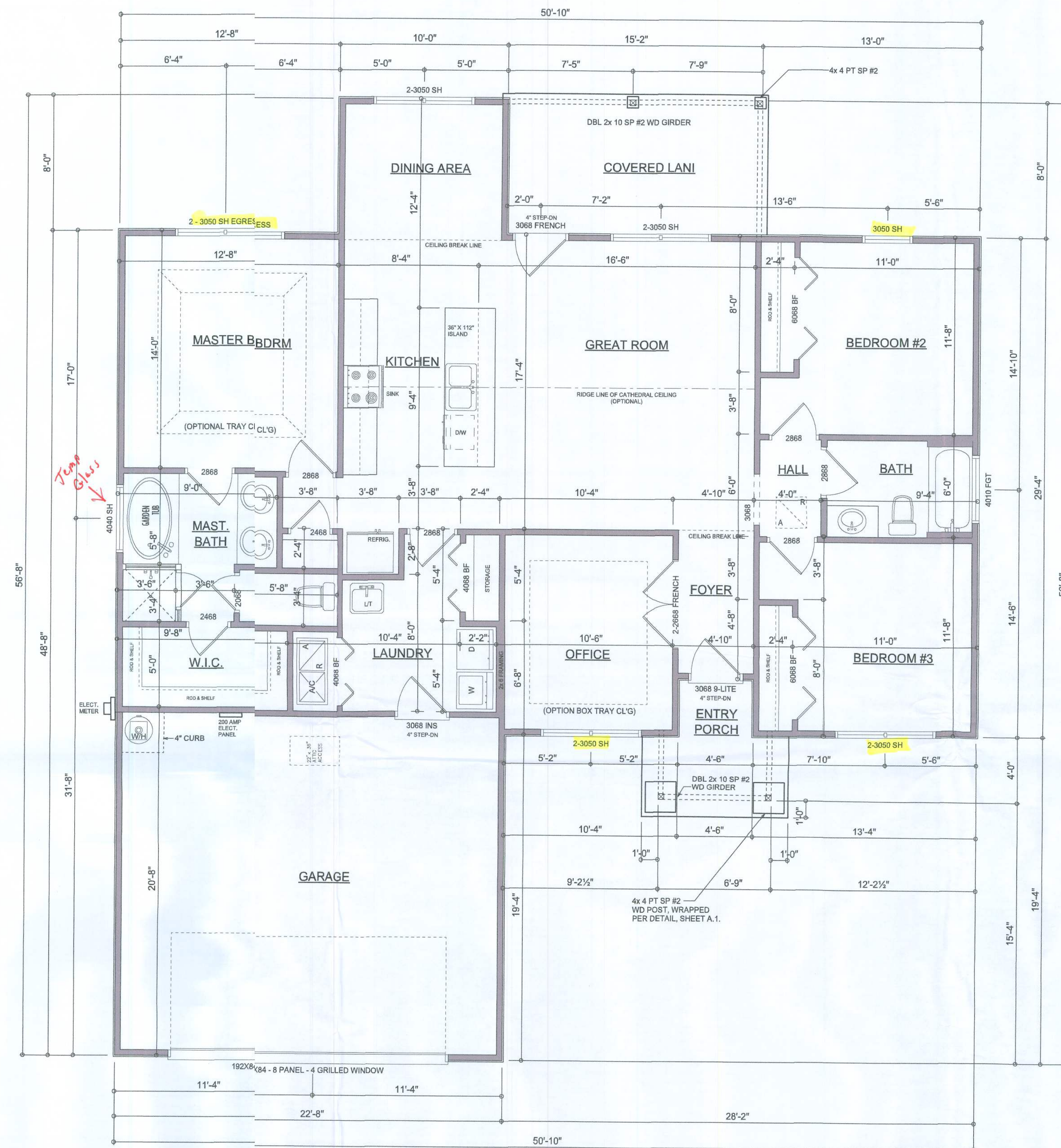

FLOOR PLAN
SCALE: 1/4" = 1'-0"

GENERAL NOTES:
ALL CEILING HEIGHTS SHALL BE 9'-0" UNLESS OTHERWISE NOTED.
ALL WINDOW HEAD HEIGHTS SHALL BE 8'-8" AFF.

Garage fire separations shall comply with the following:

1. The private garage shall be separated from the dwelling unit and its attic area by means of a minimum 1/2-inch (12.7 mm) gypsum board applied to the garage side. Garages beneath habitable rooms shall be separated from all habitable rooms above by not less than 5/8-inch Type X gypsum board or equivalent. Door openings between a private garage and the dwelling unit shall be equipped with either solid wood doors, or solid or honeycomb core steel doors not less than 1 3/8 inches (34.9 mm) thick, or doors in compliance with Section 715.3.3. Openings from a private garage directly into a room used for sleeping purposes shall not be permitted.
2. Ducts in a private garage and ducts penetrating the walls or ceilings separating the dwelling unit from the garage shall be constructed of a minimum 0.019-inch (0.48 mm) sheet steel and shall have no openings into the garage.
3. A separation is not required between a Group R-3 and U carport provided the carport is entirely open on two or more sides and there are no enclosed areas above.

AREA SUMMARY

LIVING AREA	1,523	S.F.
GARAGE AREA	461	S.F.
COVERED PORCH AREA	121	S.F.
ENTRY PORCH AREA	55	S.F.
TOTAL AREA	2,160	S.F.

NOTE: ALL DRAWINGS NOT TO BE SCALED, WRITTEN DIMENSIONS TAKE PRECEDENCE OVER SCALED DIMENSIONS

REVISIONS	DATE	BY	APP
January 27, 2020			
April 01, 2021			

SOFTPLAN
ARCHITECTURAL DESIGN SOFTWARE

DIMENSIONED FLOOR PLAN
SCALE: 1/4" = 1'-0"

TYPICAL WALL SECTION
SCALE: 1" = 1'-0"

MODEL 1523 FOR:
Lot 22, Turkey Creek
PROJECT ADDRESS: COLUMBIA COUNTY, FLORIDA
LIPSCOMB & EAGLE
LAKE BUTLER, FLORIDA



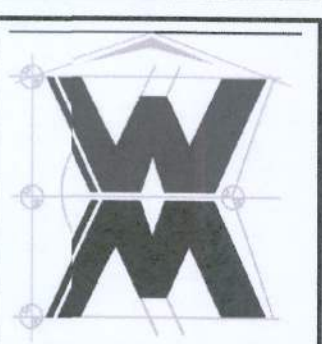





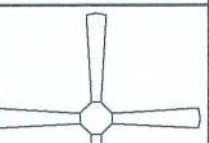
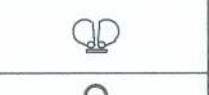

© W.M. DESIGN & ASSOCIATES, INC.
426 SW COMMERCE DR. STE 130
LAKE CITY, FL 32025
(36) 758-8406
wll@willmyers.net

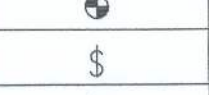

JOB NUMBER
20210402

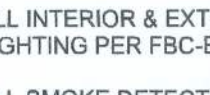
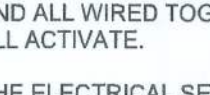
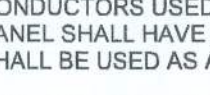
SHEET NUMBER
A.2

W.M. Design & Associates, Inc.

ELECTRICAL LEGEND	
	CEILING FAN (PRE-WIRE FLIGHT KIT)
	DOUBLE SECURITY LIGHT
	RECESSED CEILING LIGHT
	BATH EXHAUST FAN
	LIGHT FIXTURE
	DUPLEX OUTLET (AFCI & TAMPER RESISTANT)
	220v OUTLET
	GFI DUPLEX OUTLET (PER NEC 406.8)
	TELEVISION JACK
	CIRCUIT FOR SPLIT A/C UNIT
	SMOKE / CARBON MONOXIDE DETECTOR (see note below)
	WALL SWITCH
	3 WAY WALL SWITCH
	WATER PROOF GFI OUTLET
	48" FLOOR 2 OR 4 TUB FLORESCENT FIXTURE

NOTE:
ALL INTERIOR RECEPTACLES SHALL BE AFCI
(ARC FAULT CIRCUIT INTERRUPT) R NEC 210.12 & TAMPER RESISTANT PER
NEC 406.11

ALL INTERIOR & EXTERIOR LIGHTING SHALL MEET OR EXCEED THE MIN. 75% HIGH-EFFICIENCY
LIGHTING PER IRC-ENERGY CONSERVATION R404.

ALL SMOKE DETECTORS BE A COMB SMOKE & CARBON MONOXIDE DETECTOR
AND SHALL HAVE BATTERY BACKUP
AND ALL WIRING TOGETHER SO IF ONE UNIT IS ACTIVATED THEY
ALL ACTIVATE.

THE ELECTRICAL SERVICE OVERCURRENT PROTECTION DEVICE SHALL BE
INSTALLED ON THE EXTERIOR OF STRUCTURES TO SERVE AS A DISCONNECT MEANS.
CONDUCTORS USED FROM THE EXTERIOR DISCONNECTING MEANS TO A PANEL OR SUB
PANEL SHALL HAVE FOUR-WIRE CONDUCTORS, OF WHICH ONE CONDUCTOR
SHALL BE USED AS AN EQUIPMENT GROUND.

IT IS THE LICENSED ELECTRICAL CONTRACTOR'S RESPONSIBILITY TO INSURE THAT ALL
WORK PERFORMED AND EQUIPMENT INSTALLED MEETS OR EXCEEDS THE 2017 (NFPA-70) NATIONAL
ELECTRIC CODE AND ALL OTHER LOCAL CODES AND ORDINANCES.

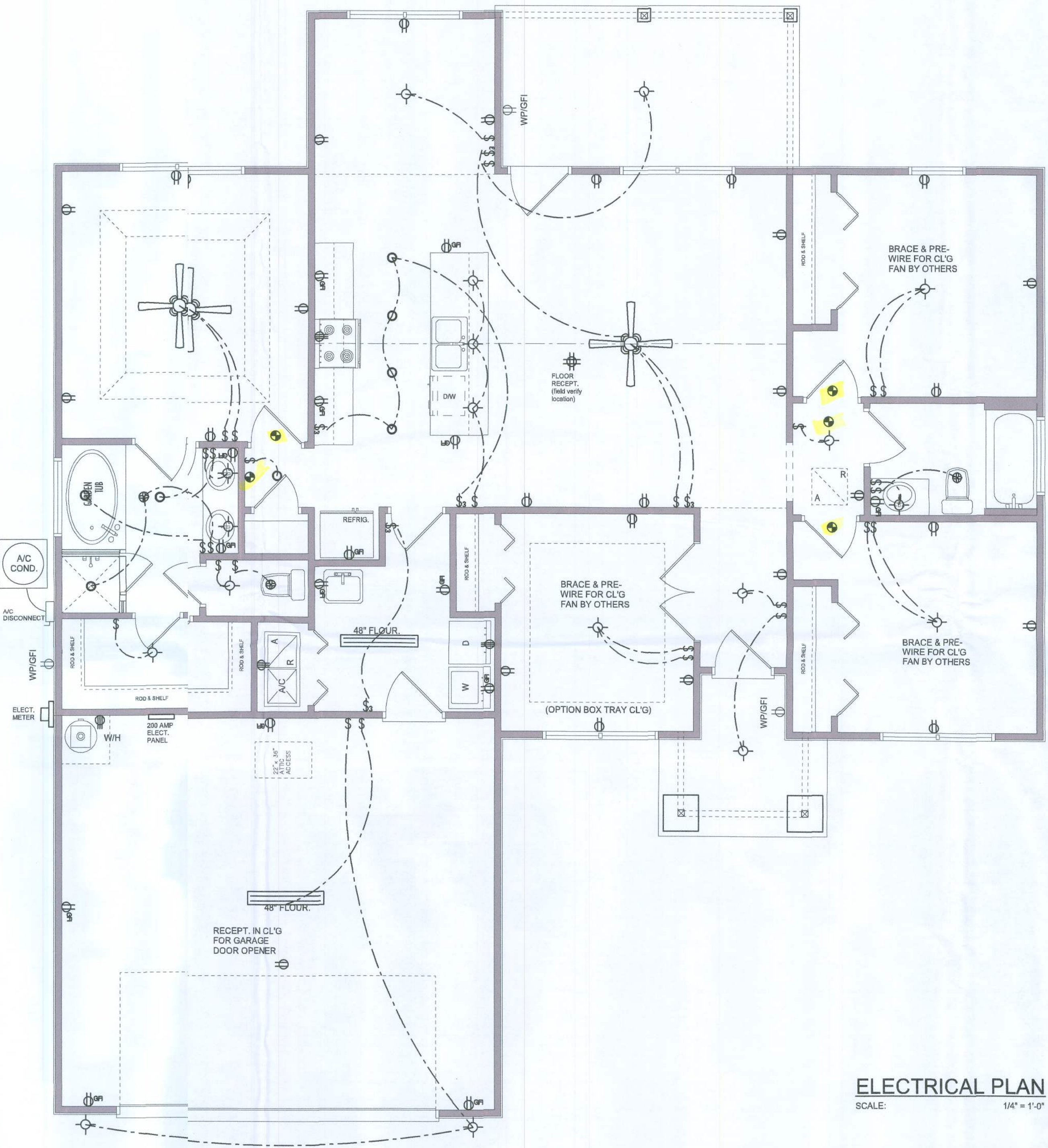

ELECTRICAL PLAN
SCALE: 1/4" = 1'-0"

NOTE: ALL DRAWINGS NOT TO BE SCALED, WRITTEN DIMENSIONS TAKE PRECEDENCE OVER SCALED DIMENSIONS

REVISIONS

January 27, 2020	
April 01, 2021	

SOFTPLAN

ARCHITECTURAL DESIGN SOFTWARE

ELECTRICAL PLAN

SCALE: 1/4" = 1'-0"

MODEL 1523 FOR:

Lot 22, Turkey Creek

PROJECT ADDRESS: COLUMBIA COUNTY, FLORIDA

LIPSCOMB & EAGLE

LAKE BUTLER, FLORIDA

© VM DESIGN & ASSOCIATES, INC.

426 SV COMMERCE DR. STE 130

LAKE CITY, FL 32025

(886) 758-8406

will@willmyers.net



JOB NUMBER

20210402

SHEET NUMBER

A.3

Willmyers

SHEET NUMBER

S.1

OF 4 SHEETS

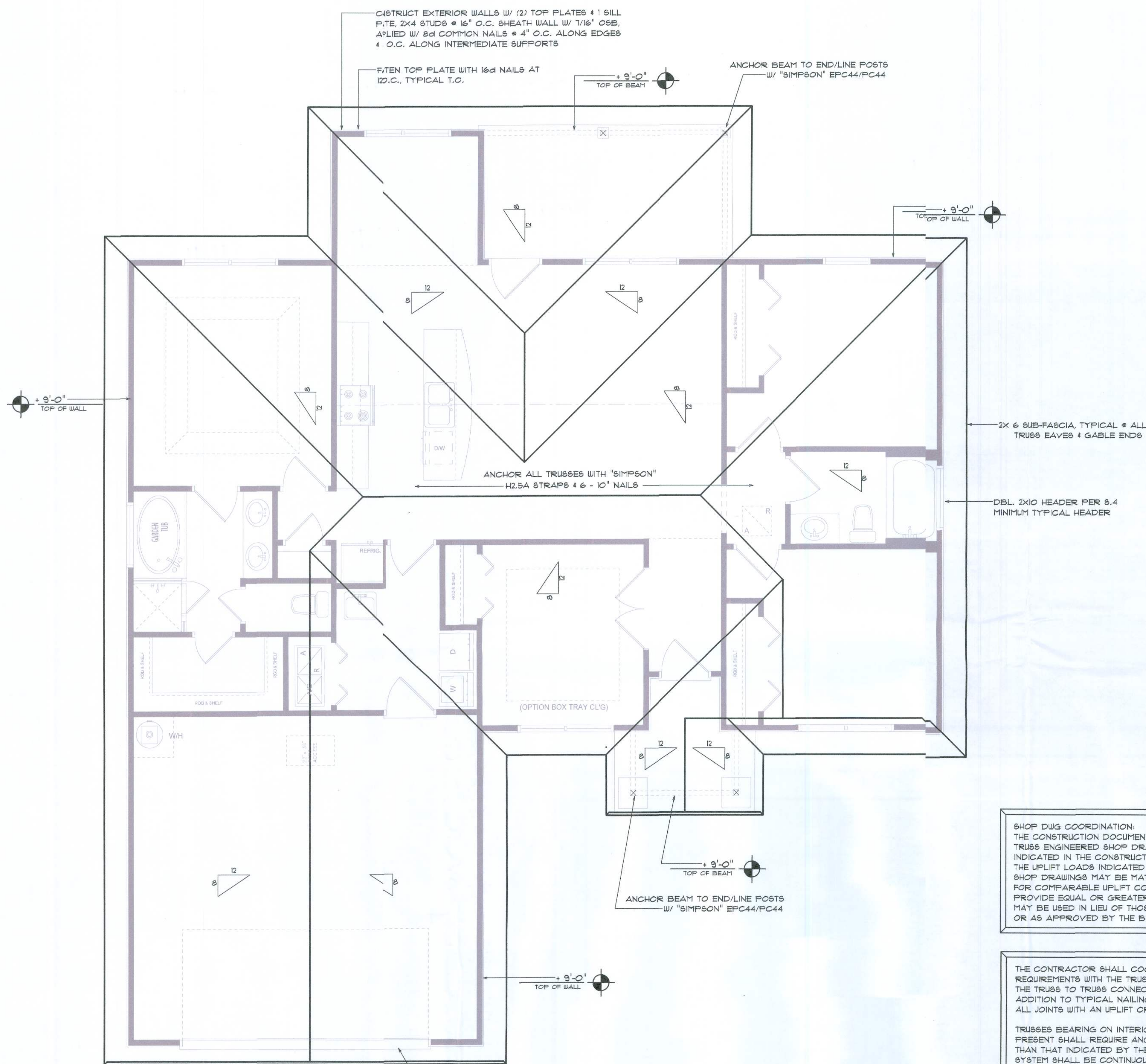

Roof Framing PLAN

SCALE: 1/4" = 1'-0"

NOTE:
ANCHOR GIRDER TRUSSES (ES) TO HEADER WITH 2 "SIMPSON" LGT2, 3 OR 4,
ANCHOR HEADER TO KING STUDS W/
2 "SIMPSON" ST2 EA. END - TYP., T.O.

NOTE:
REFER TO THE WINDOW/DOOR HEADER SCHEDULE ON SHEET 8.4 FOR ALL MINIMUM SIZE HEADERS AND ALTERNATES MINIMUM SIZE ALLOWABLE IS 2-2X10.

2- 1 3/4" X 9 1/4" 2.0E MICRO-LAM L.V.L. BEAM, EXTEND TOP PLY OF WALL PLATE FULL LENGTH, LAP MIN. 32" TO ADJOINING WALL, ASSEMBLE W/ 16d NAILS @ 12" O.C., STAGGERED TOP & BOTTOM OF BEAM, EACH SIDE.

ROOF PLAN NOTES

- R-1 SEE EXTERIOR ELEVATIONS FOR ROOF PITCH
- R-2 ALL OVERHANG 18" UNLESS OTHERWISE NOTED
- R-3 PROVIDE ATTIC VENTILATION IN ACCORDANCE WITH SCHEDULE ON 8D.3
- R-4 SEE EXTERIOR ELEVATIONS AND FLOOR PLANS TO VERIFY PLATE AND HEEL HEIGHTS
- R-5 MOVE ALL VENTS AND OTHER ROOF PENETRATIONS TO REAR

NOTE:
SHEATH ROOF W/ 1/2" CDX PLYWOOD PLACED W/ LONG DIMENSION PERPENDICULAR TO THE ROOF TRUSSES, SECURE TO FRAMING W/ 8d NAILS - AS PER DETAIL ON SHEET 8D.4

NOTE:
THE DESIGN WIND SPEED FOR THIS PROJECT IS 130 MPH PER 2020 FBC (11TH EDITION) AND LOCAL JURISDICTION REQUIREMENTS

NOTE:
ALL PENETRATIONS OF THE TOP PLATE OF ALL LOAD BEARING WALLS SHALL BE SEALED WITH FIRE RETARDANT CAULKING, INCLUDING WIRING, PLUMBING OR OTHER SUCH PENETRATIONS. WALLS OVER 8'-0" TALL SHALL HAVE CONTINUOUS BLOCKING TO LIMIT CAVITY HEIGHT TO 8'-0". PENETRATIONS THROUGH SUCH BLOCKING SHALL BE TREATED IN THE SAME MANNER AS TOP PLATES, NOTED ABOVE

GENERAL TRUSS NOTES:

- TRUSSES SHALL BE DESIGNED BY A LICENSED ENGINEER, AND IN ACCORDANCE WITH THE REQUIREMENTS OF THE "NATIONAL FOREST PRODUCTS ASSOCIATION" MANUAL FOR "STRESS RATED LUMBER AND ITS CONNECTIONS", LATEST ED., ALONG W/ THE "TRUSS PLATE INSTITUTE" SUGGESTED GUIDELINES FOR TEMPORARY AND PERMANENT BRACING, AND HANDLING OF TRUSSES. TRUSS SHOP DRAWINGS SHALL INCLUDE TRUSS DESIGN, PLACEMENT PLANS, DETS, & TRUSS TO TRUSS CONNECTIONS.
- TRUSS SHOP DRAWINGS SHALL BE SIGNED & SEALED BY THE DESIGNING ENGINEER.
- FOLLOWING DEVELOPMENT OF TRUSS SHOP DRAWINGS, ADJUSTMENTS TO THE ANCHOR REQUIREMENTS MAY BE REQUIRED DEPENDING ON THE ENGINEERED GRAVITY AND WIND UPLIFT REQUIREMENTS OF TRUSSES OR GIRDERS. THE CONTRACTOR SHALL MAKE AVAILABLE A COMPLETE SET OF TRUSS SHOP DRAWINGS TO THE ARCHITECT FOR THE PURPOSE OF REVIEW OR LOADS IMPOSED ON THE BALANCE OF THE STRUCTURE. ANY SUCH REQUIRED CHANGE SHALL BE INCORPORATED INTO THE CONSTRUCTION OF THIS STRUCTURE.

WOOD STRUCTURAL NOTES

- TEMPORARY BRACING OF THE STRUCTURE DURING ERECTION, REQUIRED FOR SAFE AND STABLE CONSTRUCTION, SHALL BE THE SOLE RESPONSIBILITY OF THE CONTRACTOR SO ENGAGED. TEMPORARY & PERMANENT BRACING OF ROOF TRUSSES SHALL BE AS PER THE STANDARD GUIDELINES OF THE "TRUSS PLATE INSTITUTE".
- ALL TRUSSES SHALL BE DESIGNED BY A LICENSED PROFESSIONAL ENGINEER & SHALL BE SIGNED AND SEALED BY SAME. TRUSS DESIGN SHALL INCLUDE PLACEMENT PLANS, TRUSS DETAILS, TRUSS TO TRUSS CONNECTIONS & THE STANDARD SPECIFICATIONS & RECOMMENDATIONS OF INSTALLATION OF THE "TRUSS PLATE INSTITUTE".
- WOOD STUDS IN EXTERIOR WALLS & INTERIOR BEARING WALLS SHALL BE NOT LESS THAN N:2 HEM-FIR OR BETTER.
- CONNECTORS FOR WOOD FRAMING SHALL BE GALVANIZED METAL OR BLACK METAL AS MANUFACTURED OR AS CALLED FOR IN THE PLANS AND BE OF A DESIGN SUITABLE FOR THE LOADS AND USE INTENDED. REFER TO THE JOINT REINFORCEMENT SCHEDULE FOR PRINCIPLE CONNECTIONS.

AREA OF ATTIC	REQ'D L.F. OF VENT	NET FREE AREA OF INTAKE
1600 SF	30 LF	410 SQ.IN.
1800 SF	24 LF	490 SQ.IN.
2200 SF	28 LF	570 SQ.IN.
2500 SF	32 LF	650 SQ.IN.
2800 SF	36 LF	730 SQ.IN.
3100 SF	40 LF	820 SQ.IN.
3600 SF	44 LF	900 SQ.IN.

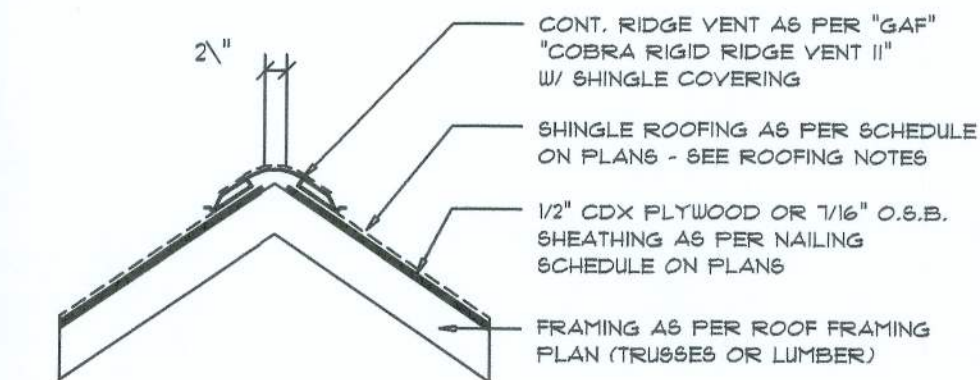

Ridge Vent DETAIL

SCALE: 3/4" = 1'-0"

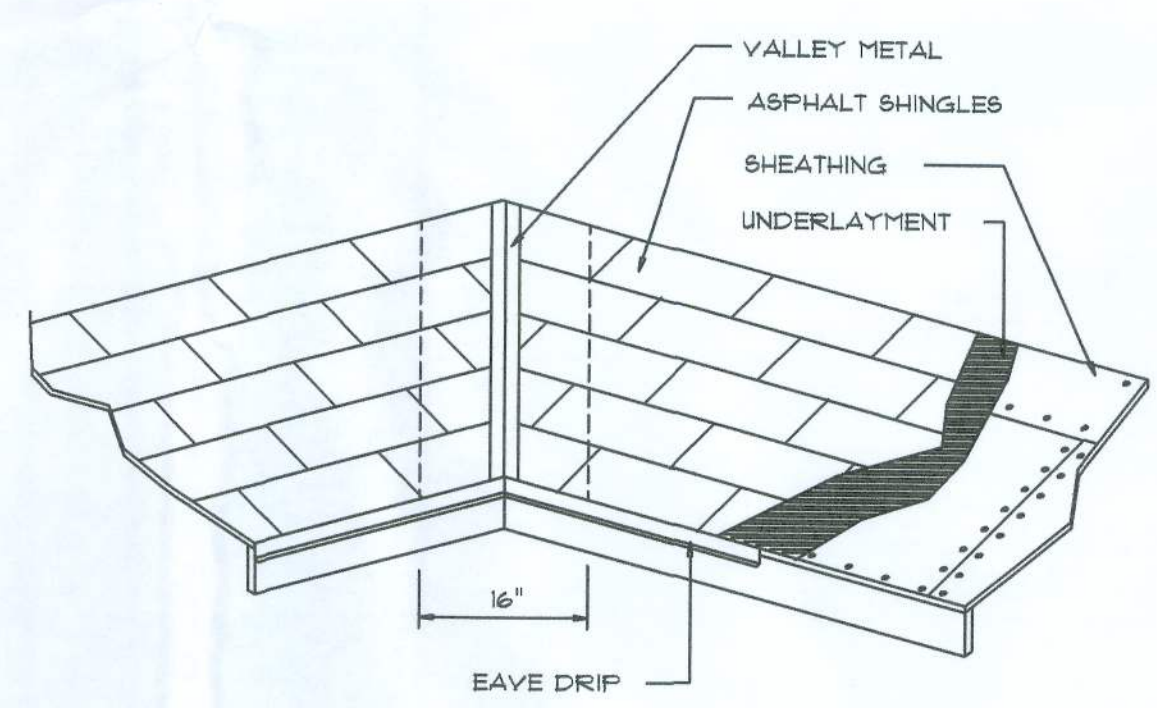

VALLEY FLASHING

ROOFING METALS for FLASHING/ROOFING MINIMUM THICKNESS REQUIREMENTS

MATERIAL	MINIMUM THICKNESS (in)	GAGE	WEIGHT (OZ.)
COPPER			16
ALUMINUM	0.024		
STAINLESS STEEL		28	
GALVANIZED STEEL	0.0178	26 (ZINC COATED G80)	
ZINC ALLOY LEAD PAINTED TERNE	0.021		40 20

Roofing/Flashing DETS.

SCALE: NONE

PROJECT COORDINATION REQUIREMENTS

NOTICE:
THESE PLANS ARE DRAWN FOR AVERAGE SITE CONDITIONS AND COMPLIANCE WITH APPLICABLE CODES IN COLUMBIA COUNTY, FL AT THE TIME THEY ARE DRAWN. DUE TO VARYING STATE, LOCAL, AND NATIONAL CODES RULES AND REGULATIONS, N.P. GEISLER, ARCHITECT CANNOT WARRANT COMPLIANCE WITH ALL APPLICABLE STATE, LOCAL, AND NATIONAL CODES IN YOUR AREA OR WITH YOUR PARTICULAR SITE CONDITIONS. IT IS THE RESPONSIBILITY OF THE PURCHASER AND/OR BUILDER TO SEE THAT THE STRUCTURE IS BUILT IN STRICT COMPLIANCE WITH ALL GOVERNING MUNICIPAL CODES (CITY, COUNTY, STATE, AND FEDERAL). IF YOUR CITY OR STATE REQUIRES AN ENGINEER'S SEAL FOR THE SITE/CIVIL PORTIONS OF THE WORK, YOU WILL NEED TO HAVE THAT DONE LOCALLY BY A QUALIFIED, LICENSED PROFESSIONAL ENGINEER.

NOTE: ALL DRAWINGS NOT TO BE SCALED, WRITTEN DIMENSIONS TAKE PRECEDENCE OVER SCALED DIMENSIONS

REVISIONS	DATE	DESCRIPTION
1	April 01, 2021	Initial Issue

SOFTPLAN
ARCHITECTURAL DESIGN SOFTWARE

ROOF PLAN
SCALE: 1/4" = 1'-0"

MODEL 1523 FOR:
LOT 22, TURKEY CREEK
PROJECT ADDRESS: COLUMBIA COUNTY, FLORIDA
LIPSCOMB & EAGLE
LAKE BUTLER, FLORIDA

ARCOOT005
06/01/2021

NICHOLAS PAUL GEISLER
ARCHITECT
1758 NW Brown Rd.
Lake City, FL 32055
N.C.A.R.C. Certified (866) 365-4355

JOB NUMBER
20210402

SHEET NUMBER
S.2
OF 4 SHEETS

FLORIDA BUILDING CODE

Compliance Summary

TYPE OF CONSTRUCTION

Roof: Gable & Hip Construction, Wood Trusses @ 24" O
Walls: 2x 4 Wood Studs @ 16" O.C.
Floor: 4" Thk. Concrete Slab W/ #4 rebar @ 24" O.C. ea. way.
Foundation: Continuous monolithic footing or Stem Wall foundation

ROOF DECKING

Material: 5/8" CD Plywood or O.S.B.
Sheet Size: 48"x96" Sheets Perpendicular to Roof Framing
Fasteners: 8d Commons or ring-shank nails per schedule on sheet 1

SHEARWALLS

Material: 1/2" CD Plywood or 7/16" O.S.B.
Sheet Size: 48"x96" Sheets Placed Vertical, stagger each sheet.
Fasteners: 8d Common Nails @ 4" O.C. Edges & 8" O.C. Interior
Dragstrut: Double Top Plate (S.Y.P.) W/16d Nails @ 12" O.C.
Wall Studs: 2x4 Wood Studs @ 16" O.C.

HURRICANE UPLIFT CONNECTORS

Truss Anchors: SIMPSON H2.5A (OR EQUIVALENT), W/ 6 - 10d NLS
Wall Tension: Wall Sheathing Nailing is Adequate - 8d @ 4" O.C. > & Bot.
Anchor Bolts: 1/2" A307 Bolts @ 48" O.C. - 1st Bolt 6" from corner
Corner Hold-down Device: (1) DTT2Z (or equiv.) @ each corner
Porch Column Base Connector: Simpson ABU44/ABU66 @ eh column
Porch Column to Beam Connector: Simpson EPC44/PC44 @ each column

FOOTINGS AND FOUNDATIONS

Footing: 20"x 10" Cont. W/ (2) #5 Bars Cont. on wire chairs or (1) #transverse @ 24" O.C.
Stemwall: 8" C.M.U. W/1-#5 Vertical Dowel @ 48" O.C.

STRUCTURAL DESIGN CRITERIA:

1. THE DESIGN COMPLIES WITH THE REQUIREMENTS OF THE 2020 FLORIDA BUILDING CODE (7TH EDITION) AND OTHER REFERENCED CODES AND SPECIFICATIONS. ALL CODES AND SPECIFICATIONS SHALL BE LATEST EDITION AT TIME OF PERMIT.

2. WIND LOAD CRITERIA: RISK CATEGORY: 2, EXPOSURE "C"

BASED ON ANSI/ASCE 7-10, 2020 FBC 1609-A WIND VELOCITY: $V_{ULT} = 130$ MPH
 $V_{ASD} = 101$ MPH

3. ROOF DESIGN LOADS:
SUPERIMPOSED DEAD LOADS: 20 PSF
SUPERIMPOSED LIVE LOADS: 20 PSF

4. FLOOR DESIGN LOADS:
SUPERIMPOSED DEAD LOADS: 25 PSF
SUPERIMPOSED LIVE LOADS:
RESIDENTIAL: 40 PSF
BALCONIES: 60 PSF

5. WIND NET UPLIFT: ARE AS INDICATED ON PLANS

TERMITE PROTECTION NOTES:

SOIL CHEMICAL BARRIER METHOD:

1. A PERMANENT SIGN WHICH IDENTIFIES THE TERMITE TREATMENT PROVIDER AND NEED FOR REINSPECTION AND TREATMENT CONTRACT RENEWAL SHALL BE PROVIDED. THE SIGN SHALL BE POSTED NEAR THE WATER HEAT OR ELECTRIC PANEL. FBC 104.2.6
2. CONDENSATE AND ROOF DOWNSPOUTS SHALL DISCHARGE AT LST 1'-0" AWAY FROM BUILDING SIDE WALLS. FBC 1503.4.4
3. IRRIGATION/SPRINKLER SYSTEMS INCLUDING ALL RISERS AND SPRAY HEADS SHALL NOT BE INSTALLED WITHIN 1'-0" FROM BUILDING SIDEWALLS. FBC 1503.4.4
4. TO PROVIDE FOR INSPECTION FOR TERMITE INFESTATION, BETWEEN WALL COVERINGS AND FINAL EARTH GRADE SHALL NOT BE LESS THAN 6" EXCEPTION: PAINT AND DECORATIVE CEMENTIOUS FINISH LESS THAN 5/8" THICK ADHERED DIRECTLY TO THE FOUNDATION WALL. FBC 1403.1
5. INITIAL TREATMENT SHALL BE DONE AFTER ALL EXCAVATION AND BACKFILL IS COMPLETE. FBC 1816.1.1
6. SOIL DISTURBED AFTER THE INITIAL TREATMENT SHALL BE RETREATED INCLUDING SPACES BOXED OR FORMED. FBC 1816.1.2
7. BOXED AREAS IN CONCRETE FLOOR FOR SUBSEQUENT INSTALLATION OF TRAPS, ETC., SHALL BE MADE WITH PERMANENT METAL OR PLASTIC FORMS. PERMANENT FORMS MUST BE OF A SIZE AND DEPTH THAT WILL ELIMINATE THE DISTURBANCE OF SOIL AFTER THE INITIAL TREATMENT. FBC 1816.1.3
8. MINIMUM 6 MIL VAPOR RETARDER MUST BE INSTALLED TO PROTECT AGAINST RAINFALL DILUTION. IF RAINFALL OCCURS BEFORE VAPOR RETARDER PLACEMENT, RETREATMENT IS REQUIRED. FBC 1816.1.4
9. CONCRETE OVERPOUR AND MORTAR ALONG THE FOUNDATION RIMETER MUST BE REMOVED BEFORE EXTERIOR SOIL TREATMENT. FBC 1816.1.5
10. SOIL TREATMENT MUST BE APPLIED UNDER ALL EXTERIOR CONCRETE OR GRADE WITHIN 1'-0" OF THE STRUCTURE SIDEWALLS. FBC 1816.1.6
11. AN EXTERIOR VERTICAL CHEMICAL BARRIER MUST BE INSTALLED AFTER CONSTRUCTION IS COMPLETE INCLUDING LANDSCAPING AND IRRIGATION. ANY SOIL DISTURBED AFTER THE VERTICAL BARRIER IS APPLIED, SHALL BE RETREATED. FBC 1816.1.6
12. ALL BUILDINGS ARE REQUIRED TO HAVE PER-CONSTRUCTION TREATMENT. FBC 1816.1.7
13. A CERTIFICATE OF COMPLIANCE MUST BE ISSUED TO THE BUILDING DEPARTMENT BY A LICENSED PEST CONTROL COMPANY BEFORE A CERTIFICATE OF OCCUPANCY WILL BE ISSUED. THE CERTIFICATE OF COMPLIANCE SHALL STATE: "THE BUILDING HAS RECEIVED A COMPLETE TREATMENT FOR THE PREVENTION OF SUBTERRANEAN TERMITES. THE TREATMENT IS IN ACCORDANCE WITH THE RULES AND LAWS OF THE FLORIDA DEPARTMENT OF AGRICULTURE AND CONSUMER SERVICES". FBC 1816.1.7
14. AFTER ALL WORK IS COMPLETED, LOOSE WOOD AND FILL MUST BE REMOVED FROM BELOW AND WITHIN 1'-0" OF THE BUILDING. THIS INCLUDES GRADE STAKES, TUB TRAP BOXES, FORMS, SHORING OR OTHER CELLULOSE-CONTAINING MATERIAL. FBC 2303.1.3
15. NO WOOD, VEGETATION, STUMPS, CARDBOARD, TRASH, ETC., SHALL BE BURIED WITHIN 15'-0" OF ANY BUILDING OR PROPOSED BUILDING. FBC 2303.4

FRAMING ANCHOR SCHEDULE

APPLICATION	MANUFACTURER/MODEL	CAP.
TRUSS TO WALL:	SIMPSON H2.5A (OR EQUIVALENT), W/ 6 - 10d NLS	960#
GIRDER TRUSS TO POST/HEADER:	SIMPSON LGT, W/ 28 - 16d NAILS	1785#
HEADER TO KING STUD(S):	SIMPSON ST22	1370#
PLATE TO STUD:	SIMPSON SP2	1065#
STUD TO SILL:	SIMPSON SP1	585#
PORCH BEAM TO POST:	SIMPSON PC44/EPC44	1700#
PORCH POST TO FND.:	SIMPSON ABU44	2200#
MISC. JOINTS	SIMPSON A34	315#/240#

NOTE:
ALL ANCHORS SHALL BE SECURED W/ NAILS AS PRESCRIBED BY THE MANUFACTURER FOR MAXIMUM JOINT STRENGTH, UNLESS NOTED OTHERWISE.

NOTE:
REFER TO THE INCLUDED STRUCTURAL DETAILS FOR ADDITIONAL ANCHORS/JOINT REINFORCEMENT AND FASTENERS.

NOTE:
ALL UNLISTED JOINTS IN THE LOAD PATH SHALL BE REINFORCED WITH SIMPSON A34 FRAMING ANCHORS, TYPICAL T.O.

NOTE:
"SEMCO" PRODUCT APPROVAL:
MIAMI/DADE COUNTY REPORT #95-0818.15

NOTE:
"SIMPSON" PRODUCT APPROVALS:
MIAMI/DADE COUNTY REPORT #97-0107.05, #96-1126.11, #99-0623.04
SBCC1 NER-443, NER-393

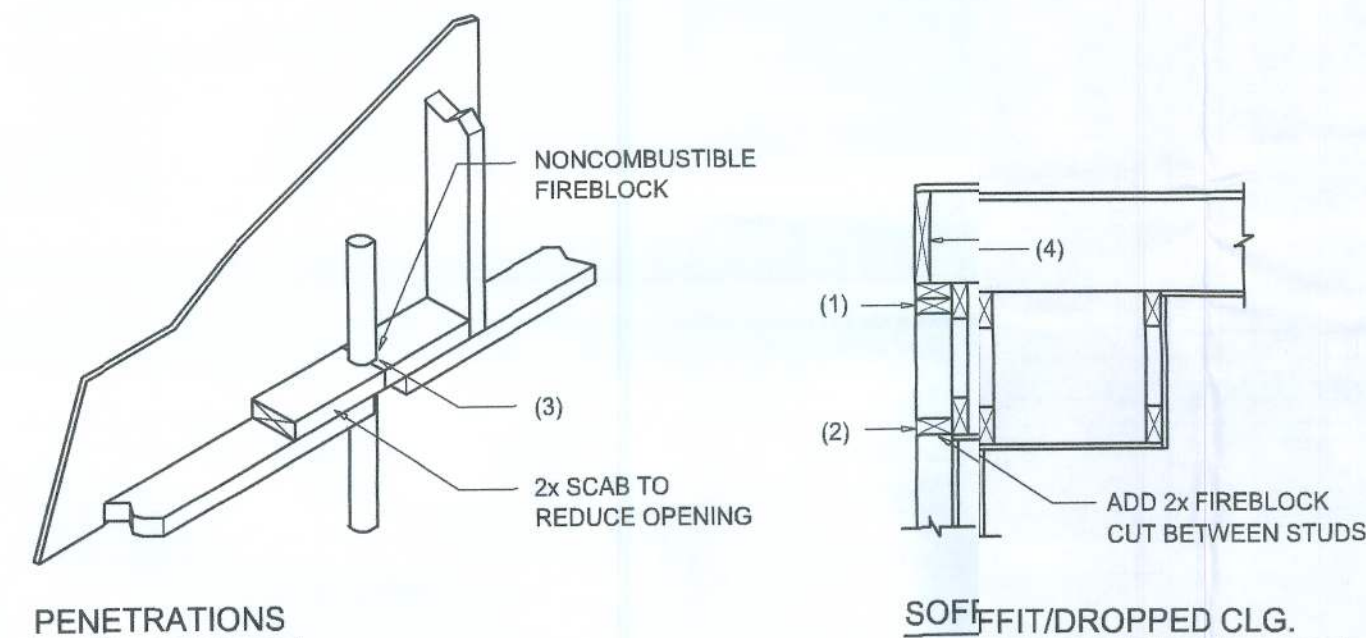

PENETRATIONS

SOFFIT/DROPPED CLG.

FIREBLOCKING NOTES:

FIREBLOCKING SHALL BE INSTALLED IN WOOD FRAME CONSTRUCTION IN THE FOLLOWING LOCATIONS:

1. IN CONCEALED SPACES OF STUD WALLS AND PARTITIONS INCLUDING FIRE-RESISTANT SPACES AT CEILING AND FLOOR LEVELS.
2. AT ALL INTERCONNECTIONS BETWEEN CONCEALED VERTICAL AND HORIZONTAL SPACES SUCH AS OCCUR AT SOFFITS, DROP CEILINGS, COVE CEILINGS, ETC.
3. AT OPENINGS AROUND VENTS, PIPES, DUCTS, CHIMNEYS AND FIREPLACES AT CEILING AND FLOOR LEVELS WITH "PYROPLAN MULTIFLEX SEALANT"
4. AT ALL INTERCONNECTIONS BETWEEN CONCEALED VERTICAL STUD WALLS OR PARTITION SPACES AND CONCEALED SPACES CREATED BY AN ASSEMBLY OF FLOOR JOISTS, FIREBLOCKING SHALL BE PROVIDED FOR THE FULL DEPTH OF THE JOISTS AT THE ENDS AND OVER THE SUPPORTS.

Fire Stopping DETAILS

SCALE: NONE

A

BUILDING COMPONENTS & CLADDING LOADS					
MEAN BUILDING HEIGHT = 30.0', EXPOSURE "B"					
ROOF ANGLE 21° TO 45°					
BLDG HEIGHT	EXPOSURE "B"	EXPOSURE "C"	EXPOSURE "D"	EXPOSURE "E"	EXPOSURE "F"
15	1.00	1.21	1.41	1.55	1.66
20	1.00	1.23	1.35	1.61	1.66
25	1.00	1.23	1.35	1.61	1.66
30	1.00	1.40	1.40	1.66	1.66

General Roofing NOTES:

DECK REQUIREMENTS:
ASPHALT SHINGLES SHALL BE FASTENED TO SOLIDLY SHEATHED DECKS.

SLOPE:
ASPHALT SHINGLES SHALL BE USED ONLY ON ROOF SLOPES OF 2:12 OR GREATER. FOR ROOF SLOPES FROM 2:12 TO 4:12, DBL. UNDERLAYMENT IS REQUIRED.

UNDERLAYMENT:
UNLESS OTHERWISE NOTED, UNDERLAYMENT SHALL CONFORM W/ ASTM D 226, TYPE 1, OR ASTM D 4869, TYPE 1.

SELF-ADHERING POLYMER MODIFIED BITUMEN SHEET:
SELF ADHERING POLYMER MODIFIED BITUMEN SHALL COMPLY W/ ASTM D 1970.

ASPHALT SHINGLES:
ASPHALT SHINGLES SHALL HAVE SELF SEAL STRIPS OR BE INTERLOCKING, AND COMPLY WITH ASTM D 225 OR ASTM D 3462.

FASTENERS:
FASTENERS FOR ASPHALT SHINGLES SHALL BE GALVANIZED, STAINLESS STEEL, ALUMINUM OR COPPER ROOFING NAILS. MINIMUM 12 GAUGE SHANK WITH A MINIMUM 3/8 INCH DIAMETER HEAD, OF A LENGTH TO PENETRATE THROUGH THE ROOFING MATERIAL AND A MINIMUM 3/4" INTO THE ROOF SHEATHING. WHERE THE SHEATHING IS LESS THAN 3/4" THICK, THE NAILS SHALL PENETRATE THROUGH THE SHEATHING.

ATTACHMENT:
ASPHALT SHINGLES SHALL BE SECURED TO THE ROOF WITH NOT LESS THAN FOUR FASTENERS PER STRIP SHINGLE OR TWO FASTENERS PER INDIVIDUAL SHINGLE. WHERE ROOFS LOCATED IN BASIC WIND SPEED OF 110 MPH OR GREATER, SPECIAL METHODS OF FASTENING ARE REQUIRED. UNLESS OTHERWISE NOTED, ATTACHMENT OF ASPHALT SHINGLES SHALL CONFORM WITH ASTM D 3161 OR M-DC PA 107-95.

UNDERLAYMENT APPLICATION:
FOR ROOF SLOPES FROM 2:12 TO 4:12, UNDERLAYMENT SHALL BE A MINIMUM OF TWO LAYERS APPLIED AS FOLLOWS:

1. STARTING AT THE EAVE, A 19 INCH STRIP OF UNDERLAYMENT SHALL BE APPLIED PARALLEL WITH THE EAVE AND FASTENED SUFFICIENTLY TO STAY IN PLACE.

2. STARTING AT THE EAVE, 36 INCH WIDE STRIPS OF UNDERLAYMENT FELT SHALL BE APPLIED OVERLAPPING SUCCESSIVE SHEETS 19 INCHES AND FASTENED SUFFICIENTLY TO STAY IN PLACE.

FOR ROOF SLOPED 4:12 AND GREATER, UNDERLAYMENT SHALL BE A MINIMUM OF ONE LAYER OF UNDERLAYMENT FELT APPLIED AS FOLLOWS:
STARTING AT THE EAVE, UNDERLAYMENT SHALL BE APPLIED SHINGLE FASHION PARALLEL TO THE EAVE, LAPPED 2 INCHES, AND FASTENED SUFFICIENTLY TO STAY IN PLACE.

BASE AND CAP FLASHINGS:
BASE AND CAP FLASHING SHALL BE INSTALLED IN ACCORDANCE W/ MFG'S INSTALLATION INSTRUCTIONS. BASE FLASHING SHALL BE OF EITHER CORROSION RESISTANT METAL OF MINIMUM NOMINAL THICKNESS 0.019 INCH OR MINERAL SURFACE ROLL ROOFING WEIGHING A MINIMUM OF 77 LBS PER 100 SQUARE FEET. CAP FLASHING SHALL BE CORROSION RESISTANT METAL OF MINIMUM NOMINAL THICKNESS OF 0.019 INCH.

VALLEYS:
VALLEY LININGS SHALL BE INSTALLED IN ACCORDANCE W/ MANUFACTURER'S INSTALLATION INSTRUCTIONS BEFORE APPLYING ASPHALT SHINGLES. VALLEY LININGS OF THE FOLLOWING TYPES SHALL BE PERMITTED.

1. FOR OPEN VALLEYS LINED WITH METAL, THE VALLEY LINING SHALL BE AT LEAST 16" WIDE AND OF ANY OF THE CORROSION RESISTANT METALS IN FBC TABLE 1507.3.9.2.
2. FOR OPEN VALLEYS, VALLEY LINING OF TWO PLIES OF MINERAL SURFACE ROLL ROOFING SHALL BE PERMITTED. THE BOTTOM LAYER SHALL BE 18 INCHES AND THE TOP LAYER A MINIMUM OF 36 INCHES WIDE.
3. FOR CLOSED VALLEYS VALLEY LINING SHALL BE ONE OF THE FOLLOWING:
 1. BOTH TYPES 1 AND 2 ABOVE, COMBINED.
 2. ONE PLY OF SMOOTH ROLL ROOFING AT LEAST 36 INCHES WIDE AND COMPLYING WITH ASTM D 224.
 3. SPECIALTY UNDERLAYMENT AT LEAST 36 INCHES WIDE AND COMPLYING WITH ASTM D 1970.

NOTE !!!

ROOF SHINGLES SHALL BE AS MANUFACTURED BY "TAMKO ROOFING PRODUCTS" OF THE FOLLOWING MODELS:

GLASS-SEAL AR
ELITE GLASS-SEAL AR
HERITAGE 30 AR
HERITAGE 40 AR
HERITAGE 50 AR

THESE SHINGLES MEET THE REQUIREMENTS OF ASTM D-3161 TYPE 1 MODIFIED TO 110 MPH WINDS & FBC TAS 100, USING 4 NAILS/SHINGLE

REVISIONS
April 01, 2021

SOFTPLAN
ARCHITECTURAL DESIGN SOFTWARE

DETAILS SHEET
SCALE: 1/4" = 1'-0"

LOT 22, TURKEY CREEK
PROJECT ADDRESS: COLUMBIA COUNTY, FLORIDA
LIPSCOMB & EAGLE
LAKE BUTLER, FLORIDA

MODEL 1343 FUR:

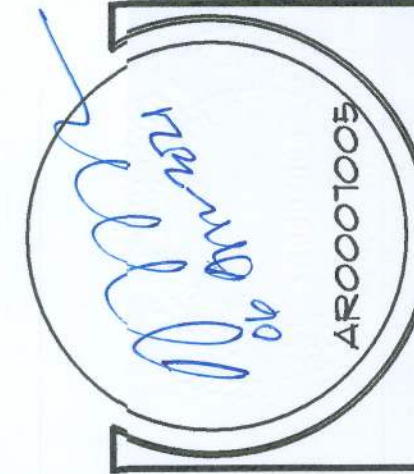

NICHOLAS
GEISLER
ARCHITECT
N.C.A.R.B. Certified
17559 NW Brown Rd.
Lake City, FL 32055
(386) 365-4355

JOB NUMBER
20210402

SHEET NUMBER
S.3
OF 4 SHEETS

NOTE: ALL DRAWINGS NOT TO BE SCALED, WRITTEN DIMENSIONS TAKE PRECEDENCE OVER SCALED DIMENSIONS

