

Columbia County Property Appraiser

Jeff Hampton

2021 Working Values

updated: 8/26/2021

Parcel: << 26-2S-15-00107-001 (259) >>

Aerial Viewer Pictometry Google Maps

Owner & Property Info

Result: 1 of 1

Owner	BOELTER CHARLES F 9084 SPINDLETREE WAY JACKSONVILLE, FL 32256		
Site	449 NW BERMUDA PL, WELLBORN		
Description*	BEG NW COR OF SEC, RUN E 810.45 FT, S 1096.26 FT, W 3.0 FT, S 1569.28 FT TO N R/W LESTER TAYLOR RD (NKA NW BERMUDA PL), W ALONG R/W 18.06 FT, N 1570.83 FT, W TO SEC LINE, N ALONG SEC LINE TO POB. 749-1031 870-260, 1034-187, LE 1286-1676, DC 1403-2588,		
Area	20.56 AC	S/T/R	26-2S-15
Use Code**	IMPROVED AG (5000)	Tax District	3

*The Description above is not to be used as the Legal Description for this parcel in any legal transaction.

**The Use Code is a FL Dept. of Revenue (DOR) code and is not maintained by the Property Appraiser's office. Please contact your city or county Planning & Zoning office for specific zoning information.

Property & Assessment Values

2020 Certified Values		2021 Working Values	
Mkt Land	\$13,087	Mkt Land	\$13,200
Ag Land	\$4,390	Ag Land	\$4,689
Building	\$99,902	Building	\$118,397
XFOB	\$11,600	XFOB	\$11,600
Just	\$201,195	Just	\$219,804
Class	\$128,979	Class	\$147,886
Appraised	\$128,979	Appraised	\$147,886
SOH Cap [?]	\$0	SOH Cap [?]	\$6,149
Assessed	\$128,979	Assessed	\$147,886
Exempt	\$0	Exempt	\$0
Total Taxable	county:\$128,979 city:\$128,979 other:\$128,979 school:\$128,979	Total Taxable	county:\$141,737 city:\$0 other:\$0 school:\$147,886

☒ 2019 ☐ 2016 ☐ 2013 ☐ 2010 ☐ 2007 ☐ 2005 ☒ Sales

+

-

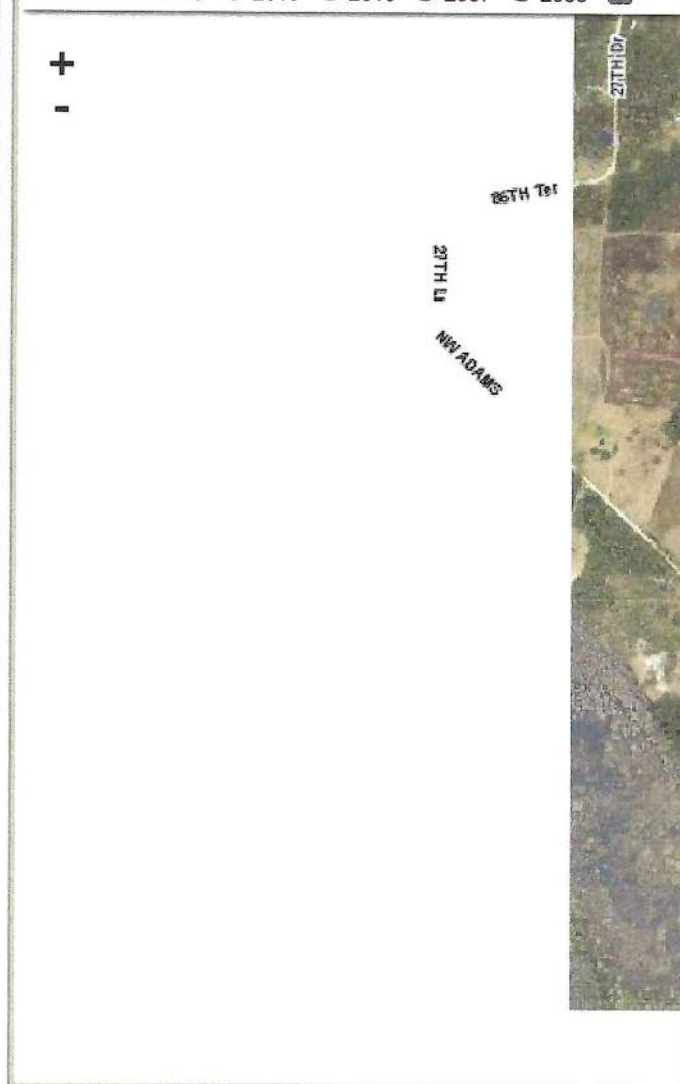

Sales History

Sale Date	Sale Price	Book/Page	Deed	V/I	Qualification (Codes)	RCode
12/4/2014	\$0	1286/1676	LE	I	U	14
9/29/2004	\$230,000	1034/0187	WD	I	U	01
6/30/1997	\$195,000	0847/1067	WD	I	U	01
7/16/1991	\$98,181	0749/1031	WD	V	Q	01

Building Characteristics

Bldg Sketch	Description*	Year Blt	Base SF	Actual SF	Bldg Value
Sketch	SINGLE FAM (0100)	1993	1944	2337	\$118,397

*Bldg Desc determinations are used by the Property Appraisers office solely for the purpose of determining a property's Just Value for ad valorem tax purposes and should not be used for any other purpose.

Extra Features & Out Buildings (Codes)

Code	Desc	Year Blt	Value	Units	Dims
0180	FPLC 1STRY	0	\$2,000.00	1.00	0 x 0
0030	BARN,MT	1993	\$8,000.00	1.00	24 x 40
0252	LEAN-TO W/O FLOOR	1993	\$800.00	320.00	8 x 40