

DATE 01/17/2007**Columbia County Building Permit****PERMIT**

This Permit Expires One Year From the Date of Issue

**000025417**

APPLICANT MARY ANN CRAWFORD PHONE 752-5152  
 ADDRESS 853 SW SISTERS WELCOME RD LAKE CITY FL 32025  
 OWNER LARRY WILMOTH PHONE 954 605-2685  
 ADDRESS 44255 SW CATHERINE ROAD LAKE CITY FL 32055  
 CONTRACTOR STANLEY CRAWFORD PHONE 752-5152  
 LOCATION OF PROPERTY 441S, TR ON CATHERINE ROAD, 1/2 MILE ON RIGHT

TYPE DEVELOPMENT SFD.UTILITY ESTIMATED COST OF CONSTRUCTION 109000.00  
 HEATED FLOOR AREA 2180.00 TOTAL AREA 3192.00 HEIGHT        STORIES 1  
 FOUNDATION CONC WALLS FRAMED ROOF PITCH 7/12 FLOOR SLAB  
 LAND USE & ZONING A-3 MAX. HEIGHT 20  
 Minimum Set Back Requirements: STREET-FRONT 30.00 REAR 25.00 SIDE 25.00  
 NO. EX.D.U. 0 FLOOD ZONE X DEVELOPMENT PERMIT NO.       

PARCEL ID 22-5S-17-09328-006 SUBDIVISION         
 LOT        BLOCK        PHASE        UNIT        TOTAL ACRES       

000001304

Culvert Permit No.        Culvert Waiver        Contractor's License Number        Applicant/Owner/Contractor *Mary Ann Crawford*  
WAIVER 06-1105-N BK JH  
 Driveway Connection        Septic Tank Number        LU & Zoning checked by        Approved for Issuance        New Resident       

COMMENTS: ONE FOOT ABOVE THE ROADALTERNATE TREATMENT RECEIVED       Check # or Cash 9382**FOR BUILDING & ZONING DEPARTMENT ONLY**

(footer Slab)

Temporary Power        Foundation        Monolithic         
date/app. by date/app. by date/app. by  
 Under slab rough-in plumbing        Slab        Sheathing/Nailing         
date/app. by date/app. by date/app. by  
 Framing        Rough-in plumbing above slab and below wood floor         
date/app. by date/app. by  
 Electrical rough-in        Heat & Air Duct        Peri. beam (Lintel)         
date/app. by date/app. by date/app. by  
 Permanent power        C.O. Final        Culvert         
date/app. by date/app. by date/app. by  
 M/H tie downs, blocking, electricity and plumbing        Pool         
date/app. by date/app. by  
 Reconnection        Pump pole        Utility Pole         
date/app. by date/app. by date/app. by  
 M/H Pole        Travel Trailer        Re-roof         
date/app. by date/app. by date/app. by

BUILDING PERMIT FEE \$ 545.00 CERTIFICATION FEE \$ 15.96 SURCHARGE FEE \$ 15.96MISC. FEES \$ 0.00 ZONING CERT. FEE \$ 50.00 FIRE FEE \$ 0.00 WASTE FEE \$       FLOOD DEVELOPMENT FEE \$        FLOOD ZONE FEE \$ 25.00 CULVERT FEE \$        **TOTAL FEE** 651.92INSPECTORS OFFICE *Stanley Crawford* CLERKS OFFICE *CH*

NOTICE: IN ADDITION TO THE REQUIREMENTS OF THIS PERMIT, THERE MAY BE ADDITIONAL RESTRICTIONS APPLICABLE TO THIS PROPERTY THAT MAY BE FOUND IN THE PUBLIC RECORDS OF THIS COUNTY. AND THERE MAY BE ADDITIONAL PERMITS REQUIRED FROM OTHER GOVERNMENTAL ENTITIES SUCH AS WATER MANAGEMENT DISTRICTS, STATE AGENCIES, OR FEDERAL AGENCIES

"WARNING TO OWNER: YOUR FAILURE TO RECORD A NOTICE OF COMMENCEMENT MAY RESULT IN YOUR PAYING TWICE FOR IMPROVEMENTS TO YOUR PROPERTY. IF YOU INTEND TO OBTAIN FINANCING, CONSULT WITH YOUR LENDER OR AN ATTORNEY BEFORE RECORDING YOUR NOTICE OF COMMENCEMENT."

**This Permit Must Be Prominently Posted on Premises During Construction**

PLEASE NOTIFY THE COLUMBIA COUNTY BUILDING DEPARTMENT AT LEAST 24 HOURS IN ADVANCE OF EACH INSPECTION, IN ORDER THAT IT MAY BE MADE WITHOUT DELAY OR INCONVENIENCE. PHONE 758-1008. THIS PERMIT IS NOT VALID UNLESS THE WORK AUTHORIZED BY IT IS COMMENCED WITHIN 6 MONTHS AFTER ISSUANCE.

The Issuance of this Permit Does Not Waive Compliance by Permittee with Deed Restrictions.

# Columbia County Building Permit Application

For Office Use Only Application # 0701-34 Date Received 1/9/07 By ST Permit # 1304/2541  
 Application Approved by - Zoning Official BLK Date 16.01.07 Plans Examiner OKTH Date 1-11-07  
 Flood Zone X Development Permit N/A Zoning A-3 Land Use Plan Map Category A-3  
 Comments \_\_\_\_\_  
☐ NOC ☒ EH ☐ Deed or PA ☒ Site Plan ☐ State Road Info ☐ Parent Parcel # ☐ Development Per

Name Authorized Person Signing Permit Mary Ann Crawford Phone (386) 752-5152  
 Address 853 S.W. Sisters Welcome Rd. Lake City, FL 32025  
 Owners Name Larry Wilmoth Phone (954) 605-2685  
 911 Address 631 - Catherine Rd. Lake City, FL 32055  
 Contractors Name Stanley Crawford Construction, Inc. Phone (386) 752-5152  
 Address 853 S.W. Sisters Welcome Rd. Lake City, FL 32025  
 Fee Simple Owner Name & Address \_\_\_\_\_  
 Bonding Co. Name & Address \_\_\_\_\_  
 Architect/Engineer Name & Address Mark Disoway P.O. Box 868 Lake City, FL 32056  
 Mortgage Lenders Name & Address N/A

Circle the correct power company - FL Power & Light - Clay Elec. - Suwannee Valley Elec. - Progressive Energy  
 Property ID Number 22-55-17-09328-006 Estimated Cost of Construction \$110,000.00  
 Subdivision Name \_\_\_\_\_ Lot \_\_\_\_\_ Block \_\_\_\_\_ Unit \_\_\_\_\_ Phase \_\_\_\_\_  
 Driving Directions Take Highway 41/441 South 2 miles beyond Watermelon Park - turn right on Catherine Rd. - Site is 1/2 mile on right.

Type of Construction Residential Number of Existing Dwellings on Property 0  
 Total Acreage 8.04 Lot Size \_\_\_\_\_ \* Do you need a - Culvert Permit or Culvert Waiver or Have an Existing Dr  
 Actual Distance of Structure from Property Lines - Front 150 Side Left 160 Right 48 Rear 1158.4  
 Total Building Height 20' 8" Number of Stories 1 Heated Floor Area 2180.5 Roof Pitch 7/12  
 TOTAL 3192

Application is hereby made to obtain a permit to do work and installations as indicated. I certify that no work or installation has commenced prior to the issuance of a permit and that all work be performed to meet the standards c all laws regulating construction in this jurisdiction.

OWNERS AFFIDAVIT: I hereby certify that all the foregoing information is accurate and all work will be done in compliance with all applicable laws and regulating construction and zoning.

WARNING TO OWNER: YOUR FAILURE TO RECORD A NOTICE OF COMMENCEMENT MAY RESULT IN YOU PAYING TWICE FOR IMPROVEMENTS TO YOUR PROPERTY. IF YOU INTEND TO OBTAIN FINANCING, CONSULT WITH YOUR LENDER OR ATTORNEY BEFORE RECORDING YOUR NOTICE OF COMMENCEMENT.

Owner Builder or Authorized Person by Notarized Letter \_\_\_\_\_

STATE OF FLORIDA  
 COUNTY OF COLUMBIA

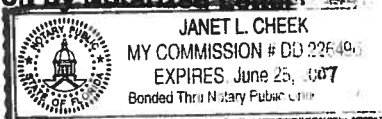

Sworn to (or affirmed) and subscribed before me

this 8th day of January 2007

Personally known ☒ or Produced Identification ☐

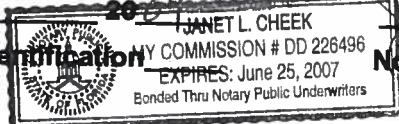

Stanley Crawford  
 Contractor Signature  
 Contractors License Number RG-0042896  
 Competency Card Number 5627  
 NOTARY STAMP/SEAL

Janet L. Cheek  
 Notary Signature  
 (Revised 6)

A SKETCH OF DEED IN SECTION 22, TOWNSHIP 5 SOUTH,  
RANGE 17 EAST, COLUMBIA COUNTY, FLORIDA.

# SYMBOL LEGEND

- 4"x4" CONCRETE MONUMENT FOUND
- 4"x4" CONCRETE MONUMENT SET
- IRON PIPE FOUND
- IRON PIN AND CAP SET
- POWER POLE
- △ WATER METER
- CENTERLINE
- WELL
- SATELLITE DISH
- TELEPHONE BOX
- ELECTRIC LINES
- WIRE FENCE
- CHAIN LINK FENCE
- WOODEN FENCE



SCALE: 1" = 100'

**DESCRIPTION:**  
A PART OF THE SW 1/4 OF SECTION 22, TOWNSHIP 5 SOUTH, RANGE 17 EAST, MORE PARTICULARLY DESCRIBED AS FOLLOWS: COMMENCE AT THE SOUTHEAST CORNER OF THE SW 1/4 OF SAID SW 1/4 AND RUN N00°34'32"E, 1410.70' (DEED), S166°39'52"W, 518.82' FEET TO A POINT ON THE NORTH RIGHT-OF-WAY LINE OF ST. CATHERINE ROAD (AN EXISTING MAINTAINED ROAD); SAID POINT ALSO BEING THE POINT OF BEGINNING; THENCE S66°39'52"W, 1410.70' FEET TO THE POINT OF BEGINNING; THENCE N00°34'32"E, 1308.48' FEET TO THE POINT OF BEGINNING. COLUMBIA COUNTY, FLORIDA

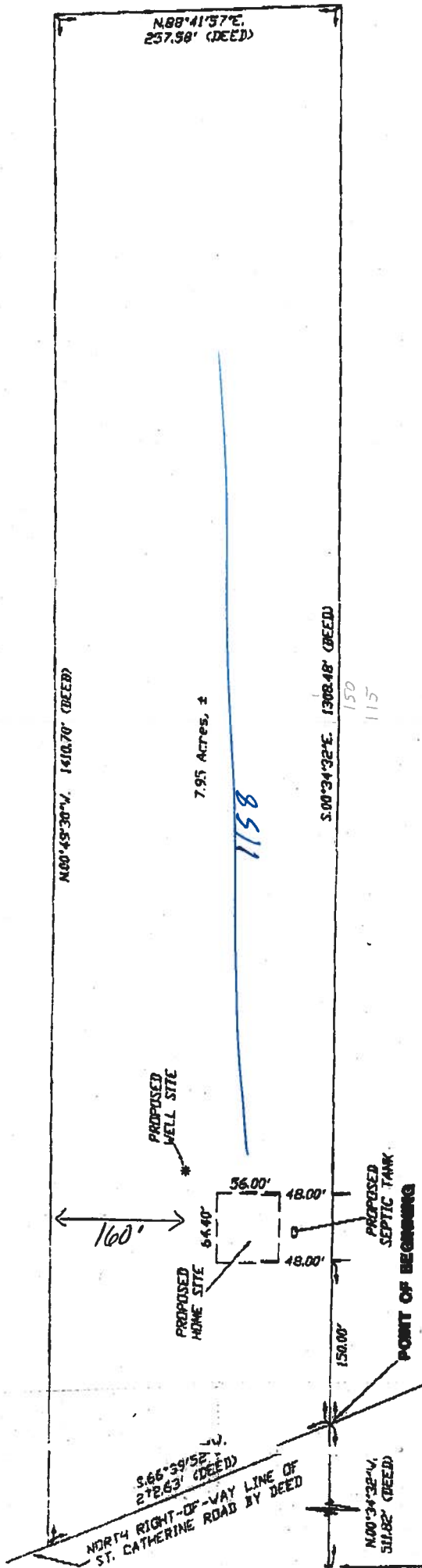

**POINT OF COMMENCEMENT**  
SE CORNER OF P SW 1/4  
OF SW 1/4, SECTION 22,  
TOWNSHIP 5 S SOUTH,  
RANGE 17 EAST

CERTIFIED TO:  
LARRY WILMOTH

FIELD # 100, SEE PAGE(S) FILE

## SURVEYOR'S CERTIFICATION

I HEREBY CERTIFY THAT THIS SURVEY WAS MADE UNDER MY PERSONAL SUPERVISION AND THAT THE MEASUREMENTS, CALCULATIONS, AND PLANS WERE MADE BY ME OR BY A PERSON LICENSED SURVEYOR AND APPROVED BY ME. I AM A LICENSED SURVEYOR IN THE STATE OF FLORIDA, LICENSE NO. 1214706, EXPIRATION DATE 12/14/06.

FIELD SURVEY DATE: 12/14/06  
DRAWN BY: LARRY WILMOTH  
CHECKED BY: LARRY WILMOTH  
I HEREBY CERTIFY THAT THIS SURVEY WAS MADE UNDER MY PERSONAL SUPERVISION AND THAT THE MEASUREMENTS, CALCULATIONS, AND PLANS WERE MADE BY ME OR BY A PERSON LICENSED SURVEYOR AND APPROVED BY ME. I AM A LICENSED SURVEYOR IN THE STATE OF FLORIDA, LICENSE NO. 1214706, EXPIRATION DATE 12/14/06.

**BRITTS SURVEYING**

LAND SURVEYORS AND MAPPERS  
829 WEST BIVAL STREET LAKE CITY, FLORIDA 33603  
(813) 752-7163 FAX (813) 752-5073  
WORK ORDER # L-18022

This Instrument Prepared by & return to:  
Name: KIM WATSON, an employee of  
TITLE OFFICES, LLC  
Address: 1089 SW MAIN BLVD.  
LAKE CITY, FLORIDA 32025  
File No. 05Y-05077KW

Inst: 2005013893 Date: 06/14/2005 Time: 12:33  
Doc Stamp-Deed: 489.30  
MK DC, P. DeWitt Cason, Columbia County B: 1048 P: 2433

Parcel I.D. #: 09328-006

SPACE ABOVE THIS LINE FOR PROCESSING DATA

SPACE ABOVE THIS LINE FOR RECORDING DATA

**THIS WARRANTY DEED** Made the 6th day of June, A.D. 2005, by **KEVIN L. BEDENBAUGH, SR.**

MARRIED, hereinafter called the grantor, to **JOAN WILMOTH,**  
A WIDOW, and **LARRY WILMOTH, SINGLE,** JOINT TENANTS WITH RIGHTS OF  
SURVIVORSHIP, whose post office address is 1200 HILLCREST CT APT 314, HOLLYWOOD,  
FLORIDA 33021  
hereinafter called the grantees:

(Wherever used herein the terms "grantor" and "grantees" include all the parties to this instrument, singular and plural, the heirs, legal representatives and assigns of individuals, and the successors and assigns of corporations, wherever the context so admits or requires.)

Witnesseth: That the grantor, for and in consideration of the sum of \$10.00 and other valuable consideration, receipt whereof is hereby acknowledged, does hereby grant, bargain, sell, alien, remise, release, convey and confirm unto the grantees all that certain land situate in **Columbia County, State of FLORIDA**, viz:

A PART OF THE SW ¼ OF SECTION 22, TOWNSHIP 5 SOUTH, RANGE 17 EAST, MORE PARTICULARLY DESCRIBED AS FOLLOWS: COMMENCE AT THE SOUTHEAST CORNER OF THE SW ¼ OF SAID SW ¼ AND RUN N 0°34'32" W, ALONG THE EAST LINE THEREOF, 511.82 FEET TO A POINT ON THE NORTH RIGHT-OF-WAY LINE OF ST. CATHERINE ROAD (AN EXISTING COUNTY MAINTAINED ROAD); SAID POINT ALSO BEING THE POINT OF BEGINNING; THENCE S 66°39'52" W, ALONG SAID NORTH RIGHT-OF-WAY LINE, 272.63 FEET; THENCE N 0°49'30" W, 1410.70 FEET; THENCE N 88°41'57" E, 257.58 FEET; THENCE S 0°34'32" E, 1308.48 FEET TO THE POINT OF BEGINNING. COLUMBIA COUNTY, FLORIDA.

THE ABOVE DESCRIBED PROPERTY IS NOT THE HOMESTEAD OF THE GRANTOR.

Together with all the tenements, hereditaments and appurtenances thereto belonging or in anywise appertaining.

To Have and to Hold the same in fee simple forever.

And the grantor hereby covenants with said grantees that he is lawfully seized of said land in fee simple; that he has good right and lawful authority to sell and convey said land, and hereby fully warrants the title to said land and will defend the same against the lawful claims of all persons whomsoever, and that said land is free of all encumbrances, except taxes accruing subsequent to December 31, 2004.

In Witness Whereof, the said grantor has signed and sealed these presents, the day and year first above written.

Signed, sealed and delivered in the presence of:

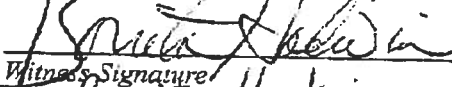
  
Witness Signature

BENITA HADWIN  
Printed Name

  
Witness Signature

Regina Simpkins  
Printed Name

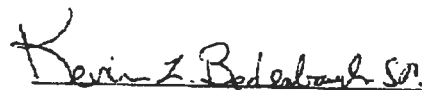
  
L.S.  
KEVIN L. BEDENBAUGH, SR.  
Address:  
P.O. BOX 1416, LIVE OAK, FL 32064

The foregoing instrument was acknowledged before me this 6th day of June, 2005, by KEVIN L. BEDENBAUGH, SR., who is known to me or who has produced Positive as identification.



Bonita Hadwin  
MY COMMISSION # 00238004 EXPIRES  
August 10, 2007  
BONDED THROUGH FARM INSURANCE INC

Bonita Hadwin  
Notary Public  
My Commission expires \_\_\_\_\_

Application for Onsite Sewage Disposal System  
Construction Permit. Part II Site Plan  
Permit Application Number: 06-01105N

**ALL CHANGES MUST BE APPROVED BY THE COUNTY HEALTH UNIT**

WILMOTH/CR 06-3783

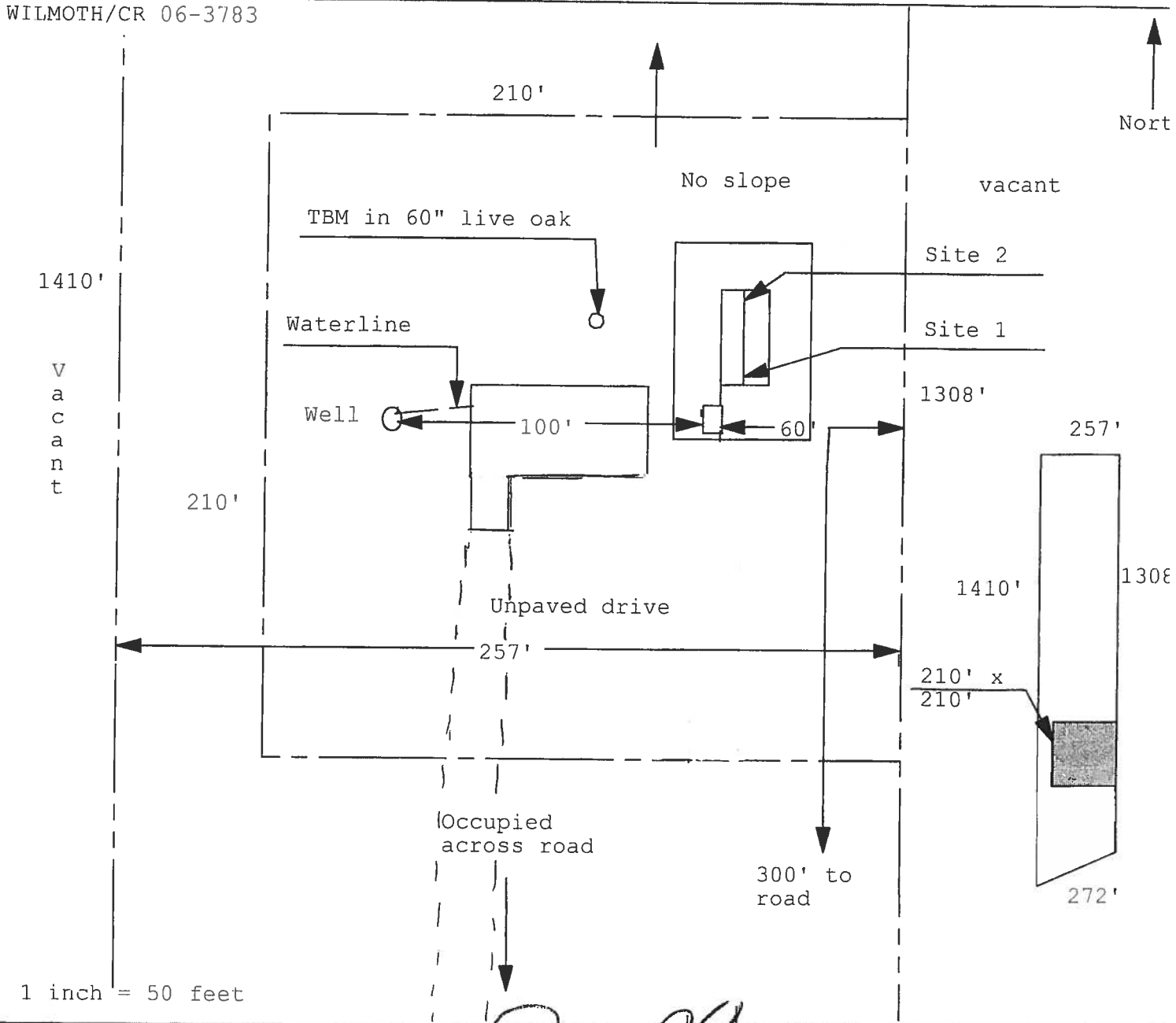

Site Plan Submitted By Paul Lopez Date 11/29/2012  
Plan Approved [Signature] Not Approved Date 12/18/12  
By [Signature] **APPROVED** **Columbia CHD** CPHU

Notes: \_\_\_\_\_

FORM 600A-2004

EnergyGauge® 4.0

# FLORIDA ENERGY EFFICIENCY CODE FOR BUILDING CONSTRUCTION

Florida Department of Community Affairs  
Residential Whole Building Performance Method A

Project Name: <u>Willmoth</u>	Builder: <u>STANLEY CRAWFORD</u>
Address:	Permitting Office: <u>Columbia</u>
City, State:	Permit Number: <u>25417</u>
Owner:	Jurisdiction Number: <u>221008</u>
Climate Zone: <u>North</u>	

1. New construction or existing <u>New</u>	12. Cooling systems
2. Single family or multi-family <u>Single family</u>	a. Central Unit <u>Cap: 42.0 kBtu/hr</u>
3. Number of units, if multi-family <u>1</u>	<u>SEER: 13.00</u>
4. Number of Bedrooms <u>3</u>	b. N/A
5. Is this a worst case? <u>Yes</u>	c. N/A
6. Conditioned floor area (ft²) <u>2180 ft²</u>	13. Heating systems
7. Glass type <sup>1</sup> and area: (Label reqd. by 13-104.4.5 if not default)	a. Electric Heat Pump <u>Cap: 41.0 kBtu/hr</u>
a. U-factor: <u>Description Area</u>	<u>HSPF: 7.00</u>
(or Single or Double DEFAULT) 7a. (Dble Default) <u>312.0 ft²</u>	b. N/A
b. SHGC:	c. N/A
(or Clear or Tint DEFAULT) 7b. (Clear) <u>312.0 ft²</u>	14. Hot water systems
8. Floor types	a. Electric Resistance <u>Cap: 50.0 gallons</u>
a. Slab-On-Grade Edge Insulation <u>R=0.0, 227.0(p) ft²</u>	<u>EF: 0.92</u>
b. N/A	b. N/A
c. N/A	c. Conservation credits
9. Wall types	(HR-Heat recovery, Solar
a. Frame, Wood, Exterior <u>R=13.0, 1296.0 ft²</u>	DTIP-Dedicated heat pump)
b. Frame, Wood, Adjacent <u>R=13.0, 266.0 ft²</u>	15. HVAC credits
c. N/A	(CF-Ceiling fan, CV-Cross ventilation,
d. N/A	WH-Whole house fan,
e. N/A	PT-Programmable Thermostat,
10. Ceiling types	MZ-C-Multizone cooling,
a. Under Attic <u>R=30.0, 2180.0 ft²</u>	M7-H-Multizone heating)
b. N/A	
c. N/A	
11. Ducts	
a. Sup: Unc. Ret: Unc. AH: Interior <u>Sup. R=6.0, 288.0 ft²</u>	
b. N/A	

Glass/Floor Area: 0.14

Total as-built points: 27539

Total base points: 30330

**PASS**

I hereby certify that the plans and specifications covered by this calculation are in compliance with the Florida Energy Code.

PREPARED BY: Stanley CrawfordDATE: 5/15/06

I hereby certify that this building, as designed, is in compliance with the Florida Energy Code.

OWNER/AGENT: Stanley CrawfordDATE: 1/8/07

Review of the plans and specifications covered by this calculation indicates compliance with the Florida Energy Code. Before construction is completed this building will be inspected for compliance with Section 553.908 Florida Statutes.

BUILDING OFFICIAL: \_\_\_\_\_

DATE: \_\_\_\_\_



<sup>1</sup> Predominant glass type. For actual glass type and areas, see Summer & Winter Glass output on pages 2&4.

FORM 600A-2004

EnergyGauge® 4.0

# SUMMER CALCULATIONS

## Residential Whole Building Performance Method A - Details

ADDRESS: , , ,

PERMIT #:

BASE				AS-BUILT								
GLASS TYPES												
.18 X Conditioned X BSPM = Points Floor Area				Type/SC	Overhang Ornt Len Hgt		Area X SPM X SOF = Points					
.18	2188.0	20.04	7893.7	Double, Clear	E	2.0	6.0	88.0	42.08	0.85	3139.0	
				Double, Clear	N	2.0	6.0	52.0	19.20	0.80	898.7	
				Double, Clear	S	2.0	6.0	48.0	35.87	0.78	1336.0	
				Double, Clear	W	2.0	6.0	124.0	38.52	0.85	4057.5	
				As-Built Total:				312.6		9431.3		
WALL TYPES Area X BSPM = Points				Type	R-Value		Area X SPM = Points					
Adjacent	268.0	0.70	188.2	Frame, Wood, Exterior	13.0		1298.0	1.50	1944.0			
Exterior	1298.0	1.70	2203.2	Frame, Wood, Adjacent	13.0		268.0	0.60	159.8			
Base Total: 1562.0 2388.4				As-Built Total:				1562.0		2103.6		
DOOR TYPES Area X BSPM = Points				Type	Area X SPM = Points							
Adjacent	18.0	2.40	43.2	Exterior Insulated	36.0 4.10 147.6							
Exterior	36.0	6.10	219.6	Adjacent Insulated	18.0 1.60 28.8							
Base Total: 54.0 262.8				As-Built Total:				54.0		176.4		
CEILING TYPES Area X BSPM = Points				Type	R-Value		Area X SPM X SCM = Points					
Under Attic	2180.0	1.73	3771.4	Under Attic	30.0		2180.0	1.73 X 1.00	3771.4			
Base Total: 2180.0 3771.4				As-Built Total:				2180.0		3771.4		
FLOOR TYPES Area X BSPM = Points				Type	R-Value		Area X SPM = Points					
Slab	227.0(p)	-37.0	-8399.0	Slab-On-Grade Edge Insulation	0.0		227.0(p)	-41.20	-9352.4			
Raised	0.0	0.00	0.0									
Base Total: -8399.0				As-Built Total:				227.0		-9352.4		
INFILTRATION Area X BSPM = Points				Area X SPM = Points								
2180.0 10.21 22257.8				2180.0 10.21 22257.8								



FORM 600A-2004

EnergyGauge® 4.0

# SUMMER CALCULATIONS

## Residential Whole Building Performance Method A - Details

ADDRESS: , , ,

PERMIT #:

BASE			AS-BUILT					
Summer Base Points: 28146.1			Summer As-Built Points: 28388.1					
Total Summer Points	X System Multiplier	= Cooling Points	Total Component (System - Points)	X Cap Ratio	X Duct Multiplier (DM x DSM x AHU)	X System Multiplier	X Credit Multiplier	= Cooling Points
			(sys 1: Central Unit 42000 btuh, SEER/EFF(13.0) Ducts: Uno(S), Uno(R), Ins(AH), R8.0(INS)					
28146.1	0.4266	12007.1	28388	1.00	(1.00 x 1.147 x 0.91)	0.263	1.000	8479.3
			28388.1	1.00	1.138	0.263	1.000	8479.3

FORM 600A-2004

EnergyGauge® 4.0

**WINTER CALCULATIONS****Residential Whole Building Performance Method A - Details**

ADDRESS: , , ,

PERMIT #:

BASE				AS-BUILT							
GLASS TYPES											
.18 X Conditioned X BWPM = Points Floor Area				Type/SC	Overhang Omt Len Hgt			Area X WPM X WOF = Point			
.18	2180.0	12.74	4999.2	Double, Clear	E	2.0	6.0	88.0	18.79	1.06	1753.9
				Double, Clear	N	2.0	6.0	52.0	24.58	1.00	1284.0
				Double, Clear	S	2.0	6.0	48.0	13.30	1.28	803.3
				Double, Clear	W	2.0	6.0	124.0	20.73	1.04	2680.1
				As-Built Total:			312.0			8521.3	
WALL TYPES Area X BWPM = Points				Type	R-Value			Area X WPM = Points			
Adjacent	280.0	3.60	957.6	Frame, Wood, Exterior	13.0			1280.0	3.40	4406.4	
Exterior	1298.0	3.70	4795.2	Frame, Wood, Adjacent	13.0			265.0	3.30	877.8	
Base Total: 1562.0 6752.8				As-Built Total:			1542.0			6284.2	
DOOR TYPES Area X BWPM = Points				Type				Area X WPM = Points			
Adjacent	18.0	11.50	207.0	Exterior Insulated				35.0	8.40	302.4	
Exterior	36.0	12.30	442.8	Adjacent Insulated				18.0	8.00	144.0	
Base Total: 54.0 649.8				As-Built Total:			54.0			446.4	
CEILING TYPES Area X BWPM = Points				Type	R Value			Area X WPM X WCM = Points			
Under Attic	2180.0	2.05	4469.0	Under Attic	30.0			2180.0	2.05 X 1.00	4469.0	
Base Total: 2180.0 4469.0				As-Built Total:			2180.0			4469.0	
FLOOR TYPES Area X BWPM = Points				Type	R-Value			Area X WPM = Points			
Slab	227.0(p)	8.8	2020.3	Slab-On-Grade Edge Insulation	0.0			227.0(p)	18.60	4267.8	
Raised	0.0	0.00	0.0								
Base Total: 2020.3				As-Built Total:			227.0			4267.8	
INFILTRATION Area X BWPM = Points							Area X WPM = Points				
2180.0 -0.58 -1266.2							2180.0 -0.58 -1266.2				

# WINTER CALCULATIONS

## Residential Whole Building Performance Method A - Details

ADDRESS: , , ,

PERMIT #:

BASE			AS-BUILT						
Winter Base Points: 16604.9			Winter As-Built Points: 19702.3						
Total Winter X Points	System = Multiplier	Heating Points	Total X Cap X Duct X System X Credit = Heating Component Ratio Multiplier Multiplier Multiplier Points						
			(System - Points)	(DM x DSM x AHU)					
			(sys 1: Electric Heat Pump 41000 btuh .EFF(7.0) Ducts:Unc(S),Unc(R),Int(AH),R6.0 19702.3 1.000 (1.000 x 1.162 x 0.93) 0.487 1.000 11154.5 19702.3 1.00 1.162 0.487 1.000 11154.5						
16604.9	0.6274	10417.9							

# WATER HEATING & CODE COMPLIANCE STATUS

## Residential Whole Building Performance Method A - Details

ADDRESS: , , ,

PERMIT #:

BASE				AS-BUILT					
WATER HEATING									
Number of Bedrooms	X	Multiplier	= Total	Tank Volume	EF	Number of Bedrooms	X Tank X Ratio	Multiplier X Credit	= Total Multiplier
3		2635.00	7905.0	50.0	0.92	3	1.00	2635.00	1.00 7905.0
				As-Built Total:					
				7905.0					

CODE COMPLIANCE STATUS							
BASE				AS-BUILT			
Cooling Points	+	Heating Points	+ Hot Water Points = Total Points	Cooling Points	+	Heating Points	+ Hot Water Points = Total Points
12007		10418	7905 30330	8479		11154	7905 27539

PASS



# Code Compliance Checklist

## Residential Whole Building Performance Method A - Details

ADDRESS: , , ,

PERMIT #:

**6A-21 INFILTRATION REDUCTION COMPLIANCE CHECKLIST**

COMPONENTS	SECTION	REQUIREMENTS FOR EACH PRACTICE	CHECK
Exterior Windows & Doors	606.1.ABC.1.1	Maximum: .3 cfm/sq.ft. window area; .5 cfm/sq.ft. door area.	
Exterior & Adjacent Walls	606.1.ABC.1.2.1	Caulk, gasket, weatherstrip or seal between: windows/doors & frames, surrounding wall; foundation & wall sole or sill plate; joints between exterior wall panels at corners; utility penetrations; between wall panels & top/bottom plates; between walls and floor. EXCEPTION: Frame walls where a continuous infiltration barrier is installed that extends from, and is sealed to, the foundation to the top plate.	
Floors	606.1.ABC.1.2.2	Penetrations/openings >1/8" sealed unless backed by truss or joist members. EXCEPTION: Frame floors where a continuous infiltration barrier is installed that is sealed to the perimeter, penetrations and seams.	
Ceilings	606.1.ABC.1.2.3	Between walls & ceilings; penetrations of ceiling plane of top floor; around shafts, chases, soffits, chimneys, cabinets sealed to continuous air barrier; gaps in gyp board & top plate; attic access. EXCEPTION: Frame ceilings where a continuous infiltration barrier is installed that is sealed at the perimeter, at penetrations and seams.	
Recessed Lighting Fixtures	606.1.ABC.1.2.4	Type IC rated with no penetrations, sealed; or Type IC or non-IC rated, installed inside a sealed box with 1/2" clearance & 3" from insulation; or Type IC rated with < 2.0 cfm from conditioned space, tested.	
Multi-story Houses	606.1.ABC.1.2.5	Air barrier on perimeter of floor cavity between floors.	
Additional Infiltration reqts	606.1.ABC.1.3	Exhaust fans vented to outdoors, dampers; combustion space heaters comply with NFPA, have combustion air.	

**6A-22 OTHER PRESCRIPTIVE MEASURES (must be met or exceeded by all residences.)**

COMPONENTS	SECTION	REQUIREMENTS	CHECK
Water Heaters	612.1	Comply with efficiency requirements in Table 612.1.ABC.3.2. Switch or clearly marked circuit breaker (electric) or cutoff (gas) must be provided. External or built-in heat trap required.	
Swimming Pools & Spas	612.1	Spas & heated pools must have covers (except solar heated). Non-commercial pools must have a pump timer. Gas spa & pool heaters must have a minimum thermal efficiency of 78%.	
Shower heads	612.1	Water flow must be restricted to no more than 2.5 gallons per minute at 80 PSIG.	
Air Distribution Systems	610.1	All ducts, fittings, mechanical equipment and plenum chambers shall be mechanically attached, sealed, insulated, and installed in accordance with the criteria of Section 610. Ducts in unconditioned attics: R-6 min. insulation.	
HVAC Controls	607.1	Separate readily accessible manual or automatic thermostat for each system.	
Insulation	604.1, 602.1	Ceilings-Min. R-19. Common walls-Frame R-11 or CBS R-3 both sides. Common ceiling & floors R-11.	

# ENERGY PERFORMANCE LEVEL (EPL) DISPLAY CARD

**ESTIMATED ENERGY PERFORMANCE SCORE\* = 84.9**

*The higher the score, the more efficient the home.*

1. New construction or existing	New	12. Cooling systems	
2. Single family or multi-family	Single family	a. Central Unit	Cap: 42.0 kBtu/hr
3. Number of units, if multi-family	1		SEER: 13.00
4. Number of Bedrooms	3	b. N/A	
5. Is this a worst case?	Yes	c. N/A	
6. Conditioned floor area (ft <sup>2</sup> )	2180 ft <sup>2</sup>		
7. Glass type <sup>1</sup> and area: (Label reqd. by 13-104.4.5 if not default)		13. Heating systems	
a. U-factor:	Description Area	a. Electric Heat Pump	Cap: 41.0 kBtu/hr
(or Single or Double DEFAULT) 7a. (Dble Default) 312.0 ft <sup>2</sup>			HSPF: 7.00
b. SHGC:		b. N/A	
(or Clear or Tint DEFAULT) 7b. (Clear) 312.0 ft <sup>2</sup>		c. N/A	
8. Floor types		14. Hot water systems	
a. Slab-On-Grade Edge Insulation	R=0.0, 227.0(p) ft <sup>2</sup>	a. Electric Resistance	Cap: 50.0 gallons
b. N/A			EF: 0.92
c. N/A		b. N/A	
9. Wall types		c. Conservation credits	
a. Frame, Wood, Exterior	R=13.0, 1296.0 ft <sup>2</sup>	(HR-Heat recovery, Solar	
b. Frame, Wood, Adjacent	R=13.0, 266.0 ft <sup>2</sup>	DHP-Dedicated heat pump)	
c. N/A		15. HVAC credits	
d. N/A		(CF-Ceiling fan, CV-Cross ventilation,	
e. N/A		11F-Whole house fan,	
10. Ceiling types		PT-Programmable Thermostat,	
a. Under Attic	R=30.0, 2180.0 ft <sup>2</sup>	MZ-C-Multizone cooling,	
b. N/A		MZ-H-Multizone heating)	
c. N/A			
11. Ducts			
a. Sup: Unc. Ret: Unc. All: Interior	Sup. R=6.0, 283.0 ft		
b. N/A			

I certify that this home has complied with the Florida Energy Efficiency Code For Building Construction through the above energy saving features which will be installed (or exceeded) in this home before final inspection. Otherwise, a new EPL Display Card will be completed based on installed Code compliant features.

Builder Signature: Stanley Graded

Date: 1/8/07

Address of New Home: \_\_\_\_\_

City/FL Zip: \_\_\_\_\_



\*NOTE: The home's estimated energy performance score is only available through the FLA/RES computer program. This is not a Building Energy Rating. If your score is 80 or greater (or 86 for a US EPA/DOE EnergyStar<sup>®</sup> designation), your home may qualify for energy efficiency mortgage (EEM) incentives if you obtain a Florida Energy Gauge Rating. Contact the Energy Gauge Hotline at 321/638-1492 or see the Energy Gauge web site at [www.fsec.ucf.edu](http://www.fsec.ucf.edu) for information and a list of certified raters. For information about Florida's Energy Efficiency Code For Building Construction, contact the Department of Community Affairs at 850/487-1824.

<sup>1</sup> Predominant glass type. For actual glass type and areas, see Summer & Winter Glass output on pages 2&4  
EnergyGauge<sup>®</sup> (Version: FLRCSB v4.0)

This instrument was Prepared By:  
STANLEY CRAWFORD CONSTRUCTION, INC.  
853 S.W. Sisters Welcome Rd.  
Lake City, Florida 32025

PERMIT NO. 25417

TAX FOLIO NO.: \_\_\_\_\_

NOTICE OF COMMENCEMENT

STATE OF FLORIDA  
COUNTY OF COLUMBIA

The undersigned hereby gives notice that improvement will be made to certain real Property, and in accordance with Chapter 713, Florida Statutes, the following information is provided in this Notice of Commencement.

- See  
EXHIBIT A
- ~~EXHIBIT A~~ ~~EXHIBIT A~~
1. Description of property: See Attachment  
44255 Catherine Rd., Lake City, FL 32055
  2. General description of improvement: Construction of Dwelling
  3. Owner information:  
Name and address: Larry Wilmoth  
1200 Hillcrest Court, Apt. 31  
Hollywood, FL 33021  
Inst: 2007001196 Date: 01/17/2007 Time: 14:25  
J.2 DC, P. Dewitt Cason, Columbia County B: 1108 P: 199
  - b. Interest in property: Fee Simple
  - c. Name and address of fee simple title holder (if other Than owner): NONE
  4. Contractor: Stanley Crawford Construction, Inc.  
853 S.W. Sisters Welcome Rd. Lake City, FL 32025
  5. Surety N/A
    - a. Name and address:
    - b. Amount of bond:
  6. Lender: N/A
  7. Persons within the State of Florida designated by Owner upon whom notices Or other documents may be served as provided by Section 713.13 (1) (a) 7., Florida Statutes: NONE
  8. In addition to himself, Owner designates \_\_\_\_\_ to receive a copy of the Lienor's Notice as provided in section 713.13 (1) (b), Florida Statutes.
  9. Expiration date of notice of commencement (the expiration date is 1 year from The date of recording unless a different date is specified).

x Larry J. Wilmoth

The foregoing instrument was acknowledged before me this 18th day of December, 2006 by Larry Wilmoth who are personally known to me and who did not take an oath.

Ronda Lynn O'Brien  
Notary Public

My Commission Expires: June 20, 2008



Ronda Lynn O'Brien  
Commission #DD330790  
Expires: Jun 20, 2008  
Bonded Thru  
Atlantic Bonding Co., Inc.

JAN-19-2007 16:11 From:

To: 97552165

Page: 2/2

25417

**COLUMBIA COUNTY 9-1-1 ADDRESSING**

P. O. Box 1787, Lake City, FL 32056-1787

PHONE: (386) 758-1125 • FAX: (386) 758-1365 • Email: ron\_craft@columbiacountyfla.com

**Addressing Maintenance**

To maintain the Countywide Addressing Policy you must make application for a 9-1-1 Address at the time you apply for a building permit. The established standards for assigning and posting numbers to all principal buildings, dwellings, businesses and industries are contained in Columbia County Ordinance 2001-9. The addressing system is to enable Emergency Service Agencies to locate you in an emergency, and to assist the United States Postal Service and the public in the timely and efficient provision of services to residents and businesses of Columbia County.

DATE REQUESTED: 1/18/2007 DATE ISSUED: 1/19/2007

**ENHANCED 9-1-1 ADDRESS:**631 ~~SW~~ SW CATHERINE LN

LAKE CITY FL 32025

PROPERTY APPRAISER PARCEL NUMBER:

22-5S-17-00328-006

Remarks:

Address Issued By:



Columbia County 9-1-1 Addressing / GIS Department

**NOTICE: THIS ADDRESS WAS ISSUED BASED ON LOCATION INFORMATION RECEIVED FROM THE REQUESTER. SHOULD, AT A LATER DATE, THE LOCATION INFORMATION BE FOUND TO BE IN ERROR, THIS ADDRESS IS SUBJECT TO CHANGE.**

Approved Address

593

JAN 19 2007

911Addressing/GIS Dept





# RIGHT-J LOAD AND EQUIPMENT SUMMARY

## Entire House

Touchstone Heating and Air, Inc.

Job: Larry Wilmoth  
Sub

P.O. Box 327, Lake Butler, FL 32054 Phone: 386-498-3487 Fax: 386-498-3147

### Project Information

For: Stanley Crawford Construction  
1531 SW Commercial Glen, Lake City, FL 32025  
Phone: 386-752-5152 Fax: 386-755-2165

Notes:

### Design Information

Weather: Gainesville, FL, US

#### Winter Design Conditions

Outside db 33 °F  
Inside db 70 °F  
Design TD 37 °F

#### Summer Design Conditions

Outside db 90 °F  
Inside db 75 °F  
Design TD 15 °F  
Daily range M  
Relative humidity 55 %  
Moisture difference 40 gr/lb

#### Heating Summary

Building heat loss 12461 Btuh  
Ventilation air 0 cfm  
Ventilation air loss 0 Btuh  
Design heat load 12461 Btuh

#### Sensible Cooling Equipment Load Sizing

Structure 29488 Btuh  
Ventilation 1275 Btuh  
Design temperature swing 3.0 °F  
Use mfg. data n  
Rate/swing multiplier 0.95  
Total sens. equip. load 29225 Btuh

#### Infiltration

Method	Simplified
Construction quality	Average
Fireplaces	1
	Heating Cooling
Area (ft²)	2181 2181
Volume (ft³)	18539 18539
Air changes/hour	0.20 0.10
Equip. AVF (cfm)	62 31

#### Latent Cooling Equipment Load Sizing

Internal gains 4370 Btuh  
Ventilation 2101 Btuh  
Infiltration 840 Btuh  
Total latent equip. load 7312 Btuh  
Total equipment load 36536 Btuh  
Req. total capacity at 0.70% SHR 3.5 ton

#### Heating Equipment Summary

Make Trane  
Trade  
TWP036C  
Efficiency 9.1 HSPF  
Heating input 46000 Btuh @ 47°F  
Heating output 26 °F  
Heating temp rise 1800 cfm  
Actual heating fan 0.128 cfm/Btuh  
Heating air flow factor  
Space thermostat

#### Cooling Equipment Summary

Make Trane  
Trade  
TWP036C  
TWE036P13  
Efficiency 13.0 SEER  
Sensible cooling 33600 Btuh  
Latent cooling 14400 Btuh  
Total cooling 48000 Btuh  
Actual cooling fan 1800 cfm  
Cooling air flow factor 0.054 cfm/Btuh  
Load sensible heat ratio 81 %

*Boilerplate values have been manually overridden*

Printout certified by ACCA to meet all requirements of Manual J 7th Ed.

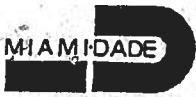

MIAMI-DADE COUNTY, FLORIDA  
METRO-DADE FLAGLER BUILDING

BUILDING CODE COMPLIANCE OFFICE  
METRO-DADE FLAGLER BUILDING  
140 WEST FLAGLER STREET, SUITE 1603  
MIAMI, FLORIDA 33130-1503  
(305) 375-2901 FAX (305) 375-2908

## PRODUCT CONTROL NOTICE OF ACCEPTANCE

Premdor Entry Systems  
911 E. Jefferson, P.O. Box 76  
Pittsburgh, KS 66762

CONTRACTOR LICENSING SECTION  
(305) 375-2527 FAX (305) 375-2558

CONTRACTOR ENFORCEMENT DIVISION  
(305) 375-2966 FAX (305) 375-2908

PRODUCT CONTROL DIVISION  
(305) 375-2902 FAX (305) 372-6339

Your application for Notice of Acceptance (NOA) of:

**Entergy 6-8 S/E Inswing Opaque Double w/sidelites Residential Insulated Steel Door**  
under Chapter 8 of the Code of Miami-Dade County governing the use of Alternate Materials and Types of Construction, and completely described herein, has been recommended for acceptance by the Miami-Dade County Building Code Compliance Office (BCCO) under the conditions specified herein.

This NOA shall not be valid after the expiration date stated below. BCCO reserves the right to secure this product or material at any time from a jobsite or manufacturer's plant for quality control testing. If this product or material fails to perform in the approved manner, BCCO may revoke, modify, or suspend the use of such product or material immediately. BCCO reserves the right to revoke this approval, if it is determined by BCCO that this product or material fails to meet the requirements of the South Florida Building Code.

The expense of such testing will be incurred by the manufacturer.

ACCEPTANCE NO.: 01-0314.23  
EXPIRES: 04/02/2006

Raul Rodriguez  
Chief Product Control Division

THIS IS THE COVERSHEET, SEE ADDITIONAL PAGES FOR SPECIFIC AND GENERAL  
CONDITIONS  
BUILDING CODE & PRODUCT REVIEW COMMITTEE

This application for Product Approval has been reviewed by the BCCO and approved by the Building Code and Product Review Committee to be used in Miami-Dade County, Florida under the conditions set forth above.

Francisco J. Quintana, R.A.  
Director  
Miami-Dade County  
Building Code Compliance Office

APPROVED: 06/05/2001

Premdor Entry Systems

ACCEPTANCE No. 01-0314.23

APPROVED : JUN 05 2001

EXPIRES : April 02, 2006

NOTICE OF ACCEPTANCE: SPECIFIC CONDITIONS

**1. SCOPE**

- 1.1 This renews the Notice of Acceptance No. 00-0321.25 which was issued on April 28, 2000. It approves a residential insulated door, as described in Section 2 of this Notice of Acceptance, designed to comply with the South Florida Building Code (SFBC), 1994 Edition for Miami-Dade County, for the locations where the pressure requirements, as determined by SFBC Chapter 23, do not exceed the Design Pressure Rating values indicated in the approved drawings.

**2. PRODUCT DESCRIPTION**

- 2.1 The Series Entergy 6-8 S/E Inswing Opaque Double Residential Insulated Steel Doors with Sidelites-Impact Resistant Door Slab Only and its components shall be constructed in strict compliance with the following documents: Drawing No 31-1029-EM-I, Sheets 1 through 6 of 6, titled "Premdor (Entergy Brand) Double Door with Sidelites in Wood Frames with Bumper Threshold (Inswing)," prepared by manufacturer, dated 7/29/97 with revision C dated 01/11/00, bearing the Miami-Dade County Product Control approval stamp with the Notice of Acceptance number and approval date by the Miami-Dade County Product Control Division. These documents shall hereinafter be referred to as the approved drawings.

**3. LIMITATIONS**

- 3.1 This approval applies to single unit applications of pair of doors and single door only, as shown in approved drawings. Single door units shall include all components described in the active leaf of this approval.
- 3.2 Unit shall be installed only at locations protected by a canopy or overhang such that the angle between the edge of canopy or overhang to sill is less than 45 degrees. Unless unit is installed in non-habitable areas where the unit and the area are designed to accept water infiltration.

**4. INSTALLATION**

- 4.1 The residential insulated steel door and its components shall be installed in strict compliance with the approved drawings.
- 4.2 Hurricane protection system (shutters):
- 4.2.1 Door: the installation of this unit will not require a hurricane protection system.
- 4.2.2 Sidelite: the installation of this unit will require a hurricane protection system.

**5. LABELING**

- 5.1 Each unit shall bear a permanent label with the manufacturer's name or logo, city, state and following statement: "Miami-Dade County Product Control Approved".

**6. BUILDING PERMIT REQUIREMENTS**

- 6.1 Application for building permit shall be accompanied by copies of the following:
- 6.1.1 This Notice of Acceptance
- 6.1.2 Duplicate copies of the approved drawings, as identified in Section 2 of this Notice of Acceptance, clearly marked to show the components selected for the proposed installation.
- 6.1.3 Any other documents required by the Building Official or the South Florida Building Code (SFBC) in order to properly evaluate the installation of this system.

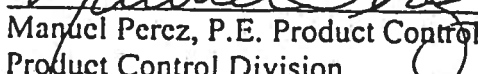
  
Manuel Perez, P.E. Product Control Examiner  
Product Control Division

NOTICE OF ACCEPTANCE: STANDARD CONDITIONS

1. Renewal of this Acceptance (approval) shall be considered after a renewal application has been filed and the original submitted documentation, including test supporting data, engineering documents, are no older than eight (8) years.
2. Any and all approved products shall be permanently labeled with the manufacturer's name, city, state, and the following statement: "Miami-Dade County Product Control Approved", or as specifically stated in the specific conditions of this Acceptance.
3. Renewals of Acceptance will not be considered if:
  - a. There has been a change in the South Florida Building Code affecting the evaluation of this product and the product is not in compliance with the code changes.
  - b. The product is no longer the same product (identical) as the one originally approved.
  - c. If the Acceptance holder has not complied with all the requirements of this acceptance, including the correct installation of the product.
  - d. The engineer who originally prepared, signed and sealed the required documentation initially submitted, is no longer practicing the engineering profession.
4. Any revision or change in the materials, use, and/or manufacture of the product or process shall automatically be cause for termination of this Acceptance, unless prior written approval has been requested (through the filing of a revision application with appropriate fee) and granted by this office.
5. Any of the following shall also be grounds for removal of this Acceptance:
  - a. Unsatisfactory performance of this product or process.
  - b. Misuse of this Acceptance as an endorsement of any product, for sales, advertising or any other purposes.
6. The Notice of Acceptance number preceded by the words Miami-Dade County, Florida, and followed by the expiration date may be displayed in advertising literature. If any portion of the Notice of Acceptance is displayed, then it shall be done in its entirety.
7. A copy of this Acceptance as well as approved drawings and other documents, where it applies, shall be provided to the user by the manufacturer or its distributors and shall be available for inspection at the job site at all time. The engineer needs not reseal the copies.
8. Failure to comply with any section of this Acceptance shall be cause for termination and removal of Acceptance.
9. This Notice of Acceptance consists of pages 1, 2 and this last page 3.

END OF THIS ACCEPTANCE

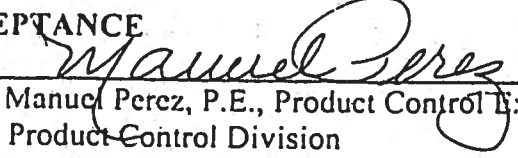
  
Manuel Perez, P.E., Product Control Examiner  
Product Control Division

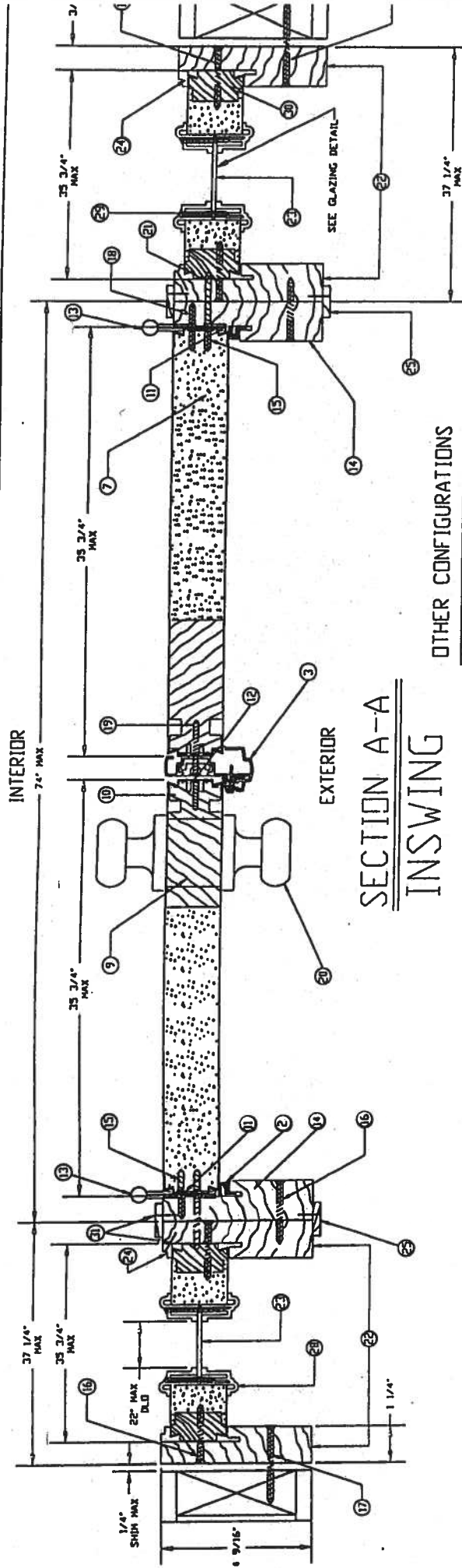

OTHER CONFIGURATIONS

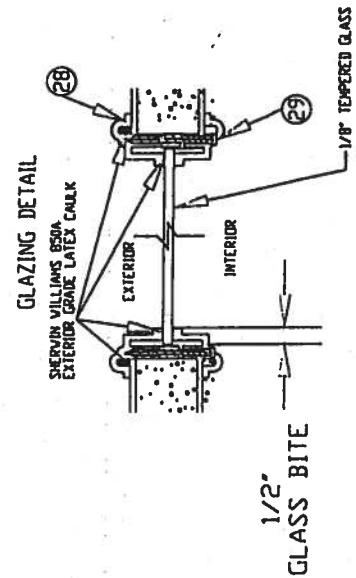
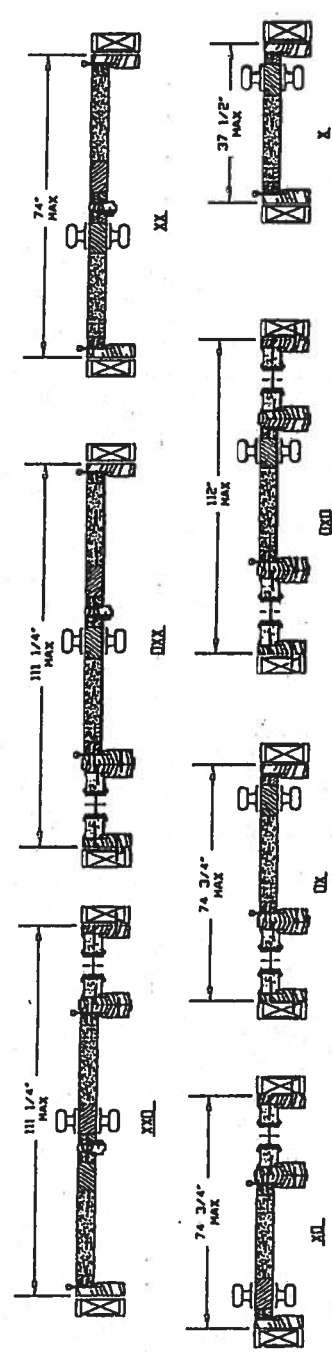

APPROVED AS COMPLYING WITH THE  
SOUTH FLORIDA BUILDING CODE  
DATE JUN 05 2000  
BY *[Signature]*  
PRODUCT CONTROL DIVISION  
BUILDING CODE COMPLIANCE OFFICE  
ACCEPTANCE NO. 01-0314-23

C - MAKE COMPANY SPECIFICATIONS		DATE	BY	REVISION
1	1/2\"	10/1/99	WLC	1
2	1/2\"	10/1/99	WLC	2
3	1/2\"	10/1/99	WLC	3
4	1/2\"	10/1/99	WLC	4
5	1/2\"	10/1/99	WLC	5
6	1/2\"	10/1/99	WLC	6
7	1/2\"	10/1/99	WLC	7
8	1/2\"	10/1/99	WLC	8
9	1/2\"	10/1/99	WLC	9
10	1/2\"	10/1/99	WLC	10
11	1/2\"	10/1/99	WLC	11
12	1/2\"	10/1/99	WLC	12
13	1/2\"	10/1/99	WLC	13
14	1/2\"	10/1/99	WLC	14
15	1/2\"	10/1/99	WLC	15
16	1/2\"	10/1/99	WLC	16
17	1/2\"	10/1/99	WLC	17
18	1/2\"	10/1/99	WLC	18
19	1/2\"	10/1/99	WLC	19
20	1/2\"	10/1/99	WLC	20
21	1/2\"	10/1/99	WLC	21
22	1/2\"	10/1/99	WLC	22
23	1/2\"	10/1/99	WLC	23
24	1/2\"	10/1/99	WLC	24
25	1/2\"	10/1/99	WLC	25
26	1/2\"	10/1/99	WLC	26
27	1/2\"	10/1/99	WLC	27
28	1/2\"	10/1/99	WLC	28
29	1/2\"	10/1/99	WLC	29

PREMIER ENTRY SYSTEMS  
WILSON, CA 94094

31-1029-EM-1  
SHEET 2 OF 6

# MATERIALS LIST

ITEM NO.	DESCRIPTION	PART NUMBER	COMMENTS
1	WOOD HEAD JAMB	EM-14	1 1/4" X 4 9/16" MTL TO BE PINE OR EQUIVALENT
2	COMPRESSION WEATHERSTRIP	EM-25	LOCKSCREEN BRAND LUXEAL 9550 BRONZE
3	ALUMINUM ASTRAGAL	EM-12	PREMIOR BRAND OR EQUIVALENT - 5/8" ALUMINUM ASTI
4	ALUMINUM-BUMPER THRESHOLD	EM-15	PREMIOR BRAND OR EQUIVALENT - 1 1/4" X 4 9/16"
5	TOP CHANNEL	EM-08	PREMIOR BRAND - 1 11/16" - 20 GA STEEL
6	STEEL SKIN	26 ga. 087 484 -000	SEE NOTE ON DRAWING
7	POLYURETHANE FOAM CORE	BASF FOAM -	DENSITY 2.0 TO 2.5 LBS./FT <sup>3</sup>
8	BOTTOM CHANNEL	EM-07	PREMIOR BRAND - 1 11/16" - 20 GA STEEL
9	WOOD LOCK BLOCK	EM-09	4" X 9 1/2" MTL TO BE PINE OR EQUIVALENT
10	STRIKE STILE	EM-06	PREMIOR BRAND - 1 11/16" - 20 GA STEEL
11	HINGE STILE	EM-05	PREMIOR BRAND - 1 11/16" - 20 GA STEEL
12	LOCK PREP FILLER PLATE	EM-10	PREMIOR BRAND - .050" THICK - MTL TO BE POLYETH
13	4"x4" HINGE	EM-16	HAGER BRAND HINGE OR EQUIVALENT - .097 THICK CS
14	WOOD HINGE JAMB	EM-13	1 1/4" X 4 9/16" MTL TO BE PINE OR EQUIVALENT
15	#10-24 x 1/2" F.H.V.S.		(4) SCREWS PER HINGE INTO DOOR
16	#10 X 2" F.H.V.S.		SEE NOTE ON DRAWING
17	DOOR FRAME		DOOR FRAME TO BE 2" X 4" IN EACH CORNER AND 1 1/2" X 4" IN THE CENTER
18	#10 X 3/4" F.H.V.S.		REFER TO ELEVATION VIEW FOR # OF SCREWS USED AND LOCATI
19	#8 X 2" F.H.V.S.		(2) SCREWS PER HINGE INTO JAMB
20	LOCKSET		(2) SCREWS AT EACH STRIKE PLATE
21	#10 X 1 3/4" F.H.V.S.		KVICKSET BRAND 200 LOCK OR HARLOC BRAND 100 LDI
22	WOOD SIDELITE JAMB	EM-18	(2) SCREWS PER HINGE INTO JAMB
23	22" X 64" SINGLE PANEL GLASS	EM-19	1 1/4" X 4 9/16" MTL TO BE PINE OR EQUIVALENT
24	SIDELITE TRIM (WOOD)	EM-20	TEMPERED GLASS IN POLYPROPYLENE FRAME - DC-1643 - G
25	WOOD CASING	EM-21	5/16" X 1/2" MTL TO BE PINE OR EQUIVALENT
26	WOOD SIDELITE HEAD JAMB	EM-22	1 1/4" X 4 9/16" MTL TO BE PINE OR EQUIVALENT
27	WOOD SIDELITE BASE	EM-23	1 1/4" X 4 9/16" MTL TO BE PINE OR EQUIVALENT
28	POLYPROPYLENE LITE FRAME	DC-1643, DCL-2	HP Polypropylene by DCL
29	#6 X 1 1/2" PAN HEAD SCREWS		18 PER FRAME BODY SPACING TO BE 7" IN FROM EACH CORNER AN
30	SIDELITE STILES	EM-26	15/16" X 1 11/16" MTL TO BE PINE OR EQUIVALENT
31	PIN NAIL		2 1/4" LONG NAIL, 4" IN FROM END, MAX 8" O.C. THEREAFTER, USED ON MILLIONS AN

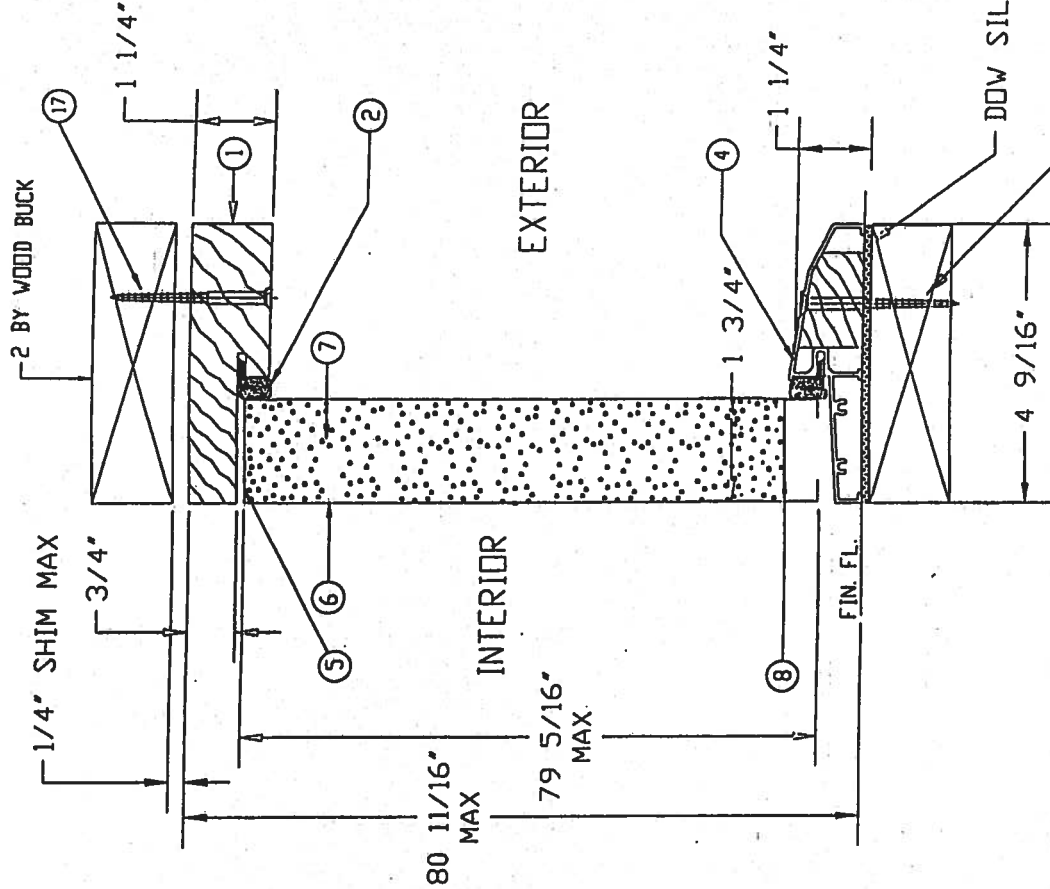

#995

DOW SILICONE

## SECTION B-B

APPROVED AS COMPLYING WITH THE  
SOUTH FLORIDA BUILDING CODE  
DATE JUN 05 2001  
BY [Signature]  
PREMIOR ENTRY SYSTEMS  
BUILDING CODE COMPLIANCE OFFICE  
ACCEPTANCE STAMP 01-0314-23

LIMITS: UNLESS NOTED, FRAC. : DEC. : ANG. :  
EXTENSIONS: UNLESS NOTED, STD. CONCL. UNITS  
ENGINEER: [Signature]  
DATE: MAY 7-29-97  
SCALE: 1/4\"/>

PREMIOR ENTRY SYSTEMS  
911 E. JEFFERSON  
PITTSBURGH, KS 66762

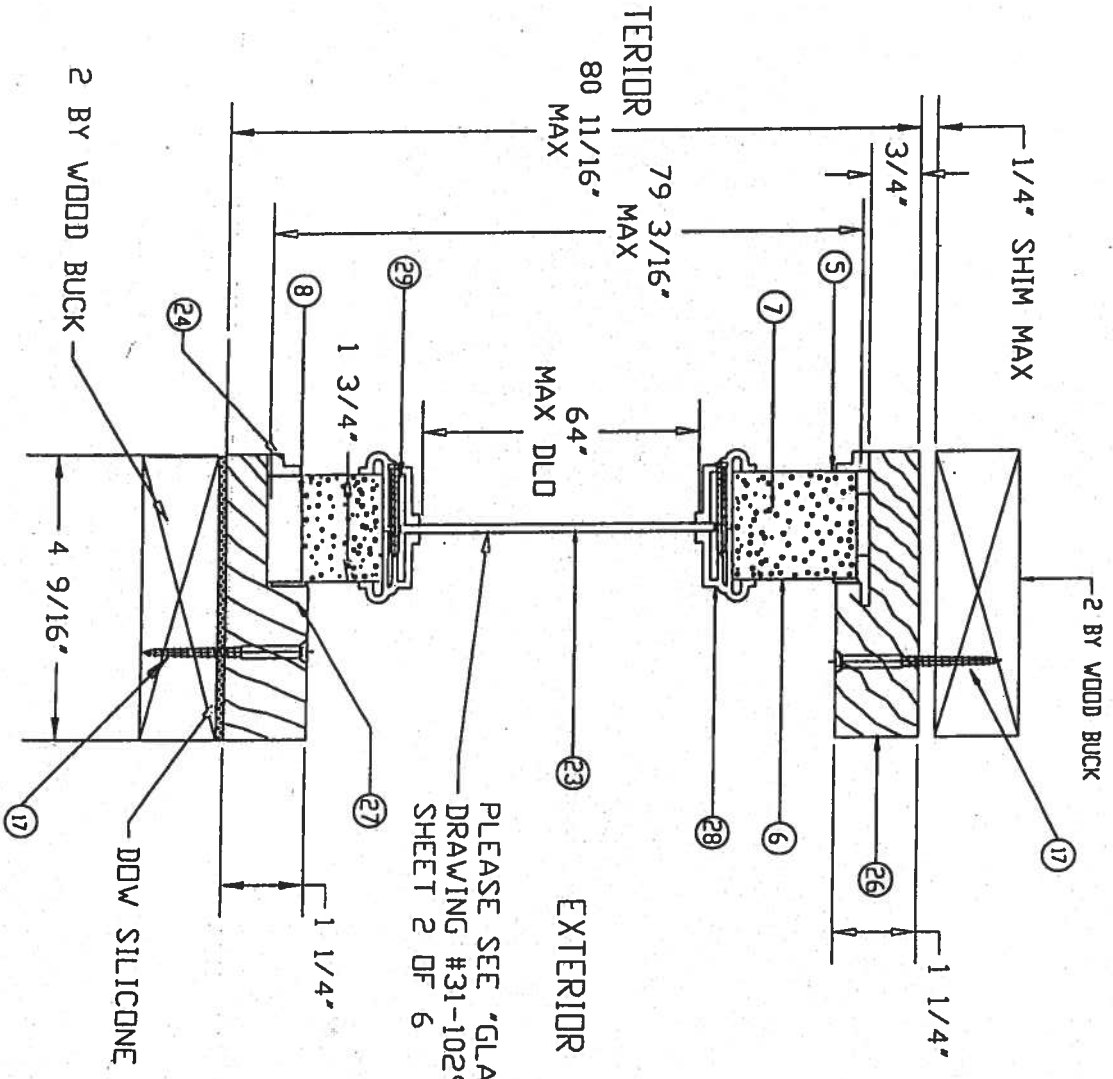

# SECTION C-C

PLEASE SEE 'GLAZING DETAIL'  
DRAWING #31-1029-EM-1  
SHEET 2 OF 6

APPROVED AS CORRELATING WITH THE  
SOUTH FLORIDA BUILDING CODE  
DATE **JUN 05 2005**  
BY *Michael J. [Signature]*  
PRODUCT CONTROL DIVISION  
BUILDING CODE COMPLIANCE OFFICE  
ACCEPTANCE NO. 01-0314.23

LIMITS: UNLESS NOTED, FPM		REV	DATE	BY
EXTENDING: UNLESS NOTED, SEE DRG. 10.5		ANG		
ENGINEER:				
DR. BY	R.S.	DATE	7-29-97	
PREMIER ENTRY SYSTEMS				
911 E. LITTON				
PITTSBURG, TX 76762				
D	DATE	7-29-97		
C	MATERIAL	VAS POLYSTYRENE	6-2-99	R.S.
B	ADDED PAGE	5 (CHIEF REVISIONS)	10-1-99	R.S.
A	AND	SCREWS TO LINE FRAME & MATERIAL LIST	12-18-97	R.S.
LIE	REVISIONS			BY
PART NAME: ENERGY RETA. EMF. SINGLE. (C-C)				
SCALE:				
31-1029-EM-1				
SHEET 4 OF 6				
REVISION LETTER D				



LIMITS: UNLESS NOTED, SPEC. : DATE : ANG. :					
EXTENSIONS: UNLESS NOTED, STR. CORP. IND. :					
ENGINEER'S:					
DR. BY	LD.	DATE	1-11-01	SCALE	
PREMIUM ENTRY SYSTEMS				31-1029-EM-	
VIN E. JOHNSON				SHEET 5 OF 6	
PHILADELPHIA, PA. 19102					



# OTHER DOOR PANEL STYLES

36" MAX

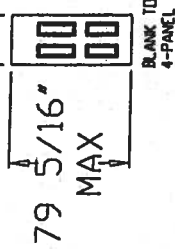

BLANK TOP  
4-PANEL



6-PANEL



4-PANEL



9-PANEL

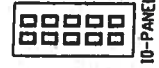

10-PANEL



18-PANEL



FLUSH



8-PANEL



CROSSBUCK

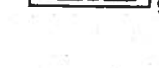

12-PANEL



4-PANEL  
EYEBROV

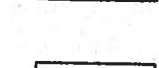

5-PANEL  
V/SCROLL

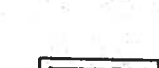

5-PANEL  
V/SCROLL



5-PANEL  
EYEBROV  
V/SCROLL



5-PANEL  
EYEBROV



5-PANEL  
EYEBROV

# OTHER SIDELITE STYLES

36" MAX

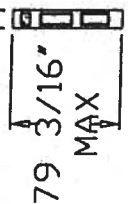

79 3/16" MAX

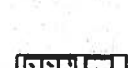
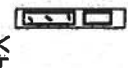

SL-10

SL-20

SL-30

SL-60

SL-50

SL-50B

SL-69A

SL-69B

SL-69C

SL-25

SL-55

SL-300B

SL-40

SL-90A

SL-90B

SL-90C

SL-300C

SL-70

SL-



PD-1



PD-2

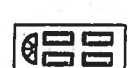

PD-3



PD-4

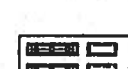

PD-5



PD-6



PD-7

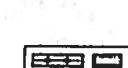

PD-8



PD-9

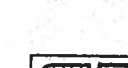

PD-10



PD-11

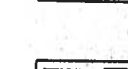

PD-12



PD-13

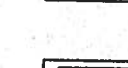

PD-14



PD-15

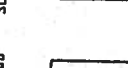

PD-16

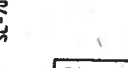

PD-17

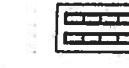

PD-18



PD-19



PD-20



PD-21



PD-22



PD-23



PD-24



PD-25



PD-26



PD-27



PD-28

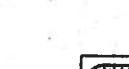

PD-29

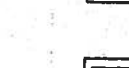

PD-30

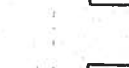

PD-31

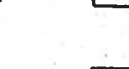

PD-32



PD-33

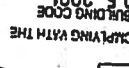

PD-34

APPROVED AS COMPLYING WITH THE  
SOUTH FLORIDA BUILDING CODE  
DATE: JUN 05 2000  
BY: [Signature]  
PRODUCT CONTROL DIVISION  
BUILDING CODE COMPLIANCE OFFICE

UNITS: UNLESS NOTED OTHERWISE: INCHES EXCEPTS: UNLESS NOTED OTHERWISE: INCHES		SCALE: 1/4" = 1'-0"	DATE: 12/15/01	BY: [Signature]
ENGINEER: [Signature]		DATE: 12/15/01	BY: [Signature]	DATE: 12/15/01
PREMIER ENTRY SYSTEMS 901 E. LUTHER PITTSBURGH, PA 15222		31-1029-EM-1 SHEET 6 OF 6		

# PREMDOR (ENTERGY BRAND) DOUBLE DOOR WITH SIDELITES IN WOOD FRAMES WITH BUMPER THRESHOLD (INSWING)

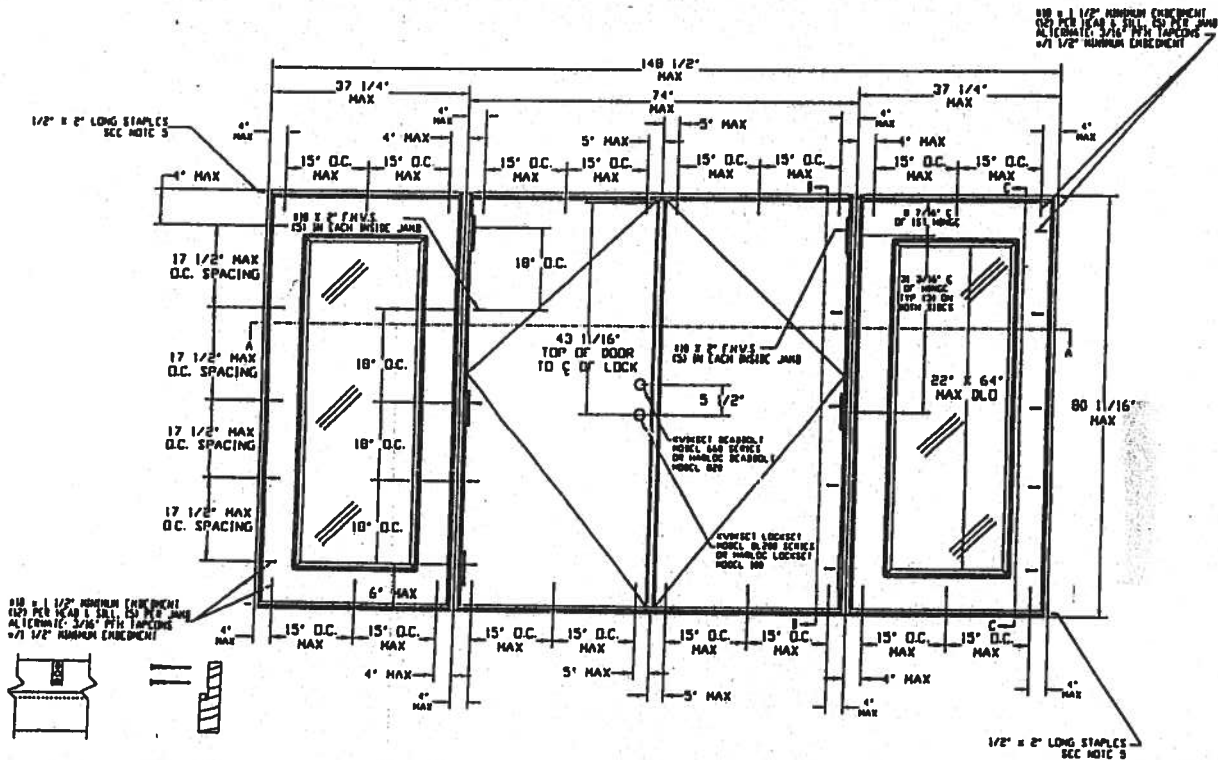

ATTACH ASTRAGAL THROW BOLT  
STRIKE PLATE TO THE HEADER  
AND THRESHOLD WITH #10 x 1 3/4\"/>

## NOTES:

1. WOOD BUCKS BY OTHERS. MUST BE ANCHORED PROPERLY TO TRANSFER LOADS TO THE STRUCTURE.
2. THE PRECEDING DRAWINGS ARE INTENDED TO QUALIFY THE FOLLOWING INSTALLATIONS.
  1. WOOD FRAME CONSTRUCTION WHERE DOOR SYSTEM IS ANCHORED TO A MINIMUM TWO BY WOOD JOINTING.
  2. MASONRY OR CONCRETE CONSTRUCTION WHERE DOOR SYSTEM IS ANCHORED TO A MINIMUM TWO BY STRUCTURAL WOOD BUCK.
  3. MASONRY OR CONCRETE CONSTRUCTION WHERE DOOR SYSTEM IS ANCHORED DIRECTLY TO CONCRETE OR MASONRY WITH OR WITHOUT A NON-STRUCTURAL INC BY WOOD BUCK.
  4. ALL ANCHORING SCREWS TO BE #10 WITH MINIMUM 1 1/2\"/>
3. UNIT MUST BE INSTALLED WITH "MIAMI-DADE COUNTY APPROVED" SHUTTERS.
4. THREE STAPLES PER SIDE JAMB INTO HEADER ON SIDELITES AND DOOR, THREE STAPLES PER JAMB INTO THRESHOLD ON SIDELITES AND DOOR.
5. LATEX SEALANT TO BE APPLIED AT SIDE BY SIDE JAMBS AND SIDELITES.
6. DOOR/SIDELITE HEADER, DOOR/SIDELITE JAMBS, AND SIDELITE BASE CORNERS ARE COPED AND BUTT JOINED.
7. DOORS SHALL BE PRE-PAINTED WITH A WATER-BASED EPOXY RUST INHIBITIVE PRIMER PAINT WITH A DRY FILM THICKNESS OF 0.8 TO 1.2 MIL.
8. FRAMES SHALL BE PRE-PAINTED WITH AN ACRYLIC LATEX WATER-BASED/ WATER-REDUCIBLE WHITE PRIMER WITH A DRY FILM THICKNESS OF 0.8 TO 1.2 MIL.

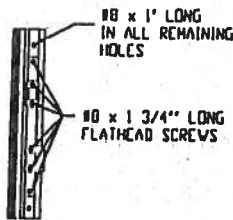

ASTRAGAL

DESIGN PRESSURE RATINGS		
	WHERE WATER INFILTRATION REQUIREMENT IS NEEDED *	WHERE WATER INFILTRATION REQUIREMENT IS NOT NEEDED
Positive	NOT APPROVED *	+55.0 psf
Negative	NOT APPROVED *	-55.0 psf

\* UNITS SHALL BE INSTALLED ONLY AT LOCATIONS PROTECTED BY A CANOPY OR OVERHANG SUCH THAT THE ANGLE BETWEEN THE EDGE OF CANOPY OR OVERHANG TO SILL IS LESS THAN 45 DEGREES. UNLESS UNIT IS INSTALLED IN NON-HABITABLE AREAS WHERE THE UNIT AND THE AREA ARE DESIGNED TO ACCEPT WATER INFILTRATION.

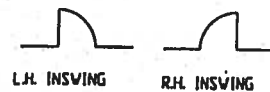

APPROVED AS COMPLYING WITH THE  
SOUTH FLORIDA BUILDING CODE  
DATE **JUN 05 2001**  
BY *[Signature]*  
PRODUCT CONTROL DIVISION  
BUILDING CODE COMPLIANCE OFFICE  
ACCEPTANCE NO. **01-0314.23**

UNITS UNLESS NOTED, TRAC	REF	ANG	C	BASE COUNTY MODIFICATIONS	DATE	BY
(EXTRUSIONS UNLESS NOTED, STD. COM. TEL'S)			A	ADDED PAGE 5 (DOOR OPTIONS)	10-1-98	RS
ENGINEER:			A	ADD OTHER DOOR CONFIGURATIONS	12/9/97	RS
PREMDOOR ENTRY SYSTEMS			11E	REVISED	DATE	BY
911 C. JEFFERSON			11F	PART NAME: ENERGY METAL EXTERIOR DOUBLE BODY W/SHUTTERS		
PITTSBURGH, PA 15222			11G	DATE: 12/06/97		
				31-1029-EM-I		
				SHEET 1 OF 6		

# CERTIFIED TESTING LABORATORIES

Architectural Division • 7252 Narcoossee Rd. • Orlando, FL 32822  
(407) 384-7744 • Fax (407) 384-7751  
Web Site: [www.ctllarch.com](http://www.ctllarch.com)  
E-mail: [ctllarch.com](mailto:ctllarch.com)

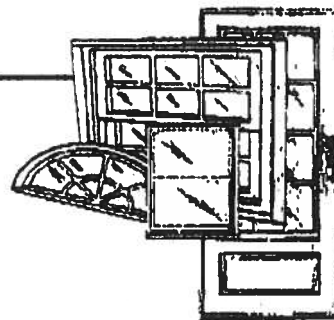

Report Number: CTLA-991W-1-AWT  
Report Date: February 18, 2003

## STRUCTURAL PERFORMANCE TEST REPORT

**Client:** ACTION WINDOOR TECHNOLOGY INC  
1312 W. CROSBY ROAD  
CARROLLTON, TX 75006

**Product Type and Series:** AWT Series 3950 Vinyl Fin Frame Single Hung Window with Reinforced Sash Top Rail, Stiles & Meeting Rail H-R40 (36"x 72")

**Test Specifications:** AAMA/NWWDA 101/1.S.2-97 "Voluntary Specifications for Aluminum, Vinyl (PVC) and Wood Windows and Glass Doors"

**Frame:** Vinyl Fin frame measured 35.50" wide x 71.50" high overall. Mitered corner weld construction. Fixed meeting rail secured to each frame jamb with one (1) #8 x 2" PH., PH. screw.

**Ventilator:** Operable sash measured 33.375" wide x 35.25" high overall. Mitered corner weld construction. Clear lite measured 31.5625" high x 33.5625" high. Fixed lite measured 32.50" wide x 33.4375" high.

**Weather Stripping:** One (1) strip of woolpile .220" high with integral plastic fin frame sill. One (1) strip of woolpile .250" high with integral plastic fin sash top rail exterior. One (1) strip of woolpile .250" high each sash stile exterior leg. One (1) strip of woolpile .250" high with integral plastic fin each sash stile interior leg. One (1) strip of foam filled bulb weatherstrip sash bottom rail.

**Hardware & Location:** Two (2) metallic sweep locks located on sash top rail approx 8" from each end of rail. Two (2) metallic keepers located on fixed meeting rail. One (1) tilt latch at each end of sash top rail. One (1) block and tackle at each frame jamb. One (1) pivot bar at each end of sash bottom rail.

**Glazing:** 5/8" insulated annealed glass consisting of .125" glass .375" air space with swiggle .125" glass. Sash exterior glazed. Fixed lite interior glazed adhesive foam strip backbedding and vinyl snap in glazing bead.

**Sealant:** A silicone type sealant was used on sill and to seal specimen to test buck.

**Weep System:** Weep notch measuring 2.25" x leg height located each end of sill weeping to the exterior.

**Muntins:** N/A

**Reinforcement:** Fixed meeting rail has one (1) piece of extruded aluminum reinforcement measuring .662" wide x .755" high x .099" thick x full length. Top rail, and sash stiles has one (1) piece of extruded aluminum reinforcement measuring .590" wide x .995" high x .115" thick x full length.

Additional Description: N/A

Screen: Roll formed aluminum frame, fiberglass mesh with vinyl spline. Two (2) metallic retainer clips and two (2) metallic plungers. Corners secured with plastic corner keys

Installation: Twenty-six (26) 1.75" roofing nails were used to secure the specimen to the wood test buck. Five (5) were located in head and sill measuring 4", 13", 21", 29", and 33" from left jamb. Eight (8) were located in each jamb measuring 4.50", 14.25", 24", 32.75", 42", 57.25", 60.50" and 70" from sill.

Surface Finish: White Vinyl

Comment: Nominal 2 mil polyethylene film was used to seal against air leakage during structural loads. The film was used in a manner that did not influence the test results.

### Performance Test Results

Paragraph No	Title of Test	Method	Measured	Allowed
2.1.2	Air Infiltration @1.57 psf	ASTM E283-91	.18 cfm/ft <sup>2</sup>	.34 cfm/ft <sup>2</sup>
The tested specimen meets or exceeds the performance levels specified in AAMA/NWDA 1014.5-2-97. Results recorded in two (2) decimals at the clients request. Unit tested with shims installed under cam locks.				
2.1.3	Water Resistance @ 5.0 gph/ft <sup>2</sup>	ASTM E547-93 Four (4) five (5) minute cycles	No Entry	No Entry
	WTP= 6.75 psf	ASTM E331-93 Fifteen (15) minute duration	No Entry	No Entry
Unit tested with insect screen.				
2.1.3	Water Resistance @ 5.0 gph/ft <sup>2</sup>	ASTM E547-93 Four (4) five (5) minute cycles	No Entry	No Entry
	WTP= 6 psf	ASTM E331-93 Fifteen (15) minute duration	No Entry	No Entry
Unit tested without insect screen.				
2.1.4.2	Uniform Load Structural Permanent Deformation @ 60 psf positive @ 60 psf negative	ASTM E330-90 Ten (10) second load	.015" .005"	.134" .134"
2.1.8	Forced Entry Resistance	AAMA 1302.5-76		
	Test A		0"	1/8"
	Test B		0"	1/8"
	Test C		0"	1/8"
	Test D, E and F		0"	1/8"
	Test G		0"	1/8"

Performance Test Results (continued)

Paragraph No	Title of Test	Method	Measured	Allowed
2.2.2.5.1	Operating Force Sash	AAMA/NWWDA 101/1.S.2-97	18 lbs.	30 lbs.
2.2.2.5.2	Deglazing	ASTM E987-88		
	Top Rail 70 lbs.		.039" = 7.8% < 100%	
	Bottom Rail 70 lbs.		.038" = 7.6% < 100%	
	Left Side 50 lbs.		.050" = 10% < 100%	
	Right Side 50 lbs.		.035" = 7.0% < 100%	
2.1.7	Welded Corner Test	AAMA/NWWDA 101/ IS2-97	Passed	

Test Date November 21, 2002

Test Completion Date: November 21, 2002

**Remarks:** Detailed drawings were available for laboratory records and comparison to the test specimen at the time of this report. A copy of this report along with representative sections of the test specimen will be retained by CTL for a period of four (4) years. The results obtained apply only to the specimen tested.

This test report does not constitute certification of this product, but only that the above test results were obtained using the designated test methods and they indicate compliance with the performance requirements (paragraphs as listed) of the above referenced specifications.

Certified Testing Laboratories assumes that all information provided by the client is accurate and that the physical and chemical properties of the components are as stated by the manufacturer.

Certified Testing Laboratories, Inc.

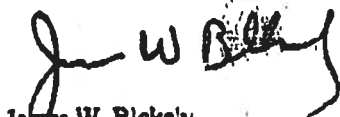

James W. Blakely  
Vice President  
Architectural Division

cc: Action Window Technology Inc. (3)  
File (1)

# CERTIFIED TESTING LABORATORIES

Architectural Division • 7252 Narcoossee Rd. • Orlando, FL 32822  
(407) 384-7744 • Fax (407) 384-7751  
Web Site: [www.ctlarch.com](http://www.ctlarch.com)  
E-mail: [ctlarch.com](mailto:ctlarch.com)

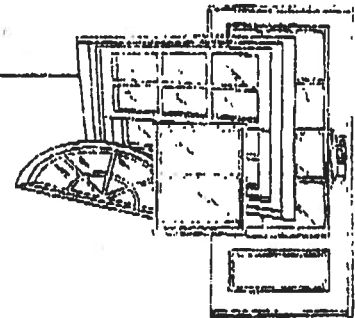

Report Number: CTLA-1038W-AWT  
Report Date: February 19, 2003

## STRUCTURAL PERFORMANCE TEST REPORT

Client: ACTION WINDOOR TECHNOLOGY INC.  
1312 W. CROSBY ROAD  
CARROELTON, TX 75006

Product Type and Series: AWT Series 3950 Vinyl Fin Frame Single Hung Window with Transom and Reinforced Meeting Rail & Top Rail (36" x 72") Design Pressure 45

Test Specifications: ASTM E 283-91 "Test Method for Determining the Rate of Air Leakage Through Exterior Windows, Curtain Walls and Doors Under Specified Pressure Differences Across the Specimen."  
ASTM E 547-93 "Test Method for Water Penetration of Exterior Windows, Curtain Walls and Doors by Uniform Static Air Pressure Difference"  
ASTM E 331-93 "Test Method for Water Penetration of Exterior Windows, Curtain Walls and Doors by Cyclic Static Air Pressure Differential."  
ASTM E 330-90 "Test Method for Structural Performance of Exterior Windows, Curtain Walls and Doors by Uniform Static Air Pressure Difference."

Frame: Vinyl fin frame measured 35.50" wide x 71.50" high overall. Mitered corner weld construction. Fixed meeting rail secured to each frame jamb with one (1) #8 x 2" PH. screw. Transom bottom rail secured to each frame jamb with four (4) #8 x 2" PH. screws

Ventilator: Operable sash measured 33.375" wide x 29.25" high overall. Mitered corner weld construction. Clear lite measured 31.5625" high x 27.5625" high. Fixed lite measured 32.50" wide x 27.4375" high. Transom lite measured 32.50" wide x 8.50" high.

Weather Stripping: One (1) strip of woolpile .220" high with integral plastic fin frame sill. One (1) strip of woolpile .250" high with integral plastic fin sash top rail exterior. One (1) strip of woolpile .250" high each sash stile exterior leg. One (1) strip of woolpile .250" high with integral plastic fin each sash stile interior leg. One (1) strip of foam filled bulb weatherstrip sash bottom rail.

Hardware & Location: Two (2) metallic sweep locks located on sash top rail approx 8" from each end of rail. One (1) tilt latch at each end of sash top rail. One (1) block and tackle at each frame jamb. One (1) pivot bar at each end of sash bottom rail.

Glazing: 5/8" insulated annealed glass consisting of .125" glass .375" air space with swiggle .125" glass. Sash exterior glazed. Fixed and transom lites interior glazed adhesive foam strip backbedding and vinyl snap in glazing bead.

- Sealant:** A silicone type sealant was used at sill corners and to seal specimen to test buck.
- Weep System:** Weep notch measuring 2.25" x leg height located each end of sill weeping to the exterior.
- Muntins:** N/A
- Reinforcement:** Fixed meeting rail has one (1) piece of extruded aluminum reinforcement measuring .662" wide x .755" high x .099" thick x full length. Top rail has one (1) piece of extruded aluminum reinforcement measuring .590" wide x .995" high x .115" thick x full length.
- Additional Description:** N/A
- Screen:** Roll formed aluminum frame, fiberglass mesh with vinyl spline. Two (2) metallic retainer clips and two (2) metallic plungers. Corners secured with plastic corner keys
- Installation:** Twenty-six (26) 1.75" roofing nails were used to secure the specimen to the wood test buck. Five (5) were located in head and sill measuring 4", 13", 21", 29", and 33" from left jamb. Eight (8) were located in each jamb measuring 4", 14.25", 24", 32.75", 42", 51", 60" and 69" from sill.
- Surface Finish:** White Vinyl
- Comment:** Nominal 2 mil polyethylene film was used to seal against air leakage during structural loads. The film was used in a manner that did not influence the test results.

#### Performance Test Results

<u>Paragraph No</u>	<u>Title of Test</u>	<u>Method</u>	<u>Measured</u>	<u>Allowed</u>
2.1.2	Air Infiltration @ 1.57 psf	ASTM E283-91	.28 cfm/ft <sup>2</sup>	.34 cfm/ft <sup>2</sup>
The tested specimen meets or exceeds the performance levels specified in AAMA/NWWDA 101/1.8.2-97. Results recorded in two (2) decimals at the clients request.				
2.1.3	Water Resistance @ 5.0 gph/ft <sup>2</sup>	ASTM E547-93 Four (4) five (5) minute cycles	No Entry	No Entry
	WTP= 6.75 psf	ASTM E331-93 Fifteen (15) minute duration	No Entry	No Entry
Unit tested with and without insect screen.				
2.1.4.2	Uniform Load Structural Permanent Deformation	ASTM E330-90 Tcn (10) second load		
DP= +45	@ 67.5 psf positive		.019"	.142"
DP= - 45	@ 67.5 psf negative		.009"	.142"

**Test Date** January 27, 2003

**Test Completion Date:** January 27, 2003

**Remarks:** Detailed drawings were available for laboratory records and comparison to the test specimen at the time of this report. A copy of this report along with representative sections of the test specimen will be retained by CTL for a period of four (4) years. The results obtained apply only to the specimen tested.

This test report does not constitute certification of this product, but only that the above test results were obtained using the designated test methods and they indicate compliance with the performance requirements (paragraphs as listed) of the above referenced specifications.

Certified Testing Laboratories assumes that all information provided by the client is accurate and that the physical and chemical properties of the components are as stated by the manufacturer.

Certified Testing Laboratories, Inc.

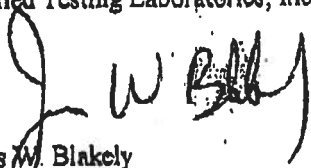

James W. Blakely  
Vice President  
Architectural Division

cc: Action Window Technology Inc. (3)  
File (1)





March 6, 2002

## **Subject: Elk Product Approval Information**

All Prestique® and Capstone® products manufactured in Tuscaloosa, AL are certified under the Miami – Dade County Building Code Office (BCCO). These products also meet the requirements for the Florida Building Code since they are MD approved. The following test protocols must be passed by each of the products in order for MD product certification:

ASTM D3462

PA 100 (110 mph uplift and wind driven rain resistance)

PA 107 (Modified ASTM D3161 - 110 mph wind uplift resistance)

The nailing patterns that were used during the PA 100 and PA 107 wind test protocols for the Prestique and Capstone products are listed below. Also listed below are the Miami – Dade Notice of Acceptance Numbers (NOA).

Raised Profile, Prestique High Definition, Prestique 25, or Prestique 30 –

PA 100 = 4 nails

PA 107 = 5 nails

MD NOA# = 01-1226.04

Prestique I 35 or Prestique I\* –

PA 100 = 4 nails

PA 107 = 5 nails

MD NOA# = 01-1226.05

Prestique Plus or Prestique Gallery Collection\* –

PA 100 = 4 nails

PA 107 = 4 nails

MD NOA# = 01-1226.03

Capstone\*

PA 100 = 4 Nails

PA 107 = 4 Nails

MD NOA# = 01-0523.01

\* As per the Elk Limited Warranty, six nails are required for the Elk high wind warranty.

If there are any questions please contact:

Mike Reed – Technical Manager  
(205) 342-0287

or

Daniel DeJarnette – QA Engineer  
(205) 342-0298

**ELK**

ROOFING PRODUCTS SPECIFICATIONS - TUSCALOOSA, AL

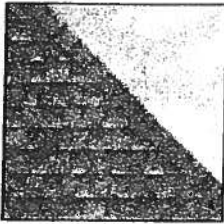
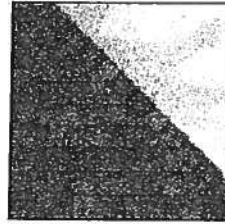
**PRESTIQUE®  
HIGH DEFINITION®****RAISED PROFILE™****Prestique Plus High Definition  
and Prestique Gallery Collection\***

Product size.....13½"x 39 ½"  
Exposure..... 5½"  
Pieces/Bundle..... 16  
Bundles/Square..... 4/98.5 sq.ft.  
Squares/Pallet..... 11

50-year limited warranty period:  
non-prorated coverage for  
shingles and application labor for  
the initial 5 years, plus an option  
for transferability\*; prorated  
coverage for application labor and  
shingles for balance of limited  
warranty period; 5-year limited  
wind warranty\*.

**Raised Profile**

Product size.....13½"x 38"  
Exposure..... 5½"  
Pieces/Bundle..... 22  
Bundles/Square..... 3/100 sq.ft.  
Squares/Pallet..... 16

30-year limited warranty period:  
non-prorated coverage for  
shingles and application labor for  
the initial 5 years, plus an option  
for transferability\*; prorated  
coverage for application labor and  
shingles for balance of limited  
warranty period; 5-year limited  
wind warranty\*.

**Prestique I High Definition**

Product size..... 13½"x 39½"  
Exposure..... 5½"  
Pieces/Bundle..... 16  
Bundles/Square..... 4/98.5 sq.ft.  
Squares/Pallet..... 14

40-year limited warranty period:  
non-prorated coverage for  
shingles and application labor for  
the initial 5 years, plus an option  
for transferability\*; prorated  
coverage for application labor and  
shingles for balance of limited  
warranty period; 5-year limited  
wind warranty\*.

**HIP AND RIDGE SHINGLES****Seal-A-Ridge® w/FLX®**

Size: 12"x 12"  
Exposure: 6½"  
Pieces/Bundle: 45  
Coverage: 4 Bundles = 100 linear feet

**Prestique High Definition**

Product size..... 13½"x 38"  
Exposure..... 5½"  
Pieces/Bundle..... 22  
Bundles/Square..... 3/100 sq.ft.  
Squares/Pallet..... 16

30-year limited warranty period:  
non-prorated coverage for  
shingles and application labor for  
the initial 5 years, plus an option  
for transferability\*; prorated  
coverage for application labor and  
shingles for balance of limited  
warranty period; 5-year limited  
wind warranty\*.

**Elk Starter Strip**

52 Bundles/Pallet  
18 Pallets/Truck  
936 Bundles/Truck  
19 Pieces/Bundle  
1 Bundle = 120.33 linear feet

Available Colors: Antique Slate, Weatheredwood, Shakedown, Sablewood, Hickory, Barkwood\*\*, Forest Green, Wedgewood\*\*, Birchwood\*\*, Sandalwood.  
Gallery Collection: Balsam Forest\*, Weathered Sage\*, Sienna Sunset\*.

All Prestique, Raised Profile and Seal-A-Ridge roofing products contain Elk WindGuard® sealant. WindGuard activates with the sun's heat, bonding shingles into a wind and weather resistant cover that resists blow-offs and leaks.

Check for availability with built-in StainGuard® treatment to inhibit the discoloration of roofing granules caused by the growth of certain types of algae. Not available in Sablewood.

All Prestique and Raised Profile shingles meet UL® Wind Resistant (UL 997) and Class "A" Fire Ratings (UL 790); and ASTM Specifications D 3018, Type-I; D 3161, Type-I; E 108 and the requirements of ASTM D 3462.

All Prestique and Raised Profile shingles meet the latest Metro Dade building code requirements.

\*See actual limited warranty for conditions and limitations.  
\*\*Check for product availability.

**SPECIFICATIONS**

**Scope:** Work includes furnishing all labor, materials and equipment necessary to complete installation of (name) shingles specified herein. Color shall be (name of color). Hip and ridge type to be Elk Seal-A-Ridge with formula FLX.

All exposed metal surfaces (flashing, vents, etc.) to be painted with matching Elk roof accessory paint.

**PREPARATION OF ROOF DECK:** Roof deck to be dry, well-seasoned 1" x 6" (25.4mm x 152.4mm) boards; exterior-grade plywood (exposure 1 rated sheathing) at least 3/8" (9.525mm) thick conforming to the specifications of the American Plywood Association; 7/16" (11.074mm) oriented strandboard; or chipboard. Most fire retardant plywood decks are NOT approved substrates for Elk shingles. Consult Elk Field Service for application specifications over other decks and other slopes.

**MATERIALS:** Underlayment for standard roof slopes, 4" per foot (101.6/304.8mm) or greater: apply non-perforated No. 15 or 30 asphalt-saturated felt underlayment. For low slopes (4" per foot (101.6/304.8mm) to a minimum of 2" per foot (50.8/304.8mm)), use two piles of underlayment overlapped a minimum of 19". Fasteners shall be of sufficient length and holding power for securing material as required by the application instructions printed on shingle wrapper.

For areas where algae is a problem, shingles shall be (name) with StainGuard treatment, as manufactured by the Elk Tuscaloosa plant. Hip and ridge type to be Seal-A-Ridge with formula FLX with StainGuard treatment.

Complete application instructions are published by Elk and printed on the back of every shingle bundle. All

warranties are contingent upon the correct installation as shown on the instructions. These instructions are the minimum required to meet Elk application requirements. In some areas, building codes may require additional application techniques or methods beyond our instructions. In these cases, the local code must be followed. Under no circumstances will Elk accept application requirements less than those contained in its application instructions.

For specifications in CSI format, call 800.354.SPEC (7732) or e-mail specinfo@elkcorp.com.

**SOUTHEAST &  
ATLANTIC OFFICE:**  
800.945.5551

**CORPORATE HEADQUARTERS:**  
800.354.7732

**PLANT LOCATION:**  
800.945.5545

**ELK**  
www.elkcorp.com

SSOOT 01/02

## DIRECTIONS FOR APPLICATION

Please read carefully. Failure to follow these instructions may void the product warranty. See specific application instructions for Prestique® Plus and Prestique Gallery Collection™ 110 MPH and Prestique 190 MPH limited wind warranty requirements.

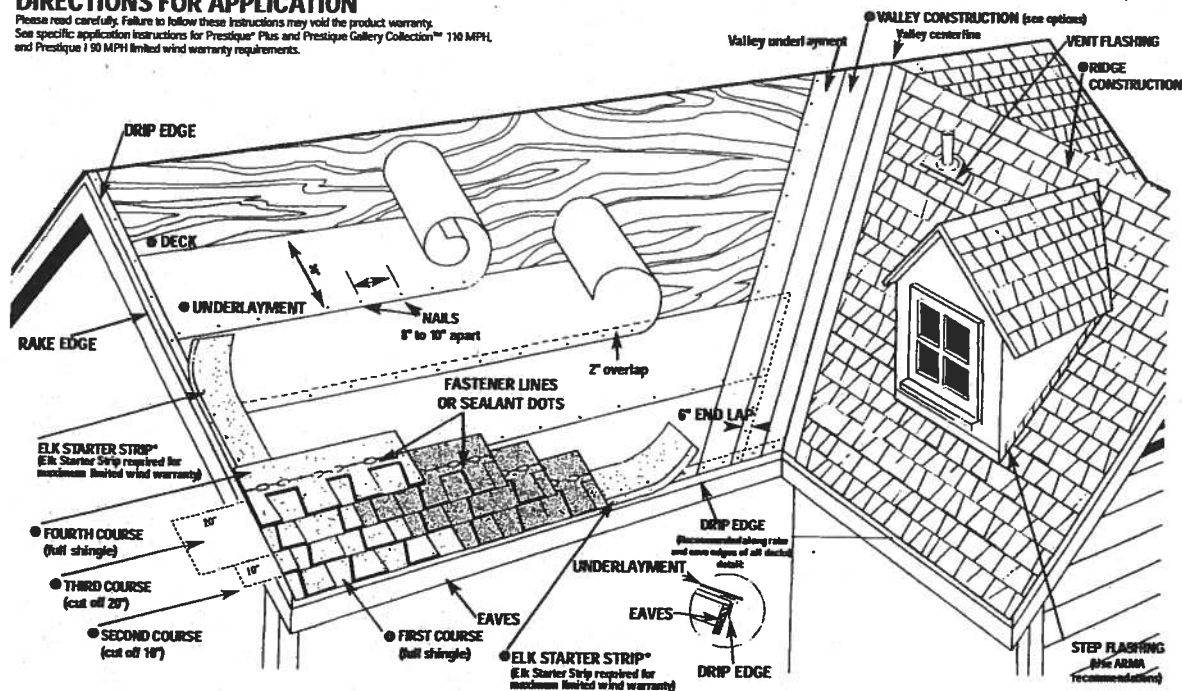

● **VALLEY CONSTRUCTION OPTION** (California Open and California Closed are also acceptable) NOTE: For complete ARMA valley installation details, see ARMA Residential Asphalt Roofing Manual.

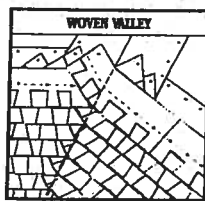

VALLEY CENTER LINE

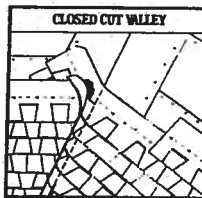

VALLEY CENTER LINE

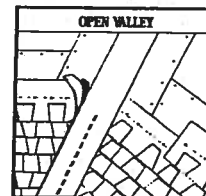

VALLEY CENTER LINE

## DIRECTIONS FOR APPLICATION

These application instructions are the minimum required to meet ELK's application requirements. Your failure to follow these instructions may void the product warranty. In some areas, the building codes may require additional application techniques or methods beyond our instructions. In these cases, the local code must be followed. Under no circumstances will ELK accept application requirements that are less than those printed here. Shingles should not be jammed tightly together. All attics should be properly ventilated. Note: It is not necessary to remove tape on back of shingle.

● **DECK PREPARATION**

Roof decks should be dry, well-seasoned 1" x 6" boards or exterior grade plywood minimum 3/8" thick and conform to the specifications of the American Plywood Association or 7/16" oriented strandboard, or 7/16" chipboard.

● **UNDERLAYMENT**

Apply underlayment (Non-Perforated No. 15 or 30 asphalt saturated felt). Cover drip edge at eaves only.

For low slope (2/12 up to 4/12), completely cover the deck with two plies of underlayment overlapping a minimum of 18". Begin by fastening a 18" wide strip of underlayment placed along the eaves. Place a full 36" wide sheet over the starter, horizontally placed along the eaves and completely overlapping the starter strip.

● **EAVE FLASHING FOR ICE DAMS (ASK A ROOFING CONTRACTOR, REFER TO ARMA MANUAL OR CHECK LOCAL CODES)**

For standard slope (4/12 to less than 21/12), use coated roll roofing of no less than 50 pounds over the felt underlayment extending from the eave edge to a point at least 24" beyond the inside wall of the living space below or one layer of a self-adhered eave and flashing membrane.

For low slope (2/12 up to 4/12), use a continuous layer of asphalt plastic cement between the two plies of underlayment from the eave edge up roof to a point at least 24" beyond the inside wall of the living space below or one layer of a self-adhered eave and flashing membrane.

Consult the Elk Field Service Department for application specifications over other decks and other slopes.

● **STARTER SHINGLE COURSE**

USE AN ELK STARTER STRIP OR A STRIP SHINGLE INVERTED WITH THE HEADLAP APPLIED AT THE EAVE EDGE. With at least 4" trimmed from the end of the first shingle, start at the rake edge overhanging the eave 1/2" to 3/4". Fasten 2" from the lower edge and 1" from each side. Shingles may be applied with a course alignment of 45° on the roof.

● **FIRST COURSE**

Start at rake and continue course with full shingles laid flush with the starter course.

● **SECOND COURSE**

Start at the rake with the shingle having 10" trimmed off and continue across roof with full shingles.

● **THIRD COURSE**

Start at the rake with the shingle having 20" trimmed off and continue across roof with full shingles.

● **FOURTH COURSE**

Start at the rake and continue with full shingles across roof.

● **FIFTH AND SUCCEEDING COURSES**

Repeat application as shown for second, third, and fourth courses. Do not rack shingles straight up the roof.

● **VALLEY CONSTRUCTION**

Open, woven and closed cut valleys are acceptable when applied by Asphalt Roofing Manufacturers Association (ARMA) recommended procedures. For metal valleys, use 36" wide vertical underlayment prior to applying 18" metal flashing (secure edge with nails). No nails are to be within 6" of valley center.

● **RIDGE CONSTRUCTION**

For ridge construction use Class "A" Seal-A-Ridge® with formula FLX™ (See ridge package for installation instructions.)

● **FASTENERS**

While nailing is the preferred method for Elk shingles, Elk will accept fastening methods according to the following instructions.

Always nail or staple through the fastener line or on products without fastener lines, nail or staple between and in line with sealant dots.

**NAILS:** Corrosive resistant, 3/8" head, minimum 12-gauge roofing nails. Elk recommends 1-1/4" for new roofs and 1-1/2" for re-roofs. In cases where you are applying shingles to a roof that has an exposed overhang, for new roofs only, 3/4" ring shank nails are allowed to be used from the eave's edge to a point up the roof that is past the outside wall line. 1" ring shank nails allowed for re-roof.

**STAPLES:** Corrosive resistant, 16-gauge minimum, crown width minimum of 15/16". Note: An improperly adjusted staple gun can result in raised staples that can cause a fish-mouthed appearance and can prevent sealing.

Fasteners should be long enough to obtain 3/4" deck penetration or penetration through deck, whichever is less.

● **MANSARD APPLICATIONS**

Correct fastening is critical to the performance of the roof. For slopes exceeding 60° (or 21/12) use six fasteners per shingle. Locate fasteners in the fastener area 1" from each side edge with the remaining four fasteners equally spaced along the length of the double thickness (laminated) area. Only fastening methods according to the above instructions are acceptable.

● **LIMITED WIND WARRANTY**

For a Limited Wind Warranty, all Prestique and Raised Profile™ shingles must be applied with 4 properly placed fasteners, or in the case of mansard applications, 6 properly placed fasteners per shingle.

For a Limited Wind Warranty up to 110 MPH for Prestique Gallery Collection or Prestique Plus or 80 MPH for Prestique I, shingles must be applied with 6 properly placed NAILS per shingle. SHINGLES APPLIED WITH STAPLES WILL NOT QUALIFY FOR THIS ENHANCED LIMITED WIND WARRANTY. Also, Elk Starter Strip shingles must be applied at the eaves and rake edges to qualify Prestique Plus, Prestique Gallery Collection and Prestique I shingles for this enhanced Limited Wind Warranty. Under no circumstances should the Elk Shingles or the Elk Starter Strip overhang the eaves or rake edge more than 3/4 of an inch.

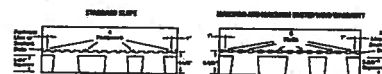
● **HELP STOP BLOW-OFFS AND CALL-BACKS**

A minimum of four fasteners must be driven into the DOUBLE THICKNESS (laminated) area of the shingle. Nails or staples must be placed along – and through – the fastener line or on products without fastener lines, nail or staple between and in line with sealant dots. CAUTION: Do not use fastener line for shingle alignment.

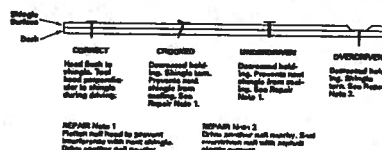

Refer to local codes which in some areas may require specific application techniques beyond those Elk has specified. All Prestique and Raised Profile shingles have a UL® Wind Resistance Rating when applied in accordance with these instructions using nails or staples on re-roofs as well as new construction.

**CAUTION TO WHOLESALE:** Careless and improper storage or handling can harm fiberglass shingles. Keep these shingles completely covered, dry, reasonably cool, and protected from the weather. Do not store near various sources of heat. Do not store in direct sunlight until applied. DO NOT DOUBLE STACK. Systematically rotate all stock so that the material that has been stored the longest will be the first to be moved out.

© 2002 Elk Corporation of Dallas.

All trademarks, ®, are registered trademarks of Elk Corporation of Dallas, an ELCOR company. Raised Profile, RidgeCrest, Gallery Collection and FLX are trademarks pending registration of Elk Corporation of Dallas. UL is a registered trademark of Underwriters Laboratories, Inc.

**ELK**  
www.elkcorp.com

# FLORIDA DEPARTMENT OF Community Affairs



[BCIS Home](#) | [Log In](#) | [Hot Topics](#) | [Submit Surcharge](#) | [Stats & Facts](#) | [Publications](#) | [FBC Staff](#) | [B](#)



**Product Approval**  
USER: Public User

[Product Approval Menu](#) > [Product or Application Search](#) > [Application List](#) > [Application Detail](#)

► COMMUNITY PLANNING

► HOUSING & COMMUNITY DEVELOPMENT

► COMMUNITY DEVELOPMENT

► COMMUNITY DEVELOPMENT

► COMMUNITY DEVELOPMENT

► EMERGENCY MANAGEMENT

► OFFICE OF THE SECRETARY

► COMMUNITY DEVELOPMENT

► COMMUNITY DEVELOPMENT

► COMMUNITY DEVELOPMENT

► COMMUNITY DEVELOPMENT

► COMMUNITY DEVELOPMENT

► COMMUNITY DEVELOPMENT

► COMMUNITY DEVELOPMENT

► COMMUNITY DEVELOPMENT

FL #

FL1476-R2

Application Type

Revision

Code Version

2004

Application Status

Approved

Comments

Archived



Product Manufacturer

Elk Corporation

Address/Phone/Email

4600 Stillman Blvd.  
Tuscaloosa, AL 35401  
(205) 342-0298  
daniel.dejarnette@elkcorp.com

Authorized Signature

Daniel DeJarnette  
daniel.dejarnette@elkcorp.com

Technical Representative  
Address/Phone/Email

Daniel DeJarnette  
4600 Stillman Blvd  
Tuscaloosa, AL 35401  
(205) 342-0298  
daniel.dejarnette@elkcorp.com

Quality Assurance Representative  
Address/Phone/Email

Category  
Subcategory

Roofing  
Asphalt Shingles

Compliance Method

Certification Mark or Listing

Certification Agency

Underwriters Laboratories Inc.

Referenced Standard and Year (of Standard)

**Standard**

ASTM D3462

TAS 107

Equivalence of Product Standards  
Certified By

Product Approval Method

Method 1 Option A

Date Submitted

09/20/2005

Date Validated

09/27/2005

Date Pending FBC Approval

09/29/2005

Date Approved

10/11/2005

**Summary of Products**

FL #	Model, Number or Name	Description
1476.1	Elk Prestique Shingles	Laminated Asphalt Shingles
<b>Limits of Use (See Other)</b> <b>Approved for use in HVHZ:</b> <b>Approved for use outside HVHZ:</b> <b>Impact Resistant:</b> <b>Design Pressure: +/-</b> <b>Other:</b> 1) All FBC sections apply except for those pertaining to Miami - Dade and Broward Counties 2) Refer to NOA # 0500706.07 for use in Dade and Broward Counties		<b>Certification Agency Certificate</b> <b>Installation Instruction</b> <u>PTID 1476 R2 I Specs</u> <u>PTID 1476 R2 I UL Pre</u> Verified By:

[Back](#)[Next](#)[DCA Administration](#)

Department of Community Affairs  
Florida Building Code Online  
Codes and Standards

2555 Shumard Oak Boulevard  
Tallahassee, Florida 32399-2100

(850) 487-1824, Suncom 277-1824, Fax (850) 414-8436

© 2000-2005 The State of Florida. All rights reserved. Copyright and Disc

Product Approval Accepts:



Door Model	Gauge	Decimal
2250/2251	25	.0185
4250/4251	25	.0185
2240/2241	24	.0225
4240/4241	24	.0225
5240/5241	24	.0225

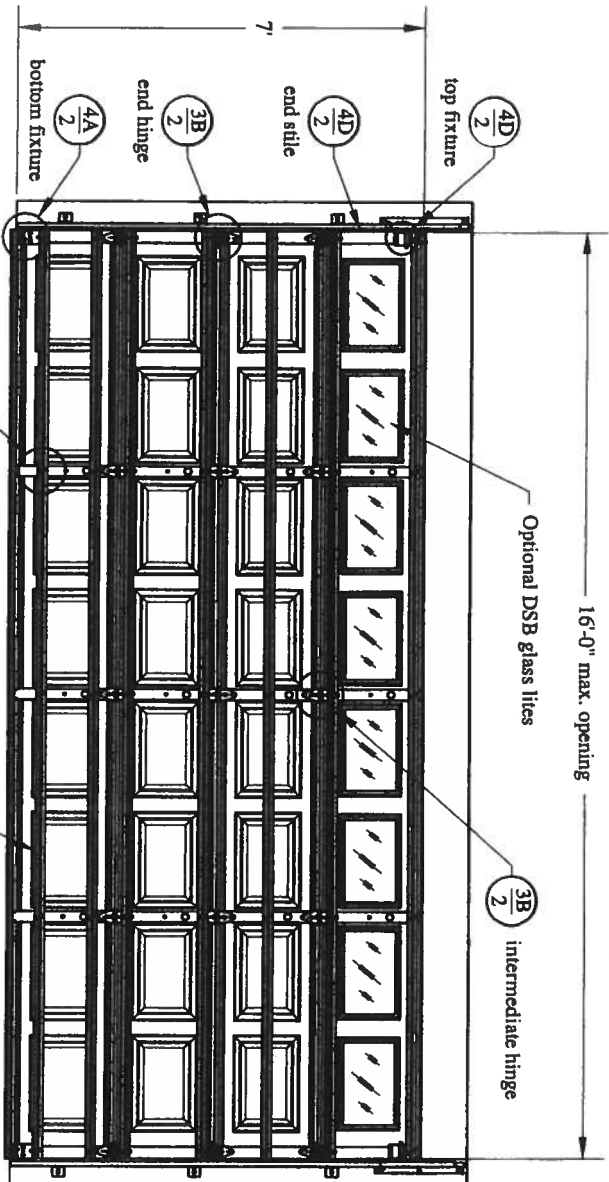

door height	section quantity	strut quantity	trk brkt per side
6'-6" to 7'-0"	4	7	3
7'-6" to 8'-0"	5	8	4
8'-3" to 8'-9"	5	9	4
9'-0" to 10'-6"	6	11	5
10'-9" to 12'-3"	7	13	6
12'-6" to 14'-0"	8	15	7

Refer to Supplemental Instructions for strut placement on doors over 7'-0" high

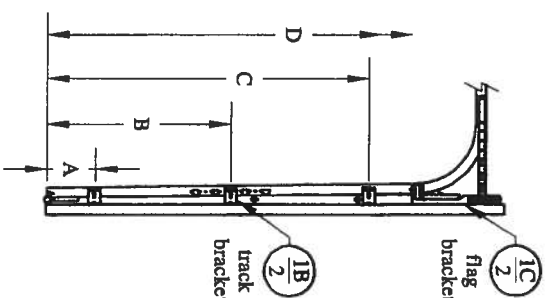

Track Bracket Chart	door height									
	6'-6"	6'-9"	7'-0"	7'-6"	7'-9"	8'-0"	8'-3"	8'-6"	8'-9"	
track brackets	D	n/a	n/a	n/a	72"	69"	72"	81"	84"	87"
	C	60"	63"	66"	58"	55"	58"	60"	63"	66"
	B	35"	35"	38"	34"	31"	34"	32"	35"	38"
	A	10"	7"	10"	10"	7"	10"	4"	7"	10"

Track bracket locations shown above are for doors up to five sections high. Additional door sections may be added for a maximum door height of 14'-0". One track bracket (per track) must be added for each section and spaced at a distance not greater than the corresponding section height.

This door has been tested in accordance with ANSI/DASMA 108-2002  
Design Pressure (DP): 18.5 pos / 20.7 neg  
Test Pressure (TP): 27.8 pos / 31.1 neg

Per 2004 FBC Table 1609.6E, DP meets or exceeds basic wind speed of:  
V = 110 MPH for Exposure B and mean roof height of 30' or less  
V = 93 MPH for Exposure C and mean roof height of 30' or less  
Maximum door size: 16'-0" wide by 14'-0" tall

Glazing and door have not been tested for windborne debris.

Wood buck and supporting structural elements shall be designed by a registered professional engineer for wind loads shown on this drawing. If door is not electrically operated, a lock must be installed.

Professional Engineer's seal provided only for verification of windload construction details

John E. Scates, P.E.  
1411 LeMay Street #205  
Carrollton, Texas 75007  
Florida P.E. # 51737

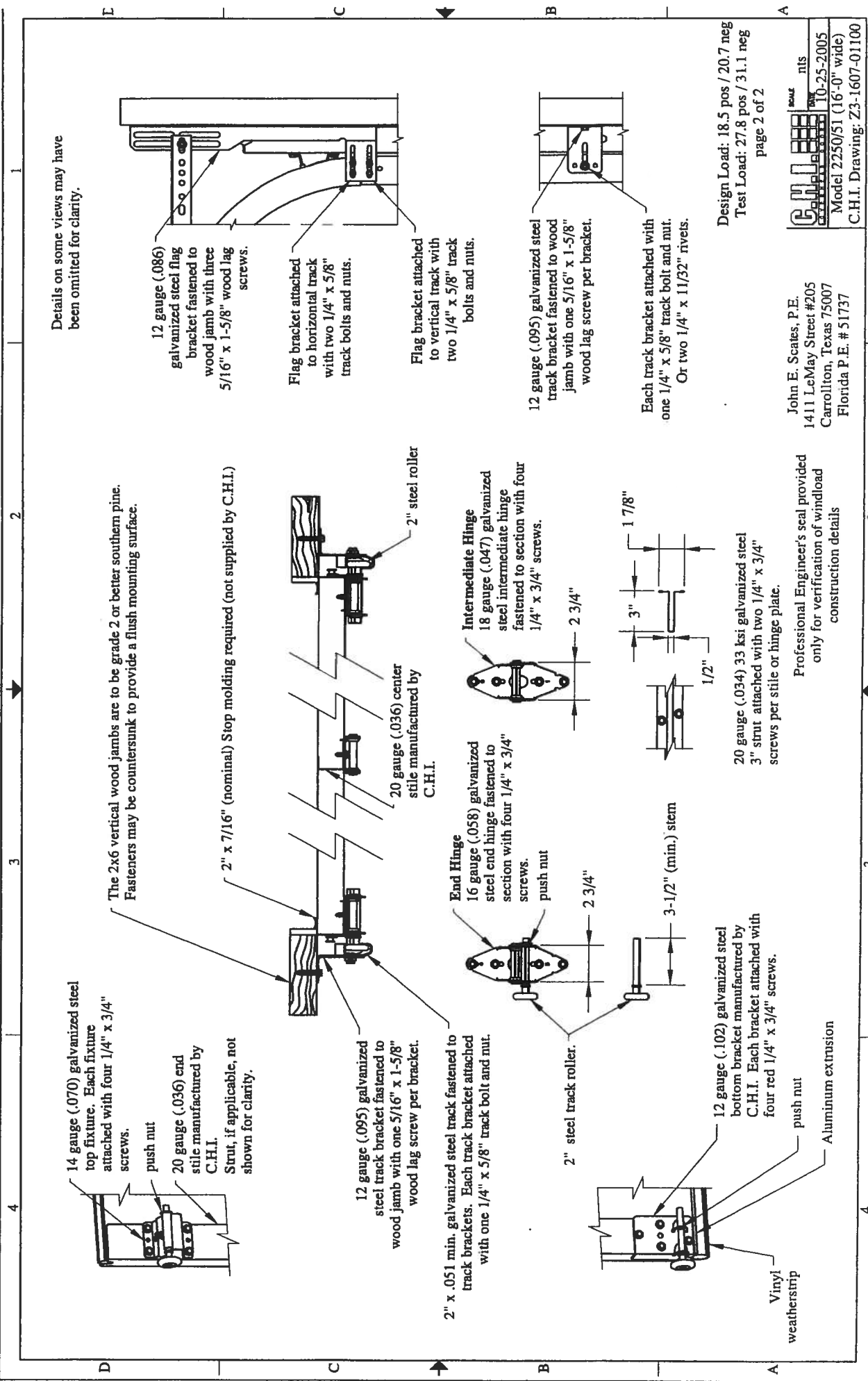

Details on some views may have been omitted for clarity.

Design Load: 18.5 pos / 20.7 neg  
 Test Load: 27.8 pos / 31.1 neg  
 page 2 of 2

	DATE	10-25-2005
	Model	2250/51 (16'-0" wide)
C.H.I. Drawing: Z3-1607-01100		

John E. Scates, P.E.  
 1411 LeMay Street #205  
 Carrollton, Texas 75007  
 Florida P.E. # 51737

Professional Engineer's seal provided only for verification of windload construction details

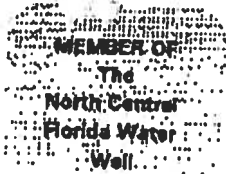

**Clyatt Well Drilling, Inc.**  
(Established in 1971)  
POST OFFICE BOX 180  
WORTHINGTON SPRINGS, FLORIDA 32697

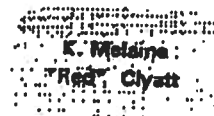

Telephone Number (386)496-2488  
FAX Number (386)496-4640

June 18, 2002

Columbia County Building Department  
Post Office Box 1529  
Lake City, Florida 32056

To Whom It May Concern:

As required by building code regulations for Columbia County in order that a building permit can be issued, the following well information is provided with regard to the above-referenced well:

Size of Pump Motor:	1-1/2 Horse Power
Size of Pressure Tank:	220 Gallon Equivalent
Cycle Stop Valve Used:	No

Should you require any additional information, please do not hesitate to contact us.

Respectfully,

**CLYATT WELL DRILLING, INC.**

K. Melaine "Red" Clyatt  
President



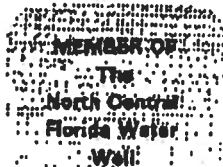

**Clyatt Well Drilling, Inc.**  
(Established in 1971)  
POST OFFICE BOX 180  
WORTHINGTON SPRINGS, FLORIDA 32697

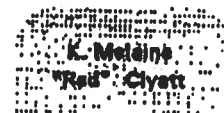

Telephone Number (386)496-2488  
FAX Number (386)496-4640

---

**PUMP AND TANK SPECIFICATIONS FOR  
STANDARD 4" RESIDENTIAL WELLS**

**PUMPS**

1 Horse Power Submersible Pump  
20 Gallons Per Minute  
Voltage: 240  
Phase: (Single) 1

1.5 Horse Power Submersible Pump  
25 Gallons Per Minute  
Voltage: 240  
Phase: (Single) 1

**TANK**

WF-255 Captive Air Tank  
Capacity 81 Gallons  
Equivalent 220 Gallons  
Draw Down 25 Gallons

Attn: webbie

**Columbia County Building Department  
Culvert Waiver**

**Culvert Waiver No.  
000001304**

DATE: 01/17/2007 BUILDING PERMIT NO. 25417  
APPLICANT MARY ANN CRAWFORD PHONE 752-5152  
ADDRESS 853 SW SISTERS WELCOME RD LAKE CITY FL 32025  
OWNER LARRY WILMOTH PHONE 954 605-2685  
ADDRESS 44255 CATHERINE ROAD LAKE CITY FL 32055  
CONTRACTOR STANLEY CRAWFORD PHONE 752-5152  
LOCATION OF PROPERTY 441S, TR ON CATHERINE ROAD, 1/2 MILE ON RIGHT

SUBDIVISION/LOT/BLOCK/PHASE/UNIT \_\_\_\_\_

PARCEL ID # 22-5S-17-09328-006

I HEREBY CERTIFY THAT I UNDERSTAND AND WILL FULLY COMPLY WITH THE DECISION OF THE COLUMBIA COUNTY PUBLIC WORKS DEPARTMENT IN CONNECTION WITH THE HEREIN PROPOSED APPLICATION.

SIGNATURE: Mary Ann Crawford

A SEPARATE CHECK IS REQUIRED  
MAKE CHECKS PAYABLE TO BCC

Amount Paid 50.00

**PUBLIC WORKS DEPARTMENT USE ONLY**

I HEREBY CERTIFY THAT I HAVE EXAMINED THIS APPLICATION AND DETERMINED THAT THE  
CULVERT WAIVER IS:

\_\_\_\_\_  
APPROVED ✓ NOT APPROVED - NEEDS A CULVERT PERMIT

COMMENTS: Need 21"X15"X32' Lower a little

SIGNED: Eric Phillips

DATE: 1-19-07

ANY QUESTIONS PLEASE CONTACT THE PUBLIC WORKS DEPARTMENT AT 386-752-5955.

**RECEIVED**

JAN 18 2007

By: \_\_\_\_\_

135 NE Hernando Ave., Suite B-21  
Lake City, FL 32055  
Phone: 386-758-1008 Fax: 386-758-2160



## Notice of Treatment

12356

Applicator: **Florida Pest Control & Chemical Co. (www.flapest.com)**

Address: 536 SE BAYA DR.

City Lake City

Phone (386) 752-1701

Site Location: Subdivision N/A

Lot # N/A

Block# N/A

Permit # 25417

Address 631 SW Catherine Lane Lake City

### Product used

### Active Ingredient

### % Concentration

- |                                    |                                  |       |
|------------------------------------|----------------------------------|-------|
| <input type="checkbox"/> Premise   | Imidacloprid                     | 0.1%  |
| <input type="checkbox"/> Termidor  | Fipronil                         | 0.12% |
| <input type="checkbox"/> Bora-Care | Disodium Octaborate Tetrahydrate | 23.0% |

### Type treatment:

☐ Soil

☒ Wood

### Area Treated

### Square feet

### Linear feet

### Gallons Applied

Main 2000

3192

256

10

As per Florida Building Code 104.2.6 – If soil chemical barrier method for termite prevention is used, final exterior treatment shall be completed prior to final building approval.

If this notice is for the final exterior treatment, initial this line \_\_\_\_\_.

02-23-07  
Date

1:50 pm  
Time

[Signature]  
Print Technician's Name

Remarks: \_\_\_\_\_

Applicator - White

Permit File - Canary

Permit Holder - Pink

10/05



# COLUMBIA COUNTY DEPARTMENT OF BUILDING AND ZONING OCCUPANCY

## COLUMBIA COUNTY, FLORIDA

### Department of Building and Zoning Inspection

*This Certificate of Occupancy is issued to the below named permit holder for the building and premises at the below named location, and certifies that the work has been completed in accordance with the Columbia County Building Code.*

Parcel Number 22-5S-17-09328-006

Building permit No. 000025417

Use Classification SFD, UTILITY

Fire: 32.37

Permit Holder STANLEY CRAWFORD

Waste: 50.25

Owner of Building LARRY WILMOTH

Total: 82.62

Location: 631 SW CATHERINE RD, LAKE CITY, FL

Date: 07/24/2007

Building Inspector

POST IN A CONSPICUOUS PLACE  
(Business Places Only)