

REVISIONS

SOFTPLAN
ARCHITECTURAL DESIGN SOFTWARE

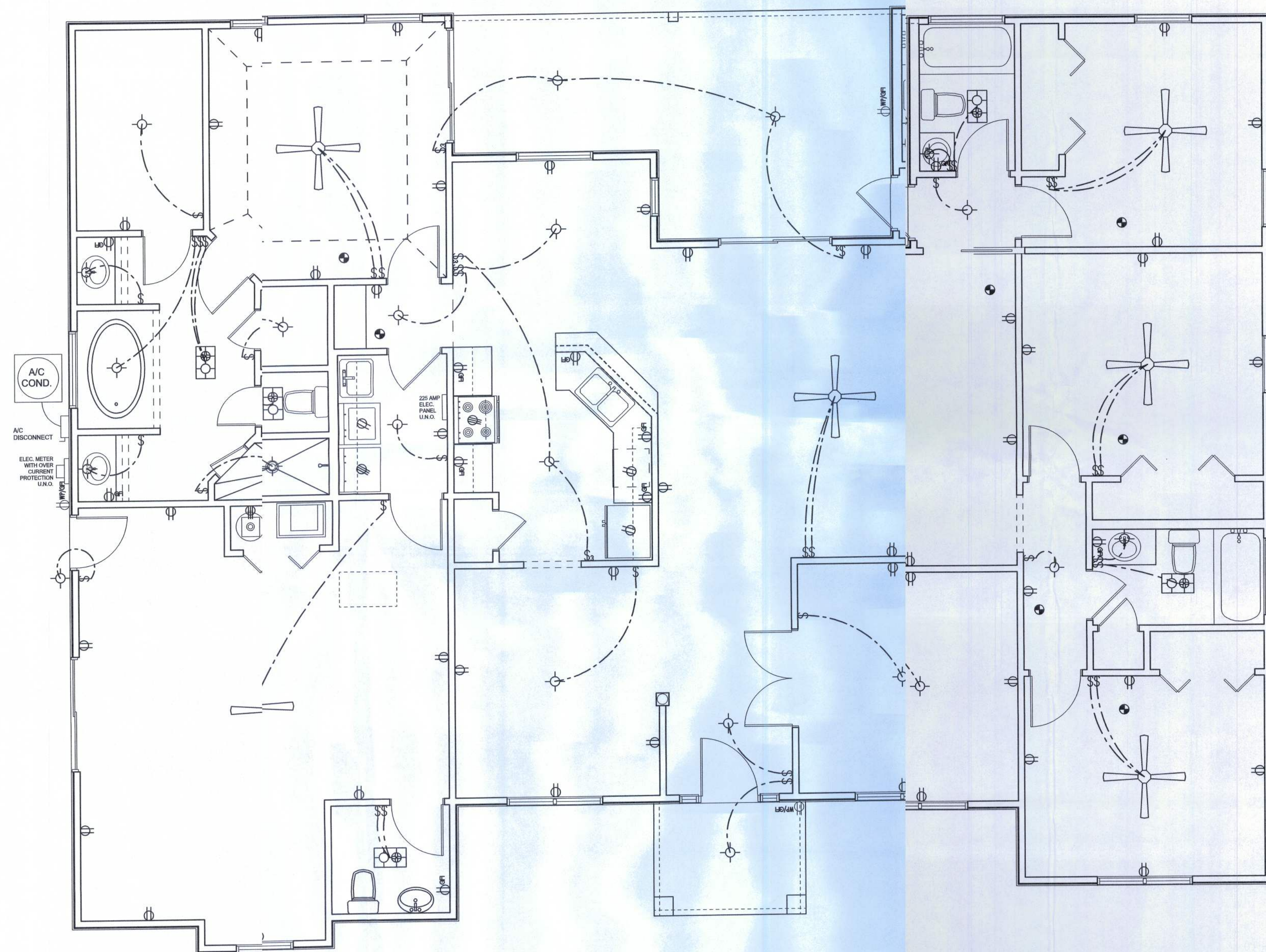

ELECTRICAL PLAN
SCALE: 1/4" = 1'-0"

ELECTRICAL PLAN NOTES

- E -1 WIRE ALL APPLIANCES, HVAC UNITS AND OTHER EQUIPMENT PER MANUF. SPECIFICATIONS.
- E -2 CONSULT THE OWNER FOR THE NUMBER OF SEPERATE TELEPHONE LINES TO BE INSTALLED.
- E -3 ALL INSTALLATIONS SHALL BE PER NAT'L. ELECTRIC CODE.
- E -4 ALL SMOKE DETECTORS SHALL BE 120V W/ BATTERY BACKUP OF THE PHOTOELECTRIC TYPE, AND SHALL BE INTERLOCKED TOGETHER. INSTALL INSIDE AND NEAR ALL BEDROOMS.
- E -5 TELEPHONE, TELEVISION AND OTHER LOW VOLTAGE DEVICES OR OUTLETS SHALL BE AS PER THE OWNER'S DIRECTIONS, & IN ACCORDANCE W/ APPLICABLE SECTIONS OF NEC-LATEST EDITION.
- E -6 ELECTRICAL CONTR SHALL BE RESPONSIBLE FOR THE DESIGN & SIZING OF ELECTRICAL SERVICE AND CIRCUITS.
- E -7 ENTRY OF SERVICE (UNDERGROUND OR OVERHEAD) TO BE DETERMINED BY POWER COMPANY.
- E -8 ALL BEDROOM RECEPTACLES SHALL BE AFCI (ARC FAULT CIRCUIT INTERRUPT)
- E -9 ALL OUTLETS TO BE LOCATED ABOVE BASE FLOOD ELEVATION
- E -10 A SERVICE DISCONNECT WITH OVER CURRENT PROTECTION SHALL BE INSTALLED OUTSIDE OF THE BUILDING, ON THE LOAD SIDE OF THE METER, AT THE PLACE ELECTRIC CONDUCTORS ENTER THE BUILDING. SERVICE ENTRANCE CONDUCTORS MAY NOT BE LOCATED INSIDE OF THE OF THE BUILDING WITHOUT SPECIAL APPROVAL OF THE BUILDING OFFICIAL.

ELECTRICAL LEGEND	
	CEILING FAN (PRE-WIRE FOR LIGHT KIT)
	DOUBLE SECURITY LIGHT
	2X4 FLUORESCENT LIGHT FIXTURE
	RECESSED CAN LIGHT
	BATH EXAUST FAN WITH LIGHT
	BATH EXAUST FAN
	LIGHT FIXTURE
	DUPLEX OUTLET
	220v OUTLET
	GFI DUPLEX OUTLET
	SMOKE DETECTOR
	WALL SWITCH
	3 WAY WALL SWITCH
	4 WAY WALL SWITCH
	WATER PROOF GFI OUTLET
	PHONE JACK
	TELEVISION JACK
	GARAGE DOOR OPENER
	WALL HEATER

WINDLOAD ENGINEER: Mark Disosway,
PE No.53915, POB 868, Lake City, FL
32056, 386-754-5419

DIMENSIONS:
Stated dimensions supersede scaled dimensions. Refer all questions to Mark Disosway, P.E. for resolution. Do not proceed without clarification.

COPYRIGHTS AND PROPERTY RIGHTS:
Mark Disosway, P.E. hereby expressly reserves its common law copyrights and property right in these instruments of service. This document is not to be reproduced, altered or copied in any form or manner without first the express written permission and consent of Mark Disosway.

CERTIFICATION: I hereby certify that I have examined this plan, and that the applicable portions of the plan, relating to wind engineering comply with section 9001.2.1, Florida building code residential 2004, to the best of my knowledge.

LIMITATION: This design is valid for one building, at specified location.

MARK DISOSWAY
P.E. 53915

Mark Disosway
06MAR08
SEAL

Sparks Construction Inc

Bryant Residence

ADDRESS:
SW Birley Ave.
Columbia Co. FL

Mark Disosway P.E.
P.O. Box 868
Lake City, Florida 32056
Phone: (386) 754 - 5419
Fax: (386) 269 - 4871

PRINTED DATE:
March 06, 2008

DRAWN BY: Ben Sparks	STRUCTURAL BY: Ben Sparks
-------------------------	------------------------------

FINALS DATE:
27 / Feb / 08

JOB NUMBER:
707261

DRAWING NUMBER

3

OF 6 SHEETS