



COLUMBIA COUNTY PRODUCT APPROVAL SPECIFICATION SHEET

As required by Florida Statute 553.842 and Florida Administrative Code 9B-72, please provide the information and approval numbers on the building components listed below if they will be utilized on the construction project for which you are applying for a building permit. We recommend you contact your local product supplier should you not know the product approval number for any of the applicable listed products. Statewide approved products are listed online at www.floridabuilding.org.

Category/Subcategory	Manufacturer	Product Description	Approval Number(s)
1. EXTERIOR DOORS			
A. SWINGING			
B. SLIDING			
C. SECTIONAL/ROLL UP			
D. OTHER			
2. WINDOWS			
A. SINGLE/DOUBLE HUNG	Wincore	Double Hung Window	15819.8 15819.9
B. HORIZONTAL SLIDER			
C. CASEMENT			
D. FIXED	Wincore	Fixed Window	15816.13
E. MULLION			
F. SKYLIGHTS			
G. OTHER			
3. PANEL WALL			
A. SIDING			
B. SOFFITS			
C. STOREFRONTS			
D. GLASS BLOCK			
E. OTHER			
4. ROOFING PRODUCTS			
A. ASPHALT SHINGLES			
B. NON-STRUCT METAL			
C. ROOFING TILES			
D. SINGLE PLY ROOF			
E. OTHER			
5. STRUCT COMPONENTS			
A. WOOD CONNECTORS			
B. WOOD ANCHORS			
C. TRUSS PLATES			
D. INSULATION FORMS			
E. LINTELS			
F. OTHERS			
6. NEW EXTERIOR			
A. ENVELOPE PRODUCTS			

The products listed below did not demonstrate product approval at plan review. I understand that at the time of inspection of these products, the following information must be available to the inspector on the jobsite; **(1)** copy of the product approval **(2)** performance characteristics which the product was tested and certified to comply with **(3)** copy of the applicable manufacturer's installation requirements. Further, I understand these products may have to be removed if approval cannot be demonstrated during inspection.

11/21/2023

APPLICANT SIGNATURE

DATE



Product Approval
USER: Public User

[Product Approval Menu](#) > [Product or Application Search](#) > **Application List**

► OFFICE OF THE
SECRETARY

Search Criteria

[Refine Search](#)

Code Version	2020	FL#	15819.8
Application Type	ALL	Product Manufacturer	ALL
Category	ALL	Subcategory	ALL
Application Status	ALL	Compliance Method	ALL
Quality Assurance Entity	ALL	Quality Assurance Entity Contract Expired	ALL
Product Model, Number or Name	ALL	Product Description	ALL
Approved for use in HVHZ	ALL	Approved for use outside HVHZ	ALL
Impact Resistant	ALL	Design Pressure	ALL
Other	ALL		

Search Results - Applications

FL#	Type	Manufacturer	Validated By	Status
FL15819-R11 History	Revision	Wincore Window Company, LLC FL#: FL15819.8 Model: h. 7700 / 9000 Series Vinyl Double Hung Window Description: Extruded PVC Double Hung Window with "Non-Impact" Insulated Glass Category: Windows Subcategory: Double Hung	Ryan J. King, P.E. (813) 767-6555	Approved

*Approved by DBPR. Approvals by DBPR shall be reviewed and ratified by the POC and/or the Commission if necessary.

[Contact Us](#) :: 2601 Blair Stone Road, Tallahassee FL 32399 Phone: 850-487-1824

The State of Florida is an AA/EEO employer. [Copyright 2007-2013 State of Florida](#). :: [Privacy Statement](#) :: [Accessibility Statement](#) :: [Refund Statement](#)

Under Florida law, email addresses are public records. If you do not want your e-mail address released in response to a public-records request, do not send electronic mail to this entity. Instead, contact the office by phone or by traditional mail. If you have any questions, please contact 850.487.1395. *Pursuant to Section 455.275(1), Florida Statutes, effective October 1, 2012, licensees licensed under Chapter 455, F.S. must provide the Department with an email address if they have one. The emails provided may be used for official communication with the licensee. However email addresses are public record. If you do not wish to supply a personal address, please provide the Department with an email address which can be made available to the public. To determine if you are a licensee under Chapter 455, F.S., please click [here](#).

Product Approval Accepts:





Product Approval
USER: Public User

[Product Approval Menu](#) > [Product or Application Search](#) > [Application List](#) > **Application Detail**

► OFFICE OF THE
SECRETARY

FL #	FL15819-R11																
Application Type	Revision																
Code Version	2020																
Application Status	Approved																
Comments																	
Archived	<input type="checkbox"/>																
Product Manufacturer	Wincore Window Company, LLC																
Address/Phone/Email	250 Staunton Avenue Parkersburg, WV 26104 (304) 485-7460 Ext 228 dgeorge@wincorewindows.com																
Authorized Signature	Vivian Wright rickw@rwbldgconsultants.com																
Technical Representative	Mike Reed																
Address/Phone/Email	250 Staunton Turnpike Parkersburg, WV 26104 (304) 485-7460 Ext 228 mreed@wincorewindows.com																
Quality Assurance Representative	Mike Reed																
Address/Phone/Email	250 Staunton Turnpike Parkersburg, WV 26104 (304) 485-7460 Ext 228 mreed@wincorewindows.com																
Category	Windows																
Subcategory	Double Hung																
Compliance Method	Evaluation Report from a Florida Registered Architect or a Licensed Florida Professional Engineer <input type="checkbox"/> Evaluation Report - Hardcopy Received																
Florida Engineer or Architect Name who developed the Evaluation Report	Lyndon F. Schmidt, P.E.																
Florida License	PE-43409																
Quality Assurance Entity	National Accreditation and Management Institute																
Quality Assurance Contract Expiration Date	12/31/2021																
Validated By	Ryan J. King, P.E. <input checked="" type="checkbox"/> Validation Checklist - Hardcopy Received																
Certificate of Independence	FL15819_R11_COI_(c) Certificate of Independence.pdf																
Referenced Standard and Year (of Standard)	<table border="0"> <thead> <tr> <th><u>Standard</u></th> <th><u>Year</u></th> </tr> </thead> <tbody> <tr> <td>AAMA/WDMA/CSA101/I.S.2/A440</td> <td>2008</td> </tr> <tr> <td>AAMA/WDMA/CSA101/I.S.2/A440</td> <td>2005</td> </tr> <tr> <td>AAMA/WDMA/CSA101/I.S.2/A440</td> <td>2011</td> </tr> <tr> <td>ASTM E 1300</td> <td>2004</td> </tr> <tr> <td>ASTM E1886</td> <td>2005</td> </tr> <tr> <td>ASTM E1886</td> <td>2013</td> </tr> <tr> <td>ASTM E1996</td> <td>2014</td> </tr> </tbody> </table>	<u>Standard</u>	<u>Year</u>	AAMA/WDMA/CSA101/I.S.2/A440	2008	AAMA/WDMA/CSA101/I.S.2/A440	2005	AAMA/WDMA/CSA101/I.S.2/A440	2011	ASTM E 1300	2004	ASTM E1886	2005	ASTM E1886	2013	ASTM E1996	2014
<u>Standard</u>	<u>Year</u>																
AAMA/WDMA/CSA101/I.S.2/A440	2008																
AAMA/WDMA/CSA101/I.S.2/A440	2005																
AAMA/WDMA/CSA101/I.S.2/A440	2011																
ASTM E 1300	2004																
ASTM E1886	2005																
ASTM E1886	2013																
ASTM E1996	2014																

Equivalence of Product Standards
Certified By

Florida Licensed Professional Engineer or Architect
[FL15819_R11_Equiv_of_Standards.pdf](#)

Sections from the Code

Product Approval Method

Method 1 Option D

Date Submitted

07/07/2020

Date Validated

07/13/2020

Date Pending FBC Approval

07/20/2020

Date Approved

10/13/2020

Summary of Products

FL #	Model, Number or Name	Description
15819.1	a. 8400 Series Vinyl Double Hung Window	Extruded PVC Double Hung Window with "Non-Impact" Insulated Glass
Limits of Use Approved for use in HVHZ: No Approved for use outside HVHZ: Yes Impact Resistant: No Design Pressure: N/A Other: See INST 15819.1 for Design Pressure Ratings, any additional use limitations, installation instructions and product particulars.		Installation Instructions FL15819_R11_IL_(d)_Inst 15819.1.pdf Verified By: Lyndon F. Schmidt, P.E. 43409 Created by Independent Third Party: Yes Evaluation Reports FL15819_R11_AE_(d)_Eval 15819.1.pdf Created by Independent Third Party: Yes
15819.2	b. 8800 Series Vinyl Double Hung Window	Extruded PVC Double Hung Window with "Impact" Insulated Glass
Limits of Use Approved for use in HVHZ: No Approved for use outside HVHZ: Yes Impact Resistant: Yes Design Pressure: N/A Other: See INST 15819.2 for Design Pressure Ratings, any additional use limitations, installation instructions and product particulars.		Installation Instructions FL15819_R11_IL_(d)_Inst 15819.2.pdf Verified By: Lyndon F. Schmidt, P.E. 43409 Created by Independent Third Party: Yes Evaluation Reports FL15819_R11_AE_(d)_Eval 15819.2.pdf Created by Independent Third Party: Yes
15819.3	c. 8800 Series "HVHZ" Vinyl Double Hung Window	Extruded PVC Double Hung Window with "Impact" Insulated Glass
Limits of Use Approved for use in HVHZ: Yes Approved for use outside HVHZ: Yes Impact Resistant: Yes Design Pressure: N/A Other: See INST 15819.3 for Design Pressure Ratings, any additional use limitations, installation instructions and product particulars.		Installation Instructions FL15819_R11_IL_(d)_Inst 15819.3.pdf Verified By: Lyndon F. Schmidt, P.E. 43409 Created by Independent Third Party: Yes Evaluation Reports FL15819_R11_AE_(d)_Eval 15819.3.pdf Created by Independent Third Party: Yes
15819.4	d. 400 Series Vinyl Double Hung Window	Extruded PVC Double Hung Window with Nailing Fin - "Non-Impact" Insulated Glass
Limits of Use Approved for use in HVHZ: No Approved for use outside HVHZ: Yes Impact Resistant: No Design Pressure: N/A Other: See INST 15819.4 for Design Pressure Ratings, any additional use limitations, installation instructions and product particulars.		Installation Instructions FL15819_R11_IL_(d)_Inst 15819.4.pdf Verified By: Lyndon F. Schmidt, P.E. 43409 Created by Independent Third Party: Yes Evaluation Reports FL15819_R11_AE_(d)_Eval 15819.4.pdf Created by Independent Third Party: Yes
15819.5	e. 500 Series Vinyl Double Hung Window	Extruded PVC Double Hung Window with Nailing Fin and Integral "J" Channel - "Non-Impact" Insulated Glass
Limits of Use Approved for use in HVHZ: No Approved for use outside HVHZ: Yes Impact Resistant: No Design Pressure: N/A		Installation Instructions FL15819_R11_IL_(d)_Inst 15819.5.pdf Verified By: Lyndon F. Schmidt, P.E. 43409 Created by Independent Third Party: Yes Evaluation Reports

Other: See INST 15819.5 for Design Pressure Ratings, any additional use limitations, installation instructions and product particulars.		FL15819_R11_AE_(d)_Eval_15819.5.pdf Created by Independent Third Party: Yes
15819.6	f. 5400 / 5400S Series Vinyl Double Hung Window	Extruded PVC Double Hung Window with "Non-Impact" Insulated Glass (Double Strength Glass with Reinforced Sash)
Limits of Use Approved for use in HVHZ: No Approved for use outside HVHZ: Yes Impact Resistant: No Design Pressure: N/A Other: See INST 15819.6 for Design Pressure Ratings, any additional use limitations, installation instructions and product particulars.		Installation Instructions FL15819_R11_IL_(d)_Inst_15819.6.pdf Verified By: Lyndon F. Schmidt, P.E. 43409 Created by Independent Third Party: Yes Evaluation Reports FL15819_R11_AE_(d)_Eval_15819.6.pdf Created by Independent Third Party: Yes
15819.7	g. 5400 / 5400S Series Vinyl Double Hung Window	Extruded PVC Double Hung Window with "Non-Impact" Insulated Glass (Single Strength Glass with non-reinforced Sash)
Limits of Use Approved for use in HVHZ: No Approved for use outside HVHZ: Yes Impact Resistant: No Design Pressure: N/A Other: See INST 15819.7 for Design Pressure Ratings, any additional use limitations, installation instructions and product particulars.		Installation Instructions FL15819_R11_IL_(d)_Inst_15819.7.pdf Verified By: Lyndon F. Schmidt, P.E. 43409 Created by Independent Third Party: Yes Evaluation Reports FL15819_R11_AE_(d)_Eval_15819.7.pdf Created by Independent Third Party: Yes
15819.8	h. 7700 / 9000 Series Vinyl Double Hung Window	Extruded PVC Double Hung Window with "Non-Impact" Insulated Glass
Limits of Use Approved for use in HVHZ: No Approved for use outside HVHZ: Yes Impact Resistant: No Design Pressure: N/A Other: See INST 15819.8 for Design Pressure Ratings, any additional use limitations, installation instructions and product particulars.		Installation Instructions FL15819_R11_IL_(d)_Inst_15819.8.pdf Verified By: Lyndon F. Schmidt, P.E. 43409 Created by Independent Third Party: Yes Evaluation Reports FL15819_R11_AE_(d)_Eval_15819.8.pdf Created by Independent Third Party: Yes
15819.9	i. 7700 / 9000 Series Vinyl Double Hung Window	Extruded PVC Double Hung Window (Reinforced Sash) with "Non-Impact" Insulated Glass
Limits of Use Approved for use in HVHZ: No Approved for use outside HVHZ: Yes Impact Resistant: No Design Pressure: N/A Other: See INST 15819.9 for Design Pressure Ratings, any additional use limitations, installation instructions and product particulars.		Installation Instructions FL15819_R11_IL_(d)_Inst_15819.9.pdf Verified By: Lyndon F. Schmidt, P.E. 43409 Created by Independent Third Party: Yes Evaluation Reports FL15819_R11_AE_(d)_Eval_15819.9.pdf Created by Independent Third Party: Yes

[Back](#)
[Next](#)

[Contact Us](#) :: 2601 Blair Stone Road, Tallahassee FL 32399 Phone: 850-487-1824

The State of Florida is an AA/EEO employer. [Copyright 2007-2013 State of Florida](#). :: [Privacy Statement](#) :: [Accessibility Statement](#) :: [Refund Statement](#)

Under Florida law, email addresses are public records. If you do not want your e-mail address released in response to a public-records request, do not send electronic mail to this entity. Instead, contact the office by phone or by traditional mail. If you have any questions, please contact 850.487.1395. *Pursuant to Section 455.275(1), Florida Statutes, effective October 1, 2012, licensees licensed under Chapter 455, F.S. must provide the Department with an email address if they have one. The emails provided may be used for official communication with the licensee. However email addresses are public record. If you do not wish to supply a personal address, please provide the Department with an email address which can be made available to the public. To determine if you are a licensee under Chapter 455, F.S., please click [here](#).

Product Approval Accepts:





250 Staunton Turnpike, Parkersburg, WV 26104

7700 / 9900 Series Vinyl Double Hung Window "NON-IMPACT"

GENERAL NOTES

1. This product has been evaluated and is in compliance with the 7th Edition (2020) Florida Building Code (FBC) structural requirements excluding the "High Velocity Hurricane Zone" (HVHZ).
2. Product anchors shall be as listed and spaced as shown on details. Anchor embedment to base material shall be beyond wall dressing or stucco.
3. When used in areas requiring wind borne debris protection this product is required to be protected with an impact resistant covering that complies with FBC Sections 1609.1.2 & R301.2.1.2.
4. For 2x stud framing construction, anchoring of these units shall be the same as that shown for 2x buck masonry construction.
5. Site conditions that deviate from the details of this drawing require further engineering analysis by a licensed engineer or registered architect.

TABLE OF CONTENTS

SHEET#	DESCRIPTION
1	Typical elevations, design pressures and general notes
2	Horizontal cross sections
3	Vertical cross sections
4	Buck and frame anchoring
5	Bill of materials, components & glazing details

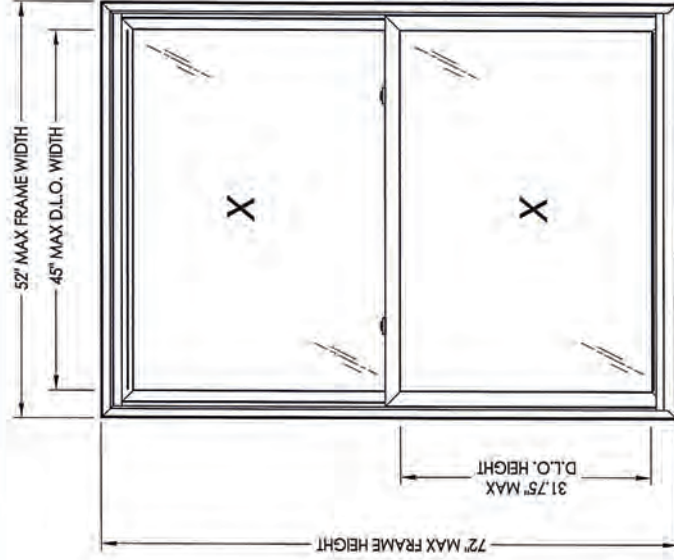

MAX. FRAME DIMENSION	MAX. D.L.O. DIMENSION	GLASS TYPE	DESIGN PRESSURE (PSF)	
			POSITIVE	NEGATIVE
32.0" X 58.0"	25.0" X 24.75"	G1, G2	+55.0	-55.0
52.0" X 40.0"	45.0" X 15.75"	G1, G2	+45.0	-45.0
48.0" X 42.0"	41.0" X 16.75"	G1, G2	+45.0	-45.0
44.0" X 44.0"	37.0" X 18.75"	G1, G2	+45.0	-45.0
40.0" X 52.0"	33.0" X 21.75"	G1, G2	+45.0	-45.0
36.0" X 56.0"	29.0" X 23.75"	G1, G2	+45.0	-45.0
32.0" X 64.0"	25.0" X 27.75"	G1, G2	+45.0	-45.0
52.0" X 44.0"	45.0" X 17.75"	G1, G2	+40.0	-40.0
48.0" X 48.0"	41.0" X 19.75"	G1, G2	+40.0	-40.0
44.0" X 52.0"	37.0" X 21.75"	G1, G2	+40.0	-40.0
40.0" X 58.0"	33.0" X 24.75"	G1, G2	+40.0	-40.0

MAX. FRAME DIMENSION	MAX. D.L.O. DIMENSION	GLASS TYPE	DESIGN PRESSURE (PSF)	
			POSITIVE	NEGATIVE
36.0" X 64.0"	29.0" X 27.75"	G1, G2	+40.0	-40.0
32.0" X 70.0"	25.0" X 30.75"	G1, G2	+40.0	-40.0
52.0" X 50.0"	45.0" X 20.75"	G1, G2	+35.0	-35.0
48.0" X 54.0"	41.0" X 22.75"	G1, G2	+35.0	-35.0
44.0" X 60.0"	37.0" X 25.75"	G1, G2	+35.0	-35.0
40.0" X 66.0"	33.0" X 28.75"	G1, G2	+35.0	-35.0
36.0" X 72.0"	29.0" X 31.75"	G1, G2	+35.0	-35.0
52.0" X 40.0"	45.0" X 25.75"	G1, G2	+30.0	-30.0
48.0" X 44.0"	41.0" X 27.75"	G1, G2	+30.0	-30.0
44.0" X 70.0"	37.0" X 30.75"	G1, G2	+30.0	-30.0
40.0" X 72.0"	33.0" X 31.75"	G1, G2	+30.0	-30.0
52.0" X 72.0"	45.0" X 31.75"	G1, G2	+25.0	-25.0

REVISIONS	
NO.	DATE
1	8/25/14
2	1/27/15
3	5/10/16
4	6/01/17
5	7/02/20
DATE: 6/23/14	
SCALE: N.T.S.	
DWG. BY: JK	
CHK. BY: LFS	
DRAWING NO.: FL-15819.8	
SHEET 1 OF 5	

PRODUCT: 7700 / 9900 SERIES Vinyl Double Hung Window	PART OR ASSEMBLY: TYPICAL ELEVATION, DESIGN PRESSURES & GENERAL NOTES
BY: JK	

July 2, 2020
Documents Prepared By: Lyndon F. Schmidt
P.E. No. 43409
Professional Engineer
L.F. SCHMIDT
FLORIDA
No. 43409
L.F. SCHMIDT
ENGINEER
BUILDING CONSULTANTS, INC.
P.O. Box 230, Vero Beach, FL 33595
Phone No.: 813.659.9197
FBPE Registry No. 9813

7700 / 9900 SERIES Vinyl Double Hung Window PART OR ASSEMBLY:	CROSS SECTIONS HORIZONTAL
(PRODUCT) Documents Prepared By: London F. Schmidt P.E. No. 43409	BUILDING CONSULTANTS, P.C. P.O. Box 230, Vero Beach, FL 33595 Phone No.: 813.659.8197 FBP# Registry No. 9213

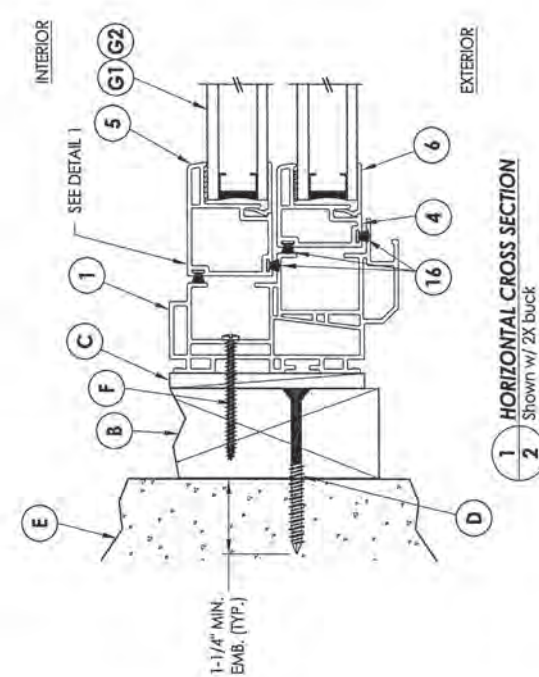
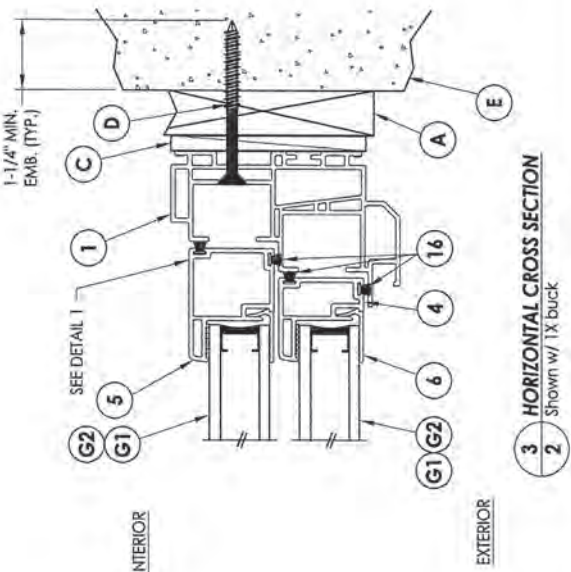

NO.	DATE	REVISIONS
1	8/25/14	REVISE SERIES NO.
2	1/27/15	UPDATE TO 5TH ED. (2014) FBC
3	5/10/16	REVISE INSTALLATION SCREWS
4	6/01/17	UPDATE TO 6TH ED. (2017) FBC
5	7/02/20	UPDATE TO 7TH ED. (2020) FBC

STATE OF
FLORIDA
PROFESSIONAL ENGINEER
BUILDING CONSULTANTS, INC.
P.O. Box 2230, Vero Beach, FL 33595
Phone No.: 813.659.9197
FBPE Registry No. 9813
Rw

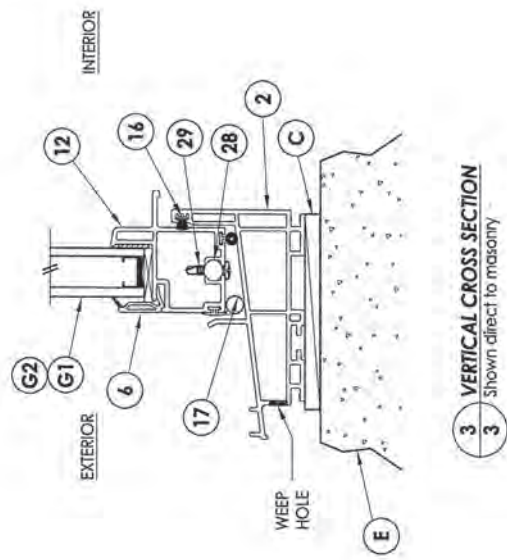

BUCK ANCHORING

FRAME ANCHORING

FRAME ANCHORING

ANCHOR TYPE	ANCHOR SIZE	MIN. EMBEDMENT	MIN. CLEARANCE TO MASONRY EDGE	MIN. CLEARANCE TO ADJACENT ANCHOR
ITW TAPCON®	1/4"	1-1/4"	2"	4"
ELCO ULTRACON®	1/4"	1-1/4"	1"	4"

WOOD SCREW INSTALLATION NOTES:

1. Maintain a minimum 5/8" edge distance, 1" end distance, & 1" o.c. spacing of wood screws to prevent the splitting of wood.

CONCRETE ANCHOR NOTES:

1. Concrete anchor locations at the corners may be adjusted to maintain the min. edge distance to marlar joints.
2. Concrete anchor locations noted as "MAX. ON CENTER" must be adjusted to maintain the min. edge distance to marlar joints; additional concrete anchors may be required to ensure the "MAX. ON CENTER" dimensions are not exceeded.
3. Concrete anchor table;

REVIEWS		NO.		DATE		REVISE SERIES NO.		BY	
LFS	LFS	5	7/02/20	UPDATE TO 7TH ED.	(2020) FBC	LFS	LFS	JR	JK
LFS	LFS	4	6/01/17	UPDATE TO 6TH ED.	(2017) FBC	LFS	LFS		
LFS	LFS	3	5/10/16	REVISE INSTALLATION	SCREENS	LFS	LFS		
LFS	LFS	2	1/23/15	UPDATE TO 5TH ED.	(2014) FBC	LFS	LFS		
LFS	LFS	1	8/23/14	REVISE SERIES NO.		LFS	LFS		

DATE: 6/23/14

SCALE: N.T.S.

DWG. BY: JK

CHK. BY: LFS

DRAWING NO.: FL-15819.8

SHEET 4 OF 5

PRODUCT:	7700 / 9900 SERIES Vinyl Double Hung Window
PART OR ASSEMBLY:	BUCK AND FRAME ANCHORING

July 2, 2020
Documents Prepared
Lyndon F. Schmidt
P.E. No. 43409
B.W.
BUILDING
P.O. Box
Phone No

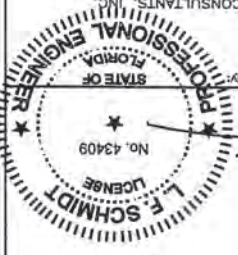

P.O. Box 230, Valrico, FL 33595
Phone No.: 813.659.9197
FBPE Registry No. 9813



Product Approval
USER: Public User

[Product Approval Menu](#) > [Product or Application Search](#) > **Application List**

► OFFICE OF THE
SECRETARY

Search Criteria

[Refine Search](#)

Code Version	2020	FL#	15819.9
Application Type	ALL	Product Manufacturer	ALL
Category	ALL	Subcategory	ALL
Application Status	ALL	Compliance Method	ALL
Quality Assurance Entity	ALL	Quality Assurance Entity Contract Expired	ALL
Product Model, Number or Name	ALL	Product Description	ALL
Approved for use in HVHZ	ALL	Approved for use outside HVHZ	ALL
Impact Resistant	ALL	Design Pressure	ALL
Other	ALL		

Search Results - Applications

FL#	Type	Manufacturer	Validated By	Status
FL15819-R11 History	Revision	Wincore Window Company, LLC FL#: FL15819.9 Model: i. 7700 / 9000 Series Vinyl Double Hung Window Description: Extruded PVC Double Hung Window (Reinforced Sash) with "Non-Impact" Insulated Glass Category: Windows Subcategory: Double Hung	Ryan J. King, P.E. (813) 767-6555	Approved

*Approved by DBPR. Approvals by DBPR shall be reviewed and ratified by the POC and/or the Commission if necessary.

[Contact Us](#) :: [2601 Blair Stone Road, Tallahassee FL 32399](#) Phone: 850-487-1824

The State of Florida is an AA/EEO employer. [Copyright 2007-2013 State of Florida](#). :: [Privacy Statement](#) :: [Accessibility Statement](#) :: [Refund Statement](#)

Under Florida law, email addresses are public records. If you do not want your e-mail address released in response to a public-records request, do not send electronic mail to this entity. Instead, contact the office by phone or by traditional mail. If you have any questions, please contact 850.487.1395. *Pursuant to Section 455.275(1), Florida Statutes, effective October 1, 2012, licensees licensed under Chapter 455, F.S. must provide the Department with an email address if they have one. The emails provided may be used for official communication with the licensee. However email addresses are public record. If you do not wish to supply a personal address, please provide the Department with an email address which can be made available to the public. To determine if you are a licensee under Chapter 455, F.S., please click [here](#).

Product Approval Accepts:





Product Approval
USER: Public User

[Product Approval Menu](#) > [Product or Application Search](#) > [Application List](#) > **Application Detail**

► OFFICE OF THE
SECRETARY

FL #	FL15819-R11																
Application Type	Revision																
Code Version	2020																
Application Status	Approved																
Comments																	
Archived	<input type="checkbox"/>																
Product Manufacturer	Wincore Window Company, LLC																
Address/Phone/Email	250 Staunton Avenue Parkersburg, WV 26104 (304) 485-7460 Ext 228 dgeorge@wincorewindows.com																
Authorized Signature	Vivian Wright rickw@rwbldgconsultants.com																
Technical Representative	Mike Reed																
Address/Phone/Email	250 Staunton Turnpike Parkersburg, WV 26104 (304) 485-7460 Ext 228 mreed@wincorewindows.com																
Quality Assurance Representative	Mike Reed																
Address/Phone/Email	250 Staunton Turnpike Parkersburg, WV 26104 (304) 485-7460 Ext 228 mreed@wincorewindows.com																
Category	Windows																
Subcategory	Double Hung																
Compliance Method	Evaluation Report from a Florida Registered Architect or a Licensed Florida Professional Engineer <input type="checkbox"/> Evaluation Report - Hardcopy Received																
Florida Engineer or Architect Name who developed the Evaluation Report	Lyndon F. Schmidt, P.E.																
Florida License	PE-43409																
Quality Assurance Entity	National Accreditation and Management Institute																
Quality Assurance Contract Expiration Date	12/31/2021																
Validated By	Ryan J. King, P.E. <input checked="" type="checkbox"/> Validation Checklist - Hardcopy Received																
Certificate of Independence	FL15819_R11_COI_(c) Certificate of Independence.pdf																
Referenced Standard and Year (of Standard)	<table border="0"> <thead> <tr> <th><u>Standard</u></th> <th><u>Year</u></th> </tr> </thead> <tbody> <tr> <td>AAMA/WDMA/CSA101/I.S.2/A440</td> <td>2008</td> </tr> <tr> <td>AAMA/WDMA/CSA101/I.S.2/A440</td> <td>2005</td> </tr> <tr> <td>AAMA/WDMA/CSA101/I.S.2/A440</td> <td>2011</td> </tr> <tr> <td>ASTM E 1300</td> <td>2004</td> </tr> <tr> <td>ASTM E1886</td> <td>2005</td> </tr> <tr> <td>ASTM E1886</td> <td>2013</td> </tr> <tr> <td>ASTM E1996</td> <td>2014</td> </tr> </tbody> </table>	<u>Standard</u>	<u>Year</u>	AAMA/WDMA/CSA101/I.S.2/A440	2008	AAMA/WDMA/CSA101/I.S.2/A440	2005	AAMA/WDMA/CSA101/I.S.2/A440	2011	ASTM E 1300	2004	ASTM E1886	2005	ASTM E1886	2013	ASTM E1996	2014
<u>Standard</u>	<u>Year</u>																
AAMA/WDMA/CSA101/I.S.2/A440	2008																
AAMA/WDMA/CSA101/I.S.2/A440	2005																
AAMA/WDMA/CSA101/I.S.2/A440	2011																
ASTM E 1300	2004																
ASTM E1886	2005																
ASTM E1886	2013																
ASTM E1996	2014																



250 Staunton Turnpike, Parkersburg, WV 26104

7700 / 9900 Series Vinyl Double Hung Window "NON-IMPACT"

GENERAL NOTES

1. This product has been evaluated and is in compliance with the 7th Edition (2020) Florida Building Code (FBC) structural requirements excluding the "High Velocity Hurricane Zone" (HVHZ).
2. Product anchors shall be as listed and spaced as shown on details. Anchor embedment to base material shall be beyond wall dressing or stucco.
3. When used in areas requiring wind borne debris protection this product is required to be protected with an impact resistant covering that complies with FBC Sections 1609.1.2 & R301.2.1.2.
4. For 2x stud framing construction, anchoring of these units shall be the same as that shown for 2x buck masonry construction.
5. Site conditions that deviate from the details of this drawing require further engineering analysis by a licensed engineer or registered architect.

TABLE OF CONTENTS

SHEET#	DESCRIPTION
1	Typical elevations, design pressures and general notes
2	Horizontal cross sections
3	Vertical cross sections
4	Buck and frame anchoring
5	Bill of materials, components & glazing details

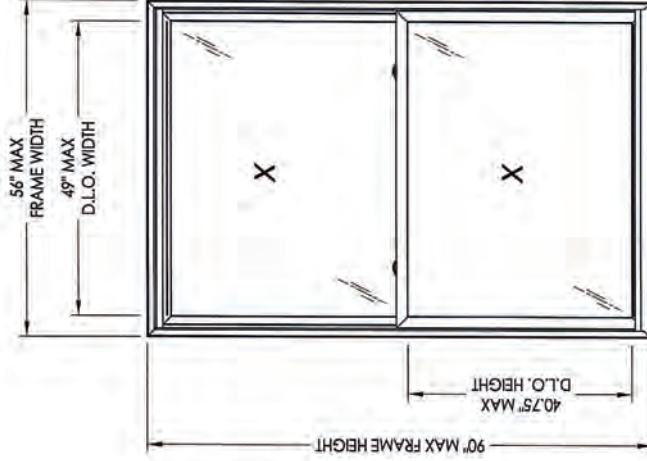

NOTE: Maximum frame height & width occur on separate units.

MAX. FRAME DIMENSION	MAX. D.L.O. DIMENSION	GLASS TYPE	DESIGN PRESSURE (PSF)	
			POSITIVE	NEGATIVE
38.0" X 74.0"	31.0" X 33.75"	G1, G2	+50.0	-50.0
56.0" X 60.0"	49.0" X 25.75"	G1, G2	+35.0	-35.0
52.0" X 64.0"	45.0" X 27.75"	G1, G2	+35.0	-35.0
48.0" X 70.0"	41.0" X 30.75"	G1, G2	+35.0	-35.0
44.0" X 74.0"	37.0" X 33.75"	G1, G2	+35.0	-35.0
40.0" X 84.0"	33.0" X 37.75"	G1, G2	+35.0	-35.0

MAX. FRAME DIMENSION	MAX. D.L.O. DIMENSION	GLASS TYPE	DESIGN PRESSURE (PSF)	
			POSITIVE	NEGATIVE
56.0" X 70.0"	49.0" X 30.75"	G1, G2	+30.0	-30.0
52.0" X 74.0"	45.0" X 32.75"	G1, G2	+30.0	-30.0
48.0" X 80.0"	41.0" X 35.75"	G1, G2	+30.0	-30.0
44.0" X 84.0"	37.0" X 37.75"	G1, G2	+30.0	-30.0
56.0" X 84.0"	49.0" X 37.75"	G1, G2	+25.0	-25.0
48.0" X 90.0"	41.0" X 40.75"	G1, G2	+25.0	-30.0

NO.	DATE	REVISIONS
1	8/25/14	REVISED REINFORCEMENT
2	1/27/15	UPDATE TO 5TH ED. (2014) FBC
3	5/10/16	REVISE INSTALLATION SCREWS
4	6/01/17	UPDATE TO 6TH ED. (2017) FBC
5	7/02/20	UPDATE TO 7TH ED. (2020) FBC

PRODUCT:	7700 / 9900 SERIES
PART OR ASSEMBLY:	Vinyl Double Hung Window
TYPICAL ELEVATION, DESIGN PRESSURES & GENERAL NOTES	



REVISIONS	
NO.	DATE
1	8/25/14
2	1/27/15
3	5/10/16
4	6/01/17
5	7/02/20
REVISED REINFORCEMENT	
JK	UPDATE TO 5TH ED. (2014) FBC
LFS	REVISE INSTALLATION SCREWS
LFS	UPDATE TO 6TH ED. (2017) FBC
LFS	UPDATE TO 7TH ED. (2020) FBC
PART OR ASSEMBLY:	
JK	
BY	

PRODUCT:	7700 / 9900 SERIES
Vinyl Double Hung Window	
CROSS SECTIONS	
HORIZONTAL	

July 6, 2020

Documents Prepared By: Lyndon F. Schmidt
P.E. No. 43408

PROFESSIONAL ENGINEER
FLORIDA
L.F. SCHMIDT
No. 43408
LICENSE

STATE OF FLORIDA

Building Consultants, Inc.
P.O. Box 230, Vero Beach, FL 33595
Phone No.: 813.659.9197
FBPE Registry No. 9813

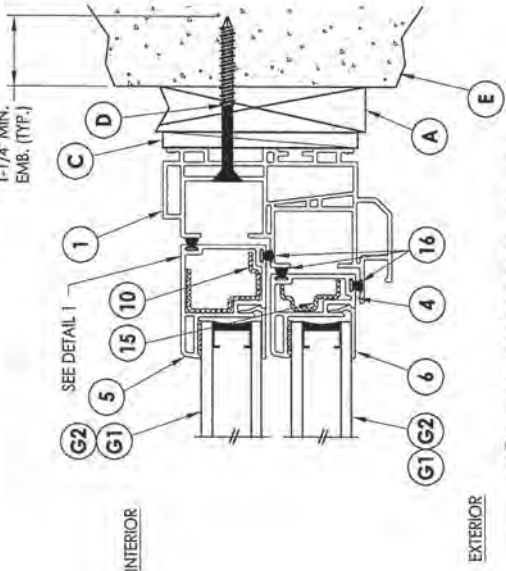

3 HORIZONTAL CROSS SECTION
2 Shown w/ 1X buck

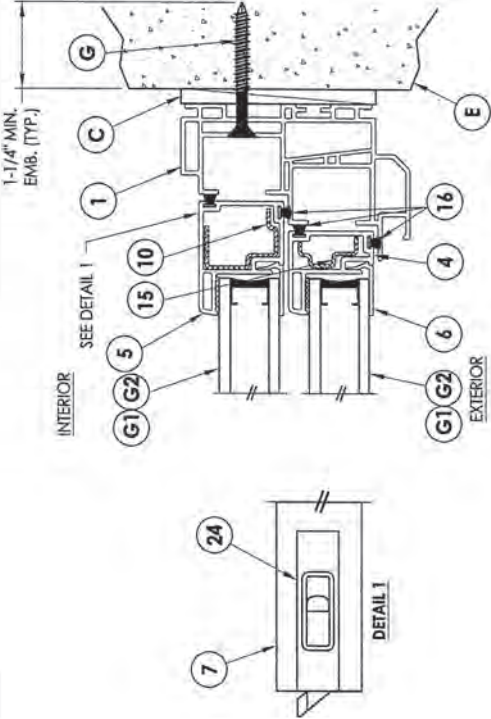

2 HORIZONTAL CROSS SECTION
2 Shown direct to masonry

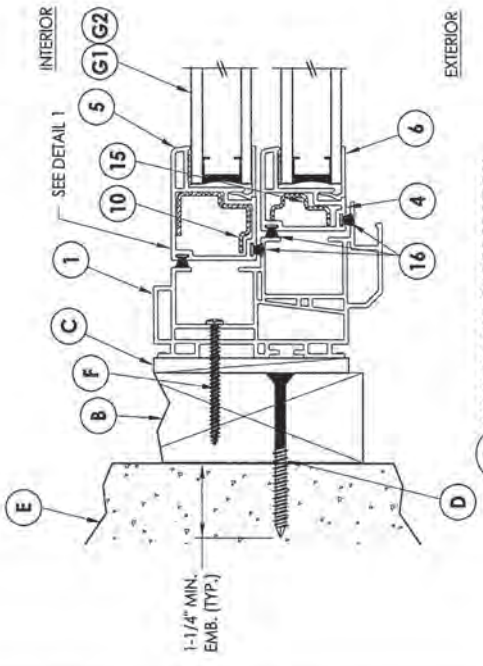

1 HORIZONTAL CROSS SECTION
2 Shown w/ 2X buck

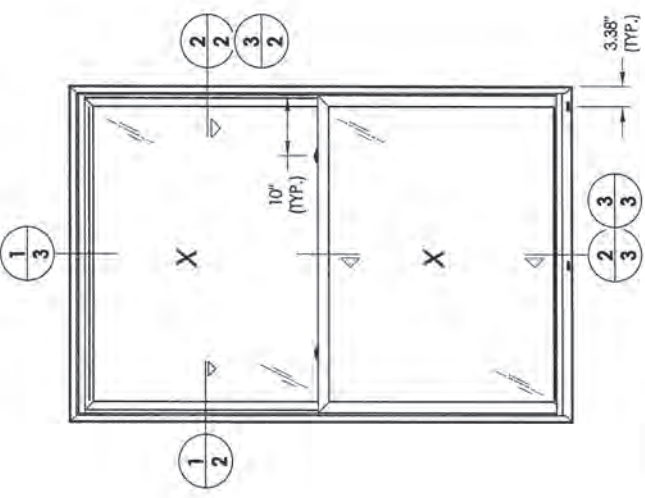

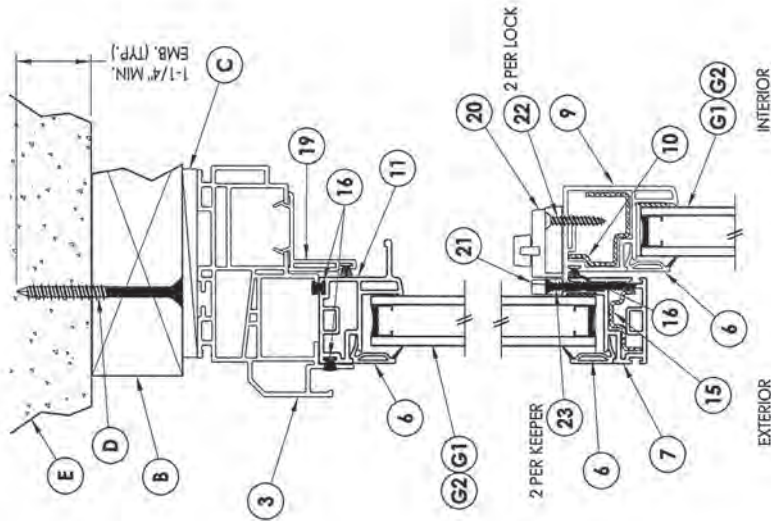

1 VERTICAL CROSS SECTION
3 Shown w/ 2X buck

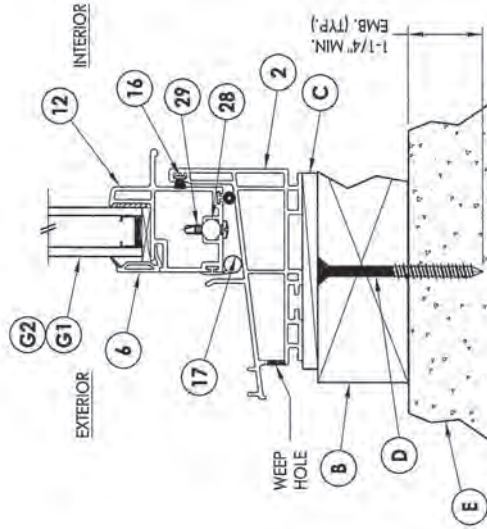

2 VERTICAL CROSS SECTION
3 Shown w/ 2X buck

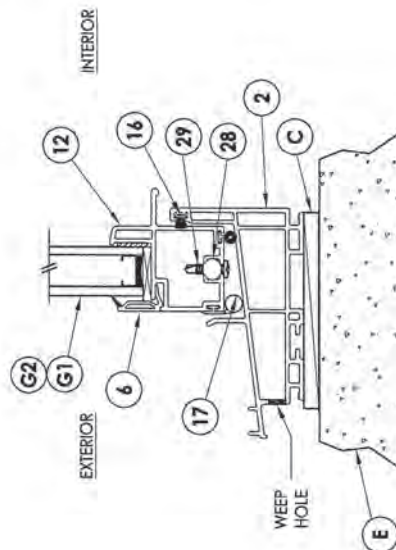

3 VERTICAL CROSS SECTION
3 Shown direct to masonry

NO.	DATE
1	8/25/14
2	1/27/15
3	5/10/16
4	6/01/17
5	7/02/20

REVISIONS
REVISED REINFORCEMENT
UPDATE TO 5TH ED. (2014) FBC
REVISED INSTALLATION SCREWS
UPDATE TO 6TH ED. (2017) FBC
UPDATE TO 7TH ED. (2020) FBC

PRODUCT:	7700 / 9900 SERIES
PART OR ASSEMBLY:	Vinyl Double Hung Window
CROSS SECTIONS	VERTICAL

Documents Prepared By: Lyndon F. Schmidt
P.E. No. 43409
July 6, 2020
L.F. SCHMIDT
FLORIDA
PROFESSIONAL ENGINEER
No. 43409
L.F. SCHMIDT
FLORIDA
PROFESSIONAL ENGINEER
No. 43409
BUILDING CONSULTANTS, INC.
P.O. Box 230, Vero Beach, FL 33595
Phone No.: 813.659.9197
FBPE Registry No. 9813

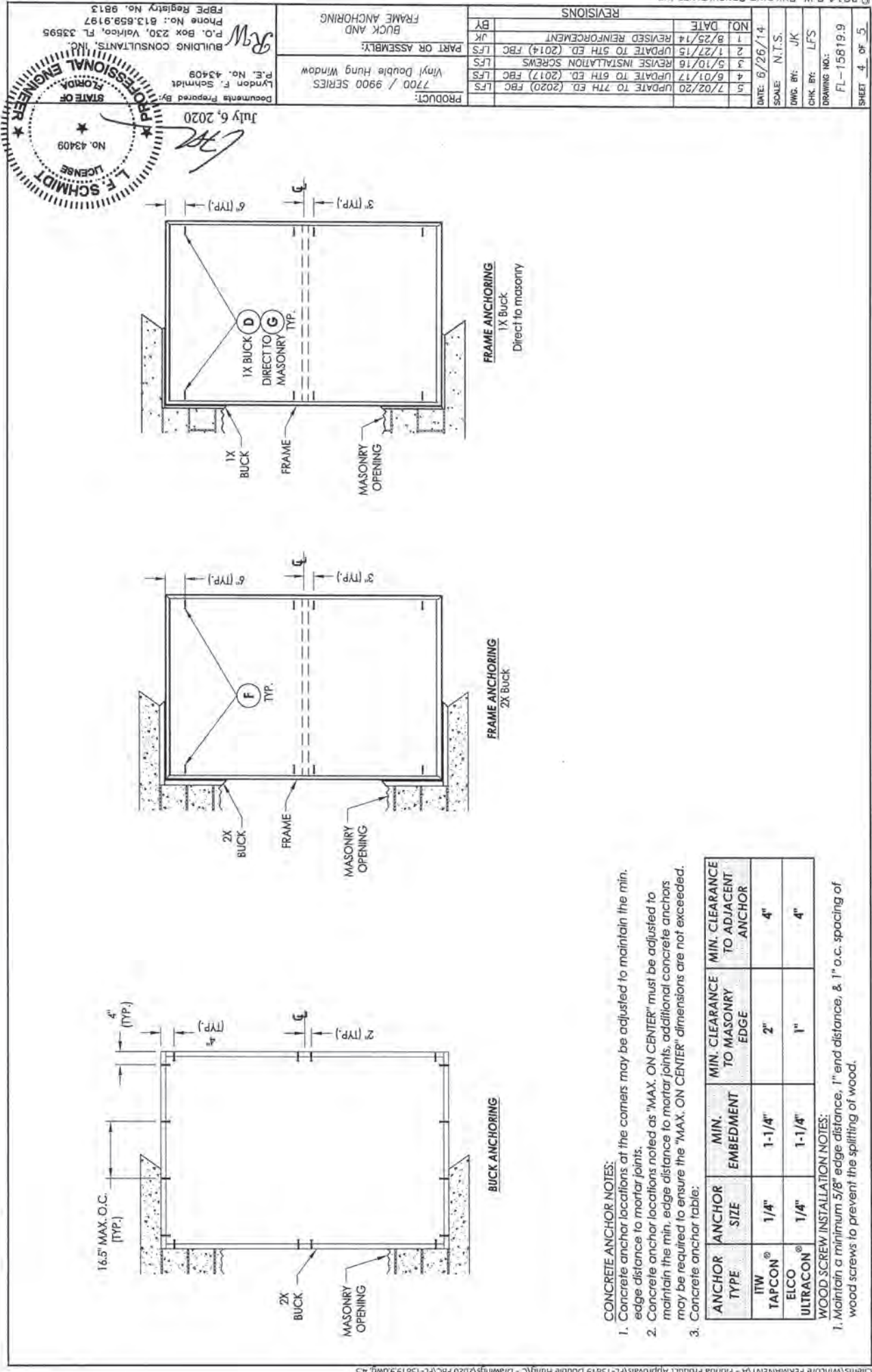

BILL OF MATERIALS		
ITEM #	DESCRIPTION	MATERIAL
A	1X BUCK SG >= 0.42	WOOD
B	2X BUCK SG >= 0.42	WOOD
C	1/4" MAX. SHIM SPACE	-
D	1/4" X 2-3/4" PHF ELCO OR ITW CONCRETE SCREW	STEEL
E	MASONRY - 3,000 PSI MIN. CONCRETE CONFORMING TO ACI 301 OR HOLLOW BLOCK CONFORMING TO ASTM C90	CONCRETE
F	#8 X 2" PAN HEAD/TRUSS HEAD WOOD SCREW [1-3/8" MIN. EMBEDMENT]	STEEL
G	1/4" X 2-1/4" PHF ELCO OR ITW CONCRETE SCREW	STEEL
1	FRAME JAMB* (DH 7701)	PVC
2	SILL* (DH 7703)	PVC
3	FRAME HEAD* (DH 7701)	PVC
4	UPPER SASH STILE* (SE 3035)	PVC
5	LOWER SASH STILE* (SE 3045)	PVC
6	GLAZING BEAD*	PVC
7	KEEPER RAIL UPPER SASH* (SE 3034)	PVC
9	LOCK RAIL LOWER SASH* (SE 3046)	PVC
10	REINFORCEMENT (RF 3101) [CS TYPE B HOT DIPPED GALV.]	STEEL
11	TOP RAIL UPPER SASH* (SE 3037)	PVC
12	BOTTOM RAIL LOWER SASH* (SE 3047)	PVC
15	REINFORCEMENT (RF 3001) [CS TYPE B HOT DIPPED GALV.]	STEEL
16	WEATHERSTRIP ULTRA FAB. 270 PILE - 270 - 1875B	-
17	WEATHERSTRIP SILBULB (AMESBURY 32690)	-
19	HEAD ADAPTER* (DH 3005)	PVC
20	LOCK 8513 / 8845 LAWRENCE	PVC
21	KEEPER 2700 - 214 LAWRENCE	PVC
22	#8 X 1" PHF (VINYL LOCK SCREWS)	STEEL
23	#6 X 1-1/2" PHF (VINYL LOCK SCREWS)	STEEL
24	TOP SASH TILT LATCH - ASHLAND	PVC
28	PIVOT BAR - CALDWELL	-
29	#8 X 1/2" SELF TAPPING PPH SMS	STEEL

* THE APPROVED WHITE RIGID PVC EXTERIOR EXTRUSIONS FOR WINDOWS ARE TO BE PRODUCED BY EXTRUDERS LICENSEES IN "AAMA CERTIFICATION PROGRAMS FOR RIGID PVC EXTRUSIONS".

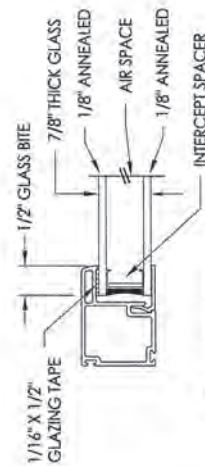

G1 GLAZING DETAIL
(See General Note 3, Sheet 1)

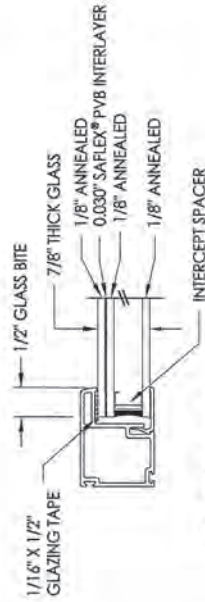

G2 GLAZING DETAIL
(See General Note 3, Sheet 1)

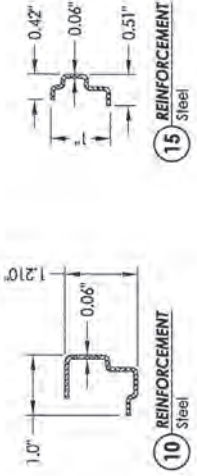
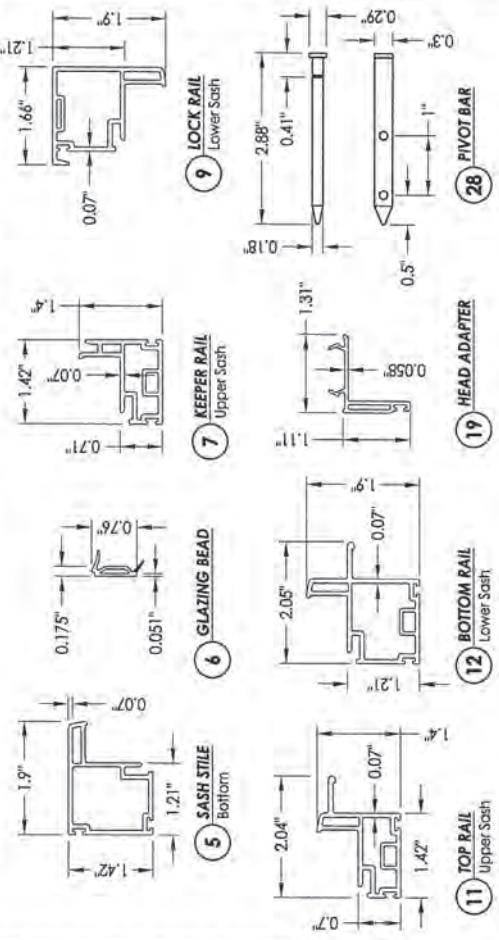
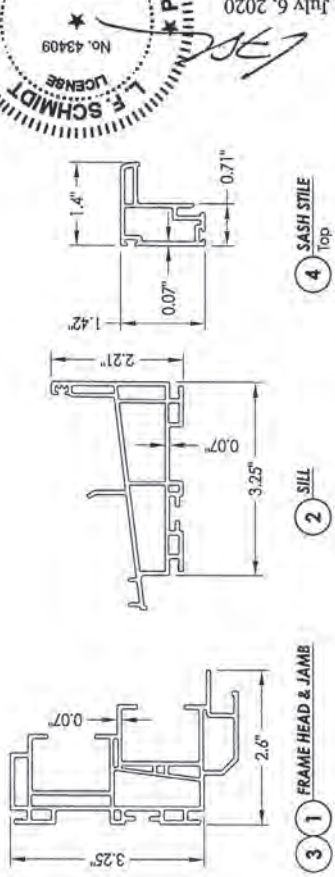

July 6, 2020
 Documents Prepared By: **L.F. SCHMIDT**
 Professional Engineer
 License No. 43409
 State of Florida
 P.O. Box 230, Vero Beach, FL 33595
 Phone No.: 813.659.9197
 FBPE Registry No. 9813

REVISIONS		DATE
1	REVISED REINFORCEMENT	8/25/14
2	UPDATE TO 5TH ED. (2014) FBC	1/27/15
3	REVISE INSTALLATION SCREWS	5/10/16
4	UPDATE TO 6TH ED. (2012) FBC	6/01/17
5	UPDATE TO 7TH ED. (2020) FBC	7/02/20
DATE: 6/26/14		
SCALE: N.T.S.		
DWG. BY: JK		
CHK. BY: LFS		
DRAWING NO.: FL-15819.9		
SHEET 5 of 5		

PRODUCT: 7700 / 9900 SERIES
 PART OR ASSEMBLY: Vinyl Double Hung Window
 BILL OF MATERIALS
 COMPONENTS & GLAZING DETAIL



Product Approval
USER: Public User

[Product Approval Menu](#) > [Product or Application Search](#) > **Application List**

► OFFICE OF THE
SECRETARY

Search Criteria

[Refine Search](#)

Code Version	2020	FL#	15816.13
Application Type	ALL	Product Manufacturer	ALL
Category	ALL	Subcategory	ALL
Application Status	ALL	Compliance Method	ALL
Quality Assurance Entity	ALL	Quality Assurance Entity Contract Expired	ALL
Product Model, Number or Name	ALL	Product Description	ALL
Approved for use in HVHZ	ALL	Approved for use outside HVHZ	ALL
Impact Resistant	ALL	Design Pressure	ALL
Other	ALL		

Search Results - Applications

FL#	Type	Manufacturer	Validated By	Status
FL15816-R10 History	Revision	Wincore Window Company, LLC FL#: FL15816.13 Model: m. 5400 / 5400S / 7700 / 8400 / 9900 Series Vinyl Fixed Window Description: Extruded PVC Fixed Window with "Non-Impact" Exterior Glazed Insulated Glass Category: Windows Subcategory: Fixed	Ryan J. King, P.E. (813) 767-6555	Approved

*Approved by DBPR. Approvals by DBPR shall be reviewed and ratified by the POC and/or the Commission if necessary.

[Contact Us](#) :: 2601 Blair Stone Road, Tallahassee FL 32399 Phone: 850-487-1824

The State of Florida is an AA/EEO employer. [Copyright 2007-2013 State of Florida](#). :: [Privacy Statement](#) :: [Accessibility Statement](#) :: [Refund Statement](#)

Under Florida law, email addresses are public records. If you do not want your e-mail address released in response to a public-records request, do not send electronic mail to this entity. Instead, contact the office by phone or by traditional mail. If you have any questions, please contact 850.487.1395. *Pursuant to Section 455.275(1), Florida Statutes, effective October 1, 2012, licensees licensed under Chapter 455, F.S. must provide the Department with an email address if they have one. The emails provided may be used for official communication with the licensee. However email addresses are public record. If you do not wish to supply a personal address, please provide the Department with an email address which can be made available to the public. To determine if you are a licensee under Chapter 455, F.S., please click [here](#).

Product Approval Accepts:





Product Approval
USER: Public User

[Product Approval Menu](#) > [Product or Application Search](#) > [Application List](#) > **Application Detail**

► OFFICE OF THE
SECRETARY

FL #	FL15816-R10																
Application Type	Revision																
Code Version	2020																
Application Status	Approved																
Comments																	
Archived	<input type="checkbox"/>																
Product Manufacturer	Wincore Window Company, LLC																
Address/Phone/Email	250 Staunton Avenue Parkersburg, WV 26104 (304) 485-7460 Ext 228 dgeorge@wincorewindows.com																
Authorized Signature	Vivian Wright rickw@rwbldgconsultants.com																
Technical Representative	Mike Reed																
Address/Phone/Email	250 Staunton Turnpike Parkersburg, WV 26104 (304) 485-7460 Ext 228 mreed@wincorewindows.com																
Quality Assurance Representative	Mike Reed																
Address/Phone/Email	250 Staunton Turnpike Parkersburg, WV 26104 (304) 485-7460 Ext 228 mreed@wincorewindows.com																
Category	Windows																
Subcategory	Fixed																
Compliance Method	Evaluation Report from a Florida Registered Architect or a Licensed Florida Professional Engineer <input type="checkbox"/> Evaluation Report - Hardcopy Received																
Florida Engineer or Architect Name who developed the Evaluation Report	Lyndon F. Schmidt, P.E.																
Florida License	PE-43409																
Quality Assurance Entity	National Accreditation and Management Institute																
Quality Assurance Contract Expiration Date	12/31/2021																
Validated By	Ryan J. King, P.E. <input checked="" type="checkbox"/> Validation Checklist - Hardcopy Received																
Certificate of Independence	FL15816_R10_COI_(c) Certificate of Independence.pdf																
Referenced Standard and Year (of Standard)	<table border="0"> <thead> <tr> <th><u>Standard</u></th> <th><u>Year</u></th> </tr> </thead> <tbody> <tr> <td>AAMA/WDMA/CSA101/I.S.2/A440</td> <td>2008</td> </tr> <tr> <td>AAMA/WDMA/CSA101/I.S.2/A440</td> <td>2005</td> </tr> <tr> <td>AAMA/WDMA/CSA101/I.S.2/A440</td> <td>2011</td> </tr> <tr> <td>ASTM E1300</td> <td>2004</td> </tr> <tr> <td>ASTM E1886</td> <td>2005</td> </tr> <tr> <td>ASTM E1886</td> <td>2013</td> </tr> <tr> <td>ASTM E1996</td> <td>2014</td> </tr> </tbody> </table>	<u>Standard</u>	<u>Year</u>	AAMA/WDMA/CSA101/I.S.2/A440	2008	AAMA/WDMA/CSA101/I.S.2/A440	2005	AAMA/WDMA/CSA101/I.S.2/A440	2011	ASTM E1300	2004	ASTM E1886	2005	ASTM E1886	2013	ASTM E1996	2014
<u>Standard</u>	<u>Year</u>																
AAMA/WDMA/CSA101/I.S.2/A440	2008																
AAMA/WDMA/CSA101/I.S.2/A440	2005																
AAMA/WDMA/CSA101/I.S.2/A440	2011																
ASTM E1300	2004																
ASTM E1886	2005																
ASTM E1886	2013																
ASTM E1996	2014																

ASTM E1996	2006
ASTM E1996	2009
TAS 201, 202, 203	1994

Equivalence of Product Standards
Certified By

Florida Licensed Professional Engineer or Architect
[FL15816_R10_Equiv_of_Standards_\(f\).pdf](#)

Sections from the Code

Product Approval Method

Method 1 Option D

Date Submitted

07/07/2020

Date Validated

07/12/2020

Date Pending FBC Approval

07/20/2020

Date Approved

10/13/2020

Summary of Products

FL #	Model, Number or Name	Description
15816.1	a. 8400 Series Vinyl Fixed Window	Extruded PVC Fixed Window with "Non-Impact" Insulated Glass
Limits of Use Approved for use in HVHZ: No Approved for use outside HVHZ: Yes Impact Resistant: No Design Pressure: N/A Other: See INST 15816.1 for Design Pressure Ratings, any additional use limitations, installation instructions and product particulars.		Installation Instructions FL15816_R10_IL_(f)_Inst 15816.1.pdf Verified By: Lyndon F. Schmidt, P.E. 43409 Created by Independent Third Party: Yes Evaluation Reports FL15816_R10_AE_(f)_Eval 15816.1.pdf Created by Independent Third Party: Yes
15816.2	b. 8800 Series Vinyl Fixed Window	Extruded PVC Fixed Window with "Impact" Insulated Glass
Limits of Use Approved for use in HVHZ: No Approved for use outside HVHZ: Yes Impact Resistant: Yes Design Pressure: N/A Other: See INST 15816.2 for Design Pressure Ratings, any additional use limitations, installation instructions and product particulars.		Installation Instructions FL15816_R10_IL_(f)_Inst 15816.2.pdf Verified By: Lyndon F. Schmidt, P.E. 43409 Created by Independent Third Party: Yes Evaluation Reports FL15816_R10_AE_(f)_Eval 15816.2.pdf Created by Independent Third Party: Yes
15816.3	c. 8800 Series Vinyl Fixed Window	Extruded PVC Fixed Window with "Impact" Insulated Glass - (Geometric Shape Configurations)
Limits of Use Approved for use in HVHZ: No Approved for use outside HVHZ: Yes Impact Resistant: Yes Design Pressure: N/A Other: See INST 15816.3 for Design Pressure Ratings, any additional use limitations, installation instructions and product particulars.		Installation Instructions FL15816_R10_IL_(f)_Inst 15816.3.pdf Verified By: Lyndon F. Schmidt, P.E. 43409 Created by Independent Third Party: Yes Evaluation Reports FL15816_R10_AE_(f)_Eval 15816.3.pdf Created by Independent Third Party: Yes
15816.4	d. 8800 Series Vinyl Fixed Window	Extruded PVC Fixed Window with "Impact" Insulated Glass
Limits of Use Approved for use in HVHZ: Yes Approved for use outside HVHZ: Yes Impact Resistant: Yes Design Pressure: N/A Other: See INST 15816.4 for Design Pressure Ratings, any additional use limitations, installation instructions and product particulars.		Installation Instructions FL15816_R10_IL_(f)_Inst 15816.4.pdf Verified By: Lyndon F. Schmidt, P.E. 43409 Created by Independent Third Party: Yes Evaluation Reports FL15816_R10_AE_(f)_Eval 15816.4.pdf Created by Independent Third Party: Yes
15816.5	e. 8800 Series Vinyl Fixed Window	Extruded PVC Fixed Window with "Impact" Insulated Glass - (Geometric Shape Configurations)
Limits of Use Approved for use in HVHZ: Yes Approved for use outside HVHZ: Yes Impact Resistant: Yes Design Pressure: N/A Other: See INST 15816.5 for Design Pressure Ratings, any		Installation Instructions FL15816_R10_IL_(f)_Inst 15816.5.pdf Verified By: Lyndon F. Schmidt, P.E. 43409 Created by Independent Third Party: Yes Evaluation Reports FL15816_R10_AE_(f)_Eval 15816.5.pdf Created by Independent Third Party: Yes

additional use limitations, installation instructions and product particulars.		
15816.6	f. 7700 / 9900 Series Vinyl Fixed Window	Extruded PVC Fixed Window with "Non-Impact" Insulated Glass
Limits of Use Approved for use in HVHZ: No Approved for use outside HVHZ: Yes Impact Resistant: No Design Pressure: N/A Other: See INST 15816.6 for Design Pressure Ratings, any additional use limitations, installation instructions and product particulars.		Installation Instructions FL15816_R10_IL (f) Inst 15816.6.pdf Verified By: Lyndon F. Schmidt, P.E. 43409 Created by Independent Third Party: Yes Evaluation Reports FL15816_R10_AE (f) Eval 15816.6.pdf Created by Independent Third Party: Yes
15816.7	g. 400 / 500 Series Vinyl Fixed Window	Extruded PVC Fixed Window with Nailing Fin "Non-Impact" Insulated Glass
Limits of Use Approved for use in HVHZ: No Approved for use outside HVHZ: Yes Impact Resistant: No Design Pressure: N/A Other: See INST 15816.7 for Design Pressure Ratings, any additional use limitations, installation instructions and product particulars.		Installation Instructions FL15816_R10_IL (f) Inst 15816.7.pdf Verified By: Lyndon F. Schmidt, P.E. 43409 Created by Independent Third Party: Yes Evaluation Reports FL15816_R10_AE (f) Eval 15816.7.pdf Created by Independent Third Party: Yes
15816.8	h. 5400 / 5400S Series Vinyl Fixed Window	Extruded PVC Fixed Window with "Non-Impact" Insulated Glass
Limits of Use Approved for use in HVHZ: No Approved for use outside HVHZ: Yes Impact Resistant: No Design Pressure: N/A Other: See INST 15816.8 for Design Pressure Ratings, any additional use limitations, installation instructions and product particulars.		Installation Instructions FL15816_R10_IL (f) Inst 15816.8.pdf Verified By: Lyndon F. Schmidt, P.E. 43409 Created by Independent Third Party: Yes Evaluation Reports FL15816_R10_AE (f) Eval 15816.8.pdf Created by Independent Third Party: Yes
15816.9	i. 5400 / 5400S / 7700 / 9900 Series Vinyl Fixed (Transom) Window	Extruded PVC Fixed (Transom) Window with "Non-Impact" Insulated Glass
Limits of Use Approved for use in HVHZ: No Approved for use outside HVHZ: Yes Impact Resistant: No Design Pressure: N/A Other: See INST 15816.9 for Design Pressure Ratings, any additional use limitations, installation instructions and product particulars.		Installation Instructions FL15816_R10_IL (f) Inst 15816.9.pdf Verified By: Lyndon F. Schmidt, P.E. 43409 Created by Independent Third Party: Yes Evaluation Reports FL15816_R10_AE (f) Eval 15816.9.pdf Created by Independent Third Party: Yes
15816.10	j. 5400 / 5400S / 7700 / 9900 Series Vinyl Fixed (Casement) Window	Extruded PVC Fixed (Casement) Window with "Non-Impact" Insulated Glass
Limits of Use Approved for use in HVHZ: No Approved for use outside HVHZ: Yes Impact Resistant: No Design Pressure: N/A Other: See INST 15816.10 for Design Pressure Ratings, any additional use limitations, installation instructions and product particulars.		Installation Instructions FL15816_R10_IL (f) Inst 15816.10.pdf Verified By: Lyndon F. Schmidt, P.E. 43409 Created by Independent Third Party: Yes Evaluation Reports FL15816_R10_AE (f) Eval 15816.10.pdf Created by Independent Third Party: Yes
15816.11	k. 400 / 500 Series Vinyl Fixed (Sidelite) Window	Extruded PVC Fixed (Sidelite) Window with "Non-Impact" Insulated Glass
Limits of Use Approved for use in HVHZ: No Approved for use outside HVHZ: Yes Impact Resistant: No Design Pressure: N/A Other: See INST 15816.11 for Design Pressure Ratings, any additional use limitations, installation instructions and product particulars.		Installation Instructions FL15816_R10_IL (f) Inst 15816.11.pdf Verified By: Lyndon F. Schmidt, P.E. 43409 Created by Independent Third Party: Yes Evaluation Reports FL15816_R10_AE (f) Eval 15816.11.pdf Created by Independent Third Party: Yes
15816.12	l. 5400 / 5400S / 7700 / 9900 Series Vinyl Fixed (Sidelite) Window	Extruded PVC Fixed (Sidelite) Window with "Non-Impact" Insulated Glass
Limits of Use Approved for use in HVHZ: No Approved for use outside HVHZ: Yes Impact Resistant: No Design Pressure: N/A Other: See INST 15816.12 for Design Pressure Ratings, any		Installation Instructions FL15816_R10_IL (f) Inst 15816.12.pdf Verified By: Lyndon F. Schmidt, P.E. 43409 Created by Independent Third Party: Yes Evaluation Reports

additional use limitations, installation instructions and product particulars.		FL15816_R10_AE_(f)_Eval 15816.12.pdf Created by Independent Third Party: Yes
15816.13	m. 5400 / 5400S / 7700 / 8400 / 9900 Series Vinyl Fixed Window	Extruded PVC Fixed Window with "Non-Impact" Exterior Glazed Insulated Glass
Limits of Use Approved for use in HVHZ: No Approved for use outside HVHZ: Yes Impact Resistant: No Design Pressure: N/A Other: See INST 15816.13 for Design Pressure Ratings, any additional use limitations, installation instructions and product particulars.		Installation Instructions FL15816_R10_IL_(f)_Inst 15816.13.pdf Verified By: Lyndon F. Schmidt, P.E. 43409 Created by Independent Third Party: Yes Evaluation Reports FL15816_R10_AE_(f)_Eval 15816.13.pdf Created by Independent Third Party: Yes
15816.14	n. 8800 Series Vinyl Fixed Window	Extruded PVC Fixed Window with "Impact" Exterior Glazed Insulated Glass
Limits of Use Approved for use in HVHZ: No Approved for use outside HVHZ: Yes Impact Resistant: Yes Design Pressure: N/A Other: See INST 15816.14 for Design Pressure Ratings, any additional use limitations, installation instructions and product particulars.		Installation Instructions FL15816_R10_IL_(g)_Inst 15816.14.pdf Verified By: Lyndon F. Schmidt, P.E. 43409 Created by Independent Third Party: Yes Evaluation Reports FL15816_R10_AE_(g)_Eval 15816.14.pdf Created by Independent Third Party: Yes
15816.15	o. 8800 Series Vinyl Fixed Window	Extruded PVC Fixed Window with "Impact" Exterior Glazed Insulated Glass
Limits of Use Approved for use in HVHZ: Yes Approved for use outside HVHZ: Yes Impact Resistant: Yes Design Pressure: N/A Other: See INST 15816.15 for Design Pressure Ratings, any additional use limitations, installation instructions and product particulars.		Installation Instructions FL15816_R10_IL_(f)_Inst 15816.15.pdf Verified By: Lyndon F. Schmidt, P.E. 43409 Created by Independent Third Party: Yes Evaluation Reports FL15816_R10_AE_(f)_Eval 15816.15.pdf Created by Independent Third Party: Yes
15816.16	p. 8800 Series Vinyl Fixed Window	Extruded PVC Fixed Window with "Impact" Exterior Glazed Insulated Glass - (Geometric Shape Configurations)
Limits of Use Approved for use in HVHZ: Yes Approved for use outside HVHZ: Yes Impact Resistant: Yes Design Pressure: N/A Other: See INST 15816.16 for Design Pressure Ratings, any additional use limitations, installation instructions and product particulars.		Installation Instructions FL15816_R10_IL_(f)_Inst 15816.16.pdf Verified By: Lyndon F. Schmidt, P.E. 43409 Created by Independent Third Party: Yes Evaluation Reports FL15816_R10_AE_(f)_Eval 15816.16.pdf Created by Independent Third Party: Yes

[Back](#) [Next](#)

[Contact Us](#) :: [2601 Blair Stone Road, Tallahassee FL 32399](#) Phone: 850-487-1824

The State of Florida is an AA/EEO employer. [Copyright 2007-2013 State of Florida](#). :: [Privacy Statement](#) :: [Accessibility Statement](#) :: [Refund Statement](#)

Under Florida law, email addresses are public records. If you do not want your e-mail address released in response to a public-records request, do not send electronic mail to this entity. Instead, contact the office by phone or by traditional mail. If you have any questions, please contact 850.487.1395. *Pursuant to Section 455.275(1), Florida Statutes, effective October 1, 2012, licensees licensed under Chapter 455, F.S. must provide the Department with an email address if they have one. The emails provided may be used for official communication with the licensee. However email addresses are public record. If you do not wish to supply a personal address, please provide the Department with an email address which can be made available to the public. To determine if you are a licensee under Chapter 455, F.S., please click [here](#).

Product Approval Accepts:



1

2

2

2

2

1

2

2

2

2

1

2

2

2

2

1

2

2

2

2

1

2

2

2

2

1

2

2

2

2

1

2

2

2

2

1

2

2

2

2

1

2

2

2

2

1

2

2

2

2

1

2

2

2

2

1

2

2

2

2

1

2

2

2

2

1

2

2

2

2

1

2

2

2

2

1

2

2

2

2

1

2

2

2

2

1

2

2

2

2

1

2

2

2

2

1

2

2

2

2

1

2

2

2

2

1

2

2

2

2

1

2

2

2

2

1

2

2

2

2

1

2

2

2

2

1

2

2

2

2

1

2

2

2

2

1

2

2

2

2

1

2

2

2

2

1

2

2

2

2

1

2

2

2

2

1

2

2

2

2

1

2

2

2

2

1

2

2

2

2

1

2

2

2

2

1

2

2

2

2

1

2

2

2

2

1

2

2

2

2

1

2

2

2

2

1

2

2

2

2

1

2

2

2

2

1

2

2

2

2

1

2

2

2

2

1

2

2

2

2

1

2

2

2

2

1

2

2

2

2

1

2

2

2

2

1

2

2

2

2

1

2

2

2

2

1

2

2

2

2

1

2

2

2

2

1

2

2

2

2

1

2

2

2

2

1

2

2

2

2

1

2

2

2

2

1

2

2

2

2

1

2

2

2

2

1

2

2

2

2

1

2

2

2

2

1

2

2

2

2

1

2

2

2

2

1

2

2

2

2

1

2

2

2

2

1

2

2

2

2

1

2

2

2

2

1

2

2

2

2

1

2

2

2

2

1

2

2

2

2

1

2

2

2

2

1

2

2

2

2

1

2

2

2

2

1

2

2

2

2

1

2

2

2

2

1

2

2

2

2

1

2

2

2

2

1

2

2

2

2

1

2

2

2

2

1

2

2

2

2

1

2

2

2

2

1

2

2

2

2

1

2

2

2

2

1

2

2

2

2

1

2

2

2

2

1

2

2

2

2

1

2

2

2

2

1

2

2

2

2

1

2

2

2

2

1

2

2

2

2

1

2

2

2

2

1

2

2

2

2

1

2

2

2

2

1

2

2

2

2

1

2

2

2

2

1

2

2

2

2

1

2

2

2

2

1

2

2

2

2

1

2

2

2

2

1

2

2

2

2

1

2

2

2

2

1

2

2

2

2

1

2

2

2

2

1

2

2

2

2

1

2

2

2

2

1

2

2

2

2

1

2

2

2

2

1

2

2

2

2

Building Consultants, Inc.
 P.O. Box 230, Venice, FL 33595
 Phone No.: 813.659.9197
 FBPE Registry No. 9813

L.F. SCHMIDT
 LICENSE
 No. 43409
 STATE OF FLORIDA
 PROFESSIONAL ENGINEER

Documents Prepared By: Landon F. Schmidt
 E.N. No. 43409
 July 6, 2020

MAX. DESIGN PRESSURE = ± 50 PSF

- CONCRETE ANCHOR NOTES:**
 1. Concrete anchor locations at the corners may be adjusted to maintain the min. edge distance to molar joints.
 2. Concrete anchor locations noted as "MAX. ON CENTER" must be adjusted to maintain the min. edge distance to molar joints, additional concrete anchors may be required to ensure the "MAX. ON CENTER" dimension are not exceeded.
 3. Concrete anchor table:

ANCHOR TYPE	ANCHOR SIZE	MIN. EMBEDMENT	MIN. CLEARANCE TO MASONRY EDGE	MIN. CLEARANCE TO ADJACENT ANCHOR
ITW TAPCON®	1/4"	1-1/4"	2"	4"
ELCO ULTRACON®	1/4"	1-1/4"	1"	4"

WOOD SCREW INSTALLATION NOTES:

1. Maintain a minimum 5/8" edge distance, 1" end distance, & 1" o.c. spacing of wood screws to prevent the splitting of wood.



CONCRETE ANCHOR NOTES:

1. Concrete anchor locations at the corners may be adjusted to maintain the min. edge distance to mortar joints.
2. Concrete anchor locations noted as "MAX. ON CENTER" must be adjusted to maintain the min. edge distance to mortar joints, additional concrete anchors may be required to ensure the "MAX. ON CENTER" dimension are not exceeded.
3. Concrete anchor table:

ANCHOR TYPE	ANCHOR SIZE	MIN. EMBEDMENT	MIN. CLEARANCE TO MASONRY EDGE	MIN. CLEARANCE TO ADJACENT ANCHOR
ITW TAPCON®	1/4"	1-1/4"	2"	4"
ELCO ULTRACON®	1/4"	1-1/4"	1"	4"

WOOD SCREW INSTALLATION NOTES:
 . Maintain a minimum 5/8" edge distance, 1" end distance, & 1" o.c. spacing of wood screws to prevent the splitting of wood.

PROFESSIONAL ENGINEER STATE OF FLORIDA L.F. SCHMIDT LICENSE No. 43408 July 6, 2020		Documents Prepared By: Lyndon F. Schmidt P.E. No. 43408 BUILDING CONSULTANTS, INC. P.O. Box 230, Vero Beach, FL 33595 Phone No.: 813.659.9197 FBPE Registry No. 9813	
PRODUCT: 5400/5400S/7700/8400/9900 SERIES VINYL FIXED WINDOW PART OR ASSEMBLY:		REVISIONS NO. DATE 1 7/06/20 UPDATE TO 7TH ED. (2020) FBC LFS BY	
5400/5400S/7700/8400/9900 SERIES VINYL FIXED WINDOW PART OR ASSEMBLY:		REVISIONS NO. DATE 1 7/06/20 UPDATE TO 7TH ED. (2020) FBC LFS BY	

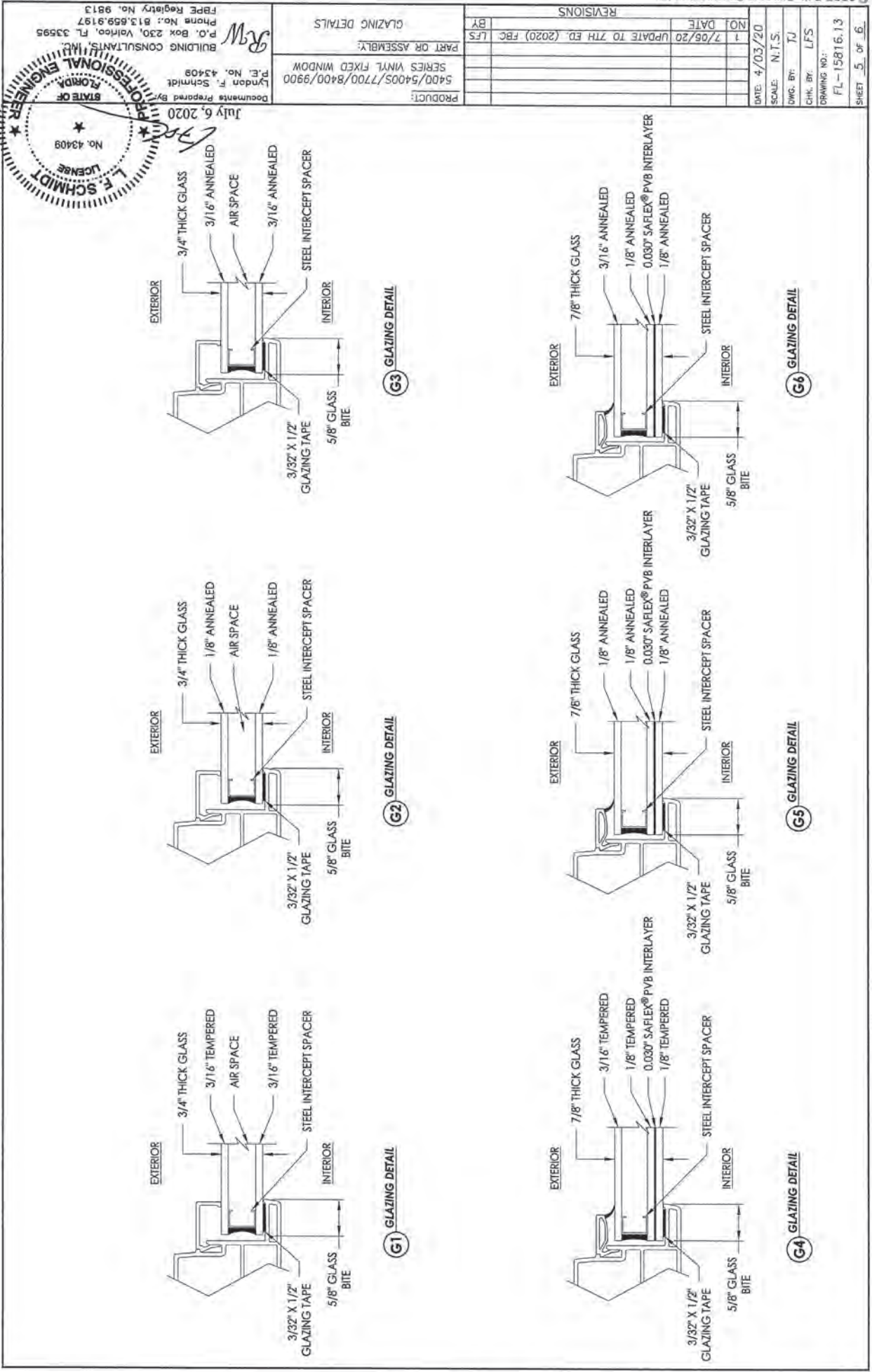

July 6, 2020
L.F. SCHMIDT
No. 43409
FLORIDA
PROFESSIONAL ENGINEER
BUILDING CONSULTANTS, INC.
P.O. Box 230, Volusia, FL 32955
Phone No.: 813.659.9197
FPE Registry No. 9813

PRODUCT: 5400/5400S/7700/8400/9900
SERIES VINYL FIXED WINDOW
PART OR ASSEMBLY:
CLAZING DETAILS

REVISIONS	
NO.	DATE
1	7/06/20
UPDATE TO 7TH ED. (2020) FBC LFS	
BY	

DATE: 4/03/20
SCALE: N.T.S.
DWG. BY: TJ
CHK. BY: LFS
DRAWING NO.: FL-15816.13
SHEET 5 OF 6

BILL OF MATERIALS		
ITEM #	DESCRIPTION	MATERIAL
A	1X BUCK (SG >= 0.42)	WOOD
B	2X BUCK (SG >= 0.42)	WOOD
C	1/4" MAX. SHIM SPACE	
D	1/4" X 2-3/4" PH ELCO OR ITW CONCRETE SCREW	STEEL
E	MASONRY - 3,000 PSI MIN. CONCRETE CONFORMING TO ACI 301 OR HOLLOW BLOCK CONFORMING TO ASTM C90	CONCRETE
F	#10 X 2" MODIFIED TRUSS HEAD (7/16" Ø) SMS (1-5/16" MIN. EMBEDMENT)	STEEL
G	1/4" X 3-1/4" HWH ELCO OR ITW CONCRETE SCREW	STEEL
H	1/4" X 2-3/4" HWH ELCO OR ITW CONCRETE SCREW	STEEL
I	FRAME (PE77018)*	PVC
2	3/4" GLAZING BEAD (BV56WH)*	PVC
3	7/8" GLAZING BEAD (BV62WH)*	PVC

* THE APPROVED WHITE RIGID PVC EXTERIOR EXTRUSIONS FOR WINDOWS ARE TO BE PRODUCED BY EXTRUDERS LICENSEES IN "AAMA CERTIFICATION PROGRAMS FOR RIGID PVC EXTRUSIONS".

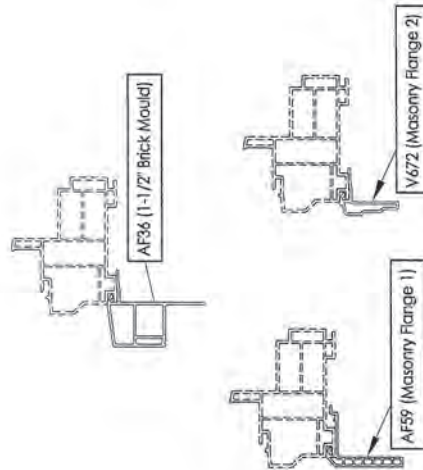

OPTIONAL COSMETIC FLANGES

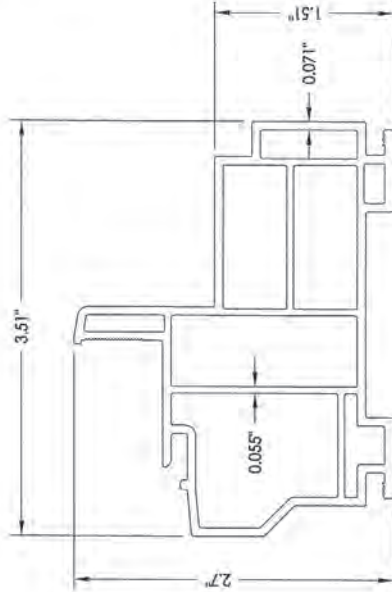

1 FRAME

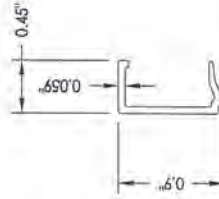

2 GLAZING BEAD

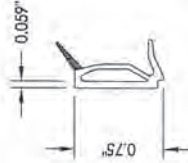

3 GLAZING BEAD

DATE: 4/03/20
SCALE: N.T.S.
DWG. BY: TJ
CHK. BY: LFS
DRAWING NO.: FL-15816.13
SHEET 6 OF 6

REVISIONS

NO.	DATE	DESCRIPTION
1	7/06/20	UPDATE TO 7TH ED. (2020) FBC

PRODUCT: 5400/5400S/7700/8400/9900
SERIES VINYL FIXED WINDOW
PART OR ASSEMBLY:
BILL OF MATERIALS AND COMPONENTS

Documents Prepared By: Lyndon F. Schmidt
P.E. No. 43409
July 6, 2020

BUILDING CONSULTANTS, INC.
P.O. Box 230, Vero Beach, FL 33595
Phone No.: 813.659.8197
FBPE Registry No. 9813

STATE OF FLORIDA
L.F. SCHMIDT
No. 43409
LICENSE
PROFESSIONAL ENGINEER