

FW



STATE OF FLORIDA
DEPARTMENT OF ENVIRONMENTAL PROTECTION
ON-SITE SEWAGE TREATMENT AND DISPOSAL
SYSTEM (OSTDS)

PERMIT NO. 23-0118
DATE PAID: 2/13/23
FEE PAID: 40.05
RECEIPT #: 1932800

APPLICATION FOR CONSTRUCTION PERMIT

APPLICATION FOR:

[] New System [☒] Existing System [] Holding Tank [] Innovative
[] Repair [] Abandonment [] Temporary []

APPLICANT: Matthew Walters EMAIL: sgtwalters774@gmail.com

AGENT: — TELEPHONE: 954-249-0067

MAILING ADDRESS: 1139 SE Adams St. High Springs, FL. 32643

TO BE COMPLETED BY APPLICANT OR APPLICANT'S AUTHORIZED AGENT. SYSTEMS MUST BE CONSTRUCTED BY A PERSON LICENSED PURSUANT TO 489.105(3) (m) OR 489.552, FLORIDA STATUTES. IT IS THE APPLICANT'S RESPONSIBILITY TO PROVIDE DOCUMENTATION OF THE DATE THE LOT WAS CREATED OR PLATTED (MM/DD/YY) IF REQUESTING CONSIDERATION OF STATUTORY GRANDFATHER PROVISIONS.

PROPERTY INFORMATION

OSTDS REMEDIATION PLAN? [Y / ☒ N]

LOT: 5 BLOCK: — SUBDIVISION: Bicentennial Acres U1 PLATTED: —

PROPERTY ID #: 11-75-17-0983-022 ZONING: — I/M OR EQUIVALENT: [Y / ☒ N]

PROPERTY SIZE: 5 ACRES WATER SUPPLY: [☒] PRIVATE PUBLIC [] ☐ ≤2000GPD [] ☐ >2000GPD

IS SEWER AVAILABLE AS PER 381.0065, FS? [Y / N] DISTANCE TO SEWER: — FT

PROPERTY ADDRESS: 1139 SE Adams St. High Springs, FL. 32643

DIRECTIONS TO PROPERTY: 441 Hwy & SE Adams St. - 1 mile East on SE Adams St.
to property - property on N. side of roadway.

BUILDING INFORMATION

☒ RESIDENTIAL [] COMMERCIAL

Unit Type of No. of Building Commercial/Institutional System Design
No. Establishment Bedrooms Area Sqft Table I, Chapter 62-6, FAC

| | | | | |
|---|----------------|---|------|-------------------|
| 1 | Storage Bldg | 0 | 448 | ORIGINAL ATTACHED |
| 2 | Garage-Carport | 0 | 1350 | |
| 3 | | | | |
| 4 | | | | |

[] Floor/Equipment Drains [] Other (Specify) N/A.

SIGNATURE: [Signature] DATE: 02-10-23

DEP 4015, 06-21-2022 (Obsoletes previous editions which may not be used)

Incorporated 62-6.004, FAC

Page 1 of 4

STATE OF FLORIDA
DEPARTMENT OF ENVIRONMENTAL PROTECTION
APPLICATION FOR CONSTRUCTION PERMIT

Permit Application Number 23-0118

..... PART II - SITEPLAN

Scale: Each block represents 10 feet and 1 inch = 40 feet.

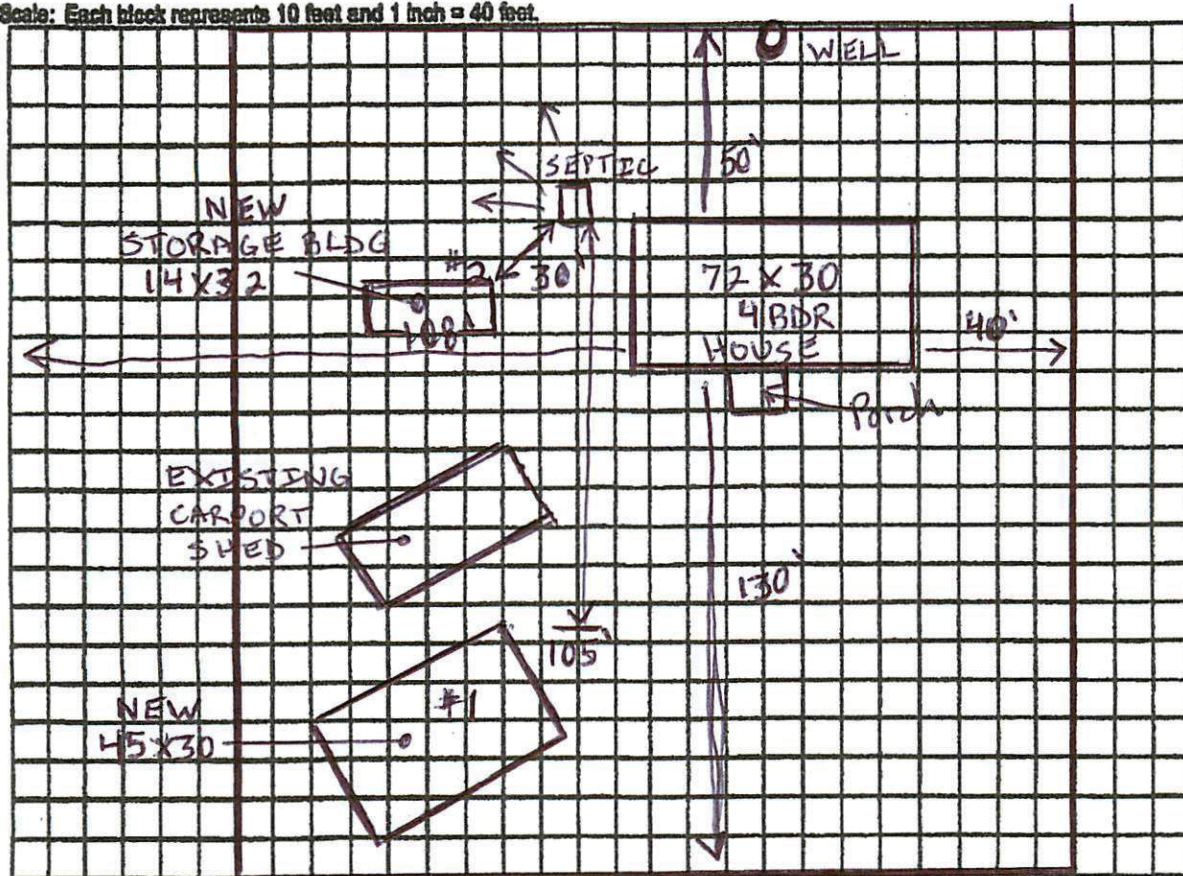

Notes:

1 AC of 5

- 1 - New 45x30 Metal Garage/Carport - Concrete Slab
- 2 - New Pre-built wood Storage building - 14x32 - Concrete Slab

Site Plan submitted by: Matthew Walters

Plan Approved ☒

Not Approved ☐

Date 2/13/23

By [Signature]

County Health Department

ALL CHANGES MUST BE APPROVED BY THE COUNTY HEALTH DEPARTMENT

DEP 4015, 06-21-2022 (Obsoletes previous editions which may not be used)

Incorporated: 62-6.004, F.A.C.

Page 2 of 4

