

REVISIONS

SUWANNEE VALLEY RESORT



AQUATAN POOLS
OF
FLORIDA INC.

CRAIG PERKINS
561 248 0299

TITLE
SUWANNEE VALLEY RESORT

DESCRIPTION
786 NW STEVEN FOSTER DRIVE
WHITE SPRINGS, FL. 32096

Scale: 1 in = 20ft. 0in.

PAGE 1 OF 6
DATE 2/4/2012

PROPERTY LINE

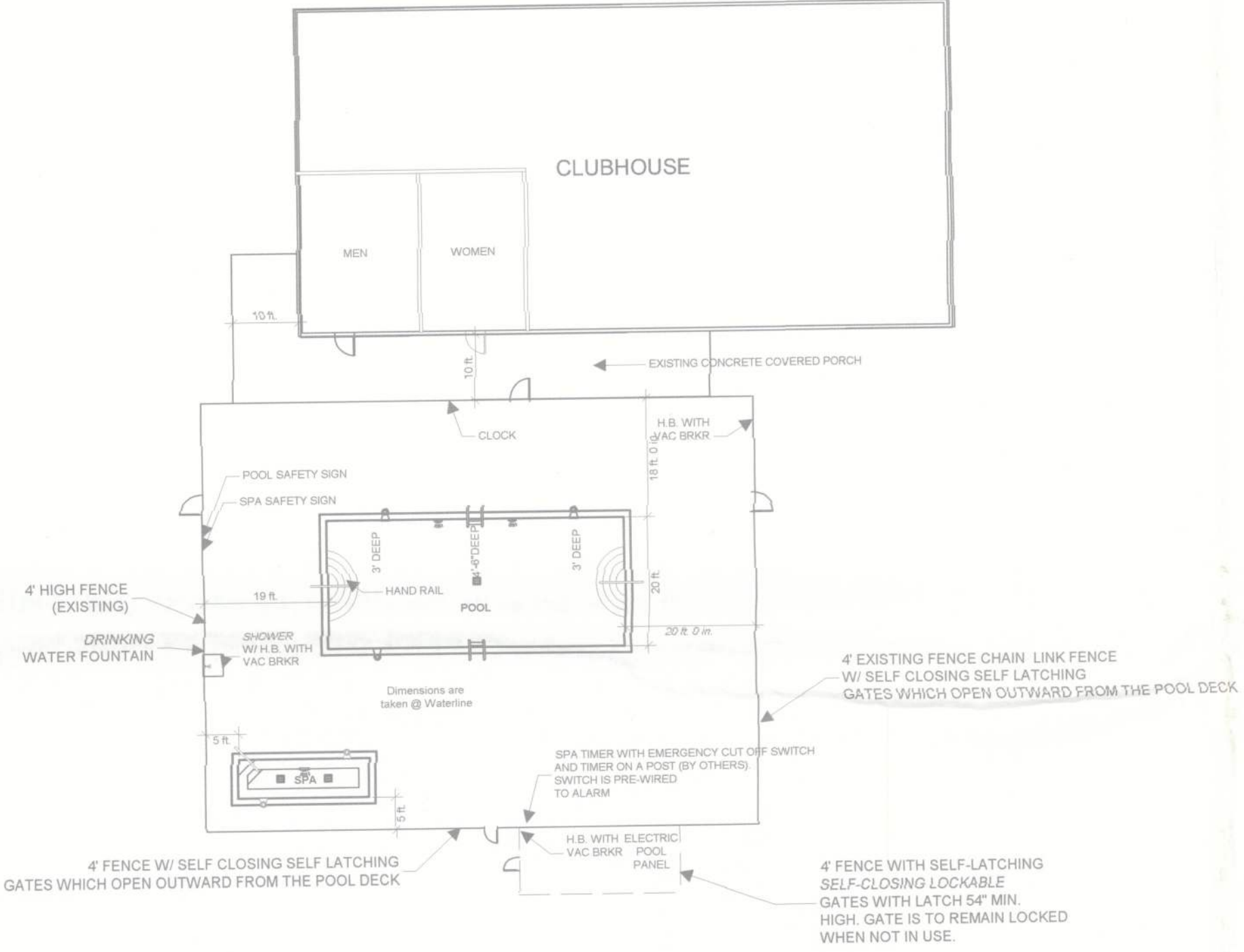

PROVISOS:

- Pool**
- 64E-9.007(8) Ensure the main drain used is the six inch line shown on the pool plumbing drawing and not the 4 inch shown in the equipment drawing.
 - 64E-9.006(1)(c)1. Ensure the pool wall is vertical within 5 degrees for the first 2 1/2 feet from the top. The 12 inch wall to floor radius shall be reduced to 6 inches in the shallow areas.
 - 64E-9.006(1)(d)3. Ensure the 3/4 X 2 inch tile used on the step edge is bullnose or use 2 inch tile on both the riser and tread.
 - 64E-9.006(1)(d)5. Ensure the hand rail is 28 to 40 inches above the step edges as well as above the pool deck.
 - 64E-9.007(4) Ensure the filter pump can provide 150 GPM at 60 TDH or justify as to why a lesser TDH is appropriate. (See application).
 - 64E-9.007 (10)(c) Provide a hydrostatic relief valve in the pool floor if there is high ground water in the area.
 - 64E-9.006 (2)(c) Ensure the pool heater is within the fenced equipment area.
 - 64E-9.006(2)(f) Ensure there is a hose bib with a vacuum breaker in or at the restrooms.
 - 64E-9.006(2)(f) Ensure the chemical crocks are labeled.
- Spa**
- 64E-9.007 (9)(f) Provide an additional inlet fitting so that the flow rate through each inlet does not exceed 20 GPM.
 - Provisos # 2, 3, 7, 8 and 9 above are also pertinent to the spa pool. Use the same bull nose tile on the benches
 - 64E-9.007 (13) Use a 2 1/2 inch flow meter that reads from 50% to at least 150%. The 1 1/2 inch flow meter shown on the equipment list is inappropriate.
 - The pipe size on the filter pump suction is not indicated. Use a 3 inch line.
 - 64E-9.010 (6)(d) Ensure a 15 minute therapy pump timer is used.

