

**PROPOSED BONUS PLAN**  
SCALE: 1/4" = 1'-0"

Garage fire separations shall comply with the following:

1. The private garage shall be separated from the dwelling unit and its attic area by means of a minimum 1/2-inch (12.7 mm) gypsum board applied to the garage side. Garages beneath habitable rooms shall be separated from all habitable rooms above by not less than 5/8-inch Type X gypsum board or equivalent. Door openings between a private garage and the dwelling unit shall be equipped with either solid wood doors, or solid or honeycomb core steel doors not less than 1 3/8 inches (34.9 mm) thick, or doors in compliance with Section 715.3.3. Openings from a private garage directly into a room used for sleeping purposes shall not be permitted.
2. Ducts in a private garage and ducts penetrating the walls or ceilings separating the dwelling unit from the garage shall be constructed of a minimum 0.019-inch (0.48 mm) sheet steel and shall have no openings into the garage.
3. A separation is not required between a Group R-3 and U carport provided the carport is entirely open on two or more sides and there are not enclosed areas above.

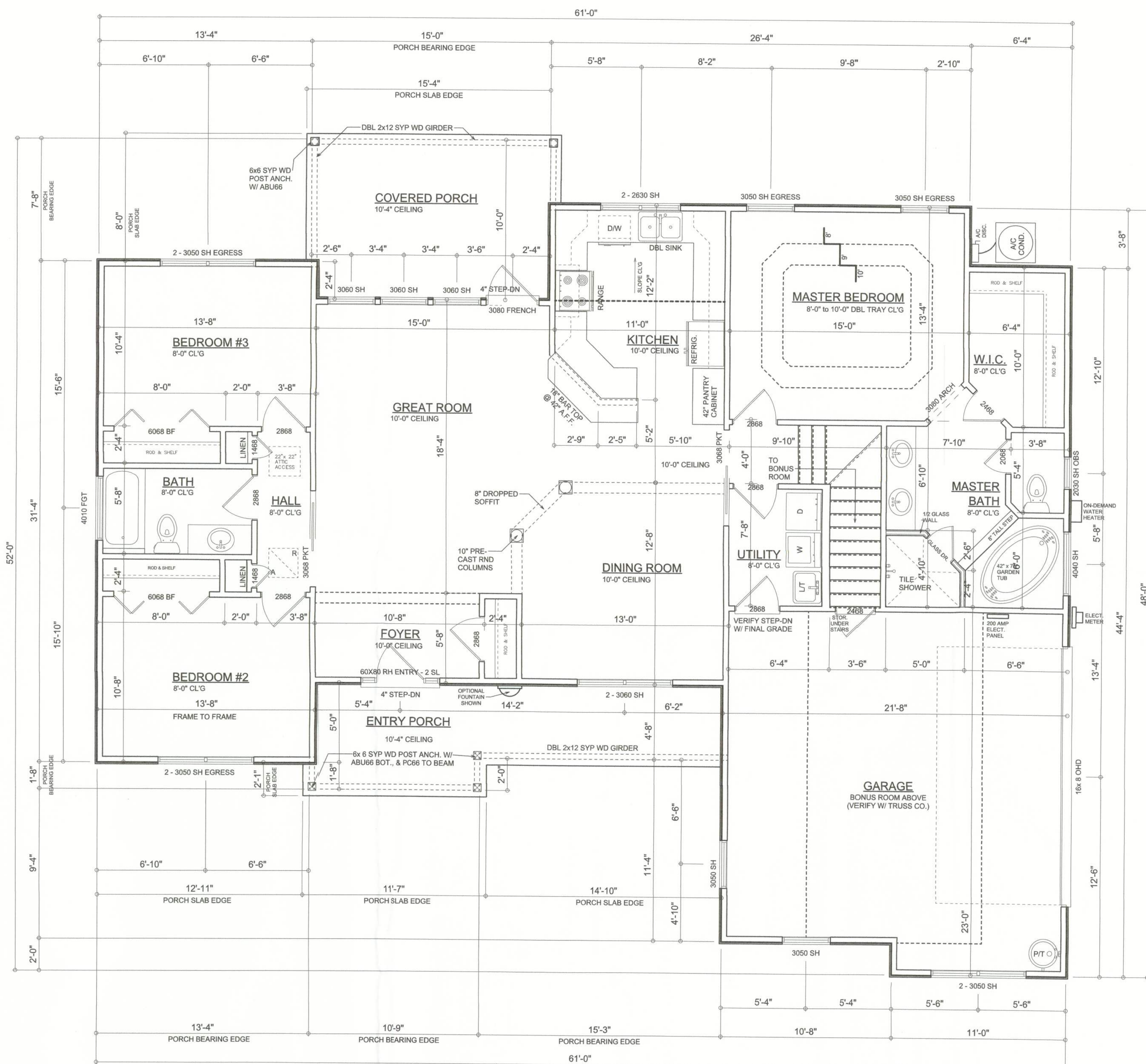

**FLOOR PLAN**  
SCALE: 1/4" = 1'-0"

**AREA SUMMARY**

LIVING AREA	1628	S.F.
BONUS ROOM AREA	227	S.F.
GARAGE AREA	477	S.F.
ENTRY PORCH AREA	145	S.F.
COVERED PORCH AREA	150	S.F.
<b>TOTAL AREA</b>	<b>2,627</b>	<b>S.F.</b>

NOTE: ALL DRAWINGS NOT TO BE SCALED, WRITTEN DIMENSIONS TAKE PRECEDENCE OVER SCALED DIMENSIONS

REVISIONS
December 06, 2011



**FLOOR PLAN**  
SCALE: 1/4" = 1'-0"

**BONUS ROOM PLAN**  
SCALE: 1/4" = 1'-0"

NAME:  
PROJECT ADDRESS:  
**STANLEY CRAWFORD CONSTRUCTION, INC.**  
LAKE CITY, FLORIDA, 32056

**WILLIAM MYERS DESIGN INC.**  
P.O. BOX 1513  
LAKE CITY, FL 32056  
(386) 758-8406  
will@willmyers.net



JOB NUMBER  
121201

SHEET NUMBER

**A.1**  
OF 3 SHEETS

*William C. Myers*