

PERMIT WORKSHEET

page 1 of 2

PERMIT NUMBER

Installer Ernest Scott Johnson License # IH-1025249
 Installer Mobile Phone # 352-494-8099
 Address of home being installed TBD SW SR 47
Fort White, FL 32038
 Manufacturer Town Home Length x width 76X

NOTE: if home is a single wide fill out one half of the blocking plan
 if home is a triple or quad wide sketch in remainder of home

I understand Lateral Arm Systems cannot be used on any home (new or used)
 where the sidewall ties exceed 5 ft 4 in.

Installer's initials

Typical pier spacing 7.6
 lateral
 longitudinal
 Show locations of Longitudinal and Lateral Systems
 (use dark lines to show these locations)

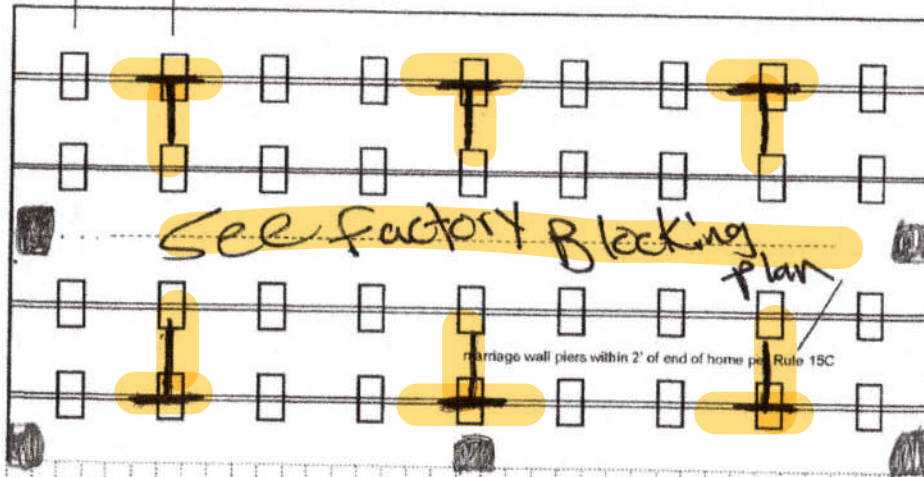

Anthony Islam

12-30-2022

New Home ☒ Used Home ☐

Home installed to the Manufacturer's Installation Manual ☒

Home is installed in accordance with Rule 15-C ☐

Single wide ☐ Wind Zone II ☒ Wind Zone III ☐

Double wide ☒ Installation Decal # 96442

Triple/Quad ☐ Serial #

Roof System: ☒ Typical ☐ Hinged

PIER SPACING TABLE FOR USED HOMES

| Load bearing capacity | Footer size (sq in) | 16" x 16" (256) | 18 1/2" x 18 1/2" (342) | 20" x 20" (400) | 22" x 22" (484)* | 24" x 24" (576)* | 26" x 26" (676) |
|-----------------------|---------------------|-----------------|-------------------------|-----------------|------------------|------------------|-----------------|
| 1000 psf | 3' | 3' | 4' | 5' | 6' | 7' | 8' |
| 1500 psf | 4' 6" | 4' 6" | 6' | 7' | 8' | 8' | 8' |
| 2000 psf | 6' | 6' | 8' | 8' | 8' | 8' | 8' |
| 2500 psf | 7' 6" | 8' | 8' | 8' | 8' | 8' | 8' |
| 3000 psf | 8' | 8' | 8' | 8' | 8' | 8' | 8' |
| 3500 psf | 8' | 8' | 8' | 8' | 8' | 8' | 8' |

* interpolated from Rule 15C-1 pier spacing table.

PIER PAD SIZES

I-beam pier pad size 23X31

Perimeter pier pad size diver 1055-11

Other pier pad sizes (required by the mfg.) outrigger bars

OK 17x25

Draw the approximate locations of marriage wall openings 4 foot or greater. Use this symbol to show the piers.

List all marriage wall openings greater than 4 foot and their pier pad sizes below.

Opening Pier pad size

see factory

TIEDOWN COMPONENTS

Longitudinal Stabilizing Device (LSD)

Manufacturer

Longitudinal Stabilizing Device w/ Lateral Arms

Manufacturer

Oliver 1101V

POPULAR PAD SIZES

| Pad Size | Sq In |
|-------------------|-------|
| 16 x 16 | 256 |
| 16 x 18 | 288 |
| 18.5 x 18.5 | 342 |
| 16 x 22.5 | 360 |
| 17 x 22 | 374 |
| 13 1/4 x 26 1/4 | 348 |
| 20 x 20 | 400 |
| 17 3/16 x 25 3/16 | 441 |
| 17 1/2 x 25 1/2 | 446 |
| 24 x 24 | 576 |
| 26 x 26 | 676 |

ANCHORS

4 ft 5 ft

FRAME TIES

within 2' of end of home spaced at 5' 4" oc

OTHER TIES

Sidewall Number
 Longitudinal 36
 Marriage wall 10
 Shearwall 6

PERMIT NUMBER

POCKET PENETROMETER TEST

The pocket penetrometer tests are rounded down to _____ psf or check here to declare 1000 lb. soil _____ without testing.

x 1000

x _____

x _____

POCKET PENETROMETER TESTING METHOD

1. Test the perimeter of the home at 6 locations.
2. Take the reading at the depth of the footer.
3. Using 500 lb. increments, take the lowest reading and round down to that increment.

x _____

x _____

x 1000

TORQUE PROBE TEST

The results of the torque probe test is _____ inch pounds or check here if you are declaring 5' anchors without testing _____. A test showing 275 inch pounds or less will require 5 foot anchors.

Note: A state approved lateral arm system is being used and 4 ft. anchors are allowed at the sidewall locations. I understand 5 ft anchors are required at all centerline tie points where the torque test reading is 275 or less and where the mobile home manufacturer may require anchors with 4000 lb. holding capacity.

Installer's initials

ALL TESTS MUST BE PERFORMED BY A LICENSED INSTALLER

Installer Name Ernest S. Johnson

Date Tested Assumed Oliver 11/01

Uses 4' 5' foot Anchors

Electrical

Connect electrical conductors between multi-wide units, but not to the main power source. This includes the bonding wire between multi-wide units. Pg. _____

Plumbing

Connect all sewer drains to an existing sewer tap or septic tank. Pg. _____

Connect all potable water supply piping to an existing water meter, water tap, or other independent water supply systems. Pg. _____



Site Preparation

Debris and organic material removed _____
Water drainage: Natural _____ Swale _____ Pad _____ Other _____

Fastening multi wide units

Floor: Type Fastener: 1995 Length: 7 Spacing: 20
Walls: Type Fastener: 1995 Length: 6 Spacing: 10
Roof: Type Fastener: 1995 Length: 6 Spacing: 20
For used homes a min. 30 gauge, 8" wide, galvanized metal strip will be centered over the peak of the roof and fastened with galv. roofing nails at 2" on center on both sides of the centerline.

Gasket (weatherproofing requirement)

I understand a properly installed gasket is a requirement of all new and used homes and that condensation, mold, mildew and buckled marriage walls are a result of a poorly installed or no gasket being installed. I understand a strip of tape will not serve as a gasket.

Installer's initials

Type gasket

Pg. factory OR R11

Installed:

Between Floors Yes _____
Between Walls Yes _____
Bottom of ridgebeam Yes _____

Weatherproofing

The bottomboard will be repaired and/or taped. Yes _____ Pg. _____
Siding on units is installed to manufacturer's specifications. Yes _____
Fireplace chimney installed so as not to allow intrusion of rain water. Yes _____

Miscellaneous

Skirting to be installed. Yes _____ No _____
Dryer vent installed outside of skirting. Yes _____ N/A _____
Range downflow vent installed outside of skirting. Yes _____ N/A _____
Drain lines supported at 4 foot intervals. Yes _____
Electrical crossovers protected. Yes _____
Other: _____

Installer verifies all information given with this permit worksheet is accurate and true based on the manufacturer's installation instructions and or Rule 15C-1 & 2

Installer Signature Ernest S. Johnson Date 12/16/22



Westchester

76

30

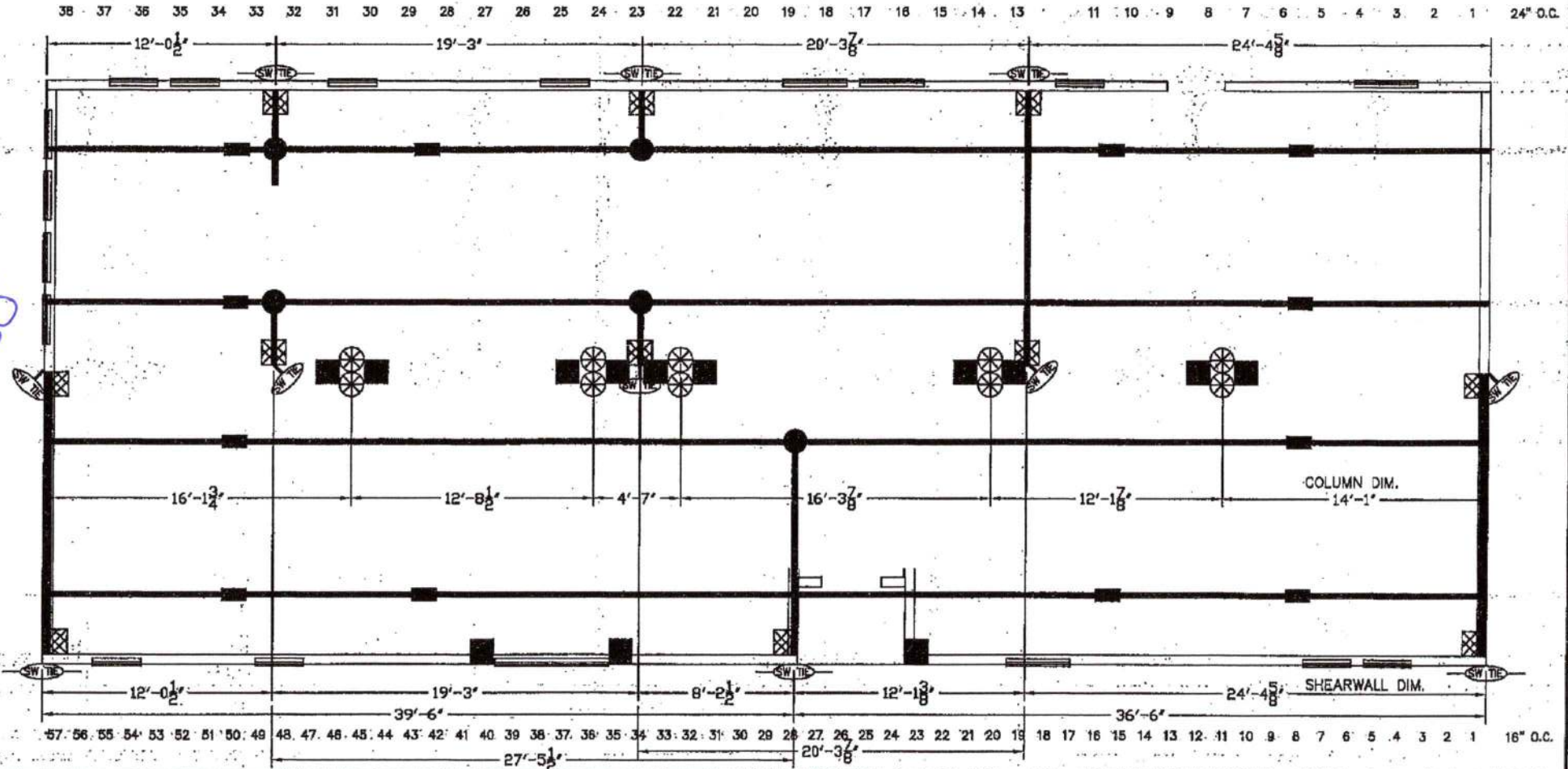

- 1-BEAM BLOCKING
SEE SOIL BEARING CAPACITY CHARTS FOR SPACING
- COLUMN BLOCKING
SEE SOIL BEARING CAPACITY CHARTS FOR PAD SIZE
- SHEARWALL BLOCKING
- SHEARWALL FRAME TIE
- CENTER LINE TIES
- VERTICAL TIE
MAX. SPACING 5'-4" CENTER TO CENTER
- LONGITUDINAL TIES



BLOCKING LEGEND: FLORIDA

- 1) ALL EXTERIOR DOORS, BAY WINDOWS, RECESSED SIDEWALLS AND EXTERIOR WALL OPENINGS 48" OR GREATER, WILL REQUIRE BLOCKING ON EACH SIDE.
- 2) 32" WIDE HOMES REQUIRED TO BE BLOCKED MIN 8'-0" ON CENTER BETWEEN COLUMNS.



TownHomes
P.O. BOX 1059
LAKE CITY, FLORIDA
32056

| | | |
|---------------|---------------------------------|---------------------------------|
| Date: 3-30-22 | Revisions | Cad#: 32240-A |
| Dr'n: DC | 6-3-22 hb | |
| Parent: NEW | 6-24-22 hb | |
| Code: T (22) | | |
| 2 | Model: WESTCHESTER 32240-827 | Print: FLORIDA BLOCKING PLAN |

WESTCHESTER

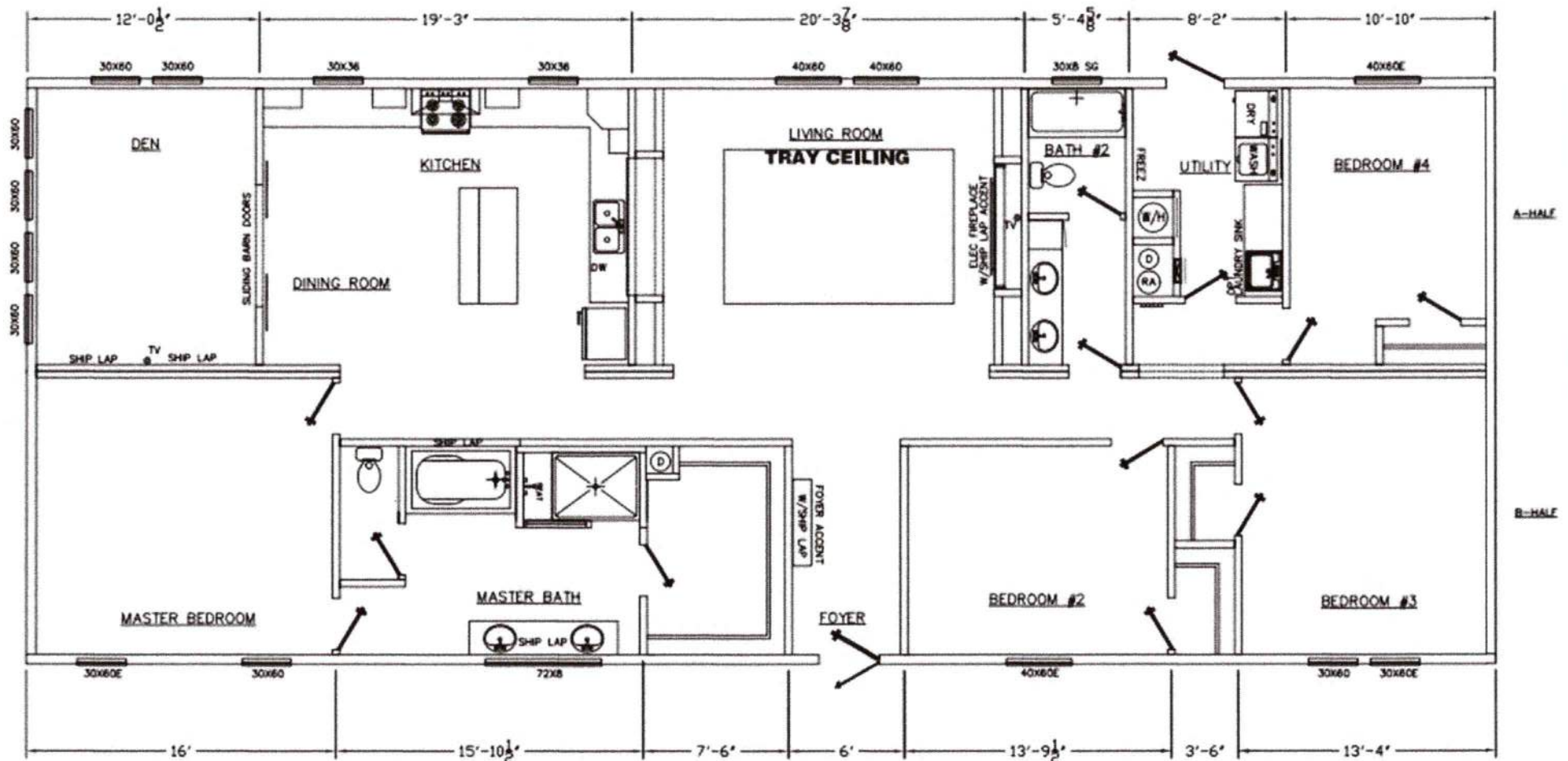

2,305 SQFT