



**NICHOLAS  
PAUL  
GEISLER  
ARCHITECT**  
N.C.A.R.B. Certified

1758 NW Brown Road  
Lake City, FL 32055  
386/365-4355

### Design No. U301

Bearing Wall Rating-2 Hr.  
Finish Rating-66 Min.

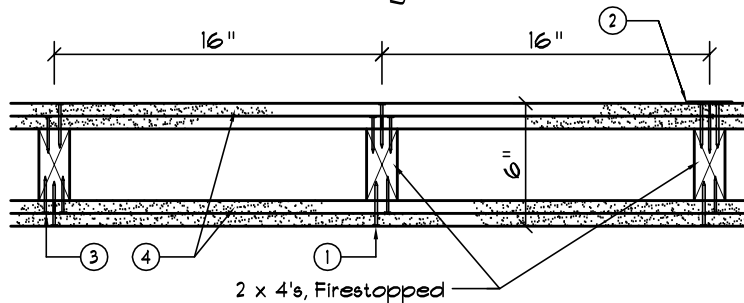

1. Nailheads - Exposed or covered with joint finisher.

2. Joints - Exposed or covered with fiber tape and joint finisher.  
As an alternate, nominal 3/32 in. thick gypsum veneer plaster may be applied to the entire surface of Classified veneer baseboard. Joints reinforced.

3. Nails - 6d cement-coated nails 1-7/8 in. long, Ø.0915 in. shank diam., 1/4 in. diam. heads, and 8d cement-coated nails 2-3/8 in. long, Ø.113 in. shank diam., 9/32 in. diam. heads.

4. Wallboard, Gypsum\* - 5/8 in. thick, two layers applied either horizontally or vertically. Inner layer attached to studs with the 1-7/8 in. nails spaced 6 in. O.C. Outer layer attached to studs over inner layer with the 2-3/8 in. long nails spaced 8 in. O.C. Vertical joints located over studs. All joints in face layers staggered with joints in base layers. Joints of each base layer offset with joints of base layer on opposite side.

Canadian Gypsum Co., Ltd. - Types C, SCX, SHX, WRX.

Celotex Corp. - Type I or FAP.

Domtar Gypsum - Type C, 4 or 9.

Gold Bond Building Products - Types F&K, F&K-G, -4, F&W, F&W-G, or -4.

James Hardie Gypsum - Type Fire X.

Pabco Gypsum, A Div. of Pacific Coast Bldg. Products. Inc. -

Types FG-2, -3, -3W, -3WS, -4 or -6.

Standard Gypsum Corp. - Type SGC or SGC-G.

United States Gypsum Co. - Type C. IP-X1, IP-X2, SCX, SHC, SHX, WRX-C, or WRX.

\*Bearing the UL Classification Marking

Digitally signed by: N. P. GEISLER  
DN: CN = N. P. GEISLER C = US O  
= AR0007005 OU = ARCHITECT  
Date: 2021.06.15 16:23:18 -05'00'