

LEGEND

- EXIT LIGHT - ARROW
REPRESENTS DIRECTION
OF EXIT
- WALL HUNG "ABC" FIRE
EXTINGUISHER
- DOOR / CLOSER FOR EXITING
OR RATING REASONS
- PRIMARY EGRESS
W/ EXIT CAPACITY
- SECONDARY EGRESS
- EMERGENCY LIGHT
w/ BATTERY BACKUP

NOTE:
EMERGENCY LIGHTING AND EXIT SIGNS SHALL BE PROVIDED
AS DIRECTED BY THE FIRE MARSHAL, AND SHALL BE WIRED
PER NEC 100-12F

NOTE:
SMOKE DETECTORS SHALL BE MOUNTED NOT LESS
THAN 90" ABOVE FINISHED FLOOR AND SHALL BE THE
IONIZATION TYPE, INTERLOCKED TOGETHER, POWERED
FROM EACH STORE PANEL w/ BATTERY BACKUP

EXIT ACCESS TRAVEL DISTANCE PER 2023 FBC TABLE 1006.2.1
OCCUPANCY - OFFICE
150 FT. (WITHOUT SPRINKLER SYSTEM)
250 FT. (WITH SPRINKLER SYSTEM)

NOTE:
TRAVEL DISTANCES SHOWN ARE MAXIMUM FOR EMERGENCY EGRESS,
SECONDARY EM. EGRESS AND NON-EMERGENCY EGRESS - ALL OTHER
TRAVEL DISTANCES ARE LESS THAN THAT SHOWN



8" SQ. MALTESE CROSS w/ "F/R" IDENTIFIER
SIGNAGE, MOUNTED @ 60" ABV. WALKWAY
LOCATE AS DIRECTED BY THE FIRE MARSHAL

2023 FBC-BUILDING, TABLE 1004.5

MAXIMUM FLOOR AREA ALLOWABLE PER OCCUPANT

OCCUPANCY CLASSIFICATION	FLOOR AREA	OCCUPANCY BASIS	NUMBER OF OCCUPANTS
CLASSROOMS / COMMON	5,450	• 22/PER CLASSROOM	96
OFFICE	748	• 1/100 SF	7
STORAGE	302	• 1/300 SF	1
BUILDING TOTALS	6,500		104

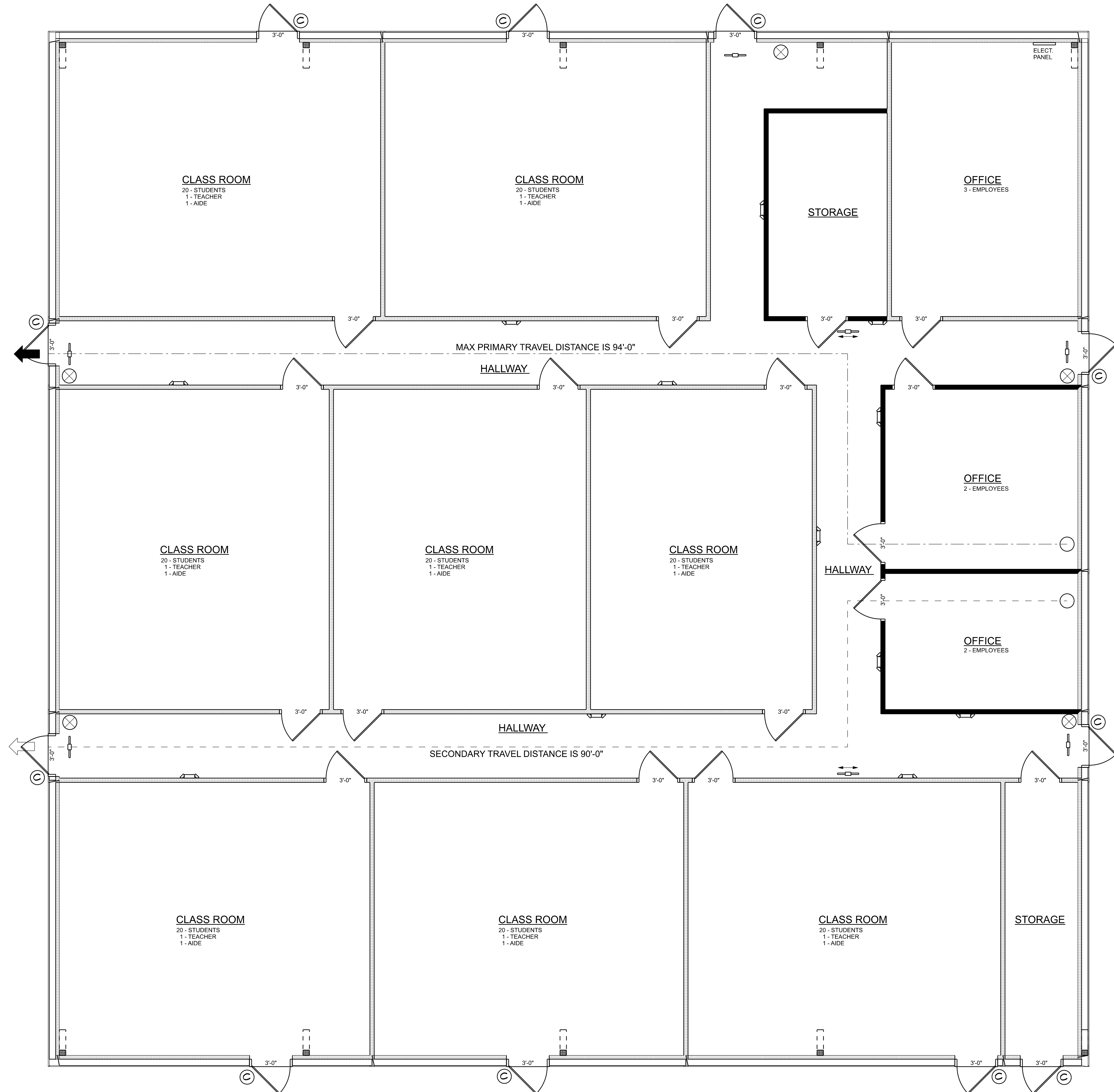

LIFE SAFETY PLAN

SCALE: 1/4" = 1'-0"

EXISTING BUILDING RENOVATIONS FOR:

KINGDOM CULTURE ACADEMY

COLUMBIA COUNTY, FLORIDA



JOINT VENTURED WITH

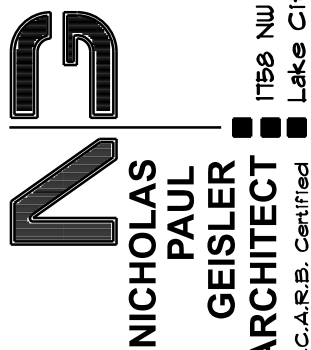

SHEET NUMBER

A.1

OF 4 SHEETS

Nicholas
P. Geisler

Digitally signed by Nicholas P. Geisler
DN: CN = Nicholas P. Geisler email =
npgisler47@gmail.com O = US O = Nicholas
P. Geisler OU = Nicholas P. Geisler
Date: 2024.03.29 12:05:44 -0500

AR0007005

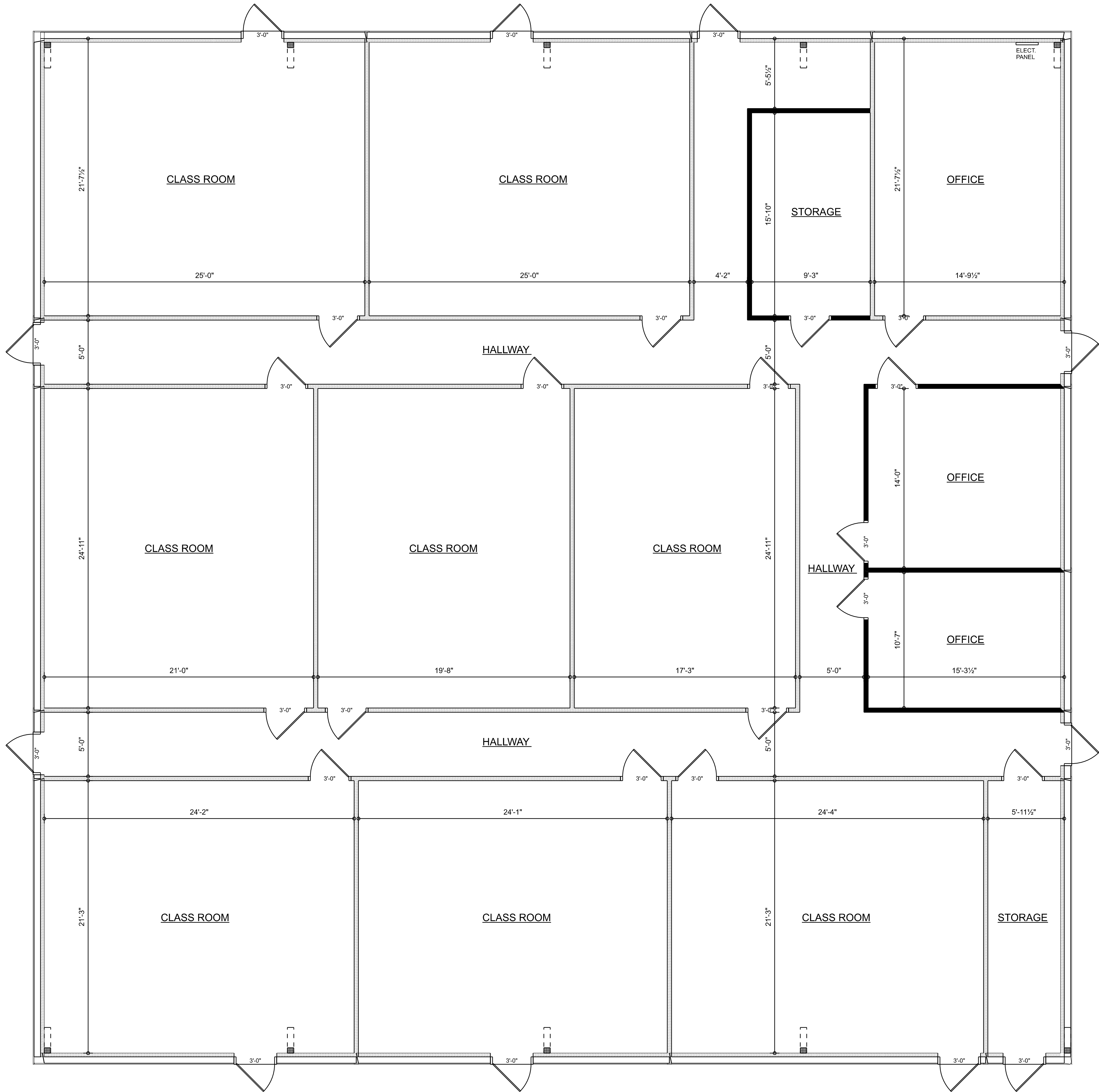

RENOVATED FLOOR PLAN
SCALE: 1/4" = 1'-0"

- NEW INTERIOR WALL
- EXISTING INTERIOR WALL
- EXISTING STEEL WALL
- STEEL COLUMN

EXISTING BUILDING RENOVATIONS FOR:
KINGDOM CULTURE ACADEMY
COLUMBIA COUNTY, FLORIDA

REVISION DATE
Mar. 5th, 2024

COUNTY / CITY APPROVAL

**RIDGEPOINT DESIGN**
RIDGEPOINTDESIGN@GMAIL.COM | 386-286-8888

JOINT VENTURED WITH

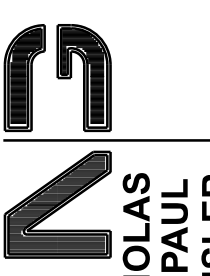
**NICHOLAS
GEISLER
PAUL
ARCHITECT**
1789 NW Brown Rd.
Lake City, FL 32095
N.C.A.R.B. Certified

SHEET NUMBER
A.2
OF 4 SHEETS

AR0007005

EXISTING BUILDING RENOVATIONS FOR:
KINGDOM CULTURE ACADEMY
COLUMBIA COUNTY, FLORIDA



JOINT VENTURED WITH

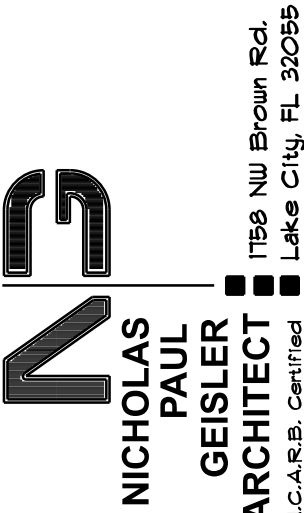

SHEET NUMBER

A.3

OF 4 SHEETS

AR0007005

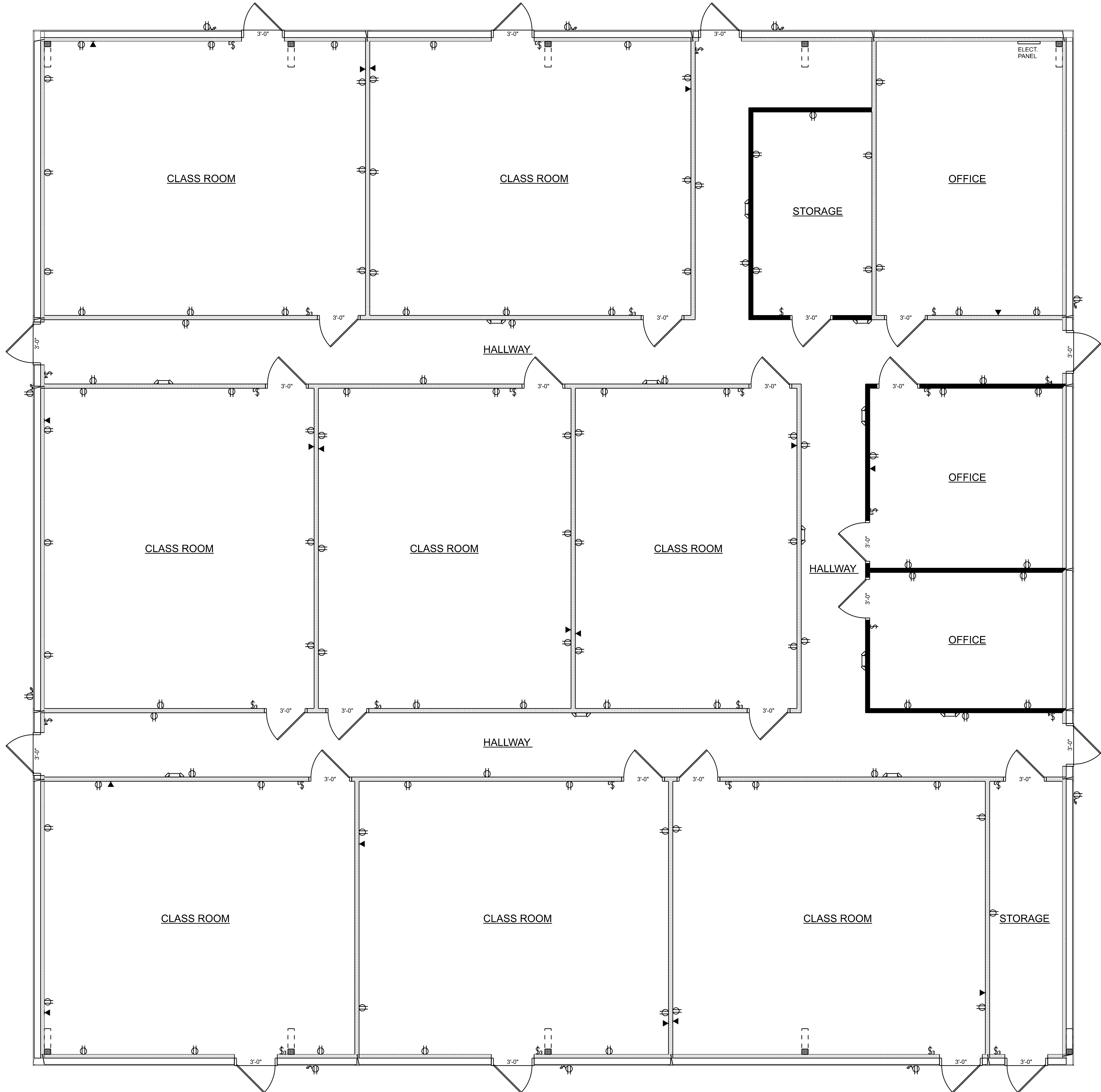

POWER PLAN
SCALE: 1/4" = 1'-0"

ELECTRICAL LEGEND	
ELECTRICAL SYMBOL	
Emergency Light	
LAN CONNECTION	
OUTLET	
OUTLET WP	
SWITCH	
SWITCH 3 WAY	
SWITCH 4 WAY	

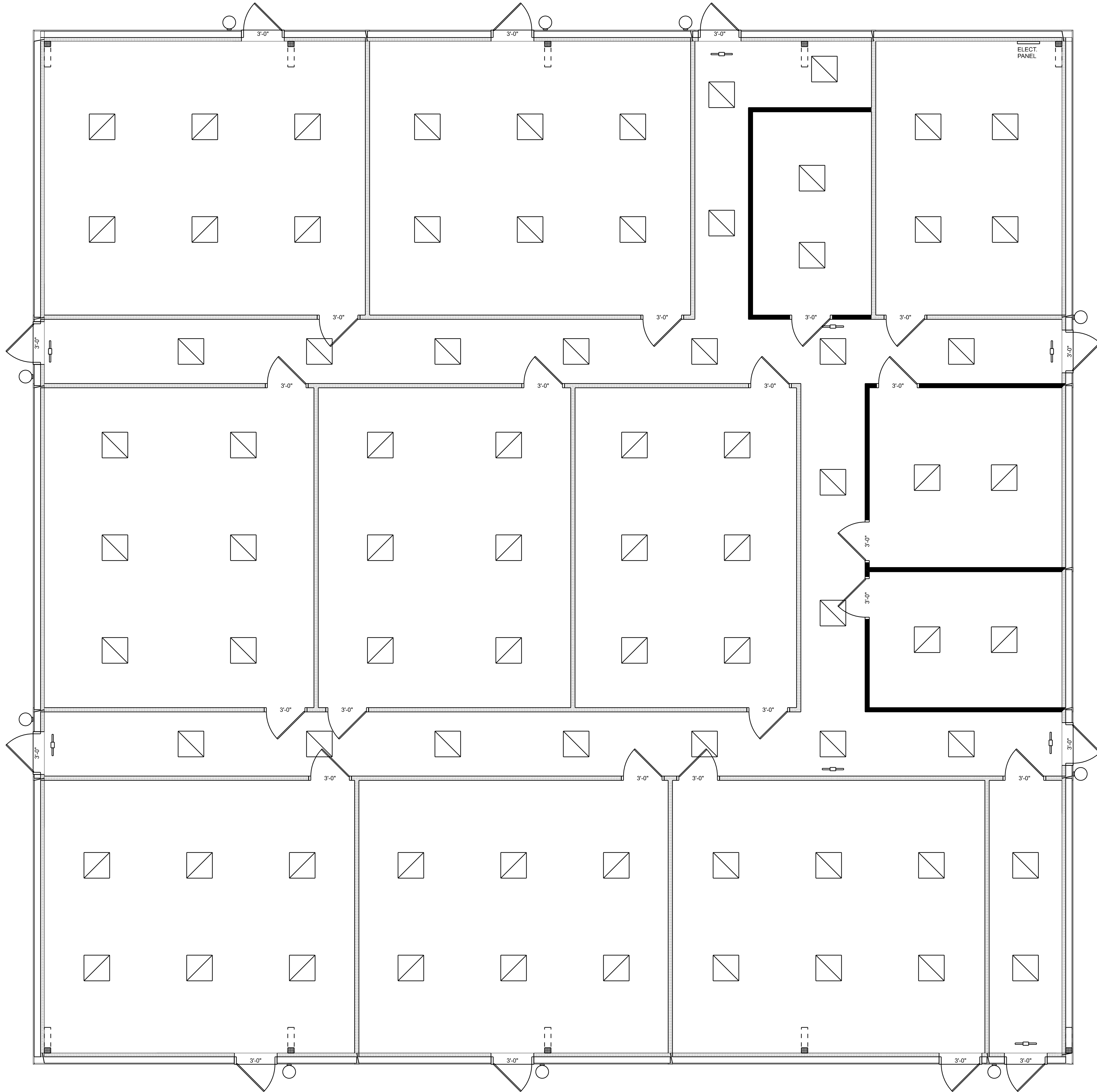

LIGHTING PLAN
SCALE: 1/4" = 1'-0"

EXISTING BUILDING RENOVATIONS FOR:
KINGDOM CULTURE ACADEMY
COLUMBIA COUNTY, FLORIDA



JOINT VENTURED WITH

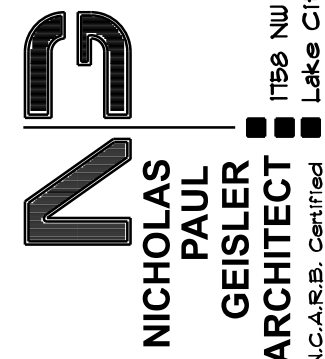

SHEET NUMBER
A.4
OF 4 SHEETS

