

[DBPR HOME](#) | [ABOUT DBPR](#) | [DBPR DIVISIONS](#) | [CONTACT DBPR](#)
[BCIS Home](#) | [Log Out](#) | [User Registration](#) | [Hot Topics](#) | [Submit Surcharge](#) | [Stats & Facts](#) | [Publications](#) | [Contact Us](#) | [BCIS Site Map](#) | [Links](#) | [Search](#)
**Product Approval****USER:** Rylee Sumner Fricks, JELD-WEN, Product Manufacturer
[Product Approval Menu](#) > [Manage Applications](#) > **Application Detail**

 ▶ OFFICE OF THE
SECRETARY

FL #	FL14095-R11								
Application Type	Affirmation								
Code Version	2020								
Application Status	Approved								
Comments									
Archived	<input type="checkbox"/>								
Product Manufacturer	JELD-WEN								
Address/Phone/Email	3737 Lakeport Blvd Klamath Falls, OR 97601 (800) 535-3936 fbc1@jeld-wen.com								
Authorized Signature	Rylee Sumner Fricks fbc1@jeld-wen.com								
Technical Representative	JELD-WEN Corporate Customer Service								
Address/Phone/Email	3737 Lakeport Blvd. Klamath Falls, OR 97601 (800) 535-3936 customerserviceagents@jeld-wen.com								
Quality Assurance Representative									
Address/Phone/Email									
Category	Windows								
Subcategory	Single Hung								
Compliance Method	Certification Mark or Listing								
Certification Agency	National Accreditation & Management Institute								
Validated By	National Accreditation & Management Institute								
Referenced Standard and Year (of Standard)	<table border="0"> <thead> <tr> <th><u>Standard</u></th> <th><u>Year</u></th> </tr> </thead> <tbody> <tr> <td>TAS 201</td> <td>1994</td> </tr> <tr> <td>TAS 202</td> <td>1994</td> </tr> <tr> <td>TAS 203</td> <td>1994</td> </tr> </tbody> </table>	<u>Standard</u>	<u>Year</u>	TAS 201	1994	TAS 202	1994	TAS 203	1994
<u>Standard</u>	<u>Year</u>								
TAS 201	1994								
TAS 202	1994								
TAS 203	1994								
Equivalence of Product Standards Certified By									

☒ I affirm that there are no changes in the new Florida Building Code which affect my product(s) and my product(s) are in compliance with the new Florida Building Code.

 Documentation from approved Evaluation or Validation Entity ☐ Yes ☐ No ☐ N/A

Product Approval Method

Method 1 Option A

Date Submitted

07/29/2020

Date Validated

07/29/2020

Date Pending FBC Approval

Date Approved

07/31/2020

Summary of Products

FL #	Model, Number or Name	Description
14095.1	Premium Atlantic Vinyl	Single Hung (8100) 36" x 72" Insulated Glass (5/16 in PVB or SGP Lam - 1/8 out Annealed)
Limits of Use Approved for use in HVHZ: Yes Approved for use outside HVHZ: Yes Impact Resistant: Yes Design Pressure: +65/-70 Other: Laminated glazing interlayer material requirements meet the current edition of the FBC in accordance with Miami-Dade NOA for DuPont SentryGlas and DuPont PVB interlayers. White PVC exterior extrusion meet the current edition of the FBC in accordance with Miami-Dade NOA for Quanex. IG back bedded with Dow 995. Safety glazing required to the exterior at heights above 30 feet.		Certification Agency Certificate FL14095_R11_C_CAC_NI011567.04-R3.pdf Quality Assurance Contract Expiration Date 04/30/2025 Installation Instructions FL14095_R11_II_FL14095_R5_II_DP65-70_36x72_Impact_Installation_Instructions.pdf FL14095_R11_II_NI011567.04-R3_Dwgs_07252017.pdf Verified By: Hermes Norero, PE 73778 Created by Independent Third Party: Yes Evaluation Reports FL14095_R11_AE_PER3094.pdf Created by Independent Third Party: Yes
14095.2	Premium Atlantic Vinyl	Single Hung (8100) 36" x 72" Insulated Glass (1/8 in - 1/8 out Annealed)
Limits of Use Approved for use in HVHZ: Yes Approved for use outside HVHZ: Yes Impact Resistant: No Design Pressure: +65/-70 Other: White PVC exterior extrusion meet the current edition of the FBC in accordance with Miami-Dade NOA for Quanex. IG back bedded with Dow 995. Safety glazing required to the exterior at heights above 30 feet.		Certification Agency Certificate FL14095_R11_C_CAC_NI011567.08-R1.pdf FL14095_R11_C_CAC_NI011567.09-R2.pdf Quality Assurance Contract Expiration Date 04/30/2025 Installation Instructions FL14095_R11_II_NI011567.09-R2_Dwgs_07252017.pdf FL14095_R11_II_PAV_TSH_FBC_36x72_SS_2017-06-26.pdf Verified By: Hermes Norero, PE 73778 Created by Independent Third Party: Yes Evaluation Reports FL14095_R11_AE_PER4869_SS_2017-06-26.pdf Created by Independent Third Party: Yes
14095.3	Premium Atlantic Vinyl	Single Hung (8100) 52 1/8" x 75" Insulated Glass (3/16 in - 3/16 out Annealed)
Limits of Use Approved for use in HVHZ: Yes Approved for use outside HVHZ: Yes Impact Resistant: No Design Pressure: +65/-70 Other: White PVC exterior extrusion meet the current edition of the FBC in accordance with Miami-Dade NOA for Quanex. IG back bedded with Dow 995. Windows with insulated glass wider than 36" require setting blocks. Safety glazing required to the exterior at heights above 30 feet.		Certification Agency Certificate FL14095_R11_C_CAC_NI011567.06-R1.pdf FL14095_R11_C_CAC_NI011567.07-R2.pdf Quality Assurance Contract Expiration Date 04/30/2025 Installation Instructions FL14095_R11_II_NI011567.07-R2_Dwgs_07252017.pdf FL14095_R11_II_PAV_TSH_FBC_52x75_SS_2017-06-26.pdf Verified By: Hermes Norero, PE 73778 Created by Independent Third Party: Yes Evaluation Reports FL14095_R11_AE_PER4870_SS_2017-06-26.pdf Created by Independent Third Party: Yes
14095.4	Premium Atlantic Vinyl	Single Hung (8100) 52 1/8" x 75" Insulated Glass (5/16 in PVB or SGP Lam - 1/8 out Annealed)
Limits of Use Approved for use in HVHZ: Yes Approved for use outside HVHZ: Yes Impact Resistant: Yes Design Pressure: +50/-60 Other: Laminated glazing interlayer material requirements meet the current edition of the FBC in accordance with Miami-Dade NOA for DuPont SentryGlas and DuPont PVB interlayers. White PVC exterior extrusion meet the current edition of the FBC in accordance with Miami-Dade NOA for Quanex. IG back bedded with Dow 995. Windows with insulated glass wider than 36" require setting blocks. Safety glazing required to the exterior at heights above 30 feet.		Certification Agency Certificate FL14095_R11_C_CAC_NI011567.02-R2.pdf Quality Assurance Contract Expiration Date 04/30/2025 Installation Instructions FL14095_R11_II_FL14095_R5_II_DP50-60_52.125x75_Impact_Installation_Instructions.pdf FL14095_R11_II_NI011567.02-R2_Dwgs_07252017.pdf Verified By: Hermes Norero, PE 73778 Created by Independent Third Party: Yes Evaluation Reports FL14095_R11_AE_PER3091.pdf Created by Independent Third Party: Yes
14095.5	Premium Atlantic Vinyl	Single Hung (8100) 52 1/8" x 75" Insulated Glass (5/16 in SGP Lam - 3/16 out Annealed)
Limits of Use		Certification Agency Certificate

Approved for use in HVHZ: Yes
Approved for use outside HVHZ: Yes
Impact Resistant: Yes
Design Pressure: +65/-75

Other: Laminated glazing interlayer material requirements meet the current edition of the FBC in accordance with Miami-Dade NOA for DuPont SentryGlas and DuPont PVB interlayers. White PVC exterior extrusion meet the current edition of the FBC in accordance with Miami-Dade NOA for Quanex. IG back bedded with Dow 995. Windows with insulated glass wider than 36" require setting blocks. Safety glazing required to the exterior at heights above 30 feet.

[FL14095_R11_C_CAC_NI011567.01-R1.pdf](#)

[FL14095_R11_C_CAC_NI011567-R1.pdf](#)

Quality Assurance Contract Expiration Date

04/30/2025

Installation Instructions

[FL14095_R11_II_FL14095_R5_II_DP65-](#)

[75_52.125x75_Impact_Installation_Instructions.pdf](#)

[FL14095_R11_II_NI011567.01-R1_Dwgs_07252017.pdf](#)

Verified By: Hermes Norero, PE 73778

Created by Independent Third Party: Yes

Evaluation Reports

[FL14095_R11_AE_PER3095.pdf](#)

Created by Independent Third Party: Yes

[Back](#)

[Next](#)

[Contact Us](#) :: [2601 Blair Stone Road, Tallahassee FL 32399](#) Phone: 850-487-1824

The State of Florida is an AA/EEO employer. [Copyright 2007-2013 State of Florida](#). :: [Privacy Statement](#) :: [Accessibility Statement](#) :: [Refund Statement](#)

Under Florida law, email addresses are public records. If you do not want your e-mail address released in response to a public-records request, do not send electronic mail to this entity. Instead, contact the office by phone or by traditional mail. If you have any questions, please contact 850.487.1395. *Pursuant to Section 455.275(1), Florida Statutes, effective October 1, 2012, licensees licensed under Chapter 455, F.S. must provide the Department with an email address if they have one. The emails provided may be used for official communication with the licensee. However email addresses are public record. If you do not wish to supply a personal address, please provide the Department with an email address which can be made available to the public. To determine if you are a licensee under Chapter 455, F.S., please click [here](#).

Product Approval Accepts:



Credit Card
Safe

securityMETRICS

NOTICE OF PRODUCT CERTIFICATION



CERTIFICATION NO: NI011567.04-R3
DATE: 05/23/2013
CERTIFICATION PROGRAM: Structural
COMPANY: JELD-WEN
CODE: 1822-1
REVISION DATE: 01/13/2017

To verify that the "Notice of Product Certification" is valid, please visit www.NAMICertification.com to assure that the product is active and currently listed. This certification represents product conformity to the applicable specification and that certification criteria has been satisfied. A NAMI approved certification label must be applied to the product to claim certification status. Please review and advise NAMI if any corrections are required to this document.

COMPANY NAME AND ADDRESS	PRODUCT DESCRIPTION
JELD-WEN 3737 Lakeport Boulevard Klamath Falls, OR 97601	"Premium Atlantic Vinyl Single Hung (8100)" Impact Rated Vinyl Single Hung Window (Fin or Flange Installation) Configuration: O/X Glazing: IG-1/8" Annealed Glass/Laminate- 1/8" Annealed Glass/0.090 "PVB Interlayer by DuPont/ 1/8" Annealed Glass or IG-1/8" Annealed Glass/Laminate- 1/8" annealedGlass/0.090" SentryGlas Plus by DuPont/ 1/8" Annealed Glass Frame: W-914mm(36") H-1829mm(72") Sash: W-845mm(33.25") H-883mm(34.75")

SPECIFICATION	PRODUCT RATING
TAS 201/202/203-94	Design Pressure: +65/-70 psf Large Missile Impact Rated

Product Tested By: National Certified Testing Laboratories
Report No: NCTL-210-3875-1
Expiration Date: April 30, 2025

Administrator's Signature: _____

A handwritten signature in black ink, appearing to be "Shi" or similar, written over a horizontal line.

**NATIONAL ACCREDITATION AND
MANAGEMENT INSTITUTE, INC.**
4794 George Washington Memorial Highway
Hayes, VA 23072
Tel: (804) 684-5124
Fax: (804) 684-5122



BUILDING DROPS

A Perfect Solution in Every Drop

Certificate of Authorization: 29578

398 E. Dania Beach Blvd.
Suite 338
Dania Beach, FL 33004
954.399.8478 PH
954.744.4738 FX
contact@buildingdrops.com

Product Evaluation Report *of*

JELD-WEN, Inc.

Premium Atlantic Vinyl Single Hung - Impact

for
Florida Product Approval

Report No. 3094

Current Florida Building Code

Method: 1 – A (Certificate)
Category: Windows
Sub – Category: Single Hung

Product: *Premium Atlantic Vinyl Single Hung - Impact*
Material: PVC
Product Dimensions: 36" x 72" (O/X)

Prepared For:
JELD-WEN, Inc.
3737 Lakeport Blvd.
Klamath Falls, OR 97601

Prepared by:
Hermes F. Norero, P.E.
Florida Professional Engineer # 73778
Date: 08/11/2014

Contents:
Evaluation Report Pages 1 – 4

Digitally signed by Hermes F. Norero, P.E.
Reason: I am approving this document
Date: 2014.09.19 16:31:49 -04'00'

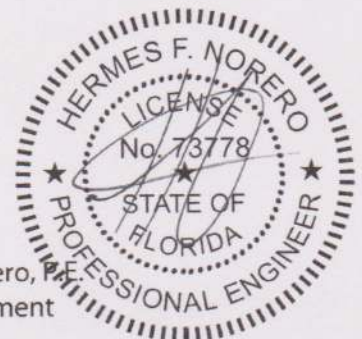

Hermes F. Norero, P.E.
Florida No. 73778



BUILDING DROPS

A Perfect Solution in Every Drop

Certificate of Authorization: 29578

Date: 08/11/2014

Report No: 3094

Manufacturer: JELD-WEN, Inc.

Product Category: Windows

Product Sub-Category: Single Hung

Compliance Method: State Product Approval Method (1)(a)

Product Name: Premium Atlantic Vinyl Single Hung – Impact
(Impact)
36" x 72" (O/X)

Scope: This is a Product Evaluation Report issued by Hermes F. Norero, P.E. (FL # 73778) for JELD-WEN, Inc. based on Method 1a of the State of Florida Product Approval, Department of Business and Professional Regulation - Florida Building Commission.

Hermes F. Norero, P.E. does not have nor will acquire financial interest in the company manufacturing or distributing the product or in any other entity involved in the approval process of the product named herein.

This product has been evaluated for use in locations adhering to the current Florida Building Code.

See Installation Instructions **NCTL210-3875-1-FBC**, signed and sealed by Hermes F. Norero, P.E. (FL # 73778) for specific use parameters.

Limits of Use:

1. This product has been evaluated and is in compliance with the current Florida Building Code, including the "High Velocity Hurricane Zone" (HVHZ).
2. Product anchors shall be as listed and spaced as shown on details. Anchor embedment into substrate material shall be beyond wall dressing or stucco.
3. When used in areas requiring wind borne debris protection this product complies with Section 1609.1.2 of the current Florida Building Code and does not require an impact resistant covering.
4. Site conditions that deviate from the details of drawing **NCTL210-3875-1-FBC** require further engineering analysis by a licensed engineer or registered architect.
5. See Installation Instructions **NCTL210-3875-1-FBC** for size and design pressure limitations.

Hermes F. Norero, P.E.

Florida No. 73778

Page 2 of 4



BUILDING DROPS

A Perfect Solution in Every Drop

Certificate of Authorization: 29578

Date: 08/11/2014
Report No: 3094

Quality Assurance:

The manufacturer has demonstrated compliance of products in accordance with the Florida Building Code for manufacturing under a quality assurance program audited by an approved quality assurance entity through **National Accreditation and Management Institute** (FBC Organization #: QUA 1789).

Performance Standards:

The product described herein has been tested per:

- TAS 201-94
- TAS 202-94
- TAS 203-94

Referenced Data:

1. Product Testing performed by **National Certified Testing Laboratories NW** (FBC Organization # TST9341)
Report #: NCTL-210-3875-1, Report Date: 4/18/2013
2. Certification Agency
National Accreditation and Management Institute
(FBC Organization #: CER 1773)
3. Material Certification
Miami Dade RER – Product Control Section NOA
E.I. DuPont De Nemours & Co., Inc.: PVB Interlayer
4. Material Certification
Miami Dade RER – Product Control Section NOA
Quanex Building Products: PVC Extrusions



BUILDING DROPS

A Perfect Solution in Every Drop

Certificate of Authorization: 29578

Date: 08/11/2014

Report No: 3094

Through Frame Installation: 1. Approved anchor types and substrates are as follows:

- A. For concrete (Min. $f'c = 3000$ psi) or masonry substrate (Min. $f'c = 1500$ psi) where one by (1X), non-structural, wood bucking is employed, use **(1) 3/16" diameter ITW Tapcon** type concrete screw anchors per location of sufficient length to achieve minimum embedment of 1.25" into concrete or masonry.
- B. For concrete (Min. $f'c = 3000$ psi) or masonry substrate (Min. $f'c = 1500$ psi) where wood bucking is NOT employed, use **(1) 3/16" diameter ITW Tapcon** type concrete screw anchors per location of sufficient length to achieve minimum embedment of 1.25" into concrete or masonry.
- C. For steel substrate, use **(1) #8 Tek Screw** type steel frame (min. 18ga.) anchors per location of sufficient length to achieve minimum three threads of penetration beyond steel structure.

Nail Fin Installation (Where applicable):

- A. For wood substrates (Min. S.G. = 0.42) use **(1) #10 Wood Screw** type installation anchors per location of sufficient length to achieve a minimum embedment of 1.50" into the wood substrate.

Refer to Installation Instructions (**NCTL210-3875-1-FBC**) for anchor spacing and more details of the installation requirements.

Design Pressure:

Design Pressure	
Positive	65 PSF
Negative	70 PSF

Hermes F. Norero, P.E.

Florida No. 73778

Page 4 of 4

THROUGH FRAME INSTALLATION

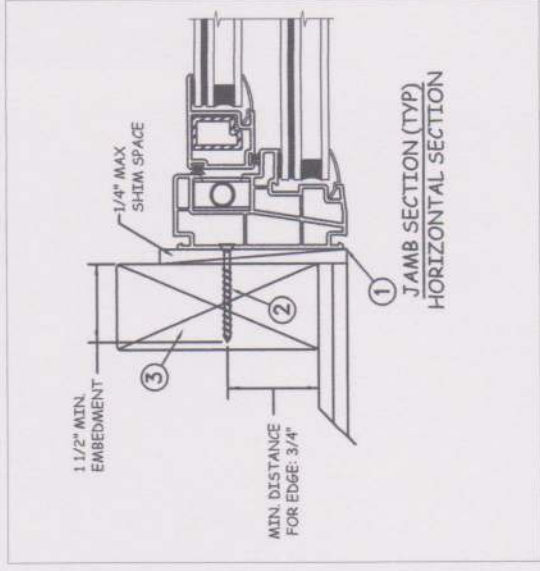
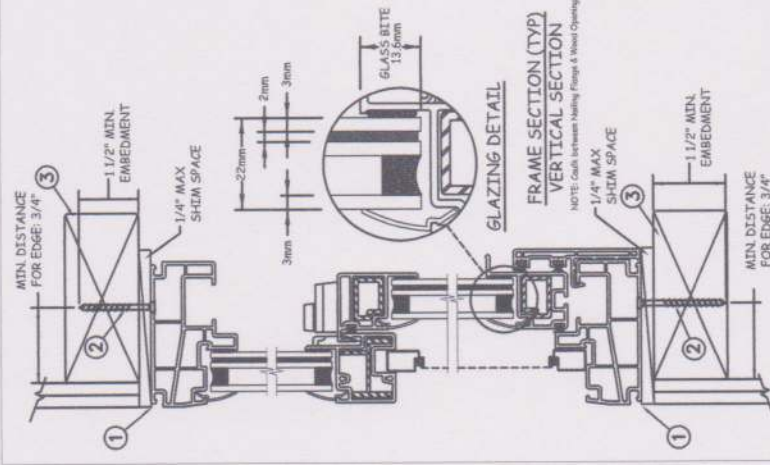
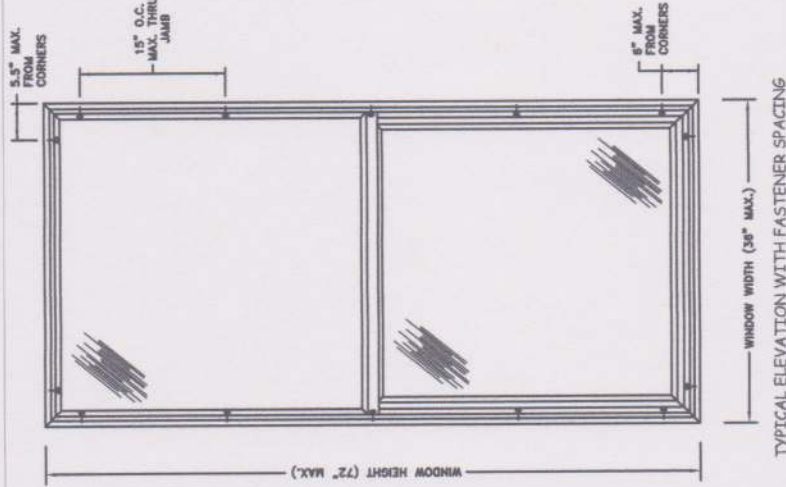

PREMIUM ATLANTIC VINYL SH WINDOW

Max Frame	DP RATING	IMPACT
36 x 72	+65/-70	YES

LARGE MISSILE IMPACT

Installation Notes:

1. Seal flange/frame to substrate.
2. Use #10 PH or greater fastener through the jamb with sufficient length to penetrate a minimum of 1 1/2" into the wood framing. For 2X wood frame substrate (min. S.G. = 0.42).
3. Host structure (wood buck, masonry, steel) to be designed and anchored to properly transfer all loads to the structure. The host structure is the responsibility of the architect or engineer of record for the project of installation.

Certification No: NI011567.04-R3

Reviewed By: *[Signature]*

Date Reviewed: 07/25/2017

This schedule addresses only the fasteners required to anchor the window to achieve the rated design pressure up to the size limitations noted. It is not intended as a guide to the installation process and does not address the sealing consideration that may arise in different wall conditions. For the complete installation procedure, see the instructions packaged with the window or go to www.jeld-wen.com/resources/installation.

DISCLAIMER:

This drawing and its contents are confidential and are not to be reproduced or copied in whole or in part or used or disclosed to others except as authorized by JELD-WEN Inc.

General Notes:

1. The product shown herein is designed, tested and manufactured to comply with the wind load criteria of the adopted International Building Code(IBC), the International Residential Code(IRC), the Florida Building Code (FBC) including HVHZ and the industry requirement for the stated conditions.
2. All glazing shall conform to ASTM E1300.
3. At minimum, glazing is 3mm annealed - 11mm airspace - 3mm annealed - 2mm PVB Interlayer by DuPont - 3mm annealed.
4. Use structural or composite shims where required.

PROJECT ENGINEER:	DATE:	06/30/2015
DRAWN BY:	SCALE:	NTS
CHECKED BY:	TITLE:	
APPROVED BY:		
PART PROJECT NO:		
IDENTIFIER NO:		

JELD-WEN
3737 Lakeport Blvd
Klamath Falls, OR, 97601
Phone: (800) 535-3936

Premium Atlantic Vinyl Impact Single Hung Window

REV: 00
SHEET 1 OF 1

NAIL FIN INSTALLATION

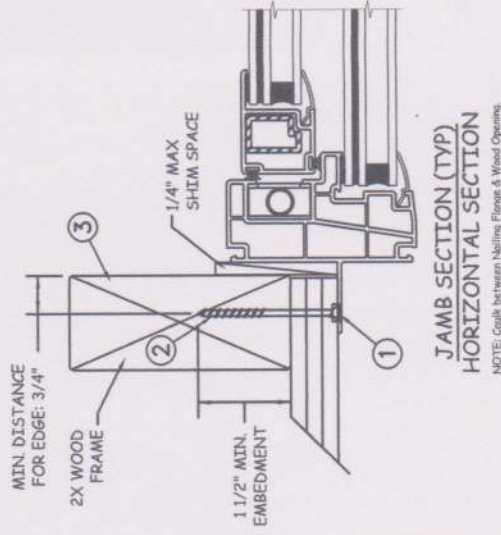
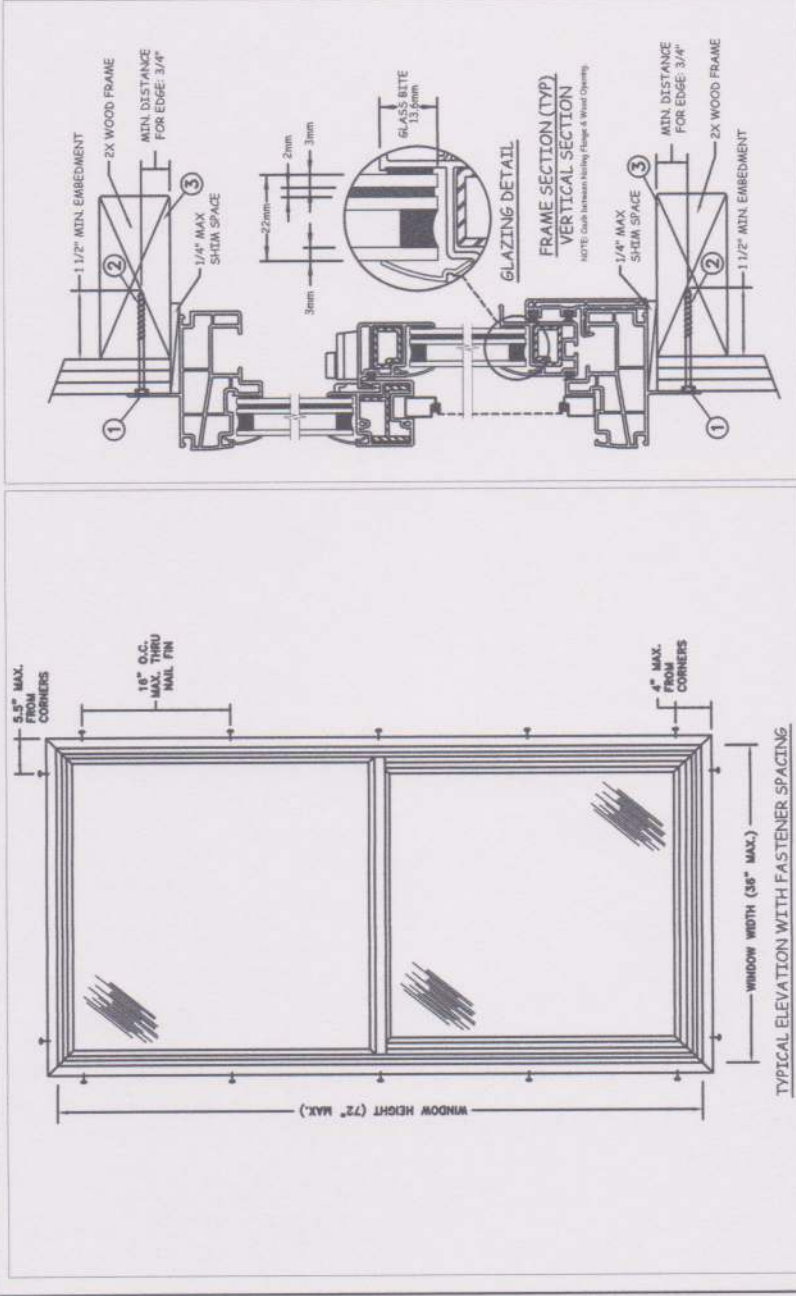

PREMIUM ATLANTIC VINYL SH WINDOW

Max Frame	DP RATING	IMPACT
36 x 72	+65/-70	YES

LARGE MISSILE IMPACT

Installation Notes:

1. Seal flange/frame to substrate.
2. Use #10 PH or greater fastener through the nail fin with sufficient length to penetrate a minimum of 1 1/2\"/>
- 3. Host structure (wood buck, masonry, steel) to be designed and anchored to properly transfer all loads to the structure. The host structure is the responsibility of the architect or engineer of record for the project of installation.

Digitally signed by Hermes F. Norero, P.E.
Reason: I am approving this document
Date: 2014.09.19 16:26:14 -04'00'

This schedule addresses only the fasteners required to anchor the window to achieve the rated design pressure up to the size limitations noted. It is not intended as a guide to the installation process and does not address the sealing consideration that may arise in different wall conditions. For the complete installation procedure, see the instructions packaged with the window or go to www.jeld-wen.com/resources/installation.

DISCLAIMER:

This drawing and its contents are confidential and are not to be reproduced or copied in whole or in part or used or disclosed to others except as authorized by JELD-WEN Inc.

General Notes:

1. The product shown herein is designed, tested and manufactured to comply with the wind load criteria of the adopted International Building Code (IBC), the International Residential Code (IRC), the Florida Building Code (FBC) including HVHZ and the industry requirement for the stated conditions.
2. All glazing shall conform to ASTM E1300.
3. At minimum, glazing is 3mm annealed - 11mm airspace - 3mm annealed - 2mm PVB Interlayer by DuPont - 3mm annealed.
4. Use structural or composite shims where required.



PROJECT ENGINEER:	DATE: 08/13/2014
DRAWN BY: D. Vezo	SCALE: NTS
CHECKED BY: J. Kantola	TITLE:
APPROVED BY:	
PART/PROJECT No.: D008729	
IDENTIFIER No.: NCT1210-3875-1	

JELD-WEN	3737 Lakeport Blvd Klamath Falls, OR. 97601 Phone: (541) 882-3451
Premium Atlantic Vinyl Impact Single Hung Window	
PLANT NAME AND LOCATION:	REV: 00 SHEET 1 OF 3

MASONRY INSTALLATION

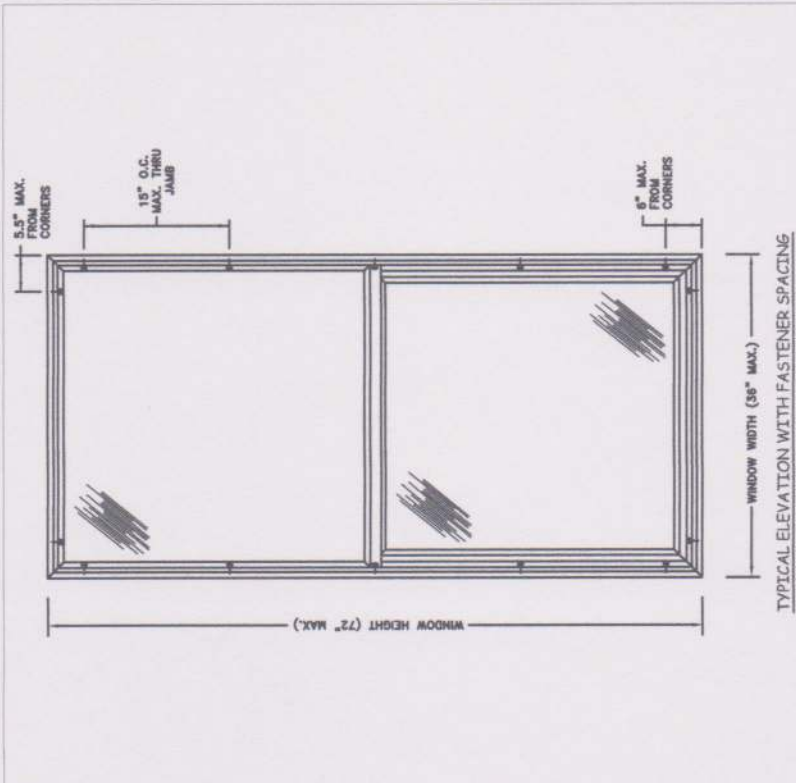
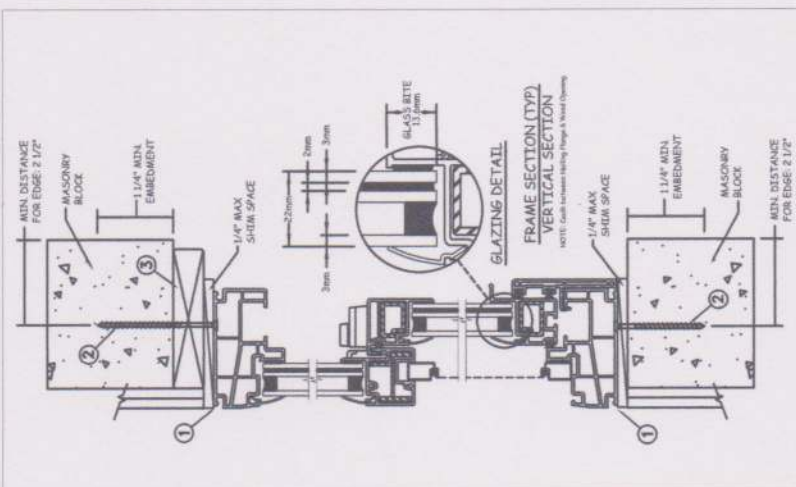

PREMIUM ATLANTIC VINYL SH WINDOW

Max Frame	DP RATING IMPACT
36 x 72	+65/-70
	YES

LARGE MISSILE IMPACT

Installation Notes:

1. Seal flange/frame to substrate.
2. Use 3/16" ITW Tapcon or equivalent fasteners through frame with sufficient length to penetrate a minimum of 1 1/4" into concrete or masonry at each location with a 2 1/2" min from edge distance. For concrete (min. f'c = 3000psi) or masonry substrate (CMU shall adhere to ASTM C90).
3. Host structure (wood buck, masonry, steel) to be designed and anchored to properly transfer all loads to the structure. The host structure is the responsibility of the architect or engineer of record for the project of installation.

This schedule addresses only the fasteners required to anchor the window to achieve the rated design pressure up to the size limitations noted. It is not intended as a guide to the installation process and does not address the sealing consideration that may arise in different wall conditions. For the complete installation procedure, see the instructions packaged with the window or go to www.jeld-wen.com/resources/installation.

DISCLAIMER:

This drawing and its contents are confidential and are not to be reproduced or copied in whole or in part or used or disclosed to others except as authorized by JELD-WEN Inc.

General Notes:

1. The product shown herein is designed, tested and manufactured to comply with the wind load criteria of the adopted International Building Code(IBC), the International Residential Code(IRC), the Florida Building Code (FBC) including HVHZ and the industry requirement for the stated conditions. All glazing shall conform to ASTM E1300.
2. At minimum, glazing is 3mm annealed - 11mm airspace - 3mm annealed - 2mm PVB Interlayer by DuPont - 3mm annealed.
3. Use structural or composite shims where required.



PROJECT ENGINEER:	DATE:
---	08/13/2014
DRAWN BY:	SCALE:
D. Vezo	NTS
CHECKED BY:	TITLE:
J. Kantola	
APPROVED BY:	
PART/PROJECT No.:	
D008729	
IDENTIFIER No.:	
NCTL210-3875-1	

3737 Lakeport Blvd
Klamath Falls, OR. 97601
Phone: (541) 882-3451

Premium Atlantic Vinyl Impact Single Hung Window

CAD DWG. No.:	REV:	SHEET
	00	2 OF 3

STEEL INSTALLATION

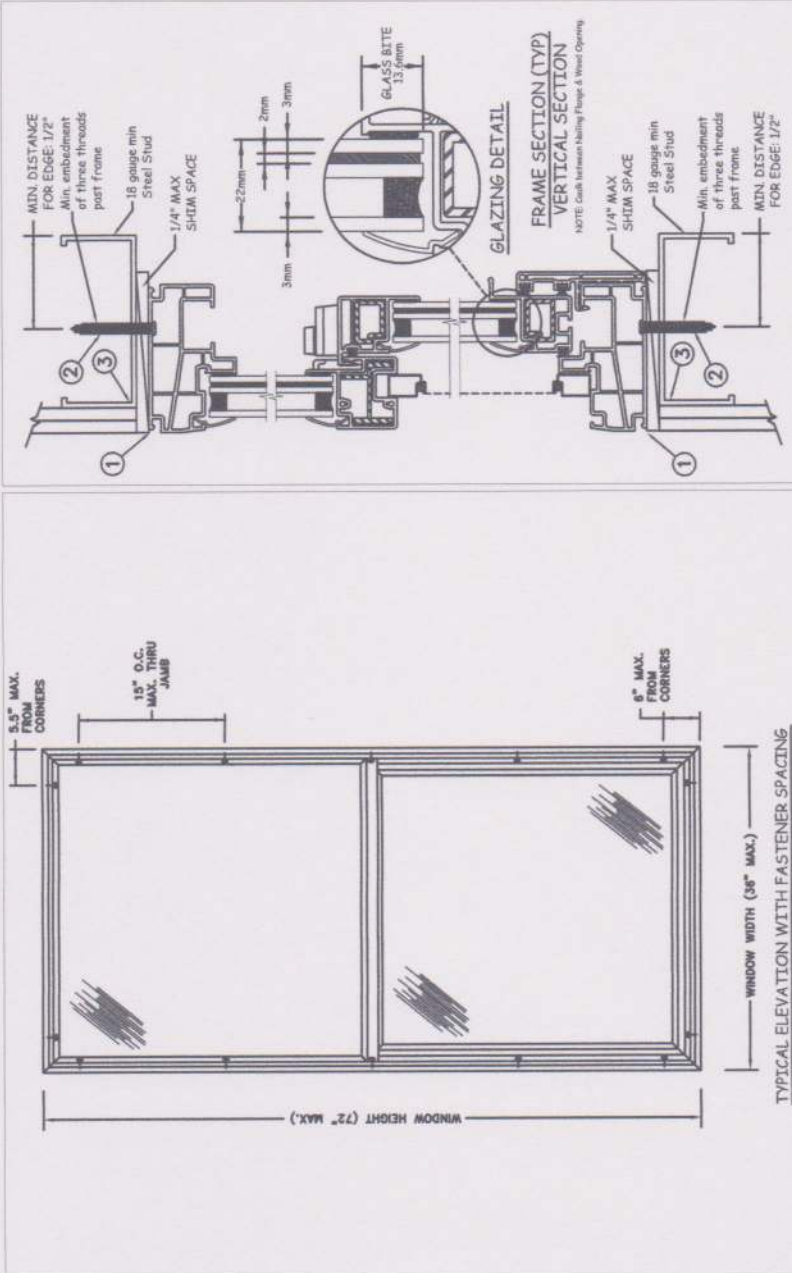

PREMIUM ATLANTIC VINYL SH WINDOW

Max Frame	DP RATING	IMPACT
36 x 72	+65/-70	YES

LARGE MISSILE IMPACT

General Notes:

- The product shown herein is designed, tested and manufactured to comply with the wind load criteria of the adopted International Building Code(IBC), the International Residential Code(IRC), the Florida Building Code (FBC) including HVHZ and the industry requirement for the stated conditions.
- All glazing shall conform to ASTM E1300.
- At minimum, glazing is 3mm annealed - 11mm airspace - 3mm annealed - 2mm PVB Interlayer by DuPont - 3mm annealed.
- Use structural or composite shims where required.

Installation Notes:

- Seal flange/frame to substrate.
- For anchoring into metal framing use #8 TEK Self Tapping screws with sufficient length to achieve a minimum embedment of three threads past the frame thickness. Steel substrate min. 18ga., fy = 33 ksi.
- Host structure (wood buck, masonry, steel) to be designed and anchored to properly transfer all loads to the structure. The host structure is the responsibility of the architect or engineer of record for the project of installation.

This schedule addresses only the fasteners required to anchor the window to achieve the rated design pressure up to the size limitations noted. It is not intended as a guide to the installation process and does not address the sealing consideration that may arise in different wall conditions. For the complete installation procedure, see the instructions packaged with the window or go to www.jeld-wen.com/resources/installation.

DISCLAIMER:

This drawing and its contents are confidential and are not to be reproduced or copied in whole or in part or used or disclosed to others except as authorized by JELD-WEN Inc.



PROJECT ENGINEER:	DATE: 08/13/2014
DRAWN BY: D. VEZO	SCALE: NTS
CHECKED BY: J. Kantola	TITLE:
APPROVED BY:	
PART/PROJECT No.: D008729	
IDENTIFIER No.: NCTL210-3875-1	

JELD-WEN
3737 Lakeport Blvd
Klamath Falls, OR. 97601
Phone: (541) 882-3451

Premium Atlantic Vinyl Impact Single Hung Window

PLANT NAME AND LOCATION: CAD DWG. No.: REV: 00 SHEET 3 OF 3