

G.K. Brooks  
 185 SW Precision Loop  
 Lake City

N ↑ 1" = 30'

21-0755

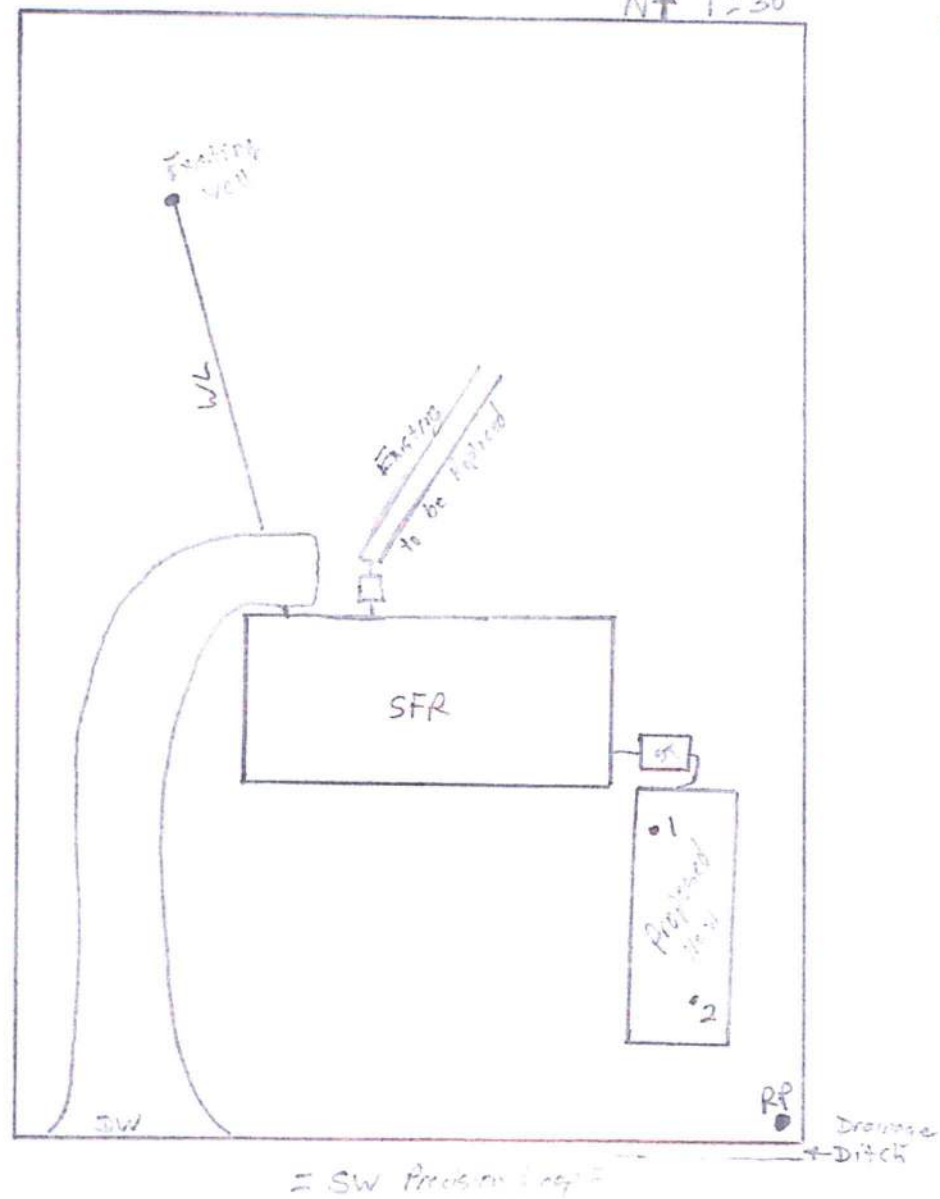

Neighbors Well

\* New home in same location as existing.

*[Signature]*  
 9-10-21

*[Signature]*  
 19-2064  
 9-10-21

Kell Rogers  
 9/16/2021  
 Columbia CHD



STATE OF FLORIDA  
DEPARTMENT OF HEALTH  
ONSITE SEWAGE TREATMENT AND DISPOSAL  
SYSTEM  
APPLICATION FOR CONSTRUCTION PERMIT

PERMIT NO: 21-0755  
DATE PAID: 9/11/21  
FEE PAID: 185.00  
RECEIPT #: 1730164

APPLICATION FOR:

[ ] New System [X] Existing System [ ] Holding Tank [ ] Innovative  
[ ] Repair [ ] Abandonment [ ] Temporary [ ]

APPLICANT: G. R. Brooks

AGENT: Tommy Jones

TELEPHONE: 352-221-4473

MAILING ADDRESS: 1490 NE 130th St. Trenton, FL. 32693

TO BE COMPLETED BY APPLICANT OR APPLICANT'S AUTHORIZED AGENT. SYSTEMS MUST BE CONSTRUCTED BY A PERSON LICENSED PURSUANT TO 489.105(3) (m) OR 489.552, FLORIDA STATUTES. IT IS THE APPLICANT'S RESPONSIBILITY TO PROVIDE DOCUMENTATION OF THE DATE THE LOT WAS CREATED OR PLATTED (MM/DD/YY) IF REQUESTING CONSIDERATION OF STATUTORY GRANDFATHER PROVISIONS.

PROPERTY INFORMATION

LOT: 18 BLOCK: \_\_\_\_\_ SUBDIVISION: Shady Acres PLATTED: \_\_\_\_\_

PROPERTY ID #: 27-45-16-03216-118 ZONING: \_\_\_\_\_ I/M OR EQUIVALENT: [ No ]

PROPERTY SIZE: .5 ACRES WATER SUPPLY: [K] PRIVATE PUBLIC [ ] <=2000GPD [ ] >2000GPD

IS SEWER AVAILABLE AS PER 381.0065, FS? [ No ] DISTANCE TO SEWER: \_\_\_\_\_ FT

PROPERTY ADDRESS: 385 SW Precision Loop Lake City, 32024

DIRECTIONS TO PROPERTY: "See attached"

BUILDING INFORMATION

[K] RESIDENTIAL [ ] COMMERCIAL

Unit No	Type of Establishment	No. of Bedrooms	Building Area Sqft	Commercial/Institutional System Design Table 1, Chapter 64E-6, FAC
---------	-----------------------	-----------------	--------------------	--------------------------------------------------------------------

1	<u>New - SFR MH</u>	<u>3</u>	<u>1508</u>	
---	---------------------	----------	-------------	--

2	<u>Replacng - SFR</u>	<u>3</u>	<u>1104</u>	
---	-----------------------	----------	-------------	--

3				
---	--	--	--	--

4				
---	--	--	--	--

ORIGINAL ATTACHED

[ ] Floor/Equipment Drains [ ] Other (Specify) \_\_\_\_\_

SIGNATURE: [Signature]

DATE: 9-10-21





STATE OF FLORIDA  
DEPARTMENT OF HEALTH  
ONSITE SEWAGE TREATMENT AND DISPOSAL  
SYSTEM

E-MAILED  
Tummy

PERMIT #: 12-SC-2369763  
APPLICATION #: AP1730166  
DATE PAID: 9/14/2021  
FEE PAID: 1800  
RECEIPT #: 12-PR-5239019  
DOCUMENT #: PR1648799

CONSTRUCTION PERMIT FOR: OSTDS Repair  
APPLICANT: G.R.\*\*21-0755 BROOKS  
PROPERTY ADDRESS: 385 SW PRECISION Lake City, FL 32024  
LOT: 18 BLOCK: SUBDIVISION: Shady Acres  
PROPERTY ID #: 03216-118 [SECTION, TOWNSHIP, RANGE, PARCEL NUMBER]  
[OR TAX ID NUMBER]

SYSTEM MUST BE CONSTRUCTED IN ACCORDANCE WITH SPECIFICATIONS AND STANDARDS OF SECTION 381.0065, F.S., AND CHAPTER 64E-6, F.A.C. DEPARTMENT APPROVAL OF SYSTEM DOES NOT GUARANTEE SATISFACTORY PERFORMANCE FOR ANY SPECIFIC PERIOD OF TIME. ANY CHANGE IN MATERIAL FACTS, WHICH SERVED AS A BASIS FOR ISSUANCE OF THIS PERMIT, REQUIRE THE APPLICANT TO MODIFY THE PERMIT APPLICATION. SUCH MODIFICATIONS MAY RESULT IN THIS PERMIT BEING MADE NULL AND VOID. ISSUANCE OF THIS PERMIT DOES NOT EXEMPT THE APPLICANT FROM COMPLIANCE WITH OTHER FEDERAL, STATE, OR LOCAL PERMITTING REQUIRED FOR DEVELOPMENT OF THIS PROPERTY.

SYSTEM DESIGN AND SPECIFICATIONS

T [ 900 ] GALLONS / GPD New Sentic CAPACITY  
A [ 0 ] GALLONS / GPD CAPACITY  
N [ 0 ] GALLONS GREASE INTERCEPTOR CAPACITY [MAXIMUM CAPACITY SINGLE TANK:1250 GALLONS]  
K [ ] GALLONS DOSING TANK CAPACITY [ ] GALLONS @ [ ] DOSES PER 24 HRS #Pumps [ ]

D [ 225 ] SQUARE FEET New drainfield SYSTEM  
R [ 0 ] SQUARE FEET SYSTEM  
A TYPE SYSTEM: [X] STANDARD [ ] FILLED [ ] MOUND [ ]  
I CONFIGURATION: [X] TRENCH [ ] BED [ ]

F LOCATION OF BENCHMARK: Nail with pink ribbon in oak SE corner of property

I ELEVATION OF PROPOSED SYSTEM SITE [ 42.00 ] [ INCHES ] FT [ ] ABOVE [ ] BELOW BENCHMARK/REFERENCE POINT  
E BOTTOM OF DRAINFIELD TO BE [ 66.00 ] [ INCHES ] FT [ ] ABOVE [ ] BELOW BENCHMARK/REFERENCE POINT

D FILL REQUIRED: [ 0.00 ] INCHES EXCAVATION REQUIRED: [ ] INCHES

O The system is sized for 3 bedrooms with a maximum occupancy of 6 persons (2 per bedroom), for a total estimated flow of 300 gpd. Required drainfield area based on rule 64E-6.015(6)(c)2. Install a new drainfield to achieve Drainfield size requirement.  
T EH recommends 375 SQFT of drainfield based on current code.  
H  
E  
R

SPECIFICATIONS BY: Kameron Keen TITLE: CEHP  
APPROVED BY: Kelli Rogers TITLE: Environmental Specialist II Columbia CHD  
DATE ISSUED: 09/16/2021 EXPIRATION DATE: 12/16/2021  
DH 4016, 08/09 (Obsoletes all previous editions which may not be used)  
Incorporated: 64E-6.003, FAC

SK