



Engineers • Planners

161 N.W. Madison St., Suite 102
Lake City, Florida 32055
Tel: 386-758-4209
Fax: 386-758-4290

6/19/06

Columbia County Building Dept.
Lake City, FL. 32055

RE: Permit # 000024235 and Permit # 000024233

To Whom it may Concern:

Please find the connection detail for the common truss connection to the 2-ply girder truss. The 2-ply girder shall support the entire reaction from the common truss. This shall be used on both houses being constructed on Lot 39 and Lot 41 of three rivers estates.

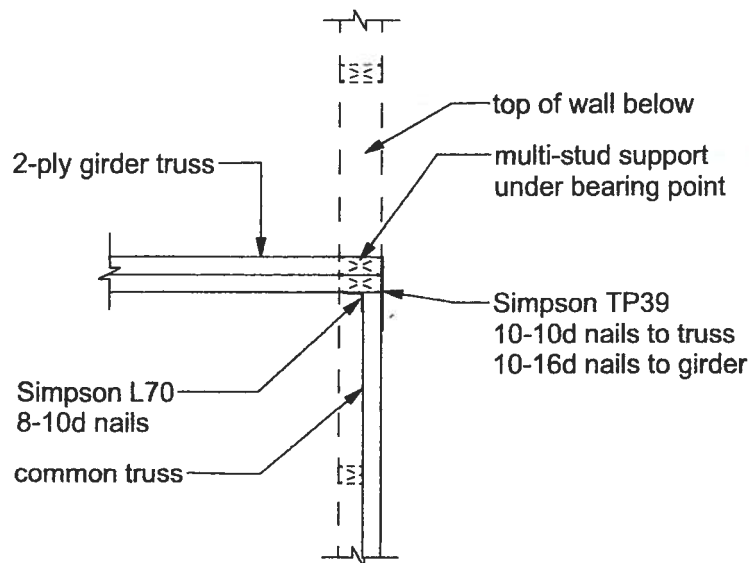

PLAN VIEW

SCALE: 3/4" = 1'-0"

Sincerely,

William H. Freeman, P.E. #56001
Certificate of Auth. #00008701