

TITLE				
The Reeves Residence 2366 SW Fry Ave Ft. White, FL 32038				
DRAWN BY Mike Jones CRC1332861	SHEET NAME		PAGE	
	Existing		1 OF 4	
	CREATED DATE	REVISED DATE	SCALE	
	4/12/2021	3/21/2022	1/4" = 1'-0"	
FILENAME REEVES - Layout Drawings - Permitting - 02-01-2022.vsdw				
			© 2020 by Universal Design Solutions All rights reserved These drawings are not to be reproduced or copied in any form whatsoever without the prior written consent of Universal Design Solutions.	

Drawing Sheet Index				
1.	As-Is / Demolition			
2.	Proposed Floor Plan			
3.	Floorplan Detail			
4.	Electrical Plan			

TITLE

The Reeves Residence
2366 SW Fry Ave
Ft. White, FL 32038

DRAWN BY

Mike Jones
CRC1332861

SHEET NAME

Proposed Floorplan

PAGE

2 OF 4

FILENAME

REEVES - Layout Drawings - Permitting - 02-01-2022 vsdx

CREATED DATE

4/12/2021

REVISED DATE

3/21/2022

SCALE

1/4" = 1'-0"

© 2020 by Universal Design Solutions

All rights reserved
These drawings are not to be reproduced or copied in any form whatsoever without the prior written consent of Universal Design Solutions.

Drawing Sheet Index			
1.	As-Is / Demolition		
2.	Proposed Floor Plan		
3.	Floorplan Detail		
4.	Electrical Plan		

Door Schedule							
Number	Width	Height	Type	Light	Handing	Panel Thickness	
1	72 in.	80 in.	Exterior	Exterior French	Full w/ Internal Blinds	Exterior Right Hand Outswing	1.5 in.
2	36 in.	80 in.	Exterior	Exterior Single	Full w/ Internal Blinds	Exterior Right Hand Outswing	1.5 in.
3	36 in.	80 in.	Interior	Interior 6 panel hollow core	None	Interior Left Hand	1.5 in.

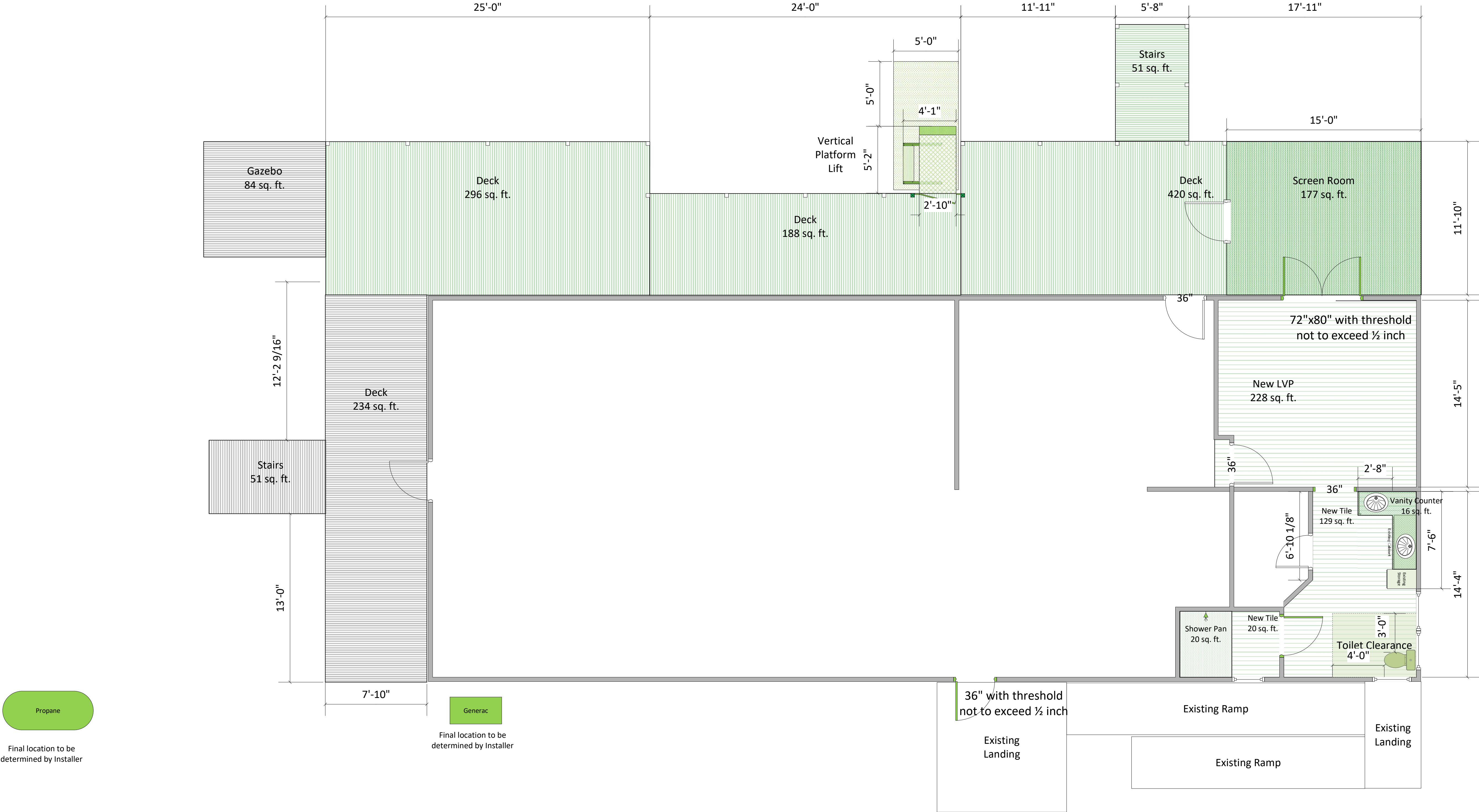

Propane

Final location to be determined by Installer

Generac

Final location to be determined by Installer

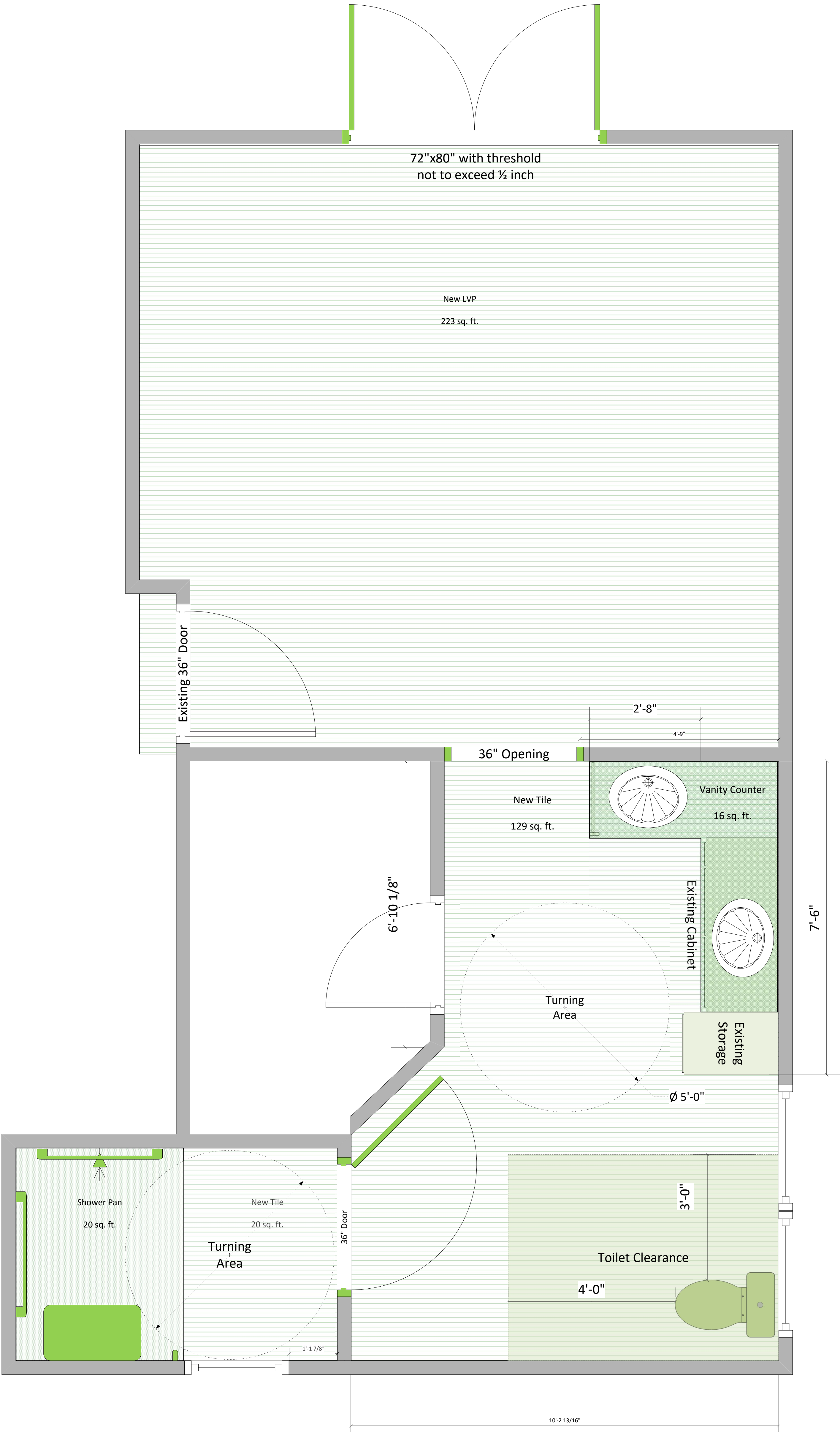

Drawing Sheet Index	
1.	As-Is / Demolition
2.	Proposed Floor Plan
3.	Floorplan Detail
4.	Electrical Plan

