



STATE OF FLORIDA
DEPARTMENT OF ENVIRONMENTAL PROTECTION
ON-SITE SEWAGE TREATMENT AND DISPOSAL
SYSTEM (OSTDS)

PERMIT NO: 1933445
DATE PAID: 1/27/23
FEE PAID: 225.00
RECEIPT #: 1933445

APPLICATION FOR CONSTRUCTION PERMIT

APPLICATION FOR:

<input type="checkbox"/> New System	<input type="checkbox"/> Existing System	<input type="checkbox"/> Holding Tank	<input type="checkbox"/> Innovative
<input type="checkbox"/> Repair	<input type="checkbox"/> Abandonment	<input type="checkbox"/> Temporary	<input type="checkbox"/>

APPLICANT: Christine W. Fadeley EMAIL: christine32643@gmail.com

AGENT: _____ TELEPHONE: 352-231-2410

MAILING ADDRESS: 122 Salazar Lane, Sebastian, FL 32958

TO BE COMPLETED BY APPLICANT OR APPLICANT'S AUTHORIZED AGENT. SYSTEMS MUST BE CONSTRUCTED BY A PERSON LICENSED PURSUANT TO 489.105(3) (m) OR 489.552, FLORIDA STATUTES. IT IS THE APPLICANT'S RESPONSIBILITY TO PROVIDE DOCUMENTATION OF THE DATE THE LOT WAS CREATED OR FLATTED (MM/DD/YY) IF REQUESTING CONSIDERATION OF STATUTORY GRANDFATHER PROVISIONS.

PROPERTY INFORMATION

LOT: 20 BLOCK: SUBDIVISION: Old Wire Farms OSTDS REMEDIATION PLAN? [Y / N]
I don't know. PLATTED: 02/13/1990

PROPERTY ID #: 14-6S-16-03818-120 ZONING: I'm not sure I/M OR EQUIVALENT: [Y / N] I don't know.
 Hopefully, you can obtain the Zoning from the attached property appraiser record.
 PROPERTY SIZE: 4.1 ACRES WATER SUPPLY: [X] PRIVATE PUBLIC [] <=2000GPD [] >2000GPD

IS SEWER AVAILABLE AS PER 381.0065, FS? [Y / N] There are no improvements on the property. DISTANCE TO SEWER: _____ FT

PROPERTY ADDRESS: 1145 SW Homestead Circle, Fort White, FL 32038

DIRECTIONS TO PROPERTY: Map included as an attachment to this application. If not legible, you can find the map at Google Maps. The property (4.1 acres) is unimproved at this time other than a driveway and land clearing for house, septic system, and well. I have submitted my electric system permit. The approval of the electric permit is pending approval of this septic system septic permit.

BUILDING INFORMATION		[X] RESIDENTIAL	[] COMMERCIAL
Unit No	Type of Establishment	No. of Bedrooms	Building Area Sqft
1	Future Manufactured Home Site (Floor Plan attached)	3	1699
2			
3	Shed	0	384
4			

[] Floor/Equipment Drains [] Other (Specify) _____
SIGNATURE: CW Fadelley DATE: 01/26/2023

DEF 4015, 06-21-2022 (Obsoletes previous editions which may not be used)
Incorporated 62-6.004, FAC

E-MAILED
-bt2
-owner

Revision # 2

STATE OF FLORIDA
DEPARTMENT OF ENVIRONMENTAL PROTECTION
APPLICATION FOR CONSTRUCTION PERMIT

1145 SW Homestead Circle
Fort White, FL 32038
Permit Application Number 58836
PART II - SITEPLAN
Fadeley

Scale: Each block represents 10 feet and 1 inch = 40 feet

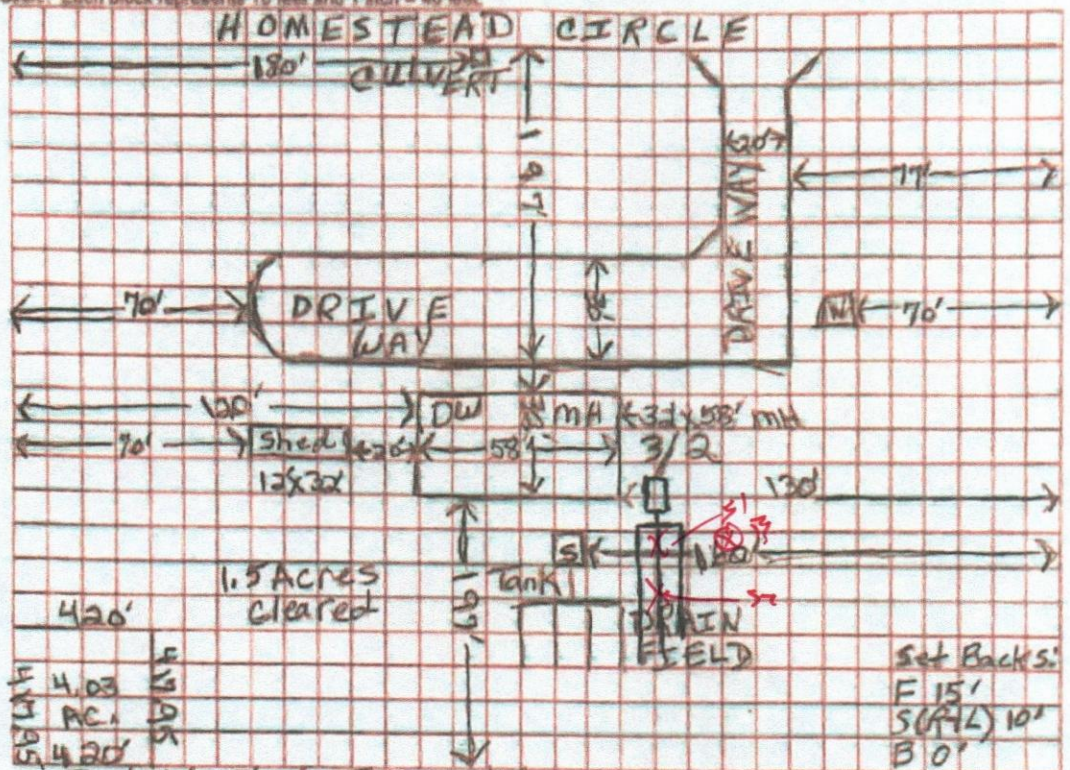

Notes: Portable Shed. To be used for storage.

Site Plan submitted by: Property owner CW Fadeley 02/17/2023

Plan Approved [Signature] Not Approved [Signature] Date 2/23/22
By [Signature] County Health Department

ALL CHANGES MUST BE APPROVED BY THE COUNTY HEALTH DEPARTMENT

DEP 4015, 06-21-2022 (Obsoletes previous editions which may not be used)
Incorporated: 62-6.004, F.A.C.

REVISED
2/23/23

CW Fadeley
02/22/2023