

Permit #139339

OFFICE OF THE
BUILDING INSPECTOR
COLUMBIA COUNTY, FLORIDA



INSTRUCTIONS:

1. Fill out this form completely. Just because you have spoken with the power company does not change the information needed by the Building Department.
2. Bring this completed form to the Building Department. The inspection fee is \$50.00. Once the form and payment are received the inspection will be set up for the date requested.

You must also contact your power company to coordinate their disconnection with our inspection date, so the power is not off for a long time period. The Building Department will automatically release your power to the power company if the inspection passes.

INSPECTION DATE REQUESTED _____

NOTE: Inspections are scheduled for the day after it is received. Therefore make your request at least one day before you will be disconnecting power.

PROPERTY OWNER INFORMATION:

NAME Ronnie Hart PHONE 386-288-8329

OTHER NAME _____

911 ADDRESS 911 NW White Springs Ave. White Springs FL 32096

SUBDIVISION Parkmeadow 8D Lot 32

DIRECTIONS R-US 41N 12.7mi, L-SR136 0.3mi,

L-White Springs Ave 1.5mi, on Left

CONTRACTOR Donald Hollingsworth PHONE 386-755-5944

CONTRACTOR LICENSE NUMBER EC13005429

THIS IS AN AUTHORIZATION TO:

☐ SERVICE CHANGE TO MH-Power Pole (EX: House, Mobile Home, Shed)

METER # 90 508 3104

*** OR AN (Only one is required. Meter or Account #.)

ACCOUNT # _____

POWER COMPANY: (Check the Power Company Name)

- ☐ CLAY ELECTRIC
- ☐ FLORIDA POWER & LIGHT
- ☒ SUWANNEE VALLEY ELECTRIC
- ☐ DUKE ENERGY
- ☐ SLASH PINE ELECTRIC

Inspected By _____

Release Number _____

Revised 7-1-15

____ Fee

135 NE Hernando Ave, Lake City, FL 32056
Phone: 386-758-1008 ~ Fax: 386-758-2160

Columbia County Property Appraiser

Jeff Hampton

2020 Working Values

updated: 2/11/2020

Parcel: << 19-2S-16-01654-032 >>

Owner & Property Info

Owner	HART RONNIE 911 NW WHITE SPRINGS AVE WHITE SPRINGS, FL 320967439		
Site	881 WHITE SPRINGS AVE, WHITE SPRINGS		
Description*	LOT 32 PARKMEADOW S/D. 645-558, AG 908-780, WD 1127- 1142, PB 1388-1326,		
Area	4.02 AC	S/T/R	19-2S-16
Use Code**	MOBILE HOM (000200)	Tax District	3

*The Description above is not to be used as the Legal Description for this parcel in any legal transaction.

**The Use Code is a FL Dept. of Revenue (DOR) code and is not maintained by the Property Appraiser's office. Please contact your city or county Planning & Zoning office for specific zoning information.

Property & Assessment Values

2019 Certified Values		2020 Working Values	
Mkt Land (5)	\$31,750	Mkt Land (5)	\$31,750
Ag Land (0)	\$0	Ag Land (0)	\$0
Building (1)	\$10,136	Building (1)	\$10,634
XFOB (11)	\$5,200	XFOB (11)	\$5,200
Just	\$47,086	Just	\$47,584
Class	\$0	Class	\$0
Appraised	\$47,086	Appraised	\$47,584
SOH Cap [?]	\$8,337	SOH Cap [?]	\$0
Assessed	\$38,749	Assessed	\$47,584
Exempt	HX H3 \$25,000	Exempt	HX H3 \$25,000
Total	county:\$11,019	Total	county:\$22,584
Taxable	city:\$11,019	Taxable	city:\$22,584
	other:\$11,019		other:\$22,584
	school:\$13,749		school:\$22,584

Aerial Viewer Pictometry Google Maps

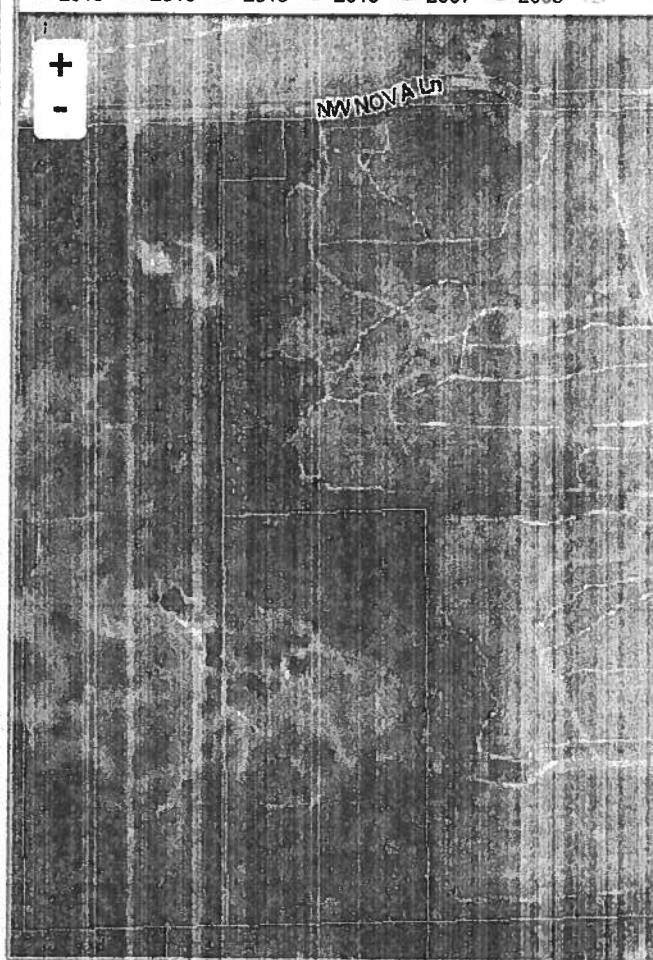
☒ 2019
 ☐ 2016
 ☐ 2013
 ☐ 2010
 ☐ 2007
 ☐ 2005
 ☒ Sales

Sales History

Sale Date	Sale Price	Book/Page	Deed	V/I	Quality (Codes)	RCode
7/8/2019	\$0	1388/1326	PB	I	U	18
8/1/2007	\$25,000	1127/1142	WD	I	U	04
8/9/2000	\$47,400	908/0780	AG	I	U	01
3/1/1988	\$10,000	645/0558	WD	V	U	

Building Characteristics

Bldg Sketch	Bldg Item	Bldg Desc*	Year Blt	Base SF	Actual SF	Bldg Value
Sketch	1	MOBILE HME (000800)	1989	960	1152	\$10,634

*Bldg Desc determinations are used by the Property Appraisers office solely for the purpose of determining a property's Just Value for ad valorem tax purposes and should not be used for any other purpose.

Extra Features & Out Buildings (Codes)

Code	Desc	Year Blt	Value	Units	Dims	Condition (% Good)
0040	BARN,POLE	2005	\$600.00	1.000	0 x 0 x 0	(000.00)
0294	SHED WOOD/	2005	\$300.00	1.000	0 x 0 x 0	(000.00)
0296	SHED METAL	2005	\$800.00	1.000	0 x 0 x 0	(000.00)
0294	SHED WOOD/	2013	\$800.00	1.000	0 x 0 x 0	(000.00)
0252	LEAN-TO W/	2013	\$200.00	1.000	0 x 0 x 0	(000.00)