

Mobile Home Permit Worksheet

Installer: Dale Houston License # 141133271

Address of home being installed _____

Manufacturer Franklin Length x width 32 x 80

NOTE: If home is a single wide fill out one half of the blocking plan
If home is a triple or quad wide sketch in remainder of home
I understand Lateral Arm Systems cannot be used on any home (new or used)
where the sidewall ties exceed 5 ft 4 in.

Installer's initials DH

Typical pier spacing

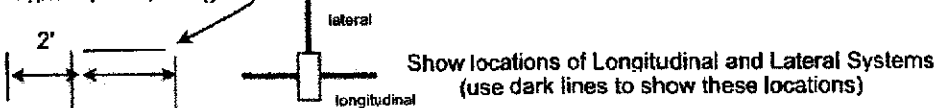

Diagram showing the layout of the mobile home with piers and walls. The layout is a grid of 8 rows and 16 columns. The first 4 rows are labeled 'longitudinal' and the last 4 rows are labeled 'lateral'. The diagram shows the locations of piers and walls. A note indicates 'marriage wall piers within 2' of end of home per Rule 15C'. The bottom of the diagram is labeled 'See Attached Print'.

Application Number: _____ Date: _____

New Home ☒ Used Home ☐

Home installed to the Manufacturer's Installation Manual
Home is installed in accordance with Rule 15-C ☐

Single wide ☐ Wind Zone II ☒ Wind Zone III ☐

Double wide ☒ Installation Decal # 112133

Triple/Quad ☐ Serial # ALPSJ34417941A0

PIER SPACING TABLE FOR USED HOMES

Load bearing capacity	Footer size (sq in)	16' x 16' (256)	18 1/2" x 18 1/2" (342)	20" x 20" (400)	22" x 22" (484)*	24" x 24" (576)*	26" x 26" (676)
1000 psf		3'	4'	5'	6'	7'	8'
1500 psf		4' 6"	6'	7'	8'	8'	8'
2000 psf		6'	8'	8'	8'	8'	8'
2500 psf		7' 6"	8'	8'	8'	8'	8'
3000 psf		8'	8'	8'	8'	8'	8'
3500 psf		8'	8'	8'	8'	8'	8'

* interpolated from Rule 15C-1 pier spacing table.

PIER PAD SIZES

I-beam pier pad size 23 x 31

Perimeter pier pad size 16 x 16

Other pier pad sizes (required by the mfg.) _____

Draw the approximate locations of marriage wall openings 4 foot or greater. Use this symbol to show the piers.

List all marriage wall openings greater than 4 foot and their pier pad sizes below.

Opening	Pier pad size
<u>1, 2, 3, 4</u>	<u>23 x 31</u>
_____	_____
_____	_____

TIEDOWN COMPONENTS

Longitudinal Stabilizing Device (LSD)

Manufacturer Olin

Longitudinal Stabilizing Device w/ Lateral Arms

Manufacturer Olin

POPULAR PAD SIZES

Pad Size	Sq In
16 x 16	256
16 x 18	288
18.5 x 18.5	342
16 x 22.5	360
17 x 22	374
13 1/4 x 26 1/4	348
20 x 20	400
17 3/16 x 25 3/16	441
17 1/2 x 25 1/2	446
24 x 24	576
26 x 26	676

ANCHORS

4 ft 5 ft @ marriage tie

FRAME TIES

within 2' of end of home spaced at 5' 4" oc

OTHER TIES

	Number
Sidewall	<u>514</u>
Longitudinal	<u>10</u>
Marriage wall	<u>10</u>
Shearwall	<u>2/1</u>

Mobile Home Permit Worksheet

POCKET PENETROMETER TEST

The pocket penetrometer tests are rounded down to _____ psf or check here to declare 1000 lb. soil ☒ without testing.

X _____ X _____ X _____

POCKET PENETROMETER TESTING METHOD

1. Test the perimeter of the home at 6 locations.
2. Take the reading at the depth of the footer.
3. Using 500 lb. increments, take the lowest reading and round down to that increment.

X _____ X _____ X _____

TORQUE PROBE TEST

The results of the torque probe test is _____ inch pounds or check here if you are declaring 5' anchors without testing _____. A test showing 275 inch pounds or less will require 5 foot anchors.

Note: A state approved lateral arm system is being used and 4 ft. anchors are allowed at the sidewall locations. I understand 5 ft anchors are required at all centerline tie points where the torque test reading is 275 or less and where the mobile home manufacturer may requires anchors with 4000 lb holding capacity.

DN Installer's Initials

ALL TESTS MUST BE PERFORMED BY A LICENSED INSTALLER

Installer Name Dale Houston

Date Tested _____

Electrical

Connect electrical conductors between multi-wide units, but not to the main power source. This includes the bonding wire between multi-wide units. Pg. 50

Plumbing

Connect all sewer drains to an existing sewer tap or septic tank. Pg. 48

Connect all potable water supply piping to an existing water meter, water tap, or other independent water supply systems. Pg. 79

Application Number: _____ Date: _____

Site Preparation

Debris and organic material removed ☒
Water drainage: Natural _____ Swale _____ Pad ☒ Other _____

Fastening multi wide units

Floor: Type Fastener: Lag Length: 6" Spacing: 24"
Walls: Type Fastener: Screw Length: 4.5" Spacing: 24"
Roof: Type Fastener: Screw Length: 4.5" Spacing: 24"
For used homes a min. 30 gauge, 8" wide, galvanized metal strip will be centered over the peak of the roof and fastened with galv. roofing nails at 2" on center on both sides of the centerline.

Gasket (weatherproofing requirement)

I understand a properly installed gasket is a requirement of all new and used homes and that condensation, mold, mildew and buckled marriage walls are a result of a poorly installed or no gasket being installed. I understand a strip of tape will not serve as a gasket.

Installer's Initials DH

Type gasket Foam Pad
Pg. 151

Installed:
Between Floors Yes ☒
Between Walls Yes ☒
Bottom of ridgebeam Yes ☒

Weatherproofing

The bottomboard will be repaired and/or taped. Yes ☒ Pg. 62
Siding on units is installed to manufacturer's specifications. Yes ☒
Fireplace chimney installed so as not to allow intrusion of rain water. Yes N/A

Miscellaneous

Skirting to be installed. Yes ☒ No ☒
Dryer vent installed outside of skirting. Yes ☒ N/A
Range downflow vent installed outside of skirting. Yes ☒
Drain lines supported at 4 foot intervals. Yes ☒
Electrical crossovers protected. Yes ☒
Other: _____

Installer verifies all information given with this permit worksheet is accurate and true based on the manufacturer's installation instructions and or Rule 15C-1 & 2

Installer Signature Dale Houston

Date 7/19/24

SOID#: 228136
 DEALER: CLAYTON, LAKE CITY
 CUSTOMER: LIMA
 DATE: 7/14/23 @ 11:15AM

THESE DESIGNS ARE FOR ESTIMATE
 "ONLY". NOT FOR CONSTRUCTION
 AND ARE SUBJECT TO CHANGE.

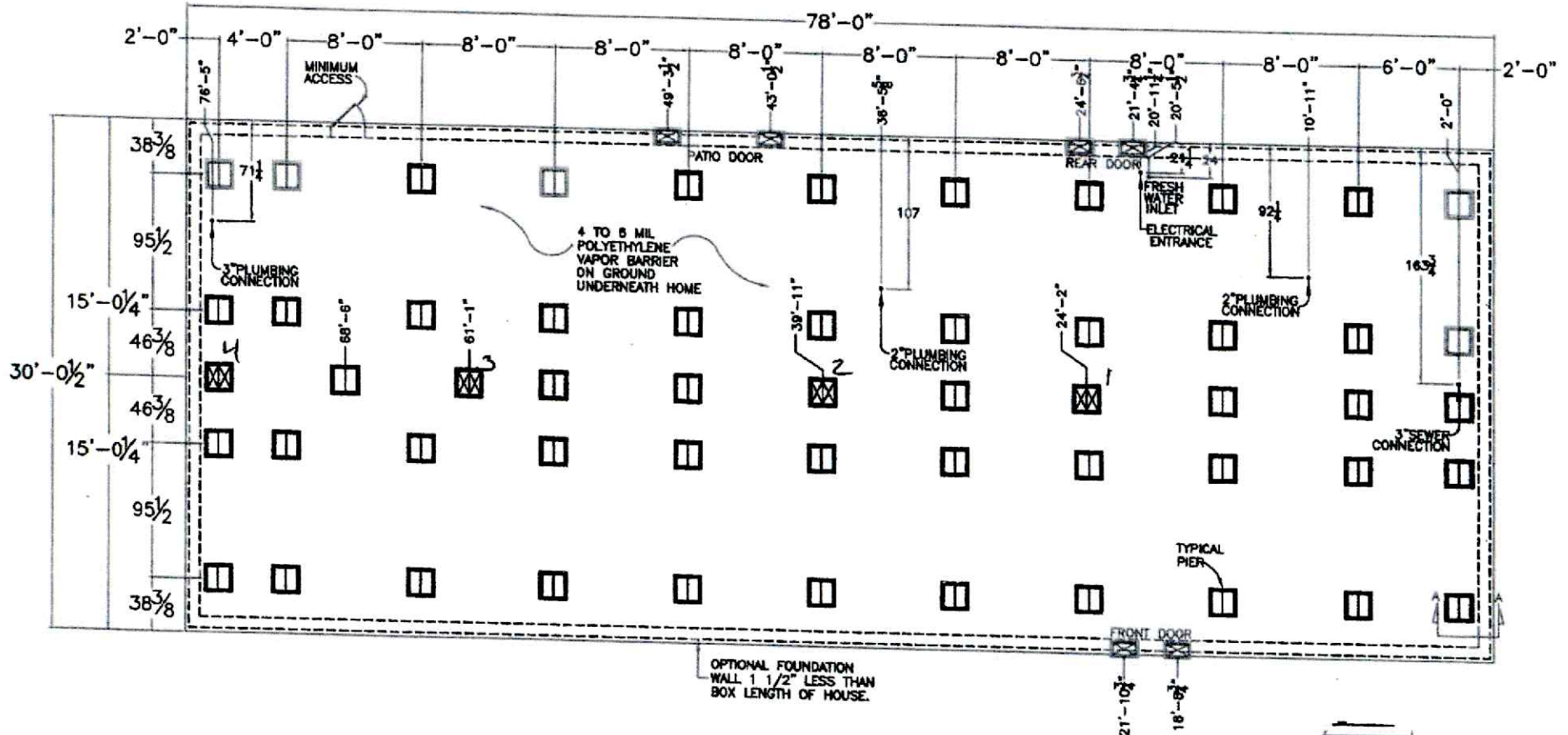

NOTES:

1. ALL INFORMATION SHOWN ON THIS PAGE IS DONE AT SITE BY OTHERS.
2. BOTTOM OF FOOTING TO REST ON UNDISTURBED SOIL, BELOW FROST LEVEL BUT NO LESS THAN 12" BELOW GRADE. (FOOTING AND FOUNDATION WALL TO COMPLY WITH ALL REQUIREMENTS OF STATE/CITY/ BUILDING CODE.)
3. REFER TO THE FRANKLIN HOMES, INC. SET-UP MANUAL FOR FOOTING, PIER DESIGN, AND SITE PREPARATION, ETC.
4. THESE DESIGNS ARE ILLUSTRATIVE IN NATURE, FOUNDATION DESIGN TO BE COMPLETED BY LOCAL ENGINEER FOUNDATION TO BE BUILT ON-SITE BY LOCAL CONTRACTOR

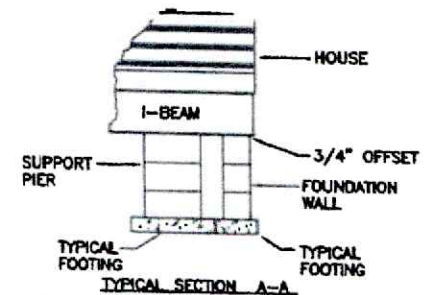

REVISION:		BY: CANDY	DATE: 7/14/23		FRANKLIN HOMES, INC. RUSSELLVILLE, ALABAMA TITLE: 95.1/2" I-BEAM SPACING BLOCKING/FOUNDATION DETAIL FD-1017-82-4-32		NO. 300 SERIAL NO: 228136
		CHECKED:					
		SCALE:	N.T.S.				

Peregrino

License Number: IH / 1133271 / 1 Name: DALE HOUSTON

Order #: 6286	Label #: 112133	Manufacturer:	(Check Size of Home)
Homeowner:	Year Model:	Single	_____
Address:	Length & Width:	Double	_____
City/State/Zip:	Type Longitudinal System:	Triple	_____
Phone #:	Type Lateral Arm System:	HUD Label #:	_____
Date Installed:	New Home: _____ Used Home: _____	Soil Bearing / PSF:	_____
Installed Wind Zone:	Data Plate Wind Zone:	Torque Probe / in-lbs:	_____
Note:		Permit #:	_____

STATE OF FLORIDA
INSTALLATION CERTIFICATION LABEL

112133

LABEL #

DATE OF INSTALLATION

DALE HOUSTON

NAME

IH / 1133271 / 1

6286

LICENSE #

ORDER #

CERTIFIES THAT THE INSTALLATION OF THIS MOBILE HOME IS
IN ACCORDANCE WITH FLORIDA STATUTES 320.8249, 320.8325
AND RULES OF THE HIGHWAY SAFETY AND MOTOR VEHICLES

INSTRUCTIONS

PLEASE WRITE DATE OF
INSTALLATION AND AFFIX
LABEL NEXT TO HUD LABEL.
USE PERMANENT INK PEN
OR MARKER ONLY.
COMPLETE INFORMATION
ABOVE AND KEEP ON FILE
FOR A MINIMUM OF 2 YEARS.
YOU ARE REQUIRED TO
PROVIDE COPIES WHEN
REQUESTED.