



# COLUMBIA COUNTY PRODUCT APPROVAL SPECIFICATION SHEET

As required by Florida Statute 553.842 and Florida Administrative Code 9B-72, please provide the information and approval numbers on the building components listed below if they will be utilized on the construction project for which you are applying for a building permit. We recommend you contact your local product supplier should you not know the product approval number for any of the applicable listed products. Statewide approved products are listed online at [www.floridabuilding.org](http://www.floridabuilding.org).

Category/Subcategory	Manufacturer	Product Description	Approval Number(s)
1. EXTERIOR DOORS			
A. SWINGING			
B. SLIDING			
C. SECTIONAL/ROLL UP			
D. OTHER			
2. WINDOWS			
A. SINGLE/DOUBLE HUNG	Wincore	Double Hung	15819.8
B. HORIZONTAL SLIDER			
C. CASEMENT			
D. FIXED			
E. MULLION			
F. SKYLIGHTS			
G. OTHER			
3. PANEL WALL			
A. SIDING			
B. SOFFITS			
C. STOREFRONTS			
D. GLASS BLOCK			
E. OTHER			
4. ROOFING PRODUCTS			
A. ASPHALT SHINGLES			
B. NON-STRUCT METAL			
C. ROOFING TILES			
D. SINGLE PLY ROOF			
E. OTHER			
5. STRUCT COMPONENTS			
A. WOOD CONNECTORS			
B. WOOD ANCHORS			
C. TRUSS PLATES			
D. INSULATION FORMS			
E. LINTELS			
F. OTHERS			
6. NEW EXTERIOR			
A. ENVELOPE PRODUCTS			

The products listed below did not demonstrate product approval at plan review. I understand that at the time of inspection of these products, the following information must be available to the inspector on the jobsite: (1) copy of the product approval (2) performance characteristics which the product was tested and certified to comply with (3) copy of the applicable manufacturer's installation requirements. Further, I understand these products may have to be removed if approval cannot be demonstrated during inspection.

APPLICANT SIGNATURE

1/24/2024

DATE



**Product Approval**  
USER: Public User

[Product Approval Menu](#) > [Product or Application Search](#) > **Application List**

OFFICE OF THE  
SECRETARY

### Search Criteria

Code Version	2023	FL #	15819.8
Application Type	ALL	Product Manufacturer	ALL
Category	ALL	Subcategory	ALL
Application Status	ALL	Compliance Method	ALL
Quality Assurance Entity	ALL	Quality Assurance Entity Contract Expired	ALL
Product Model, Number or Name	ALL	Product Description	ALL
Approved for use in HVHZ	ALL	Approved for use outside HVHZ	ALL
Impact Resistant	ALL	Design Pressure	ALL
Other	ALL		ALL

[Refine Search](#)

### Search Results - Applications

FL #	Type	Manufacturer	Validated By	Status
<a href="#">FL15819-R12</a> <a href="#">History</a>	Revision	Wincore Window Company, LLC FL #: FL15819.8 Model: h. 7700 / 9000 Series Vinyl Double Hung Window Description: Extruded PVC Double Hung Window with "Non-Impact" Insulated Glass Category: Windows Subcategory: Double Hung	Ryan J. King, P.E. (813) 767-6555	Approved

\*Approved by DBPR. Approvals by DBPR shall be reviewed and ratified by the POC and/or the Commission if necessary.

[Contact Us](#) :: [2601 Blair Stone Road, Tallahassee FL 32399](#) Phone: 850-487-1824

The State of Florida is an AA/EEO employer. [Copyright 2007-2013 State of Florida.](#) :: [Privacy Statement](#) :: [Accessibility Statement](#) :: [Refund Statement](#)

Under Florida law, email addresses are public records. If you do not want your e-mail address released in response to a public-records request, do not send electronic mail to this entity. Instead, contact the office by phone or by traditional mail. If you have any questions, please contact 850-487.1395. \*Pursuant to Section 455.275(1), Florida Statutes, effective October 1, 2012, licensees licensed under Chapter 455, F.S., must provide the Department with an email address if they have one. The emails provided may be used for official communication with the licensee. However email addresses are public record. If you do not wish to supply a personal address, please provide the Department with an email address which can be made available to the public. To determine if you are a licensee under Chapter 455, F.S., please click [here](#).

#### Product Approval Accepts:



[DBPR HOME](#) / [ABOUT DBPR](#) / [DBPR DIVISIONS](#) / [CONTACT DBPR](#)



250 Staunton Turnpike, Parkersburg, WV 26104

## 7700 / 9900 Series Vinyl Double Hung Window "NON-IMPACT"

### GENERAL NOTES

- This product has been evaluated and is in compliance with the 8th Edition (2023) Florida Building Code (FBC) structural requirements excluding the "High Velocity Hurricane Zone" (HVHZ).
- Product anchors shall be as listed and spaced as shown on details. Anchor embedment to base material shall be beyond wall dressing or stucco.
- When used in areas requiring wind borne debris protection this product is required to be protected with an impact resistant covering that complies with FBC Sections 1609.1.2 & R301.2.1.2.
- For 2x stud framing construction, anchoring of these units shall be the same as that shown for 2x buck masonry construction.
- Site conditions that deviate from the details of this drawing require further engineering analysis by a licensed engineer or registered architect.

TABLE OF CONTENTS

SHEET#	DESCRIPTION
1	Typical elevations, design pressures and general notes
2	Horizontal cross sections
3	Vertical cross sections
4	Buck and frame anchoring
5	Bill of materials, components & glazing details

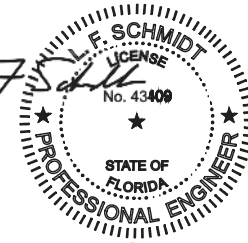
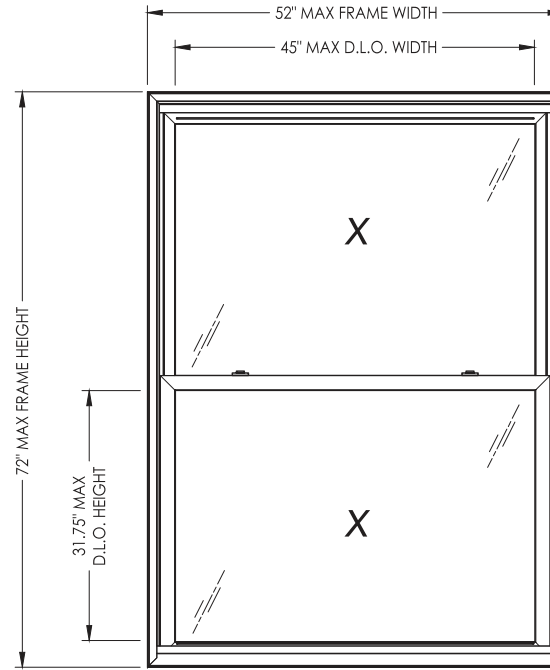

Digitally signed by Lyndon F Schmidt  
Date: 2023.07.06 10:02:20 -04'00'

This item has been digitally signed and sealed by  
L. F. Schmidt, P.E. on the date adjacent to the seal.  
Printed copies of this document are not  
considered signed and sealed and the signature  
must be verified on any electronic copies.

THIS PRODUCT APPROVAL IS VALID  
ONLY FOR THE STATE OF FLORIDA

MAX. FRAME DIMENSION	MAX. D.L.O. DIMENSION	GLASS TYPE	DESIGN PRESSURE (PSF)	
			POSITIVE	NEGATIVE
32.0" X 58.0"	25.0" X 24.75"	G1, G2	+55.0	-55.0
52.0" X 40.0"	45.0" X 15.75"	G1, G2	+45.0	-45.0
48.0" X 42.0"	41.0" X 16.75"	G1, G2	+45.0	-45.0
44.0" X 46.0"	37.0" X 18.75"	G1, G2	+45.0	-45.0
40.0" X 52.0"	33.0" X 21.75"	G1, G2	+45.0	-45.0
36.0" X 56.0"	29.0" X 23.75"	G1, G2	+45.0	-45.0
32.0" X 64.0"	25.0" X 27.75"	G1, G2	+45.0	-45.0
52.0" X 44.0"	45.0" X 17.75"	G1, G2	+40.0	-40.0
48.0" X 48.0"	41.0" X 19.75"	G1, G2	+40.0	-40.0
44.0" X 52.0"	37.0" X 21.75"	G1, G2	+40.0	-40.0
40.0" X 58.0"	33.0" X 24.75"	G1, G2	+40.0	-40.0

MAX. FRAME DIMENSION	MAX. D.L.O. DIMENSION	GLASS TYPE	DESIGN PRESSURE (PSF)	
			POSITIVE	NEGATIVE
36.0" X 64.0"	29.0" X 27.75"	G1, G2	+40.0	-40.0
32.0" X 70.0"	25.0" X 30.75"	G1, G2	+40.0	-40.0
52.0" X 50.0"	45.0" X 20.75"	G1, G2	+35.0	-35.0
48.0" X 54.0"	41.0" X 22.75"	G1, G2	+35.0	-35.0
44.0" X 60.0"	37.0" X 25.75"	G1, G2	+35.0	-35.0
40.0" X 66.0"	33.0" X 28.75"	G1, G2	+35.0	-35.0
36.0" X 72.0"	29.0" X 31.75"	G1, G2	+35.0	-35.0
52.0" X 60.0"	45.0" X 25.75"	G1, G2	+30.0	-30.0
48.0" X 64.0"	41.0" X 27.75"	G1, G2	+30.0	-30.0
44.0" X 70.0"	37.0" X 30.75"	G1, G2	+30.0	-30.0
40.0" X 72.0"	33.0" X 31.75"	G1, G2	+30.0	-30.0
52.0" X 72.0"	45.0" X 31.75"	G1, G2	+25.0	-25.0

Documents Prepared By:  
Lyndon F. Schmidt  
P.E. No. 43409

PRODUCT:  
7700 / 9900 SERIES  
Vinyl Double Hung Window  
PART OR ASSEMBLY:  
TYPICAL ELEVATION, DESIGN  
PRESSURES & GENERAL NOTES

6	7/06/23	UPDATE TO 8TH ED. (2023)	FBC	LFS
5	7/02/20	UPDATE TO 7TH ED. (2020)	FBC	LFS
4	6/01/17	UPDATE TO 6TH ED. (2017)	FBC	LFS
3	5/10/16	REVISE INSTALLATION SCREWS	LFS	
2	1/27/15	UPDATE TO 5TH ED. (2014)	FBC	JK
1	8/25/14	REVISE SERIES NO.		JK
NO.	DATE			BY
REVISIONS				
DATE: 6/23/14				
SCALE: N.T.S.				
DWG. BY: JK				
CHK. BY: LFS				
DRAWING NO.: FL-15819.8				
SHEET 1 OF 5				

RW BUILDING CONSULTANTS, INC.  
P.O. Box 230, Valrico, FL 33595  
Phone No.: 813.659.9197  
FBPE Registry No. 9813

Z:\2023 FBC Drawings\Wincore Window Company\FL-15819 R12\FL-15819.8.dwg

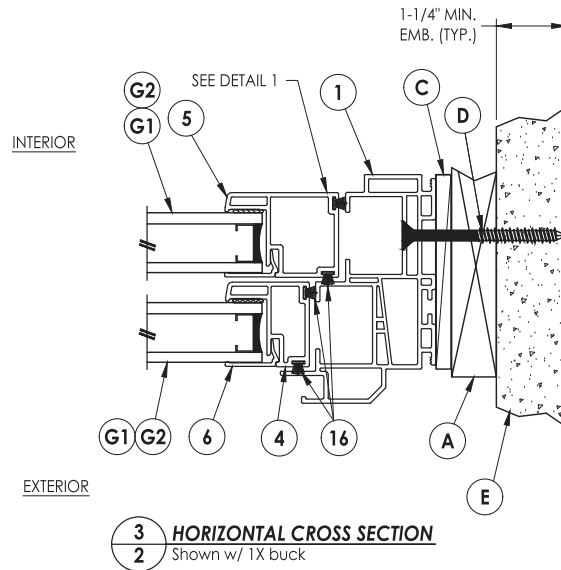
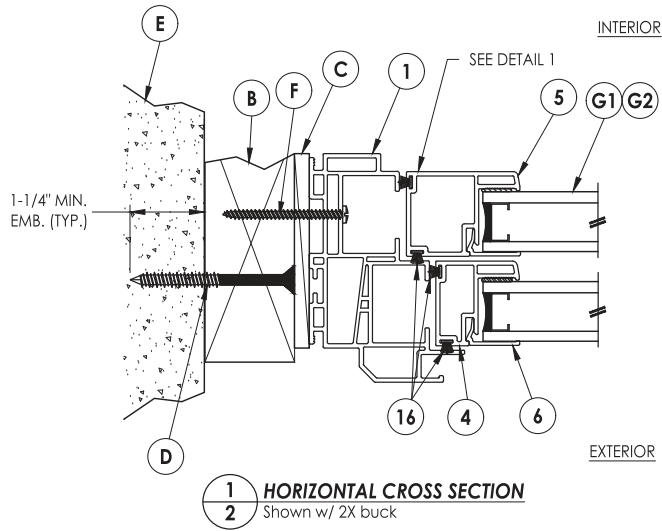
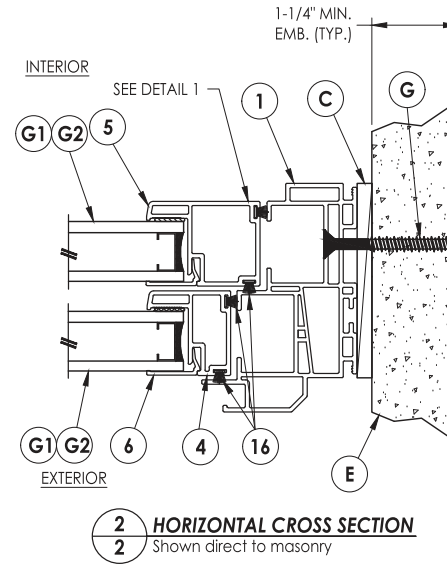
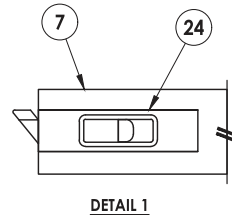
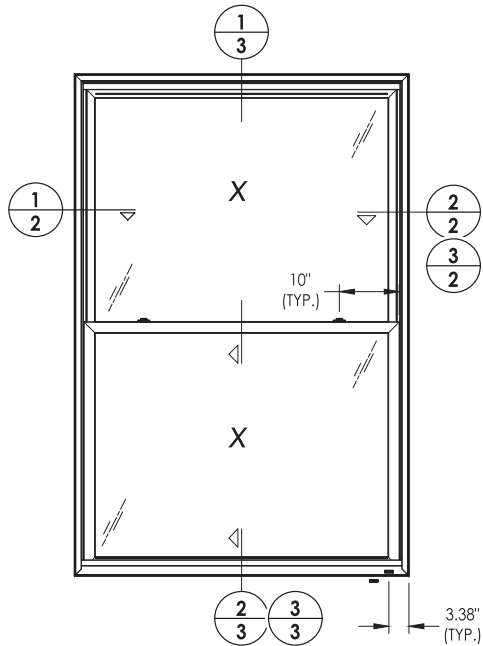

Documents Prepared By:		Lyndon F. Schmidt		P.E. No. 43409	
PRODUCT:		7700 / 9900 SERIES		Vinyl Double Hung Window	
PART OR ASSEMBLY:		HORIZONTAL		CROSS SECTIONS	
6	7/06/23	UPDATE TO 8TH ED.	(2023)	FBC	LFS
5	7/02/20	UPDATE TO 7TH ED.	(2020)	FBC	LFS
4	6/01/17	UPDATE TO 6TH ED.	(2017)	FBC	LFS
3	5/10/16	REVISE INSTALLATION SCREWS			LFS
2	1/27/15	UPDATE TO 5TH ED.	(2014)	FBC	LFS
1	8/25/14	REVISE SERIES NO.			JK
NO.		DATE		REVISIONS	
DATE:		6/23/14			
SCALE:		N.T.S.			
DWG. BY:		JK			
CHK. BY:		LFS			
DRAWING NO.:		FL-15819.8			
SHEET		2		OF 5	

RW BUILDING CONSULTANTS, INC.  
P.O. Box 230, Valrico, FL 33595  
Phone No.: 813.659.9197  
FBPE Registry No. 9813

Z:\2023 FBC Drawings\Wincore Window Company\FL-15819 R12\FL-15819.8.dwg

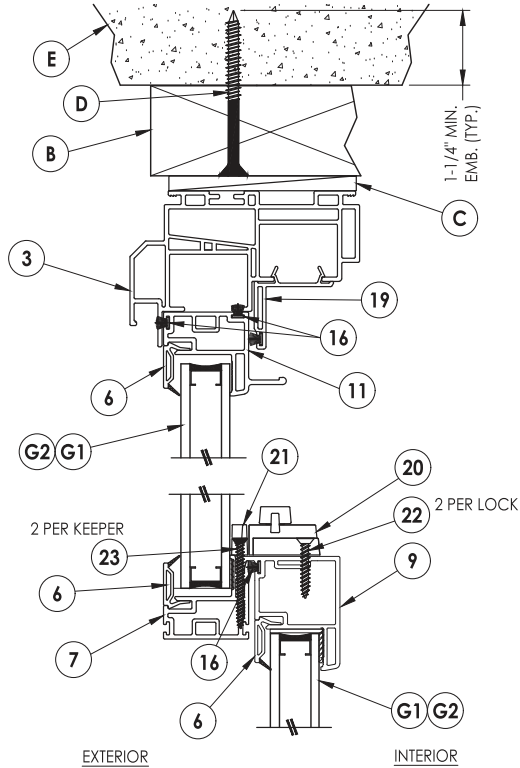

**1 VERTICAL CROSS SECTION**  
3 Shown w/ 2X buck

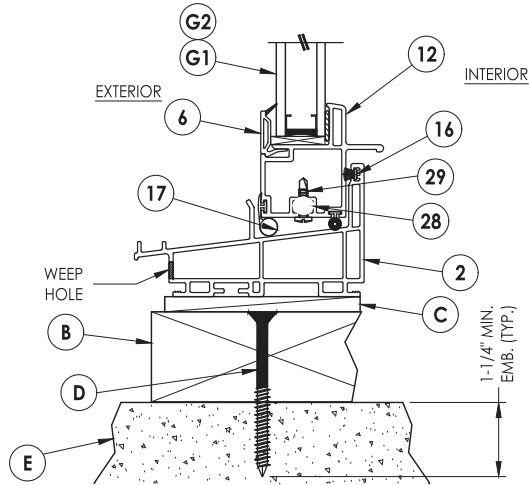

**2 VERTICAL CROSS SECTION**  
3 Shown w/ 2X buck

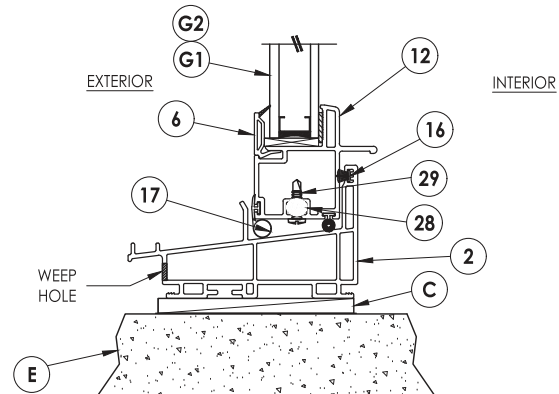

**3 VERTICAL CROSS SECTION**  
3 Shown direct to masonry

Documents Prepared By: Lyndon F. Schmidt P.E. No. 43409		PRODUCT: 7700 / 9900 SERIES Vinyl Double Hung Window		PART OR ASSEMBLY: VERTICAL CROSS SECTIONS		R.W. BUILDING CONSULTANTS, INC. P.O. Box 230, Valrico, FL 33595 Phone No.: 813.659.9197 FBPE Registry No. 9813	
6	7/06/23	UPDATE TO 8TH ED. (2023)	FBC	LFS	DATE	NO.	BY
5	7/02/20	UPDATE TO 7TH ED. (2020)	FBC	LFS			
4	6/01/17	UPDATE TO 6TH ED. (2017)	FBC	LFS			
3	5/10/16	REVISE INSTALLATION SCREWS	FBC	LFS			
2	1/27/15	UPDATE TO 5TH ED. (2014)	FBC	LFS			
1	8/25/14	REVISE SERIES NO.		JK			
REVISIONS							
DATE: 6/23/14							
SCALE: N.T.S.							
DWG. BY: JK							
CHK. BY: LFS							
DRAWING NO.: FL-15819.8							
SHEET 3 OF 5							

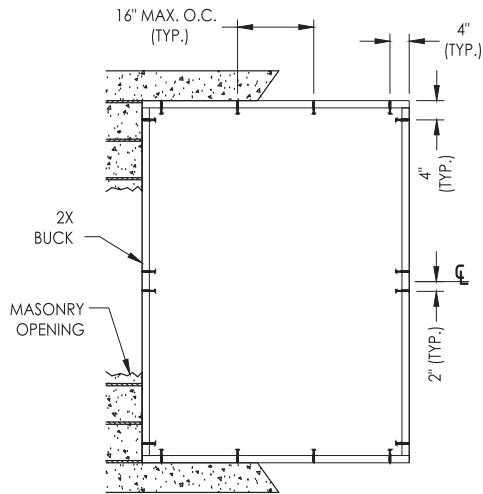

**BUCK ANCHORING**

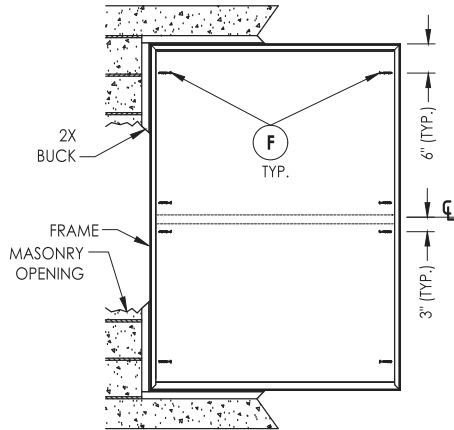

**FRAME ANCHORING**  
2X Buck

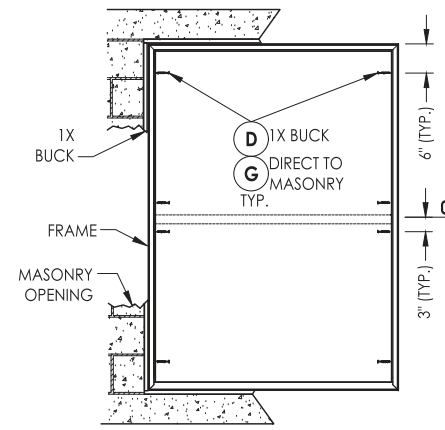

**FRAME ANCHORING**  
1X Buck  
Direct to masonry

**CONCRETE ANCHOR NOTES:**

- Concrete anchor locations at the corners may be adjusted to maintain the min. edge distance to mortar joints.
- Concrete anchor locations noted as "MAX. ON CENTER" must be adjusted to maintain the min. edge distance to mortar joints, additional concrete anchors may be required to ensure the "MAX. ON CENTER" dimensions are not exceeded.
- Concrete anchor table:

ANCHOR TYPE	ANCHOR SIZE	MIN. EMBEDMENT	MIN. CLEARANCE TO MASONRY EDGE	MIN. CLEARANCE TO ADJACENT ANCHOR
ITW TAPCON®	1/4"	1-1/4"	2"	4"
DeWALT ULTRACON®	1/4"	1-1/4"	1"	4"

**WOOD SCREW INSTALLATION NOTES:**

- Maintain a minimum 5/8" edge distance, 1" end distance, & 1" o.c. spacing of wood screws to prevent the splitting of wood.

Documents Prepared By:  
Lyndon F. Schmidt  
P.E. No. 43409

PRODUCT:  
7700 / 9900 SERIES  
Vinyl Double Hung Window

PART OR ASSEMBLY:  
BUCK AND  
FRAME ANCHORING

NO.	DATE	REVISIONS
6	7/06/23	UPDATE TO 8TH ED. (2023) FBC
5	7/02/20	UPDATE TO 7TH ED. (2020) FBC
4	6/01/17	UPDATE TO 6TH ED. (2017) FBC
3	5/10/16	REVISE INSTALLATION SCREWS
2	1/27/15	UPDATE TO 5TH ED. (2014) FBC
1	8/25/14	REVISE SERIES NO.

DATE: 6/23/14  
SCALE: N.T.S.  
DWG. BY: JK  
CHK. BY: LFS  
DRAWING NO.:  
FL-15819.8  
SHEET 4 OF 5

**RW BUILDING CONSULTANTS, INC.**  
P.O. Box 230, Valrico, FL 33595  
Phone No.: 813.659.9197  
FBPE Registry No. 9813

BILL OF MATERIALS		
ITEM #	DESCRIPTION	MATERIAL
A	1X BUCK SG >= 0.42	WOOD
B	2X BUCK SG >= 0.42	WOOD
C	1/4" MAX. SHIM SPACE	-
D	1/4" X 2-3/4" PFH DeWALT OR ITW CONCRETE SCREW	STEEL
E	MASONRY - 3,000 PSI MIN. CONCRETE CONFORMING TO ACI 301 OR HOLLOW BLOCK CONFORMING TO ASTM C90	CONCRETE
F	#8 X 2" PAN HEAD/TRUSS HEAD WOOD SCREW (1-3/8" MIN. EMBEDMENT)	STEEL
G	1/4" X 2-1/4" PFH DeWALT OR ITW CONCRETE SCREW	STEEL
1	FRAME JAMB* (DH 7701)	PVC
2	SILL* (DH 7703)	PVC
3	FRAME HEAD* (DH 7701)	PVC
4	UPPER SASH STILE* (SE 3035)	PVC
5	LOWER SASH STILE* (SE 3045)	PVC
6	GLAZING BEAD*	PVC
7	KEEPER RAIL UPPER SASH* (SE 3034)	PVC
9	LOCK RAIL LOWER SASH* (SE 3046)	PVC
11	TOP RAIL UPPER SASH* (SE 3037)	PVC
12	BOTTOM RAIL LOWER SASH* (SE 3047)	PVC
16	WEATHERSTRIP ULTRA FAB .270 PILE - 270 -1875B	-
17	WEATHERSTRIP SILLBULB (AMESBURY 32690)	-
19	HEAD ADAPTER* (DH 3005)	PVC
20	LOCK 8513 / 8845 LAWRENCE	PVC
21	KEEPER 2700 - 214 LAWRENCE	PVC
22	#8 X 1" PFH (VINYL LOCK SCREWS)	STEEL
23	#6 X 1-1/2" PFH (VINYL LOCK SCREWS)	STEEL
24	TOP SASH TILT LATCH - ASHLAND	PVC
28	PIVOT BAR - CALDWELL	-
29	#8 X 1/2" SELF TAPPING PPH SMS	STEEL

\* THE APPROVED WHITE RIGID PVC EXTRUSIONS FOR WINDOWS ARE TO BE PRODUCED BY EXTRUDERS LICENSEES IN "AAMA CERTIFICATION PROGRAMS FOR RIGID PVC EXTRUSIONS".

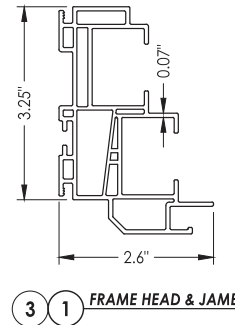

③ ① **FRAME HEAD & JAMB**

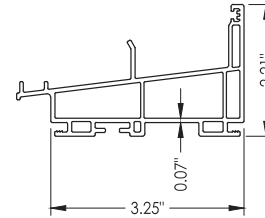

② **SILL**

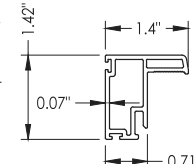

④ **SASH STILE**  
Top

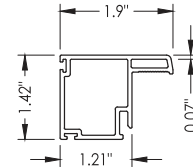

⑤ **SASH STILE**  
Bottom

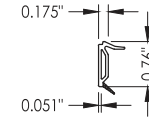

⑥ **GLAZING BEAD**

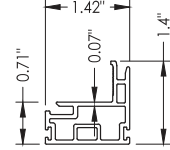

⑦ **KEEPER RAIL**  
Upper Sash

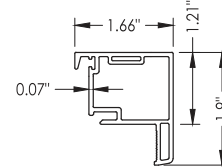

⑨ **LOCK RAIL**  
Lower Sash

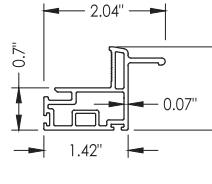

⑪ **TOP RAIL**  
Upper Sash

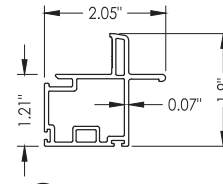

⑫ **BOTTOM RAIL**  
Lower Sash

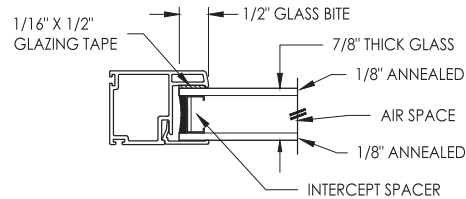

① **GLAZING DETAIL**  
(See General Note 3, Sheet 1)

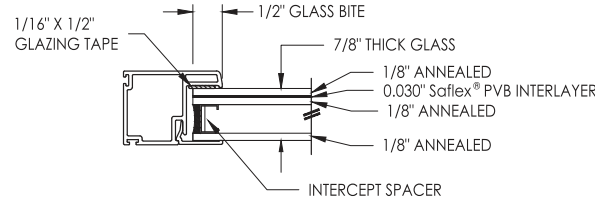

② **GLAZING DETAIL**  
(See General Note 3, Sheet 1)

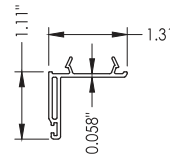

⑪ **HEAD ADAPTER**

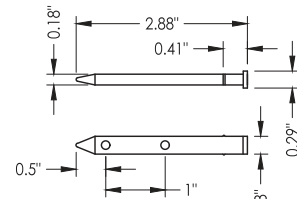

② **PIVOT BAR**

Documents Prepared By: Lyndon F. Schmidt P.E. No. 43409				<i>RW</i> BUILDING CONSULTANTS, INC. P.O. Box 230, Valrico, FL 33595 Phone No.: 813.659.9197 FBPE Registry No. 9813			
PRODUCT: 7700 / 9900 SERIES Vinyl Double Hung Window				PART OR ASSEMBLY: BILL OF MATERIALS COMPONENTS & GLAZING DETAIL			
6	7/06/23	UPDATE TO 8TH ED. (2023)	FBC	LFS	REVISIONS		
5	7/02/20	UPDATE TO 7TH ED. (2020)	FBC	LFS			
4	6/01/17	UPDATE TO 6TH ED. (2017)	FBC	LFS			
3	5/10/16	REVISE INSTALLATION SCREWS		LFS			
2	1/27/15	UPDATE TO 5TH ED. (2014)	FBC				
1	8/25/14	REVISE SERIES NO.		JK			
NO. DATE				BY			
DATE: 6/23/14							
SCALE: N.T.S.							
DWG. BY: JK							
CHK. BY: LFS							
DRAWING NO.: FL-15819.8							
SHEET 5 OF 5							