

SITE PLAN
IN SECTIONS 6 & 7
TOWNSHIP 3 SOUTH, RANGE 17 EAST
COLUMBIA COUNTY, FLORIDA

DESCRIPTION

The Southeast 1/4 of the Southwest 1/4 of Section 6, Township 3 South, Range 17 East, Columbia County, Florida, less and except the East 60 feet thereof.

TOGETHER WITH an easement for ingress and egress purposes, being 40 feet in width, lying 40 feet North of and adjacent to the following described line: COMMENCE at the Southwest corner of Section 6, Township 3 South, Range 17 East, Columbia County, Florida and run North 87°56'56" East along the South line of said Section 6 a distance of 940.42 feet to the POINT OF BEGINNING; thence continue North 87°56'56" East along the South line of said Section 6 a distance of 414.89 feet to the Southeast corner of the Southwest 1/4 of the Southwest 1/4 of said Section 6, and the TERMINAL POINT of herein described line.

AND an easement for ingress and egress purposes, being 40 feet in width, lying 20 feet left (East) of and 20 feet right (West) of the following described centerline: COMMENCE at the Northwest corner of Section 7, Township 3 South, Range 17 East, Columbia County, Florida and run North 87°56'56" East along the North line of said Section 7 a distance of 962.88 feet to the POINT OF BEGINNING; thence South 29°06'58" East a distance of 417.97 feet; thence South 02°52'57" West a distance of 126.60 feet; thence South 49°02'31" West a distance of 262.47 feet; thence South 52°41'43" West a distance of 500.62 feet; thence South 25°23'33" West a distance of 925.06 feet to the Northerly end of the maintained right-of-way of NW Moore Farm Road and the TERMINAL POINT of herein described centerline and easement.

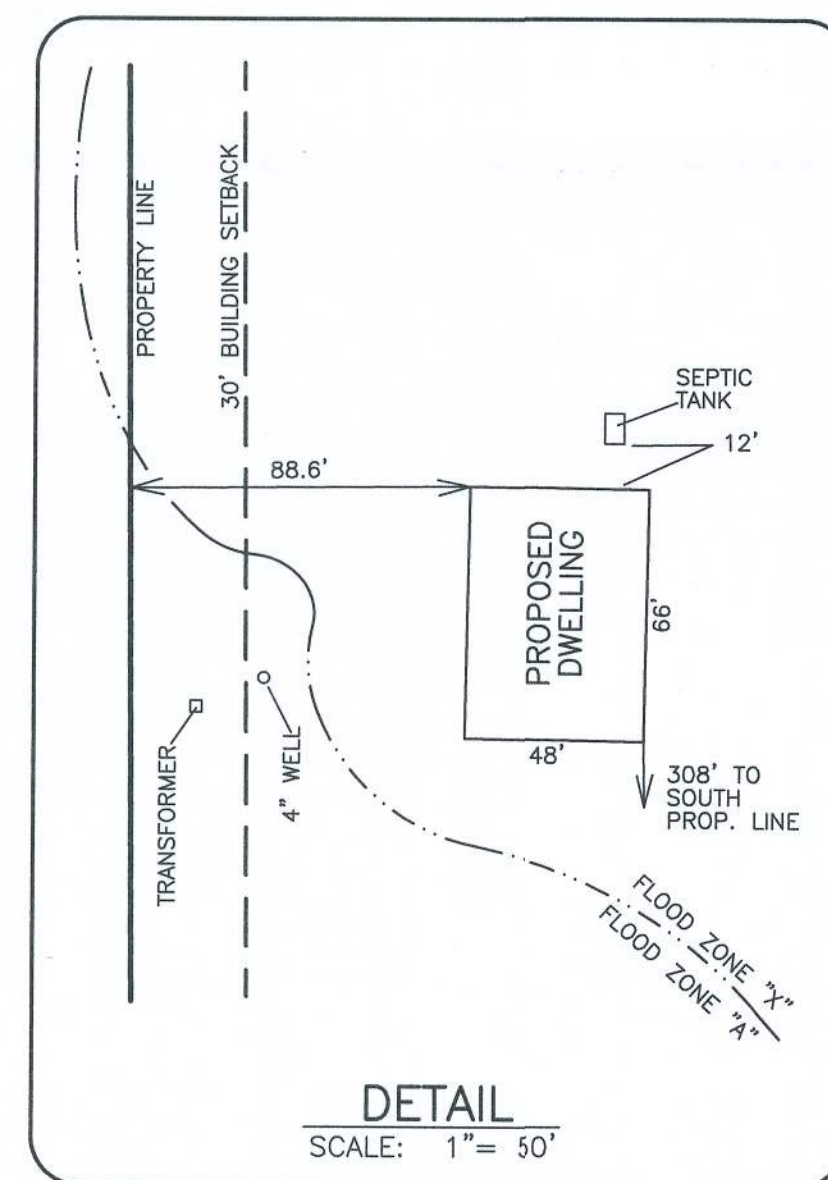

NOT A SURVEY

EASEMENT TO
NW MOORE
FARM ROAD

40' INGRESS/EGRESS EASEMENT
414.89'

WETLANDS

N 0°24'27" W
1326.94'

30' BUILDING SETBACK

PROPOSED DWELLING
(SEE DETAIL)

FLOOD ZONE "X"
FLOOD ZONE "A"

POND

POND AND RUN-OFF

25' BUILDING SETBACK

ZONING: A-3

TRAIL RD.

S 87°52'48" W
1288.55'

39.29 ACRES

SE 1/4 OF SW 1/4
SECTION 6
LESS EAST 60 FEET

WETLANDS & FLOOD ZONE "A"

WETLANDS & FLOOD ZONE "A"

FLOOD ZONE "X"
FLOOD ZONE "A"

FLOOD ZONE "X"
FLOOD ZONE "A"

1290.61'
N 87°56'56" E

WETLANDS

S 0°29'54" E
1328.43'

60.02'

60.02'

FILE: A-64-33

DATE: 9-19-19
W.O. No. 19-7276
CAD FILE: 7276.DWG
FOR: Emory Lane



Donald F. Lee and Associates, Inc.

SURVEYORS

140 Northwest Ridgewood Avenue, Lake City, Florida 32055
Phone: (386) 755-6166 FAX: (386) 755-6167
Certificate of Authorization # LB 7042

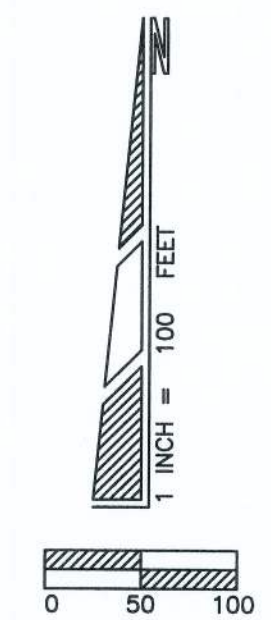

EAST 60 FEET OF
SE 1/4 OF SW 1/4
NOT A PART

East Line of
SE 1/4 OF SW 1/4