

DATE 10/18/2007**Columbia County Building Permit****PERMIT**

This Permit Expires One Year From the Date of Issue

000026340

APPLICANT RANDOLPH COLEMAN PHONE 386-454-1781
ADDRESS 366 SE COLEMAN LN HIGH SPRINGS FL 32643
OWNER WILLIAM COLEMAN PHONE 386-454-1781
ADDRESS 366 SE COLEMAN LN HIGH SPRINGS FL 32643
CONTRACTOR OWNER PHONE _____
LOCATION OF PROPERTY 441 S. L SE COLEMAN LN GO STRAIGHT AT THE 90 DEGREE CURVE
TO END ON THE END
TYPE DEVELOPMENT ~~MH, UTILITY~~ *Reconnection* ESTIMATED COST OF CONSTRUCTION 0.00
HEATED FLOOR AREA _____ TOTAL AREA _____ HEIGHT _____ STORIES _____
FOUNDATION _____ WALLS _____ ROOF PITCH _____ FLOOR _____
LAND USE & ZONING _____ MAX. HEIGHT _____
Minimum Set Back Requirments: STREET-FRONT _____ REAR _____ SIDE _____
NO. EX.D.U. 1 FLOOD ZONE NA DEVELOPMENT PERMIT NO. _____

PARCEL ID 15-7S-17-09989-000 SUBDIVISION _____
LOT _____ BLOCK _____ PHASE _____ UNIT _____ TOTAL ACRES 6.20

Randolph S. Coleman
Culvert Permit No. _____ Culvert Waiver _____ Contractor's License Number _____ Applicant/Owner/Contractor
EXISTING 07-820 LH LH N
Driveway Connection _____ Septic Tank Number _____ LU & Zoning checked by _____ Approved for Issuance _____ New Resident _____

COMMENTS: EXISTING MHCheck # or Cash CASH**FOR BUILDING & ZONING DEPARTMENT ONLY**

(footer/Slab)

Temporary Power _____ Foundation _____ Monolithic _____
date/app. by _____ date/app. by _____ date/app. by _____
Under slab rough-in plumbing _____ Slab _____ Sheathing/Nailing _____
date/app. by _____ date/app. by _____ date/app. by _____
Framing _____ Rough-in plumbing above slab and below wood floor _____
date/app. by _____ date/app. by _____
Electrical rough-in _____ Heat & Air Duct _____ Peri. beam (Lintel) _____
date/app. by _____ date/app. by _____ date/app. by _____
Permanent power _____ C.O. Final _____ Culvert _____
date/app. by _____ date/app. by _____ date/app. by _____
M/H tie downs, blocking, electricity and plumbing _____ Pool _____
date/app. by _____ date/app. by _____
Reconnection _____ Pump pole _____ Utility Pole _____
date/app. by _____ date/app. by _____ date/app. by _____
M/H Pole _____ Travel Trailer _____ Re-roof _____
date/app. by _____ date/app. by _____ date/app. by _____

BUILDING PERMIT FEE \$ 0.00 CERTIFICATION FEE \$ 0.00 SURCHARGE FEE \$ 0.00

26340

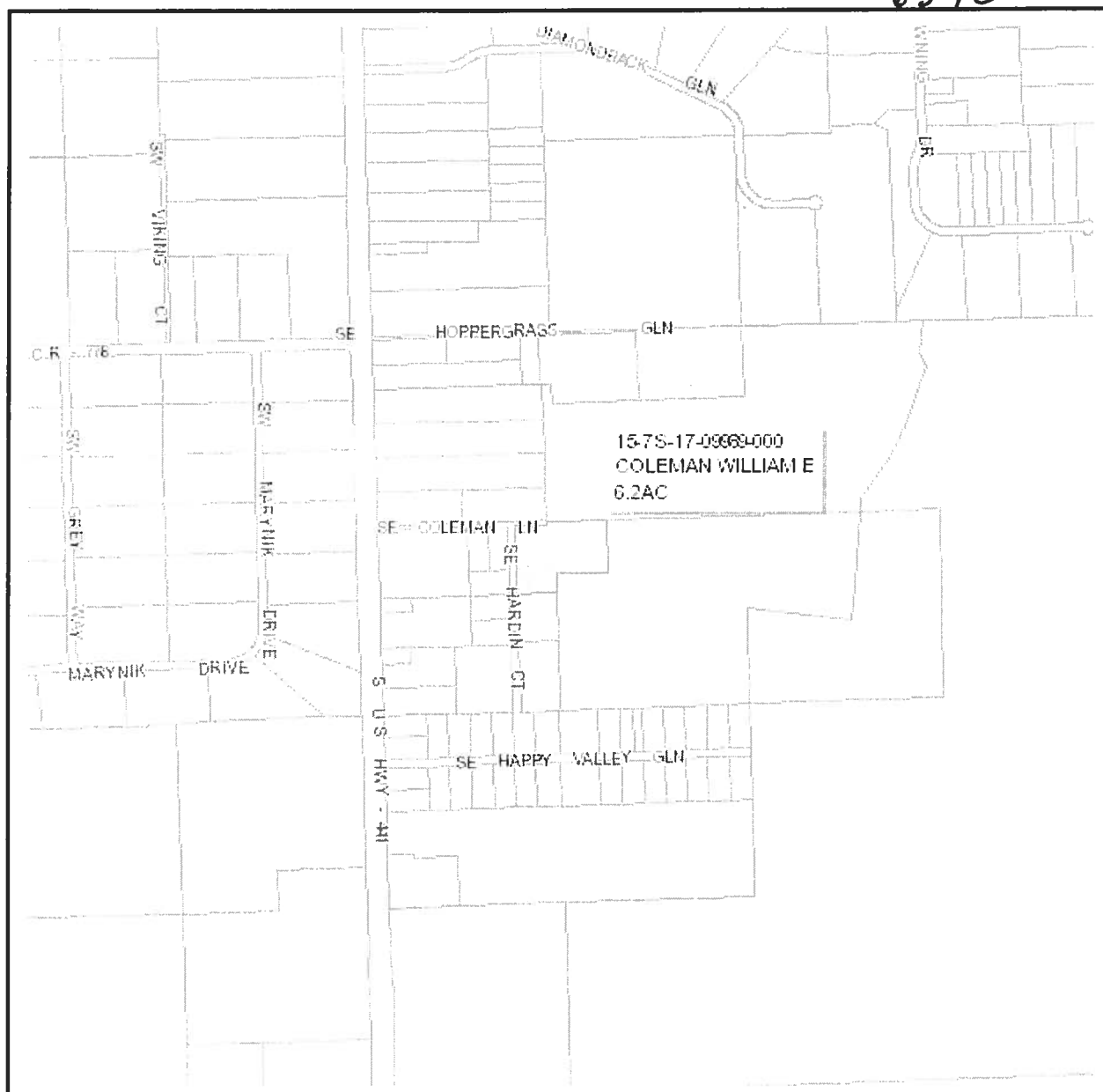

Columbia County Property Appraiser

J. Doyle Crews, C.T.A. - Lake City, Florida - 386-756-1083

PARCEL: 15-7S-17-09989-000 HX WR - SINGLE FAM (000100)

Name: COLEMAN WILLIAM E	LandVal	\$49,740.00
Site: COLEMAN	BldgVal	\$44,863.00
Mail: 366 SE COLEMAN LANE	ApprVal	\$98,503.00
Info: HIGH SPRINGS, FL 32643	JustVal	\$98,503.00
	Assd	\$54,845.00
	Exmpt	\$25,500.00
	Taxable	\$29,345.00

0 0.08 0.16 0.24 mi



This information, GIS Map Updated: 10/5/2007, was derived from data which was compiled by the Columbia County Property Appraiser Office solely for the governmental purpose of property assessment. This information should not be relied upon by anyone as a determination of the ownership of property or market value. No warranties, expressed or implied, are provided for the accuracy of the data herein, its use, or its interpretation. Although it is periodically updated, this information may not reflect the data currently on file in the Property Appraiser's office. The assessed values are NOT certified values and therefore are subject to change before being finalized for ad valorem assessment purposes.